

BENCHMARK (CITY OF RIVERSIDE) RA 614/66
 CALLINI & MONROE ELEV. 784.72

- NOTES:
- IF THE SUBDIVISION DESIRES TO EXCEED REQUIREMENTS OR IMPROVED BASE MATERIAL, ADDITIONAL SOIL TESTS MAY BE TAKEN AT THE SUBDIVISIONS EXPENSE AFTER STREETS ARE PREPARED TO BE OPENED. SUBDIVISIONS WILL CONTACT INSPECTION DIVISION, CITY OF RIVERSIDE, BEFORE MAKING TESTS.
 - THE CITY OF RIVERSIDE SHALL MAKE A TEST OF BASE MATERIAL IN PLACE BEFORE PAVING CAN BE INSTALLED. RESULTS OF THIS TEST MUST INDICATE THAT THE BASE MATERIAL IS SATISFACTORY TO THE INSPECTION DIVISION.
 - CONSTRUCTION TO BE IN ACCORDANCE WITH STANDARDS AND SPECIFICATIONS OF THE CITY OF RIVERSIDE, DEPT. OF PUBLIC WORKS.
 - STREET NAME SIGNS AND POSTS TO BE FURNISHED AND INSTALLED BY THE SUBDIVIDER AS PER CITY OF RIVERSIDE STANDARD SPEC.

NOTE: It shall be the responsibility of the Contractor to clear the right of way in accordance with the provisions of the law or it affects each utility including irrigation lines and appurtenances and at no cost to the City.

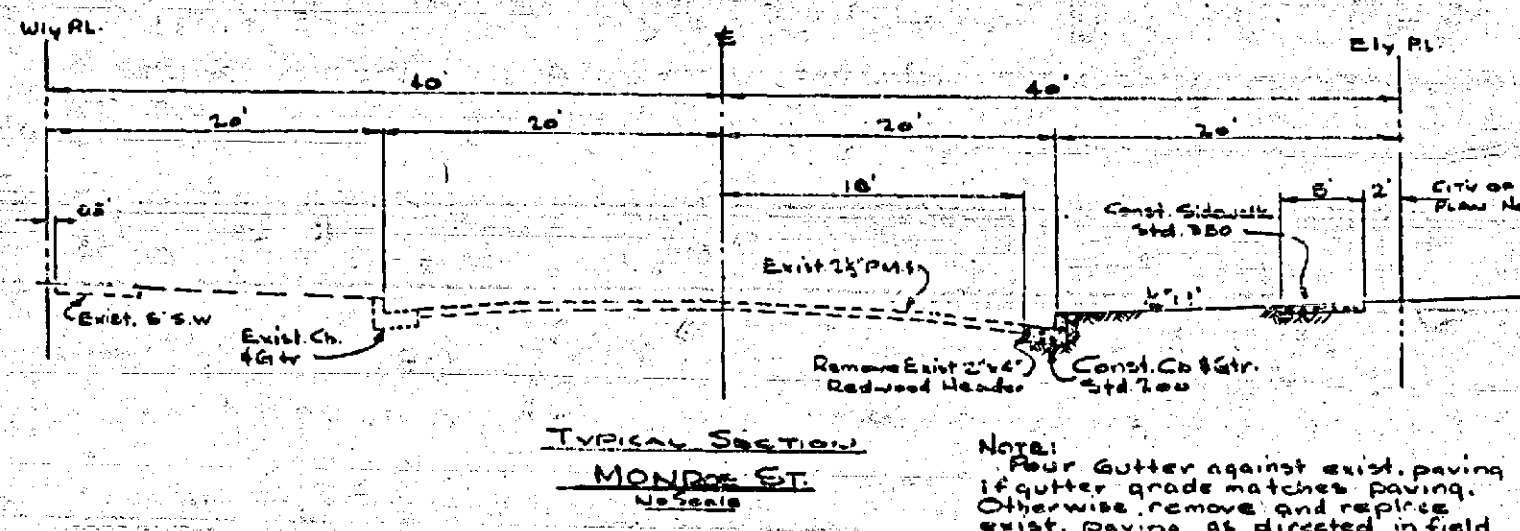

STREET NAME SIGN SCHEDULE

(A)	MONROE ST	4500
(B)	BASWOOD AVE.	8500
(C)	SAUYER PL.	4500
(D)	BASWOOD AVE.	8500
(E)	TOYON RD.	4500
(F)	BASWOOD AVE.	8500
(G)	SAUYER PL.	4500
(H)	RAINYREE AVE.	8500
(I)	RAINYREE AVE.	8500
(J)	TOYON RD.	4500

CURB RETURN DATA

R	A	T	L
55'	30'01"	150'	54.37
75'	05'59"	64.35	54.97

QUANTITY ESTIMATE

CURB AND GUTTER, STD. 100	4622 L.F.
2-GTC AND ASPHALT, STD.	1930 S.F.
5' CONC. SIDEWALK, STD.	20,628 S.F.
2 1/2" PLANT MIX SURFACING	64,258 S.F.
IMPROVED BASE MATERIAL	1,380 CY.
EXCAVATION	

REVISION

MARK	DATE	DESCRIPTION
(1)	7-10-60	Revised Sta. 8500, etc.
(2)	8-2-60	Revised Sta. 8500, etc.

ALBERT A. WEBB ASSOCIATES
 CIVIL ENGINEERS - RIVERSIDE, CALIFORNIA
 APPROVED *Albert A. Webb* DATE 3/23/60

CITY OF RIVERSIDE, CALIFORNIA
 DEPARTMENT OF PUBLIC WORKS

STREET PLAN AND PROFILE
 MONROE STREET
 LE CHATEAU

APPROVED BY *Tom O'Neil*
 DATE 4-1-60

NO. R-375
 SHEET 1 OF 3

PROFILE

DATE	BY
REVISION	

PLAN

DATE	BY
REVISION	

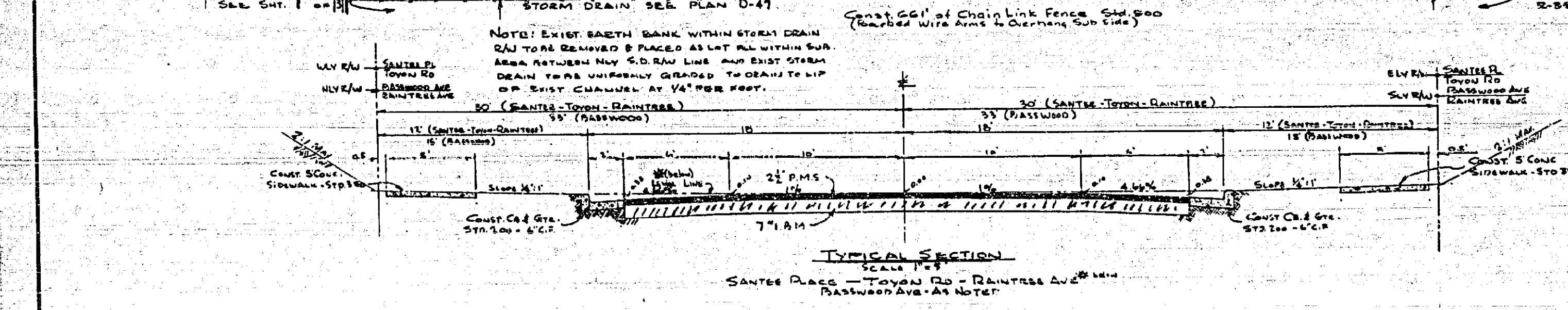
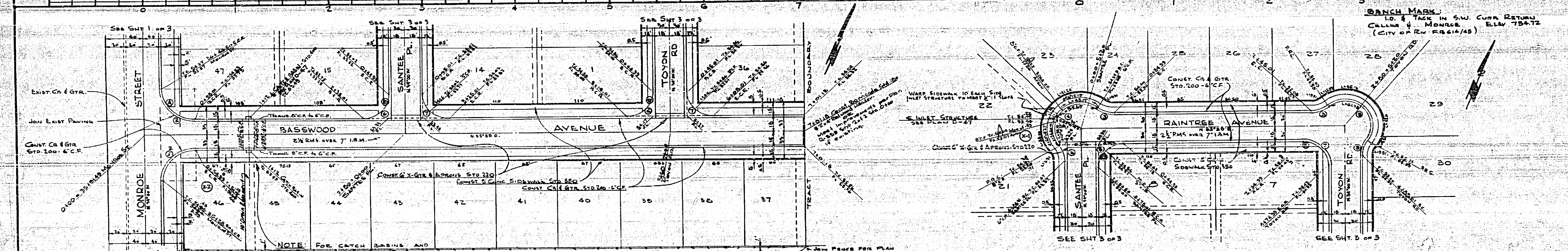

CURB RETURN DATA

NO.	R	A	T	L
1	85'	82'01"	35.01	26.59
2	85'	82'50"	24.39	26.57
3	27'	37'91.45"	9.26	17.84
4	30'	165'42.38"	-	86.77
5	27'	83'55"	26.33	42.40
7	27'	80'01"	27.01	42.42

REVISION

MARK	DATE	DESCRIPTION
(1)	7-30-60	Revised Elev. & Grades due to
(2)	8-2-60	Revised Elev. & Grades due to
		OK by [Signature]

ALBERT A. WEBB ASSOCIATES
CIVIL ENGINEERS - RIVERSIDE, CALIFORNIA

APPROVED: [Signature] DATE 3/23/60

CITY OF RIVERSIDE, CALIFORNIA
DEPARTMENT OF PUBLIC WORKS

STREET PLAN AND PROFILE
RAINTREE AVENUE
BASSWOOD AVENUE
LE CHATEAU

APPROVED BY: [Signature]
DATE 4-1-60

NO. R-375
SHEET 2 OF 3

* RAIN TREE AVE. IS NOT A LEVEL SECTION. THE TOP OF CURB ON THE NORTH (N) SIDE IS 2.15' BELOW THE TOP OF CURB ON THE SOUTH (S) SIDE. PARABOLA SHOPS IS 7.15% ON THE NORTH (N) SIDE.

PROFILE

NO.	DATE	DESCRIPTION

PLAN

NO.	DATE	DESCRIPTION

