

STATION	ELEVATION
315	855.00
316	855.00
317	855.00
318	855.00
319	855.00
320	855.00
321	855.00
322	855.00
323	855.00
324	855.00
325	855.00
326	855.00
327	855.00
328	855.00
329	855.00
330	855.00

HESS ARLINGTON HEIGHTS

B.M. ELEV 859.67 TOP F.H.N.W. COR. VICTORIA & HARRISON.  
 F.B. 683/5-10, 15-16  
 SCALE: HOR. 1"=50'  
 VERT. 1"=5'

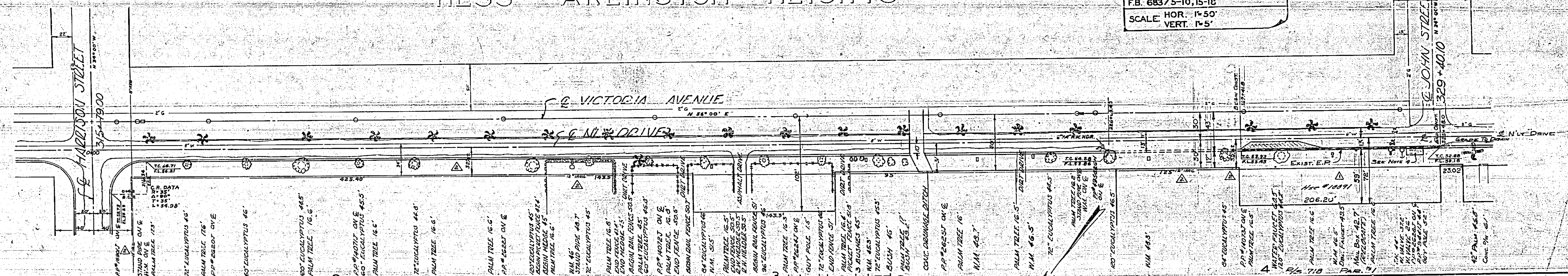

- Notes**
- All construction shall be in accordance with standards and specifications No. 441 of the City of Riverside, Dept. of Public Works.
  - It shall be the responsibility of the contractor to clear the right of way in accordance with the drawings of the law as it affects, such utility, including irrigation lines and appurtenances, and as a part of the city.
  - The utility of existing conditions shall be shown as follows: existing as shown and finally existing as shown in the field in accordance with the approved plan.
  - Construction shall conform to the Standard Specifications for Highway Construction, 1957 Edition, as amended, and as may be amended from time to time, and as may be amended from time to time, and as may be amended from time to time.
  - Prime coat, sand binder, and seal coat will be required.
  - Remove concrete curb and pavement to 10' from center of NLY Drive and construct 5' of A.C. Match-up Pavement, Or 2 1/2" A.C. Over 6" A.B.

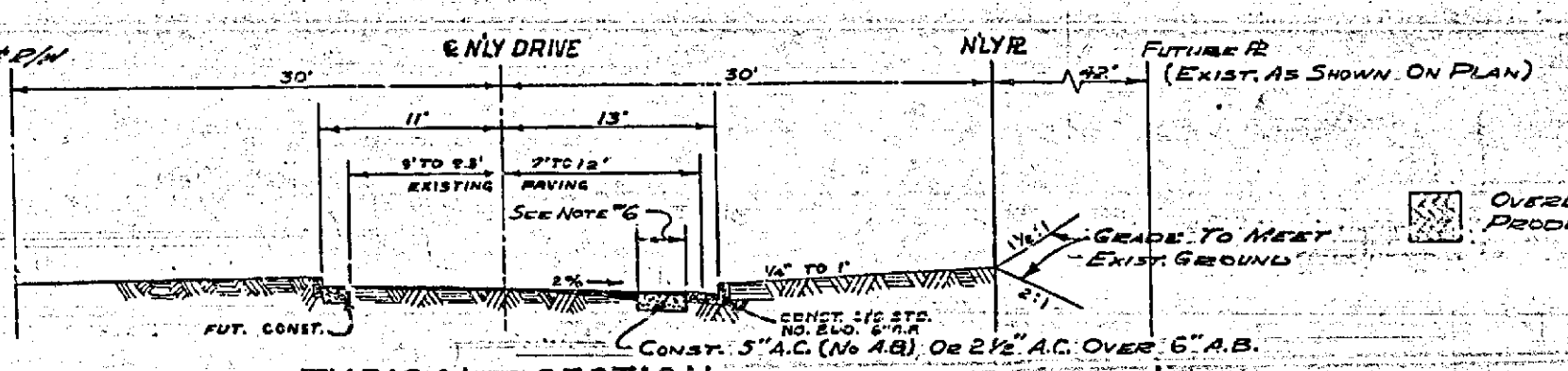

REVISIONS			CITY OF RIVERSIDE, CALIFORNIA DEPARTMENT OF PUBLIC WORKS
MARK	DATE	DESCRIPTION	
1	4-1-63	REVISED LIMITS OF CONSTRUCTION STA. 325+48.25 TO 325+48.00	VICTORIA AVENUE CURB & GUTTER HARRISON STREET TO JOHN STREET
2	5-11-68	CHANGED 5' SIDE TO 12' SIDE FROM THE LOCATION SHOWN ON PLAN	

DESIGNED BY: [Signature]    CHECKED BY: [Signature]    APPROVED BY: [Signature]    PROJ. NO. R-378

DRAWN BY: [Signature]    PARK DEPT. TRAFFIC DIV.    DATE: May 22 1968    SHEET 1 OF 1

