

BENCHMARK:
 G7-E2
 P.K. NAIL & CITY ENGINEER TAG IN THE
 EASTERLY WING OF A CATCH BASIN ON THE
 SOUTHERLY CURB OF ARLINGTON AVE.
 55' EASTERLY OF THE CENTERLINE OF
 VICTORIA AVE.
 ELEV. - 969.928

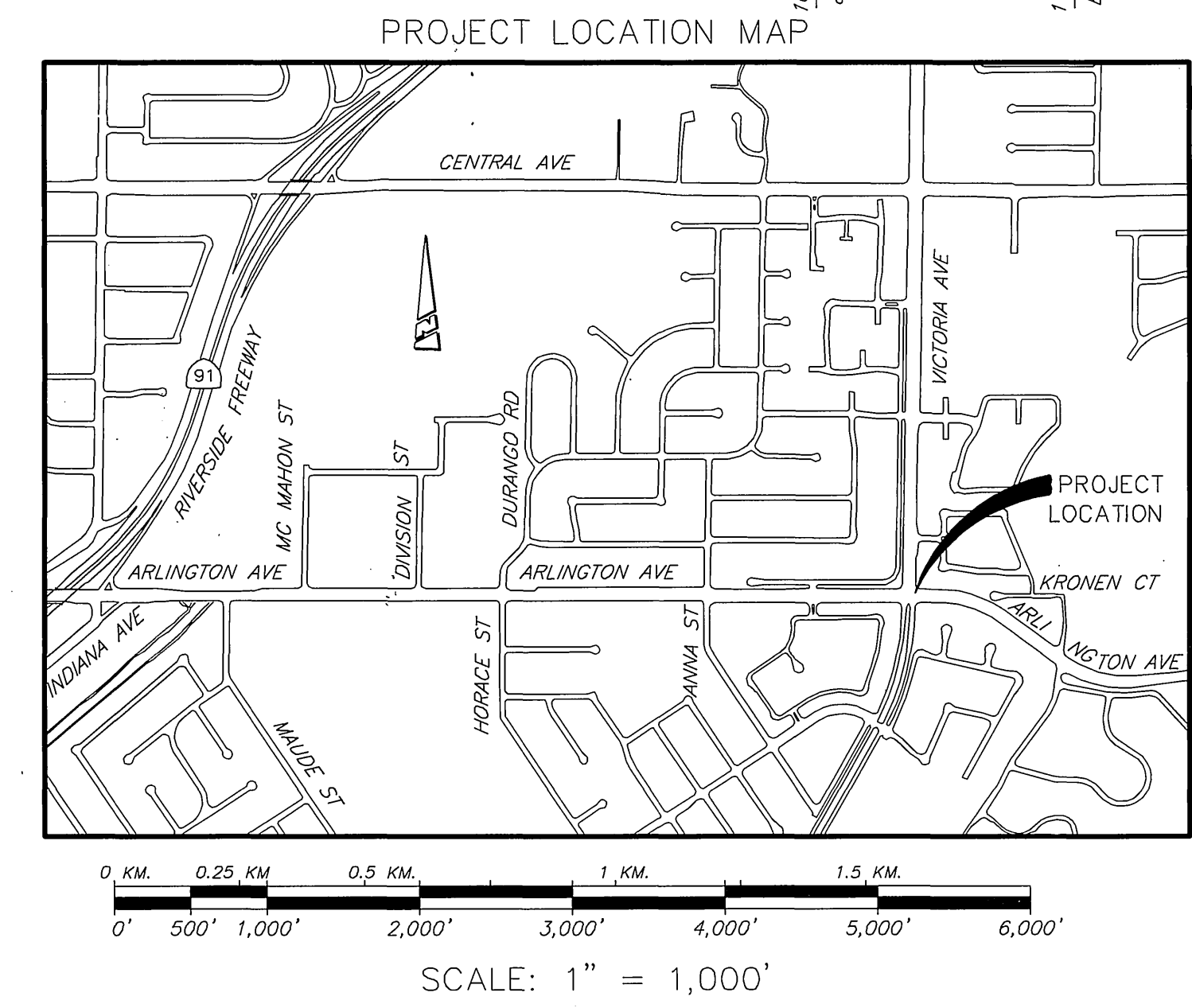

- SPECIFIC CONSTRUCTION NOTES**
- NUMBERS ABOVE 100 IN A HEXAGON ON THE PLAN REFER TO THE RESPECTIVE STANDARD DRAWING AND SHALL BE CONSTRUCTED ACCORDINGLY. UNLESS MODIFICATIONS ARE NOTED ON THE PLAN OR COVER SHEET. ANY NUMBER SHOWN BELOW THE STANDARD DRAWING NUMBER INDICATES THE SPECIFIC ALTERNATE TO BE CONSTRUCTED.
 - Ⓢ CONSTRUCT STRUCTURAL SECTION OF 0.50" D.C.A.C. OVER 0.67" C.A.B. OVER COMPACTED NATIVE SOIL.
 - Ⓐ ADJUST SEWER, STORM DRAIN, ELECTRIC OR WATER MANHOLE OR GATE VALVE TO GRADE. ADJUSTMENT TO GRADE OR RELOCATION OF GAS & TELEPHONE COMPANY'S FACILITIES WILL BE DONE BY OTHERS.
 - Ⓡ REMOVE EXISTING TREE. CLASS I - 6" TO 18", CLASS II - OVER 18" TO 36", CLASS III - OVER 36". (BY OTHERS)
 - Ⓡ RELOCATE EXISTING TRAFFIC CONTROL SIGNS AS DIRECTED BY THE PUBLIC WORKS INSPECTOR AND PER STANDARD DRAWING NUMBER 666.
 - Ⓡ CONSTRUCT VARIABLE THICKNESS D.C.A.C. OVERLAY (0.1" MINIMUM THICKNESS)

- GENERAL CONSTRUCTION NOTES**
- 1 EXISTING UTILITIES SHOWN ON THIS PLAN ARE PLOTTED FROM UTILITY RECORDS. THE CONTRACTOR IS REQUIRED TO TAKE DUE PRECAUTIONARY MEASURES TO LOCATE AND PROTECT ALL UTILITIES WHETHER OR NOT SHOWN ON THIS PLAN. IF THE COVER OF A UTILITY IS KNOWN, IT IS SHOWN IN THE PROFILE. UTILITIES SHOWN IN THE PROFILE AS INDICATES THAT THE COVER IS UNKNOWN, BUT THE UTILITY IS NOT EXPECTED TO CONFLICT WITH THE PROPOSED IMPROVEMENTS.
 - 2 ALL ELEVATIONS SHOWN ON THE PLANS SHALL BE STAKED IN THE FIELD.
 - 3 PRIME CONTRACTORS BIDDING THIS WORK SHALL HAVE A CLASS "A" LICENSE.
 - 4 CONSTRUCTION SHALL BE IN ACCORDANCE WITH THE CITY OF RIVERSIDE STANDARD DRAWINGS AND STANDARD SPECIFICATIONS FOR PUBLIC WORKS CONSTRUCTION, 1997 EDITION.
 - 5 PRIOR TO ISSUANCE OF GRADE SHEETS FOR ANY PROPOSED STORM DRAIN FACILITIES CONTRACTOR SHALL EXPOSE ALL UTILITIES WHICH CROSS OR MAY BE IN CONFLICT WITH THE PROPOSED STORM DRAIN FACILITIES AND COORDINATE WITH THE INSPECTOR TO HAVE THE LOCATION AND ELEVATION VERIFIED BY CITY SURVEYORS.

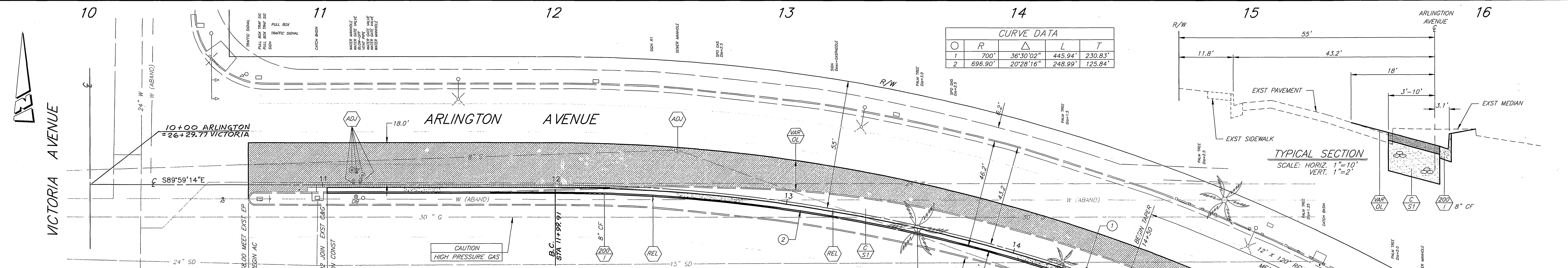
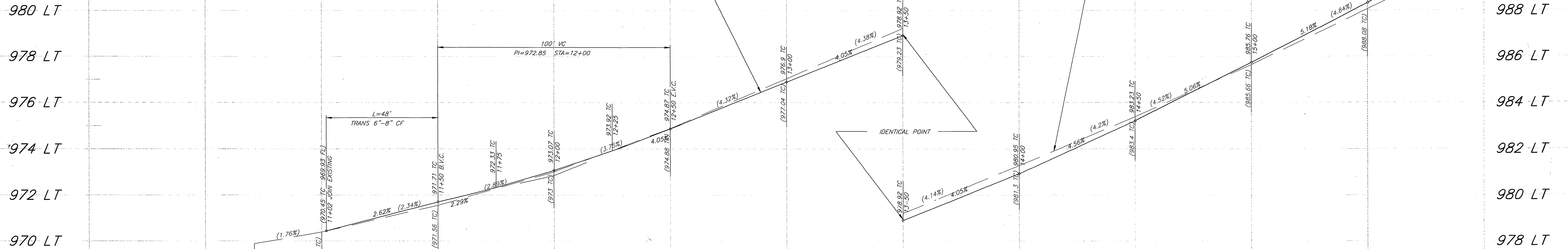
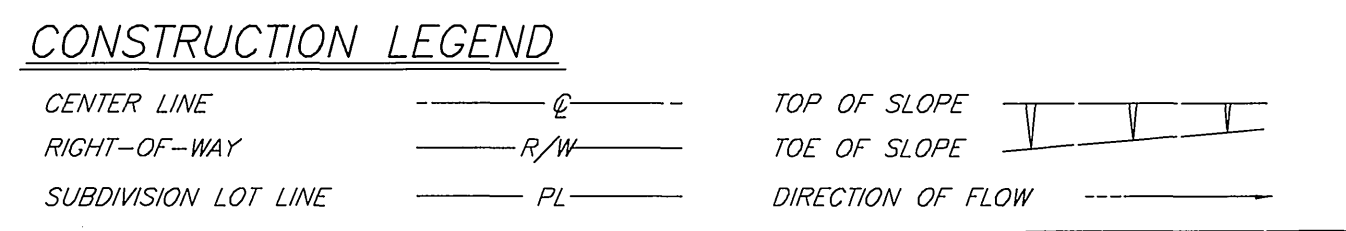

IMPORTANT NOTICE
 Section 4216/4217 of the Government Code requires a Dig Alert Identification Number to be issued before a permit to excavate will be voided. For your Dig Alert ID Number call CALL TOLL FREE 48 HOURS BEFORE YOU DIG UNDERGROUND SERVICE ALERT 1-800-227-2600

ENGINEER IN RESPONSIBLE CHARGE
 PHILIP L. HANNAWAY
 R.C.E. No. 44747 expires 3/31/06
 DATE 5/11/05

REGISTERED PROFESSIONAL ENGINEER
 PHILIP L. HANNAWAY
 No. 44747
 Exp. 3-31-2006
 CIVIL
 STATE OF CALIFORNIA

CITY OF RIVERSIDE, CALIFORNIA
PUBLIC WORKS DEPARTMENT

APPROVED BY: [Signature] DATE: 5/11/05
 CITY ENGINEER

ARLINGTON AVENUE
MEDIAN
FROM 600' E'LY
OF VICTORIA AVENUE

HORIZ. SCALE: 1" = 20' VERT. SCALE: 1" = 2'

ACCT. No.: 9576230214-440302XX
R-3796
 SHEET 1 OF 1

INDEXED 6-24-05 Lft