

B.M. ELEV. 1042.48 - TOP I.P. UNDER CAP AT SUNSET DR. 159' WESTERLY OF E. SHADOW HILL DR.
 F.B. 617-26/28 667/35
 Scales: HOR. 1"=20' VERT. 1"=5'

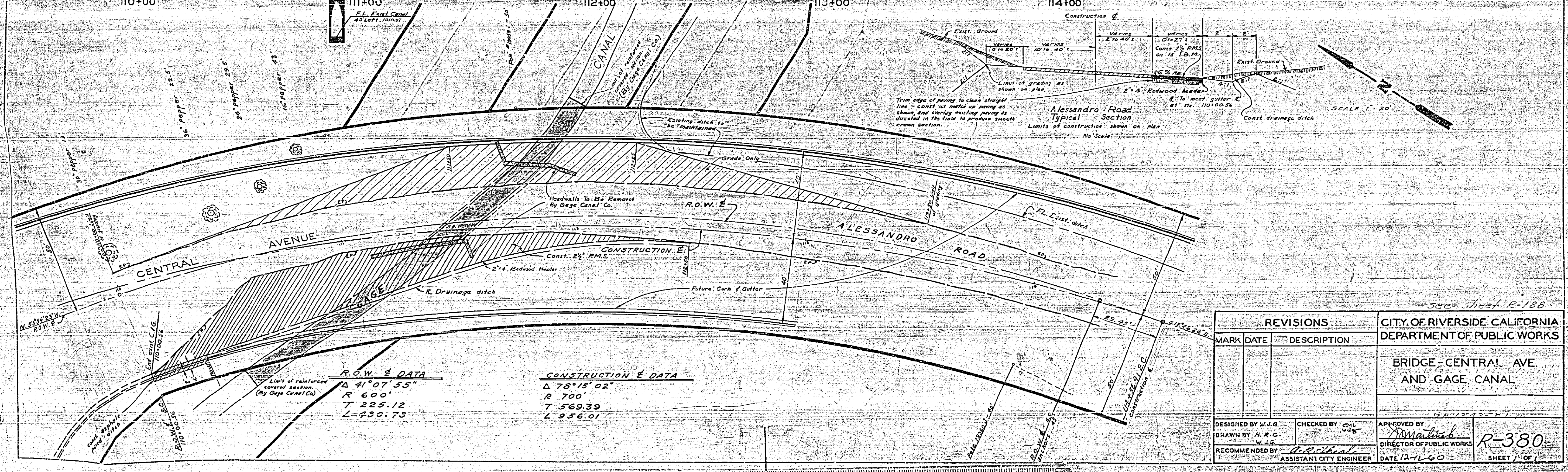

R.O.W. E DATA
 Δ 41°07'55"
 R 600'
 T 225.12
 L 230.73

CONSTRUCTION E DATA
 Δ 75°15'02"
 R 700'
 T 569.39
 L 956.01

REVISIONS		CITY OF RIVERSIDE, CALIFORNIA DEPARTMENT OF PUBLIC WORKS	
MARK	DATE	DESCRIPTION	
		BRIDGE - CENTRAL AVE AND GAGE CANAL	
DESIGNED BY W.J.G.		CHECKED BY <i>[Signature]</i>	APPROVED BY <i>[Signature]</i>
DRAWN BY W.A.S.		DIRECTOR OF PUBLIC WORKS	
RECOMMENDED BY <i>[Signature]</i>		ASSISTANT CITY ENGINEER	DATE 12-1-60
			R-380 SHEET 1 OF 1

PROFILE	MARK	DATE	DESCRIPTION

PLAN	MARK	DATE	DESCRIPTION

