

- GENERAL NOTES**
- If the Subdivider desires to reduce the requirements on import base material, additional soil tests may be taken at Subdivider's expense after streets are prepared to rough grade. Subdivider will contact inspection division, City of Riverside, before making tests.
  - The City will make a test of base material in place before paving can be installed, results of this test must indicate that the base material is satisfactory to the inspection division.
  - Construction to be in accordance with Specifications and Standards of the City of Riverside, Department of Public Works.
  - Street name signs and posts to be furnished and installed by the Subdivider as per City Specifications and Standard Dwg. No. 662.
  - It shall be the responsibility of the Contractor to clear the right of way in accordance with the provisions of the law as it affects each utility including irrigation lines and appurtenances and at no cost to the City.

**QUANTITY ESTIMATE**

Curb & Gutter Std. #200-6" C.F.	2,993 lin. ft.
24" P.M.S. with seal coat	25,474 sq. ft.
Cross Gutter Std. #220	701 sq. ft.
Sidewalk Std. #350	11,935 sq. ft.
6" Imported Base Material	650 cu. yds.
Barricade Std. #80	1
6" concrete block wall Std. #704	450 lin. ft.
Excavation	9,780 cu. yds.
2"x4" Redwood Header	40 lin. ft.

**ALBERT A. WEBB ASSOCIATES**  
 CIVIL ENGINEERS - RIVERSIDE, CALIFORNIA  
 APPROVED: [Signature] DATE: 2-26-60

**CITY OF RIVERSIDE, CALIFORNIA**  
 DEPARTMENT OF PUBLIC WORKS

**STREET PLAN & PROFILE**  
**HILLSIDE AVENUE**  
**SHERRY PARK ESTATES**

MARK	DATE	DESCRIPTION

DATE: Feb. 19, 1960  
 DRAWN: REC  
 CHECKED: J.A. 416

NO. **R-381**  
 SHEET 1 OF 2

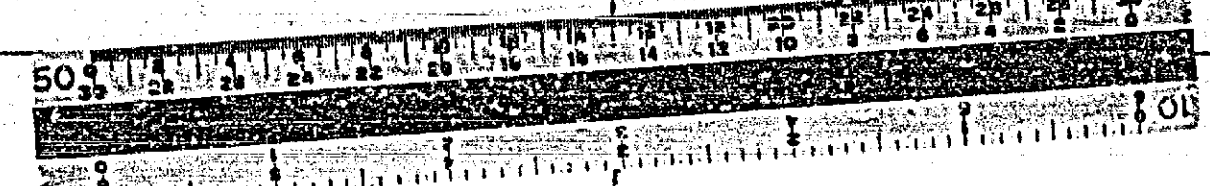

**PROFILE**

NO.	DATE	BY

**PLAN**

NO.	DATE	BY

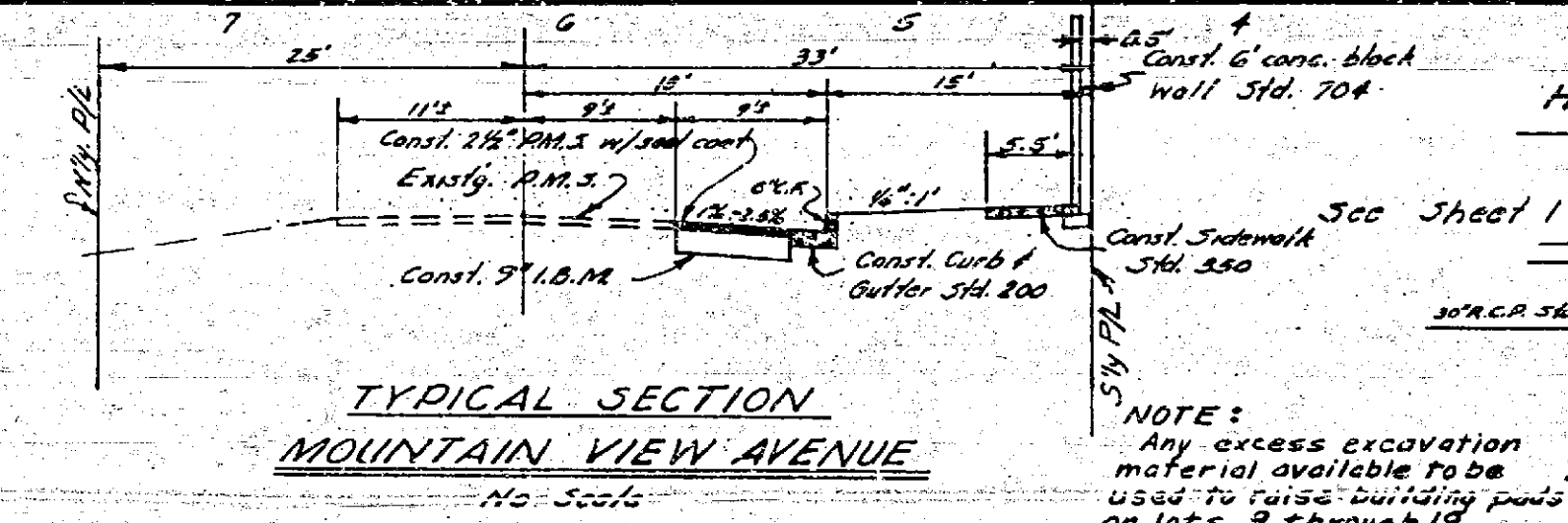
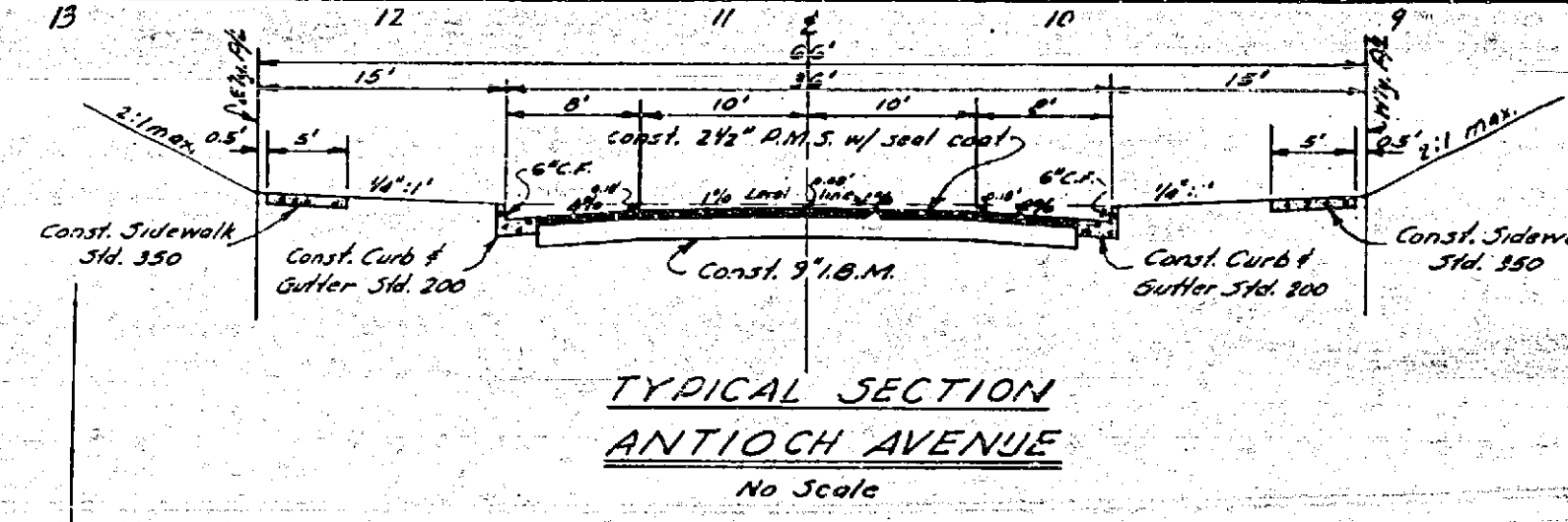
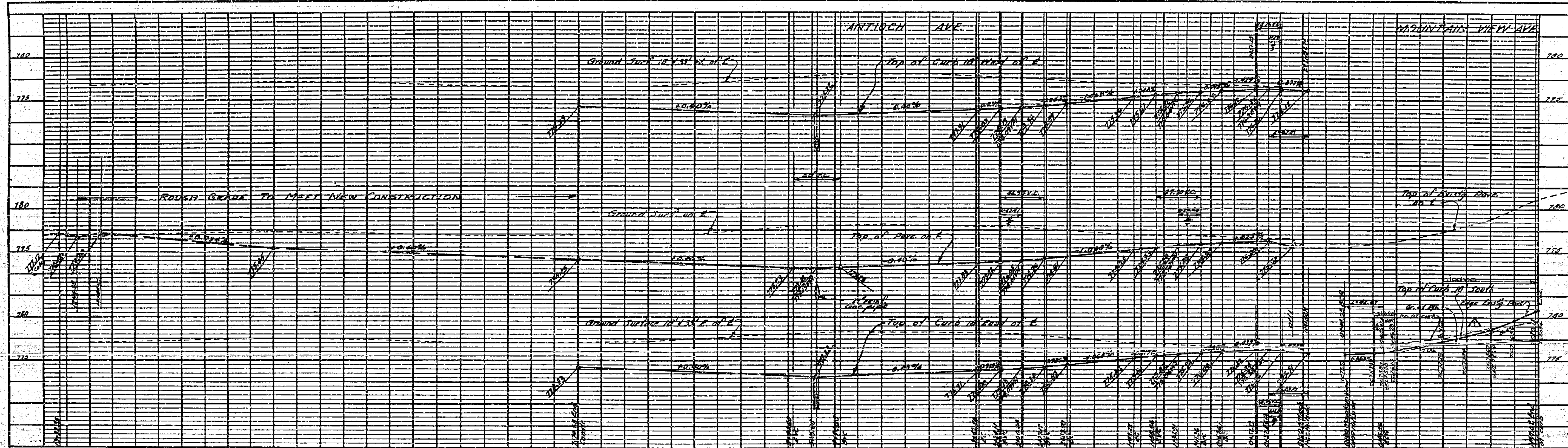

NOTE:  
Any excess excavation material available to be used to raise building pads on lots 9 through 19

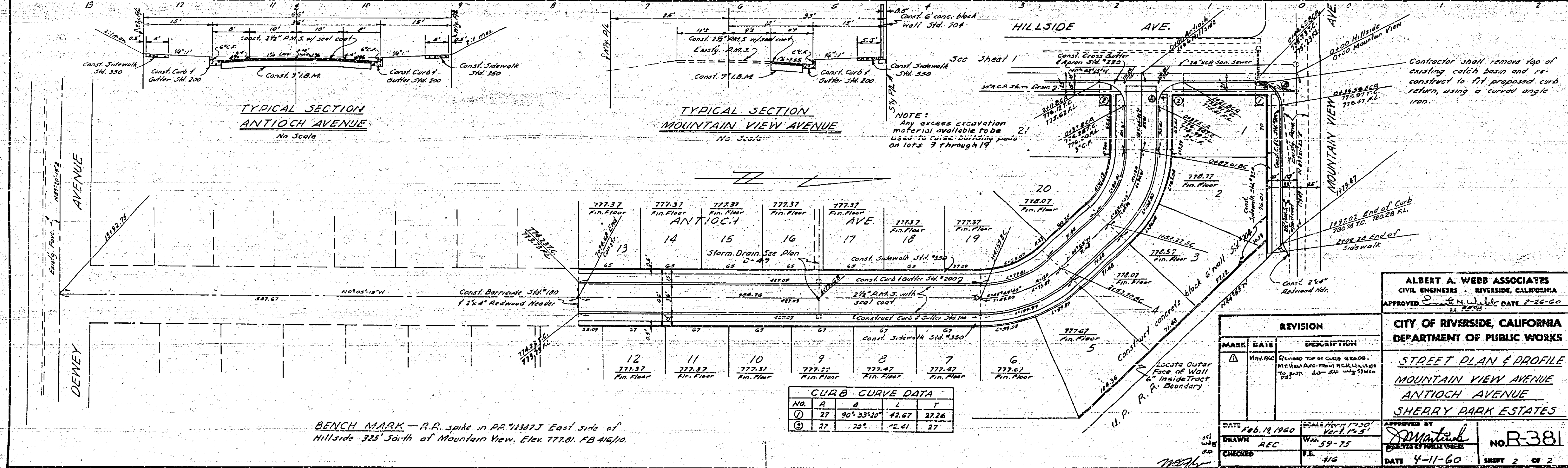

**CURB CURVE DATA**

NO.	R	A	L	T
①	27	90° 33' 20"	42.67	27.26
②	27	70°	42.61	27

BENCH MARK - R.R. spike in PR 72387J East side of Hillside 325' South of Mountain View. Elev. 777.01. FB 416/10.

ALBERT A. WEBB ASSOCIATES  
 CIVIL ENGINEERS - RIVERSIDE, CALIFORNIA  
 APPROVED: *[Signature]* DATE: 2-26-60

CITY OF RIVERSIDE, CALIFORNIA  
 DEPARTMENT OF PUBLIC WORKS  
**STREET PLAN & PROFILE**  
 MOUNTAIN VIEW AVENUE  
 ANTIOCH AVENUE  
 SHERRY PARK ESTATES

**REVISION**

MARK	DATE	DESCRIPTION
Δ	MAY 1960	REVISED TOP OF CURB GRADE - MOUNTAIN VIEW AVENUE FROM 776.00 TO 776.41

DATE: Feb. 19, 1960  
 DRAWN: REC  
 CHECKED: P.K.

APPROVED BY: *[Signature]*  
 DATE: 4-11-60  
 SHEET 2 OF 2

**PROFILE**

NO.	DATE	BY	CHKD.

**PLAN**

NO.	DATE	BY	CHKD.

