

LOCATION # 1 - N.T.S.  
CENTRAL CITY FOCUS AREA

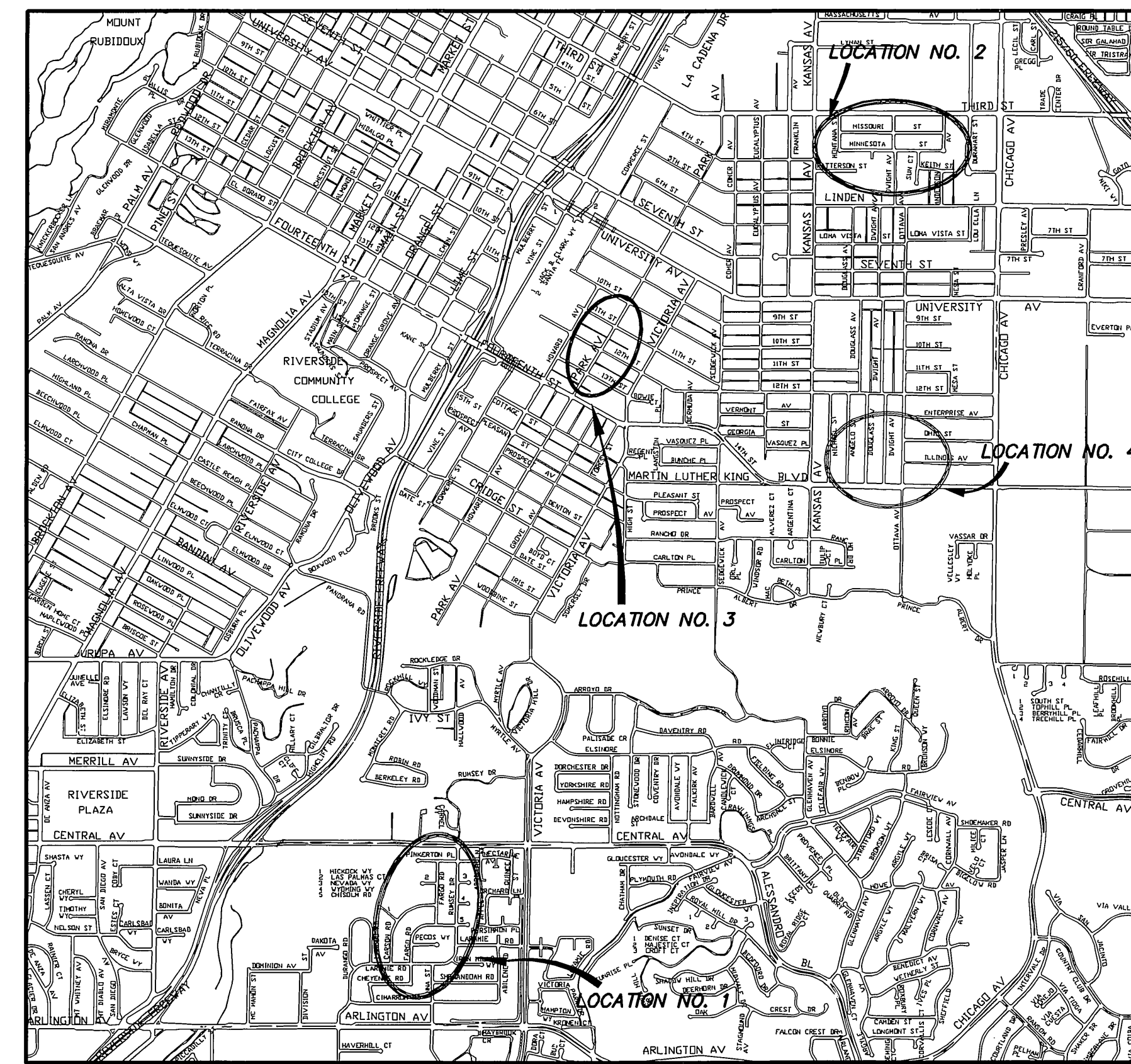

PROJECT LOCATION MAP  
N.T.S.

GENERAL CONSTRUCTION NOTES

- 1 PRIME CONTRACTORS BIDDING THIS WORK SHALL HAVE A CLASS A OR C-B LICENSE.
- 2 CONFLICTING UTILITIES, IF ANY, WITHIN CONSTRUCTION AREA, SHALL BE RELOCATED PRIOR TO CONSTRUCTION.
- 3 TREES AND SHRUBS, AFFECTED BY THE PROPOSED SIDEWALK CONSTRUCTION, SHALL BE TRIMMED TO AT LEAST 4' VERTICALLY ABOVE THE SIDEWALK SURFACE AND TO AT LEAST 3' LATERALLY OF THE SIDEWALK, WHERE RIGHT-OF-WAY PERMITS.
- 4 ALL STREET PULL BOXES AFFECTED BY CONSTRUCTION, SHALL BE ADJUSTED TO THE PROPOSED SIDEWALK GRADE.
- 5 EXISTING SPRINKLERS AND IRRIGATION LINES, AFFECTED BY THE CONSTRUCTION OF THE PROPOSED SIDEWALK, SHALL BE MODIFIED AS NECESSARY TO MEET IRRIGATION REQUIREMENTS. NEW PIPES AND SPRINKLER HEADS SHALL BE SAME OR EQUAL TO EXISTING AS APPROVED BY INSPECTOR.

SPECIFIC CONSTRUCTION NOTES

- NUMBERS, ABOVE 100 IN A HEXAGON ON THE PLAN, REFER TO THE RESPECTIVE STANDARD DRAWING AND SHALL BE CONSTRUCTED ACCORDINGLY, UNLESS MODIFICATIONS ARE NOTED ON THE PLAN OR COVER SHEET. ANY NUMBER SHOWN BELOW THE STANDARD DRAWING NUMBER INDICATES THE SPECIFIC ALTERNATE TO BE CONSTRUCTED.
- ▲▲▲ CONSTRUCT WHEELCHAIR RAMP PER STD. DWG. 304.

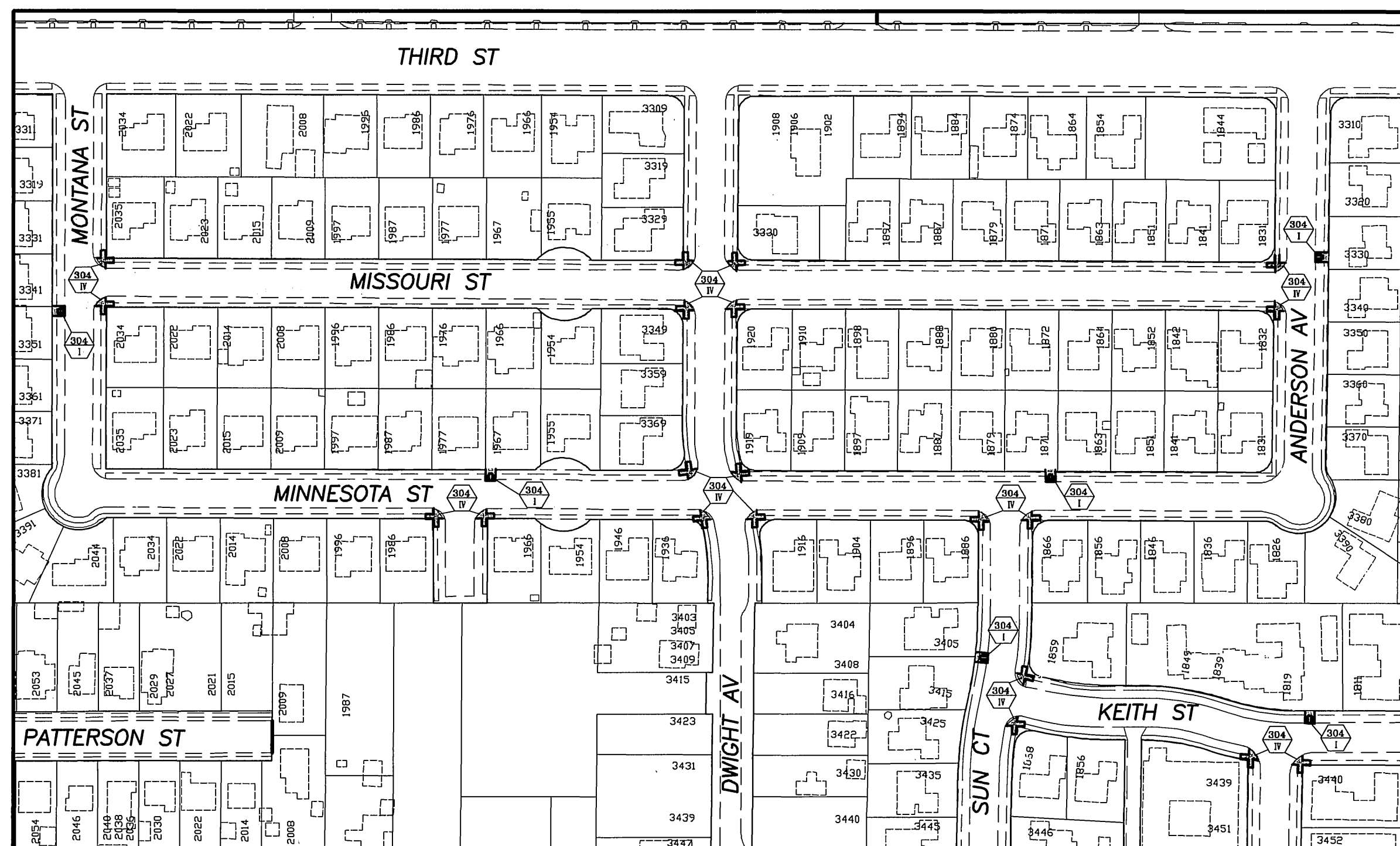

LOCATION # 2 - N.T.S.  
NORTH END FOCUS AREA



LOCATION # 3 - N.T.S.  
NORTH END FOCUS AREA

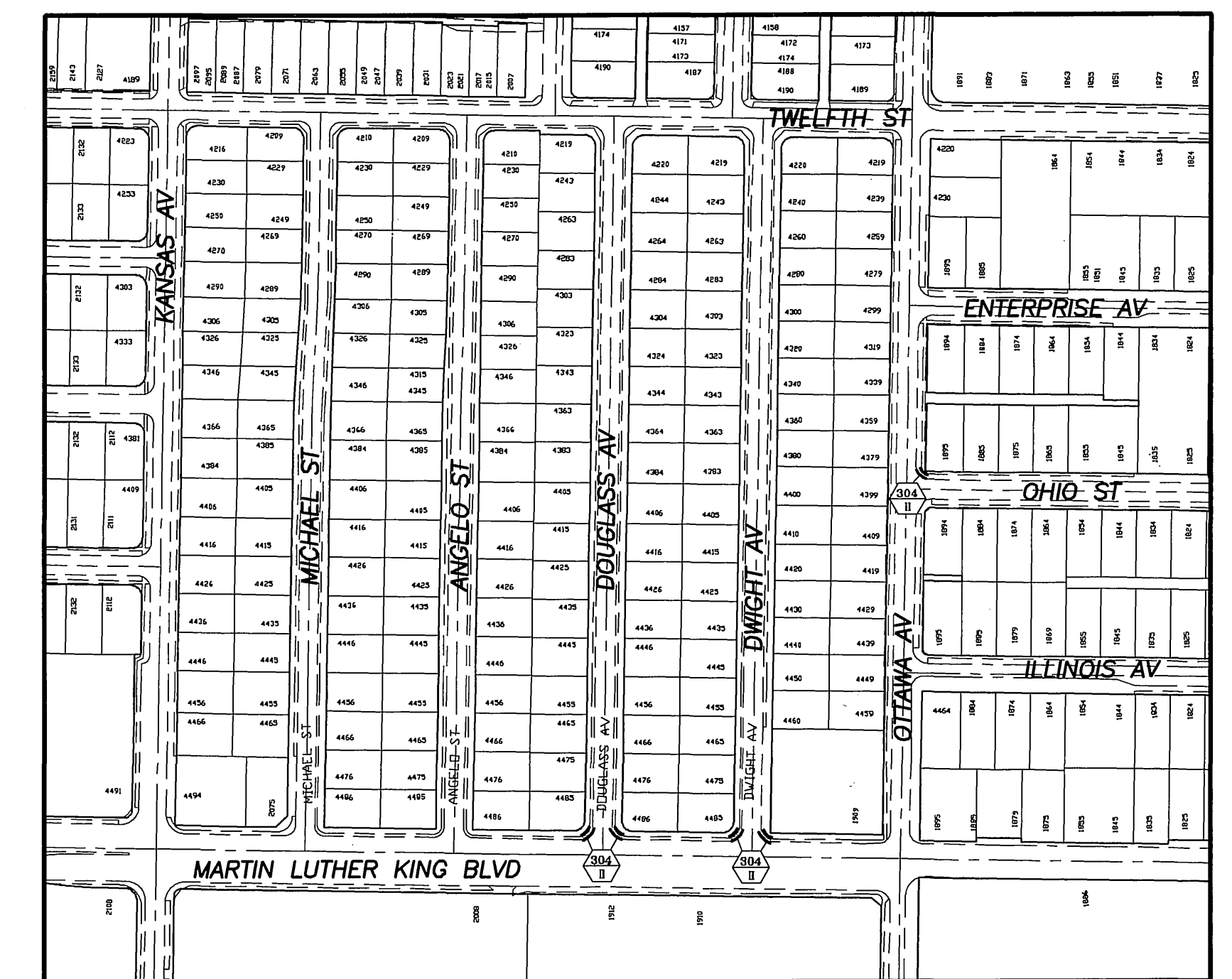

LOCATION # 4 - N.T.S.  
NORTH END FOCUS AREA

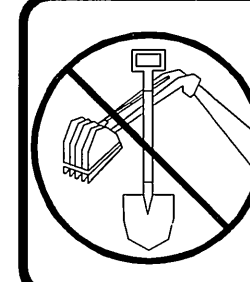

**IMPORTANT NOTICE**  
Section 42106/42117 of the Government Code requires a Dig Alert identification number to be issued before a "Permit to Excavate" will be valid. For your Dig Alert ID, Number call CALL TOLL FREE 48 HOURS BEFORE YOU DIG UNDERGROUND SERVICE ALERT 1-800-227-2600

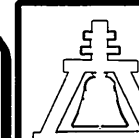

**ENGINEER IN RESPONSIBLE CHARGE**  
Philip L. Hannawi  
R.C.E. No. 44747 expires 3/31/06  
DATE 8/31/05

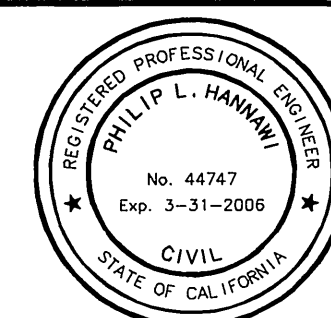

MARK	REVISIONS	APPR.	DATE
DESIGNED BY	DRAWN BY	CHECKED BY	

CITY OF RIVERSIDE, CALIFORNIA PUBLIC WORKS DEPARTMENT			
APPROVED BY	BY	DATE	
PRINCIPAL ENGINEER	PH	8/31/05	
CONST. CONTRACT ADMIN.	SA	8/31/05	
STREET SERVICES	SA	9-1-05	
SURVEYOR			
TRAFFIC DIVISION			
PARKS-DEPARTMENT			

2005-2006 CDBG  
**WHEELCHAIR RAMP FOR CENTRAL CITY & NORTH END FOCUS AREAS**  
NOT TO SCALE

ACCT. NO. 9225200611-440120XX  
**R-3876**  
SHEET 1 OF 1  
FILE: