

CONSTRUCTION LEGEND:

- NUMBERS ABOVE 100 IN A HEXAGON ON THE PLAN REFER TO THE RESPECTIVE STANDARD DRAWING AND SHALL BE CONSTRUCTED ACCORDINGLY, UNLESS MODIFICATIONS ARE NOTED ON THE PLAN. ANY NUMBER SHOWN BELOW THE STANDARD DRAWING NUMBER INDICATES THE SPECIFIC ALTERNATE TO BE CONSTRUCTED.
- ADJUST GATE VALVE COVER TO GRADE.
- ADJUST WATER METER VAULT TO GRADE.
- CONSTRUCT STRUCTURAL SECTION OF 0.3" AC OVER 0.45" MISCELLANEOUS BASE (PER C/R PLAN NO. R-3719).
- GRIND EXISTING WHEELCHAIR RAMP CURB FACE HEIGHT TO 0".
- REMOVE CLASS 1 TREE (18" OR LESS DIAMETER) AS SHOWN ON THE PLANS.
- RELOCATE TRAFFIC SIGNAL FACILITIES.
- INSTALL TRAFFIC DETECTING LOOPS.
- PUBLIC UTILITIES DEPARTMENT, WATER DIVISION TO RELOCATE PRIOR TO CONSTRUCTION.
- CONST. 6" THICK CONCRETE DRIVEWAY PER CITY STD. NO. 302.

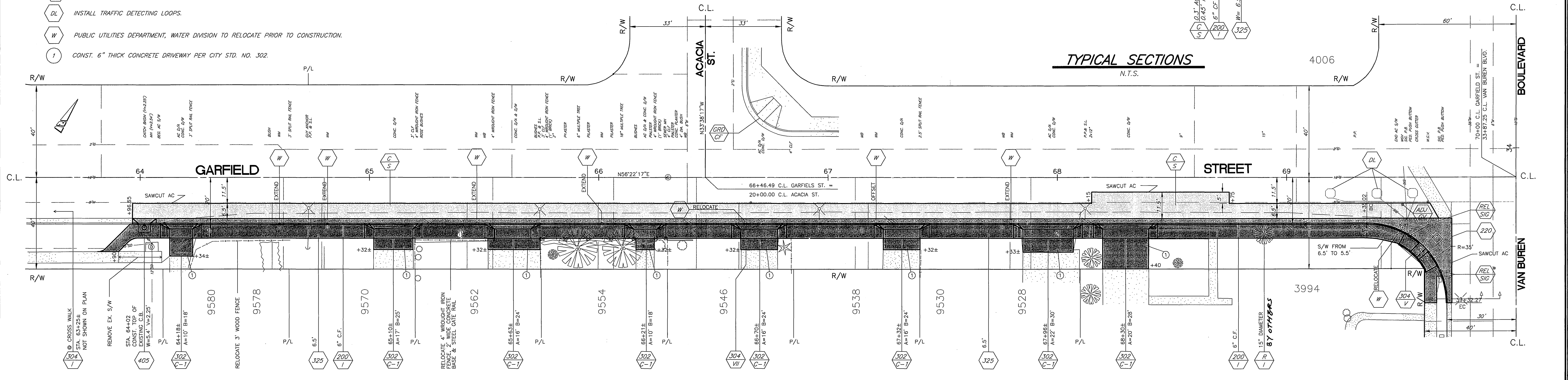
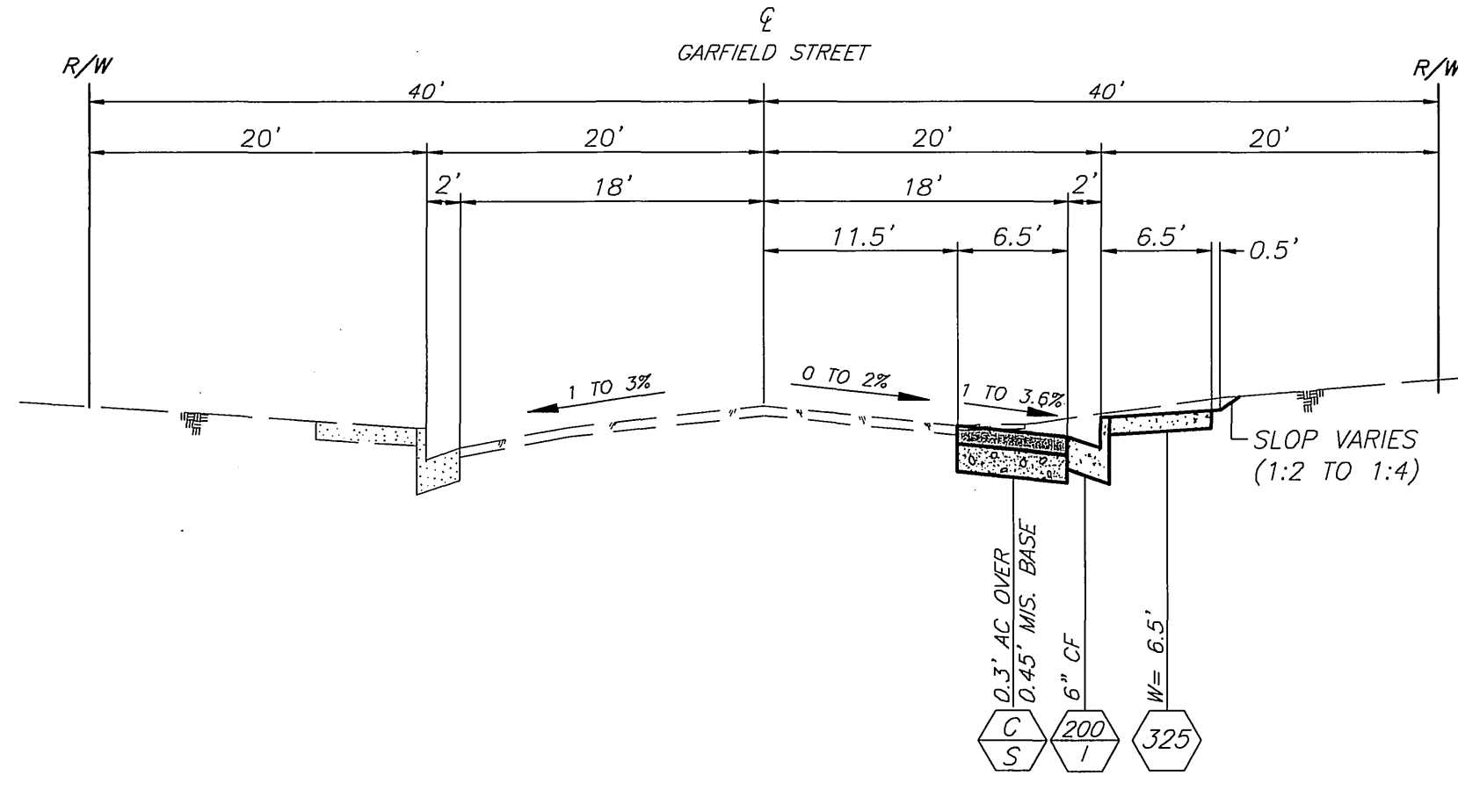

IMPORTANT NOTICE
 Section 42121.1 of the Government Code requires a Dig Alert Identification Number to be placed before a "Permit to Excavate" will be valid for your 30' alert I.D. Number call CALL TOLL FREE 48 HOURS BEFORE YOU DIG UNDERGROUND SERVICE ALERT 1-800-227-2600

BENCHMARK: F4-D3
 P.K. NAIL AND CITY ENGINEER TAG IN THE MOST EASTERLY CURB RETURN OF VAN BUREN BLVD. AND GARFIELD ST.
 ELEVATION: 771.483'

STATION	CHORD	CHORD	CHORD
1	89'58'07"	35'	54.96'
			34.98'

CURVE DATA

ENGINEER IN RESPONSIBLE CHARGE
 PHILIP HANNAWI
 R.C.E. No. 44747 expires 3/31/2006
 DATE 10/17/05



MARK	REVISIONS	APPR.	DATE

CITY OF RIVERSIDE, CALIFORNIA
 PUBLIC WORKS DEPARTMENT

APPROVED BY: PH 10/17/05
 TRAFFIC DIVISION: 10/17/05
 SURVEYOR: 10/17/05
 STREET SERVICES: 10/17/05
 INSPECTION: 10/17/05
 PARK & REC. DEPT.

GARFIELD STREET IMPROVEMENTS
 S'LY SIDE FROM SEQUOIA STREET TO VAN BUREN BOULEVARD

HORIZ. SCALE: 1" = 20' VERT. SCALE: 1" = 2'

ACCT. NO.: R-3882
 SHEET 1 OF 1
 FILE: COMMON/COMPLETE/R-3874