

**GENERAL CONSTRUCTION NOTES:**

- 1). CONSTRUCTION SHALL BE IN ACCORDANCE WITH THE CITY OF RIVERSIDE STANDARD DRAWINGS AND STANDARD SPECIFICATIONS FOR PUBLIC WORKS CONSTRUCTION, 2003 EDITION.
- 2). EXISTING UTILITIES SHOWN ON THIS PLAN ARE PLOTTED FROM PUBLIC RECORDS. THE CONTRACTOR IS REQUIRED TO TAKE DUE PRECAUTIONARY MEASURES TO LOCATE AND PROTECT ALL UTILITIES WHETHER OR NOT SHOWN ON THIS PLAN.
- 3). CONTRACTOR SHALL POT-HOLE AND VERIFY ALL LOCATIONS AND ELEVATIONS OF UTILITIES PRIOR TO THE START OF CONSTRUCTION TO ELIMINATE INTERFERENCE WITH NEW CONSTRUCTION.
- 4). ALL ELEVATIONS SHOWN ON THIS PLAN SHALL BE STAKED IN THE FIELD.
- 5). ANY WORK THAT WILL CAUSE DAMAGE TO THE DETECTOR LOOPS SHALL NOT BE PERFORMED UNTIL TRAFFIC SIGNAL MAINTENANCE PERSONNEL HAVE BEEN NOTIFIED AND THE NECESSARY TIMING ADJUSTMENTS ARE MADE TO MAINTAIN SIGNAL OPERATION.
- 6). CONTRACTOR SHALL REPLACE ALL EXISTING TRAFFIC DETECTOR LOOPS AFFECTED BY CONSTRUCTION.
- 7). TEMPORARY CONSTRUCTION EASEMENTS HAVE BEEN OBTAINED FOR WORK SHOWN OUTSIDE OF CITY RIGHT OF WAY.
- 8). CONTRACTOR SHALL RELOCATE ALL TRAFFIC SIGNS REMOVED DUE TO CONSTRUCTION. PER CITY STANDARDS.
- 9). SEE PLAN S-1852 FOR SEWER IMPROVEMENTS ALONG TEQUESQUITE AVENUE.
- 10). WATER METER VAULTS AND PULL BOXES AFFECTED BY CONSTRUCTION SHALL BE ADJUSTED TO GRADE BY THE CONTRACTOR.

**SPECIFIC CONSTRUCTION NOTES:**

- 1) PROPOSED 36" VCP SEWER PER PLAN S-1852
- 2) PROTECT AND SUPPORT IN PLACE.
- 3) PEDESTRIAN ACCESS MUST BE MAINTAINED WHENEVER CONSTRUCTION IS NOT OCCURRING PLACE TEMPORARY A.C. WHEELCHAIR RAMP.
- 4) CONSTRUCT VARIABLE THICKNESS AC OVERLAY TO MATCH GUTTER LIP TO EXISTING PAVEMENT.

NUMBERS ABOVE 100 IN A HEXAGON ON THE PLAN REFER TO THE RESPECTIVE STANDARD DRAWING AND SHALL BE CONSTRUCTED ACCORDINGLY, UNLESS MODIFICATIONS ARE NOTED ON THE PLAN. ANY NUMBER SHOWN BELOW THE STANDARD DRAWING NUMBER INDICATES THE SPECIFIC ALTERNATE TO BE CONSTRUCTED.

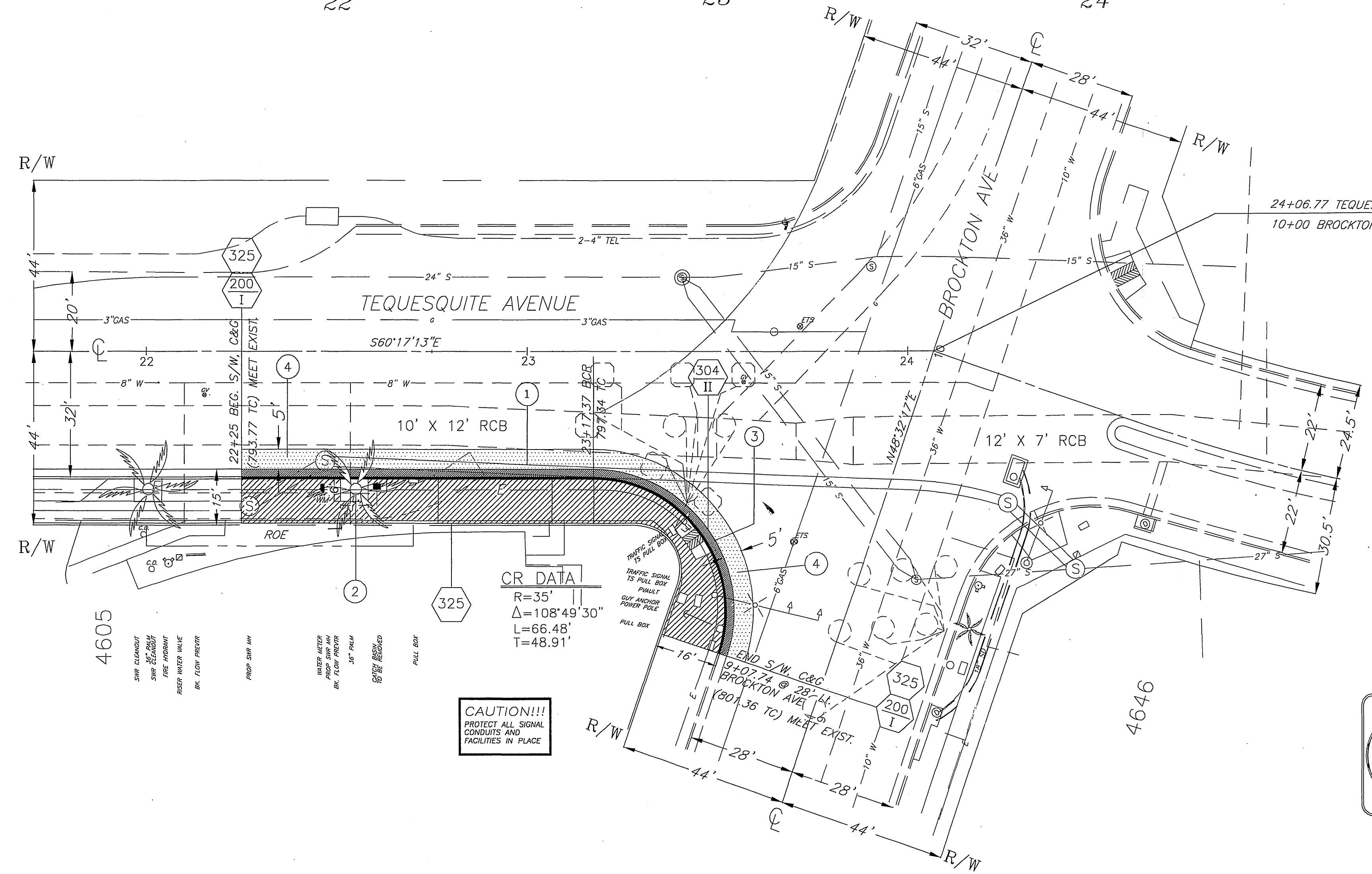

**BENCHMARK**  
15-C2 BRASS DISK STAMPED "16-C" AT THE CENTERLINE INTERSECTION OF PALM AVENUE AND PINE STREET  
ELEV= 773.826

**IMPORTANT NOTICE**  
Section 4216.4217 of the Government Code requires a Dig Alert Identification Number to be issued before a "Permit to Excavate" will be valid. For your Dig Alert ID Number call CALL TOLL FREE 48 HOURS BEFORE YOU DIG UNDERGROUND SERVICE ALERT 1-800-227-2600

ENGINEER IN RESPONSIBLE CHARGE  
*Lauren F. Caldwell*  
LAUREN F. CALDWELL  
R.C.E. No. 39441 expires 12/31/05  
DATE 11/2/2005



MARK	REVISIONS	APPR.	DATE

CITY OF RIVERSIDE, CALIFORNIA  
PUBLIC WORKS DEPARTMENT  
APPROVED BY: *[Signature]*  
PRINCIPAL ENGINEER  
INSPECTION: *[Signature]*  
SURVEYOR: *[Signature]*  
WASTE WATER OPS. MGR. *[Signature]*  
DATE: 4/26/05

TEQUESQUITE SEWER  
TEQUESQUITE AVENUE CURB REPLACEMENT  
S'LY SIDE OF TEQUESQUITE AVE FROM  
BROCKTON AVE TO 170' W'LY  
HORIZ. SCALE: 1" = 20'  
VERT. SCALE: 1" = 5'

ACC. No. 9764223203-44030109  
W.O. 0501807  
R-3889  
SHEET 1 OF 1