

CONSTRUCTION NOTES:

- NUMBERS ABOVE 100 IN A HEXAGON ON THE PLAN REFER TO THE RESPECTIVE STANDARD DRAWING AND SHALL BE CONSTRUCTED ACCORDINGLY, UNLESS MODIFICATIONS ARE NOTED ON THE PLAN. ANY NUMBER SHOWN BELOW THE STANDARD DRAWING NUMBER INDICATES THE SPECIFIC ALTERNATE TO BE CONSTRUCTED.
- COLD MILL EXISTING A/C 0.1" DEEP.
- COLD MILLING - TYPE 1 (10' WIDE), THE MILLING DEPTH AT BEGIN POINT SHALL BE 0.10" AND STRAIGHT GRADED IN 10' TO MATCH EXISTING PAVEMENT SURFACE.
- CONSTRUCT STRUCTURAL SECTION OF 0.33' DGAC OVER 0.85' CRUSHED MISCELLANEOUS BASE (T.I.=6, R-VALUE=12)
- OVERLAY EXISTING PAVEMENT WITH 0.10" MIN THICKNESS DGAC.
- ADJUST WATER, SEWER OR TELEPHONE MANHOLE COVER TO GRADE.
- ADJUST WATER GATE VALVE COVER TO GRADE.
- ADJUST WATER METER BOX TO GRADE.
- PROTECT IN PLACE (DESCRIPTION PER PLAN).
- REMOVE AND/OR RELOCATE EXISTING FEATURE: SGN-SIGN, TBL-PICNIC TABLE
- SAWCUT EXISTING A/C WHERE SHOWN ON PLAN.
- REMOVE EXISTING CONCRETE WALKWAY AS NEEDED FOR NEW CONSTRUCTION AS SHOWN ON PLAN AND DESCRIBED IN THE SPECIAL PROVISIONS.
- CONCRETE FOOTING TO BE REMOVED BY CONTRACTOR AS DESCRIBED IN THE SPECIAL PROVISIONS.
- REMOVE EXISTING 6" RETAINING CURB WHERE SHOWN ON PLAN.
- EXISTING STREET LAMP AND ELECTRIC PULLBOX TO BE REMOVED/RELOCATED BY OTHERS.
Remove chain link fence

CONSTRUCTION NOTES (CONTINUED):

- EXISTING STREET LIGHTS AND PULL BOXES TO BE RELOCATED OR REMOVED BY RIVERSIDE PUBLIC UTILITIES. AS NEEDED. (SEE STREET LIGHT PLANS)
- REMOVE/RELOCATE IRRIGATION FACILITIES PER LANDSCAPING AND IRRIGATION PLANS.
- FIRE HYDRANT/WATER METER TO BE RELOCATED BY CITY FORCES AS NEEDED. (SEE CITY OF RIVERSIDE PUBLIC UTILITIES WATER IMPROVEMENT PLANS)
- TELEPHONE MANHOLE OR RISER TO BE RELOCATED OR ADJUSTED BY TELEPHONE COMPANY AS NEEDED.
- RELOCATE EXISTING TRAFFIC FACILITIES PER TRAFFIC PLANS.
- SAWCUT AND REMOVE INTERFERING PORTIONS OF EXISTING A/C PAVEMENT WHERE SHOWN ON PLAN.

GENERAL NOTES:

1. CONSTRUCTION SHALL BE IN ACCORDANCE WITH THE CITY OF RIVERSIDE STANDARD DRAWINGS AND STANDARD SPECIFICATIONS FOR PUBLIC WORKS CONSTRUCTION, 2006 EDITION.
2. ALL ELEVATIONS SHOWN IN THE PLAN VIEW SHALL BE STAKED IN THE FIELD, EXCEPT FOR ELEVATIONS SHOWN IN PARENTHESIS WHICH DENOTE EXISTING GRADES.
3. CUT AND FILL SLOPES SHALL BE 2:1 OR FLATTER UNLESS OTHERWISE SHOWN ON THE PLAN.
4. EXISTING UTILITIES SHOWN ON THE PLANS, ARE PLOTTED FROM UTILITY RECORDS THE CONTRACTOR IS REQUIRED TO TAKE DUE PRECAUTIONARY MEASURES TO LOCATE AND PROTECT ALL UTILITIES WHETHER OR NOT SHOWN ON THESE PLANS.
5. ALL EXISTING TREES WHICH INTERFERE WITH CONSTRUCTION ON THIS PLAN WILL BE REMOVED BY CITY FORCES PRIOR TO CONSTRUCTION.

RIVERSIDE



CALIFORNIA

PUBLIC WORKS DEPARTMENT
NINTH STREET IMPROVEMENTS
(FROM MARKET AVE TO ORANGE STREET)

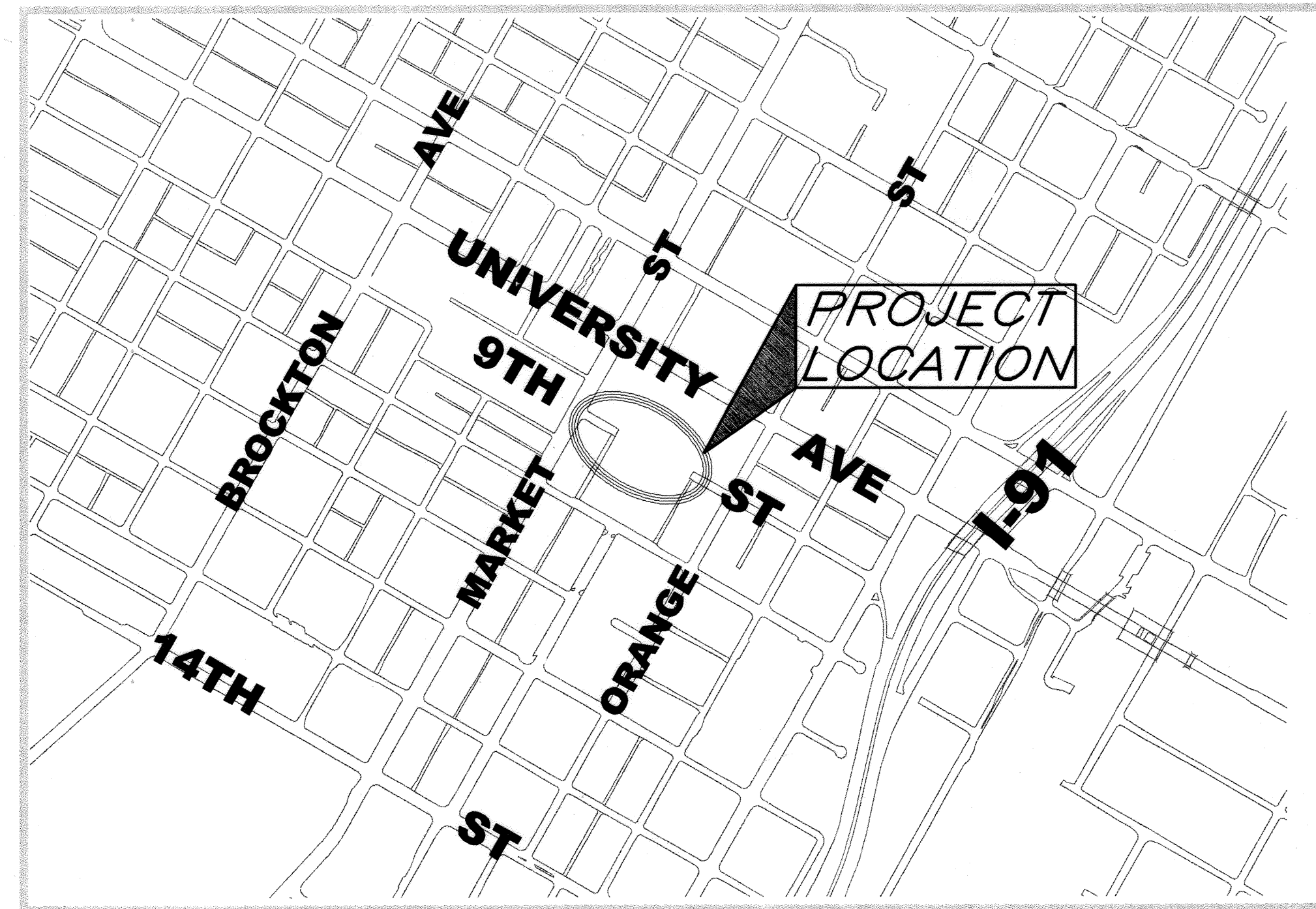

LOCATION/INDEX MAP
1"=600'

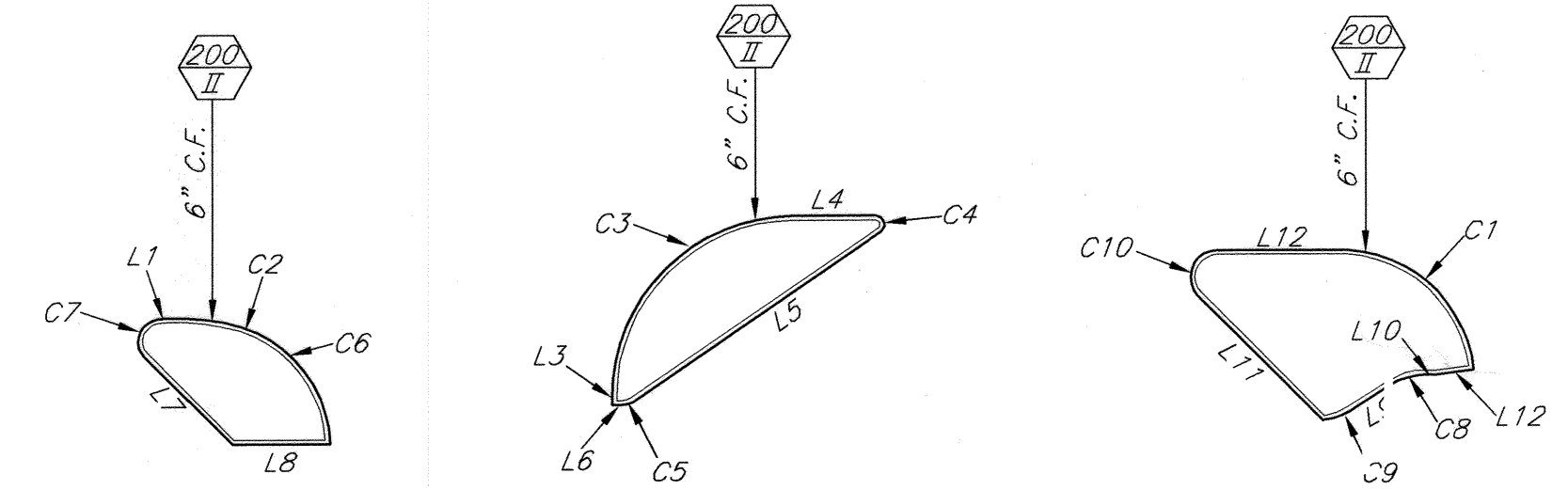

MEDIAN DETAIL "A" SCALE: HORIZ. 1"=20'
MEDIAN DETAIL "B" SCALE: HORIZ. 1"=20'
MEDIAN DETAIL "C" SCALE: HORIZ. 1"=20'

CURVE	LENGTH	RADIUS	TANGENT
C1	21.04	15.00	12.67
C2	8.33	23.00	4.21
C3	31.42	20.00	20.00
C4	2.54	1.00	3.23
C5	1.50	2.50	0.77
C6	17.37	14.00	10.01
C7	5.65	2.50	5.29
C8	4.03	7.00	2.07
C9	3.29	7.00	1.68
C10	7.06	3.00	7.23

LINE	LENGTH	BEARING
L1	1.00	N65°42'48"W
L2	4.31	N67°30'05"W
L3	1.00	S29°46'38"W
L4	9.16	N60°13'22"E
L5	33.15	N85°21'51"E
L6	0.96	S60°13'22"E
L7	13.73	N15°08'33"W
L8	10.80	S60°13'22"E
L9	5.18	N86°51'09"E
L10	1.18	N60°10'52"W
L11	19.55	S15°08'33"E
L12	14.39	N60°13'22"W

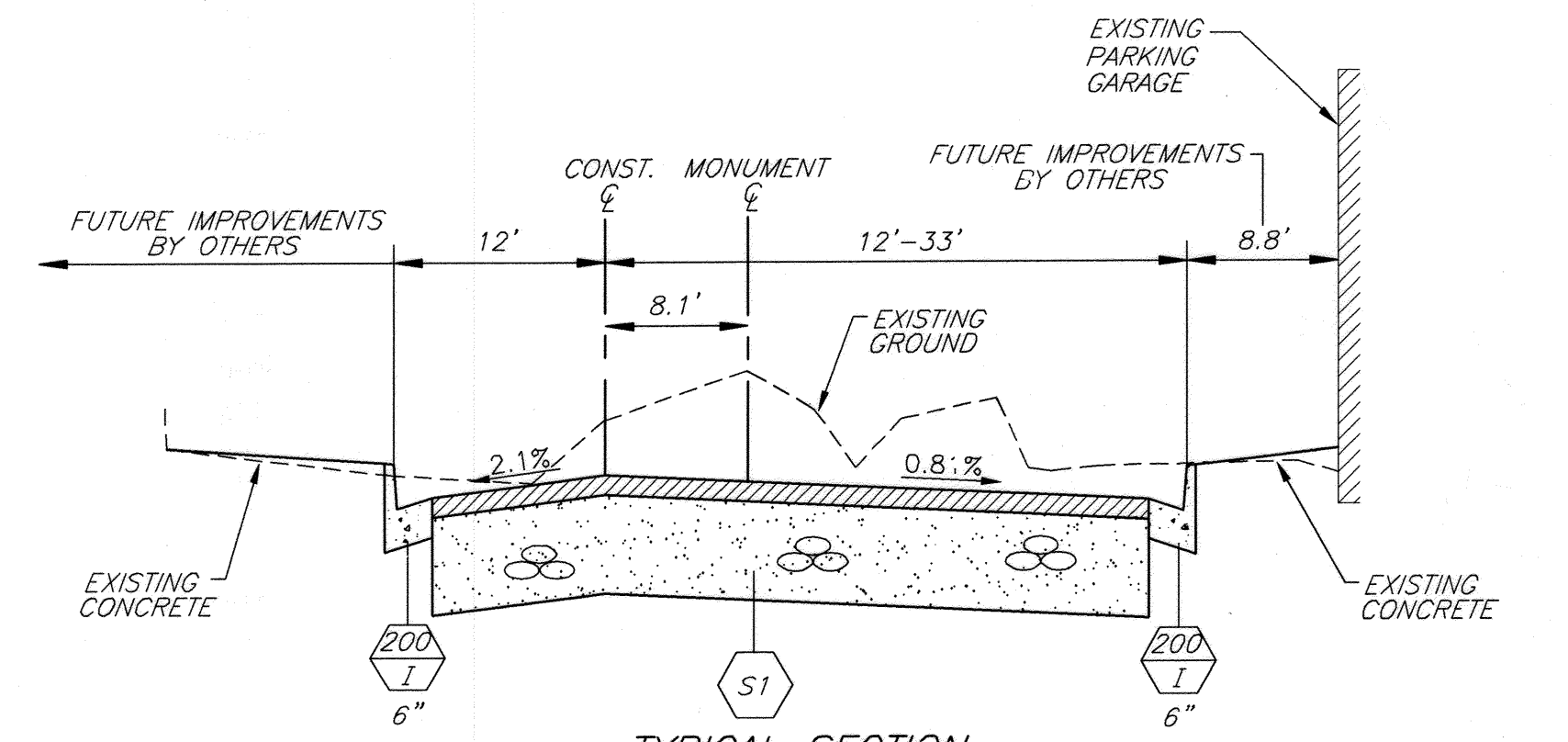

TYPICAL SECTION
STA. 14+61.85 - STA. 16+28.69
SCALE: HORIZ. 1"=10'
VERT. 1"=2'

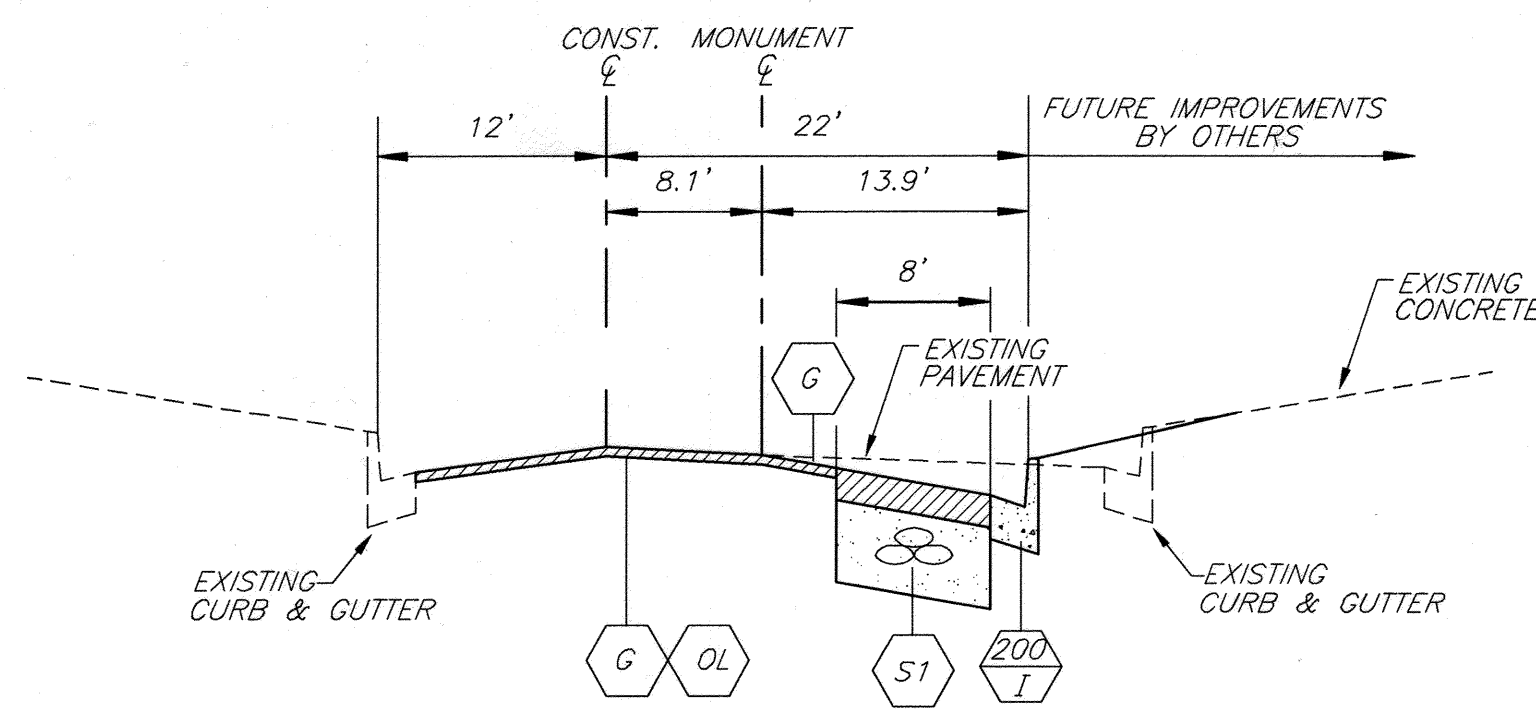

TYPICAL SECTION
STA. 10+38± - STA. 11+16.70
SCALE: HORIZ. 1"=10'
VERT. 1"=2'

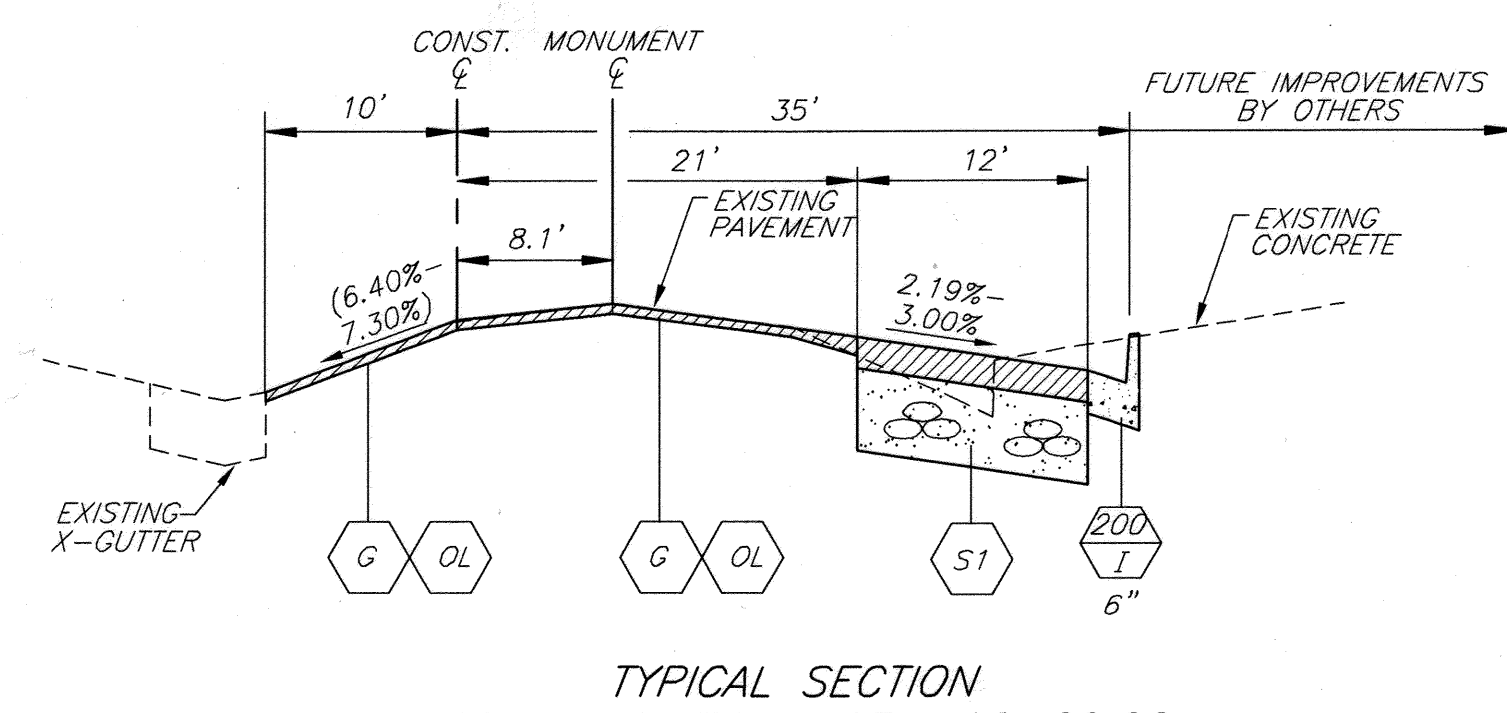

TYPICAL SECTION
STA. 11+16.70 - STA. 12+00.00
SCALE: HORIZ. 1"=10'
VERT. 1"=2'

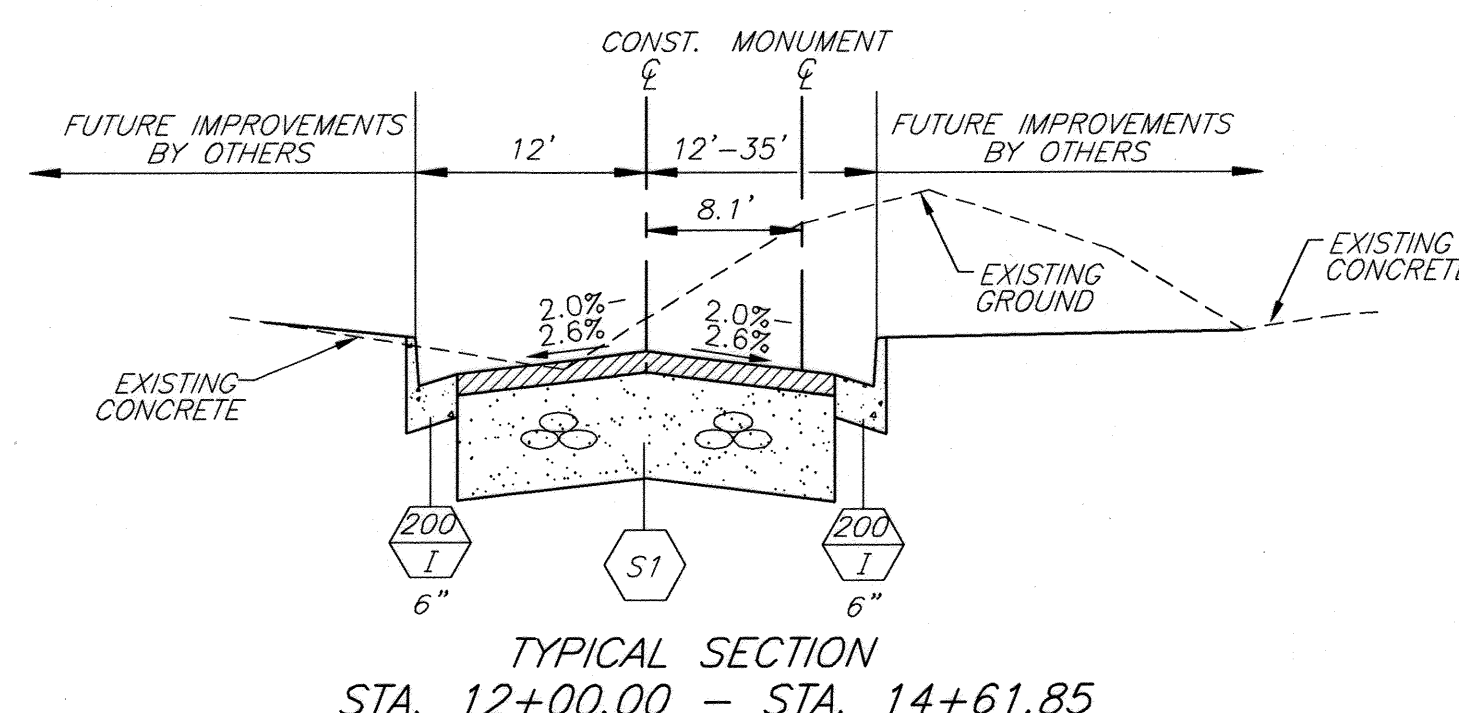

TYPICAL SECTION
STA. 12+00.00 - STA. 14+61.85
SCALE: HORIZ. 1"=10'
VERT. 1"=2'

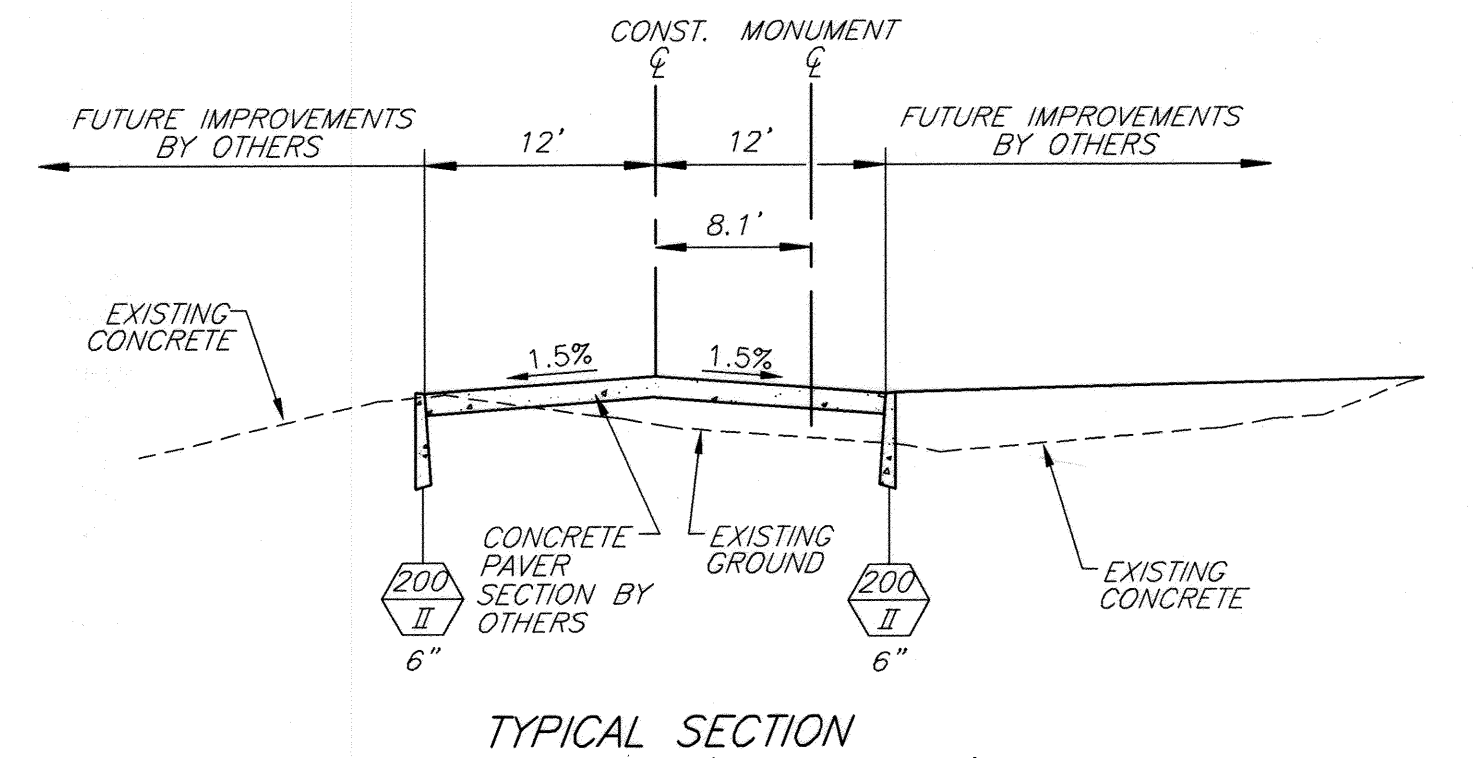

TYPICAL SECTION
STA. 14+36.11 (CROSSWALK)
SCALE: HORIZ. 1"=10'
VERT. 1"=2'

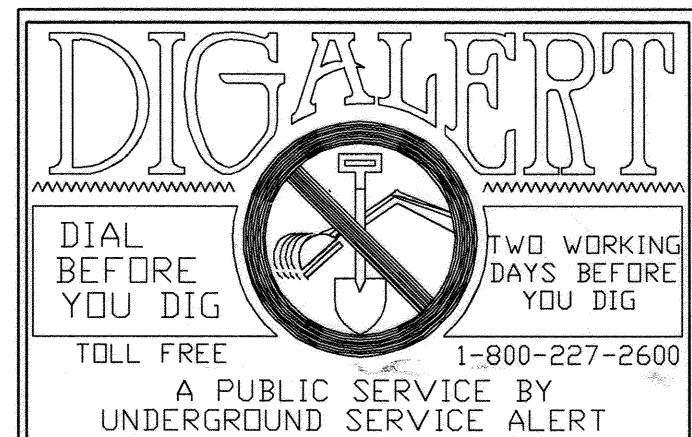

BENCHMARK NO.: 17-U3

ELEV.: 850.400
P.K. NAIL AND CITY ENGINEER TAG IN THE TOP OF A DROP INLET STRUCTURE AT THE SOUTHEASTERLY CORNER OF NINTH STREET AND ORANGE STREET.

ENGINEER IN RESPONSIBLE CHARGE
Philip Hannawi
PHILIP HANNAWI
R.C.E. No. 44747 expires 3/31/2008
DATE 6/4/07



MARK	REVISIONS	APPR.	DATE
CS	CS	PH	

CITY OF RIVERSIDE, CALIFORNIA
PUBLIC WORKS DEPARTMENT

APPROVED BY	BY	DATE	APPROVED BY
PRINCIPAL ENGINEER	<i>[Signature]</i>	6/14/07	CITY ENGINEER
CONSTRUCTION ADMIN.	<i>[Signature]</i>	6/14/07	
STREET SERVICES	<i>[Signature]</i>	6/14/07	
TRAFFIC ENGINEER	<i>[Signature]</i>	6/14/07	

9TH STREET
EXTENSION
BETWEEN ORANGE STREET
AND MARKET STREET

HORIZ. SCALE: 1" = 20' VERT. SCALE: N/A

AS-BUILT 7-20-18

ACCT. NO.: 9590427152-440223X

R-3952
SHEET 1 OF 2

FILE: \G:\COMMON\PROJECTS\COMPLETE

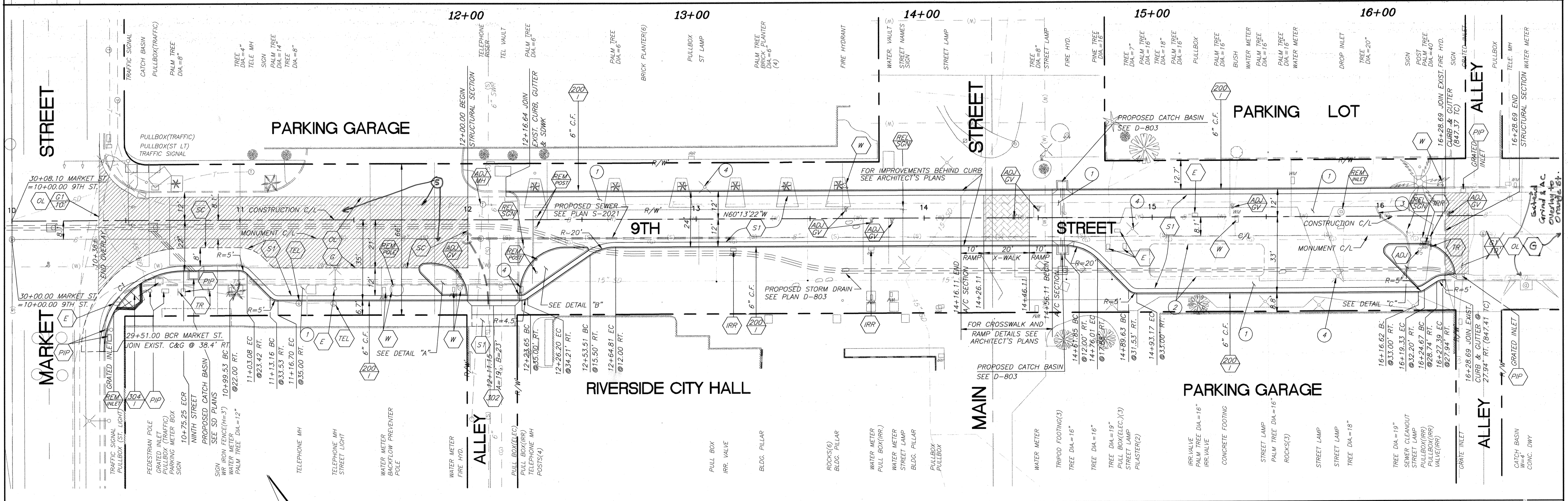
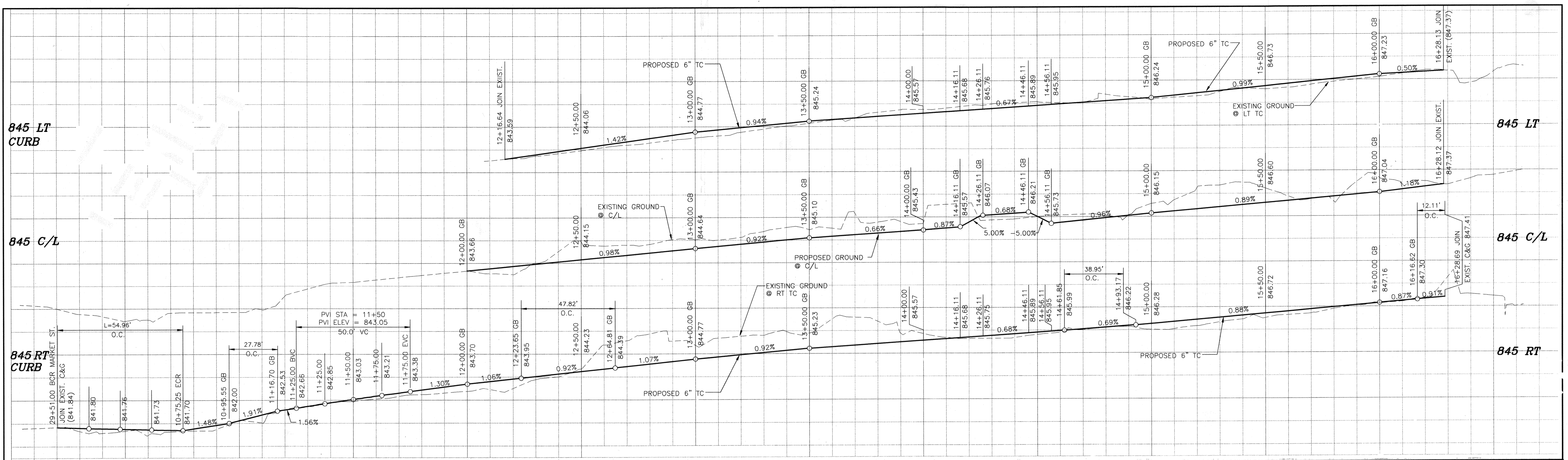

CURVE TABLE

CURVE	LENGTH	RADIUS	DELTA	TANGENT
C1	54.96	35.00	89°58'31"	34.98

BENCHMARK NO. : 17-U3

ELEV.: 850.400
 P.K. NAIL AND CITY ENGINEER TAG IN THE TOP OF A DROP INLET STRUCTURE AT THE SOUTHEASTERLY CORNER OF NINTH STREET AND ORANGE STREET.

ENGINEER IN RESPONSIBLE CHARGE
Philip Hannawi
 PHILIP HANNAWI
 R.C.E. No. 44747 expires 3/31/2008
 DATE: 6/14/07

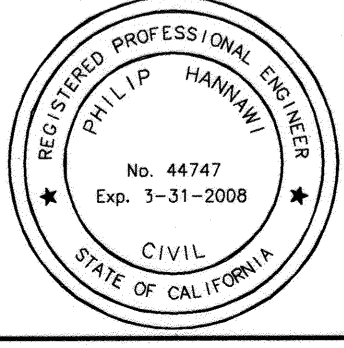

DESIGNED BY: CS DRAWN BY: CS CHECKED BY: PH

MARK	REVISIONS	APPR.	DATE

CITY OF RIVERSIDE, CALIFORNIA
 PUBLIC WORKS DEPARTMENT

APPROVED BY: [Signature]
 PRINCIPAL ENGINEER
 CONSTRUCTION ADMIN. [Signature]
 SURVEYOR [Signature]
 STREET SERVICES [Signature]
 TRAFFIC ENGINEER [Signature]

DATE: 2/19/07

9TH STREET EXTENSION
 BETWEEN ORANGE STREET AND MARKET STREET

HORIZ. SCALE: 1" = 20'
 VERT. SCALE: N/A

ACCT. NO.: 9590427152-440223XX
 R-3952
 SHEET 2 OF 2
 FILE: \\COMMON\PROJECTS\COMPLETE