

FOR IMPROVEMENTS FROM STA. 17+50.00 TO STA. 21+53.28 SEE SHEET 6

HORIZ. SCALE: 1" = 20'  
 VERT. SCALE: 1" = 4'

NOTE: PRUNING ANY PART OF THIS HISTORIC TREE CAN ONLY BE DONE BY ROBERT FILAR (951)-826-6112.

DETAIL ONLY APPLIES AT 1804 ENTERPRISE AVE

LINE	LENGTH	BEARING
L1	3.50	N70°12'05"W
L2	2.00	N00°52'31"E
L3	2.00	N00°52'31"E
L4	7.14	S57°03'17"W
L5	66.70	S87°12'43"W

- NOTE:
- PRIOR TO ANY WORK IN THE VICINITY OF THE CAMPHOR TREE, CONSULT THE CITY'S URBAN FORESTER AT 951-826-6112.
  - ANY EXCAVATION ON THE S'LY SIDE OF THE ROAD BETWEEN STA. 16+00 AND STA. 17+00 SHALL BE DONE BY HAND.
  - IF THE EXIST. TREE ROOTS ARE IN CONFLICT WITH THE PROPOSED DRIVEWAY, C&G, ELIMINATE CONCRETE AND CONSTRUCT AC DWY AND AC BERM INSTEAD.

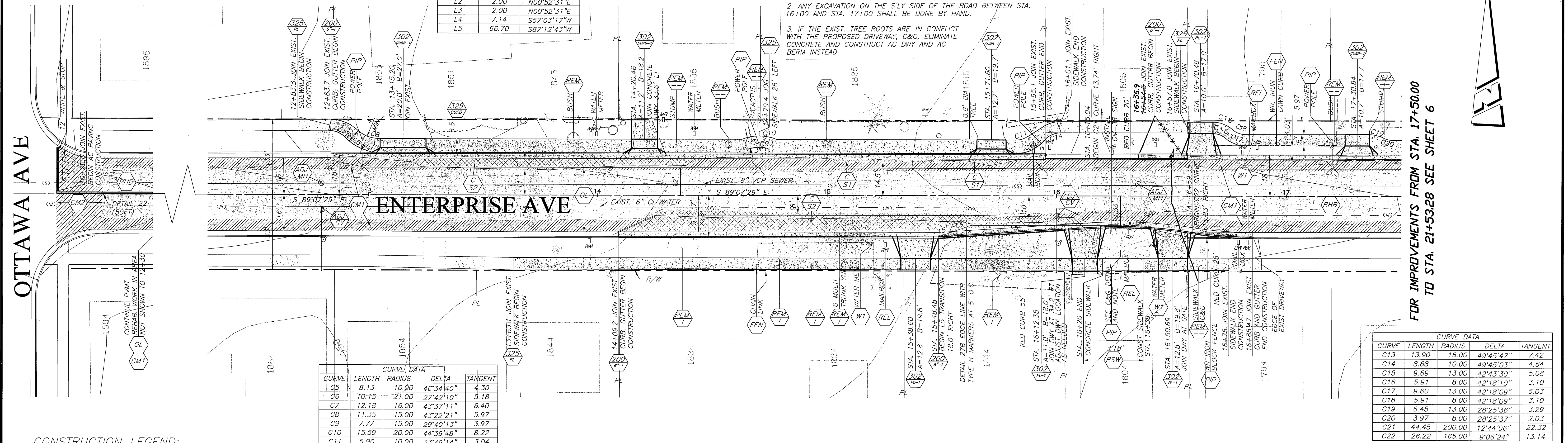

FOR IMPROVEMENTS FROM STA. 17+50.00 TO STA. 21+53.28 SEE SHEET 6

CURVE	LENGTH	RADIUS	DELTA	TANGENT
C5	8.13	10.00	46°34'40"	4.30
C6	10.15	21.00	27°42'10"	5.18
C7	12.18	16.00	43°37'11"	6.40
C8	11.35	15.00	43°22'21"	5.97
C9	7.77	15.00	29°40'13"	3.97
C10	15.59	20.00	44°39'48"	8.22
C11	5.90	10.00	33°49'14"	3.04
C12	6.86	15.00	26°12'01"	3.49

CURVE	LENGTH	RADIUS	DELTA	TANGENT
C13	13.90	16.00	49°45'47"	7.42
C14	8.68	10.00	49°45'03"	4.64
C15	9.69	13.00	42°43'30"	5.08
C16	5.91	8.00	42°18'10"	3.10
C17	9.60	13.00	42°18'09"	5.03
C18	5.91	8.00	42°18'09"	3.10
C19	6.45	13.00	28°25'36"	3.29
C20	3.97	8.00	28°25'37"	2.03
C21	44.45	200.00	12°44'06"	22.32
C22	26.22	165.00	9°06'24"	13.14

**CONSTRUCTION LEGEND:**

- NEW STRUCTURAL SECTION (DESCRIPTION PER PLAN)
- COLD MILL & CONSTRUCT AC OVERLAY (DESCRIPTION PER PLAN)
- CONSTRUCT PCC CONCRETE (DESCRIPTION PER PLAN)
- CONSTRUCT AC OVERLAY (DESCRIPTION PER PLAN)

**BENCHMARK: H7-Q3**  
 PK nail and City Engineer tog in Northeast corner of a catch basin along the northerly curb of Martin Luther King Blvd at the northeast corner of Ottawa Ave and Martin Luther King Blvd.  
 ELEVATION: 955.980

**ENGINEER IN RESPONSIBLE CHARGE**  
 Michael Katusian  
 MICHAEL KATUSIAN  
 R.C.E. No. 36886 expires 6/30/08  
 DATE 11/17/06

APPROVED BY: *[Signature]* DATE: 11/17/06  
 PRINCIPAL ENGINEER  
 CONSTRUCTION ADMIN. DATE: 11/17/06  
 SURVEYOR DATE: 11/17/06  
 STREET SERVICES DATE: 11/17/06  
 TRAFFIC ENGINEER DATE: 11/17/06

CITY OF RIVERSIDE, CALIFORNIA  
 PUBLIC WORKS DEPARTMENT

APPROVED BY: *[Signature]*  
 CITY ENGINEER  
 DATE: 11/16/06

**ENTERPRISE AVENUE IMPROVEMENTS**  
 STA. 12+83.30 TO STA. 17+50.00  
 SHEET 5 OF 7

ACT. NO. 9587430214  
 W.O. NO. 0603682  
**R-3961**  
 FILE NO.