

N.T.S.

Location Map AREA-1

Polk St

* AC DEPTH FOR REMOVAL AND REPLACEMENT AREAS SHALL BE A MIN. OF 0.5' OR MATCH EXISTING STRUCTURAL SECTION WHICHEVER IS GREATER.

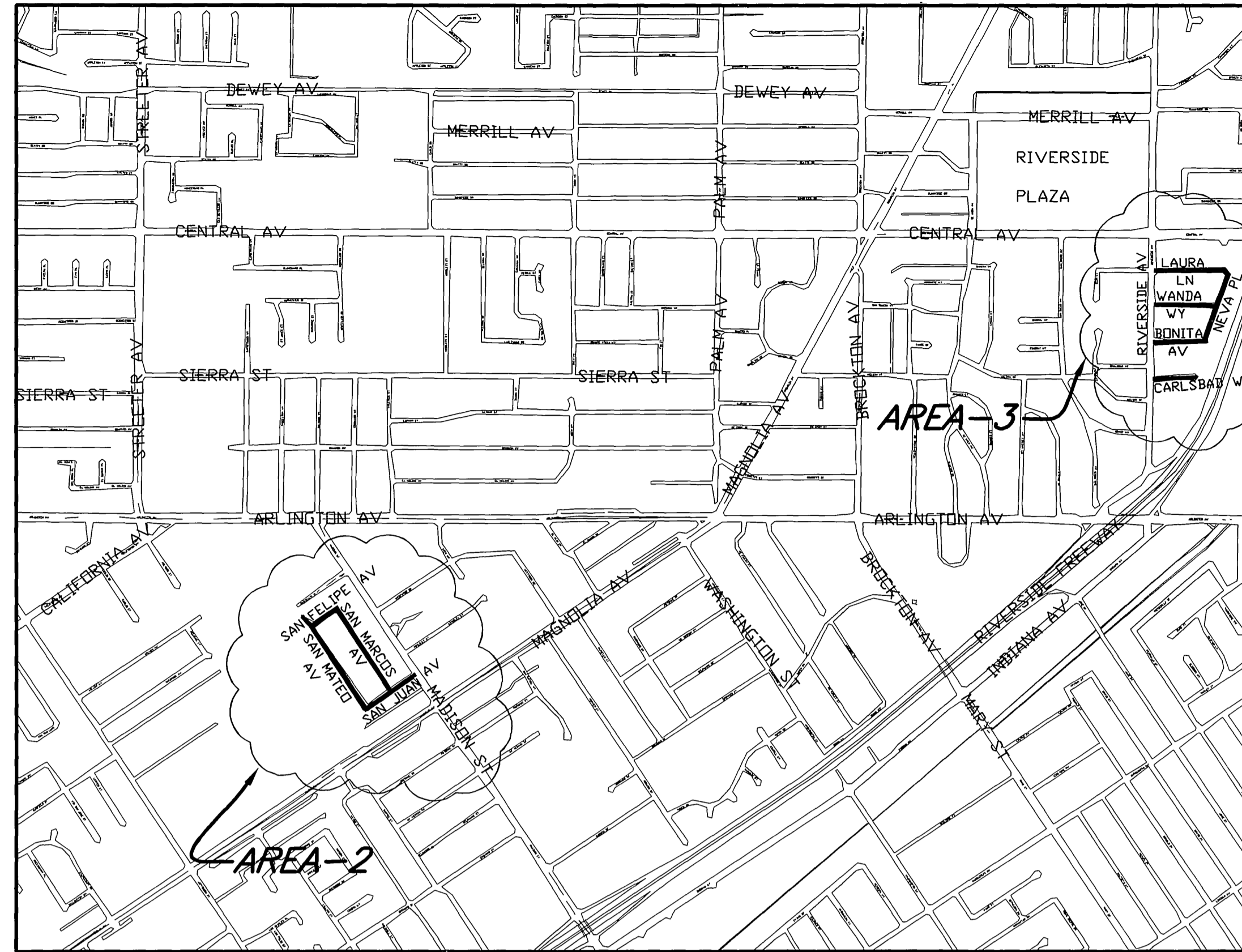

N.T.S.

QUANTITIES TABLE

#	STREET NAME	STREET LIMIT	STREET LIMIT	STREET LENGTH (LF)	0.1' ARHM-GG OVERLAY (TON)	AC REMOVA (SF)	AC REPLACE (TON)	COLD MILLING TYPE I-W=5' LF	COLD MILLING TYPE II-W=10' LF	R&R CURB & GUTTER (LF)	R&R SIDEWALK (SF)	R&R WCR (EA)	R&R DWY APPR (SF)	R&R X-GUTTER (SF)	ADJUST. SEWER & SD MH (EA)	ADJUST WATER GATE VALVE (EA)	REPLACE TRAFFIC LOOPS (EA)
1	San Marcos Av	San Felipe Av	San Juan Av	885	250	-	-	1,950	-	-	135	-	-	-	2	2	-
2	San Mateo Av	San Felipe Av	San Juan Av	1,050	295	-	-	2,310	35	25	100	3	-	-	3	5	-
3	San Felipe Av	San Mateo Av	San Marcos Av	265	75	-	-	575	-	-	35	-	-	-	-	-	-
4	San Juan Av	San Mateo Av	Madison St	545	155	-	-	1,195	40	-	-	3	-	-	1	3	-
5	Laura Ln	Riverside Av	Neva Pl	690	290	1,000	45	155	40	120	-	2	-	-	2	6	-
6	Wanda Wy	Riverside Av	Neva Pl	580	165	-	-	1,275	30	65	-	-	-	-	2	1	-
7	Bonita Av	Riverside Av	Neva Pl	470	135	-	-	1,035	40	85	570	-	-	-	2	-	-
8	Carlsbad Wy	Riverside Av	East end	405	115	-	-	890	40	55	200	3	100	120	2	-	-
9	Neva Pl	Bonita Av	Laura Ln	695	195	-	-	1,530	-	60	-	-	-	-	2	2	-
10	Polk St	Magnolia Av	Hole Av	4,220	2,950	5,000	190	-	200	325	2,305	6	500	200	23	18	9
11	Via Junipero Serra	Via Concepcion	Via Mindi	875	245	200	10	1,925	-	55	415	-	-	-	3	2	-
12	Via Terrano	Via Concepcion	EOS	490	140	-	-	1,080	-	-	260	-	-	-	1	3	-
13	Via Cerezo	Via Concepcion	EOS	370	105	-	-	810	-	-	320	-	-	-	3	3	-
14	Via Callisto	Via Conpcion	EOS	485	135	-	-	1,065	-	70	690	3	-	-	2	1	-
15	Via Mindi	Via Junipero Serra	Via Callisto	890	250	-	-	1,960	-	70	1,405	3	-	-	3	4	-
16	Via Concepcion	Canyon Crest Dr	Via Cervantes	1,935	545	560	25	4,295	40	100	2,690	15	405	-	8	14	-
17	Via Orizaba	Via Callisto	EOS	430	120	-	-	945	-	-	475	-	-	-	1	4	-
18	Via Cervantes	Via Concepcion	EOS	155	175	-	-	1,400	-	45	1,230	-	-	-	1	-	-
19	Via Las Nubes	Via Mindi	132-ft 5'y	140	40	-	-	290	-	-	445	-	-	-	1	1	-
TOTAL				15,575													

CONSTRUCTION NOTES:

- FOR WHEELCHAIR RAMPS AT LOCATIONS WHERE SIDEWALK IS LESS THAN 5 FEET WIDE, CONTRACTOR SHALL INSTALL THE SPECIFIED CITY STANDARD WHEELCHAIR RAMP AND TRANSITION THE ASSOCIATED SIDEWALK TO MATCH EXISTING
- FOR AREAS MARKED FOR FULL ROAD-WIDTH GRINDING (LAURA LN. & POLK ST.), PAVEMENT SHALL BE INSPECTED FOR STRUCTURAL FAILURES AFTER GRINDING. FAILED AREAS SHALL BE REMOVED AND REPLACED PRIOR TO OVERLAYING THE ENTIRE AREA WITH 0.15" THICK ARHM-GG.
- TYPE I COLD MILLING = 5'-10' WIDE AND 0.10' DEEP
- TYPE II COLD MILLING (POLK ST & LAURA LANE) / SF AND 0.10'-0.20' DEEP
- LOCATIONS FOR DIGOUTS AND FULL ROAD-WIDTH GRINDING SHALL BE MARKED ON SITE.

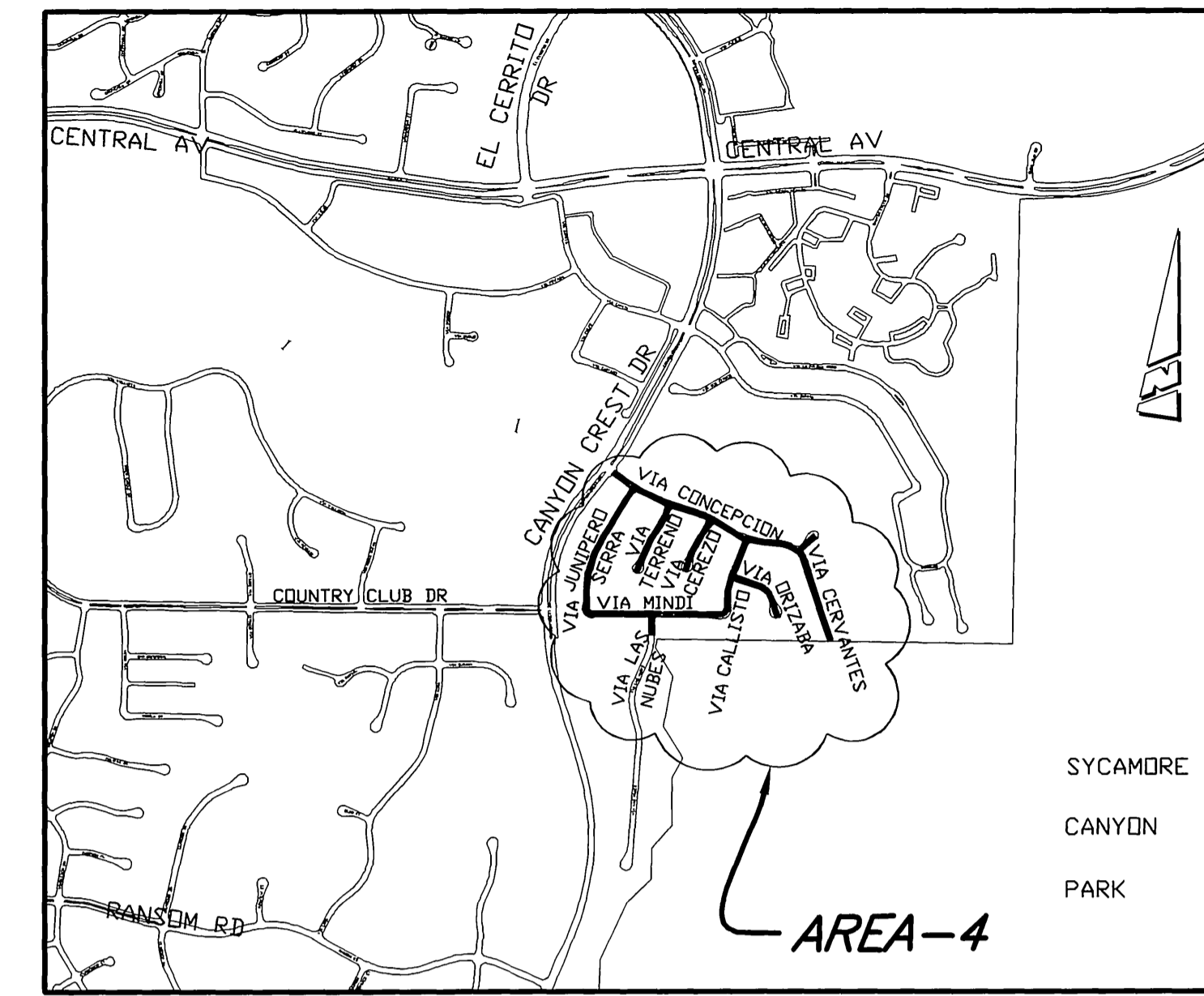

N.T.S.

Location Map AREA-2

San Marcos Av
San Mateo Av
San Felipe Av
San Juan Av

* AC DEPTH FOR REMOVAL AND REPLACEMENT AREAS SHALL BE 0.33' OR MATCH EXISTING STRUCTURAL SECTION.

Location Map AREA-3

Laura Ln
Wanda Wy
Bonita Av
Neva Pl
Carlsbad Wy

* AC DEPTH FOR REMOVAL AND REPLACEMENT AREAS SHALL BE 0.33' OR MATCH EXISTING STRUCTURAL SECTION.

Location Map AREA-4

Via Junipero Serra
Via Terrano
Via Cerezo
Via Callisto
Via Mindi
Via Orizaba
Via Concepcion
Via Cervantes

* AC DEPTH FOR REMOVAL AND REPLACEMENT AREAS SHALL BE A MIN. OF 0.5' OR MATCH EXISTING STRUCTURAL SECTION WHICHEVER IS GREATER.

GENERAL NOTES:

- PRIME CONTRACTOR BIDDING THIS PROJECT SHALL HAVE A CLASS "A" OR CLASS "C-12" LICENSE.
- CONSTRUCTION SHALL BE IN ACCORDANCE WITH THE CITY OF RIVERSIDE DEPARTMENT OF PUBLIC WORKS, STANDARD DRAWINGS, ITS SUPPLEMENTAL NOTES AND THE "STANDARD SPECIFICATIONS FOR PUBLIC WORKS CONSTRUCTION", 2006 EDITION.
- THE CONTRACTOR IS REQUIRED TO TAKE DUE PRECAUTIONARY MEASURES TO LOCATE AND PROTECT ALL UTILITIES WITHIN THE CONSTRUCTION WORK AREAS. MH'S & WATER VALVES SHALL BE "TIED OUT" PRIOR TO PAVEMENT OVERLAY WORK FOR SUBSEQUENT ADJUSTMENT WORK.
- ANY TEMPORARY TRAFFIC CONTROL STRIPING OBLITERATED AND/OR BADLY WORN DURING CONSTRUCTION SHALL BE RESTORED BY THE CONTRACTOR WITHIN ONE DAY AFTER NOTIFICATION FROM THE CITY INSPECTOR.
- IN PAVEMENT OVERLAY AREAS, ANY DISTRESSED EXISTING PAVEMENT SHALL BE REMOVED AND REPLACED AS DIRECTED BY THE INSPECTOR PRIOR TO OVERLAYING WITH ARHM-GG PAVING.
- WHERE NEW PAVEMENT IS TO JOIN THE EXISTING PAVEMENT, THE EDGE OF THE EXISTING PAVEMENT SHALL BE TRIMMED IN A SMOOTH AND STRAIGHT LINE. CONSTRUCT MATCH-UP PAVING AS DIRECTED IN THE FIELD TO PRODUCE A SMOOTH SECTION.
- STREET IMPROVEMENT WORK THAT WILL CAUSE DAMAGE TO THE DETECTOR LOOP'S SHALL NOT BE PERFORMED UNTIL TRAFFIC SIGNAL MAINTENANCE PERSONNEL HAVE BEEN NOTIFIED AND THE NECESSARY TIMING ADJUSTMENTS ARE MADE TO MAINTAIN SIGNAL OPERATION.
- THE CONTRACTOR IS RESPONSIBLE FOR THE FINAL STRIPING AND PAVEMENT MARKING.
- SURVEY STAKING REQUESTS AND GRADE SHEETS ARE REQUIRED FOR THE REPLACEMENT OF ALL CURBS AND/OR GUTTER OVER 50' IN LENGTH. SURVEY REQUESTS SHALL BE SUBMITTED AFTER THE EXISTING IMPROVEMENTS HAVE BEEN REMOVED. CONTRACTOR SHALL ALLOW 4 WORKING DAYS AFTER REQUESTING SURVEY TO SCHEDULE SURVEY AND PROCESS GRADE SHEETS.
- MANHOLES AND VALVE COVERS WITHIN THE COLD MILLING OR PAVEMENT REPLACEMENT LIMITS SHALL NOT BE ADJUSTED TO GRADE. INSTEAD, COLD MILLING OR PAVEMENT REMOVAL BY OTHER MEANS SHALL BE DONE TO PROVIDE A SMOOTH FINISHED SURFACE TRANSITION AROUND THE COMPLETE CIRCUMFERENCE OF THE STRUCTURE. EXCEPTIONS TO THIS ARE WHERE MH AND VALVE COVERS ARE WITHIN PAVEMENT REMOVAL AREAS BUT ARE TOO CLOSE (WITHIN 3') TO THE ADJACENT PROPOSED A.C. OVERLAY. CONTRACTOR MAY DO DOUBLE ADJUSTMENT TO MANHOLES AND VALVES WITHIN COLD MILL AREAS.
- THE INSPECTOR MAY DIRECT COLD MILLING AND PAVING INTO SIDE STREETS TO IMPROVE THE RIDE QUALITY AND OTHER STREET CONDITIONS.
- WATER VALVES AND FIRE HYDRANTS MUST BE LOCATED DURING CONSTRUCTION TO MAKE VALVE BOX AND COVER ADJUSTMENTS AND FIRE HYDRANT BLUE MARKER INSTALLATIONS. THE VALVE BOXES MUST BE "TIED OUT" AS PART OF THE CONTRACTOR'S WORK.
- PAVEMENT PREPARATION SHALL CONSIST OF REMOVAL AND REPLACEMENT (R&R) OF DETERIORATED PAVEMENT AREAS AS MARKED IN THE FIELD AND DIRECTED BY THE INSPECTOR AT THE TIME OF CONSTRUCTION. QUANTITIES SHOWN ARE BASED UPON ALL PREMARKED R&R SECTIONS BEING A MINIMUM OF 0.5' IN DEPTH FOR CITY STREETS.
- THE SEAM BETWEEN PASSES OF THE AC OVERLAY SHALL COINCIDE, AS CLOSE AS POSSIBLE, TO THE LANE LINES.
- COLD MILLING TYPE I AND TYPE II SHALL BE AS DIRECTED BY THE INSPECTOR AND AS DESCRIBED IN SPECIAL PROVISIONS.
- APPROXIMATELY 40 NEW WHEELCHAIR RAMPS SHALL BE CONSTRUCTED WITHIN THE PROJECT AREA. EACH RAMP REQUIRES THE REMOVAL AND REPLACEMENT OF APPROXIMATELY 200 SF OF RAMP AREA, 100 SF OF SIDEWALK, 35 LF OF CURB AND GUTTER, 30 LF OF NEW RETAINING CURB AND 200 SF OF ASPHALT CONCRETE PAVEMENT. THESE QUANTITIES ARE APPROXIMATE AND MAY CHANGE ACCORDING TO EACH RAMP SITE CONDITION. RAMPS SHALL BE CONSTRUCTED PER CITY STANDARDS, ADA REQUIREMENTS AND AS DIRECTED BY THE ENGINEER. AREAS FOR REMOVAL SHALL BE MARKED BY BOTH THE CITY'S AND THE CONTRACTOR'S REPRESENTATIVES AT THE TIME OF CONSTRUCTION. SEE ATTACHED LIST FOR RAMP LOCATION AND TYPE.

Underground Service Alert
CALL BEFORE YOU DIG
CALL:TOLL FREE
1-800
227-2600
TWO WORKING DAYS BEFORE YOU DIG

ENGINEER IN RESPONSIBLE CHARGE
Ibrahim A. Massoud
IBRAHIM A. MASSOUD
R.C.E. No. 64224 expires 6/30/09
DATE 8-23-07

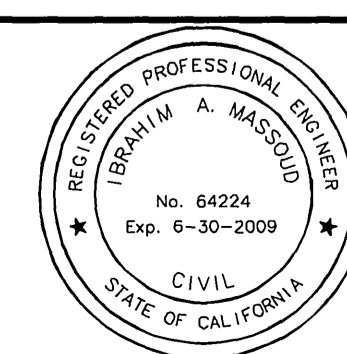

MARK	REVISIONS	APPR.	DATE

DESIGNED BY: JUF DRAWN BY: JUF CHECKED BY: ABE

CITY OF RIVERSIDE, CALIFORNIA
PUBLIC WORKS DEPARTMENT

APPROVED BY: [Signature]
DATE: 8/21/07

APPROVED BY: [Signature]
DATE: 8/21/07

MISCELLANEOUS STREET REHABILITATION AT VARIOUS LOCATIONS 2007-2008

ACCT. NO. 9596130214 - 440302
WORK ORDER: 0801952
R-4033
SHEET 1 OF 1
FILE NO.