

SEC 30 OF T.3S, R.4W
VICINITY MAP
N.T.S.

LEGEND:

- STREET TREES
- REMOVE AND REPLACE EXIST. AC PAVEMENT
- SAWCUT 2" AC PAVEMENT COLD PLANE @ 0.5" MIN. THICKNESS (SEE JOINT DETAIL HEREON)

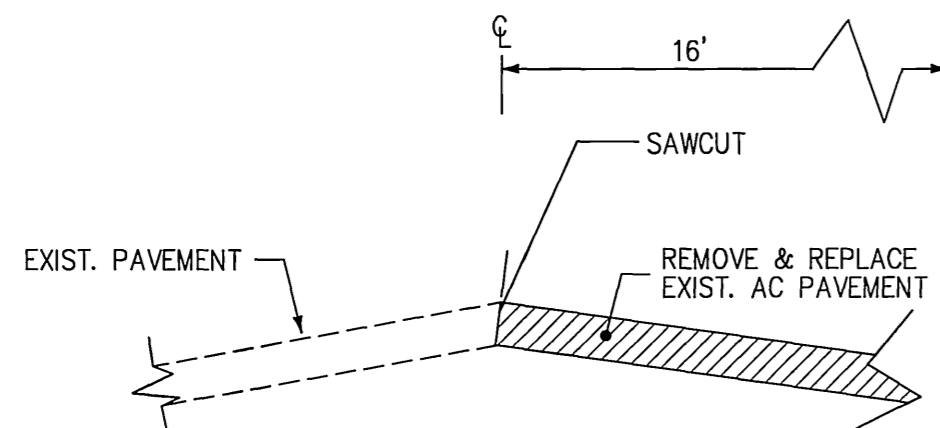

JOINT DETAIL
N.T.S.

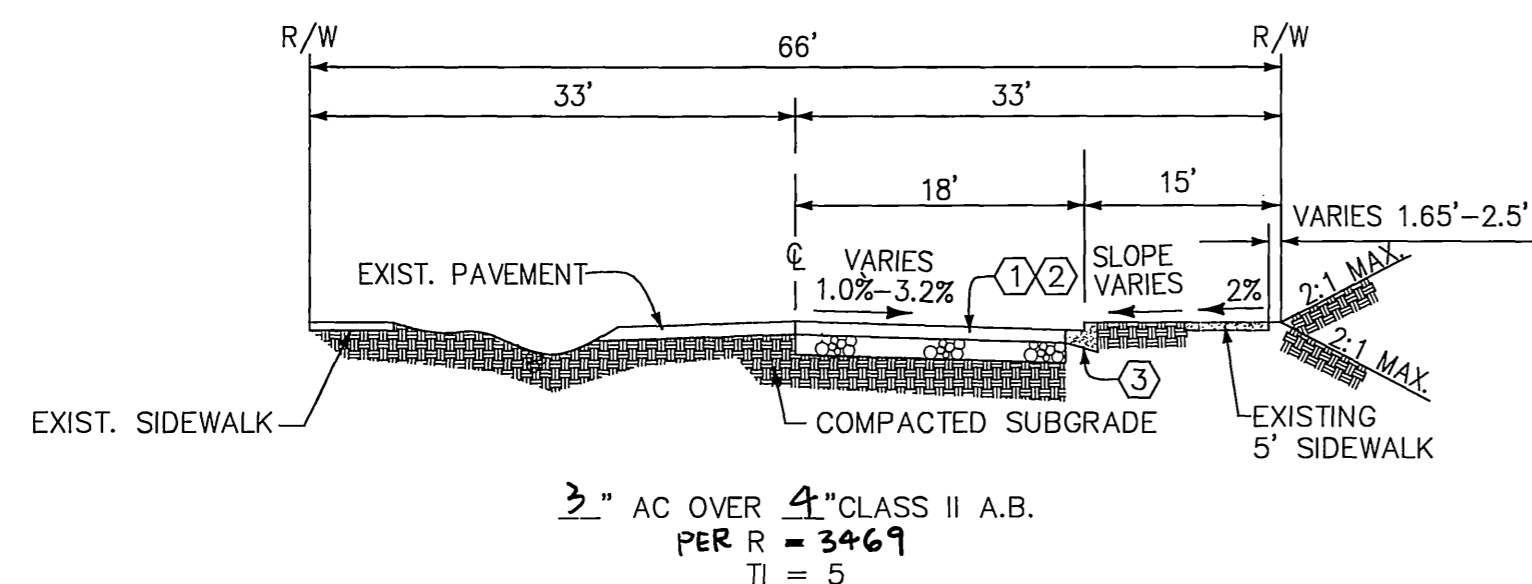

13TH STREET
STA. 1+98.00 TO STA. 3+62.52
N.T.S.

TYPICAL STREET SECTION

STREET IMPROVEMENT PLANS
13TH STREET
1+98.00 S' WLY SIDE ALMOND ST. TO 3+62.52 S'E'LY
CITY OF RIVERSIDE, CALIFORNIA

GENERAL NOTES

1. NO PERSON SHALL PERFORM ANY CONSTRUCTION ACTIVITY OR INSTALL ANY OBJECTS WITHIN THE PUBLIC RIGHT-OF-WAY OR EASEMENTS OF THE CITY OF RIVERSIDE WITHOUT A VALID CONSTRUCTION PERMIT OR A STREET OPENING PERMIT OR AN ENCROACHMENT PERMIT ISSUED BY THE CITY'S PUBLIC WORKS DEPARTMENT.
2. IT SHALL BE THE RESPONSIBILITY OF THE CONTRACTOR TO CLEAR THE RIGHT-OF-WAY IN ACCORDANCE WITH THE PROVISIONS OF LAW AS IT AFFECTS EACH UTILITY INCLUDING IRRIGATION LINES AND APPURTENANCES AND AT NO COST TO THE CITY.
3. CONSTRUCTION SHALL BE IN ACCORDANCE WITH THE CITY OF RIVERSIDE DEPARTMENT OF PUBLIC WORKS, STANDARD DRAWINGS, ITS SUPPLEMENTAL NOTES AND THE STANDARD SPECIFICATIONS FOR PUBLIC WORKS CONSTRUCTION, CURRENT EDITION.
4. THE PRIVATE ENGINEER SIGNING THESE PLANS IS RESPONSIBLE FOR ASSURING THE ACCURACY AND ACCEPTABILITY OF THE WORK HEREON. IN THE EVENT OF DISCREPANCIES ARISING DURING CONSTRUCTION, THE PRIVATE ENGINEER SHALL BE RESPONSIBLE FOR DETERMINING AN ACCEPTABLE SOLUTION AND REVISING THE PLANS FOR APPROVAL BY THE CITY.
5. THE DEVELOPER SHALL BE RESPONSIBLE FOR PRESERVING OR REESTABLISHING AND REFERENCING SURVEY MONUMENT DESTROYED, DISTURBED OR BURIED AS A RESULT OF CONSTRUCTION SHOWN HEREON.
6. ALL FLAGGED ELEVATIONS SHALL BE STAKED IN THE FIELD BY THE PRIVATE ENGINEER.
7. WHERE NEW PAVEMENT IS TO JOIN THE EXISTING PAVEMENT, THE EDGE OF THE EXISTING PAVEMENT SHALL BE TRIMMED IN A SMOOTH AND STRAIGHT LINE. CONSTRUCT MATCH-UP PAVING AS SHOWN ON THE PLANS AND OVERLAY PAVING AS DIRECTED IN THE FIELD TO PRODUCE A SMOOTH SECTION.
8. THE SUBDIVIDER SHALL ARRANGE FOR A SOIL TEST TO BE MADE BY A SOILS ENGINEER AFTER THE STREET HAVE BEEN PREPARED TO ROUGH GRADE AND PRIOR TO CURB AND GUTTER CONSTRUCTION. DEPTH OF BASE MATERIAL AND A.C. PAVING SHALL BE DETERMINED BY THE CITY OF RIVERSIDE DESIGN STANDARDS AND TEST PROCEDURES.
9. ON ALL AREAS WITHIN PUBLIC RIGHT-OF-WAY WHERE THE FILL IS ONE (1) FOOT OR GREATER, A LETTER WILL BE REQUIRED FROM THE SOILS ENGINEER, CERTIFYING THE COMPACTION OF THE FILL BELOW SUBGRADE, PRIOR TO ISSUANCE OF THE CONSTRUCTION PERMIT/CUT SHEETS.
10. ALL TRAFFIC SIGNS SHALL BE INSTALLED PRIOR TO OPENING THE STREETS TO TRAFFIC.
11. ANY TRAFFIC CONTROL STRIPING OBLITERATED AND/OR BADLY WORN DURING CONSTRUCTION SHALL BE RESTORED BY THE CONTRACTOR WITHIN FIVE DAYS AFTER NOTIFICATION FROM THE CITY INSPECTORS.
12. FINAL STRIPING FOR TRAFFIC CONTROL AND/OR PAVEMENT MARKING TO BE THE RESPONSIBILITY OF THE CONTRACTOR.
13. THE CONTRACTOR SHALL CALL IN A LOCATION REQUEST TO UNDERGROUND SERVICE ALERT (USA), PHONE # 1-800-227-2600, TWO WORKING DAYS BEFORE DIGGING. NO CONSTRUCTION PERMIT WILL BE ISSUED BY THE PUBLIC WORKS DEPARTMENT INVOLVING EXCAVATION FOR UNDERGROUND FACILITIES UNLESS THE APPLICANT HAS BEEN PROVIDED AN INQUIRY IDENTIFICATION NUMBER BY U.S.A.
14. THE CONTRACTOR SHALL COORDINATE TRENCHING FOR CABLE TELEVISION WITH OTHER TRENCHING WITHIN THE SUBDIVISION.
15. CONSTRUCT DRIVEWAY APPROACHES PER STANDARD DWG. 302. EXACT SIZE AND LOCATION TO BE STAKED BY THE PRIVATE ENGINEER PRIOR TO CONSTRUCTION OF THE CURB AND GUTTER.
16. BEFORE THE RIPRAP AT THE OUTLET OF ANY DRAINAGE STRUCTURE IS ACCEPTED BY THE CITY, IT SHALL BE TESTED UNDER FLOWS AS CLOSE AS POSSIBLE TO DESIGN CONDITIONS WITH WATER OBTAINED FROM THE FIRE HYDRANTS IN THE IMMEDIATE AREA.

NOTE:

1. APPROXIMATE TREE LOCATION. NO STREET TREES SHALL BE PLANTED WITHIN 10 FEET OF DRIVEWAYS OR CORNER CUTBACKS.
2. QUANTITIES SHOWN HEREON ARE FOR PERMIT AND / OR BONDING PURPOSES ONLY AND SHALL NOT BE USED FOR BIDDING. CONTRACTOR SHALL DETERMINE HIS OWN QUANTITIES AND BID TO COMPLETE THE PROJECT.
3. SEE CITY OF RIVERSIDE UTILITY APPROVED DRAWING FOR QUANTITY AND LOCATIONS OF REQUIRED STREET LIGHTS, AND UNDERGROUND ELECTRIC FACILITIES. CONTACT BILL MAINORD @ 951-826-5393.

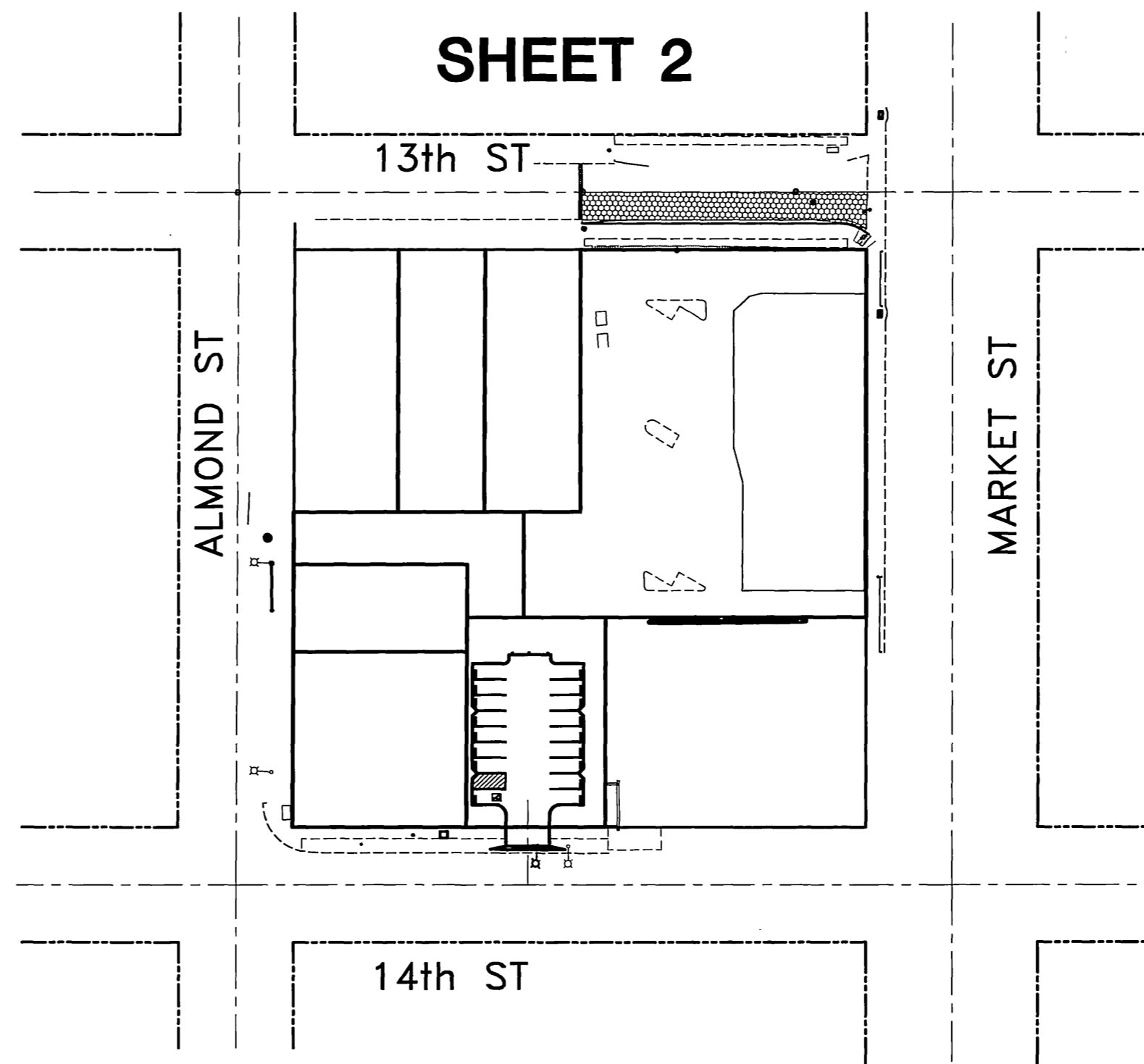

INDEX MAP

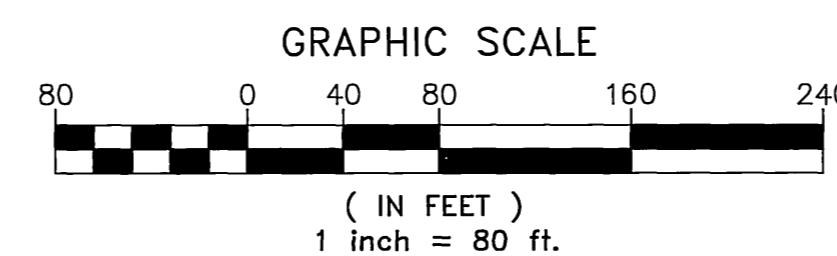

INDEX OF SHEETS:

SHEET NO(S).	DESCRIPTION
1	TITLE SHEET
2	PLAN & PROFILE

CONSTRUCTION NOTES & QUANTITY ESTIMATE

NO.	ITEMS	QUANTITY	UNIT
(1)	CONST. 3" A.C. OVER 4" CLASS II A.B. PER R-3469 & CITY OF RIV. MIN. STRUCTURAL REQUIREMENT	2,988	SF
(2)	REMOVE AND REPLACE EXISTING AC PAVEMENT	2,988	SF
(3)	CONSTRUCT TYPE I CURB & GUTTER (6") PER CITY OF RIVERSIDE STD. DWG. NO 200	375	LF
(4)	EXIST. 5' SIDEWALK PROTECT IN-PLACE	1,070	SF
(5)	EXISTING STREET NAME SIGN PROTECT IN-PLACE	1	EA
(6)	EXISTING TREES PROTECT IN-PLACE	7	EA
(7)	EXISTING FIRE HYDRANT PROTECT IN-PLACE	1	EA
(8)	RELOCATE EXISTING SIGN BOARD	1	EA
(9)	EXIST. POWER POLE PROTECT IN-PLACE	1	EA
(10)	EXIST. 1.5" WATER METER PROTECT IN-PLACE	1	EA
(11)	ADJUST RIM TO GRADE	2	EA
(12)	EXIST. WHEELCHAIR RAMP BUILT BY CITY ON JULY 2007 PROTECT IN PLACE	1	EA

ENGINEERS NOTE:

CONTRACTOR AGREES THAT HE SHALL ASSUME SOLE AND COMPLETE RESPONSIBILITY FOR JOB SITE CONDITIONS DURING THE COURSE OF CONSTRUCTION OF THIS PROJECT, INCLUDING SAFETY OF ALL PERSONS AND PROPERTY; THAT THIS REQUIREMENT SHALL APPLY CONTINUOUSLY AND NOT BE LIMITED TO NORMAL WORKING HOURS, AND THAT THE CONTRACTOR SHALL DEFEND, INDEMNIFY AND HOLD THE OWNER AND THE ENGINEER HARMLESS FROM ANY LIABILITY, REAL OR ALLEGED, IN CONNECTION WITH THE PERFORMANCE OF WORK ON THIS PROJECT, EXCEPTING FOR LIABILITY ARISING FROM THE NEGLIGENCE OF THE OWNER OR ENGINEER.

THE EXISTENCE AND LOCATION OF ANY UNDERGROUND UTILITIES OR STRUCTURES SHOWN ON THESE PLANS ARE OBTAINED BY A DILIGENT SEARCH OF AVAILABLE RECORDS. THE CONTRACTOR IS REQUIRED TO TAKE ALL PRECAUTIONARY MEASURES TO PROTECT ALL THE UTILITIES SHOWN AND ANY OTHER LINES OR STRUCTURES NOT SHOWN ON THESE PLANS AND IS RESPONSIBLE FOR THE PROTECTION OF, AND ANY DAMAGE TO THESE LINES OR STRUCTURES.

Underground Service Alert



Call: TOLL FREE
1-800-227-2600

TWO WORKING DAYS BEFORE YOU DIG

CITY OF RIVERSIDE WATER DEPARTMENT

APPROVED: *MW McLe*

DATE: 8/16/07

REVIEWED BY: RIVERSIDE PUBLIC UTILITIES ELECTRIC

APPROVED: *[Signature]*

DATE: 8/16/07

NOTE: WORK CONTAINED WITHIN THESE PLANS SHALL NOT COMMENCE UNTIL AN CONSTRUCTION PERMIT AND/OR A GRADING PERMIT HAS BEEN ISSUED.

SEAL:

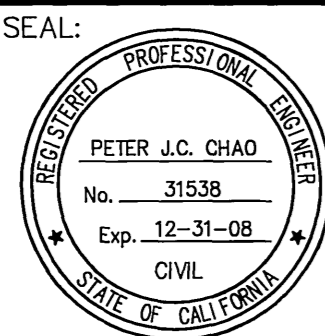

PACIFIC COAST LAND CONSULTANTS, Inc.
Civil Engineering • Land Planning • Land Surveying
25096 Jefferson Avenue, Suite 101, Murrieta, Ca. 92562
Tel: (951) 698-1350 Fax: (951) 698-8657

PREPARED BY: *[Signature]*
PETER J.C. CHAO
R.C.E. NO. 31538
DATE: 8/16/07

BENCHMARK:

GPS-54 ELEVATION: 841.125 NAVD 1929
U.S. COAST AND GEODETIC SURVEY BRASS DISK "NEWMAN 1929" IN THE SIDEWALK 6 FEET BACK OF THE NORTHERLY CURB OF FOURTEENTH STREET, 125 FEET WEST OF THE CENTERLINE OF MAIN STREET.

DATE	BY	MARK	REVISIONS:	APPR	DATE
ENGINEER				CITY	

CITY OF RIVERSIDE, CALIFORNIA PUBLIC WORKS DEPARTMENT					
APPROVED BY:	BY:	DATE:	APPROVED BY:	DATE:	
PRINCIPAL ENGINEER	<i>[Signature]</i>	8/16/07	<i>[Signature]</i>	8/16/07	
TRAFFIC DIVISION	J. U.	8-16-07	CITY ENGINEER		

CITY BUSINESS TAX CERTIFICATE NO. 113295 EXP. 8-30-2007

PW 07-0660

STREET IMPROVEMENT PLANS
13TH STREET
1+98.00 SOUTHWESTERLY SIDE ALMOND ST TO 3+62.52 SOUTHEASTERLY
TITLE SHEET

R-4051

SHEET 1 OF 2

SCALE: HORIZ.: 1"=80' VERT.: N/A

INDEXED 9-18-07 LHL

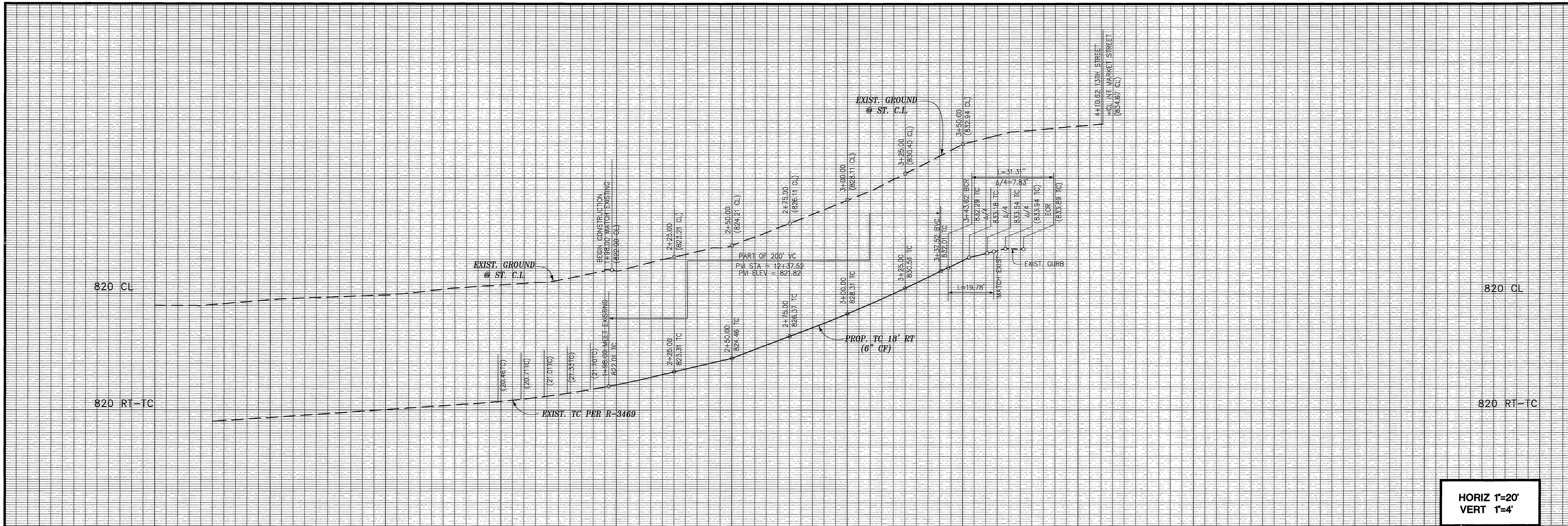

HORIZ 1"=20'
VERT 1"=4'

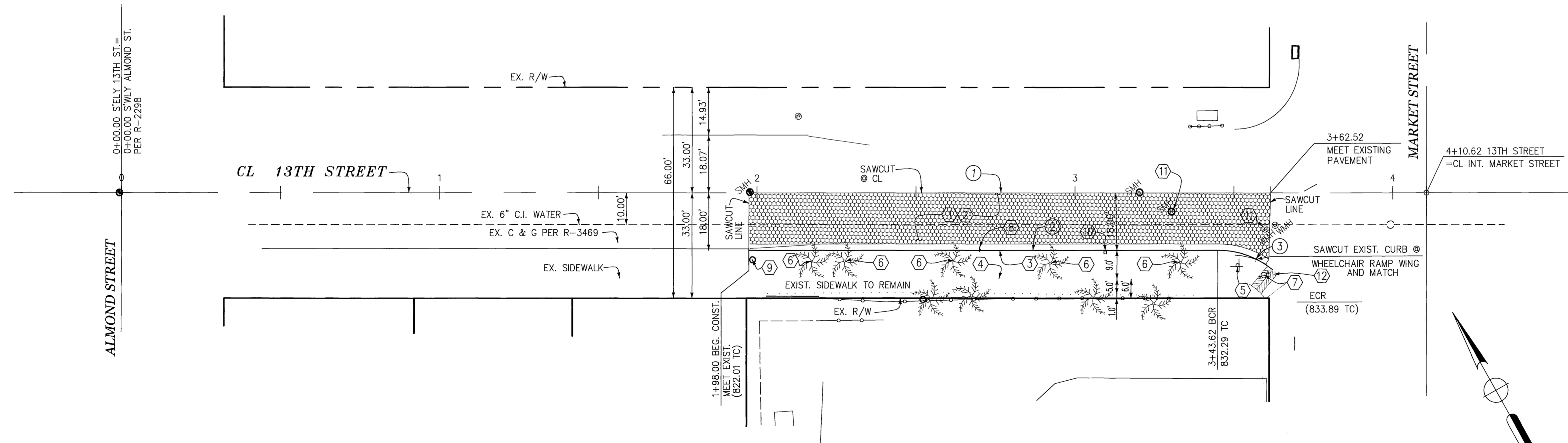

- CONSTRUCTION NOTES:**
- 1 CONST. 3" A.C. OVER 4" CLASS II A.B. PER R-3469 & CITY OF RIVERSIDE MINIMUM STRUCTURAL SECTION REQUIREMENTS.
 - 2 REMOVE AND REPLACE EXISTING AC PAVEMENT
 - 3 CONST. 6" CURB & GUTTER TYPE I PER CITY OF RIVERSIDE STD. DWG. NO. 200
 - 4 EXIST. 5' SIDEWALK PROTECT IN-PLACE
 - 5 EXISTING STREET NAME SIGN TO BE PROTECTED IN-PLACE
 - 6 EXISTING TREES PROTECT IN-PLACE
 - 7 EXISTING FIRE HYDRANT TO BE PROTECTED IN-PLACE
 - 8 RELOCATE EXISTING SIGN BOARD
 - 9 EXIST. POWER POLE PROTECT IN-PLACE
 - 10 EXIST. 1.5" WATER METER PROTECT IN-PLACE
 - 11 ADJUST RIM TO GRADE
 - 12 EXISTING WHEELCHAIR RAMP BUILT BY CITY ON JULY 2007 PROTECT IN PLACE

DATA TABLE

NO	DELTA/BRG	RADIUS	LENGTH	TANGENT
1	N60°53'05"W	-	410.62'	-
2	N60°53'05"W	-	147.69'	-
3	41°58'05"	27.00'	19.78'	10.36'

LEGEND:

REMOVE AND REPLACE EXIST. AC PAVEMENT

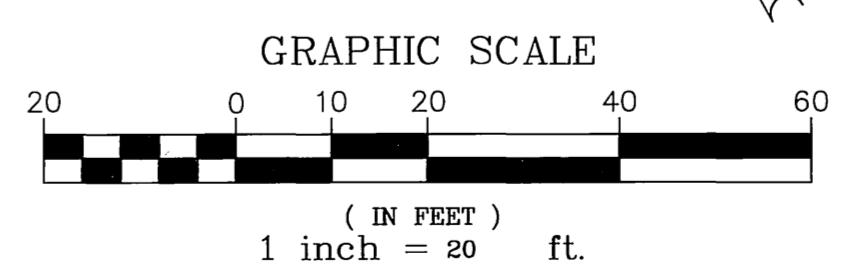

Underground Service Alert

Call: TOLL FREE
1-800-227-2600

TWO WORKING DAYS BEFORE YOU DIG

CITY OF RIVERSIDE
WATER DEPARTMENT

MW McNeil
APPROVED

8/7/07
DATE

REVIEWED BY:
RIVERSIDE PUBLIC UTILITIES
ELECTRIC

[Signature]
APPROVED

8/7/07
DATE

13 TH STREET

NOTE: WORK CONTAINED WITHIN THESE PLANS SHALL NOT COMMENCE UNTIL AN CONSTRUCTION PERMIT AND/OR A GRADING PERMIT HAS BEEN ISSUED.

THE PRIVATE ENGINEER SIGNING THESE PLANS IS RESPONSIBLE FOR ASSURING THE ACCURACY OF DESIGN & ACCEPTABILITY OF THE WORK HEREON. IN THE EVENT OF DISCREPANCIES ARISING AFTER CITY APPROVAL OR DURING CONSTRUCTION, THE PRIVATE ENGINEER SHALL BE RESPONSIBLE FOR DETERMINING AN ACCEPTABLE SOLUTION AND REVISING THE PLANS FOR APPROVAL BY THE CITY.

SEAL:
REGISTERED PROFESSIONAL ENGINEER
PETER J.C. CHAO
No. 31538
Exp. 12-31-08
CIVIL
STATE OF CALIFORNIA

PACIFIC COAST LAND CONSULTANTS, Inc.
Civil Engineering • Land Planning • Land Surveying
25095 Jefferson Avenue, Suite "D", Murrieta, Ca. 92562
Tel: (951) 698-1350 Fax: (951) 698-8657

PREPARED BY:
[Signature]
PETER J.C. CHAO

R.C.E. NO. 31538
DATE 8/6/07

BENCHMARK:
GPS-54
ELEVATION: 841.125
NAVD 1929

U.S. COAST AND GEODETIC SURVEY BRASS DISK "NEWMAN 1929" IN THE SIDEWALK 6 FEET BACK OF THE NORTHERLY CURB OF FOURTEENTH STREET, 125 FEET WEST OF THE CENTERLINE OF MAIN STREET.

DATE	BY	MARK	REVISIONS:	APPR DATE	CITY

CITY OF RIVERSIDE, CALIFORNIA
PUBLIC WORKS DEPARTMENT

APPROVED BY: BY: DATE: APPROVED BY:
PRINCIPAL ENGINEER *[Signature]* 8/8/07
TRAFFIC DIVISION *[Signature]* 8-8-07
CITY ENGINEER
[Signature]
DATE 8/14/07

STREET IMPROVEMENT PLANS
13TH STREET
+198.00 TO 3+62.52

SCALE: HORIZ.: 1"=20' VERT.: 1"=4'

R-4051

SHEET 2 OF 2

S:\Land Projects\2004\UR_DHALLA.dwg\13TH STREET\ST_IMP_SHT_02.dwg 8-06-07 04:53:34 PM Bmjf