

EXISTING UNDERGROUND UTILITIES:

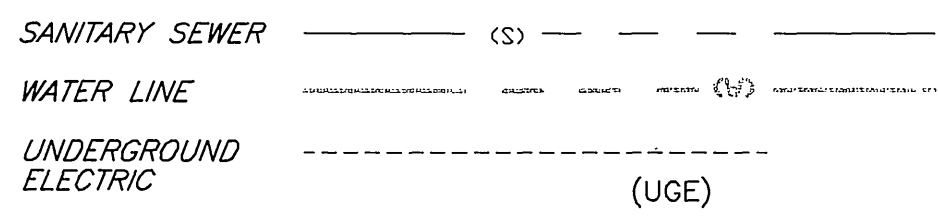

EXISTING TOPOGRAPHY:

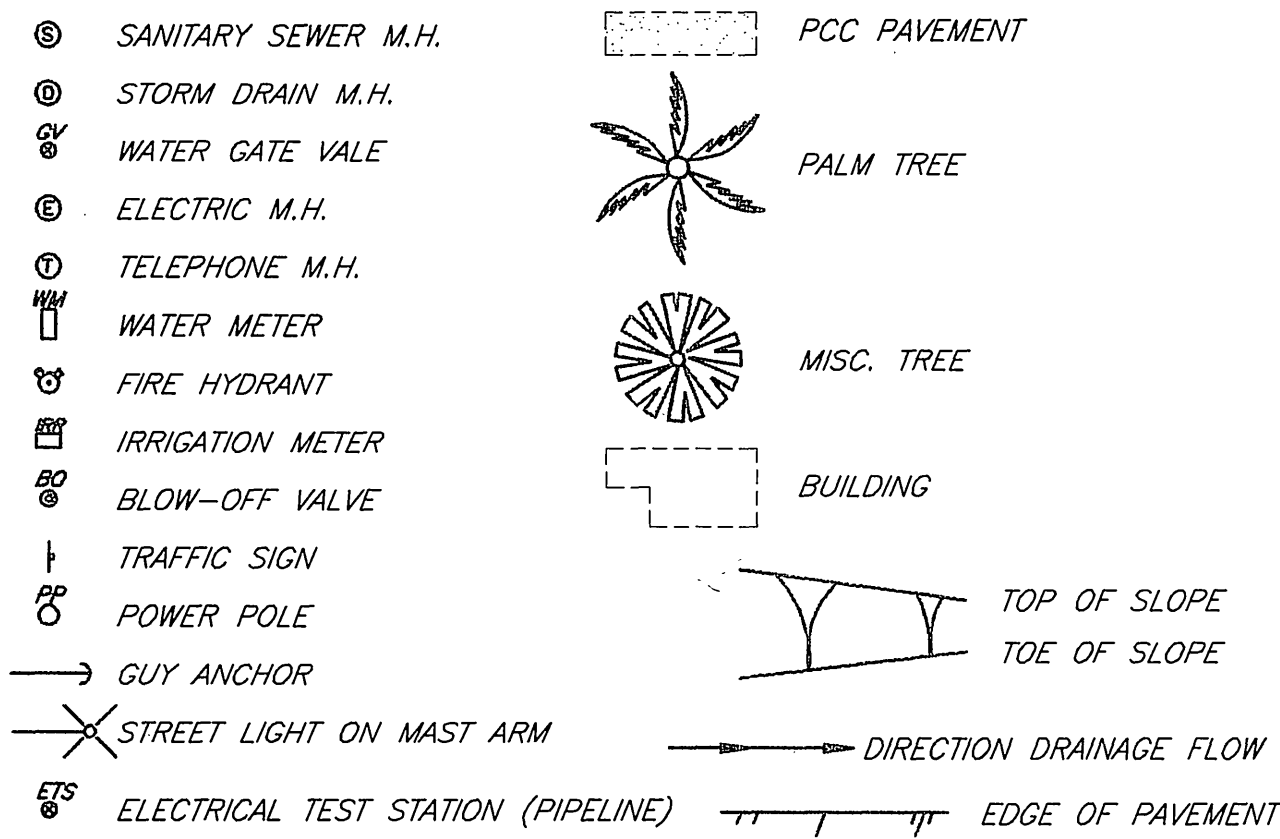

LEGEND AND ABBREVIATIONS

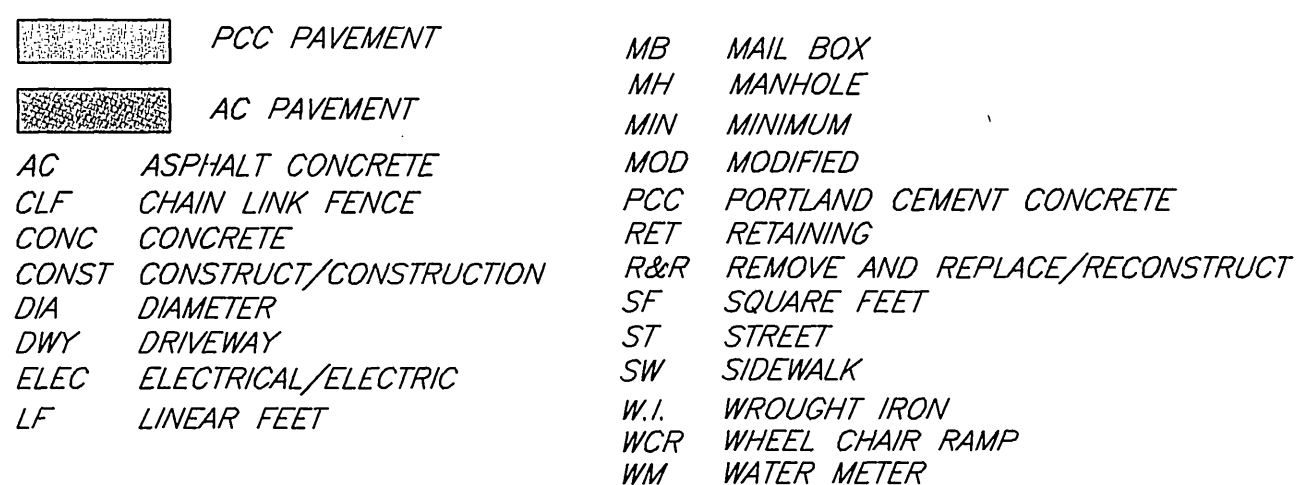

SHEET INDEX:

SHEET NO.	DESCRIPTION
1	SAFE PATHWAY TO SCHOOL, 2007-08 CDBG (A HUD FUNDED PROJECT) TITLE SHEET
2	SAFE PATHWAY TO SCHOOL, 2007-08 CDBG (A HUD FUNDED PROJECT) CHAPEL STREET (TREY AVE TO BEAU AVE) - EAST SIDE
3	SAFE PATHWAY TO SCHOOL, 2007-08 CDBG (A HUD FUNDED PROJECT) BEEJAY STREET (BABB AVE TO CYPRESS AVE) - EAST SIDE
4	SAFE PATHWAY TO SCHOOL, 2007-08 CDBG (A HUD FUNDED PROJECT) NOBLE STREET (PHILBIN AVE TO CYPRESS AVE) - EAST SIDE
5	SAFE PATHWAY TO SCHOOL, 2007-08 CDBG (A HUD FUNDED PROJECT) BABB & PHILBIN AVENUE (CREST AVE TO NOBLE ST) - NORTHEAST SIDE
6	SAFE PATHWAY TO SCHOOL, 2007-08 CDBG (A HUD FUNDED PROJECT) TREY AVENUE (BABB AVE TO RUTLAND AVE) - SOUTH SIDE

TREE SCHEDULE

SHEET NO.	STREET NAME	TYPE OF TREE
2	CHAPEL STREET (TREY AVE TO BEAU AVE)	GINKGO BILOBA
3	BEEJAY STREET (BABB AVE TO CYPRESS AVE)	CHINESE PISTACHE
4	NOBLE STREET (PHILBIN AVE TO CYPRESS AVE)	MAGNOLIA GRANDIFLORA
5	BABB AVENUE (CREST AVE TO PHILBIN AVE ST)	CRAPE MYRTLE
5	PHILBIN AVENUE (BEEJAY AVE TO NOBLE ST)	VICTORIAN BOX
6	TREY AVENUE (BABB AVE TO RUTLAND AVE)	JACARANDA MMOSIFOLIA

PUBLIC WORKS DEPARTMENT SAFE PATHWAY TO SCHOOL, 2007-08 CDBG (A HUD FUNDED PROJECT)



LOCATION MAP
NTS

GENERAL NOTES:

- EXISTING UTILITIES SHOWN ON THIS PLAN ARE PLOTTED FROM UTILITY RECORDS. THE CONTRACTOR IS REQUIRED TO TAKE DUE PRECAUTIONARY MEASURES TO LOCATE AND PROTECT ALL UTILITIES WHETHER OR NOT SHOWN ON THIS PLAN.
- CONTRACTOR SHALL GRADE BEHIND PROPOSED SIDEWALK TO ENSURE PROPER TRANSITION INTO THE LOT AND SHALL NOT IMPEDE EXISTING DRAINAGE PATTERNS.
- ANY TEMPORARY TRAFFIC CONTROL STRIPING OBLITERATED AND/OR BADLY WORN DURING CONSTRUCTION SHALL BE RESTORED BY THE CONTRACTOR WITHIN ONE DAY AFTER NOTIFICATION FROM THE CITY INSPECTOR.
- WHERE NEW PAVEMENT IS TO JOIN THE EXISTING PAVEMENT, THE EDGE OF THE EXISTING PAVEMENT SHALL BE TRIMMED IN A SMOOTH AND STRAIGHT LINE. CONSTRUCT MATCH-UP PAVING AS DIRECTED IN THE FIELD TO PRODUCE A SMOOTH SECTION.
- SURVEY STAKING REQUESTS AND GRADE SHEETS ARE REQUIRED FOR THE REPLACEMENT OF ALL CURBS AND/OR GUTTER OVER 50' IN LENGTH. SURVEY REQUESTS SHALL BE SUBMITTED AFTER THE EXISTING IMPROVEMENTS HAVE BEEN REMOVED. CONTRACTOR SHALL ALLOW 4 WORKING DAYS AFTER REQUESTING SURVEY TO SCHEDULE SURVEY AND PROCESS GRADE SHEETS. CONTRACTOR SHALL PROVIDE TRAFFIC CONTROL FOR ALL REQUIRED CONSTRUCTION SURVEY WORK BY CITY PERSONNEL.
- THIS PROJECT HAS APPROXIMATELY 16 PROPOSED NEW AND EXISTING WHEELCHAIR RAMPS TO BE RECONSTRUCTED. EACH NEW OR RECONSTRUCTED RAMP REQUIRES THE REMOVAL AND REPLACEMENT OF APPROXIMATELY 150 SF OF RAMP AREA, 50 TO 100 SF OF SIDEWALK, 30 LF OF CURB AND GUTTER, 30 LF OF NEW RETAINING CURB AND SOME RAMPS MAY REQUIRE APPROXIMATELY 200 SF OF ASPHALT CONCRETE PAVEMENT REMOVAL AND REPLACEMENT FOR CROSS-FALL WHICH SHALL BE LESS THAN 5%. THESE QUANTITIES ARE APPROXIMATE AND MAY CHANGE ACCORDING TO EACH RAMP TYPE AND SITE CONDITIONS. RAMPS SHALL BE CONSTRUCTED PER CITY STANDARDS, ADA REQUIREMENTS AND AS DIRECTED BY THE ENGINEER. AREAS FOR REMOVAL SHALL BE MARKED BY THE CONTRACTOR AND ACCEPTED BY THE CITY INSPECTOR AT THE TIME OF CONSTRUCTION. SEE PLANS FOR RAMP LOCATIONS AND TYPES.
- MAIL BOXES THAT LIMIT SIDEWALK ACCESS AND ARE NOT PROTECTED IN PLACE (PIP), WHETHER OR NOT NOTED ON PLAN, SHALL BE RELOCATED PER PART 3 OF THE SPECIAL PROVISIONS. CANTILEVER MAIL BOXES TO BE RELOCATED SHALL BE ADJUSTED TO NON-CANTILEVER MAIL BOXES.

CONSTRUCTION NOTES:

- NUMBERS ABOVE 100 IN A HEXAGON ON THE PLAN REFER TO THE RESPECTIVE STANDARD DRAWING AND SHALL BE CONSTRUCTED ACCORDINGLY. UNLESS MODIFICATIONS ARE NOTED ON THE PLAN OR COVER SHEET, ANY NUMBER SHOWN BELOW THE STANDARD DRAWING NUMBER INDICATES THE SPECIFIC ALTERNATE TO BE CONSTRUCTED.
- RELOCATE EXISTING SIGN, TREE OR OBJECTS, AS SHOWN ON PLANS AND/OR AS DIRECTED BY THE ENGINEER TO PROVIDE REQUIRED CLEARANCE.
- REMOVE AND DISPOSE EXISTING IMPROVEMENTS OR OBJECTS IN CONFLICT WITH PROPOSED CONSTRUCTION AND/OR IMPROVEMENTS AS SHOWN ON PLAN AND OR AS DIRECTED BY THE ENGINEER.
- PROTECT IN PLACE (DESCRIPTION PER PLAN).
- ADJUST EXISTING MANHOLES AND WATER METER BOXES TO GRADE. REPLACE ALL PLASTIC WATER METER BOXES WITH CONCRETE WATER METER BOXES. CONCRETE WATER METER BOXES SHALL BE PROVIDED BY THE CITY AND CONTRACTOR SHALL ARRANGE FOR PICK UP FROM THE CITY CORPORATION YARD LOCATED AT 8095 LINCOLN AVE, CITY OF RIVERSIDE.
- CONSTRUCT PCC SIDEWALK PER CITY STANDARD DWG 325. ADJUST IRRIGATION SYSTEM AS NECESSARY TO PROVIDE ADEQUATE CONNECTIONS AND COVERAGE FOR REMAINING LANDSCAPE AREAS.
- REMOVE AND REPLACE EXISTING IMPROVEMENTS AS INDICATED ON THE PLANS.
- TREES TO BE REMOVED BY CITY FORCES. CONTRACTOR SHALL REGRADE SITE AND REPLACE REMOVED TREES WITH 24" BOX TREES. NEW LOCATIONS AND TYPES OF TREES ARE AS SHOWN ON PLAN OR AS DIRECTED BY THE ENGINEER DURING CONSTRUCTION.
- CONSTRUCT PCC DRIVEWAY APPROACH (CURB-I TYPE) PER CITY STANDARD DRAWING 302. MATCH-UP LIMITS FOR DRIVEWAYS MAY CHANGE AT THE TIME OF CONSTRUCTION FROM LIMITS NOTED ON PLANS TO ENSURE PROPER TRANSITION BETWEEN PROPOSED AND THE EXISTING IMPROVEMENTS.
- CONSTRUCT PCC WHEELCHAIR RAMP PER CITY STANDARD DWG 304. TYPE AND LOCATION OF RAMP MAY CHANGE DURING CONSTRUCTION TO FIT SITE CONDITION AS DIRECTED BY THE ENGINEER.
- REPLACE A RAMP FLAIR (WING) WITH (0"-6") RETAINING CURB TO ACCOMMODATE AN EXISTING FIRE HYDRANT.
- CONSTRUCT PCC CROSS GUTTER PER CITY STANDARD DWG 220.

SPECIFIC NOTES:

- REMOVE AND REPLACE AC PAVEMENT. LIMITS OF AC REMOVAL AND REPLACEMENT ARE SHOWN ON PLANS AND SHALL BE VERIFIED BY THE INSPECTOR AT THE TIME OF CONSTRUCTION. PAVEMENT THICKNESS SHALL BE 6" MINIMUM OR MATCH EXISTING PAVEMENT THICKNESS WHICHEVER IS GREATER.
- REMOVE INTERFERING IMPROVEMENTS AS SHOWN ON PLAN.
- CONSTRUCT PCC RETAINING CURB (H=0"-8"), WHERE RETAINING CURB IS NOT REQUIRED GRADE BACK EXISTING SURFACE BEHIND THE PROPOSED SIDEWALK UP TO 5:1 AND REPLACE THE DISTURBED AREAS OF LAWN WITH SOD. RETAINING CURB SHALL BE CONSTRUCTED MONOLITHIC WITH THE SIDEWALK.
- REMOVE 8" BLOCK WALL AND FOOTING. GRADE AS NECESSARY TO PROVIDE SMOOTH SURFACE.
- REPLACE REMOVED TREE WITH 24" BOX TREE (SEE TREE REPLACEMENT SCHEDULE, PAGE 1 OF 6)

Underground Service Port
CALL BEFORE YOU DIG
CALL-TOLL FREE
1-800-227-2600
TWO WORKING DAYS BEFORE YOU DIG

ENGINEER IN RESPONSIBLE CHARGE
IBRAHIM A. MASSOUD
R.C.E. No. 64224 expires 6/30/09
DATE 2/2/08

REGISTERED PROFESSIONAL ENGINEER
IBRAHIM A. MASSOUD
No. 64224
Exp. 6-30-2009
CIVIL
STATE OF CALIFORNIA

CITY OF RIVERSIDE, CALIFORNIA
PUBLIC WORKS DEPARTMENT

APPROVED BY: [Signature]
DATE: 2/2/08

DESIGNED BY: JUE DRAWN BY: JUE CHECKED BY: ADE

SAFE PATHWAY TO SCHOOL
2007-08 CDBG
(A HUD FUNDED PROJECT)
TITLE SHEET

ACCT. NO.: 9228700611
W.O. 0809581
R-4089
SHEET 1 OF 6
FILE NO.

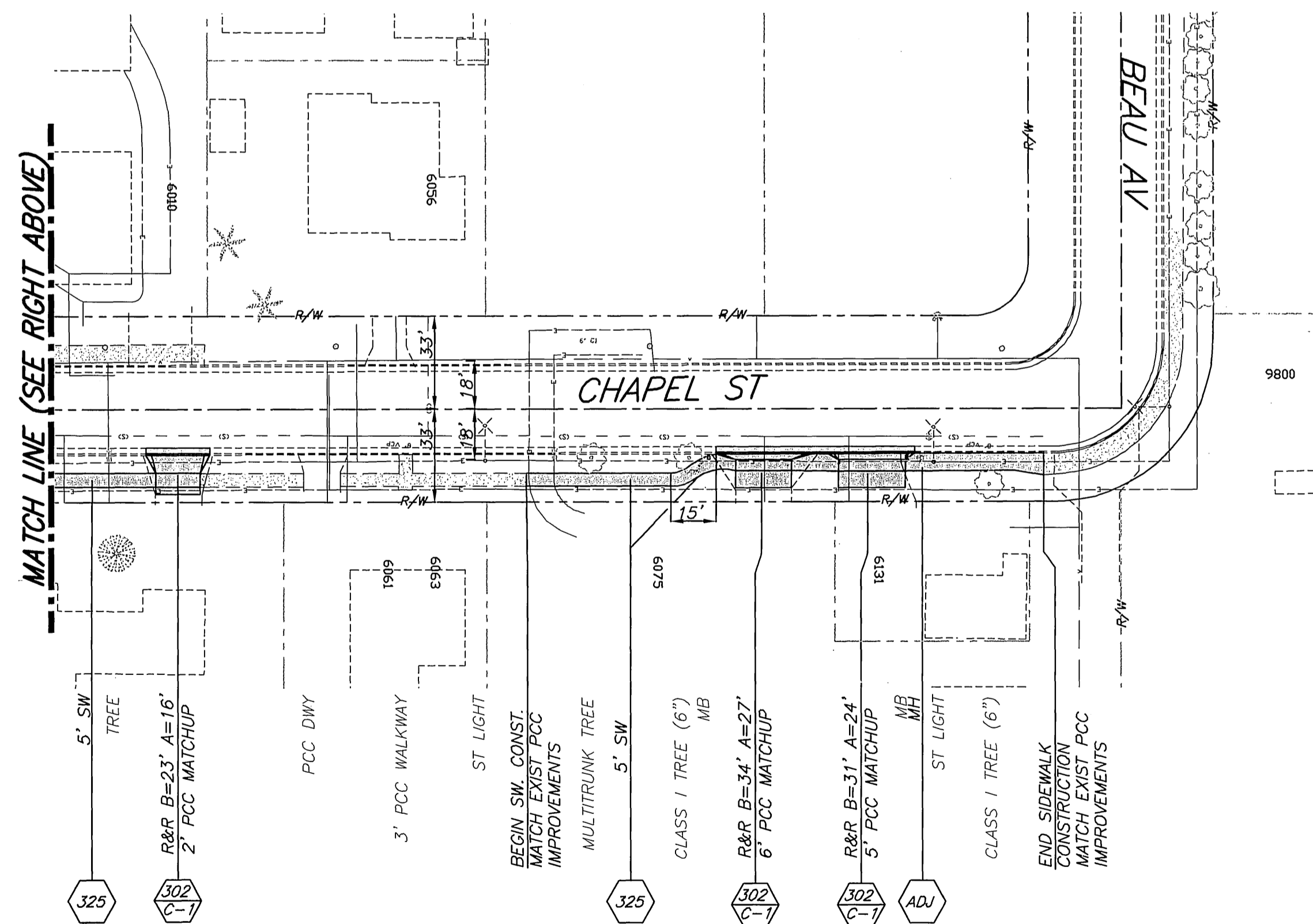
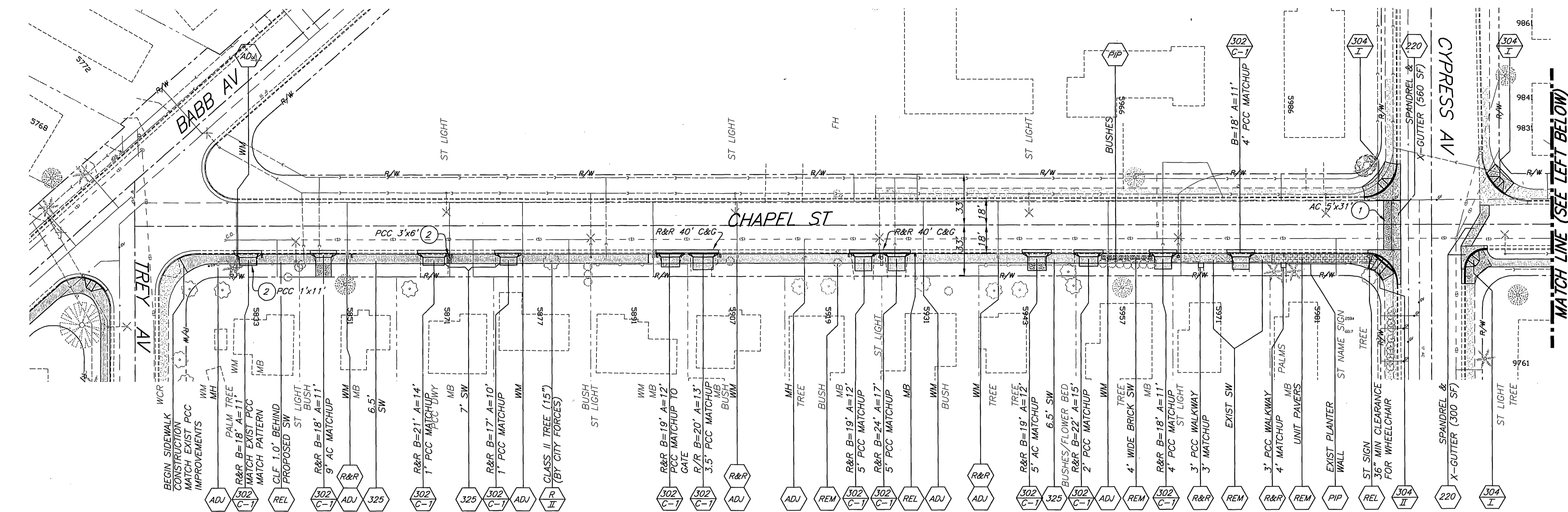

CONSTRUCTION NOTES:

- NUMBERS ABOVE 100 IN A HEXAGON ON THE PLAN REFER TO THE RESPECTIVE STANDARD DRAWING AND SHALL BE CONSTRUCTED ACCORDINGLY. UNLESS MODIFICATIONS ARE NOTED ON THE PLAN OR COVER SHEET, ANY NUMBER SHOWN BELOW THE STANDARD DRAWING NUMBER INDICATES THE SPECIFIC ALTERNATE TO BE CONSTRUCTED.
- RELOCATE EXISTING SIGN, TREE OR OBJECTS, AS SHOWN ON PLANS AND/OR AS DIRECTED BY THE ENGINEER TO PROVIDE REQUIRED CLEARANCE.
- REMOVE AND DISPOSE EXISTING IMPROVEMENTS OR OBJECTS IN CONFLICT WITH PROPOSED CONSTRUCTION AND/OR IMPROVEMENTS AS SHOWN ON PLAN AND OR AS DIRECTED BY THE ENGINEER.
- PROTECT IN PLACE (DESCRIPTION PER PLAN).
- ADJUST EXISTING MANHOLES AND WATER METER BOXES TO GRADE. REPLACE ALL PLASTIC WATER METER BOXES WITH CONCRETE WATER METER BOXES. CONCRETE WATER METER BOXES SHALL BE PROVIDED BY THE CITY AND CONTRACTOR SHALL ARRANGE FOR PICK UP FROM THE CITY CORPORATION YARD LOCATED AT 8095 LINCOLN AVE, CITY OF RIVERSIDE.
- CONSTRUCT PCC SIDEWALK PER CITY STANDARD DWG 325. ADJUST IRRIGATION SYSTEM AS NECESSARY TO PROVIDE ADEQUATE CONNECTIONS AND COVERAGE FOR REMAINING LANDSCAPE AREAS.
- REMOVE AND REPLACE EXISTING IMPROVEMENTS AS INDICATED ON THE PLANS.
- TREES TO BE REMOVED BY CITY FORCES. CONTRACTOR SHALL REGRADE SITE AND REPLACE REMOVED TREES WITH 24" BOX TREES. NEW LOCATIONS AND TYPES OF TREES ARE AS SHOWN ON PLAN OR AS DIRECTED BY THE ENGINEER DURING CONSTRUCTION.
- CONSTRUCT PCC DRIVEWAY APPROACH (CURB-I TYPE) PER CITY STANDARD DRAWING 302. MATCH-UP LIMITS FOR DRIVEWAYS MAY CHANGE AT THE TIME OF CONSTRUCTION FROM LIMITS NOTED ON PLANS TO ENSURE PROPER TRANSITION BETWEEN PROPOSED AND THE EXISTING IMPROVEMENTS.
- CONSTRUCT PCC WHEELCHAIR RAMP PER CITY STANDARD DWG 304. TYPE AND LOCATION OF RAMP MAY CHANGE DURING CONSTRUCTION TO FIT SITE CONDITION AS DIRECTED BY THE ENGINEER.
- REPLACE A RAMP FLAIR (WING) WITH (0'-6") RETAINING CURB TO ACCOMMODATE AN EXISTING FIRE HYDRANT.
- CONSTRUCT PCC CROSS GUTTER PER CITY STANDARD DWG 220.

SPECIFIC NOTES:

- REMOVE AND REPLACE AC PAVEMENT. LIMITS OF AC REMOVAL AND REPLACEMENT ARE SHOWN ON PLANS AND SHALL BE VERIFIED BY THE INSPECTOR AT THE TIME OF CONSTRUCTION. PAVEMENT THICKNESS SHALL BE 6" MINIMUM OR MATCH EXISTING PAVEMENT THICKNESS WHICHEVER IS GREATER.
- REMOVE INTERFERING IMPROVEMENTS AS SHOWN ON PLAN.
- CONSTRUCT PCC RETAINING CURB (H=0'-8"), WHERE RETAINING CURB IS NOT REQUIRED GRADE BACK EXISTING SURFACE BEHIND THE PROPOSED SIDEWALK UP TO 5:1 AND REPLACE THE DISTURBED AREAS OF LAWN WITH SOD. RETAINING CURB SHALL BE CONSTRUCTED MONOLITHIC WITH THE SIDEWALK.
- REMOVE 8" BLOCK WALL AND FOOTING. GRADE AS NECESSARY TO PROVIDE SMOOTH SURFACE.
- REPLACE REMOVED TREE WITH 24" BOX TREE (SEE TREE REPLACEMENT SCHEDULE, PAGE 1 OF 6)

Underground Service Alert
CALL BEFORE YOU DIG
CALL TOLL FREE
1-800-227-2600
TWO WORKING DAYS BEFORE YOU DIG

ENGINEER IN RESPONSIBLE CHARGE
Moham Mansour
IBRAHIM A. MASSOUD
R.C.E. No. 64224 expires 6/30/09
DATE 9-3-08



DESIGNED BY: JUE	DRAWN BY: JUE	CHECKED BY: ABE
APPROVED BY: [Signature]	DATE: 9/3/08	

CITY OF RIVERSIDE, CALIFORNIA
PUBLIC WORKS DEPARTMENT

APPROVED BY: [Signature]	DATE: 9/3/08
ENGINEERING MANAGER	
PRINCIPAL ENGINEER	
STREET SERVICES	
SURVEYOR	
TRAFFIC DIVISION	
CONST. CONT. ADMIN.	

SAFE PATHWAY TO SCHOOL
2007-08 CDBG
(A HUD FUNDED PROJECT)
CHAPEL STREET
(TREY AV TO BEAU AV)

ACCT. NO.: 9228700611
W.O. 0809581
R-4089
SHEET 2 OF 6
FILE NO.

C:\COMMON\DESIGN\PROJECTS\07-0289-0286\2007-08 L\DESIGN\PLANS\TRANSPORTATION\0402-SHEETS\SH2-2-C.DWG

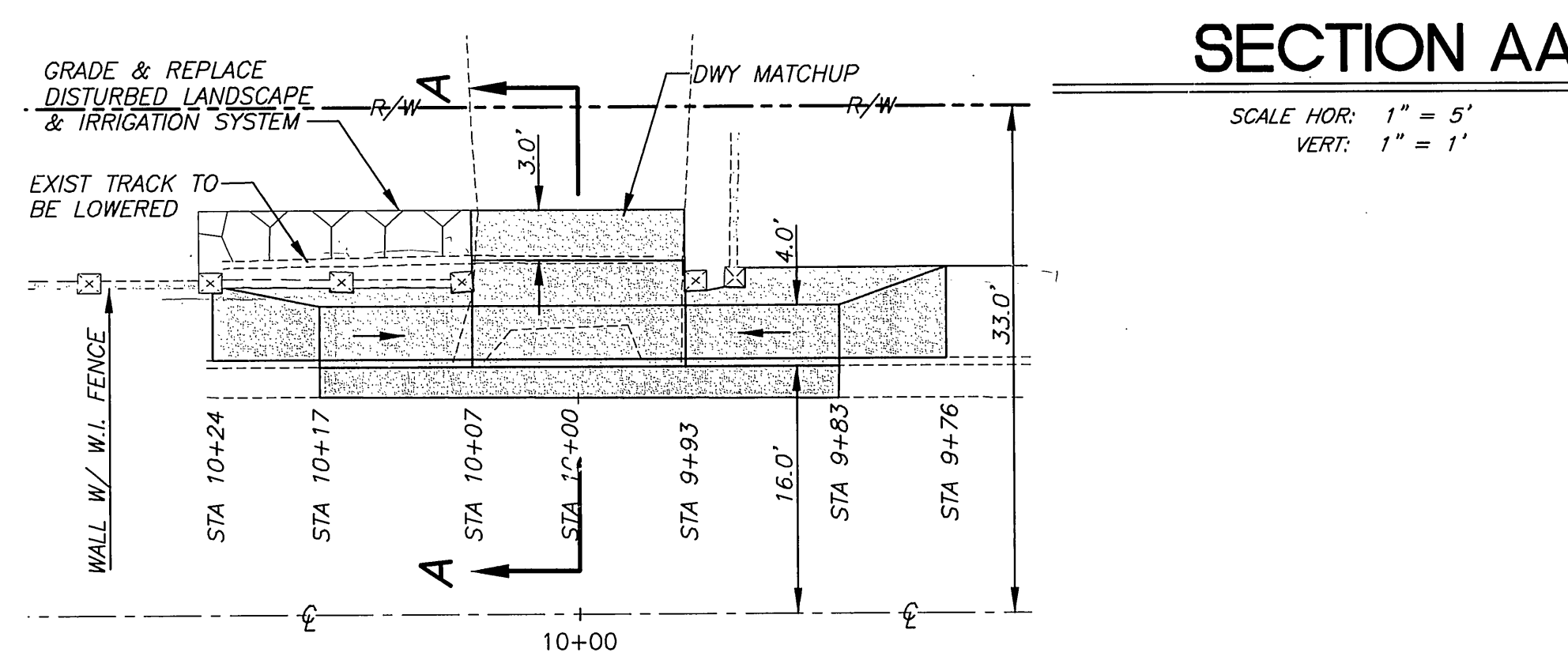
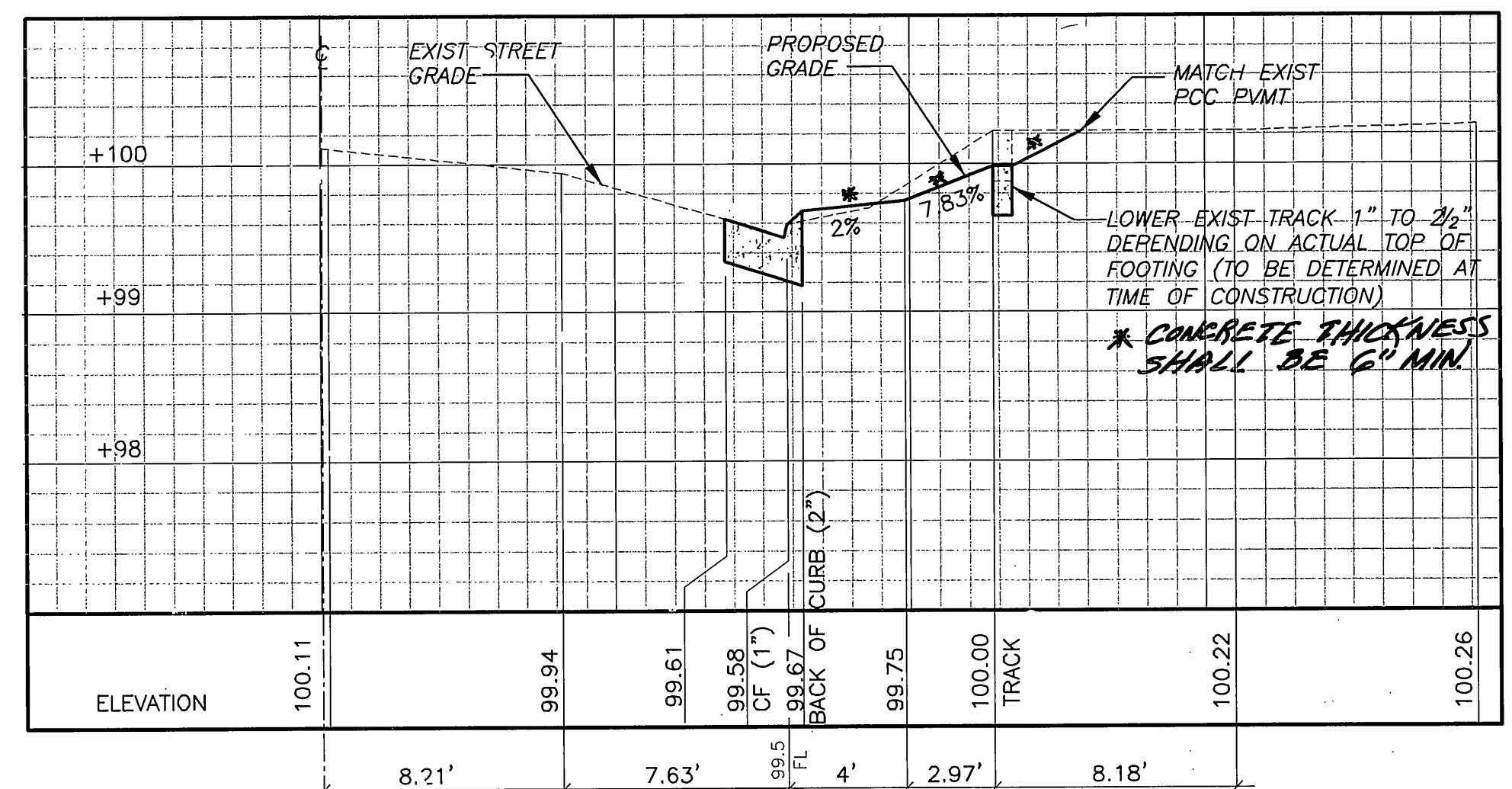
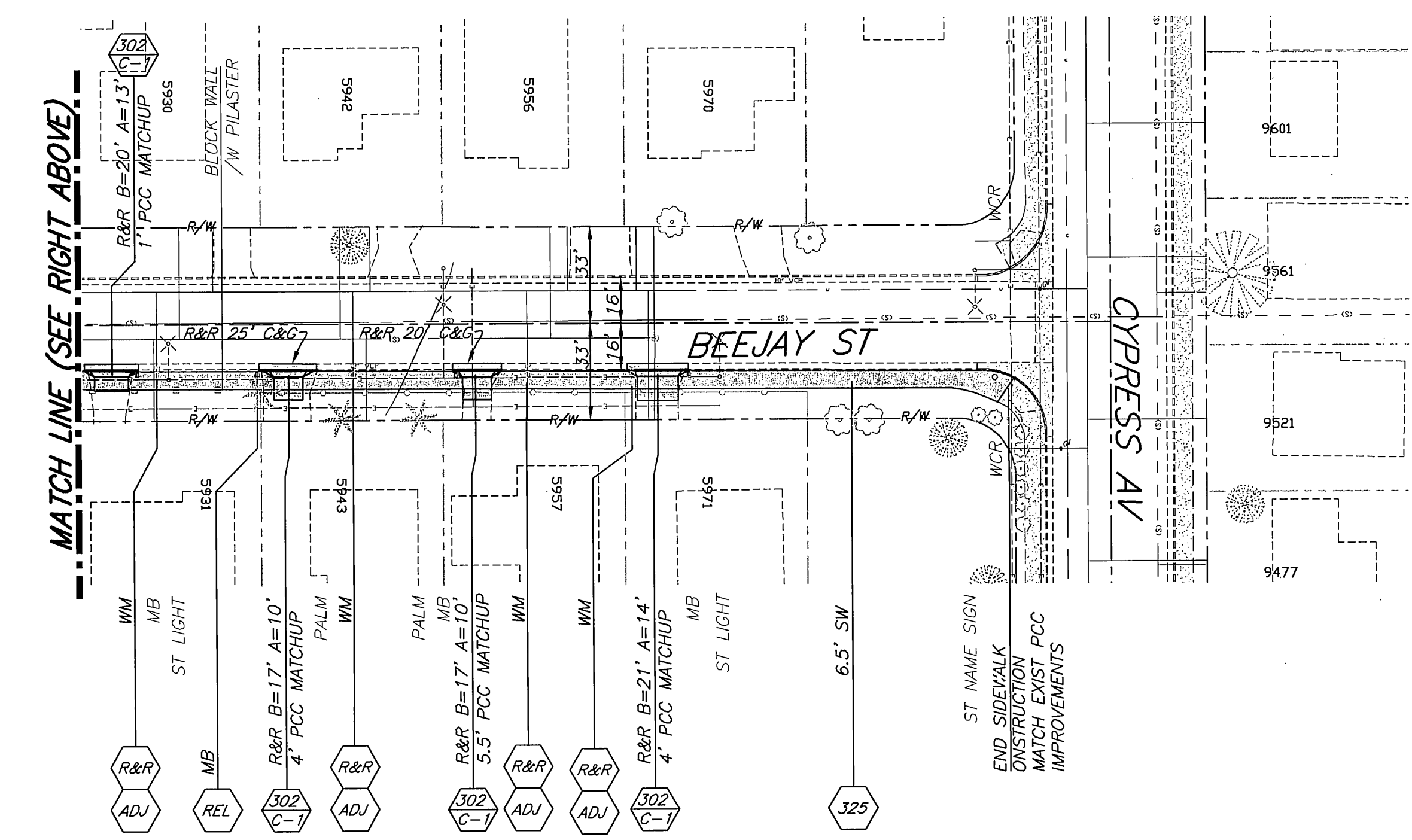
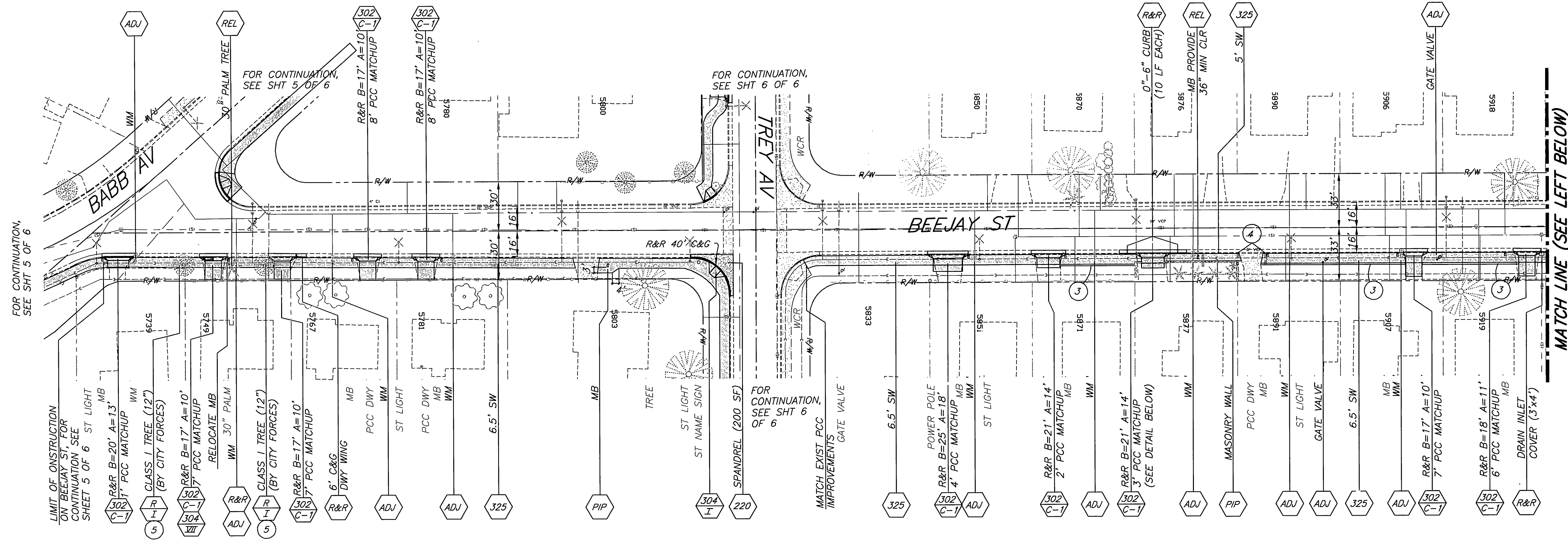

DRIVEWAY @ 5877 BEEJAY ST
SCALE 1" = 10'

CONSTRUCTION NOTES:

- NUMBERS ABOVE 100 IN A HEXAGON ON THE PLAN REFER TO THE RESPECTIVE STANDARD DRAWING AND SHALL BE CONSTRUCTED ACCORDINGLY. UNLESS MODIFICATIONS ARE NOTED ON THE PLAN OR COVER SHEET, ANY NUMBER SHOWN BELOW THE STANDARD DRAWING NUMBER INDICATES THE SPECIFIC ALTERNATE TO BE CONSTRUCTED.
- REL RELOCATE EXISTING SIGN, TREE OR OBJECTS, AS SHOWN ON PLANS AND/OR AS DIRECTED BY THE ENGINEER TO PROVIDE REQUIRED CLEARANCE.
- REM REMOVE AND DISPOSE EXISTING IMPROVEMENTS OR OBJECTS IN CONFLICT WITH PROPOSED CONSTRUCTION AND/OR IMPROVEMENTS AS SHOWN ON PLAN AND OR AS DIRECTED BY THE ENGINEER.
- PIP PROTECT IN PLACE (DESCRIPTION PER PLAN).
- ADJ ADJUST EXISTING MANHOLES AND WATER METER BOXES TO GRADE. REPLACE ALL PLASTIC WATER METER BOXES WITH CONCRETE WATER METER BOXES. CONCRETE WATER METER BOXES SHALL BE PROVIDED BY THE CITY AND CONTRACTOR SHALL ARRANGE FOR PICK UP FROM THE CITY CORPORATION YARD LOCATED AT 8095 LINCOLN AVE, CITY OF RIVERSIDE.
- 325 CONSTRUCT PCC SIDEWALK PER CITY STANDARD DWG 325. ADJUST IRRIGATION SYSTEM AS NECESSARY TO PROVIDE ADEQUATE CONNECTIONS AND COVERAGE FOR REMAINING LANDSCAPE AREAS.
- R&R REMOVE AND REPLACE EXISTING IMPROVEMENTS AS INDICATED ON THE PLANS.
- R I TREES TO BE REMOVED BY CITY FORCES. CONTRACTOR SHALL REGRADE SITE AND REPLACE REMOVED TREES WITH 24" BOX TREES. NEW LOCATIONS AND TYPES OF TREES ARE AS SHOWN ON PLAN OR AS DIRECTED BY THE ENGINEER DURING CONSTRUCTION.
- 302 C-1 CONSTRUCT PCC DRIVEWAY APPROACH (CURB-1 TYPE) PER CITY STANDARD DRAWING 302. MATCH-UP LIMITS FOR DRIVEWAYS MAY CHANGE AT THE TIME OF CONSTRUCTION FROM LIMITS NOTED ON PLANS TO ENSURE PROPER TRANSITION BETWEEN PROPOSED AND THE EXISTING IMPROVEMENTS.
- 304 I CONSTRUCT PCC WHEELCHAIR RAMP PER CITY STANDARD DWG 304. TYPE AND LOCATION OF RAMP MAY CHANGE DURING CONSTRUCTION TO FIT SITE CONDITION AS DIRECTED BY THE ENGINEER.
- MOD 304 I REPLACE A RAMP FLAIR (WING) WITH (0"-6") RETAINING CURB TO ACCOMMODATE AN EXISTING FIRE HYDRANT.
- 220 CONSTRUCT PCC CROSS GUTTER PER CITY STANDARD DWG 220.

SPECIFIC NOTES:

- 1 REMOVE AND REPLACE AC PAVEMENT. LIMITS OF AC REMOVAL AND REPLACEMENT ARE SHOWN ON PLANS AND SHALL BE VERIFIED BY THE INSPECTOR AT THE TIME OF CONSTRUCTION. PAVEMENT THICKNESS SHALL BE 6" MINIMUM OR MATCH EXISTING PAVEMENT THICKNESS WHICHEVER IS GREATER.
- 2 REMOVE INTERFERING IMPROVEMENTS AS SHOWN ON PLAN.
- 3 CONSTRUCT PCC RETAINING CURB (H=0"-8"). WHERE RETAINING CURB IS NOT REQUIRED GRADE BACK EXISTING SURFACE BEHIND THE PROPOSED SIDEWALK UP TO 5:1 AND REPLACE THE DISTURBED AREAS OF LAWN WITH SOD. RETAINING CURB SHALL BE CONSTRUCTED MONOLITHIC WITH THE SIDEWALK.
- 4 REMOVE 8" BLOCK WALL AND FOOTING. GRADE AS NECESSARY TO PROVIDE SMOOTH SURFACE.
- 5 REPLACE REMOVED TREE WITH 24" BOX TREE (SEE TREE REPLACEMENT SCHEDULE, PAGE 1 OF 6)

Underground Service Alert
CALL BEFORE YOU DIG
CALL-TOLL FREE
1-800-227-2600
TWO WORKING DAYS BEFORE YOU DIG

ENGINEER IN RESPONSIBLE CHARGE
Muhammad Ibrahim A. Massoud
IBRAHIM A. MASSOUD
R.C.E. No. 64224 expires 6/30/09
DATE 9-3-08

REGISTERED PROFESSIONAL ENGINEER
IBRAHIM A. MASSOUD
No. 64224
Exp. 6-30-2009
CIVIL
STATE OF CALIFORNIA

DESIGNED BY: JUE DRAWN BY: JUE CHECKED BY: ADE
REVISIONS
APPR. DATE

CITY OF RIVERSIDE, CALIFORNIA PUBLIC WORKS DEPARTMENT
APPROVED BY: [Signature]
ENGINEERING MANAGER
PRINCIPAL ENGINEER
STREET SERVICES
SUPERVISOR
TRAFFIC DIVISION
CONST. CONT. ADMIN.
DATE: 9/2/08

SAFE PATHWAY TO SCHOOL
2007-08 CDBG
(A HUD FUNDED PROJECT)
BEEJAY STREET
(BABB AV TO CYPRESS AV)
HORIZ. SCALE: 1" = 40'

ACCT. No.: 9228700611
W.O. 0809581
R-4089
SHEET 3 OF 6
FILE NO.



FOR CONTINUATION, SEE SHT 6 OF 6

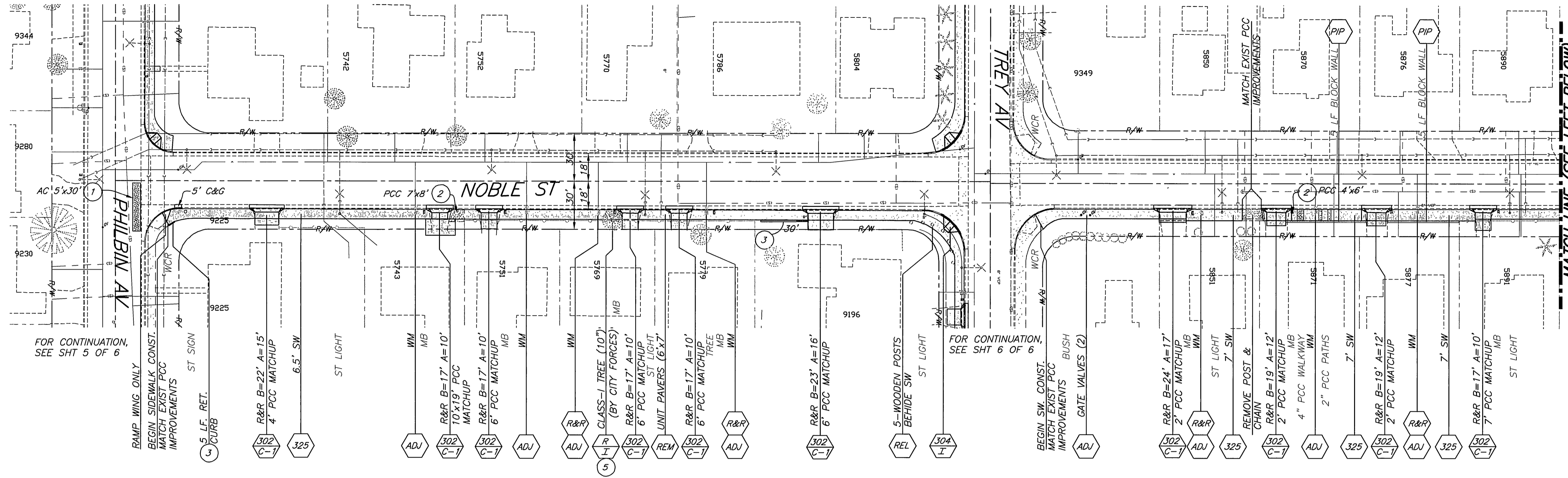

FOR CONTINUATION, SEE SHT 5 OF 6

FOR CONTINUATION, SEE SHT 6 OF 6

MATCH LINE (SEE LEFT BELOW)

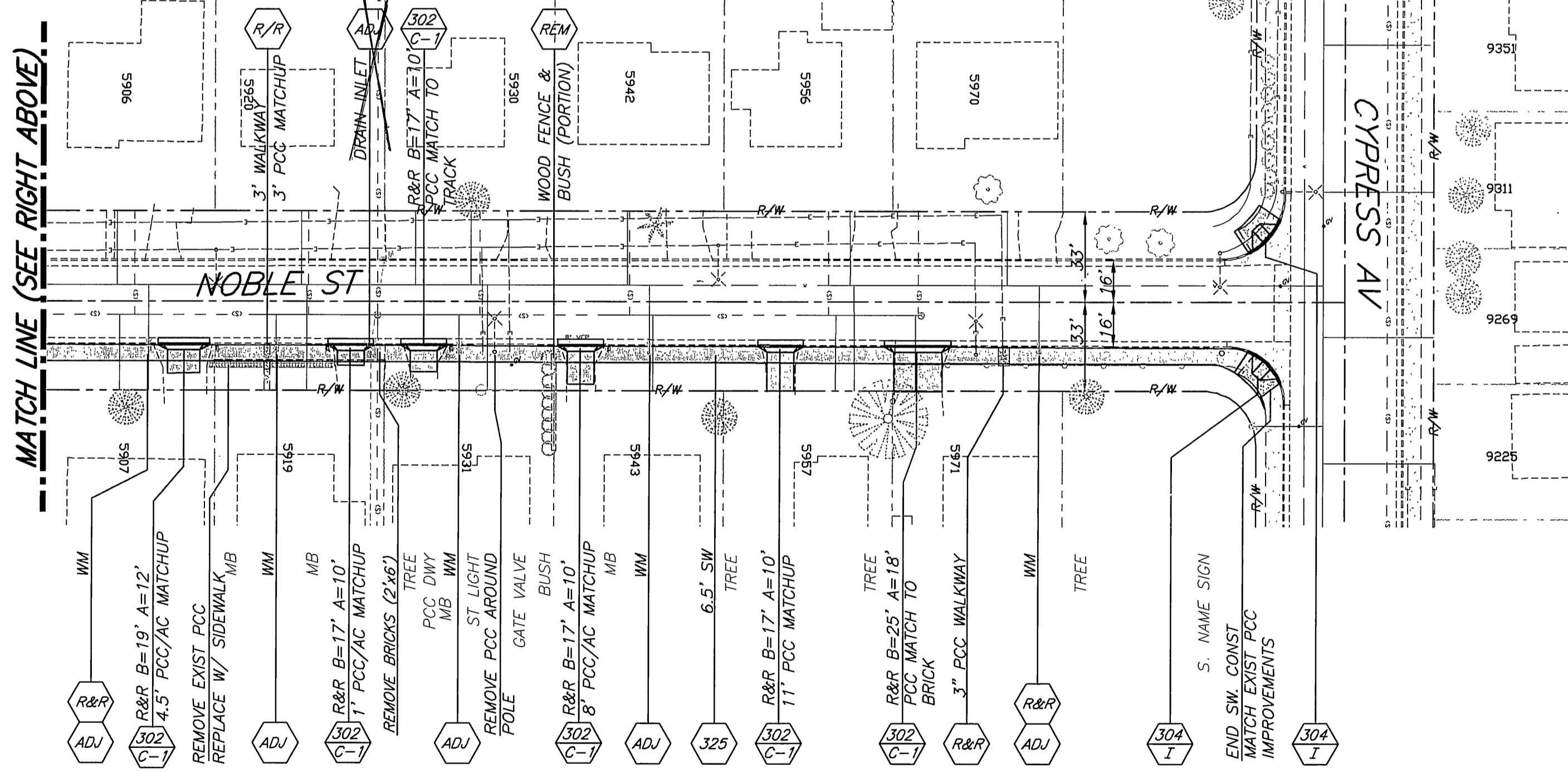

MATCH LINE (SEE RIGHT ABOVE)

CONSTRUCTION NOTES:

- NUMBERS ABOVE 100 IN A HEXAGON ON THE PLAN REFER TO THE RESPECTIVE STANDARD DRAWING AND SHALL BE CONSTRUCTED ACCORDINGLY. UNLESS MODIFICATIONS ARE NOTED ON THE PLAN OR COVER SHEET. ANY NUMBER SHOWN BELOW THE STANDARD DRAWING NUMBER INDICATES THE SPECIFIC ALTERNATE TO BE CONSTRUCTED.
- REL RELOCATE EXISTING SIGN, TREE OR OBJECTS, AS SHOWN ON PLAN AND/OR AS DIRECTED BY THE ENGINEER TO PROVIDE REQUIRED CLEARANCE.
- REM REMOVE AND DISPOSE EXISTING IMPROVEMENTS OR OBJECTS IN CONFLICT WITH PROPOSED CONSTRUCTION AND/OR IMPROVEMENTS AS SHOWN ON PLAN AND/OR AS DIRECTED BY THE ENGINEER.
- PIP PROTECT IN PLACE (DESCRIPTION PER PLAN).
- ADJ ADJUST EXISTING MANHOLES AND WATER METER BOXES TO GRADE. REPLACE ALL PLASTIC WATER METER BOXES WITH CONCRETE WATER METER BOXES. CONCRETE WATER METER BOXES SHALL BE PROVIDED BY THE CITY AND CONTRACTOR SHALL ARRANGE FOR PICK UP FROM THE CITY CORPORATION YARD LOCATED AT 8095 LINCOLN AVE, CITY OF RIVERSIDE.
- 325 CONSTRUCT PCC SIDEWALK PER CITY STANDARD DWG 325. ADJUST IRRIGATION SYSTEM AS NECESSARY TO PROVIDE ADEQUATE CONNECTIONS AND COVERAGE FOR REMAINING LANDSCAPE AREAS.
- R&R REMOVE AND REPLACE EXISTING IMPROVEMENTS AS INDICATED ON THE PLANS.
- R TREES TO BE REMOVED BY CITY FORCES. CONTRACTOR SHALL REGRADE SITE AND REPLACE REMOVED TREES WITH 24" BOX TREES. NEW LOCATIONS AND TYPES OF TREES ARE AS SHOWN ON PLAN OR AS DIRECTED BY THE ENGINEER DURING CONSTRUCTION.
- 302 CONSTRUCT PCC DRIVEWAY APPROACH (CURB-I TYPE) PER CITY STANDARD DRAWING 302. MATCH-UP LIMITS FOR DRIVEWAYS MAY CHANGE AT THE TIME OF CONSTRUCTION FROM LIMITS NOTED ON PLANS TO ENSURE PROPER TRANSITION BETWEEN PROPOSED AND THE EXISTING IMPROVEMENTS.
- 304 CONSTRUCT PCC WHEELCHAIR RAMP PER CITY STANDARD DWG 304. TYPE AND LOCATION OF RAMP MAY CHANGE DURING CONSTRUCTION TO FIT SITE CONDITION AS DIRECTED BY THE ENGINEER.
- MOD 304 REPLACE A RAMP FLAIR (WING) WITH (0"-6") RETAINING CURB TO ACCOMMODATE AN EXISTING FIRE HYDRANT.
- 220 CONSTRUCT PCC CROSS GUTTER PER CITY STANDARD DWG 220.

SPECIFIC NOTES:

- 1 REMOVE AND REPLACE AC PAVEMENT. LIMITS OF AC REMOVAL AND REPLACEMENT ARE SHOWN ON PLANS AND SHALL BE VERIFIED BY THE INSPECTOR AT THE TIME OF CONSTRUCTION. PAVEMENT THICKNESS SHALL BE 6" MINIMUM OR MATCH EXISTING PAVEMENT THICKNESS WHICHEVER IS GREATER.
- 2 REMOVE INTERFERING IMPROVEMENTS AS SHOWN ON PLAN.
- 3 CONSTRUCT PCC RETAINING CURB (H=0"-8"), WHERE RETAINING CURB IS NOT REQUIRED GRADE BACK EXISTING SURFACE BEHIND THE PROPOSED SIDEWALK UP TO 5:1 AND REPLACE THE DISTURBED AREAS OF LAWN WITH SOD. RETAINING CURB SHALL BE CONSTRUCTED MONOLITHIC WITH THE SIDEWALK.
- 4 REMOVE 8" BLOCK WALL AND FOOTING. GRADE AS NECESSARY TO PROVIDE SMOOTH SURFACE.
- 5 REPLACE REMOVED TREE WITH 24" BOX TREE (SEE TREE REPLACEMENT SCHEDULE, PAGE 1 OF 6)

Underground Service Alert
CALL BEFORE YOU DIG
CALL-TOLL FREE
1-800-227-2600
TWO WORKING DAYS BEFORE YOU DIG

ENGINEER IN RESPONSIBLE CHARGE
Ibrahim A. Massoud
IBRAHIM A. MASSOUD
R.C.E. No. 64224 expires 6/30/09
DATE **9-3-08**

REGISTERED PROFESSIONAL ENGINEER
IBRAHIM A. MASSOUD
No. 64224
Exp. 6-30-2009
CIVIL
STATE OF CALIFORNIA

MARK	REVISIONS	APPR	DATE

DESIGNED BY: JUE DRAWN BY: JUE CHECKED BY: ADE

**CITY OF RIVERSIDE, CALIFORNIA
PUBLIC WORKS DEPARTMENT**

APPROVED BY: [Signature] DATE: 9/3/08
ENGINEERING MANAGER
PRINCIPAL ENGINEER
STREET SERVICES
SURVEYOR
TRAFFIC DIVISION
CONST. CONT. ADMIN.

**SAFE PATHWAY TO SCHOOL
2007-08 CDBG
(A HUD FUNDED PROJECT)
NOBLE STEET
(PHILBIN AV TO CYPRESS AV)**

HORIZ. SCALE: 1" = 40'

ACCT. NO.: 9228700611
W.O. 0809581
R-4089
SHEET **4** OF **6**
FILE NO.

C:\COMPLAN\DESIGN PROJECTS\07-020-0200 2007-08 L.DESIGN PLANS\1704\SPRINT\0402-SHEETS\SH6 2-6.DWG

CONSTRUCTION NOTES:

- NUMBERS ABOVE 100 IN A HEXAGON ON THE PLAN REFER TO THE RESPECTIVE STANDARD DRAWING AND SHALL BE CONSTRUCTED ACCORDINGLY. UNLESS MODIFICATIONS ARE NOTED ON THE PLAN OR COVER SHEET. ANY NUMBER SHOWN BELOW THE STANDARD DRAWING NUMBER INDICATES THE SPECIFIC ALTERNATE TO BE CONSTRUCTED.
- REL RELOCATE EXISTING SIGN, TREE OR OBJECTS, AS SHOWN ON PLANS AND/OR AS DIRECTED BY THE ENGINEER TO PROVIDE REQUIRED CLEARANCE.
- REM REMOVE AND DISPOSE EXISTING IMPROVEMENTS OR OBJECTS IN CONFLICT WITH PROPOSED CONSTRUCTION AND/OR IMPROVEMENTS AS SHOWN ON PLAN AND OR AS DIRECTED BY THE ENGINEER.
- PIP PROTECT IN PLACE (DESCRIPTION PER PLAN).
- ADJ ADJUST EXISTING MANHOLES AND WATER METER BOXES TO GRADE. REPLACE ALL PLASTIC WATER METER BOXES WITH CONCRETE WATER METER BOXES. CONCRETE WATER METER BOXES SHALL BE PROVIDED BY THE CITY AND CONTRACTOR SHALL ARRANGE FOR PICK UP FROM THE CITY CORPORATION YARD LOCATED AT 8095 LINCOLN AVE, CITY OF RIVERSIDE.
- 325 CONSTRUCT PCC SIDEWALK PER CITY STANDARD DWG 325. ADJUST IRRIGATION SYSTEM AS NECESSARY TO PROVIDE ADEQUATE CONNECTIONS AND COVERAGE FOR REMAINING LANDSCAPE AREAS.
- R&R REMOVE AND REPLACE EXISTING IMPROVEMENTS AS INDICATED ON THE PLANS.
- R/T TREES TO BE REMOVED BY CITY FORCES. CONTRACTOR SHALL REGRADE SITE AND REPLACE REMOVED TREES WITH 24" BOX TREES. NEW LOCATIONS AND TYPES OF TREES ARE AS SHOWN ON PLAN OR AS DIRECTED BY THE ENGINEER DURING CONSTRUCTION.
- 302-C-1 CONSTRUCT PCC DRIVEWAY APPROACH (CURB-I TYPE) PER CITY STANDARD DRAWING 302. MATCH-UP LIMITS FOR DRIVEWAYS MAY CHANGE AT THE TIME OF CONSTRUCTION FROM LIMITS NOTED ON PLANS TO ENSURE PROPER TRANSITION BETWEEN PROPOSED AND THE EXISTING IMPROVEMENTS.
- 304-I CONSTRUCT PCC WHEELCHAIR RAMP PER CITY STANDARD DWG 304. TYPE AND LOCATION OF RAMP MAY CHANGE DURING CONSTRUCTION TO FIT SITE CONDITION AS DIRECTED BY THE ENGINEER.
- MOD 304-I REPLACE A RAMP FLAIR (WING) WITH (0"-6") RETAINING CURB TO ACCOMMODATE AN EXISTING FIRE HYDRANT.
- 220 CONSTRUCT PCC CROSS GUTTER PER CITY STANDARD DWG 220.

SPECIFIC NOTES:

- 1 REMOVE AND REPLACE AC PAVEMENT. LIMITS OF AC REMOVAL AND REPLACEMENT ARE SHOWN ON PLANS AND SHALL BE VERIFIED BY THE INSPECTOR AT THE TIME OF CONSTRUCTION. PAVEMENT THICKNESS SHALL BE 6" MINIMUM OR MATCH EXISTING PAVEMENT THICKNESS WHICHEVER IS GREATER.
- 2 REMOVE INTERFERING IMPROVEMENTS AS SHOWN ON PLAN.
- 3 CONSTRUCT PCC RETAINING CURB (H=0"-8") WHERE RETAINING CURB IS NOT REQUIRED GRADE BACK EXISTING SURFACE BEHIND THE PROPOSED SIDEWALK UP TO 5:1 AND REPLACE THE DISTURBED AREAS OF LAWN WITH SOD. RETAINING CURB SHALL BE CONSTRUCTED MONOLITHIC WITH THE SIDEWALK.
- 4 REMOVE 8" BLOCK WALL AND FOOTING. GRADE AS NECESSARY TO PROVIDE SMOOTH SURFACE.
- 5 REPLACE REMOVED TREE WITH 24" BOX TREE (SEE TREE REPLACEMENT SCHEDULE, PAGE 1 OF 6)

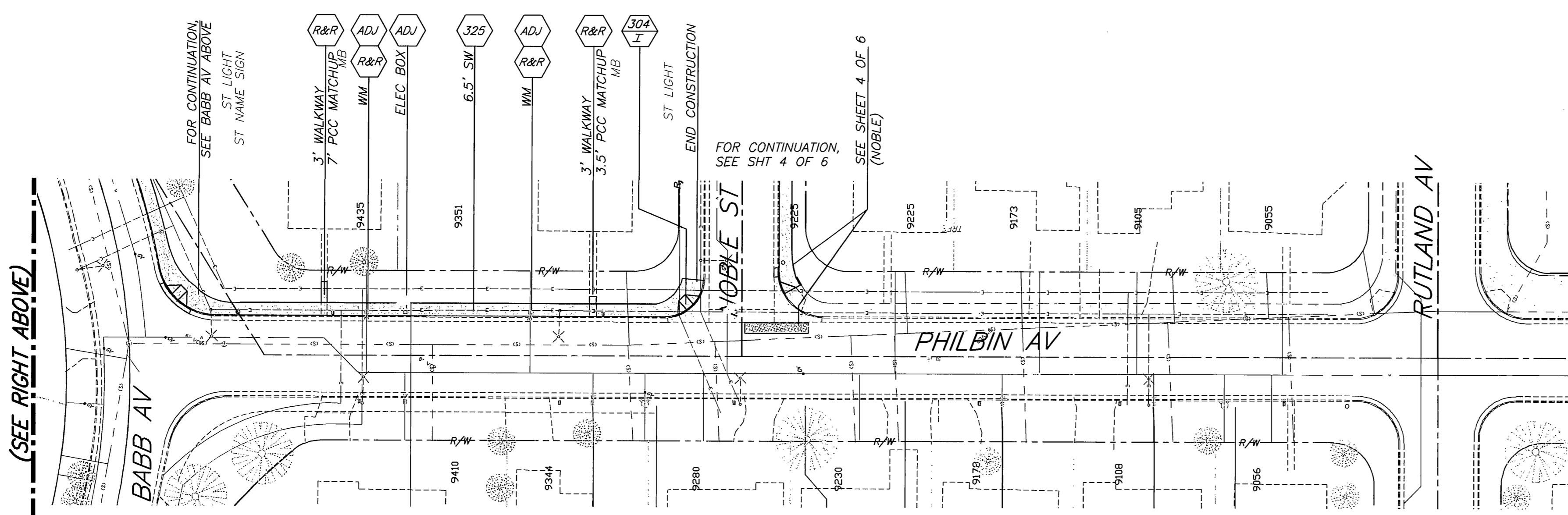
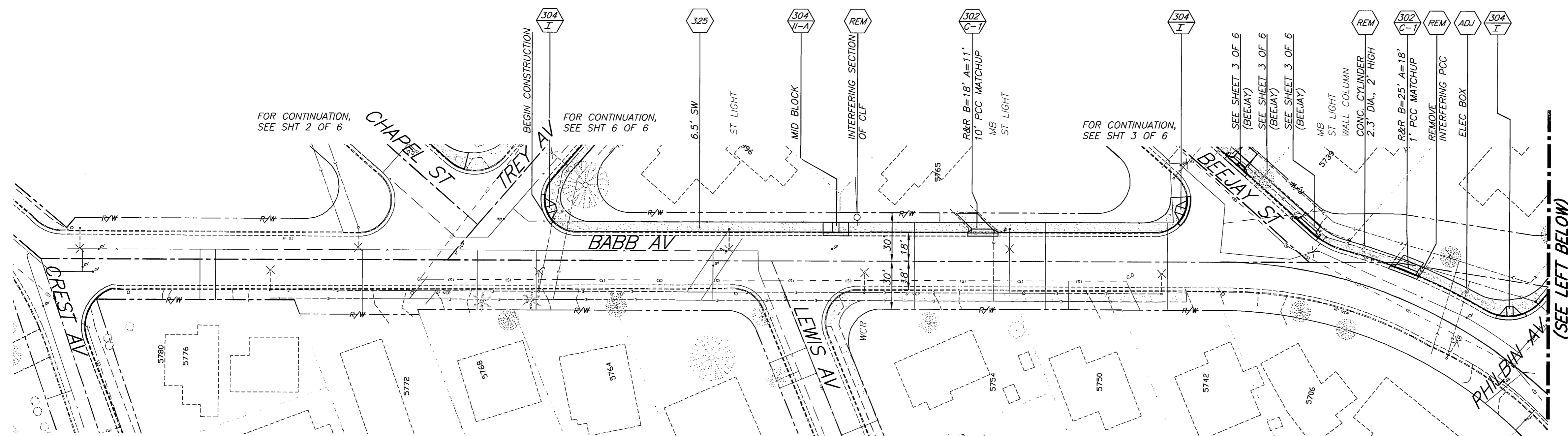

Underground Service Alert
 CALL BEFORE YOU DIG
 CALL-TOLL FREE
 1-800-227-2600
 TWO WORKING DAYS BEFORE YOU DIG

ENGINEER IN RESPONSIBLE CHARGE
 Ibrahim A. Massoud
 No. 64224
 Exp. 6-30-2009
 CIVIL
 STATE OF CALIFORNIA
 DATE: 9/3/08

MARK	REVISIONS	APPR.	DATE

**CITY OF RIVERSIDE, CALIFORNIA
 PUBLIC WORKS DEPARTMENT**

APPROVED BY	BY	DATE	APPROVED BY
ENGINEERING MANAGER	[Signature]	9/1/08	[Signature]
PRINCIPAL ENGINEER	[Signature]	9/1/08	CITY ENGINEER
STREET SERVICES	[Signature]	9/1/08	
SUPERVISOR			
TRAFFIC DIVISION			
CONST. CONT. ADMIN.			

DESIGNED BY: JUE DRAWN BY: JUE CHECKED BY: ADE DATE: 9/8/08

**SAFE PATHWAY TO SCHOOL
 2007-08 CDBG
 (A HUD FUNDED PROJECT)
 BABB & PHILBIN AV
 (CREST AV TO NOBLE ST)**

ACCT. NO.: 9228700611
 W.O 0809581
R-4089
 SHEET 5 OF 6
 FILE NO.

G:\COMMON\DESIGN PROJECTS\07-080-CDBG-2007-08\DESIGN PLANS\TRANSPORTATION\CADD_SHEETS\Shts 2-4.DWG



CONSTRUCTION NOTES:

- NUMBERS ABOVE 100 IN A HEXAGON ON THE PLAN REFER TO THE RESPECTIVE STANDARD DRAWING AND SHALL BE CONSTRUCTED ACCORDINGLY. UNLESS MODIFICATIONS ARE NOTED ON THE PLAN OR COVER SHEET, ANY NUMBER SHOWN BELOW THE STANDARD DRAWING NUMBER INDICATES THE SPECIFIC ALTERNATE TO BE CONSTRUCTED.
- RELOCATE EXISTING SIGN, TREE OR OBJECTS, AS SHOWN ON PLANS AND/OR AS DIRECTED BY THE ENGINEER TO PROVIDE REQUIRED CLEARANCE.
- REMOVE AND DISPOSE EXISTING IMPROVEMENTS OR OBJECTS IN CONFLICT WITH PROPOSED CONSTRUCTION AND/OR IMPROVEMENTS AS SHOWN ON PLAN AND OR AS DIRECTED BY THE ENGINEER.
- PROTECT IN PLACE (DESCRIPTION PER PLAN).
- ADJUST EXISTING MANHOLES AND WATER METER BOXES TO GRADE. REPLACE ALL PLASTIC WATER METER BOXES WITH CONCRETE WATER METER BOXES. CONCRETE WATER METER BOXES SHALL BE PROVIDED BY THE CITY AND CONTRACTOR SHALL ARRANGE FOR PICK UP FROM THE CITY CORPORATION YARD LOCATED AT 8095 LINCOLN AVE, CITY OF RIVERSIDE.
- CONSTRUCT PCC SIDEWALK PER CITY STANDARD DWG 325. ADJUST IRRIGATION SYSTEM AS NECESSARY TO PROVIDE ADEQUATE CONNECTIONS AND COVERAGE FOR REMAINING LANDSCAPE AREAS.
- REMOVE AND REPLACE EXISTING IMPROVEMENTS AS INDICATED ON THE PLANS.
- TREES TO BE REMOVED BY CITY FORCES. CONTRACTOR SHALL REGRADE SITE AND REPLACE REMOVED TREES WITH 24" BOX TREES. NEW LOCATIONS AND TYPES OF TREES ARE AS SHOWN ON PLAN OR AS DIRECTED BY THE ENGINEER DURING CONSTRUCTION.
- CONSTRUCT PCC DRIVEWAY APPROACH (CURB-I TYPE) PER CITY STANDARD DRAWING 302. MATCH-UP LIMITS FOR DRIVEWAYS MAY CHANGE AT THE TIME OF CONSTRUCTION FROM LIMITS NOTED ON PLANS TO ENSURE PROPER TRANSITION BETWEEN PROPOSED AND THE EXISTING IMPROVEMENTS.
- CONSTRUCT PCC WHEELCHAIR RAMP PER CITY STANDARD DWG 304. TYPE AND LOCATION OF RAMP MAY CHANGE DURING CONSTRUCTION TO FIT SITE CONDITION AS DIRECTED BY THE ENGINEER.
- REPLACE A RAMP FLAIR (WING) WITH (0"-6") RETAINING CURB TO ACCOMMODATE AN EXISTING FIRE HYDRANT.
- CONSTRUCT PCC CROSS GUTTER PER CITY STANDARD DWG 220.

SPECIFIC NOTES:

- 1 REMOVE AND REPLACE AC PAVEMENT. LIMITS OF AC REMOVAL AND REPLACEMENT ARE SHOWN ON PLANS AND SHALL BE VERIFIED BY THE INSPECTOR AT THE TIME OF CONSTRUCTION. PAVEMENT THICKNESS SHALL BE 6" MINIMUM OR MATCH EXISTING PAVEMENT THICKNESS WHICHEVER IS GREATER.
- 2 REMOVE INTERFERING IMPROVEMENTS AS SHOWN ON PLAN.
- 3 CONSTRUCT PCC RETAINING CURB (H=0"-8"), WHERE RETAINING CURB IS NOT REQUIRED GRADE BACK EXISTING SURFACE BEHIND THE PROPOSED SIDEWALK UP TO 5:1 AND REPLACE THE DISTURBED AREAS OF LAWN WITH SOD. RETAINING CURB SHALL BE CONSTRUCTED MONOLITHIC WITH THE SIDEWALK.
- 4 REMOVE 8" BLOCK WALL AND FOOTING. GRADE AS NECESSARY TO PROVIDE SMOOTH SURFACE.
- 5 REPLACE REMOVED TREE WITH 24" BOX TREE (SEE TREE REPLACEMENT SCHEDULE, PAGE 1 OF 6)

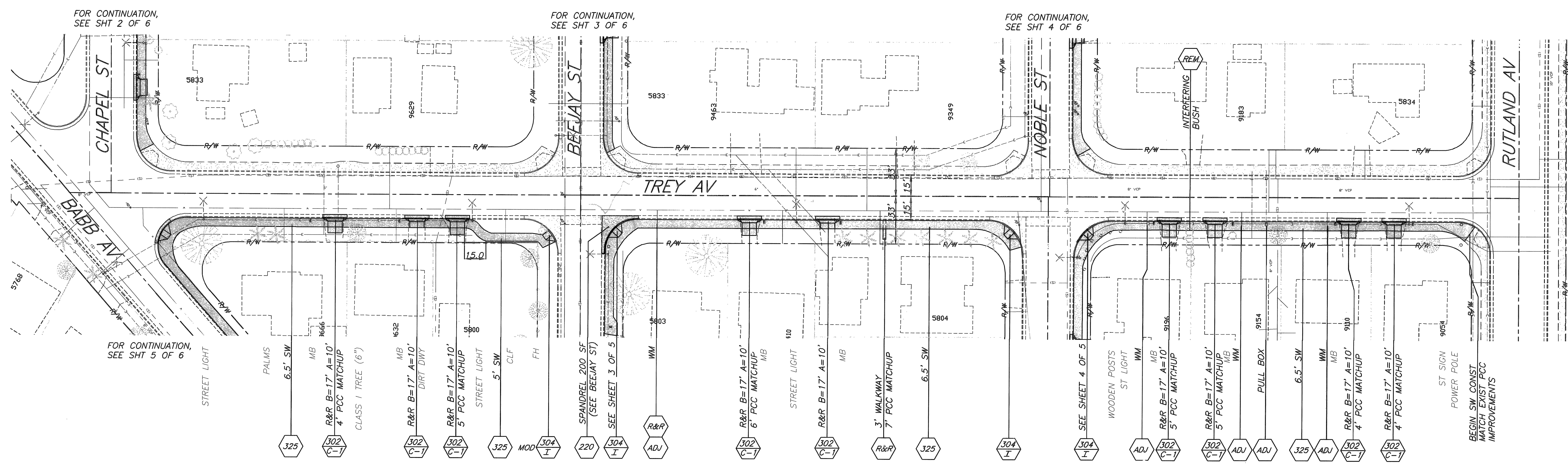

 Underground Service Alert CALL BEFORE YOU DIG CALL-TOLL FREE 1-800-227-2600 TWO WORKING DAYS BEFORE YOU DIG	 ENGINEER IN RESPONSIBLE CHARGE <i>Ibrahim A. Massoud</i> IBRAHIM A. MASSOUD R.C.E. No. 64224 expires 6/30/09 DATE <u>9-2-09</u>	 REGISTERED PROFESSIONAL ENGINEER IBRAHIM A. MASSOUD No. 64224 Exp. 6-30-2009 CIVIL STATE OF CALIFORNIA	CITY OF RIVERSIDE, CALIFORNIA PUBLIC WORKS DEPARTMENT APPROVED BY: <i>[Signature]</i> DATE: <u>9/8/08</u> ENGINEERING MANAGER PRINCIPAL ENGINEER STREET SERVICES SURVEYOR TRAFFIC DIVISION CONST. CONT. ADMIN.	SAFE PATHWAY TO SCHOOL 2007-08 CDBG (A HUD FUNDED PROJECT) TREY AVENUE (BABB AV TO RUTLAND AV) ACCT. NO.: 9228700611 W.O. 0809581 R-4089 SHEET <u>6</u> OF <u>6</u> FILE NO.
DESIGNED BY: <u>JUE</u> DRAWN BY: <u>JUE</u> CHECKED BY: <u>ADP</u>				HORIZ. SCALE: 1" = 40' DATE: <u>9/8/08</u>

G:\COMMON\DESIGN\PROJECTS\07-020-CDBG-2007-08\DESIGN PLANS\TRANSPORTATION\CADD\SHEETS\SHS 2-6.DWG