

# RIVERSIDE CALIFORNIA

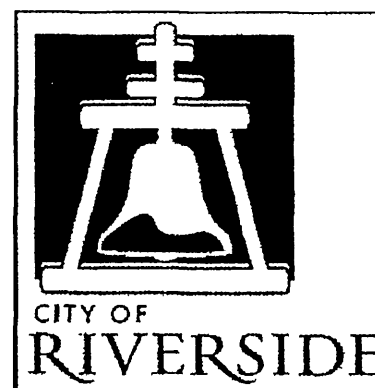

## PUBLIC WORKS DEPARTMENT 2008-09 MINOR STREETS REHABILITATION AT VARIOUS LOCATIONS

### GENERAL NOTES:

- PRIME CONTRACTOR BIDDING THIS PROJECT SHALL HAVE A CLASS "A" OR CLASS "C-12" LICENSE.
- CONSTRUCTION SHALL BE IN ACCORDANCE WITH THE CITY OF RIVERSIDE DEPARTMENT OF PUBLIC WORKS, STANDARD DRAWINGS AND THE "STANDARD SPECIFICATIONS FOR PUBLIC WORKS CONSTRUCTION", 2006 EDITION.
- THE CONTRACTOR IS REQUIRED TO TAKE DUE PRECAUTIONARY MEASURES TO LOCATE AND PROTECT ALL UTILITIES WITHIN THE CONSTRUCTION WORK AREAS. MH'S & WATER VALVES SHALL BE "TIED OUT" PRIOR TO PAVEMENT OVERLAY WORK FOR SUBSEQUENT ADJUSTMENT WORK.
- ANY TEMPORARY TRAFFIC CONTROL STRIPING OBLITERATED AND/OR BADLY WORN DURING CONSTRUCTION SHALL BE RESTORED BY THE CONTRACTOR WITHIN ONE DAY AFTER NOTIFICATION FROM THE CITY INSPECTOR.
- IN PAVEMENT OVERLAY AREAS, ANY DISTRESSED EXISTING PAVEMENT SHALL BE REMOVED AND REPLACED AS DIRECTED BY THE INSPECTOR AFTER COLD-MILLING AND PRIOR TO OVERLAYING WITH ARHM-GG PAVING.
- WHERE NEW PAVEMENT IS TO JOIN THE EXISTING PAVEMENT, THE EDGE OF THE EXISTING PAVEMENT SHALL BE TRIMMED IN A SMOOTH AND STRAIGHT LINE. CONSTRUCT MATCH-UP PAVING AS DIRECTED IN THE FIELD TO PRODUCE A SMOOTH SECTION.
- STREET IMPROVEMENT WORK THAT WILL CAUSE DAMAGE TO THE DETECTOR LOOP'S SHALL NOT BE PERFORMED UNTIL TRAFFIC SIGNAL MAINTENANCE PERSONNEL HAVE BEEN NOTIFIED AND THE NECESSARY TIMING ADJUSTMENTS ARE MADE TO MAINTAIN SIGNAL OPERATION.
- THE CONTRACTOR IS RESPONSIBLE FOR THE FINAL STRIPING AND PAVEMENT MARKING. STRIPING AND PAVING WORK SHALL BE COMPLETED PER PLANS, CITY STANDARDS AND SPECIAL PROVISIONS.
- SURVEY STAKING REQUESTS AND GRADE SHEETS ARE REQUIRED FOR THE REPLACEMENT OF ALL CURBS AND/OR GUTTER OVER 50' IN LENGTH. SURVEY REQUESTS SHALL BE SUBMITTED AFTER THE EXISTING IMPROVEMENTS HAVE BEEN REMOVED. CONTRACTOR SHALL ALLOW 4 WORKING DAYS AFTER REQUESTING SURVEY TO SCHEDULE SURVEY AND PROCESS GRADE SHEETS. CONTRACTOR SHALL PROVIDE TRAFFIC CONTROL FOR ALL REQUIRED CONSTRUCTION SURVEY WORK BY CITY PERSONNEL. NO STAKING WILL BE REQUIRED FOR SIDEWALK, DWY APPROACHES AND WHEELCHAIR RAMP CONSTRUCTION.
- CONTRACTOR MAY USE SINGLE/DOUBLE ADJUSTMENT OR RAMP-UP OPTIONS FOR MANHOLES AND VALVE COVERS WITHIN THE COLD MILLING AND/OR PAVEMENT REPLACEMENT LIMITS. RAMP-UP OPTION SHALL HAVE SMOOTH FINISH AND SAFE TRANSITION AROUND THE CIRCUMFERENCE OF THE STRUCTURE. RAMP-UP WORK SHALL BE ACCEPTED BY THE INSPECTOR BEFORE ROAD IS OPENED TO TRAFFIC. PAVING MATERIALS USED FOR RAMP-UP SHALL BE REMOVED COMPLETELY BEFORE OVERLAY/PAVING OPERATION TAKES PLACE.
- THE INSPECTOR MAY DIRECT COLD-MILLING AND PAVING INTO SIDE STREETS TO IMPROVE THE RIDE QUALITY AND OTHER STREET CONDITIONS.
- WATER VALVES AND FIRE HYDRANTS MUST BE LOCATED DURING CONSTRUCTION TO MAKE VALVE BOX AND COVER ADJUSTMENTS AND FIRE HYDRANT BLUE MARKER INSTALLATIONS. THE VALVE BOXES MUST BE "TIED OUT" AS PART OF THE CONTRACTOR'S WORK.
- PAVEMENT PREPARATION SHALL CONSIST OF REMOVAL AND REPLACEMENT (R&R) OF DETERIORATED PAVEMENT AREAS AS MARKED IN THE FIELD AND DIRECTED BY THE INSPECTOR AT THE TIME OF CONSTRUCTION. QUANTITIES SHOWN ARE APPROXIMATE AND BASED UPON ALL PREMARKED REMOVAL AND REPLACEMENT SECTIONS BEING A MINIMUM OF 6" IN DEPTH FOR MINOR STREETS, 10" FOR MULBERRY ST AND GRAND AVE. STREETS DESIGNATED FOR COLD MILLING AND PAVEMENT REMOVAL AND REPLACEMENT SHALL BE DONE AFTER COLD MILLING IS COMPLETED.
- THE SEAM BETWEEN PASSES OF THE AC OVERLAY SHALL COINCIDE, AS CLOSE AS POSSIBLE, TO THE LANE LINES.
- COLD MILLING TYPE I AND TYPE II SHALL BE AS DIRECTED BY THE ENGINEER AND AS DESCRIBED IN SPECIAL PROVISIONS.
- THIS PROJECT HAS APPROXIMATELY 98 NEW AND RECONSTRUCTED WHEELCHAIR RAMPS. MOST RAMPS REQUIRE THE REMOVAL AND REPLACEMENT OF APPROXIMATELY 100 TO 150 SF OF RAMP AREA, 50 TO 100 SF OF SIDEWALK, 30 LF OF CURB AND GUTTER, 30 LF OF NEW RETAINING CURB. SOME RAMPS MAY REQUIRE APPROXIMATELY 200 SF OF ASPHALT CONCRETE PAVEMENT REMOVAL AND REPLACEMENT FOR CROSS-FALL. THESE QUANTITIES ARE APPROXIMATE AND MAY CHANGE ACCORDING TO EACH RAMP TYPE AND SITE CONDITIONS. RAMPS SHALL BE CONSTRUCTED PER CITY STANDARDS, ADA REQUIREMENTS AND AS DIRECTED BY THE ENGINEER. AREAS FOR REMOVAL SHALL BE MARKED BY THE CONTRACTOR AND ACCEPTED BY THE CITY ENGINEER AT THE TIME OF CONSTRUCTION. FOR LIST OF RAMP LOCATIONS AND TYPES, SEE SPECIAL PROVISIONS.

### CONSTRUCTION NOTES:

NUMBERS ABOVE 100 IN A HEXAGON ON THE PLAN REFER TO THE RESPECTIVE STANDARD DRAWING AND SHALL BE CONSTRUCTED ACCORDINGLY. UNLESS INDICATED OTHERWISE ARE NOTED ON THE PLAN OR COVER SHEET. ANY NUMBER SHOWN BELOW THE STANDARD DRAWING NUMBER INDICATES THE SPECIFIC ALTERNATE TO BE CONSTRUCTED.

### SPECIFIC NOTES:

- CONTRACTOR SHALL REPLACE EXISTING STRIPING AND MARKINGS AFTER OVERLAY TO THE ORIGINAL CONFIGURATIONS, UNLESS THERE IS A SIGNING & STRIPING PLAN, IN ACCORDANCE WITH SPECIAL PROVISIONS.
- OVERLAY ENTIRE ROAD WIDTH OF ALL MINOR STREETS WITH 0.10' OF ASPHALT RUBBER HOT MIX GAP GRADED AND 0.20' FOR MULBERRY ST AND GRAND AVE. (ENTIRE SECTION OF MULBERRY ST AND GRAND AVE SHALL BE COLD-MILLED FOR A DEPTH OF 0.15' PRIOR TO OVERLAYING AND PRIOR TO REMOVAL & REPLACEMENT OF DAMAGED A.C. PAVEMENT).
- FOR PROPERTIES WITH AC DRIVEWAY APPROACH, AC PAVEMENT OVERLAY SHALL BE EXTENDED TO MATCH EXISTING DRIVEWAYS OR TO PROPERTY LINE WITHOUT ADVERSE IMPACT TO THE EXISTING FLOWLINE.
- IF COLD-MILLING IS NOT POSSIBLE AT AREAS ADJACENT TO AN AC BERM, THE BERM'S HEIGHT SHALL BE RAISED AFTER OVERLAY TO MAINTAIN ITS ORIGINAL HEIGHT AND RUNOFF FLOW ALONG THE BERM.
- ADEQUATE FLOW LINES SHALL BE MAINTAINED AT ALL LOCATIONS.
- FOR WHEELCHAIR RAMPS AT LOCATIONS WHERE SIDEWALK IS LESS THAN 6 FEET WIDE, CONTRACTOR SHALL INSTALL THE SPECIFIED CITY STANDARD WHEELCHAIR RAMP AND TRANSITION THE ASSOCIATED SIDEWALK TO MATCH EXISTING.
- LOCATIONS FOR DIGOUTS SHALL BE MARKED ON SITE AT THE TIME OF CONSTRUCTION AND AFTER COLD-MILLING OPERATIONS HAVE BEEN COMPLETED, WHERE REQUIRED. UNLESS SPECIFIED ON PLANS, AC DEPTH FOR REMOVAL AND REPLACEMENT AREAS SHALL BE A MINIMUM OF 6" FOR ALL MINOR STREETS, 10" FOR MULBERRY ST AND 8" FOR GRAND AVE, OR MATCH EXISTING STRUCTURAL SECTION, WHICHEVER IS GREATER.
- AT THE EXISTING WHEELCHAIR RAMPS WHETHER OR NOT REQUIRE ALTERATION, THE CROSS SLOPE OF THE PAVEMENT ADJACENT TO THE RAMP SHALL NOT EXCEED 5% FOR ANY RAMP. WHERE SUCH PAVEMENT CROSS-SLOPE EXCEEDS 5%, CONTRACTOR SHALL COLD-MILL THE EXISTING PAVEMENT TO A DEPTH OF AN ADDITIONAL 0.10' BELOW THE GUTTER LIP TO A DISTANCE OF 7' RADIALLY TO SATISFY THE REQUIRED 5% SLOPE AND PROVIDE SMOOTH TRANSITION TO PAVEMENT IN THE DRIVING LANES.
- DURING THE CONSTRUCTION WORK, ALL SEWER, STORM DRAIN & UTILITY MANHOLES AND WATER GATE VALVES SHALL BE RAMPED UP OR DOUBLE ADJUSTED TO FACILITATE THE COLD-MILLING AND PAVING OPERATIONS. FOLLOWING THE CONSTRUCTION OF A.R.H.M.-GG AC FINAL FINISH SURFACE, ALL MANHOLES AND GATE VALVE COVERS SHALL BE ADJUSTED TO GRADE AS NEEDED.

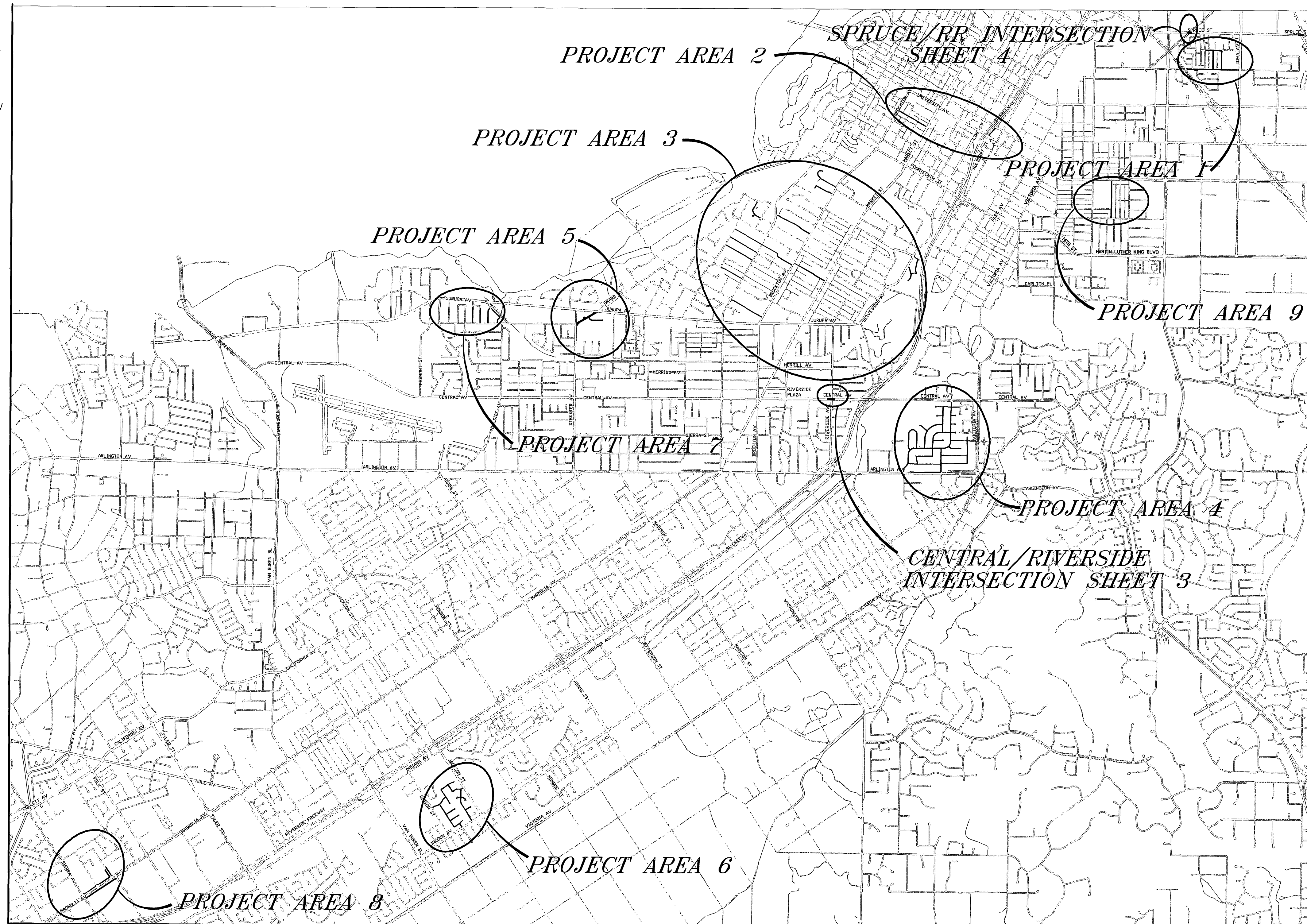

### SHEET INDEX:

SHEET NO.	DESCRIPTION
1	TITLE SHEET
2	AREA 1 TO AREA 6
3	AREA 8 / MAGNOLIA AVE AT LA SIERRA AVE
4	AREA 7
5	CENTRAL AVE / RIVERSIDE AVE INTERSECTION
6	SPRUCE ST / U.P.R.R. CROSSING

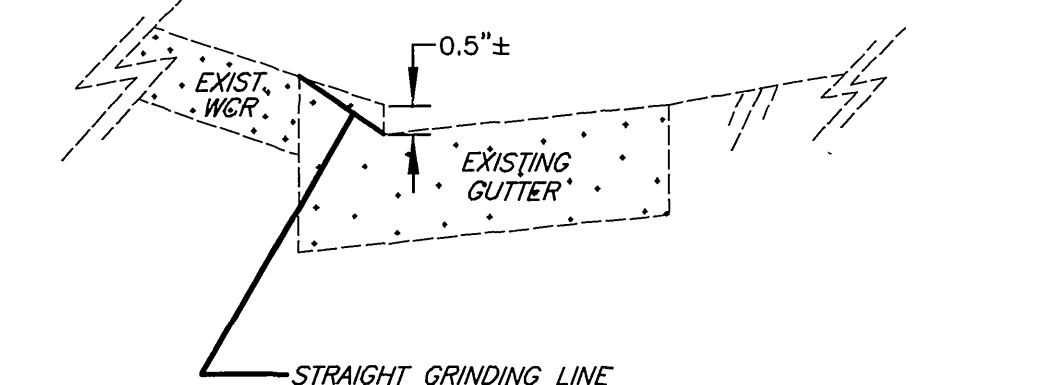

WCR CURB FACE GRINDING DETAIL (NTS)

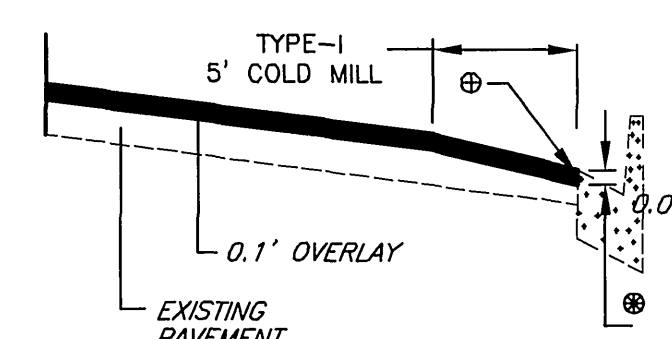

PAVING & COLD MILLING DETAIL

N.T.S.

Ⓢ COLD MILLING DEPTH AT GUTTER LIP MAY BE DECREASED WHERE MACADAM BASE IS ENCOUNTERED.

Ⓢ ASPHALT RUBBER HOT MIX SHALL BE ROLLED TO WITHIN + 1/4" TO FLUSH WITH THE GUTTER LIP.

### LOCATION MAP

<p>Underground Service Alert CALL BEFORE YOU DIG CALL-TOLL FREE 1-800-227-2600 TWO WORKING DAYS BEFORE YOU DIG</p>	<p>ENGINEER IN RESPONSIBLE CHARGE <i>Ibrahim A. Massoud</i> IBRAHIM A. MASSOUD R.C.E. No. 04224 expires 6/30/09 DATE: 4/20/09</p>	<p>REGISTERED PROFESSIONAL ENGINEER IBRAHIM A. MASSOUD No. 04224 Exp. 6-30-2009 CIVIL STATE OF CALIFORNIA</p>	<p>CITY OF RIVERSIDE, CALIFORNIA PUBLIC WORKS DEPARTMENT</p>		<p>2008-09 MINOR STREETS REHABILITATION AT VARIOUS LOCATIONS</p>	<p>ACCT. NO.: 9586927 R-4121 SHEET 1 OF 6 FILE NO.</p>
			<p>DESIGNED BY: AE DRAWN BY: AE CHECKED BY: ADE</p>	<p>APPROVED BY: [Signature] ENGINEERING MANAGER STREET SERVICES SURVEYOR CONSTRUCTION ADMIN.</p>		

C:\CZM\DWG\Design\_Plans\TRANSPORTATION\CAD\_SHEETS\Cover\_Sheet.DWG

**QUANTITIES TABLE**

#	STREET NAME	STREET LIMIT	STREET LIMIT	STREET LENGTH (LF)	STREET WIDTH (LF)	AC REMOVAL (TON)	AC REPLACE (TON)	R&R UNY APP	SPEED HUMP REMOVAL (EA)	AC OVERLAY (TON)	WCR (GA)	R&R CURB & GUTTER (LF)	R&R SIDEWALK (SF)	LOOPS (EA)	W-GUTTER (SF)	POLYMER CONCRETE TYPE 1 5' WIDE	POLYMER CONCRETE TYPE 2 10' WIDE	ADJ. SEWER & S.D. (EA)	VALVES	COLD MILLING TYPE II	New Sidewalk (S.F.)	COMMENTS	
1	Alta Vista Dr	Brookton Av	End	1,100	32	2,800	84	450		264	4	35	1,100			2,200	32	5	1				
2	Homewood Ct	Brookton Av	End	770	32	8,000	240	700		185	4	10	130			1,540	32	3	1				
3	Beechwood Pl	Palm Av	Brookton Av	1,370	32	7,500	225	350		329	4	490	1,180			2,740	32	6	2				
4	Linwood Pl	Palm Av	Brookton Av	2,500	36	38,000	1,140			675						5,000	36	2	4				
5	Linwood Pl	Magnolia Av	Brookton Av	1,260	36	25,000	250	1600		340	1	115	40			2,520	36	0	2				
6	Oakwood Pl	Tower Rd	Palm Av	1,100	28	13,500	405			231		130				2,200	28	4	2				
7	Rosewood Pl	Tower Rd	Palm Av	1,100	32	11,500	345	400		264	3	80	200			2,200	32	4	2				
8	Brentwood Pl	Palm Av	Edgewood Pl	870	33	2,900	87			215		200				1,740	33	4	3				
9	Rubidoux Av	Brookton Av	Palm Av	1,150	34	3,900	117	1,200		293	4	80	240				34	2	3				
10	Boxwood Pl	Olivewood Av	End	550	36	9,000	270	100		149	2	50	775				3	5					
11	Brooks St	Olivewood Av	Boxwood Pl	880	34	450	14	300		224	3		2,000					4	8				
12	Nopal Pl	Hoya Pl	End	500	33	1,200	36			124		30				1,000		4	2				
13	Saguaro Rd	Nopal Pl	Jackson St	690	36	1,400	42	95		186	4		60			1,380		4	4				
14	Joshua Tree Rd	Saguaro Rd	Lincoln Av	1,200	34	3,600	108			306	7	30				2,400	34	5	5				
15	Caral Tree Ln	End	End	400	36	500	15			108	4		60			800		2	1				
16	Hoya Pl	Nopal Pl	End	580	35	450	14	95		152		10				1,160		2	2				
17	Aralia Dr	Gibson St	Hoya Pl	620	36	500	15	95		167	6	10	300			1,240	36	1	7				
18	Mesquite Dr	Aralia Dr	Agave Pl	950	34	1,000	30			242	3	10	320					4	4				
19	Flax Pl	Mesquite Dr	End	360	38	200	6	95		103	3		740			720		1	0				
20	Tamarisk Pl	Mesquite Dr	End	360	38	1,700	51			103	3		400			720		1	0				
21	Agave Pl	Mesquite Dr	End	370	38	2,000	60			105			240			740		1	1				
22	Abraham Av	Agave Pl	Lincoln Av	150	36	100	3			41	3		400			300	36	0	6				
23	Bamboo Ln	Joshua Tree Rd	End	220	36	1,200	36			59	3					440	36	1	0				
24	Wroxton Dr	Grand Av	End	551	36	5,500	165			149						1,102	36	3	3				
25	Pinkerton Pl	End	End	880	28	50	2			185		40	555			1,760	28	5	4				
26	Las Palmas Ct	Fargo Rd	End	200	30	200	6			45		50	40			150	400	30	2	1			
27	Nevada Wy	Rumsey Dr	End	170	28	450	14			36						340	28	1	1				
28	Wyoming Wy	Rumsey Dr	End	170	28	255	8			36						340	28	1	1				
29	Fargo Rd	Cheyenne Rd	Pinkerton Pl	2,020	36	200	6	160		545		30	125			120	4,040	36	8	8			
30	Rumsey Dr	Laramie Rd	Central Av	1,620	32	450	14	120	3	389		160	550			520	3,240	32	7	8			
31	Hickock Wy	Carson Rd	End	330	28	635	19			69			110			660		1	1				
32	Carson Rd	Laramie Rd	Fargo Rd	1,250	35	2,400	72			328		45	585			592	2,500		4	1			
33	Laredo Rd	Laramie Rd	Durango Rd	930	32	2,200	66			223	1					1,860		1	1				
34	Durango Rd	Arlington Av	Laredo Rd	1,970	32	300	9			473		165	615			3,940		12	14				
35	Laramie Rd	Durango Rd	Iron Hills Wy	1,450	32	570	17	3	348		130					2,900	32	10	9				
36	Laramie Rd	Rumsey Dr	Victoria Av	900	32	300	9			216	5	120	300			1,800	32	5	1				
37	Iron Hills Wy	Rumsey Dr	End	460	28	1,250	38			97		25	60			920		3	3				
38	Abilene Rd	Cimarron Rd	End	960	34	1,200	36	45		245		80	530			1,920	34	5	4				
39	Shenandoah Rd	Anna St	Abilene Rd	940	32	240	7			226		106				1,890		3	1				
40	Anna St	Arlington Av	Laramie Rd	840	36	200	6	2	227		30	200				1,680		4	4				
41	Cimarron Rd	Durango Rd	Abilene Rd	2,100	34	4,500	135		2	536	2	30	280			4,200		6	2				
42	Arlington Frontage Rd	Anna St	Horace St	1,100	32	6,400	192			264	4					2,200	32	0	0				
43	Cheyenne Rd	Cimarron Rd	Fargo Rd	840	34	200	6			214	1	30	105			1,680		4	2				
44	Pecos Wy	Fargo Rd	End	370	32	1,100	33			89						740		2	1				
45	Chisholm Rd	Fargo Rd	End	480	36	120	4			130		20	150			960		1	4				
46	Tenth Street	Market St	Brookton Av	1,563	34	2,800	84	550		399	5	480	1,300	6	550	3,126	34	2	3				
47	Mulberry Street	University Ave	Mission Inn Ave	355	36	2,700	162			144	2	35	480	12		710	1	3	12,780			GRIND 0.15' & OVERLAY 0.20'	
48	Grand Ave	Mt. View Ave	Jurupa Ave	870	64	15,500	930			835	2	50	19			1,740	3	6	55,680			GRIND 0.15' & OVERLAY 0.20' INCLUDING THE CUL-DE-SAC (BULB)*	
49	Massachusetts Ave	215-Fwy	Iowa Ave	1,700	40	1,200	36			510	5	290	250			3,400	40	3	8				
50	Topaz Dr	Massachusetts	Amethyst St	650	36	300	9			176		220	300			1,300	36	0	2			Cold-Mill MIN. 0.20" (ON TOPAZ FOR 50' AT THE INTERSECTION)**	
51	Turquoise	Massachusetts	Amethyst St	650	36	480	14			176		220	70			1,300	36	2	2				
52	Amethyst St	Atlanta Ave	Turquoise	615	40	11,000	330	135		185	4	50	200			135	1,230	40	4	3			
53	Central Ave	Riverside Ave	Riverside Ave	Intersection						93				7				5	10	12,400			
54	Spruce Street	Spruce St	UPRR	157	60					63								1		8,000			
55	Spruce Street	Watkin Drive	Watkin Drive								1											\$75	
56	Elmwood Court	Cliffside Drive	Kendall Str	915	32	11,000	330			220		55	2,300			1,541	1,830	10	8				
57	Douglass Ave	12th St	University Ave	1,375		15,700	588	3,500		403		760				600	3,000	2	9				
				Total		47,056																	

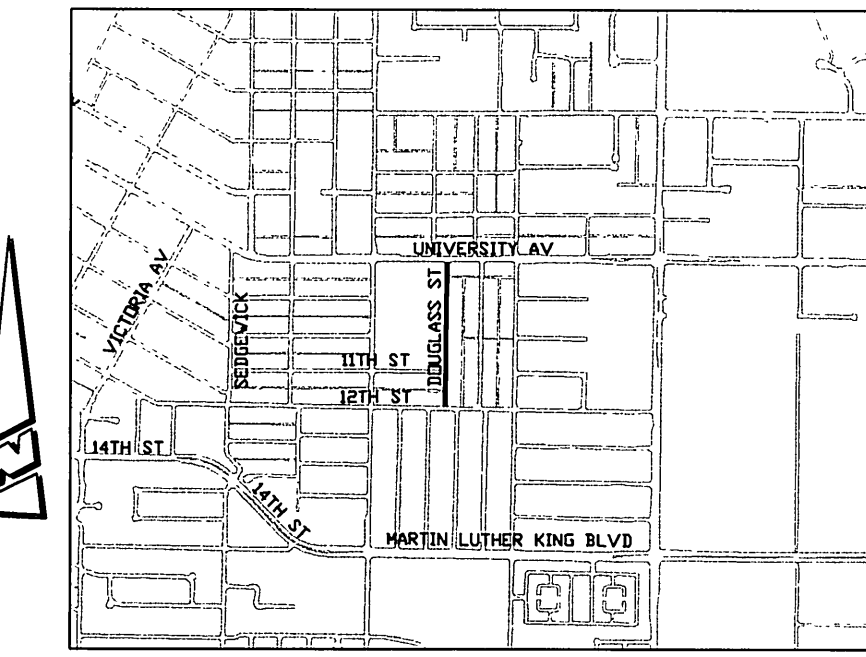

AREA 9

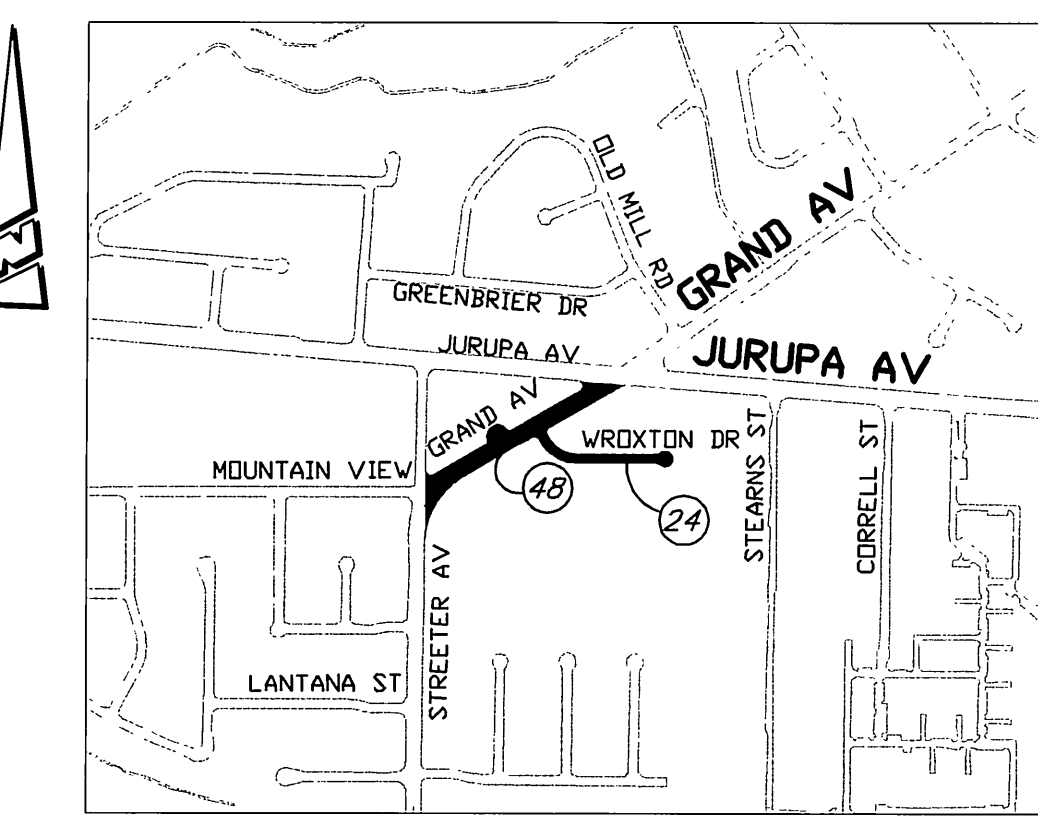

AREA 5

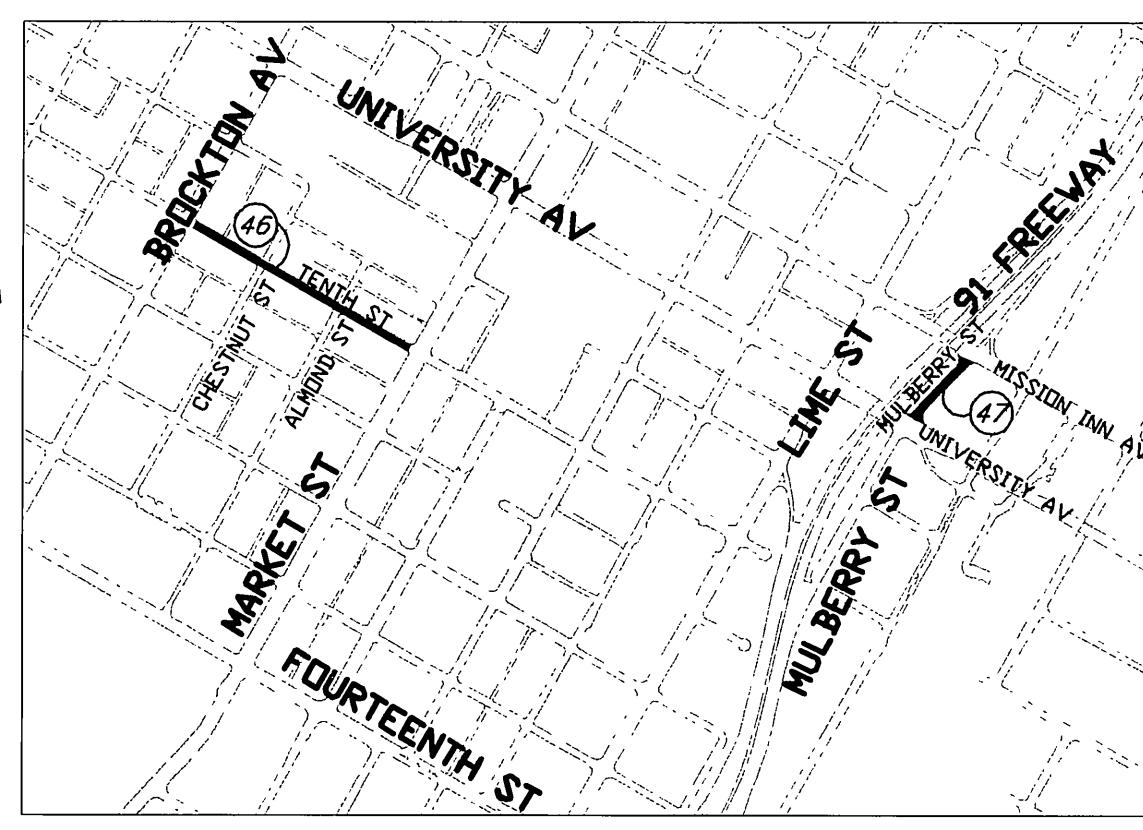

AREA 2

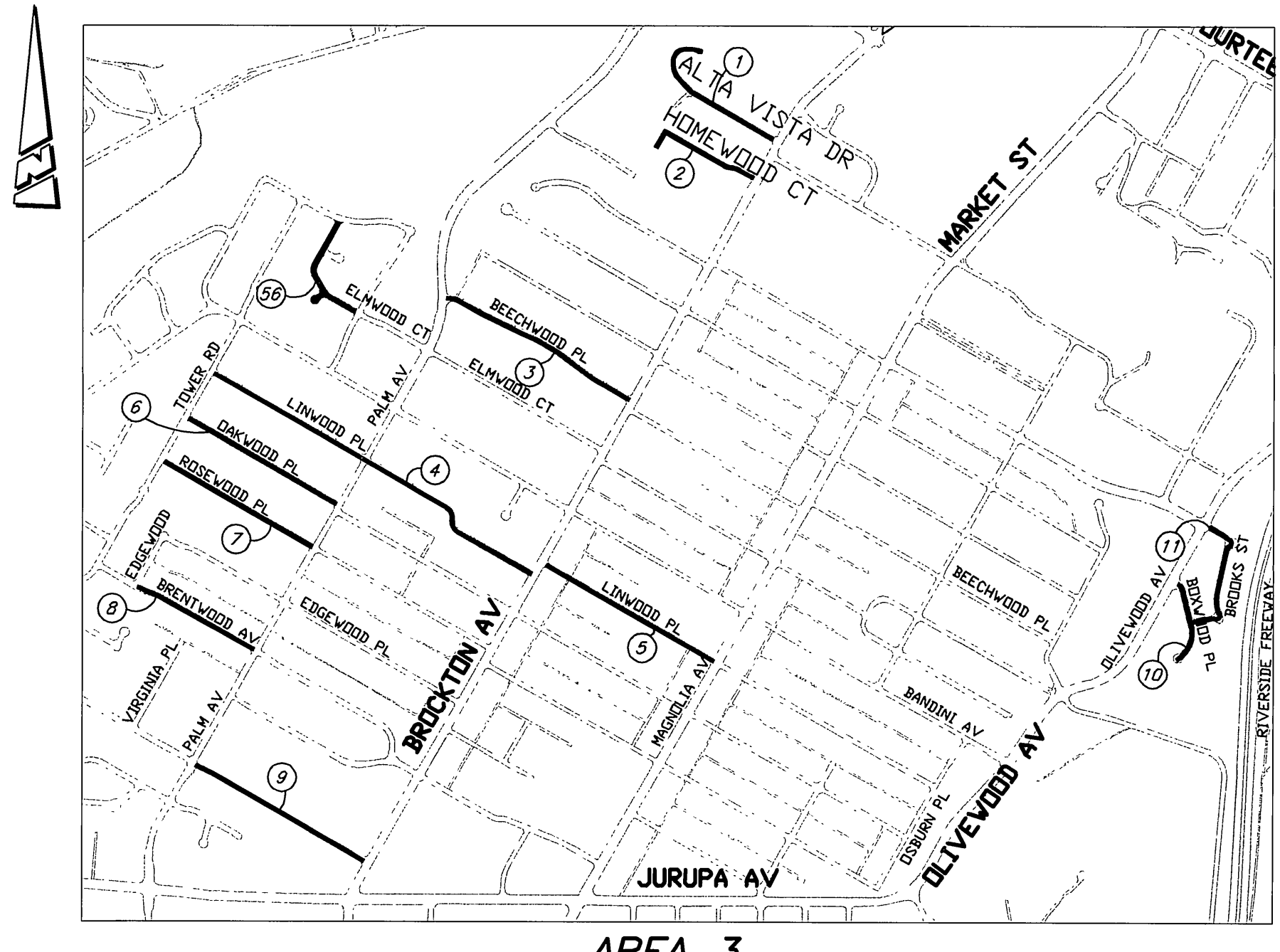

AREA 3

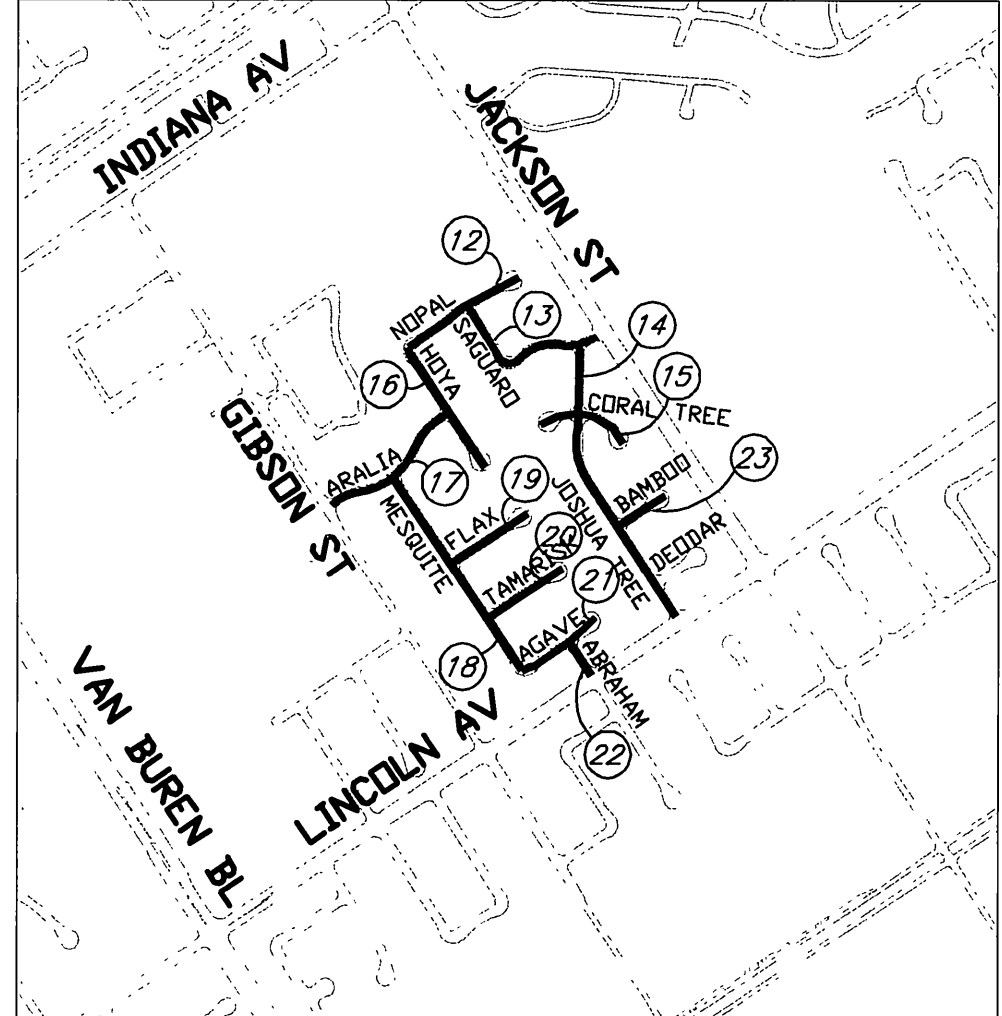

AREA 6

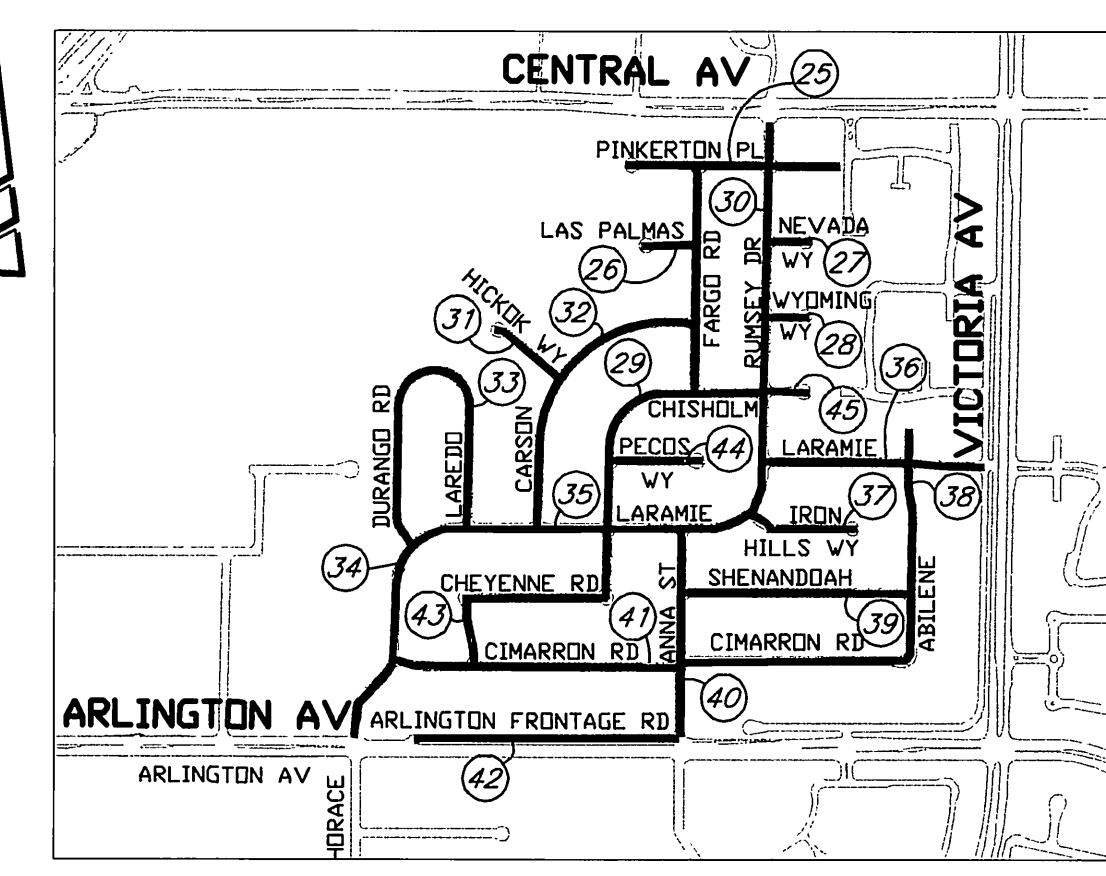

AREA 4

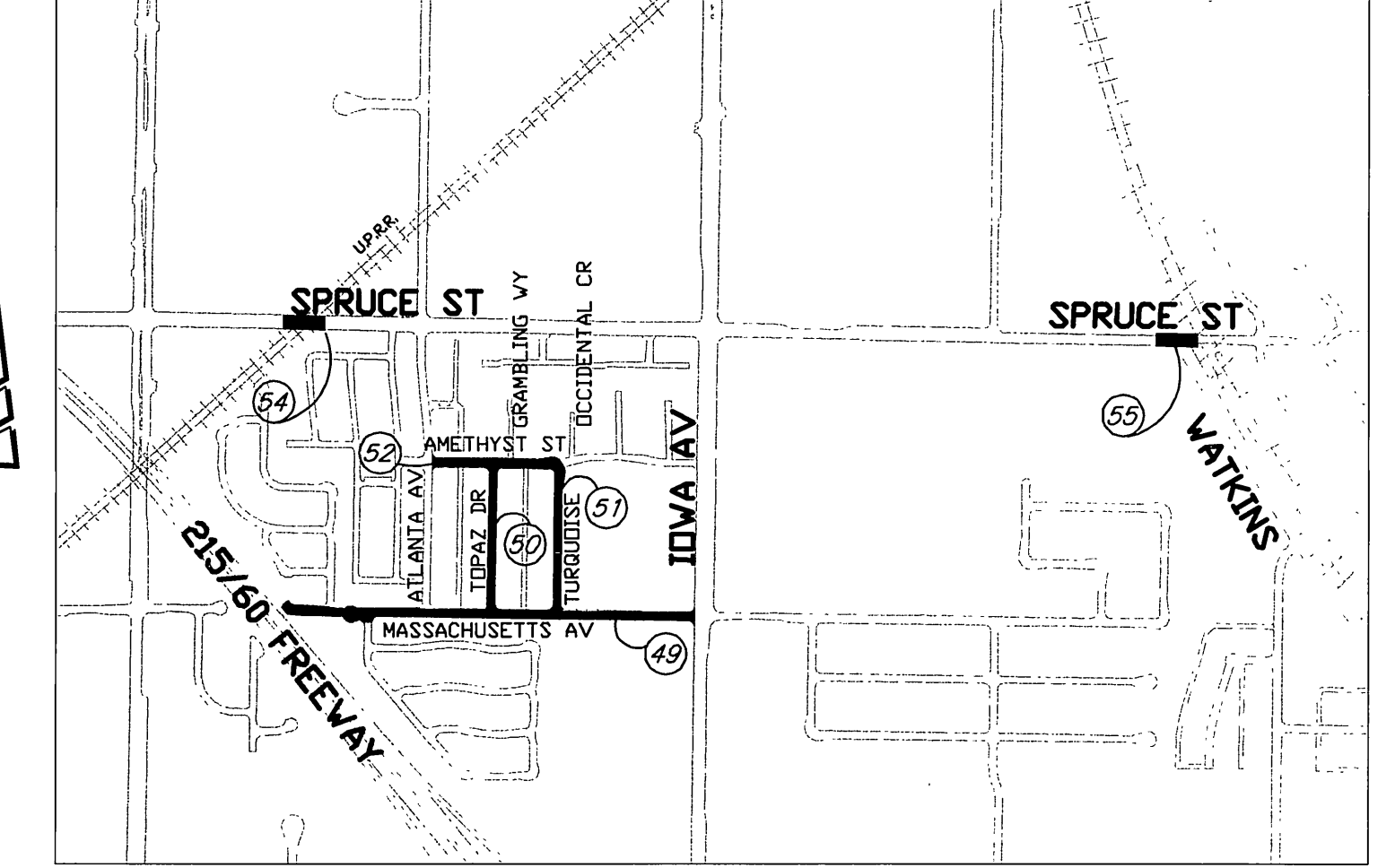

AREA 1

**CONSTRUCTION NOTES:**

NUMBERS ABOVE 100 IN A HEXAGON ON THE PLAN REFER TO THE RESPECTIVE STANDARD DRAWING AND SHALL BE CONSTRUCTED ACCORDINGLY. UNLESS MODIFICATIONS ARE NOTED ON THE PLAN OR COVER SHEET, ANY NUMBER SHOWN BELOW THE STANDARD DRAWING NUMBER INDICATES THE SPECIFIC ALTERNATE TO BE CONSTRUCTED.

**SPECIFIC NOTES:**

- CONTRACTOR SHALL REPLACE EXISTING STRIPING AND MARKINGS AFTER OVERLAY TO THE ORIGINAL CONFIGURATIONS, UNLESS THERE IS A SIGNING & STRIPING PLAN, IN ACCORDANCE WITH SPECIAL PROVISIONS.
- OVERLAY ENTIRE ROAD WIDTH OF ALL MINOR STREETS WITH 0.10' OF ASPHALT RUBBER HOT MIX GAP GRADED AND 0.20' FOR MULBERRY ST AND GRAND AVE. (ENTIRE SECTION OF MULBERRY ST AND GRAND AVE SHALL BE COLD-MILLED FOR A DEPTH OF 0.15' PRIOR TO OVERLAYING AND PRIOR TO REMOVAL & REPLACEMENT OF DAMAGED A.C. PAVEMENT).
- FOR PROPERTIES WITH AC DRIVEWAY APPROACH, AC PAVEMENT OVERLAY SHALL BE EXTENDED TO MATCH EXISTING DRIVEWAYS OR TO PROPERTY LINE WITHOUT ADVERSE IMPACT TO THE EXISTING FLOWLINE.
- IF COLD-MILLING IS NOT POSSIBLE AT AREAS ADJACENT TO AN AC BERM, THE BERM'S HEIGHT SHALL BE RAISED AFTER OVERLAY TO MAINTAIN ITS ORIGINAL HEIGHT AND RUNOFF FLOW ALONG THE BERM.
- ADEQUATE FLOW LINES SHALL BE MAINTAINED AT ALL LOCATIONS.
- FOR WHEELCHAIR RAMPS AT LOCATIONS WHERE SIDEWALK IS LESS THAN 6 FEET WIDE, CONTRACTOR SHALL INSTALL THE SPECIFIED CITY STANDARD WHEELCHAIR RAMP AND TRANSITION THE ASSOCIATED SIDEWALK TO MATCH EXISTING.
- LOCATIONS FOR DIGOUTS SHALL BE MARKED ON SITE AT THE TIME OF CONSTRUCTION AND AFTER COLD-MILLING OPERATIONS HAVE BEEN COMPLETED, WHERE REQUIRED.  
UNLESS SPECIFIED ON PLANS, AC DEPTH FOR REMOVAL AND REPLACEMENT AREAS SHALL BE A MINIMUM OF 6" FOR ALL MINOR STREETS, 10" FOR MULBERRY ST AND 8" FOR GRAND AVE, OR MATCH EXISTING STRUCTURAL SECTION, WHICHEVER IS GREATER.
- AT THE EXISTING WHEELCHAIR RAMPS WHETHER OR NOT REQUIRE ALTERATION, THE CROSS SLOPE OF THE PAVEMENT ADJACENT TO THE RAMP SHALL NOT EXCEED 5% FOR ANY RAMP. WHERE SUCH PAVEMENT CROSS-SLOPE EXCEEDS 5%, CONTRACTOR SHALL COLD-MILL THE EXISTING PAVEMENT TO A DEPTH OF AN ADDITIONAL 0.10' BELOW THE GUTTER LIP TO A DISTANCE OF 7' RADIALLY, TO SATISFY THE REQUIRED 5% SLOPE AND PROVIDE SMOOTH TRANSITION TO PAVEMENT IN THE DRIVING LANES.
- DURING THE CONSTRUCTION WORK, ALL SEWER, STORM DRAIN & UTILITY MANHOLES AND WATER GATE VALVES SHALL BE RAMPED UP OR DOUBLE ADJUSTED TO FACILITATE THE COLD-MILLING AND PAVING OPERATIONS. FOLLOWING THE CONSTRUCTION OF A.R.H.M.-GG AC FINAL FINISH SURFACE, ALL MANHOLES AND GATE VALVE COVERS SHALL BE ADJUSTED TO GRADE AS NEEDED.

**Underground Service Alert**  
CALL BEFORE YOU DIG  
CALL-TOLL FREE  
1-800-227-2600  
TWO WORKING DAYS BEFORE YOU DIG

**ENGINEER IN RESPONSIBLE CHARGE**  
Ibrahim A. Massoud  
R.C.E. No. 64224 expires 6/30/09  
DATE 4/20/09

**REGISTERED PROFESSIONAL ENGINEER**  
IBRAHIM A. MASSOUD  
No. 64224  
Exp. 6-30-2009  
CIVIL  
STATE OF CALIFORNIA

**CITY OF RIVERSIDE, CALIFORNIA**  
**PUBLIC WORKS DEPARTMENT**  
APPROVED BY: [Signature]  
DATE: 4/20/09

**2008-09 MINOR STREETS REHABILITATION**  
AT VARIOUS LOCATIONS  
N.T.S.

ACCT. NO.: 9596927  
**R-4121**  
SHEET 2 OF 6  
FILE NO.

C:\COMMON\Design Projects\MINOR STREET REHAB 08-09\DESIGN PLANS\TRANSPORTATION\CADD-SHEETS\Street2.DWG

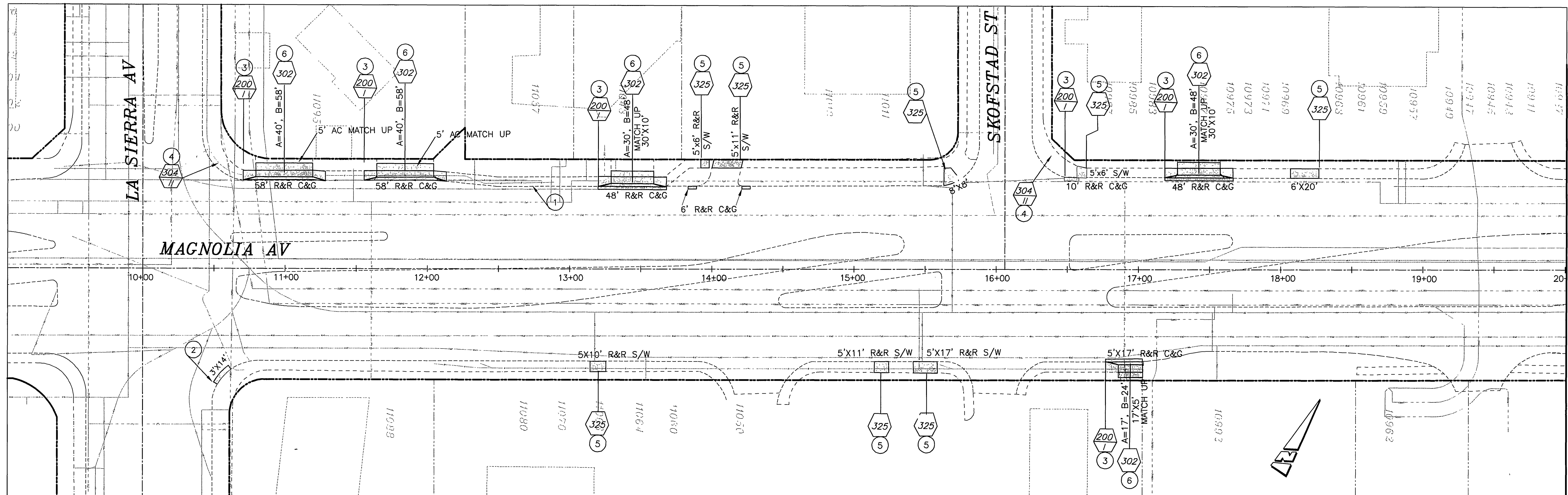

**SPECIFIC NOTE:**

AT THE EXISTING WHEELCHAIR RAMPS WHETHER OR NOT REQUIRE ALTERATION, THE CROSS SLOPE OF THE PAVEMENT ADJACENT TO THE RAMP SHALL NOT EXCEED 5% FOR ANY RAMP. WHERE SUCH PAVEMENT CROSS-SLOPE EXCEEDS 5%, CONTRACTOR SHALL GOLD-MILL THE EXISTING PAVEMENT TO A DEPTH OF AN ADDITIONAL 0.10' BELOW THE GUTTER LIP TO A DISTANCE OF 7' RADIALLY TO SATISFY THE REQUIRED 5% SLOPE AND PROVIDE SMOOTH TRANSITION TO PAVEMENT IN THE DRIVING LANES.

**CONSTRUCTION NOTES:**

NUMBERS ABOVE 100 IN A HEXAGON ON THE PLAN REFER TO THE RESPECTIVE STANDARD DRAWING AND SHALL BE CONSTRUCTED ACCORDINGLY. UNLESS MODIFICATIONS ARE NOTED ON THE PLAN OR COVER SHEET, ANY NUMBER SHOWN BELOW THE STANDARD DRAWING NUMBER INDICATES THE SPECIFIC ALTERNATE TO BE CONSTRUCTED.

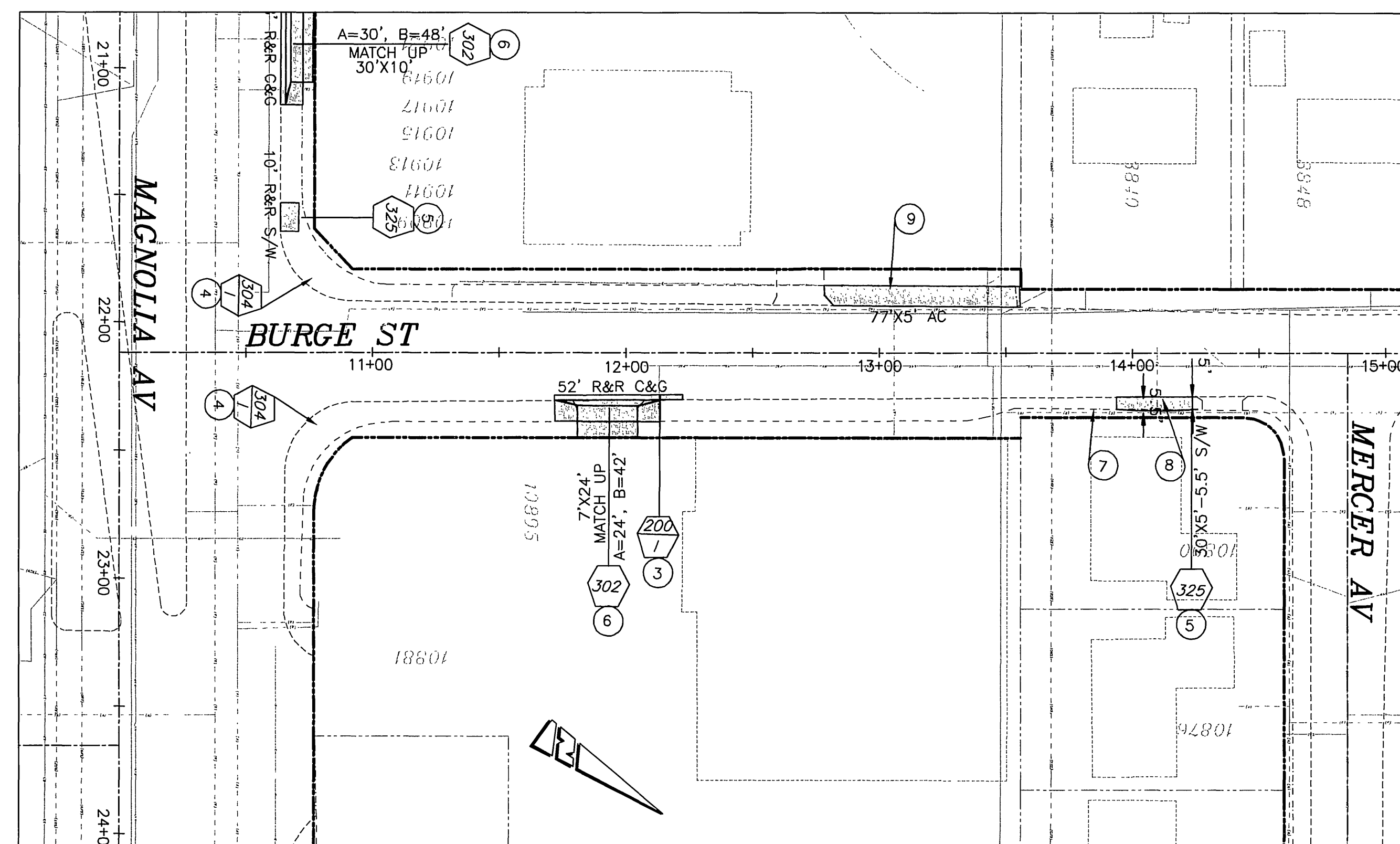
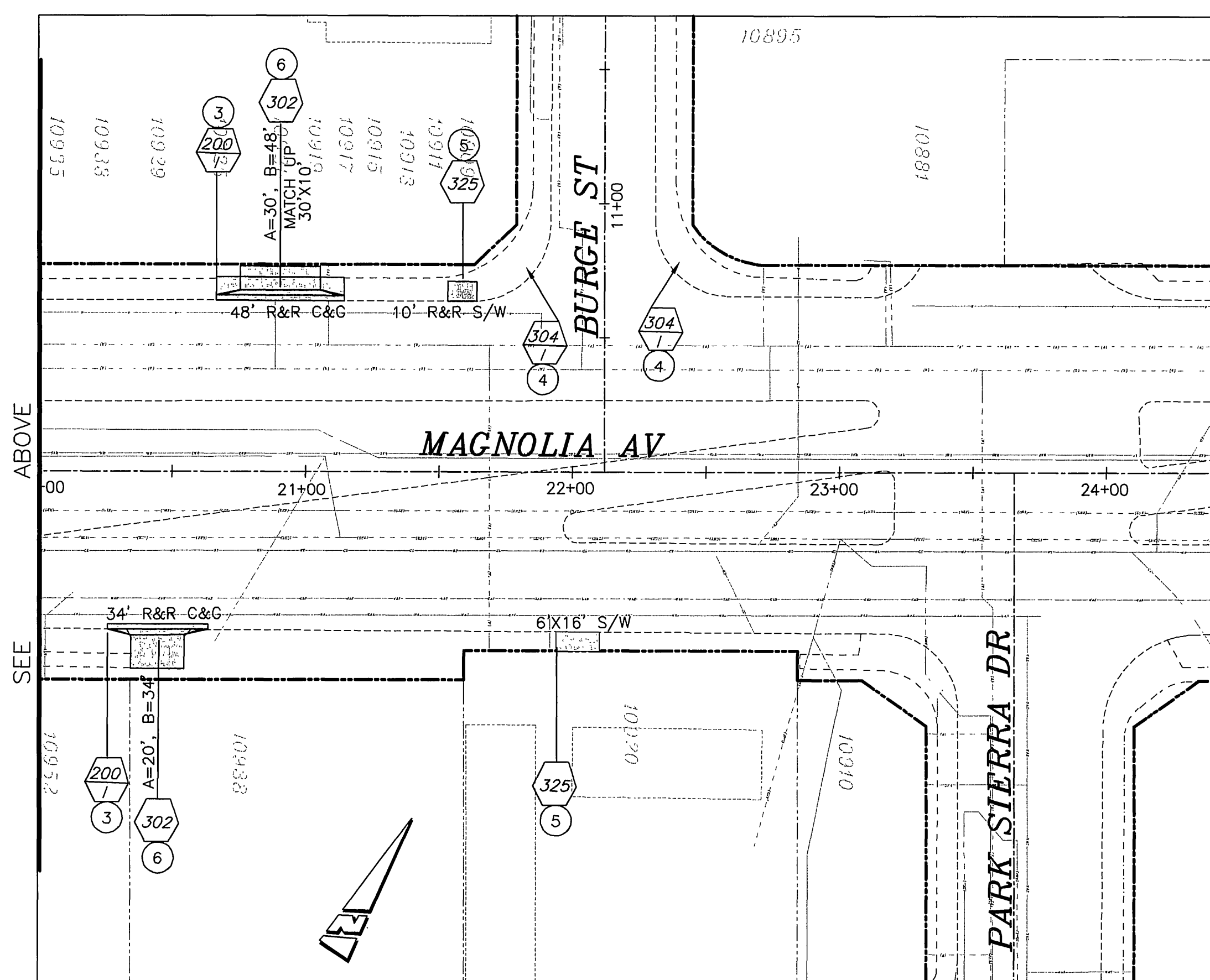

- 1 REMOVE AND REPLACE EXISTING DAMAGED WATER METER BOX (CONTRACTOR TO MAKE ARRANGEMENT WITH PUD-W TO PICK UP CITY-FURNISHED METER BOX)
- 2 REMOVE AND REPLACE EXISTING AC PAVEMENT (MIN. DEPTH=6")
- 3 REMOVE AND REPLACE EXISTING CURB & GUTTER PER STD. DRAWING 200 AS SHOWN ON THE PLAN AND AS DIRECTED BY THE ENGINEER. (CONTRACTOR SHALL NOTIFY THE ENGINEER TO DETERMINE THE PROPER LONGITUDINAL GRADE AND THE NEED FOR STAKING OF CURB AND GUTTER PRIOR TO THE REMOVAL OF THESE AREAS)
- 4 REMOVE AND REPLACE EXISTING ACCESS RAMP PER STD. DRAWING 304 AND AS SHOWN ON THE PLAN
- 5 REMOVE AND REPLACE EXISTING SIDEWALK PER STD. DRAWING 325 (INCLUDES REMOVAL/ ADJUSTMENT OF EXISTING LANDSCAPING AND IRRIGATION)
- 6 REMOVE AND REPLACE EXISTING DRIVEWAY PER STD. DRAWING 302 (TYPE CURB-I) USING PCC QUICK-SET CONCRETE
- 7 RELOCATE "6" WOOD FENCE" TO 6" FROM THE EXISTING LOCATION
- 8 RELOCATE EXISTING "SPEED SIGN" TO ABOUT 200', NEXT TO "LAZY BOY FURNITURE STORE", AS DIRECTED BY THE ENGINEER
- 9 PROVIDE AC PAVEMENT TRANSITION (THICKNESS=3" MIN.) BETWEEN EXISTING SIDEWALK AND DRIVEWAY, AS DIRECTED BY THE ENGINEER

**Underground Service Alert**  
CALL BEFORE YOU DIG  
CALL-TOLL FREE  
1-800  
227-2600  
TWO WORKING DAYS BEFORE YOU DIG

**ENGINEER IN RESPONSIBLE CHARGE**  
Ibrahim A. Massoud  
R.C.E. No. 64224 expires 6/30/09  
DATE 4/20/09

REGISTERED PROFESSIONAL ENGINEER  
IBRAHIM A. MASSOUD  
No. 64224  
Exp. 6-30-2009  
CIVIL  
STATE OF CALIFORNIA

MARK	REVISIONS	APPR.	DATE
DESIGNED BY: AE	DRAWN BY: AE	CHECKED BY: NDE	

**CITY OF RIVERSIDE, CALIFORNIA  
PUBLIC WORKS DEPARTMENT**

APPROVED BY: [Signature]  
ENGINEERING MANAGER  
DATE: 4/20/09

APPROVED BY: [Signature]  
CITY ENGINEER  
DATE: 4/20/09

**PATHWAY BARRIERS REPAIR**  
MAGNOLIA AVE  
BETWEEN LA SIERRA AVE AND PARK SIERRA DRIVE

N.T.S.

ACCT. NO.: 9596927  
**R-4121**  
SHEET 3 OF 6  
FILE NO.

**CONSTRUCTION NOTES:**

NUMBERS ABOVE 100 IN A HEXAGON ON THE PLAN REFER TO THE RESPECTIVE STANDARD DRAWING AND SHALL BE CONSTRUCTED ACCORDINGLY. UNLESS MODIFICATIONS ARE NOTED ON THE PLAN OR COVER SHEET. ANY NUMBER SHOWN BELOW THE STANDARD DRAWING NUMBER INDICATES THE SPECIFIC ALTERNATE TO BE CONSTRUCTED.

**SPECIFIC NOTES:**

- CONTRACTOR SHALL REPLACE EXISTING STRIPING AND MARKINGS AFTER OVERLAY TO THE ORIGINAL CONFIGURATIONS, UNLESS THERE IS A SIGNING & STRIPING PLAN, IN ACCORDANCE WITH SPECIAL PROVISIONS.
- OVERLAY ENTIRE ROAD WIDTH OF ALL MINOR STREETS WITH 0.10' OF ASPHALT RUBBER HOT MIX GAP GRADED AND 0.20' FOR MULBERRY ST AND GRAND AVE. (ENTIRE SECTION OF MULBERRY ST AND GRAND AVE SHALL BE COLD-MILLED FOR A DEPTH OF 0.15' PRIOR TO OVERLAYING AND PRIOR TO REMOVAL & REPLACEMENT OF DAMAGED A.C. PAVEMENT).
- FOR PROPERTIES WITH AC DRIVEWAY APPROACH, AC PAVEMENT OVERLAY SHALL BE EXTENDED TO MATCH EXISTING DRIVEWAYS OR TO PROPERTY LINE WITHOUT ADVERSE IMPACT TO THE EXISTING FLOWLINE.
- IF COLD-MILLING IS NOT POSSIBLE AT AREAS ADJACENT TO AN AC BERM, THE BERM'S HEIGHT SHALL BE RAISED AFTER OVERLAY TO MAINTAIN ITS ORIGINAL HEIGHT AND RUNOFF FLOW ALONG THE BERM.
- ADEQUATE FLOW LINES SHALL BE MAINTAINED AT ALL LOCATIONS.
- FOR WHEELCHAIR RAMPS AT LOCATIONS WHERE SIDEWALK IS LESS THAN 6 FEET WIDE, CONTRACTOR SHALL INSTALL THE SPECIFIED CITY STANDARD WHEELCHAIR RAMP AND TRANSITION THE ASSOCIATED SIDEWALK TO MATCH EXISTING.
- LOCATIONS FOR DIGOUTS SHALL BE MARKED ON SITE AT THE TIME OF CONSTRUCTION AND AFTER COLD-MILLING OPERATIONS HAVE BEEN COMPLETED, WHERE REQUIRED.  
UNLESS SPECIFIED ON PLANS, AC DEPTH FOR REMOVAL AND REPLACEMENT AREAS SHALL BE A MINIMUM OF 6" FOR ALL MINOR STREETS, 10" FOR MULBERRY ST AND 8" FOR GRAND AVE, OR MATCH EXISTING STRUCTURAL SECTION, WHICHEVER IS GREATER.
- AT THE EXISTING WHEELCHAIR RAMPS WHETHER OR NOT REQUIRE ALTERATION, THE CROSS SLOPE OF THE PAVEMENT ADJACENT TO THE RAMP SHALL NOT EXCEED 5% FOR ANY RAMP. WHERE SUCH PAVEMENT CROSS-SLOPE EXCEEDS 5%, CONTRACTOR SHALL COLD-MILL THE EXISTING PAVEMENT TO A DEPTH OF AN ADDITIONAL 0.10' BELOW THE GUTTER LIP TO A DISTANCE OF 7' RADIALLY, TO SATISFY THE REQUIRED 5% SLOPE AND PROVIDE SMOOTH TRANSITION TO PAVEMENT IN THE DRIVING LANES.
- DURING THE CONSTRUCTION WORK, ALL SEWER, STORM DRAIN & UTILITY MANHOLES AND WATER GATE VALVES SHALL BE RAMPED UP OR DOUBLE ADJUSTED TO FACILITATE THE COLD-MILLING AND PAVING OPERATIONS. FOLLOWING THE CONSTRUCTION OF A.R.H.M.-GG AC FINAL FINISH SURFACE, ALL MANHOLES AND GATE VALVE COVERS SHALL BE ADJUSTED TO GRADE AS NEEDED.

**QUANTITIES TABLE**

#	STREET NAME	STREET LIMIT	STREET LIMIT	STREET LENGTH (L <sub>F</sub> )	STREET WIDTH (L <sub>F</sub> )	AC AREA (SQ)	AC (TON)	OVERLAY A.R.H.M.-GG (TON)	AC REMOVAL (SQ)	WCR (EA)	R&R CURB & GUTTER (L <sub>F</sub> )	R&R SIDEWALK (SQ)	AGGREGATE BASE (CY)	K-GUTTER (SF)	COLDMILLING TYPE I 8" WIDE	COLDMILLING TYPE I 10" WIDE	ADJ. SLOPE & S.D. (EA)	VALVES	COLDMILLING TYPE II	New Sidewalk (S.F.)	COMMENTS	
1	Florence St	Mountain View Av	Jurupa Ave	540	32	17,280	454	130	17,280	-	2	365	600	512	-	-	52	5	1	-	-	Requires complete removal and replacement entire structural section
2	William St	Mountain View Av	Jurupa Ave	620	34	21,100	554	159	21,100	-	1	320	150	625	-	-	54	3	1	-	-	Requires complete removal and replacement entire structural section
3	Anita Pl	Mountain View Av	Jurupa Ave	550	32	17,600	462	132	17,600	-	1	380	485	522	-	-	52	6	2	-	-	Requires complete removal and replacement entire structural section
4	Sheppard St	Anita Pl	Mountain View Av	660	32	21,120	555	159	21,120	-	-	325	255	626	-	-	56	2	4	-	-	Requires complete removal and replacement entire structural section
				Total		2,870																

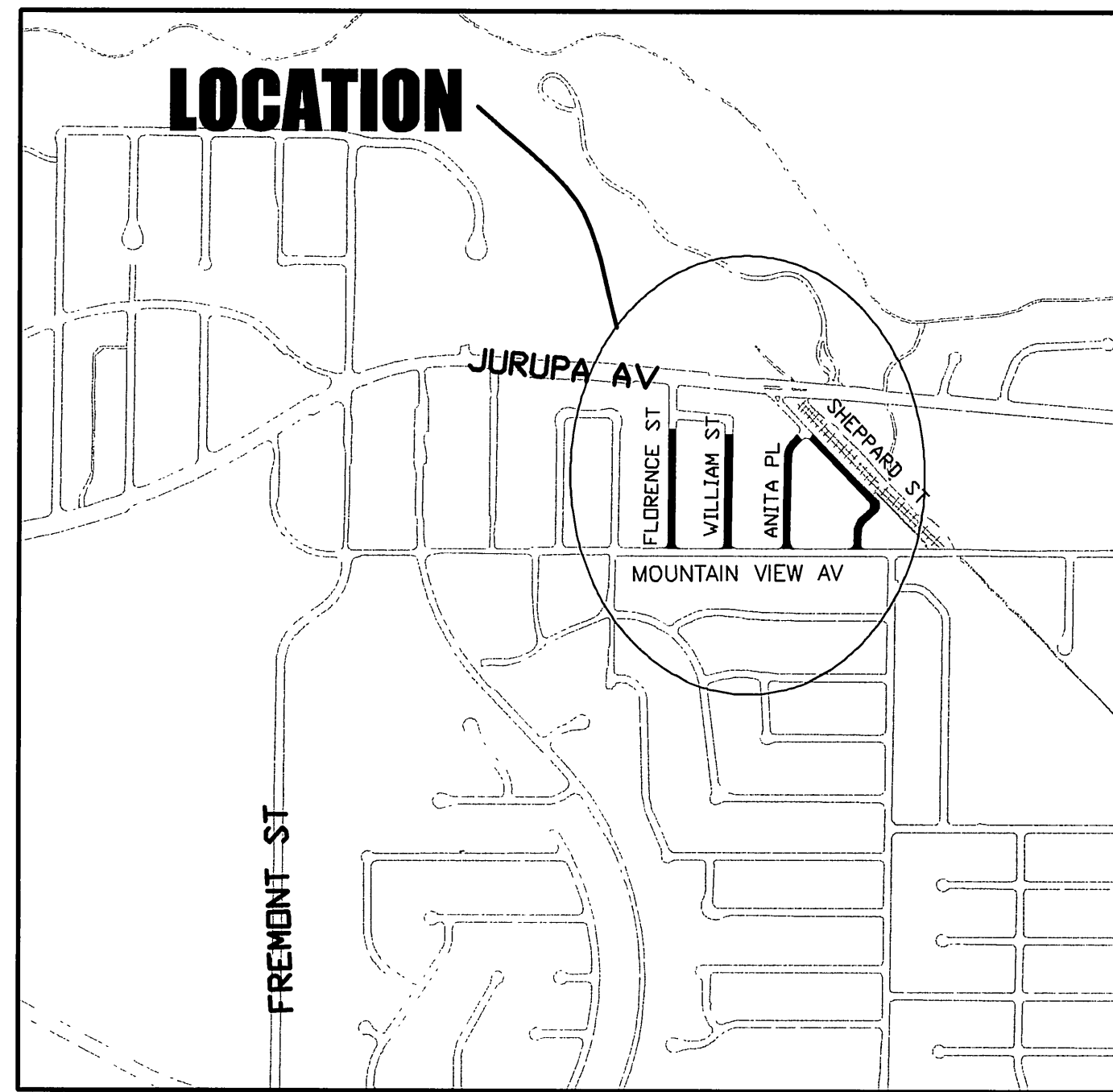

AREA 7

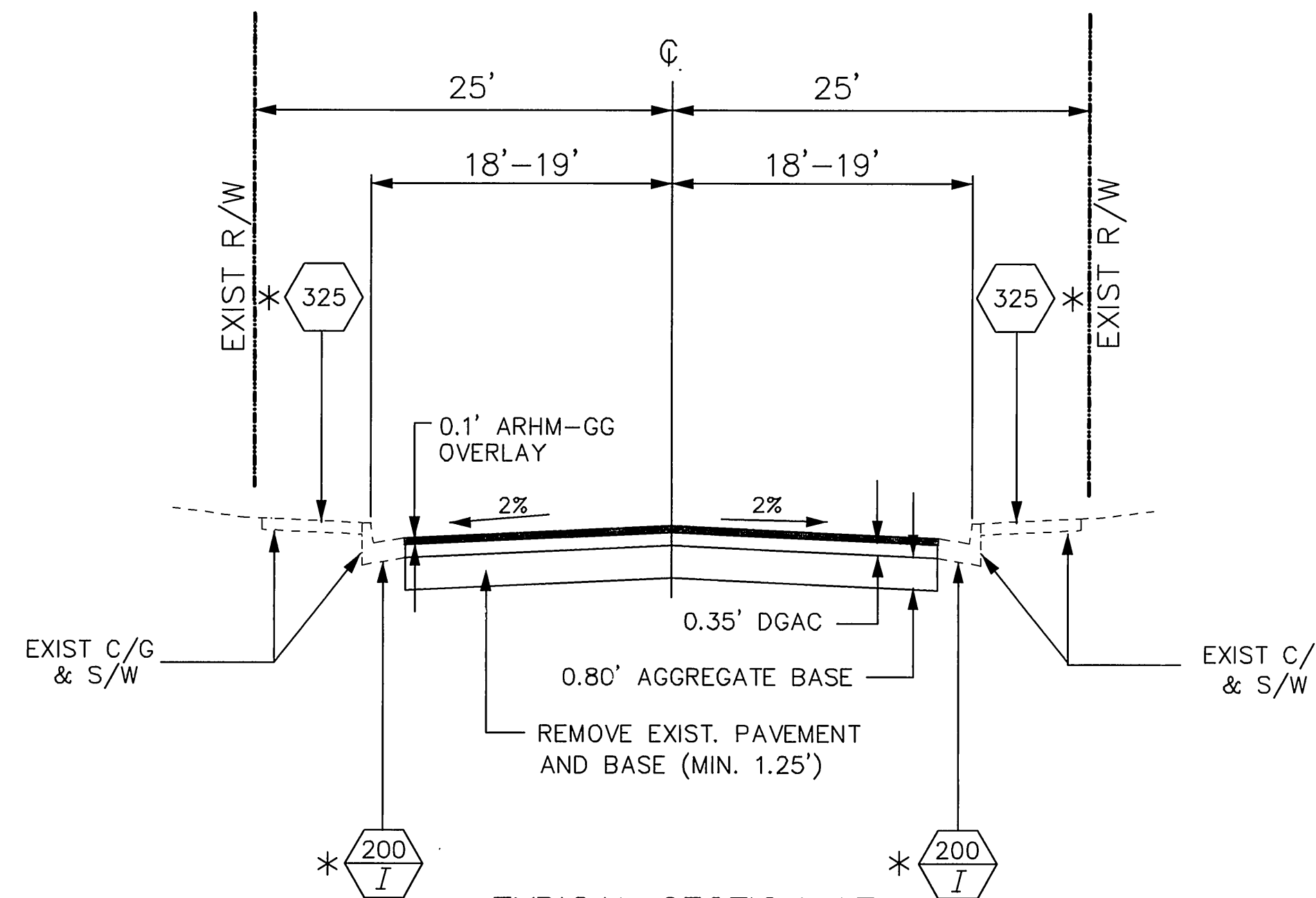

TYPICAL SECTION AT  
WILLIAM ST  
FLORENCE ST  
ANITA PL  
SHEPPARD ST (NO C&G ON NORTH-SIDE BY R/R)

\* R&R EXIST. DAMAGED C/G & S/W

Notes:

- AC REMOVAL FOR THE ABOVE STREETS INCLUDE REMOVAL OF AC PAVEMENT, BASE AND SUB-GRADE TO A DEPTH OF MINIMUM 1.25'.
- ALL STREETS INCLUDE COMPLETE REMOVAL AND RECONSTRUCTION PER NEW STRUCTURAL SECTION ON THIS SHEET.

**Underground Service Alert**  
CALL BEFORE YOU DIG  
CALL-TOLL FREE  
1-800-227-2600  
TWO WORKING DAYS BEFORE YOU DIG

**ENGINEER IN RESPONSIBLE CHARGE**  
IBRAHIM A. MASSOUD  
R.C.E. No. 64224 expires 6/30/09  
DATE: 4/20/09

REGISTERED PROFESSIONAL ENGINEER  
IBRAHIM A. MASSOUD  
No. 64224  
Exp. 6-30-2009  
CIVIL  
STATE OF CALIFORNIA

CITY OF RIVERSIDE, CALIFORNIA  
PUBLIC WORKS DEPARTMENT

APPROVED BY: [Signature]  
ENGINEERING MANAGER  
DATE: 4/20/09

APPROVED BY: [Signature]  
CITY ENGINEER  
DATE: 4/20/09

2008-09 MINOR STREETS REHABILITATION  
AT VARIOUS LOCATIONS

ACCT. NO.: 9596927  
R-4121  
SHEET 4 OF 6  
FILE NO.

G:\COMMON\Design Projects 08-09\DESIGN PLANS\TRANSPORTATION\CADD\_SHEETS\Sheppard.DWG

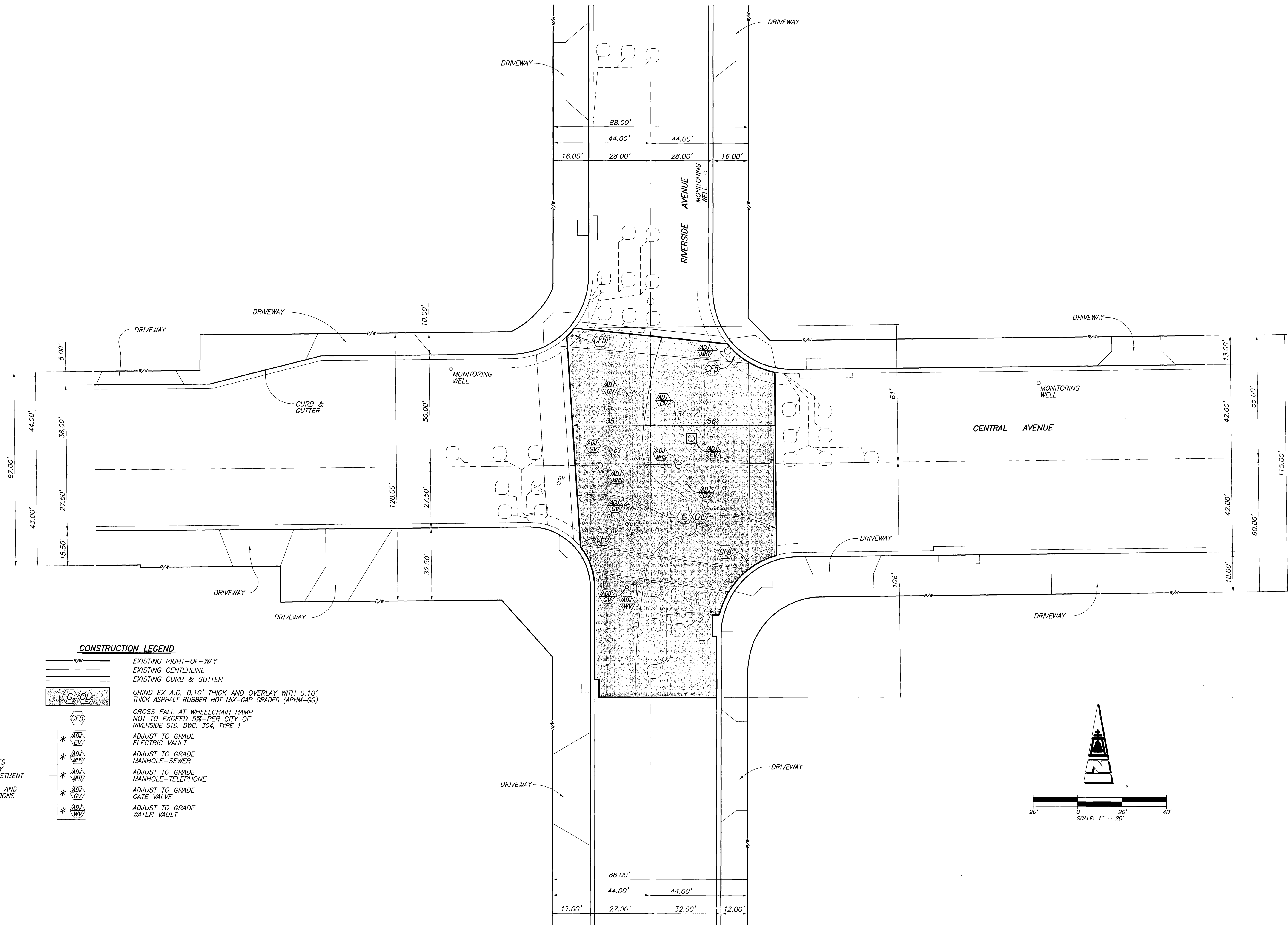

**CONSTRUCTION LEGEND**

- EXISTING RIGHT-OF-WAY
- EXISTING CENTERLINE
- EXISTING CURB & GUTTER
- GRIND EX A.C. 0.10' THICK AND OVERLAY WITH 0.10' THICK ASPHALT RUBBER HOT MIX-GAP GRADED (ARHM-GG)
- CROSS FALL AT WHEELCHAIR RAMP NOT TO EXCEED 5% PER CITY OF RIVERSIDE STD. DWG. 304, TYPE 1
- ADJUST TO GRADE ELECTRIC VAULT
- ADJUST TO GRADE MANHOLE-SEWER
- ADJUST TO GRADE MANHOLE-TELEPHONE
- ADJUST TO GRADE GATE VALVE
- ADJUST TO GRADE WATER VAULT

\* ALL MANHOLES, VAULTS AND GATE VALVES MAY REQUIRE DOUBLE ADJUSTMENT OR A.C. RAMP-UP DURING COLD MILLING AND A.C. PAVEMENT OPERATIONS

QUANTITIES			
ITEM	QUANTITY	ITEM	QUANTITY
A.C. PAVEMENT OVERLAY	93 TONS	ADJUST TO GRADE-ELECTRIC VAULT	1 EA.
A.C. PAVEMENT GRIND - 0.10' THICK	12,400 S.F.	ADJUST TO GRADE-WATER VAULT	1 EA.
ADJUST TO GRADE-SEWER MANHOLE	2 EA.	ADJUST TO GRADE-GATE VALVE	10 EA.
ADJUST TO GRADE-PACIFIC BELL MANHOLE	1 EA.		

**ENGINEER IN RESPONSIBLE CHARGE**

*Philip Hanawai*

PHILIP HANAWAI  
R.C.E. No. C 44747 expires 03/31/2010  
DATE 2/11/09

MARK	REVISIONS	APPR.	DATE

DESIGNED BY: RICH DRAWN BY: RICH CHECKED BY: PLH

CITY OF RIVERSIDE, CALIFORNIA  
PUBLIC WORKS DEPARTMENT

APPROVED BY	BY DATE	APPROVED BY
ENGINEERING MANAGER	<i>[Signature]</i> 2/10/09	PHILIP HANAWAI
PRINCIPAL ENGINEER		
SURVEYOR		
TRAFFIC DIVISION		
CONSTRUCTION CONTRACT ADMINISTRATION		

DATE 2/20/09

**CENTRAL AVENUE/  
RIVERSIDE AVENUE  
INTERSECTION  
PAVEMENT REHAB**

HORIZ. SCALE: 1" = 20'

**R-4121**

SHEET 5 OF 6

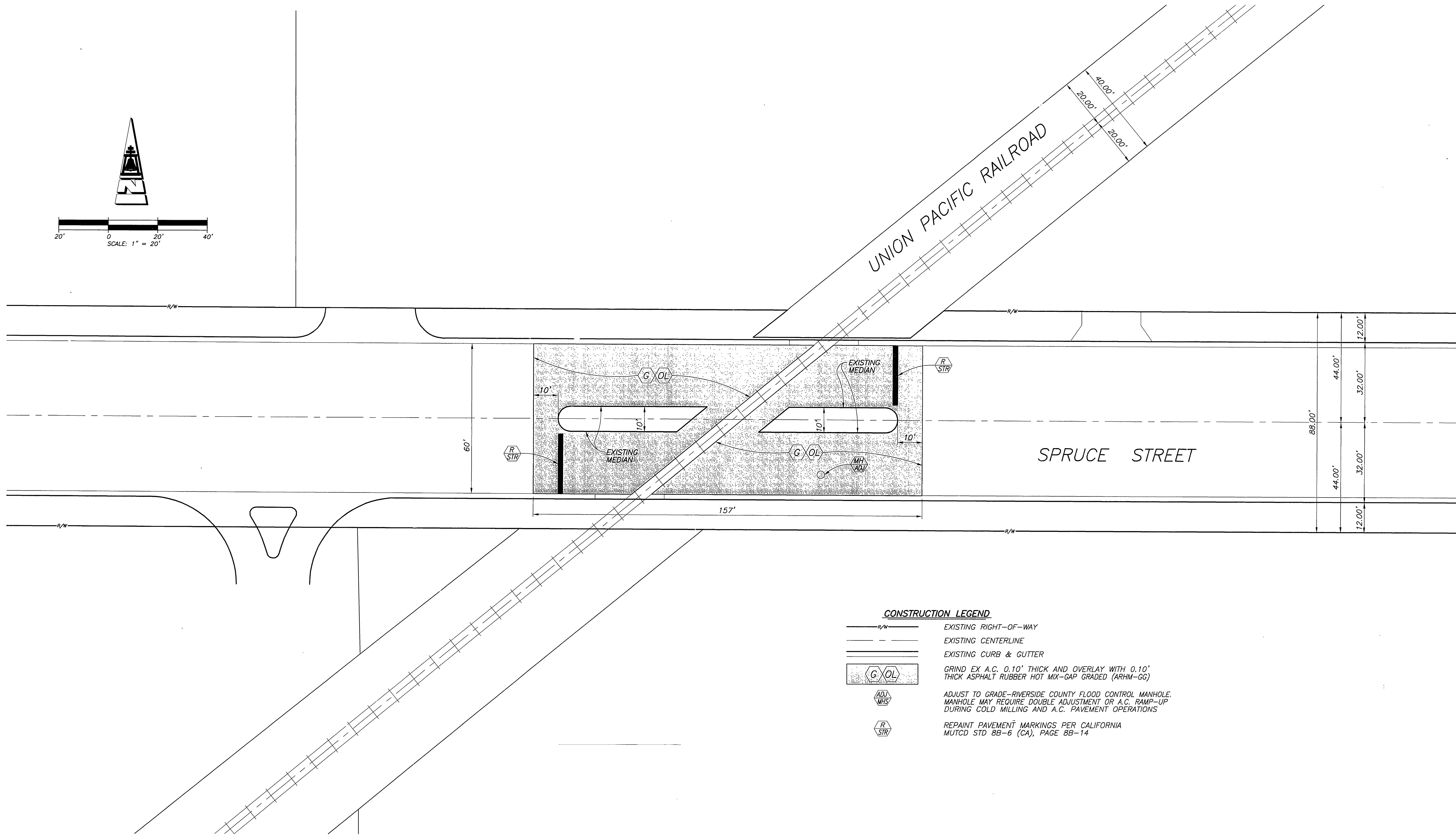
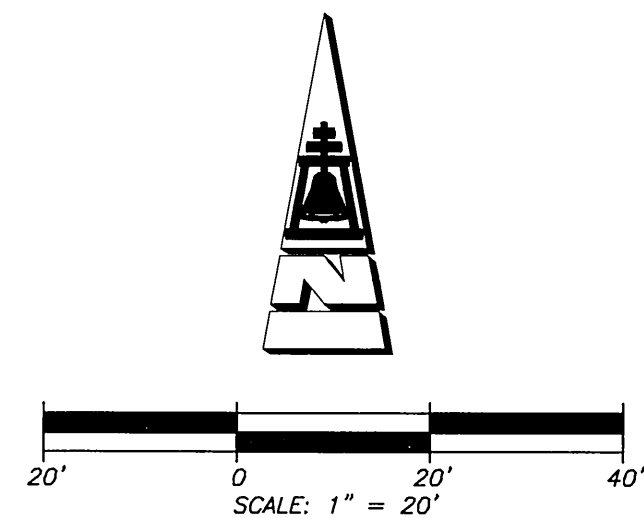

**CONSTRUCTION LEGEND**

- EXISTING RIGHT-OF-WAY
- EXISTING CENTERLINE
- EXISTING CURB & GUTTER
- GRIND EX A.C. 0.10' THICK AND OVERLAY WITH 0.10' THICK ASPHALT RUBBER HOT MIX-GAP GRADED (ARHM-GG)
- ADJUST TO GRADE-RIVERSIDE COUNTY FLOOD CONTROL MANHOLE. MANHOLE MAY REQUIRE DOUBLE ADJUSTMENT OR A.C. RAMP-UP DURING COLD MILLING AND A.C. PAVEMENT OPERATIONS
- REPAINT PAVEMENT MARKINGS PER CALIFORNIA MUTCD STD 8B-6 (CA), PAGE 8B-14

QUANTITIES	
ITEM	QUANTITY
A.C. PAVEMENT OVERLAY	60 TONS
A.C. PAVEMENT GRIND - 0.10' THICK	8,000 S.F.
ADJUST TO GRADE-RCFC & WCD MANHOLE	1 EA.

**ENGINEER IN RESPONSIBLE CHARGE**  
  
 PHILIP HANNAWI  
 R.C.E. No. C 44747, expires 03/31/2010  
 DATE 2/11/2009

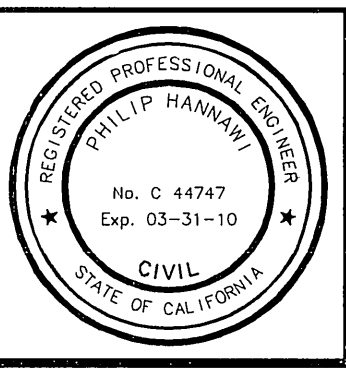

MARK	REVISIONS	APPR.	DATE

CITY OF RIVERSIDE, CALIFORNIA  
 PUBLIC WORKS DEPARTMENT

APPROVED BY	BY	DATE	APPROVED BY
ENGINEERING MANAGER		2/11/09	
PRINCIPAL ENGINEER		2/11/09	
SURVEYOR			
TRAFFIC DIVISION			
CONSTRUCTION CONTRACT ADMINISTRATION	APB	2/10/09	DATE 2/22/09

**SPRUCE STREET/  
 SOUTHERN PACIFIC R.R.  
 PAVEMENT REHAB**

HORIZ. SCALE: 1" = 20'

**R-4121**  
 SHEET 6 OF 6