

# RIVERSIDE CALIFORNIA

## PUBLIC WORKS DEPARTMENT VICTORIA AVENUE AND SOMERSET DRIVE INTERSECTION IMPROVEMENTS

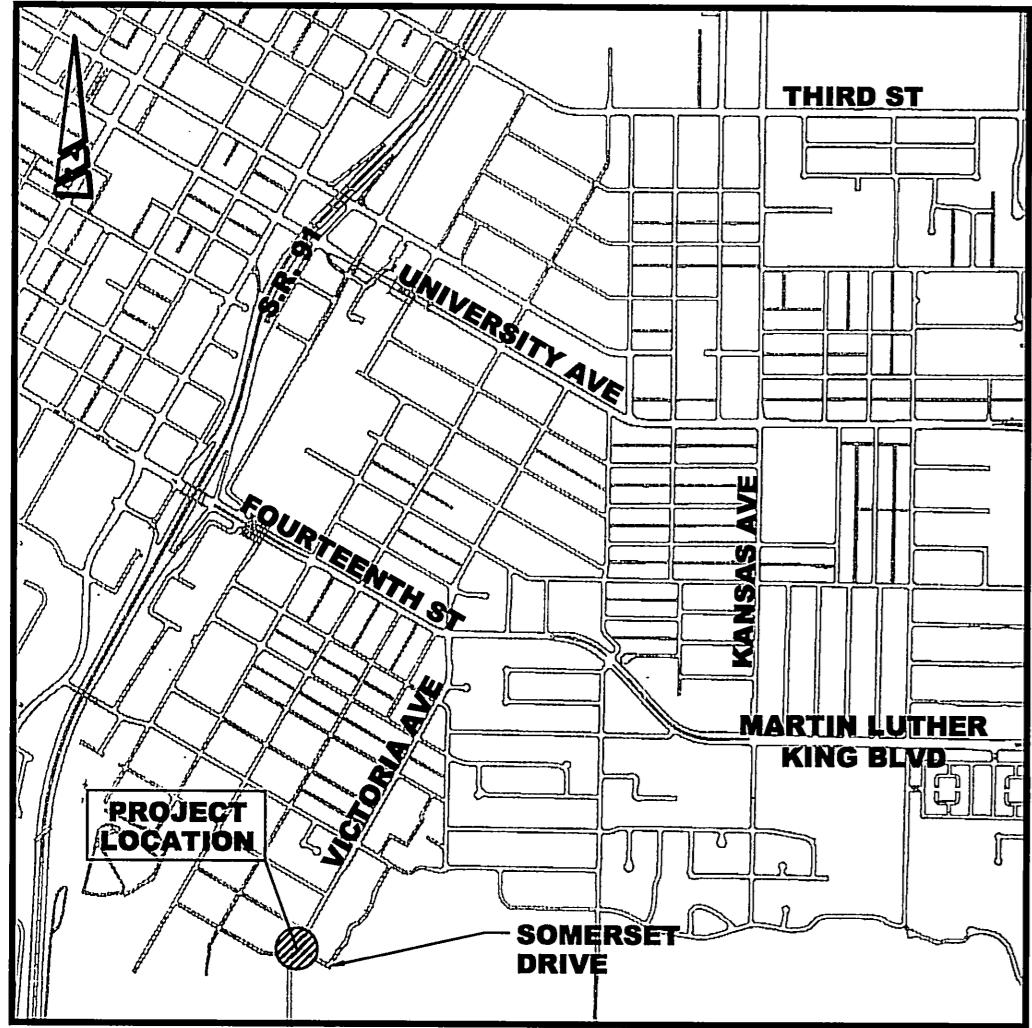

LOCATION MAP  
NTS

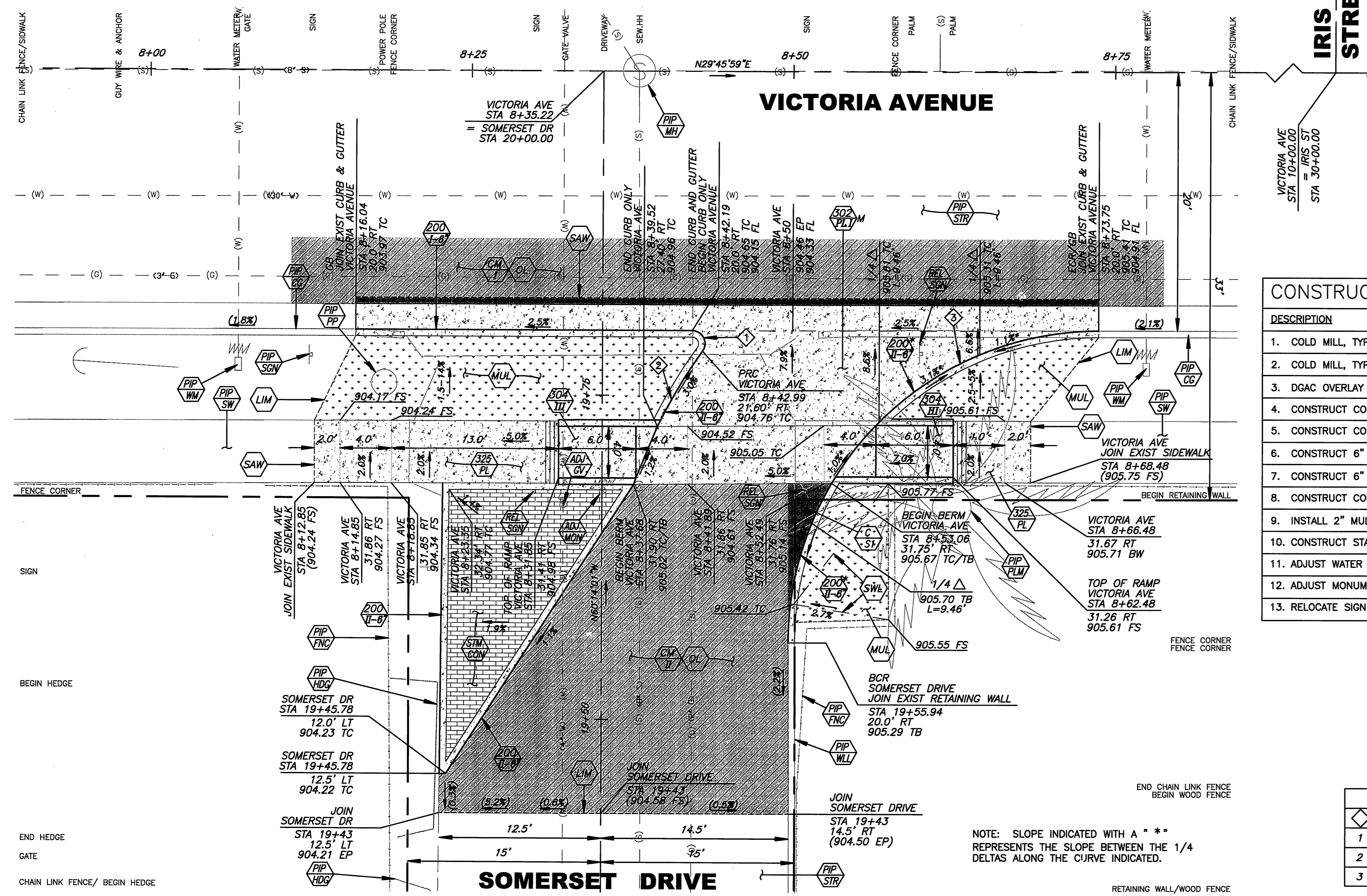

DESCRIPTION	QUANTITY
1. COLD MILL, TYPE I (.1' MIN)	70 LF
2. COLD MILL, TYPE II (0.1'-0.2')	100 SF
3. DGAC OVERLAY (0.1' MIN)	10 TN
4. CONSTRUCT CONCRETE DRIVEWAY	90 SF
5. CONSTRUCT CONCRETE WHEELCHAIR RAMP	2 EA
6. CONSTRUCT 6" CURB ONLY	360 LF
7. CONSTRUCT 6" CURB AND GUTTER	30 LF
8. CONSTRUCT CONCRETE SIDEWALK	125 SF
9. INSTALL 2" MULCH LAYER	300 SF
10. CONSTRUCT STAMPED CONCRETE	150 SF
11. ADJUST WATER GATE VALVE TO GRADE	1 EA
12. ADJUST MONUMENT TO GRADE	1 EA
13. RELOCATE SIGN	2 EA

### CONSTRUCTION NOTES

- NUMBERS ABOVE 100 IN A HEXAGON ON THE PLAN REFER TO THE RESPECTIVE STANDARD DRAWING AND SHALL BE CONSTRUCTED ACCORDINGLY, UNLESS MODIFICATIONS ARE NOTED ON THE PLAN. ANY NUMBER SHOWN BELOW THE STANDARD DRAWING NUMBER INDICATES THE SPECIFIC ALTERNATE TO BE CONSTRUCTED.
- PIP XX PROTECT IN PLACE EXISTING FACILITY (XX=TYPE, PER PLAN). THE FOLLOWING IS THE FACILITY LEGEND:  
- WM=WATER METER VALVE; MH=MANHOLE; SGN=SIGN; HDG=HEDGE; FNC=FENCE  
- WLL=WALL; CG=CURB & GUTTER; SW=SIDEWALK; STR=STREET; PLM=TWO PALM TREES
  - REL XX RELOCATE EXISTING FACILITY (XX=TYPE, PER PLAN). THE FOLLOWING IS THE FACILITY LEGEND:  
- SGN=SIGN
  - ADJ GY ADJUST TO GRADE EXISTING FACILITY (XX=TYPE, PER PLAN). THE FOLLOWING IS THE FACILITY LEGEND:  
- GV=GATE VALVE; MON=MONUMENT
  - SAW SAWCUT EXISTING PAVEMENT 6" FROM ADJACENT GUTTER LIP TO CONSTRUCT NEW CURB AND GUTTER AND REPLACE WITH FULL DEPTH DGAC.
  - CM I 5' WIDE AND 0.1' MIN DEPTH COLD MILL WITH 0.1' MIN VARIABLE DEPTH OVERLAY.
  - CM II VARIABLE WIDTH COLD MILL, WITH 0.1' MIN TO 0.2' MAX DEPTH, WITH 0.1' MIN VARIABLE DEPTH DGAC OVERLAY TO OBTAIN GRADES PER PLAN.
  - C ST CONSTRUCT STRUCTURAL SECTION OF 5" DGAC OVER 95% COMPACTED NATIVE. STRUCTURAL SECTION SHALL EXTEND BENEATH THE ENTIRE PROPOSED AC BERM.
  - MUL INSTALL 2" THICK MULCH LAYER
  - LIM LIMITS OF REMOVALS. CONTRACTOR TO PROTECT IN PLACE ADJACENT AREAS.
  - SWL GRADE SWALE AS NECESSARY TO ENSURE DRAINAGE FROM THE EXISTING ELEVATIONS FROM 6" OFF EXISTING FENCE TO 3' AWAY FROM THE PROPOSED BCR.
  - 200\* I-B CONSTRUCT CONCRETE CURB ONLY PER CITY STANDARD 200, TYPE II:  
- MODIFIED TO BE A HEIGHT OF 6".  
- NOTE: "\*" SLOPE INDICATED ALONG CURB REPRESENTS SLOPE BETWEEN 1/4 DELTAS.
  - 302 PLM CONSTRUCT CONCRETE DRIVEWAY APPROACH PER STANDARD DRAWING 302, TYPE PL-1, WITH THE FOLLOWING MODIFICATIONS:  
- THE APPROACH SHALL BE CONSTRUCTED AS INDICATED INCLUDING GEOMETRY, CURB, GRADES, ELEVATIONS, AND INCORPORATE ALL OTHER ADJACENT IMPROVEMENTS.
  - 225 PL CONSTRUCT PROPERTY LINE SIDEWALK AS INDICATED TO PROVIDE A MAXIMUM 5% LONGITUDINAL GRADE WITH 4' LANDING AREAS, BOTH WITH A CROSS SLOPE NOT TO EXCEED 2%. THE SIDEWALK SHALL TRANSITION AND JOIN EXISTING SIDEWALK WITHIN 2' BEYOND THE END OF EACH LANDING. ANY EXISTING FENCE POST FOOTINGS SHALL BE MODIFIED/RECONSTRUCTED/RELOCATED IF NECESSARY TO CONSTRUCT THE SIDEWALK AS SHOWN.
  - 315 CON CONSTRUCT 3.5" THICK STAMPED CONCRETE ISLAND. SURFACE SHALL BE STRAIGHT GRADED BETWEEN THE ELEVATIONS SHOWN. CURB HEIGHT ADJACENT TO SIDEWALK SHALL TRANSITION FROM THE SIDEWALK SURFACE ELEVATION TO A 6" HEIGHT AT THE BACK OF CURB. THE CURB ELEVATION SHOWN ON THE PLAN ADJACENT TO THE SIDEWALK REPRESENTS THE ELEVATION AT THE BACK OF CURB. THE STAMP CONCRETE SHALL BE CONSTRUCTED WITH THE FOLLOWING SPECIFICATIONS:

303-6.3.1 PATTERN APPLICATION. THE PATTERN FOR THE STAMPED CONCRETE SHALL BE "NEW BRICK-RUNNING BOND" PER L.M. SCOFIELD OR CITY APPROVED EQUAL.

ALL FINISHED CONCRETE SHALL BE PROTECTED FROM GRAFFITI. CONTRACTOR SHALL BE RESPONSIBLE FOR PROVIDING CONCRETE WATCHMEN. A FINISH WITH GRAFFITI WILL NOT BE ACCEPTED.

303-7.1.1 COLOR APPLICATION. COLOR FOR THE STAMPED CONCRETE BE QUARRY RED (C-32) PER L.M. SCOFIELD COMPANY (PHONE NO. 800-800-9900, EMAIL: .COM).

### GENERAL NOTES

- CONSTRUCTION SHALL BE IN ACCORDANCE WITH THE CITY OF RIVERSIDE STANDARD DRAWINGS AND STANDARD SPECIFICATIONS FOR PUBLIC WORKS CONSTRUCTION, 2006 EDITION.
- ALL ELEVATIONS SHOWN IN THE PLAN VIEW SHALL BE STAKED IN THE FIELD, EXCEPT FOR ELEVATIONS SHOWN IN PARENTHESIS WHICH DENOTE EXISTING GRADES.
- CUT AND FILL SLOPES SHALL BE 2:1 OR FLATTER UNLESS OTHERWISE SHOWN ON THE PLAN.
- EXISTING UTILITIES SHOWN ON THE PLANS, ARE PRECATED FROM UTILITY RECORDS THE CONTRACTOR IS REQUIRED TO TAKE DUE PRECAUTIONARY MEASURES TO LOCATE AND PROTECT ALL UTILITIES WHETHER OR NOT SHOWN ON THESE PLANS.
- ANY UNCLASSIFIED EXCAVATION, COMPACTION, AND GRADING SHALL BE COMPLETED AS REQUIRED TO CONTRUCTION ALL THE IMPROVEMENTS SHOWN HEREON.
- ALL WORK SHALL BE COMPLETED AS DESCRIBED HEREON AND AS SPECIFIED IN THE SPECIAL PROVISIONS FOR BID No 6709.

CURVE DATA TABLE					
DELTA	RADIUS	LENGTH	TANGENT	REMARK	
126°02'55"	1.00'	2.20'	1.96'	S'LY VICTORIA/SOMERSET CURB RETURN	
09°22'15"	38.00'	6.21'	3.11'	S'LY SOMERSET DRIVE CURB	
90°17'57"	24.00'	37.82'	24.13'	N'LY VICTORIA/SOMERSET CURB RETURN	

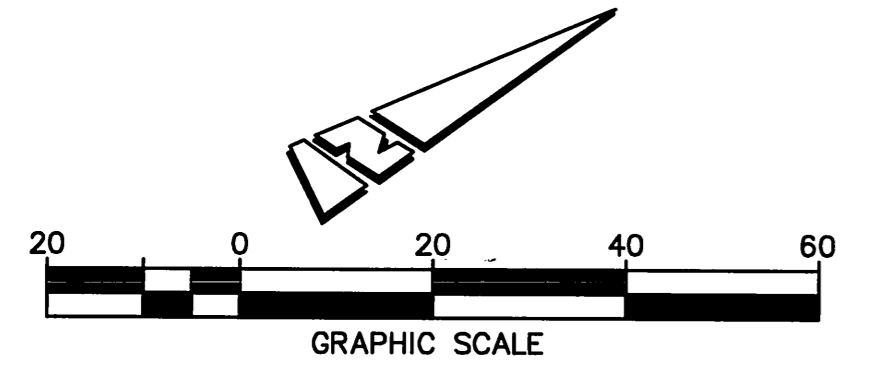

**BENCHMARK H7-A2**  
BRASS DISK STAMPED "H7-A" IN A MONUMENT WELL AT THE INTERSECTION OF VICTORIA AVENUE AND CRIDGE STREET  
ELEVATION: 909.777

**ENGINEER IN RESPONSIBLE CHARGE**  
*Edward Lara*  
EDWARD LARA  
R.C.E. No. 63763 expires 9/30/10  
DATE April 30, 2009

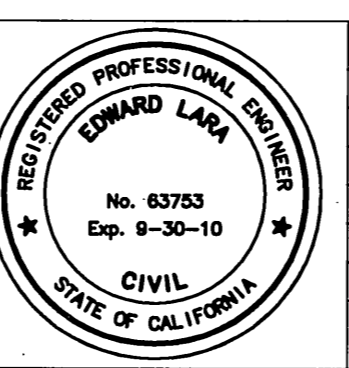

APPROVED BY:	BY:	DATE:
PRINCIPAL ENGINEER		
CONSTRUCTION ADMIN.		
SURVEYOR		
STREET SERVICES		
TRAFFIC ENGINEER		
PARK & REC. DEP.		

CITY OF RIVERSIDE, CALIFORNIA  
PUBLIC WORKS DEPARTMENT  
APPROVED BY:  
*Michael Kabisian*  
CITY ENGINEER  
DATE 4/30/09

VICTORIA AVENUE AND SOMERSET DRIVE INTERSECTION IMPROVEMENTS  
TITLE SHEET, NOTES, AND STREET IMPROVEMENT PLAN  
HORIZ. SCALE: 1"=5' VERT. SCALE: N/A

WORK ORDER NO. 0907023  
R-4130  
SHEET 1 OF 1  
FILE NO.