

HORIZ. SCALE: 1" = 20'  
VERT. SCALE: 1" = 4'

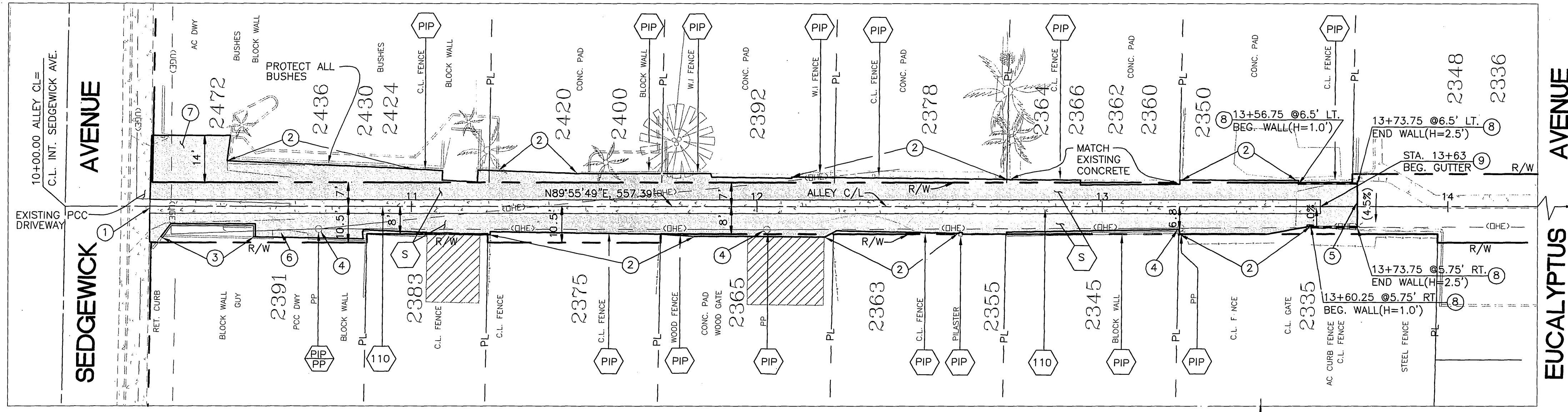

**GENERAL NOTES:**

- CONSTRUCTION SHALL BE IN ACCORDANCE WITH THE CITY OF RIVERSIDE STANDARD DRAWINGS AND STANDARD SPECIFICATIONS FOR PUBLIC WORKS CONSTRUCTION, 2006 EDITION.
- ALL ELEVATIONS SHOWN IN THE PLAN VIEW SHALL BE STAKED IN THE FIELD, EXCEPT FOR ELEVATIONS SHOWN IN PARENTHESIS WHICH DENOTE EXISTING GRADES.
- C:T AND FILL SLOPES SHALL BE 2:1 OR FLATTER UNLESS OTHERWISE SHOWN ON THE PLAN.
- EXISTING UTILITIES SHOWN ON THE PLANS, ARE PLOTTED FROM UTILITY RECORDS THE CONTRACTOR IS REQUIRED TO TAKE DUE PRECAUTIONARY MEASURES TO LOCATE AND PROTECT ALL UTILITIES WHETHER OR NOT SHOWN ON THESE PLANS.

**SPECIFIC CONSTRUCTION NOTES**

- ① NUMBERS ABOVE 100 IN A HEXAGON ON THE PLAN REFER TO THE RESPECTIVE STANDARD DRAWING AND SHALL BE CONSTRUCTED ACCORDINGLY. UNLESS MODIFICATIONS ARE NOTED ON THE PLAN OR COVER SHEET, ANY NUMBER SHOWN BELOW THE STANDARD DRAWING NUMBER INDICATES THE SPECIFIC ALTERNATE TO BE CONSTRUCTED.
- PIP PROTECT IN PLACE EXISTING FEATURE.
- S CONSTRUCT 6" OF FULL DEPTH DGAC OVER COMPACTED NATIVE.
- ① THE GUTTER CROSS SECTION SHALL TRANSITION TO MEET THE FINISHED SURFACE WITHIN THE LAST 4'
- ② INSTALL 2"x4" REDWOOD HEADER PER CITY STANDARD DRAWING 110
- ③ CONSTRUCT RETAINING CURB. HEIGHT ABOVE FINISHED SURFACE VARIES 6" TO 18". DEPTH BELOW FINISHED SURFACE SHALL BE 30".
- ④ INSTALL 3 REFLECTIVE STRIPES ON EXISTING POWER POLE, 1' ON CENTER FROM 3' TO 4' ABOVE GROUND. (TECH PRODUCTS, INC OR EQUAL)
- ⑤ SAWCUT AND REMOVE EXISTING IMPROVEMENTS.
- ⑥ REMOVE INTERFERING CONCRETE IMPROVEMENTS.
- ⑦ REMOVE EXISTING AC AT DRIVEWAY. PLACE NEW AC AT 6" DEEP AND MATCH EXISTING.
- ⑧ CONSTRUCT 2.5' TALL MAX. RETAINING WALL PER CITY OF RIVERSIDE STD. DWG. 707. TOP OF WALL SHALL BE 6" ABOVE FINISHED SURFACE OF PAVEMENT AND TOP OF FOOTING SHALL HAVE MIN. 6" OF COVER. BLOCKS SHALL BE PRECISION GREY WITH MATCHING CAP.
- ⑨ FROM STATION 13+63.00 TO STATION 13+73.75 THERE IS A PAVEMENT CROSS-SLOPE TRANSITION. PAVEMENT SHALL TRANSITION FROM 4.5% AWAY FROM CENTERLINE AT STATION 13+73.75 ON THE EXISTING PAVEMENT TO 1.0% TOWARD THE CENTERLINE AT STATION 13+63.00 ON THE PROPOSED PAVEMENT.
- ⑩ CONSTRUCT 3/4" AGGREGATE BASE WRAPPED IN MIRAFI 140N GEOTEXTILE FABRIC OR EQUIVALENT CONTINUOUSLY UNDER ALLEY GUTTER. ALLEY GUTTER SHALL BE CONSTRUCTED WITH PERVIOUS CONCRETE AS SPECIFIED IN SPECIAL PROVISIONS.

**HATCHING LEGEND**



**EXISTING UNDERGROUND UTILITIES:**

SANITARY SEWER	(S)
WATER LINE	(W)
GAS	(G)
UNDERGROUND ELECTRIC	(UE)
UNDERGROUND CABLE	(UC)
UNDERGROUND TELEPHONE	(UT)
OVERHEAD ELECTRIC	(OUE)
OVERHEAD CABLE	(OUC)
OVERHEAD TELEPHONE	(OHT)

**LEGEND**

(754.76)	EXISTING ELEVATION	CL	CENTERLINE
754.76	PROPOSED ELEVATION	GB	GRADE BREAK
TC	TOP OF CURB	AC	ASPHALTIC CONCRETE
EP	EDGE OF PAVEMENT	PCC	PORTLAND CEMENT CONCRETE
FL	FLOWLINE	STA	STREET STATION
FS	FINISHED SURFACE	PI	POINT OF INTERSECTION
PP	POWER POLE	R/W	RIGHT OF WAY
SL	STREET LIGHT	V.C.	VERTICAL CURVE
WIF	WROUGHT IRON FENCE	BVC	BEGIN VERTICAL CURVE
CLF	CHAIN LINK FENCE	EVC	END VERTICAL CURVE

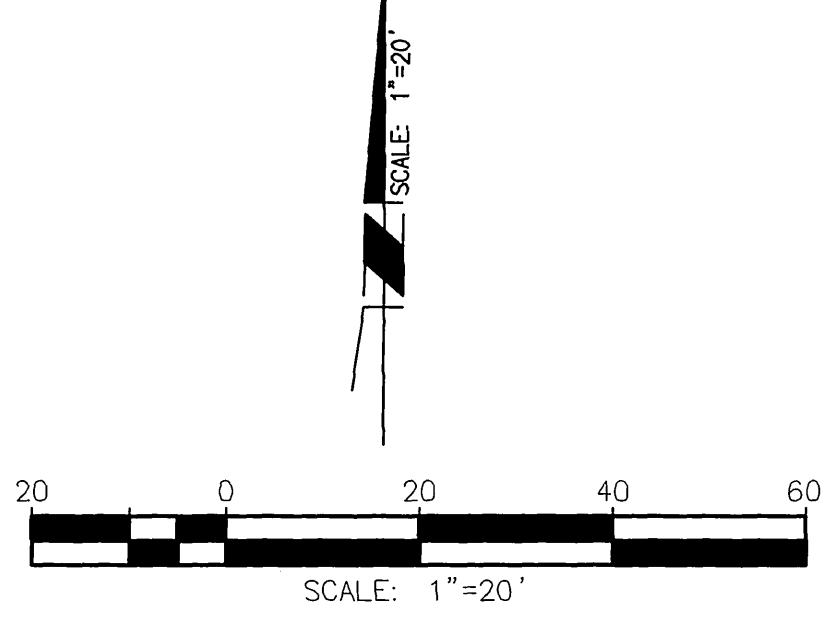

**BENCHMARK 17-H3**  
ELEVATION: 914.011  
P.K. NAIL IN THE BASE OF A STREET LIGHT POLE AT THE BACK OF A SOUTHERLY CURB OF UNIVERSITY AVENUE, 27 FEET EASTERLY OF THE CENTERLINE OF COMER AVENUE PRODUCED.

**ENGINEER IN RESPONSIBLE CHARGE**  
*Abraham A. Massoud*  
ABRAHAM A. MASSOUD  
R.C.E. No. 64224 expires 6/30/11  
DATE: 1/8/2010



DESIGNED BY	CS	DRAWN BY	CS	CHECKED BY	MT
APPROVED BY	BY	DATE			
SURVEYOR	CS	1/8/10			
STREET SERVICES	CS	1/14/10			
CONSTRUCTION ADMIN.	AB	1/12/10			
ENGINEERING MANAGER	PA	1/13/10			

CITY OF RIVERSIDE, CALIFORNIA	ALLEY IMPROVEMENTS
PUBLIC WORKS DEPARTMENT	SOUTH OF UNIVERSITY AVE. BETWEEN SEDGEWICK ST. AND EUCALYPTUS AVE.
APPROVED BY	<i>[Signature]</i>
CITY ENGINEER	DATE: 1/13/10

DESIGN NO. 1014988  
CONSTRUCTION NO. NO.  
**R-4147**  
SHEET 1 OF 1  
FILE NO.

HORIZ. SCALE: 1"=20'	VERT. SCALE: 1"=4'
----------------------	--------------------