

## PUBLIC WORKS DEPARTMENT DAUCHY AVENUE STREET IMPROVEMENTS (VAN BUREN BOULEVARD TO 700' SOUTHERLY)

### CONSTRUCTION NOTES:

- NUMBERS ABOVE 100 IN A HEXAGON ON THE PLAN REFER TO THE RESPECTIVE STANDARD DRAWING AND SHALL BE CONSTRUCTED ACCORDINGLY. UNLESS MODIFICATIONS ARE NOTED ON THE PLAN OR COVER SHEET, ANY NUMBER SHOWN BELOW THE STANDARD DRAWING NUMBER INDICATES THE SPECIFIC ALTERNATE TO BE CONSTRUCTED.
- ADJ ADJUST TO GRADE, DESCRIPTION PER PLAN. (WM) WATER METER OR VAULT. (GV) GATE VALVE.
- PIP PROTECT IN PLACE, DESCRIPTION PER PLAN.
- OL OVERLAY EXISTING PAVEMENT WITH 1" MINIMUM THICKNESS A.R.H.M.-GG-C.
- G COLD MILL EXISTING A.C. PAVEMENT TO A UNIFORM DEPTH OF 1".
- S CONSTRUCT 3" (B-PG-64-10) DGAC OVER 5" COMPACTED AGGREGATE BASE MATERIAL. DOES NOT INCLUDE 1" OVERLAY CAP.
- W EXISTING WATER METER TO BE RELOCATED BY CITY OF RIVERSIDE PUBLIC UTILITIES.
- REL MB RELOCATE EXISTING MAILBOX TO BEHIND PROPOSED CURB TO MEET UNITED STATES POSTAL SERVICE (USPS) GUIDELINES.
- REL SGN RELOCATE STREET SIGN TO BACK OF PROPOSED IMPROVEMENTS.
- R&R SGN REMOVE AND REPLACE STREET SIGN TO BEHIND PROPOSED IMPROVEMENTS.
- SC SAWCUT AND REMOVE ALL EXISTING IMPROVEMENTS NECESSARY TO CONSTRUCT PROPOSED IMPROVEMENTS.
- REL TRASH EXISTING TRASH BIN SHALL BE RELOCATED BY PROPERTY OWNER PRIOR TO CONSTRUCTION. CONTRACTOR SHALL REMOVE AND RETURN REMAINING RAILROAD TIE ENCLOSURE TO PROPERTY OWNER.
- 1 CONSTRUCT RETAINING CURB MONOLITHIC WITH SIDEWALK (H=0"-6").
- 2 TRIM EXISTING TREE AS DIRECTED BY ENGINEER.

### GENERAL NOTES:

1. EXISTING UTILITIES SHOWN ON THIS PLAN ARE PLOTTED FROM UTILITY RECORDS. THE CONTRACTOR IS REQUIRED TO TAKE DUE PRECAUTIONARY MEASURES TO LOCATE AND PROTECT ALL UTILITIES WHETHER OR NOT SHOWN ON THIS PLAN.
2. ANY TEMPORARY TRAFFIC CONTROL STRIPING OBLITERATED AND/OR BADLY WORN DURING CONSTRUCTION SHALL BE RESTORED BY THE CONTRACTOR WITHIN ONE DAY AFTER NOTIFICATION FROM THE CITY INSPECTOR.
3. WHERE NEW PAVEMENT IS TO JOIN THE EXISTING PAVEMENT, THE EDGE OF THE EXISTING PAVEMENT SHALL BE TRIMMED IN A SMOOTH AND STRAIGHT LINE. CONSTRUCT MATCH-UP PAVING AS DIRECTED IN THE FIELD TO PRODUCE A SMOOTH SECTION.
4. SURVEY STAKING REQUESTS AND GRADE SHEETS ARE REQUIRED FOR THE REPLACEMENT OF ALL CURBS AND/OR GUTTER OVER 50' IN LENGTH. SURVEY REQUESTS SHALL BE SUBMITTED AFTER THE EXISTING IMPROVEMENTS HAVE BEEN REMOVED. CONTRACTOR SHALL ALLOW 4 WORKING DAYS AFTER REQUESTING SURVEY TO SCHEDULE SURVEY AND PROCESS GRADE SHEETS. CONTRACTOR SHALL PROVIDE TRAFFIC CONTROL FOR ALL REQUIRED CONSTRUCTION SURVEY WORK BY CITY PERSONNEL.
5. ALL EXISTING FENCING AND POWER POLES SHALL BE PROTECTED-IN-PLACE.
6. CONTRACTOR SHALL REMOVE ALL EXISTING DRIVEWAY CULVERT PIPES AS PART OF CLEARING AND GRUBBING.
7. CONTRACTOR SHALL REPLACE ALL DAMAGED STRIPING IN KIND.

### R-4173 SHEET INDEX: STREET IMPROVEMENTS

SHEET NO.	DESCRIPTION
1	TITLE SHEET
2	DAUCHY AVENUE STA 3+22.82 TO STA 6+50.00
3	DAUCHY AVENUE STA 6+50.00 TO STA 9+27.10

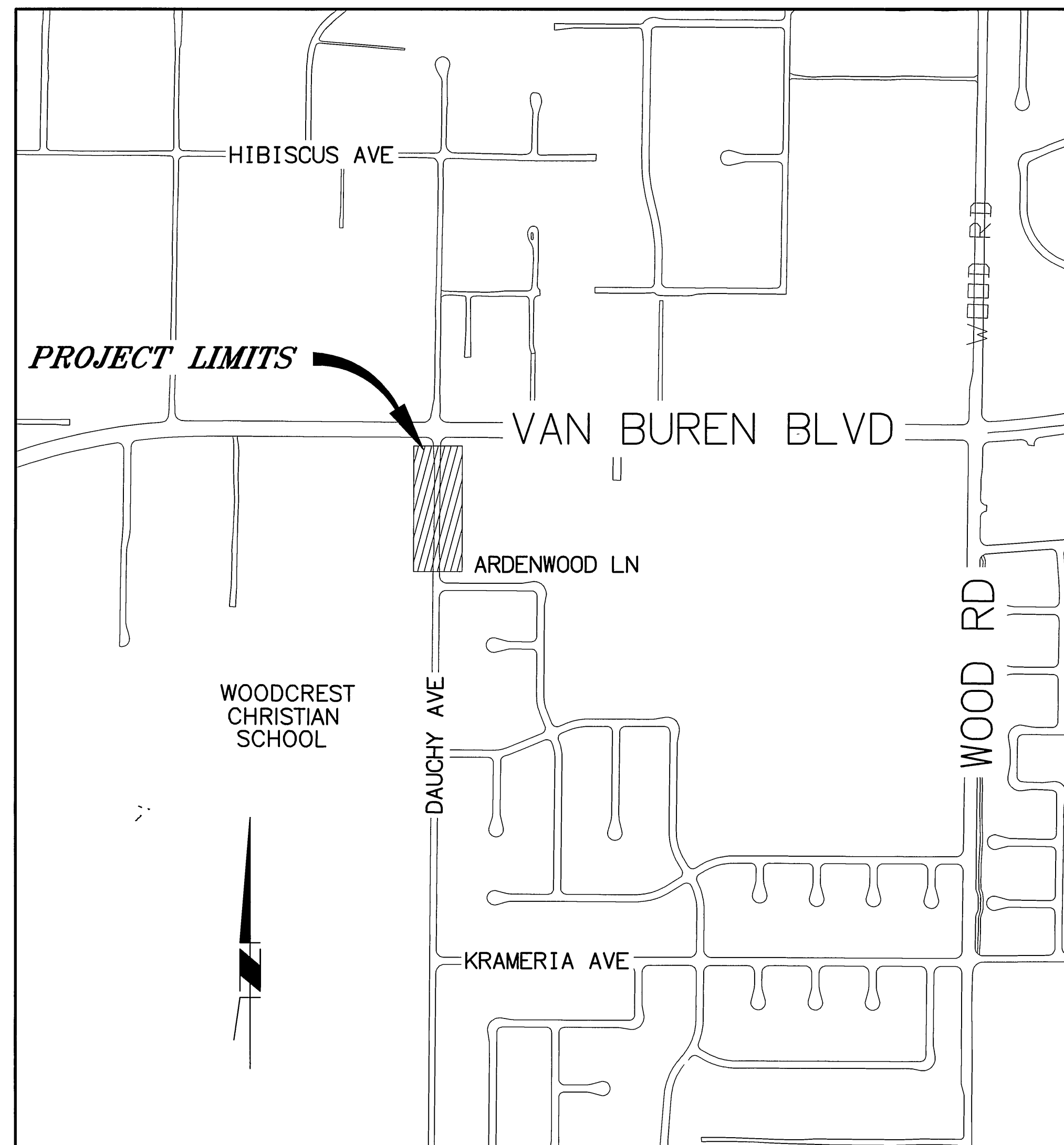

### EXISTING TOPOGRAPHY:

- Sanitary Sewer M.H.
- Storm Drain M.H.
- Water Gate Valve
- Electric M.H.
- Telephone M.H.
- Water Meter
- Fire Hydrant
- Irrigation Meter
- Blow-off Valve
- Traffic Sign
- Power Pole
- Guy Anchor
- Street Light on Mast Arm
- Electrical Test Station (Pipeline)
- PCC Pavement
- Palm Tree
- Misc. Tree
- Building
- Top of Slope
- Toe of Slope
- Edge of Pavement
- Direction Drainage Flow

### LEGEND

- AC PAVEMENT
- PCC
- GRIND

### EXISTING UNDERGROUND UTILITIES:

- Sanitary Sewer (S)
- Water Line (W)
- Underground Electric (E)
- Gas (G)

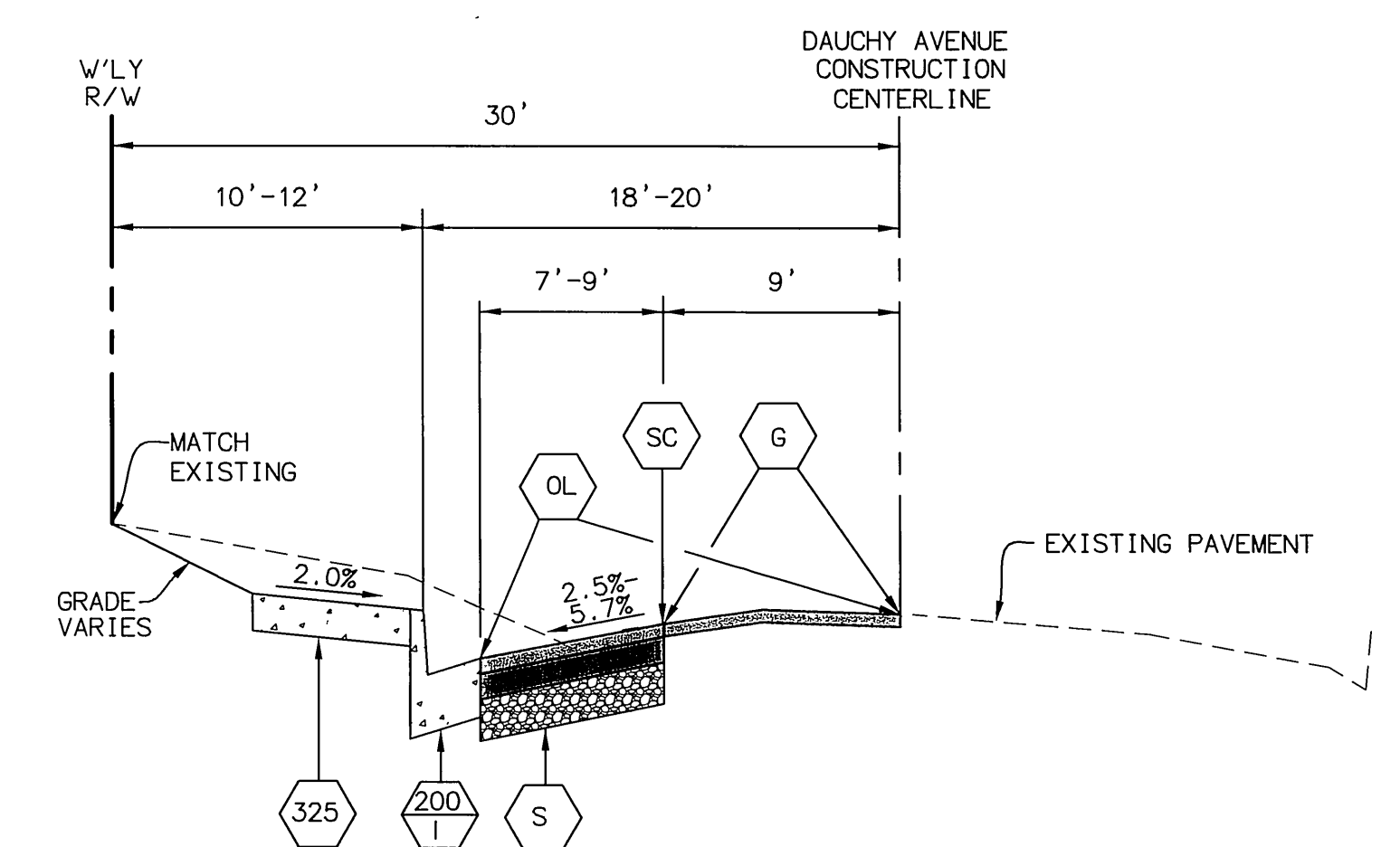

<b>CONTROL POINT 5560</b> ELEVATION: 1602.06 INTERSECTION OF VAN BUREN AND DAUCHY. FD NAIL IN PATCH FLUSH PER TIES.	ENGINEER IN RESPONSIBLE CHARGE <b>Farshid Mohammadi</b> FARSHID AGHA MOHAMMADI R.C.E. No. 51304 expires 6/30/12 DATE 7/27/10	APPROVED BY: BY: DATE SURVEYOR: S 7/26/10 STREET SERVICES: JSP 7/29/10 CONSTRUCTION ADMIN: PC 7/27/10 ENGINEERING MANAGER: PH 7/27/10	CITY OF RIVERSIDE, CALIFORNIA PUBLIC WORKS DEPARTMENT APPROVED BY: [Signature] CITY ENGINEER DATE 7/27/10	DAUCHY AVENUE STREET IMPROVEMENTS FROM VAN BUREN BOULEVARD TO 700' SOUTHERLY TITLE SHEET HORIZ. SCALE: N/A VERT. SCALE: N/A	DESIGN W.D. NO.: 1026917 CONSTRUCTION W.D. NO.: 102000X
					MARK REVISIONS APRR. DATE DESIGNED BY CS DRAWN BY CS CHECKED BY FAM

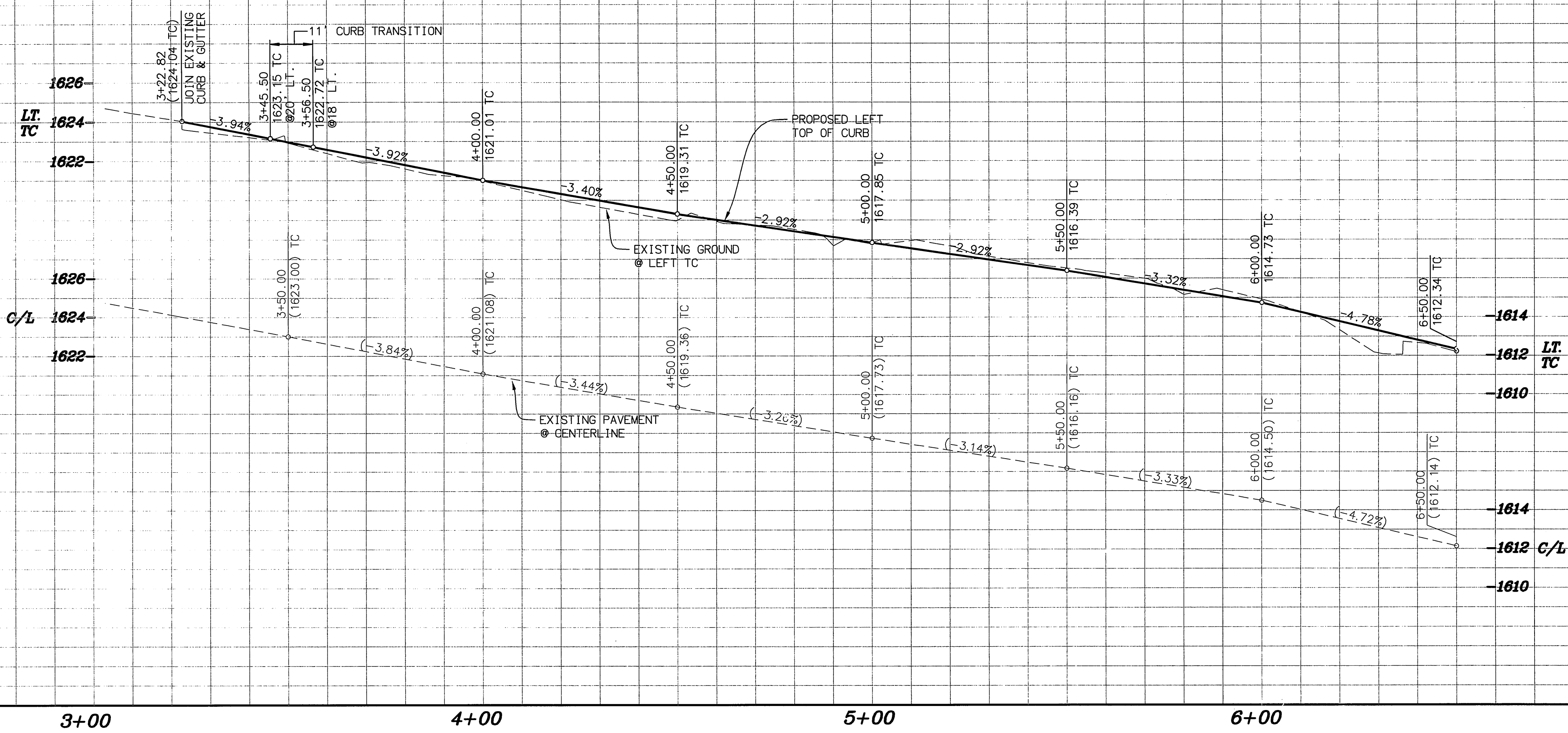

HORZ. SCALE: 1" = 20'  
 VERT. SCALE: 1" = 4'

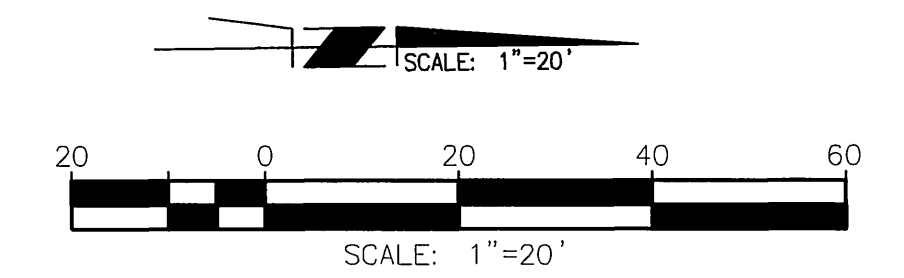
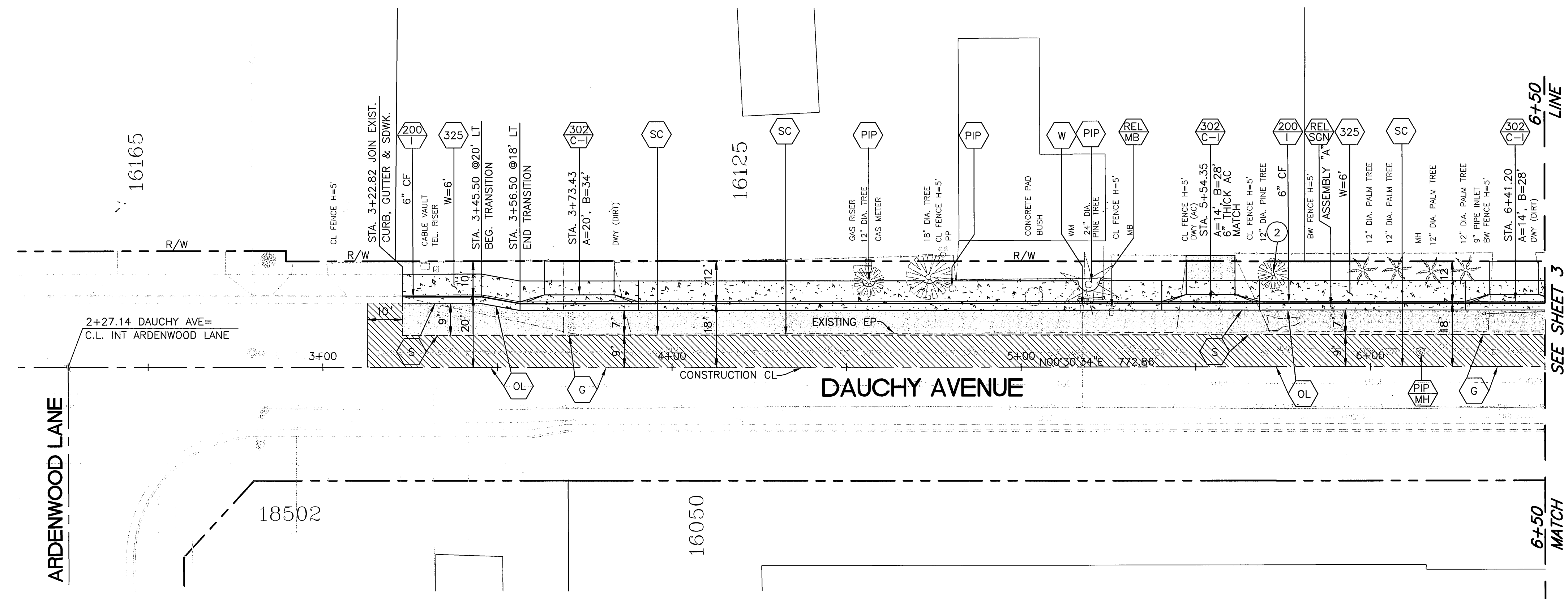

**CONTROL POINT 5560**  
 ELEVATION: 1602.06  
 INTERSECTION OF VAN BUREN AND DAUCHY.  
 FD NAIL IN PATCH FLUSH PER TIES.

**ENGINEER IN RESPONSIBLE CHARGE**  
 Farshid Mohammadi  
 FARSHID AGHA MOHAMMADI  
 R.C.E. No. 51304 expires 6/30/12  
 DATE 7/27/10



MARK	REVISIONS	APPR.	DATE

APPROVED BY	BY	DATE
	CS	7/26/10
	DC	7-29-10
	DC	7/27/10
	PL	7/27/10

CITY OF RIVERSIDE, CALIFORNIA  
 PUBLIC WORKS DEPARTMENT  
 APPROVED BY  
 [Signature]  
 CITY ENGINEER  
 DATE 7/27/10

DAUCHY AVENUE  
 STREET IMPROVEMENTS  
 FROM VAN BUREN BOULEVARD TO  
 700' SOUTHERLY  
 3+22.82 TO 6+50.00  
 HORIZ. SCALE: 1"=20' VERT. SCALE: 1"=4'

DESIGN NO. 1028917  
 CONSTRUCTION NO. 102000X  
**R-4173**  
 SHEET 2 OF 3  
 FILE NO.



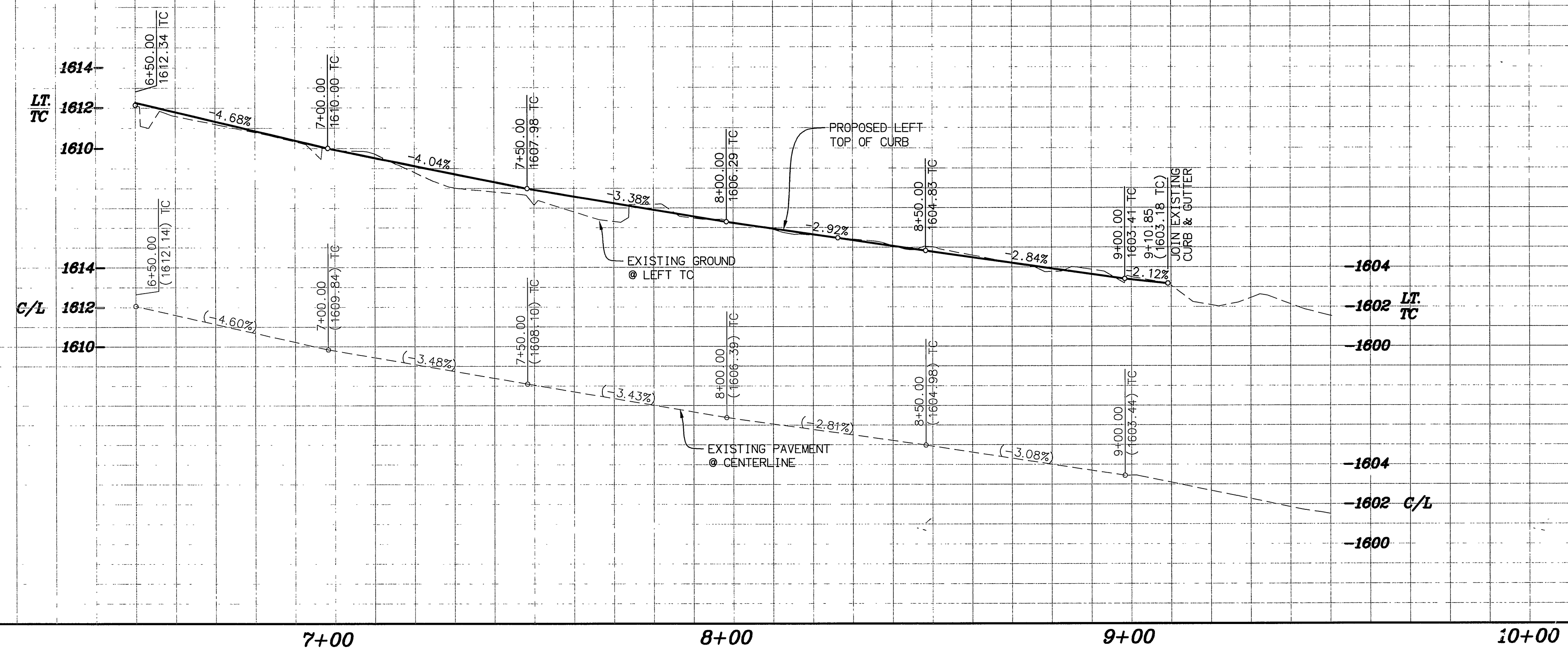

HORZ. SCALE: 1" = 20'  
VERT. SCALE: 1" = 4'

6+00 7+00 8+00 9+00 10+00

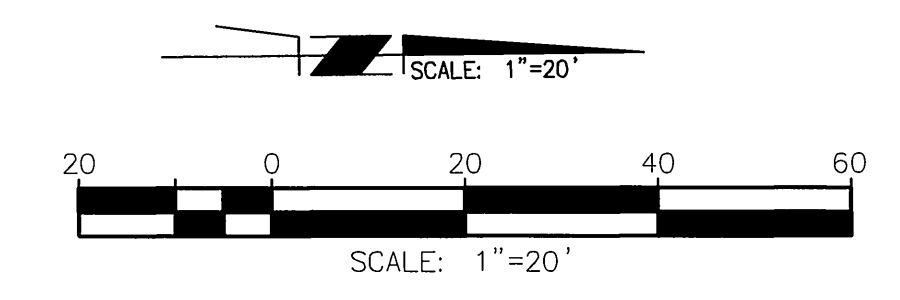
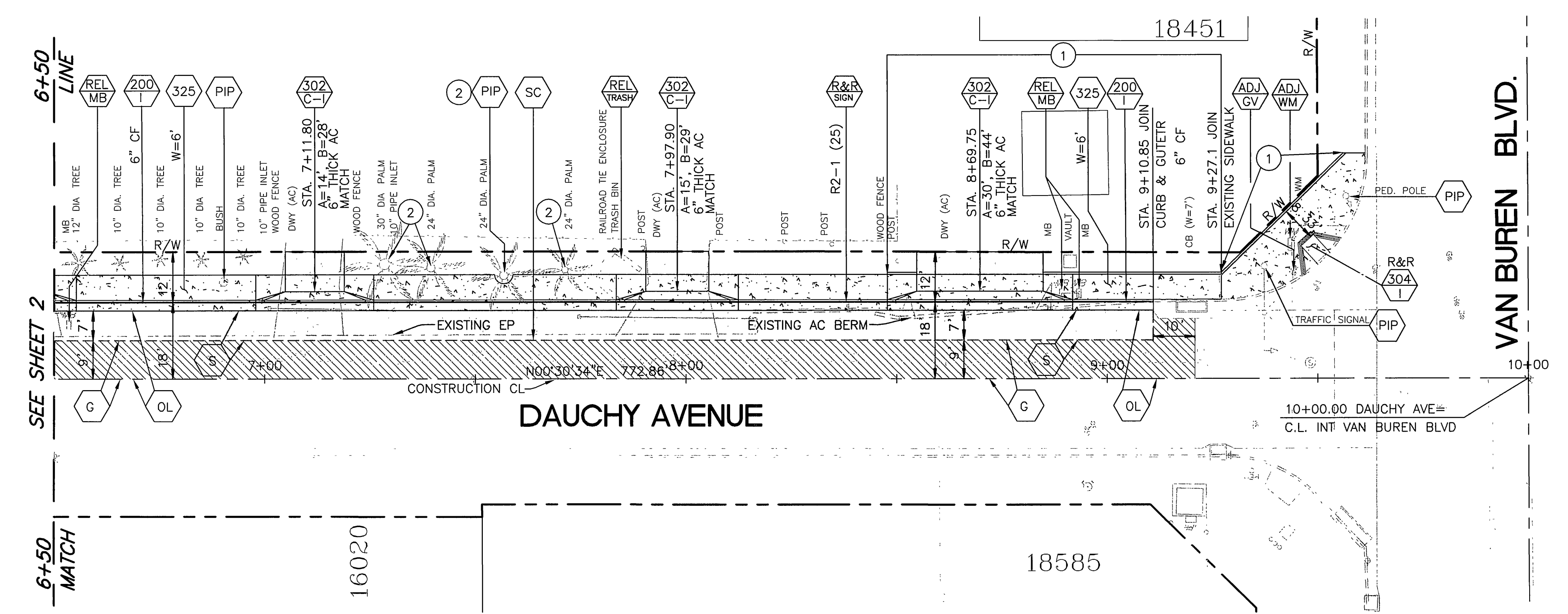

**CONTROL POINT 5560**  
ELEVATION: 1602.06  
INTERSECTION OF VAN BUREN AND DAUCHY.  
FD NAIL IN PATCH FLUSH PER TIES.

**ENGINEER IN RESPONSIBLE CHARGE**  
Farshid Mohammadi  
FARSHID AGHA MOHAMMADI  
R.C.E. No. 51304 expires 6/30/12  
DATE 7/27/10



DESIGNED BY	CS	DRAWN BY	CS	CHECKED BY	FAM
MARK		REVISIONS		APPR.	DATE

APPROVED BY	BY	DATE
SURVEYOR	CS	1/26/10
STREET SERVICES	SPB	7/23/10
CONSTRUCTION ADMIN.	DC	7/27/10
ENGINEERING MANAGER	PH	7/27/10

CITY OF RIVERSIDE, CALIFORNIA  
PUBLIC WORKS DEPARTMENT  
APPROVED BY  
CITY ENGINEER  
DATE 7/27/10

DAUCHY AVENUE  
STREET IMPROVEMENTS  
FROM VAN BUREN BOULEVARD TO  
700' SOUTHERLY  
6+50 TO 9+27.10  
HORIZ. SCALE: 1"=20' VERT. SCALE: 1"=4'

DESIGN W.G. NO. 1026917  
CONSTRUCTION W.G. NO. 1022000  
R-4173  
SHEET 3 OF 3  
FILE NO.