

**CONSTRUCTION NOTES:**

- NUMBERS ABOVE 100 IN A HEXAGON ON THE PLAN REFER TO THE RESPECTIVE STANDARD DRAWING AND SHALL BE CONSTRUCTED ACCORDINGLY. UNLESS MODIFICATIONS ARE NOTED ON THE PLAN OR COVER SHEET. ANY NUMBER SHOWN BELOW THE STANDARD DRAWING NUMBER INDICATES THE SPECIFIC ALTERNATE TO BE CONSTRUCTED.
- 325 CONSTRUCT P.C.C. SIDEWALK PER CITY STANDARD NO 325
- 304 CONSTRUCT P.C.C. WHEELCHAIR RAMP PER CITY STANDARD DRAWING 304. TYPE AND LOCATION OF RAMP MAY CHANGE DURING CONSTRUCTION TO FIT SITE CONDITION AS DIRECTED BY THE ENGINEER. ENSURE THE PROPOSED RAMP DOES NOT ENCR OACH INTO PRIVATE PROPERTY.
- PIP PROTECT IN PLACE EXISTING EQUIPMENT OR CONDITION
- ADJ. WM ADJUST WATER METER VAULT TO GRADE
- R/R WM REMOVE AND REPLACE EXISTING WATER METER VAULT TO GRADE
- REL RELOCATE EXISTING SIGN, TREE OR OBJECT, AS SHOWN ON PLAN, AS DIRECTED BY THE ENGINEER AND/OR PROPERTY OWNER
- 302 CONSTRUCT P.C.C. DRIVEWAY APPROACH PER CITY STANDARD DRAWING 302. MATCH-UP LIMITS FOR DRIVEWAY MAY CHANGE AT THE TIME OF CONSTRUCTION FROM LIMITS NOTED ON PLANS TO ENSURE PROPER TRANSITION BETWEEN PROPOSED AND THE EXISTING IMPROVEMENTS.
- REM REMOVE AND DISPOSE EXISTING IMPROVEMENTS OR OBJECTS IN CONFLICT WITH PROPOSED CONSTRUCTION AND/OR IMPROVEMENTS BACK TO THE R.O.W.
- 1 REMOVE AND REPLACE EXISTING PORTION OF P.C.C. DRIVEWAY (6" THICK) PER CITY OF RIVERSIDE STANDARD DWG. 302.
- 2 REMOVE AND REPLACE PORTION OF P.C.C. SIDEWALK (3.5" THICK) PER CITY OF RIVERSIDE STANDARD DWG. 325.
- 3 REMOVE AND REPLACE EXISTING CURB AND GUTTER PER STD. DWG. 200.
- 4 COMPLETELY REMOVE TREE STUMPS AND REPLACE WITH SUITABLE FILL AND SOD. REPAIR IRRIGATION IF DAMAGED OR CHANGED.
- 5 REMOVE AND RECONSTRUCT PORTION OF BRICK PLANTER TO THE FRONT OF PROPOSED SIDEWALK. RELOCATE LANDSCAPING ACCORDINGLY AS DIRECTED BY THE ENGINEER AND/OR PROPERTY OWNER.
- 6 REMOVE PORTION OF BLOCK WALL (H=24") TO BACK OF PROPOSED SIDEWALK AND PATCH ACCORDINGLY AS DIRECTED BY ENGINEER AND/OR PROPERTY OWNER.
- 7 REMOVE AND RECONSTRUCT PORTION OF DRIVEWAY IN KIND WITH THE DIRECTION OF THE ENGINEER AND/OR PROPERTY OWNER.
- 8 REMOVE PORTION OF CONCRETE CURB TO THE BACK OF THE PROPOSED SIDEWALK.
- 9 REMOVE PORTION OF EXISTING BRICK WALKWAY TO ALLOW FOR THE CONSTRUCTION OF THE PROPOSED SIDEWALK.

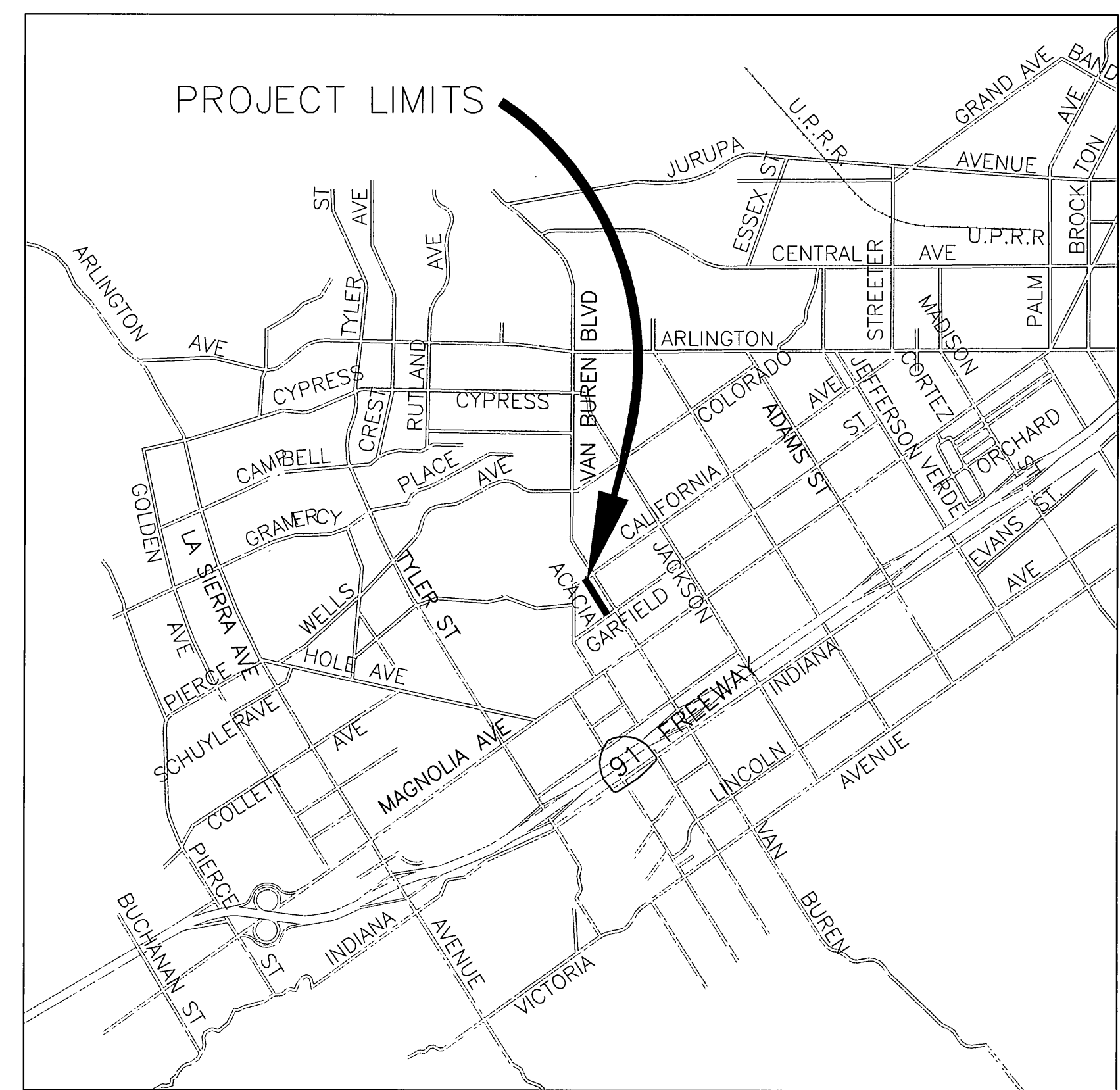

LOCATION MAP

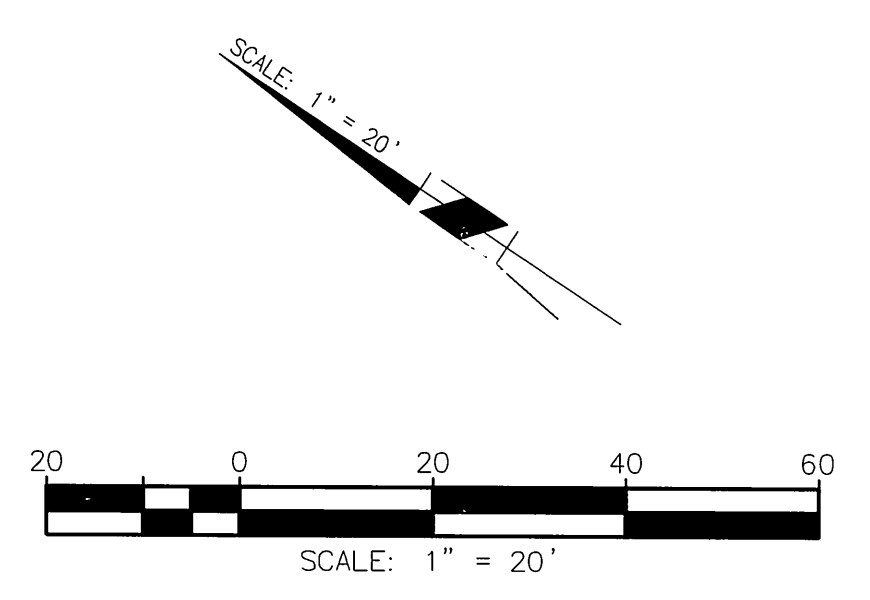

Under Ground Service Alert of Southern California  
Call: TOLL FREE 1-800 227-2600  
TWO WORKING DAYS BEFORE YOU DIG

**ENGINEER IN RESPONSIBLE CHARGE**  
Philip L. Hannawi  
R.C.E. No. 69170 EXPIRES: 3-31-12  
DATE: 2/7/2011

| MARK | REVISIONS | APPR. | DATE |
|------|-----------|-------|------|
|      |           |       |      |

CITY OF RIVERSIDE, CALIFORNIA  
DEPARTMENT OF PUBLIC WORKS

|                     |    |         |             |
|---------------------|----|---------|-------------|
| APPROVED BY         | BY | DATE    | APPROVED BY |
|                     | PH | 2/7/11  |             |
| CONSTRUCTION ADMIN. | AS | 2/23/11 |             |
| TRAFFIC DIVISION    |    | 2/18/11 |             |
| STREET SERVICES     |    |         |             |
| SURVEY DIVISION     |    |         |             |

DATE: 2/23/11

**SIDEWALK CONSTRUCTION**

ACACIA STREET FROM CALIFORNIA AVENUE TO GARFIELD STREET

SCALE: 1" = 20'

ACCT. NO. W.O. NO. 1077123  
**R-4173**  
SHEET 1 OF 2  
FILE NAME: R-4173.DWG

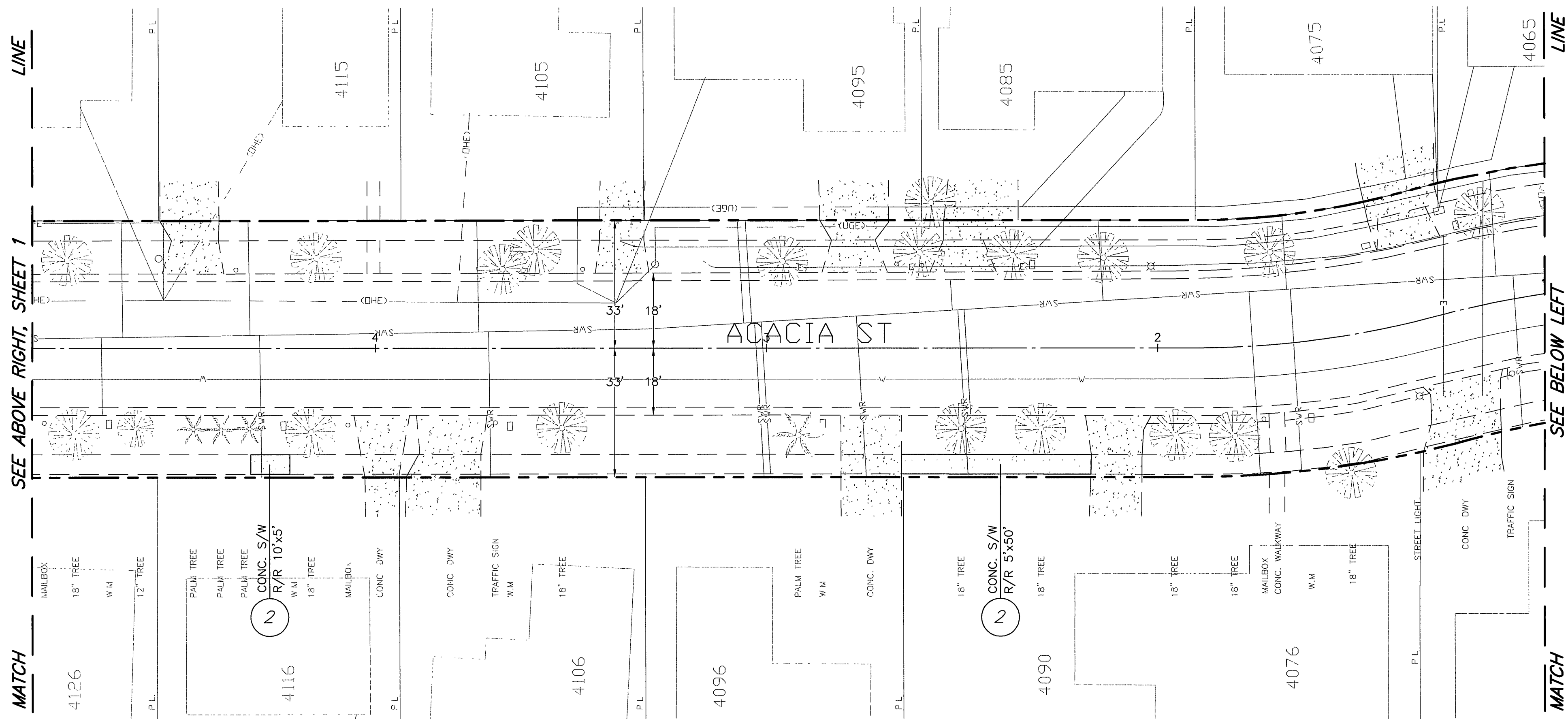

- NUMBERS ABOVE 100 IN A HEXAGON ON THE PLAN REFER TO THE RESPECTIVE STANDARD DRAWING AND SHALL BE CONSTRUCTED ACCORDINGLY. UNLESS MODIFICATIONS ARE NOTED ON THE PLAN OR COVER SHEET. ANY NUMBER SHOWN BELOW THE STANDARD DRAWING NUMBER INDICATES THE SPECIFIC ALTERNATE TO BE CONSTRUCTED.
- 325 CONSTRUCT P.C.C. SIDEWALK PER CITY STANDARD NO 325
- 304 CONSTRUCT P.C.C. WHEELCHAIR RAMP PER CITY STANDARD DRAWING 304. TYPE AND LOCATION OF RAMP MAY CHANGE DURING CONSTRUCTION TO FIT SITE CONDITION AS DIRECTED BY THE ENGINEER. ENSURE THE PROPOSED RAMP DOES NOT ENCROACH INTO PRIVATE PROPERTY.
- PIP PROTECT IN PLACE EXISTING EQUIPMENT OR CONDITION
- ADJ ADJUST WATER METER VAULT TO GRADE
- R/R REMOVE AND REPLACE EXISTING WATER METER VAULT TO GRADE
- REL RELOCATE EXISTING SIGN, TREE OR OBJECT, AS SHOWN ON PLANS, AS DIRECTED BY THE ENGINEER AND/OR PROPERTY OWNER.
- 302 CONSTRUCT P.C.C. DRIVEWAY APPROACH PER CITY STANDARD DRAWING 302. MATCH-UP LIMITS FOR DRIVEWAYS MAY CHANGE AT THE TIME OF CONSTRUCTION FROM LIMITS NOTED ON PLANS TO ENSURE PROPER TRANSITION BETWEEN PROPOSED AND THE EXISTING IMPROVEMENTS.
- REM REMOVE AND DISPOSE EXISTING IMPROVEMENTS OR OBJECTS IN CONFLICT WITH PROPOSED CONSTRUCTION AND/OR IMPROVEMENTS BACK TO THE R.O.W.
- 1 REMOVE AND REPLACE EXISTING PORTION OF P.C.C. DRIVEWAY (6" THICK) PER CITY OF RIVERSIDE STANDARD DWG. 312
- 2 REMOVE AND REPLACE PORTION OF P.C.C. SIDEWALK (3.5' THICK) PER CITY OF RIVERSIDE STANDARD DWG. 325.
- 3 REMOVE AND REPLACE EXISTING CURB AND GUTTER PER STD. 200.
- 4 COMPLETELY REMOVE TREE STUMPS AND REPLACE WITH SUITAIBLE FILL AND SOD. REPAIR IRRIGATION IF DAMAGED OR CHANGED.
- 5 REMOVE AND RECONSTRUCT PORTION OF BRICK PLANTER TO THE FRONT OF PROPOSED SIDEWALK. RELOCATE LANDSCAPING ACCORDINGLY AS DIRECTED BY THE ENGINEER AND/OR PROPERTY OWNER.
- 6 REMOVE PORTION OF BLOCK WALL (H=24") TO BACK OF PROPOSED SIDEWALK AND PATCH ACCORDINGLY AS DIRECTED BY ENGINEER AND/OR PROPERTY OWNER.
- 7 REMOVE AND RECONSTRUCT PORTION OF DRIVEWAY IN KIND WITH THE DIRECTION OF THE ENGINEER AND/OR PROPERTY OWNER.
- 8 REMOVE PORTION OF CONCRETE CURB TO THE BACK OF THE PROPOSED SIDEWALK.
- 9 REMOVE PORTION OF EXISTING BRICK WALKWAY TO ALLOW FOR THE CONSTRUCTION OF THE PROPOSED SIDEWALK.

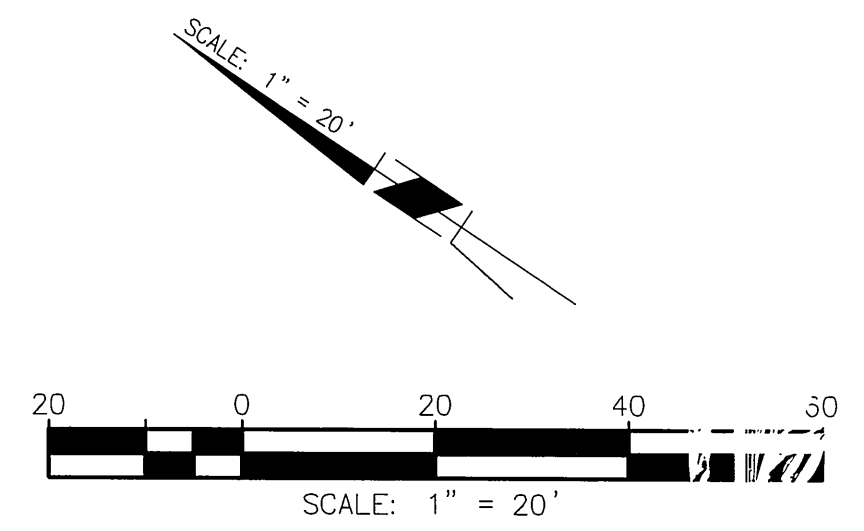

Under Ground Service Alert of Southern California  
 Call: TOLL FREE 1-800-227-2600  
 TWO WORKING DAYS BEFORE YOU DIG

**ENGINEER IN RESPONSIBLE CHARGE**  
 PHILIP L. HANNAWAY  
 R.C.E. No. 69170 EXPIRES: 3-31-12  
 DATE: 2/7/2011

| MARK | REVISIONS | APPR. | DATE |
|------|-----------|-------|------|
|      |           |       |      |
|      |           |       |      |

**CITY OF RIVERSIDE, CALIFORNIA  
 DEPARTMENT OF PUBLIC WORKS**

|                     |    |         |                    |
|---------------------|----|---------|--------------------|
| APPROVED BY         | BY | DATE    | APPROVED BY        |
| ENGINEERING MANAGER | PH | 2/7/11  | Philip L. Hannaway |
| CONSTRUCTION ADMIN. | KS | 2/23/11 | City Engineer      |
| TRAFFIC DIVISION    |    | 2/18/11 |                    |
| STREET SERVICES     |    |         |                    |
| SURVEY DIVISION     |    |         |                    |

**SIDEWALK CONSTRUCTION**

**ACACIA STREET  
 FROM CALIFORNIA AVENUE  
 TO GARFIELD STREET**

SCALE: 1" = 20'

|                       |                     |
|-----------------------|---------------------|
| ACCT. NO.             | W.O. NO. 1022       |
| <b>R-4179</b>         | <b>SHEET 2 OF 2</b> |
| FILE NAME: R-4179.DWG |                     |