

RIVERSIDE



CALIFORNIA

PUBLIC WORKS DEPARTMENT

2010-2011 MINOR STREET REHABILITATION - PHASE 1

GENERAL NOTES:

- PRIME CONTRACTOR BIDDING THIS PROJECT SHALL HAVE A CLASS "A" OR CLASS "C-12" LICENSE.
- CONSTRUCTION SHALL BE IN ACCORDANCE WITH THE CITY OF RIVERSIDE DEPARTMENT OF PUBLIC WORKS, STANDARD DRAWINGS AND THE "STANDARD SPECIFICATIONS FOR PUBLIC WORKS CONSTRUCTION", 2009 EDITION.
- THE CONTRACTOR IS REQUIRED TO TAKE DUE PRECAUTIONARY MEASURES TO LOCATE AND PROTECT ALL UTILITIES WITHIN THE CONSTRUCTION WORK AREAS. MH'S & WATER VALVES SHALL BE "TIED OUT" PRIOR TO PAVEMENT OVERLAY WORK FOR SUBSEQUENT ADJUSTMENT WORK.
- ANY TEMPORARY TRAFFIC CONTROL STRIPING OBLITERATED AND/OR BADLY WORN DURING CONSTRUCTION SHALL BE RESTORED BY THE CONTRACTOR WITHIN ONE DAY AFTER NOTIFICATION FROM THE CITY INSPECTOR.
- IN PAVEMENT OVERLAY AREAS, ANY DISTRESSED EXISTING PAVEMENT SHALL BE REMOVED AND REPLACED AS DIRECTED BY THE INSPECTOR AFTER COLD-MILLING AND PRIOR TO OVERLAYING WITH ARHM-GG PAVING.
- WHERE NEW PAVEMENT IS TO JOIN THE EXISTING PAVEMENT, THE EDGE OF THE EXISTING PAVEMENT SHALL BE TRIMMED IN A SMOOTH AND STRAIGHT LINE. CONSTRUCT MATCH-UP PAVING AS DIRECTED IN THE FIELD TO PRODUCE A SMOOTH SECTION.
- STREET IMPROVEMENT WORK THAT WILL CAUSE DAMAGE TO THE DETECTOR LOOP'S SHALL NOT BE PERFORMED UNTIL TRAFFIC SIGNAL MAINTENANCE PERSONNEL HAVE BEEN NOTIFIED AND THE NECESSARY TIMING ADJUSTMENTS ARE MADE TO MAINTAIN SIGNAL OPERATION.
- THE CONTRACTOR IS RESPONSIBLE FOR THE FINAL STRIPING AND PAVEMENT MARKING. STRIPING AND PAVING WORK SHALL BE COMPLETED PER PLANS, CITY STANDARDS AND SPECIAL PROVISIONS.
- SURVEY STAKING REQUESTS AND GRADE SHEETS ARE REQUIRED FOR THE REPLACEMENT OF ALL CURBS AND/OR GUTTER OVER 50' IN LENGTH. SURVEY REQUESTS SHALL BE SUBMITTED AFTER THE EXISTING IMPROVEMENTS HAVE BEEN REMOVED. CONTRACTOR SHALL ALLOW 4 WORKING DAYS AFTER REQUESTING SURVEY TO SCHEDULE SURVEY AND PROCESS GRADE SHEETS. CONTRACTOR SHALL PROVIDE TRAFFIC CONTROL FOR ALL REQUIRED CONSTRUCTION SURVEY WORK BY CITY PERSONNEL. NO STAKING WILL BE REQUIRED FOR SIDEWALK, DWY APPROACHES AND WHEELCHAIR RAMP CONSTRUCTION.
- CONTRACTOR MAY USE SINGLE/DOUBLE ADJUSTMENT OR RAMP-UP OPTIONS FOR MANHOLES AND VALVE COVERS WITHIN THE COLD MILLING AND/OR PAVEMENT REPLACEMENT LIMITS. RAMP-UP OPTION SHALL HAVE SMOOTH FINISH AND SAFE TRANSITION AROUND THE CIRCUMFERENCE OF THE STRUCTURE. RAMP-UP WORK SHALL BE ACCEPTED BY THE INSPECTOR BEFORE ROAD IS OPENED TO TRAFFIC. PAVING MATERIALS USED FOR RAMP-UP SHALL BE REMOVED COMPLETELY BEFORE OVERLAY/PAVING OPERATION TAKES PLACE.
- THE INSPECTOR MAY DIRECT COLD-MILLING AND PAVING INTO SIDE STREETS TO IMPROVE THE RIDE QUALITY AND OTHER STREET CONDITIONS.
- WATER VALVES AND FIRE HYDRANTS MUST BE LOCATED DURING CONSTRUCTION TO MAKE VALVE BOX AND COVER ADJUSTMENTS AND FIRE HYDRANT BLUE MARKER INSTALLATIONS. THE VALVE BOXES MUST BE "TIED OUT" AS PART OF THE CONTRACTOR'S WORK.
- PAVEMENT PREPARATION SHALL CONSIST OF REMOVAL AND REPLACEMENT (R&R) OF DETERIORATED PAVEMENT AREAS AS MARKED IN THE FIELD AND DIRECTED BY THE INSPECTOR AT THE TIME OF CONSTRUCTION. QUANTITIES SHOWN ARE APPROXIMATE AND BASED UPON ALL PREMARKED REMOVAL AND REPLACEMENT SECTIONS. STREETS DESIGNATED FOR COLD MILLING AND PAVEMENT REMOVAL AND REPLACEMENT SHALL BE DONE AFTER COLD MILLING IS COMPLETED.
- THE SEAM BETWEEN PASSES OF THE AC OVERLAY SHALL COINCIDE, AS CLOSE AS POSSIBLE, TO THE LANE LINES.
- COLD MILLING TYPE I AND TYPE II SHALL BE AS DIRECTED BY THE ENGINEER AND AS DESCRIBED IN SPECIAL PROVISIONS.
- THIS PROJECT HAS APPROXIMATELY 92 NEW AND RECONSTRUCTED WHEELCHAIR RAMPS. MOST RAMPS REQUIRE THE REMOVAL AND REPLACEMENT OF APPROXIMATELY 100 TO 150 SF OF RAMP AREA, 50 TO 100 SF OF SIDEWALK, 30 LF OF CURB AND GUTTER, 30 LF OF NEW RETAINING CURB. SOME RAMPS MAY REQUIRE APPROXIMATELY 200 SF OF ASPHALT CONCRETE PAVEMENT REMOVAL AND REPLACEMENT FOR CROSS-FALL. THESE QUANTITIES ARE APPROXIMATE AND MAY CHANGE ACCORDING TO EACH RAMP TYPE AND SITE CONDITIONS. RAMPS SHALL BE CONSTRUCTED PER CITY STANDARDS, ADA REQUIREMENTS AND AS DIRECTED BY THE ENGINEER. AREAS FOR REMOVAL SHALL BE MARKED BY THE CONTRACTOR AND ACCEPTED BY THE CITY ENGINEER AT THE TIME OF CONSTRUCTION. FOR LIST OF RAMP LOCATIONS AND TYPES, SEE SPECIAL PROVISIONS.

CONSTRUCTION NOTES:

NUMBERS ABOVE 100 IN A HEXAGON ON THE PLAN REFER TO THE RESPECTIVE STANDARD DRAWING AND SHALL BE CONSTRUCTED ACCORDINGLY. UNLESS MODIFICATIONS ARE NOTED ON THE PLAN OR COVER SHEET, ANY NUMBER SHOWN BELOW THE STANDARD DRAWING NUMBER INDICATES THE SPECIFIC ALTERNATE TO BE CONSTRUCTED.

SPECIFIC NOTES:

- CONTRACTOR SHALL REPLACE EXISTING STRIPING AND MARKINGS AFTER OVERLAY TO THE ORIGINAL CONFIGURATIONS, UNLESS THERE IS A SIGNING & STRIPING PLAN, IN ACCORDANCE WITH SPECIAL PROVISIONS.
- OVERLAY ENTIRE ROAD WIDTH OF ALL MINOR STREETS WITH 0.10' OF ASPHALT RUBBER HOT MIX GAP GRADED AND 0.15' FOR HARRISON ST. (ENTIRE SECTION OF HARRISON ST. SHALL BE COLD-MILLED FOR A DEPTH OF 0.15' PRIOR TO OVERLAYING AND PRIOR TO REMOVAL & REPLACEMENT OF DAMAGED A.C. PAVEMENT).
- FOR PROPERTIES WITH AC DRIVEWAY APPROACH, AC PAVEMENT OVERLAY SHALL BE EXTENDED TO MATCH EXISTING DRIVEWAYS OR TO PROPERTY LINE WITHOUT ADVERSE IMPACT TO THE EXISTING FLOWLINE.
- IF COLD-MILLING IS NOT POSSIBLE AT AREAS ADJACENT TO AN AC BERM, THE BERM'S HEIGHT SHALL BE RAISED AFTER OVERLAY TO MAINTAIN ITS ORIGINAL HEIGHT AND RUNOFF FLOW ALONG THE BERM.
- ADEQUATE FLOW LINES SHALL BE MAINTAINED AT ALL LOCATIONS.
- FOR WHEELCHAIR RAMPS AT LOCATIONS WHERE SIDEWALK IS LESS THAN 6 FEET WIDE, CONTRACTOR SHALL INSTALL THE SPECIFIED CITY STANDARD WHEELCHAIR RAMP AND TRANSITION THE ASSOCIATED SIDEWALK TO MATCH EXISTING.
- LOCATIONS FOR DIGOUTS SHALL BE MARKED ON SITE AT THE TIME OF CONSTRUCTION AND AFTER COLD-MILLING OPERATIONS HAVE BEEN COMPLETED, WHERE REQUIRED.
- PAVEMENT STRUCTURAL SECTIONS FOR R&R AREAS ON ALL STREETS ARE SHOWN IN TABLE ON SHEET 2 OF THIS SET.
- AT THE EXISTING WHEELCHAIR RAMPS WHETHER OR NOT REQUIRE ALTERATION, THE CROSS SLOPE OF THE PAVEMENT ADJACENT TO THE RAMP SHALL NOT EXCEED 5% FOR ANY RAMP. WHERE SUCH PAVEMENT CROSS-SLOPE EXCEEDS 5%, CONTRACTOR SHALL COLD-MILL THE EXISTING PAVEMENT TO A DEPTH OF AN ADDITIONAL 0.10' BELOW THE GUTTER LIP TO A DISTANCE OF 7' RADIALLY, TO SATISFY THE REQUIRED 5% SLOPE AND PROVIDE SMOOTH TRANSITION TO PAVEMENT IN THE DRIVING LANES.
- DURING THE CONSTRUCTION WORK, ALL SEWER, STORM DRAIN & UTILITY MANHOLES AND WATER GATE VALVES SHALL BE RAMPED UP OR DOUBLE ADJUSTED TO FACILITATE THE COLD-MILLING AND PAVING OPERATIONS. FOLLOWING THE CONSTRUCTION OF A.R.H.M.-GG AC FINAL FINISH SURFACE, ALL MANHOLES AND GATE VALVE COVERS SHALL BE ADJUSTED TO GRADE AS NEEDED.

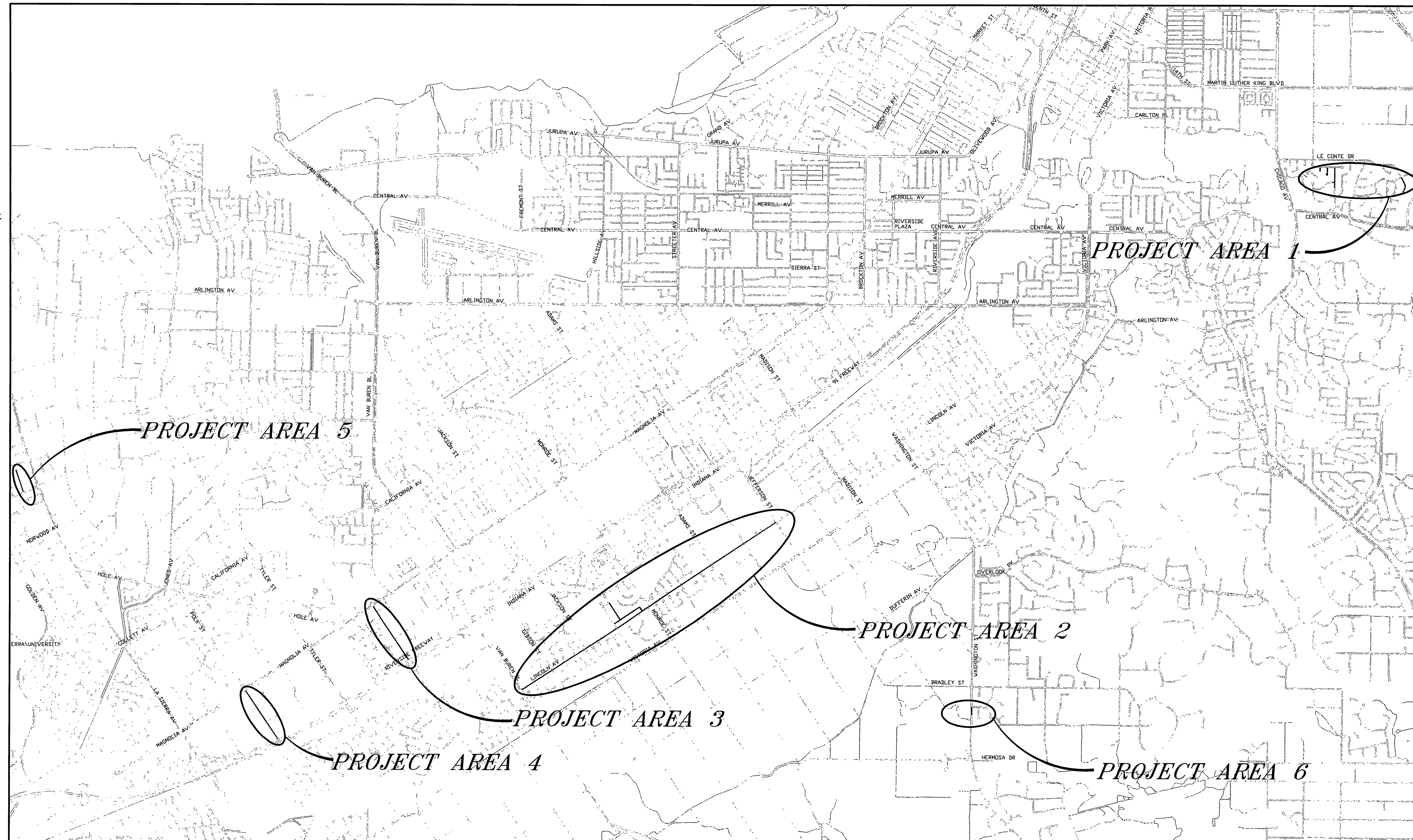

SHEET INDEX:

SHEET NO.	DESCRIPTION
1	TITLE SHEET
2	AREA 1 TO AREA 6
3	WASHINGTON STREET IMPROVEMENTS

Under Ground Service Alert of Southern California
Call: TOLL FREE 1-800-227-2600
TWO WORKING DAYS BEFORE YOU DIG

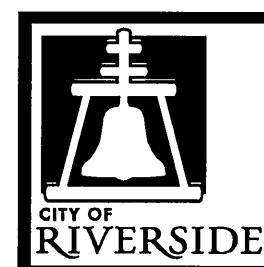

ENGINEER IN RESPONSIBLE CHARGE
Roma
Name: Roma
R.C.E. No. 44747 EXPIRES: 3-31-12
DATE: 9/28/2010



MARK	REVISIONS	APPR	DATE

CITY OF RIVERSIDE, CALIFORNIA DEPARTMENT OF PUBLIC WORKS			
APPROVED BY	BY	DATE	APPROVED BY
ENGINEERING MANAGER	<i>PT</i>	9/28/10	<i>Roma</i>
CONSTRUCTION ADMIN.	<i>AB</i>	10/13/10	CITY ENGINEER
TRAFFIC DIVISION	<i>PH</i>	10/13/10	
STREETS SERVICES			
SURVEY	<i>CS</i>	10/13/10	

STREET IMPROVEMENTS	
2010-2011 MINOR STREET REHABILITATION PHASE 1	
SCALE: 1" = 20'	

R-4181
SHEET 1 OF 3
CONSTRUCTION WO# 1105133

QUANTITIES TABLE

#	STREET NAME	STREET LIMIT	STREET LIMIT	STREET LENGTH (L)	STREET AREA (SF)	AC REMOVAL (SF)	DGAC REPLACE (TON)	AGGREGATE BASE (CY)	R&R DWY APP (SF)	ARHM-DG OVERLAY (TON)	WCR (EA)	R&R CURB & GUTTER (LF)	R&R SIDEWALK (SF)	LOOPS (EA)	X-GUTTER (SF)	COLDMILL TYPE I 10' WIDE (L.F.)	COLDMILL TYPE II 10' WIDE (L.F.)	COLDMILL TYPE III 10' WIDE (S.F.)	UNIFORM COLD MILL (S.F.)	ADJ S&S (EA)	VALVES (EA)	R&R WATER METER PULLBOX (EA)	COMMENTS
1	Le Conte Dr.	Monte Vista	End	570	20,300	-	-	-	-	155	-	-	-	-	-	1,280	-	-	-	2	2	-	OVERLAY 0.10'
2	Cherryhill Dr.	Rosehill Dr.	Fairhill Dr.	850	25,400	-	-	-	-	195	4	-	490	-	-	1,740	-	600	-	3	6	-	PROJECT EXTENDS 740' SOUTH ON CHERRYHILL & 110' WEST ON FAIRHILL. 0.10' OVERLAY
3	Leafhill Pl.	Rosehill Dr.	End	140	5,600	-	-	-	-	45	2	-	60	-	-	375	-	-	-	1	-	-	OVERLAY 0.10'
4	Brookhill Pl.	Rosehill Dr.	End	270	9,800	1,250	35	-	-	75	2	65	185	-	200	680	-	-	-	1	1	-	OVERLAY 0.10' /NEW SECTION FOR R&R TO BE 0.10' ARHM OVER 0.33' DGAC OVER NATIVE
5	Continental Dr.	Lincoln	Irving	1,220	38,500	38,500	930	-	-	290	5	-	180	-	-	-	-	1,800	-	-	4	-	COMPLETE R&R. NEW SECTION FOR R&R TO BE 0.10' ARHM OVER 0.33' DGAC OVER NATIVE
6	Quebec Dr.	Continental	Cherbourg	670	20,500	20,500	500	-	-	160	-	-	-	-	-	-	-	500	-	-	4	-	COMPLETE R&R. NEW SECTION FOR R&R TO BE 0.10' ARHM OVER 0.33' DGAC OVER NATIVE
7	Lincoln Ave.	Van Buren	Jackson	2,725	158,000	30,000	1,080	-	-	1,185	9	25	320	9	-	-	-	-	-	13	21	-	NEW SECTION FOR R&R AREAS TO BE 0.10' ARHM OVER 0.50' DGAC OVER NATIVE
8	Lincoln Ave.	Jackson	Monroe	2,725	159,000	41,200	1,485	-	-	1,195	6	-	340	8	220	-	-	-	-	18	15	-	NEW SECTION FOR R&R AREAS TO BE 0.10' ARHM OVER 0.50' DGAC OVER NATIVE
9	Lincoln Ave.	Monroe	Adams	2,725	160,000	7,500	270	-	-	1,200	18	-	-	-	-	-	-	-	-	9	23	-	NEW SECTION FOR R&R AREAS TO BE 0.10' ARHM OVER 0.50' DGAC OVER NATIVE
10	Lincoln Ave.	Adams	Jefferson	2,725	167,000	36,300	1,310	-	-	1,260	22	50	350	9	-	-	-	5,450	-	-	7	21	NEW SECTION FOR R&R AREAS TO BE 0.10' ARHM OVER 0.50' DGAC OVER NATIVE
11	Paik St.	Diana	Magnolia	2,150	89,000	47,900	2,160	-	-	670	10	-	450	6	-	2,300	-	2,000	-	5	14	-	OVERLAY 0.10' /NEW SECTION FOR R&R TO BE 0.10' ARHM OVER 0.60' DGAC OVER NATIVE
12	Harrison St.	Diana	Magnolia	2,350	83,000	9,000	240	-	300	930	12	50	1,550	6	-	-	-	82,500	-	13	7	-	GRIND & OVERLAY 0.15' /NEW SECTION FOR R&R TO BE 0.15' ARHM OVER 0.35' DGAC OVER NATIVE
13	Washington St.	Highridge	1100' Southerly	1,100	1,100	8,400	300	400	-	200	-	-	-	-	-	60	-	1,000	-	-	-	-	SEE SHEET 3 OF THIS PLAN SET
14	Rose Ave.	Gramercy	End	820	25,700	6,100	150	-	-	200	2	-	-	-	-	-	-	-	-	2	-	-	OVERLAY 0.10' /NEW SECTION FOR R&R TO BE 0.10' ARHM OVER 0.33' DGAC OVER NATIVE
Total					21,040																		

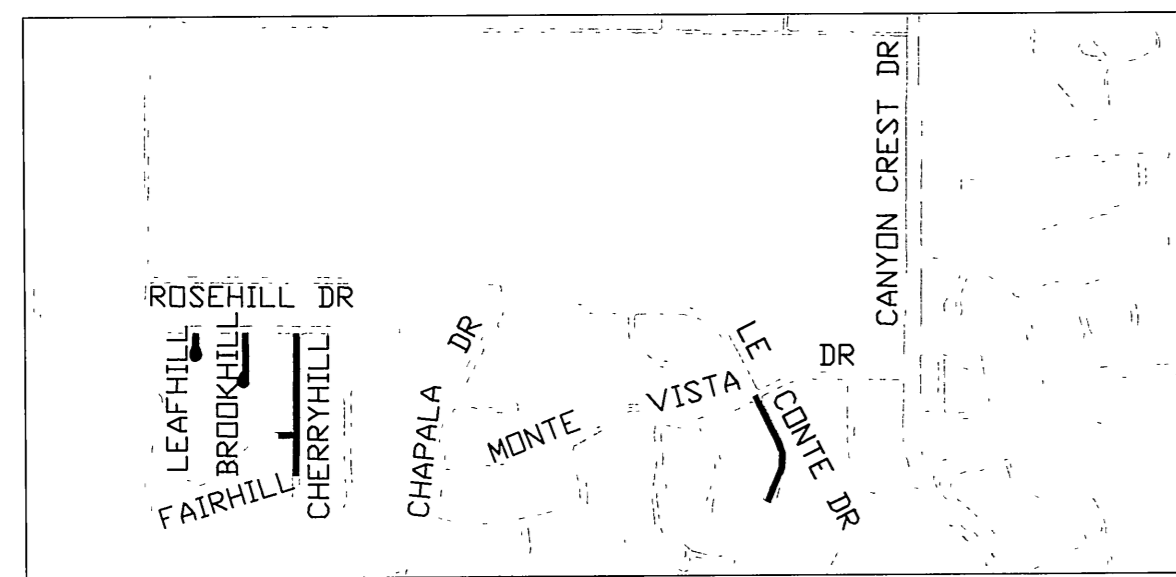

AREA 1



AREA 2

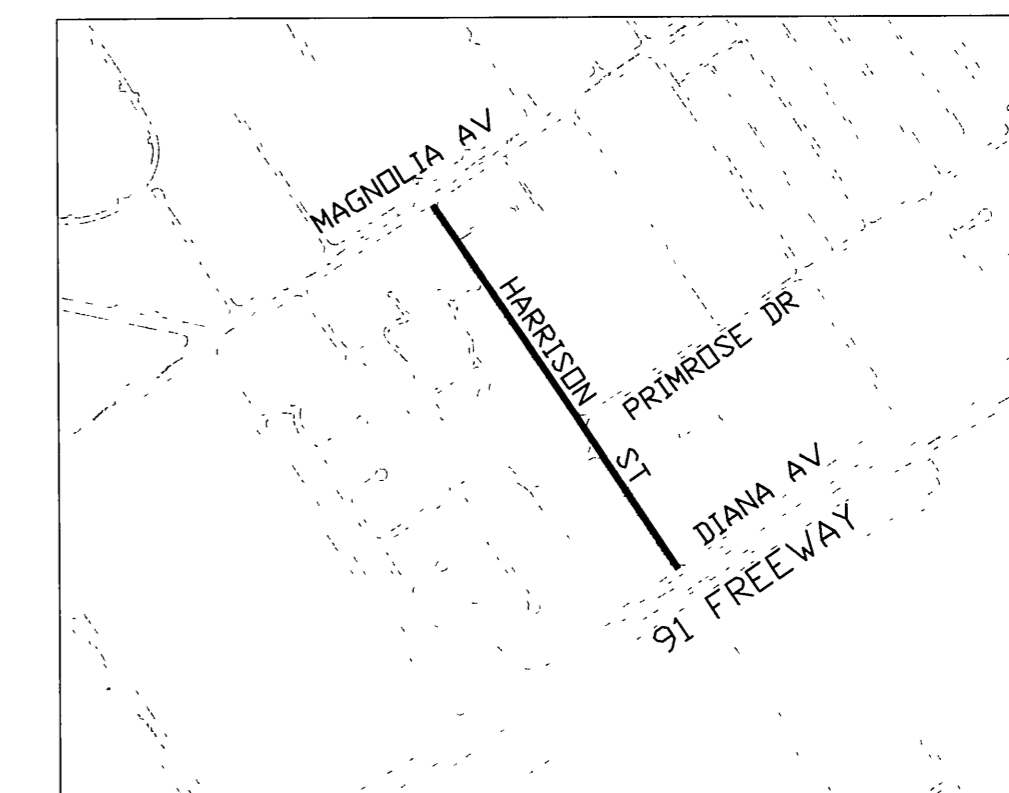

AREA 3

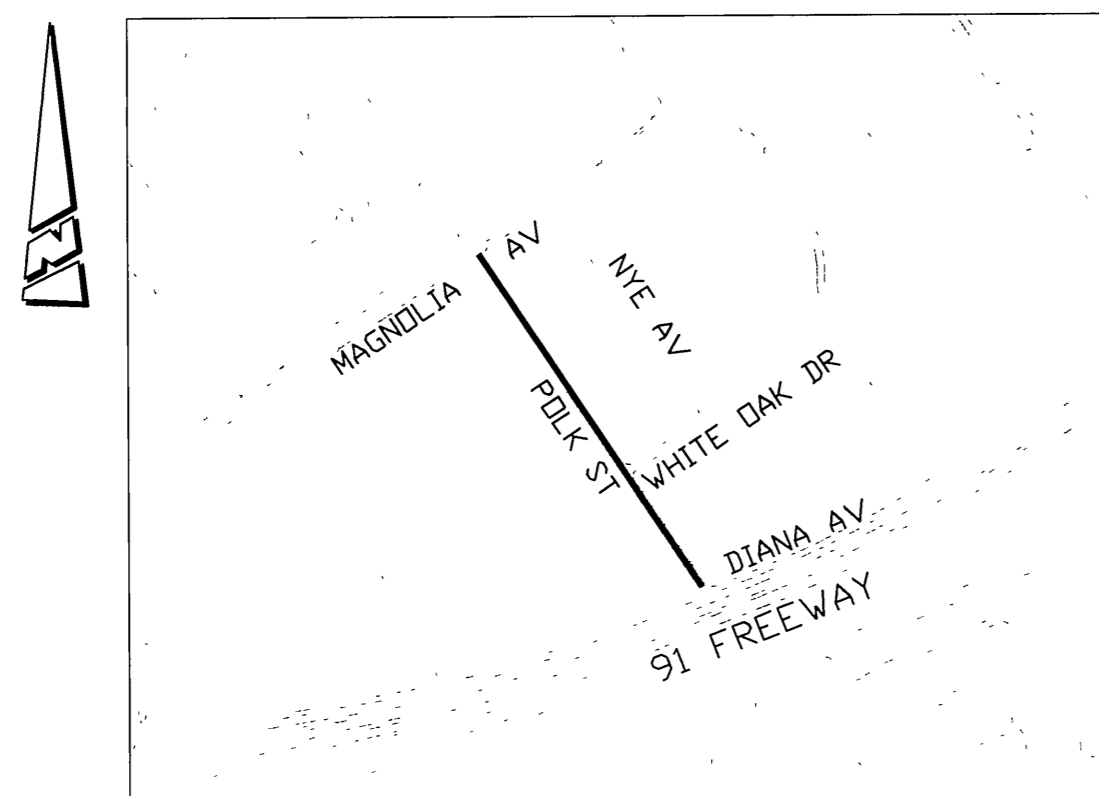

AREA 4

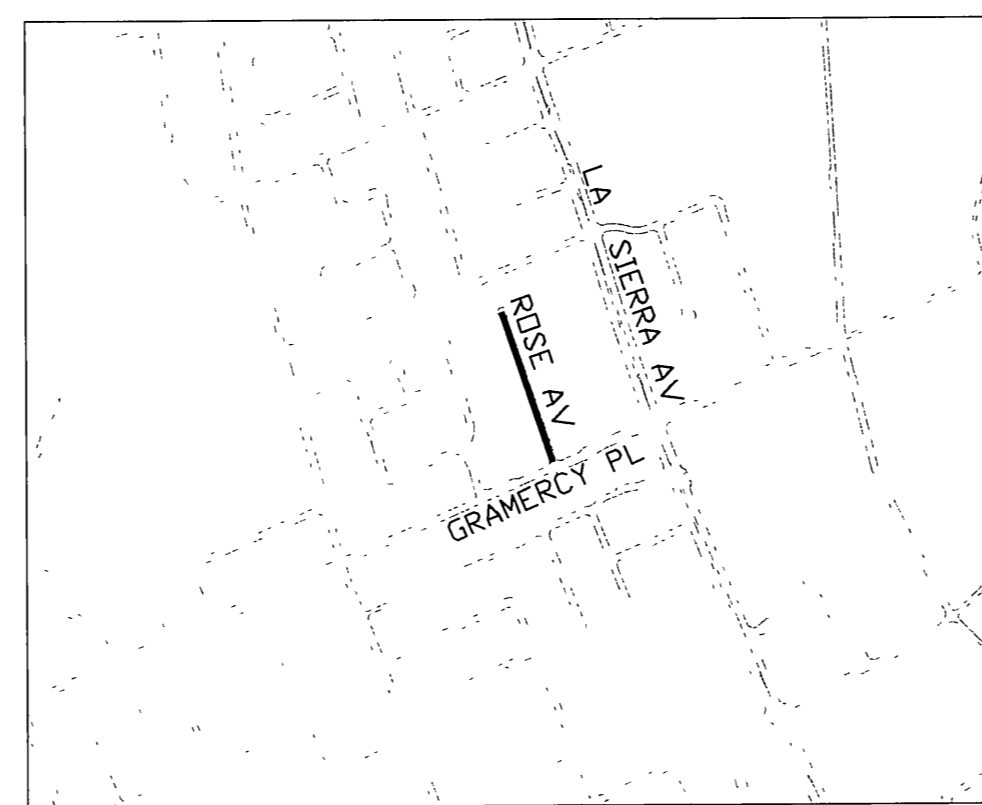

AREA 5

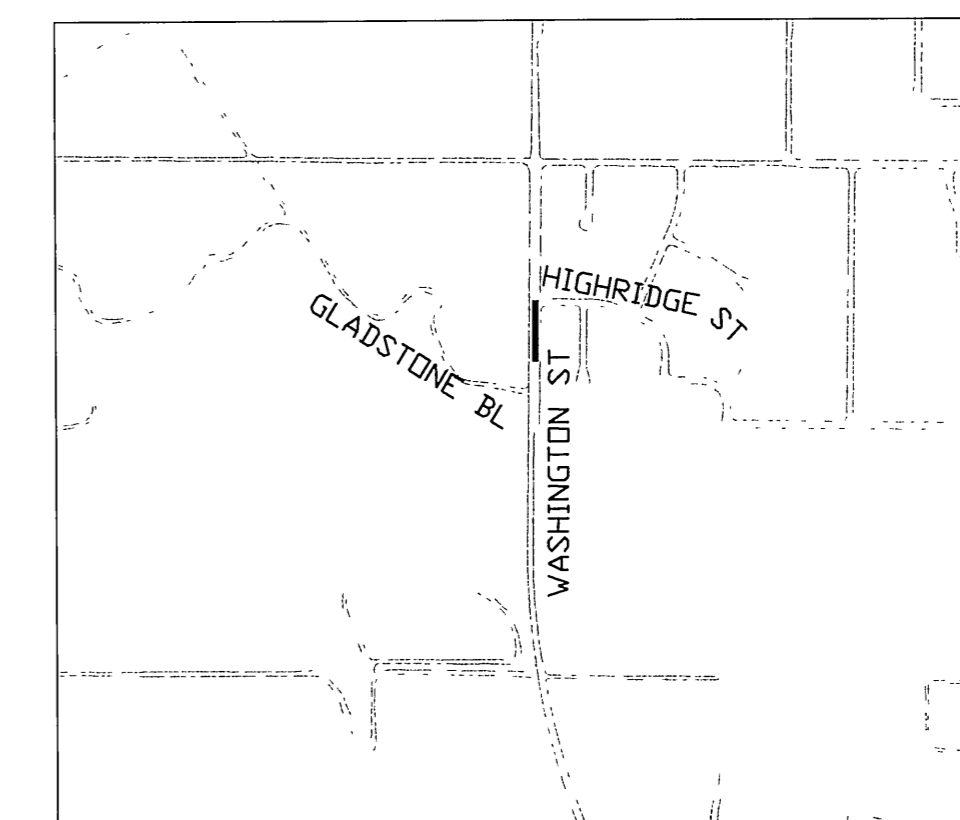

AREA 6

(SEE SHEET 3 OF 3)

Under Ground Service Alert
of Southern California
Call: TOLL FREE
1-800-227-2600
TWO WORKING DAYS BEFORE YOU DIG

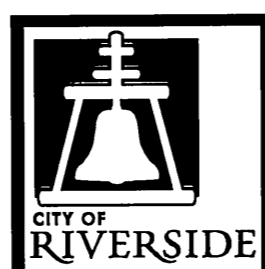

ENGINEER IN RESPONSIBLE CHARGE

Name: *Ramirez*
R.C.E. No. 44747 EXPIRES: 3-31-12
DATE: 9/28/2010



DESIGNED BY	CS	DRAWN BY	CS	CHECKED BY	PH
MARK		REVISIONS		APPR.	DATE

CITY OF RIVERSIDE, CALIFORNIA DEPARTMENT OF PUBLIC WORKS			
APPROVED BY	BY	DATE	APPROVED BY
ENGINEERING MANAGER	<i>DH</i>	9/28/10	<i>Ramirez</i>
CONSTRUCTION ADMIN.	<i>AB</i>	10/13/10	CITY ENGINEER
TRAFFIC DIVISION	<i>A.W.</i>	10/13/10	
STREETS SERVICES			DATE: <u>10/13/10</u>
SURVEY	<i>CB</i>	10/13/10	

STREET IMPROVEMENTS
2010-2011
MINOR STREET REHABILITATION
PHASE 1
SCALE: 1" = 20'

R-4181
SHEET 2 OF 3
CONSTRUCTION WO# 1105133

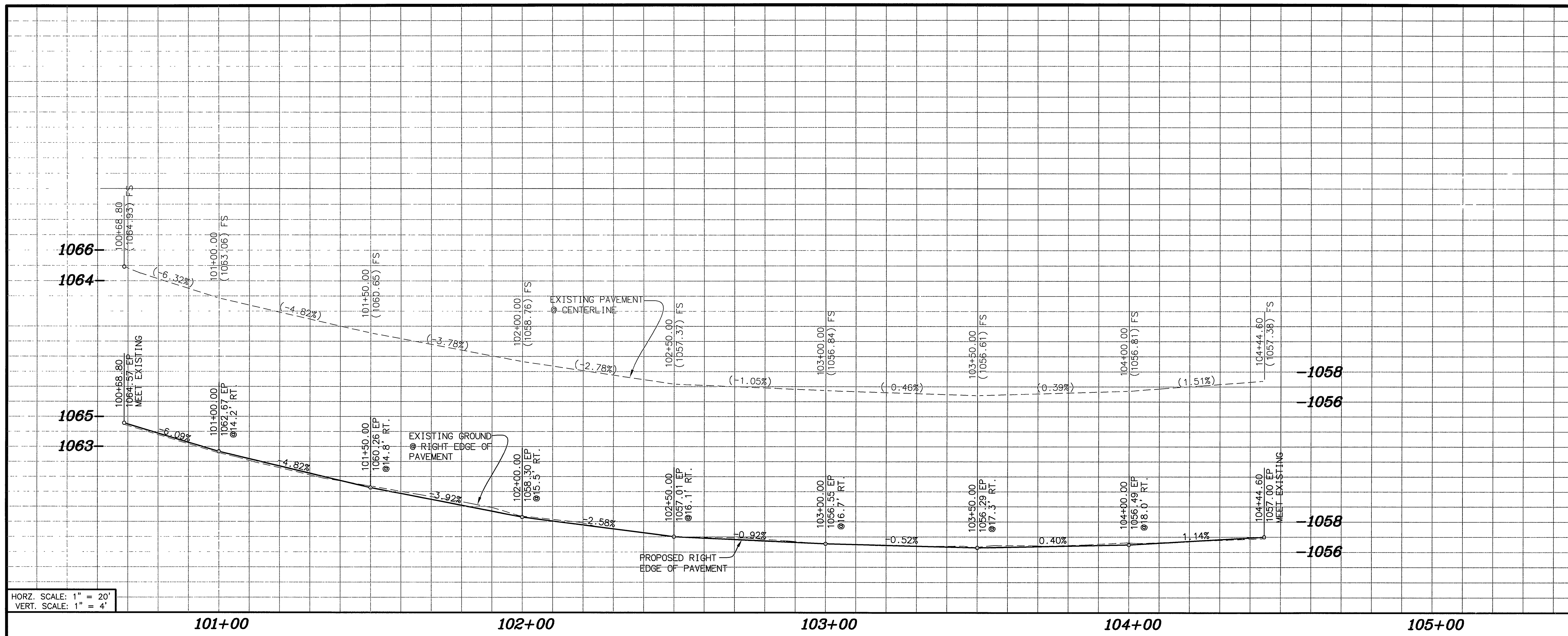

- CONSTRUCTION NOTES:**
- NUMBERS ABOVE 100 IN A HEXAGON ON THE PLAN REFER TO THE RESPECTIVE STANDARD DRAWING AND SHALL BE CONSTRUCTED ACCORDINGLY, UNLESS MODIFICATIONS ARE NOTED ON THE PLAN OR COVER SHEET. ANY NUMBER SHOWN BELOW THE STANDARD DRAWING NUMBER INDICATES THE SPECIFIC ALTERNATE TO BE CONSTRUCTED.
 - SAWCUT AND REMOVE EXISTING ASPHALT AND SUBGRADE MATERIAL TO DEPTH NECESSARY TO CONSTRUCT 0.40' (B-PG-64-10) DGAC OVER 1.10' COMPACTED AGGREGATE BASE MATERIAL. (DOES NOT INCLUDE OVERLAY CAP).
 - OVERLAY EXISTING PAVEMENT WITH 0.10' MIN. THICKNESS A.R.H.M.-GG-C.
 - COLD MILL EXISTING AC PAVEMENT TO A MINIMUM DEPTH OF 0.10' BELOW GUTTER LIP OR OUTER EDGE AND "DAYLIGHT" OVER 5'.
 - COLD MILL EXISTING AC PAVEMENT TO A MINIMUM DEPTH OF 0.10' OVER 10'.
 - CONSTRUCT 2"x 4" REDWOOD HEADER AT PROPOSED EDGE OF PAVEMENT IN WIDENING AREAS PER PLAN WHERE NO AC BERM IS PROPOSED.
 - CONTRACTOR SHALL GRADE 4' WIDE SHOULDER ADJACENT TO EDGE OF PAVEMENT.
 - CONTRACTOR SHALL GRADE AND PAVE 4' WIDE X 1' DEEP DIRT SWALE WITH 3" THICK AC PAVEMENT.
 - TRIM OVERHANGING TREE BRANCHES FROM PROPOSED WIDENING AREA.

HORIZ. SCALE: 1" = 20'
VERT. SCALE: 1" = 4'

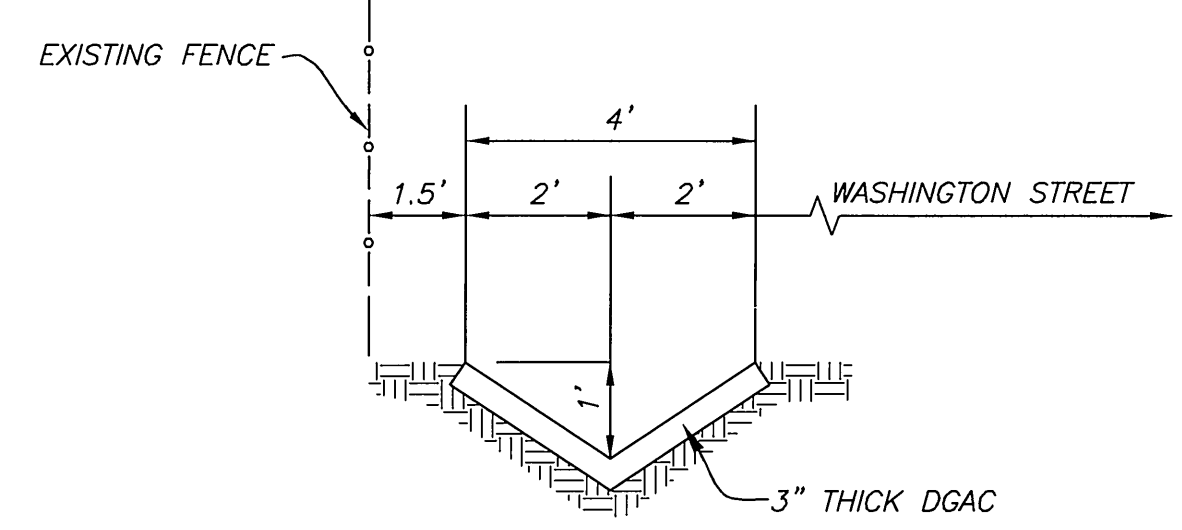
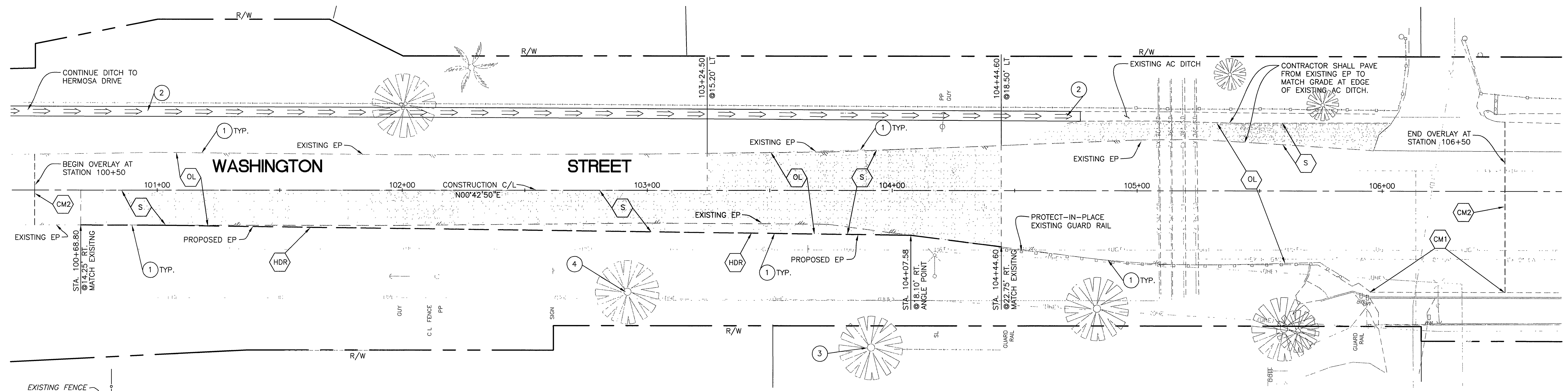

4' AC V-DITCH DETAIL
NTS

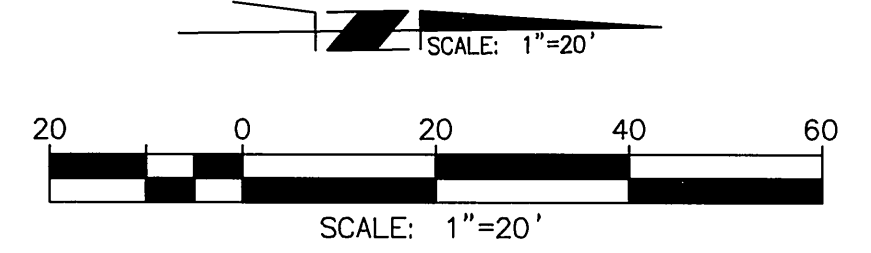

Under Ground Service Alert of Southern California
Call: TOLL FREE 1-800-227-2600
TWO WORKING DAYS BEFORE YOU DIG

ENGINEER IN RESPONSIBLE CHARGE
Abuana
Name: Abuana
R.C.E. No. 44747 EXPIRES: 3-31-12
DATE: 9/28/2010

MARK	REVISIONS	APPR	DATE

DESIGNED BY: CS DRAWN BY: CS CHECKED BY: PH

**CITY OF RIVERSIDE, CALIFORNIA
DEPARTMENT OF PUBLIC WORKS**

APPROVED BY:	PH	DATE:	9/28/10
ENGINEERING MANAGER:	PH	DATE:	10/13/10
CONSTRUCTION ADMIN.:	PH	DATE:	10/13/10
TRAFFIC DIVISION:	PH	DATE:	10/13/10
STREETS SERVICES:	PH	DATE:	10/13/10
SURVEY:	PH	DATE:	10/13/10

STREET IMPROVEMENTS
2010-2011
MINOR STREET REHABILITATION
PHASE 1
SCALE: 1" = 20'

R-4181
SHEET 3 OF 3
CONSTRUCTION WO# 1105133