

PUBLIC WORKS DEPARTMENT DEERCREEK DRIVE STREET IMPROVEMENTS (FROM ORANGE TERRACE PARKWAY TO GROVE COMMUNITY DRIVE)

CONSTRUCTION NOTES:

- NUMBERS ABOVE 100 IN A HEXAGON ON THE PLAN REFER TO THE RESPECTIVE STANDARD DRAWING AND SHALL BE CONSTRUCTED ACCORDINGLY. UNLESS MODIFICATIONS ARE NOTED ON THE PLAN OR COVER SHEET, ANY NUMBER SHOWN BELOW THE STANDARD DRAWING NUMBER INDICATES THE SPECIFIC ALTERNATE TO BE CONSTRUCTED.
- CONSTRUCT 3" (B-PG-64-10) DGAC OVER 4" CRUSHED MISCELLANEOUS BASE.
- REMOVE EXISTING TREE AND REPLACE WITH A 15 GALLON NEW TREE OF SAME TYPE BEHIND NEW IMPROVEMENTS AS DIRECTED BY CITY INSPECTOR.
- RELOCATE EXISTING SIGN BEHIND NEW IMPROVEMENTS.
- RELOCATE EXISTING STREET LIGHT 2' BEHIND NEW CURB FACE. INTERCEPT CABLE AND PULL NEW #8 COPPER FROM THE STREETLIGHTS THAT FEED FROM THE SOUTH AND EXTEND EXISTING 1" SCHEDULE 40 PVC AND 2#8CU WIRE FOR 120 VOLT STREET LIGHT SERVICE PER SPECIFICATIONS 2-6. FOOTING PER UGS-801.
- CONSTRUCT CURB ONLY PER CITY OF RIVERSIDE STANDARD DRAWING NO. 200 TYPE II MODIFIED TO BE 6" HIGH.
- CONSTRUCT CURB SIDEWALK PER CITY OF RIVERSIDE STANDARD DRAWING NO. 325 MODIFIED TO BE 8' WIDE.
- ① CONSTRUCT 4' WIDE PCC GUTTER AS SHOWN IN TYPICAL SECTION HEREON.
- ② REMOVE INTERFERING PORTIONS OF EXISTING SIDEWALK AND RECONSTRUCT TO THE NEAREST SCORELINE AS DIRECTED BY ENGINEER IN FIELD.
- ③ SAWCUT AND REMOVE ALL EXISTING IMPROVEMENTS NECESSARY TO CONSTRUCT PROPOSED IMPROVEMENTS.

GENERAL NOTES:

1. EXISTING UTILITIES SHOWN ON THIS PLAN ARE PLOTTED FROM UTILITY RECORDS. THE CONTRACTOR IS REQUIRED TO TAKE DUE PRECAUTIONARY MEASURES TO LOCATE AND PROTECT ALL UTILITIES WHETHER OR NOT SHOWN ON THIS PLAN.
2. ANY TEMPORARY TRAFFIC CONTROL STRIPING OBLITERATED AND/OR BADLY WORN DURING CONSTRUCTION SHALL BE RESTORED BY THE CONTRACTOR WITHIN ONE DAY AFTER NOTIFICATION FROM THE CITY INSPECTOR.
3. WHERE NEW PAVEMENT IS TO JOIN THE EXISTING PAVEMENT, THE EDGE OF THE EXISTING PAVEMENT SHALL BE TRIMMED IN A SMOOTH AND STRAIGHT LINE. CONSTRUCT MATCH-UP PAVING AS DIRECTED IN THE FIELD TO PRODUCE A SMOOTH SECTION.
4. SURVEY STAKING REQUESTS AND GRADE SHEETS ARE REQUIRED FOR THE REPLACEMENT OF ALL CURBS AND/OR GUTTER OVER 50' IN LENGTH. SURVEY REQUESTS SHALL BE SUBMITTED AFTER THE EXISTING IMPROVEMENTS HAVE BEEN REMOVED. CONTRACTOR SHALL ALLOW 4 WORKING DAYS AFTER REQUESTING SURVEY TO SCHEDULE SURVEY AND PROCESS GRADE SHEETS. CONTRACTOR SHALL PROVIDE TRAFFIC CONTROL FOR ALL REQUIRED CONSTRUCTION SURVEY WORK BY CITY PERSONNEL.
5. CONTRACTOR SHALL REPLACE ALL DAMAGED STRIPING IN KIND.
6. ANY EXISTING SPEED BUMPS WHICH ARE DAMAGED BY CONTRACTOR DURING CONSTRUCTION SHALL BE RECONSTRUCTED BY CONTRACTOR.
7. ALL EXISTING IRRIGATION WHICH IS IN CONFLICT WITH PROPOSED IMPROVEMENTS SHALL BE RECONSTRUCTED BY CONTRACTOR TO BEHIND THE PROPOSED IMPROVEMENTS. A COPY OF THE EXISTING IRRIGATION PLANS HAS BEEN INCLUDED IN THE SPECIFICATIONS FOR REFERENCE. ALL MATERIALS USED SHALL BE EQUIVALENT TO WHAT IS ON THE EXISTING IRRIGATION PLANS.

SHEET INDEX: STREET IMPROVEMENT

SHEET NO.	DESCRIPTION
1	TITLE SHEET
2	DEERCREEK DRIVE STA 10+00 TO STA 14+65
3	DEERCREEK DRIVE STA 14+65 TO STA 20+00
4	DEERCREEK DRIVE STA 20+00 TO STA 22+82

LEGEND

- NEW AC PAVEMENT
- NEW PCC

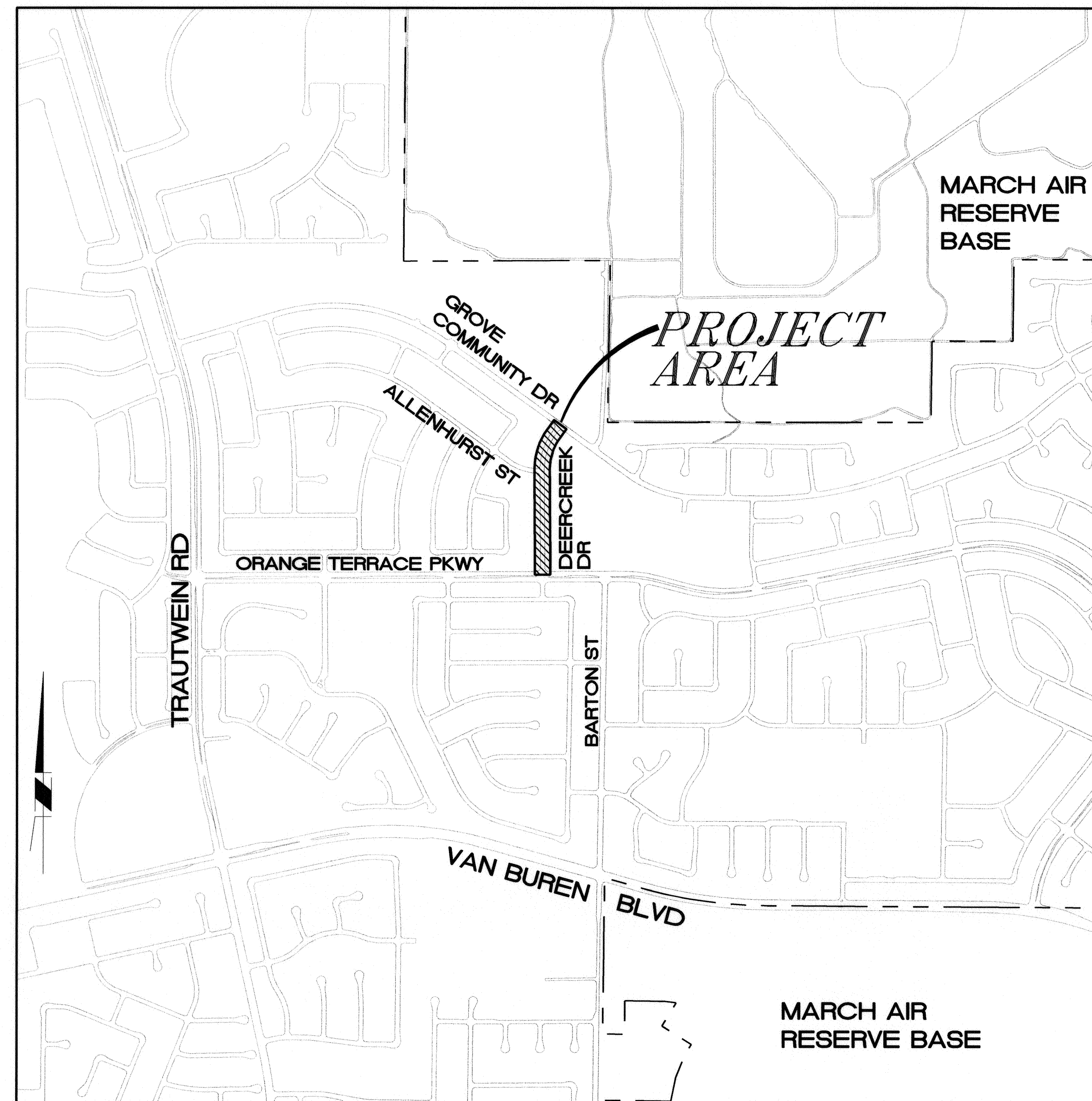

VICINITY MAP
N.T.S.

EXISTING UNDERGROUND UTILITIES:

- SANITARY SEWER --- EX SWP ---
- WATER LINE --- EX WTR ---
- STORM DRAIN --- EX SD ---
- UNDERGROUND ELEC. --- (UGE) ---
- GAS --- (G) ---
- TELEPHONE --- (UCT) ---

EXISTING TOPOGRAPHY:

- ⊙ SANITARY SEWER M.H.
- ⊙ STORM DRAIN M.H.
- ⊙ WATER GATE VALE
- ⊙ ELECTRIC M.H.
- ⊙ TELEPHONE M.H.
- ⊙ WATER METER
- ⊙ FIRE HYDRANT
- ⊙ IRRIGATION METER
- ⊙ BLOW-OFF VALVE
- ⊙ TRAFFIC SIGN
- ⊙ POWER POLE
- GUY ANCHOR
- ⊗ STREET LIGHT ON MAST ARM
- PALM TREE
- MISC. TREE
- BUILDING
- TOP OF SLOPE
- TOE OF SLOPE
- DIRECTION DRAINAGE FLOW
- EDGE OF PAVEMENT

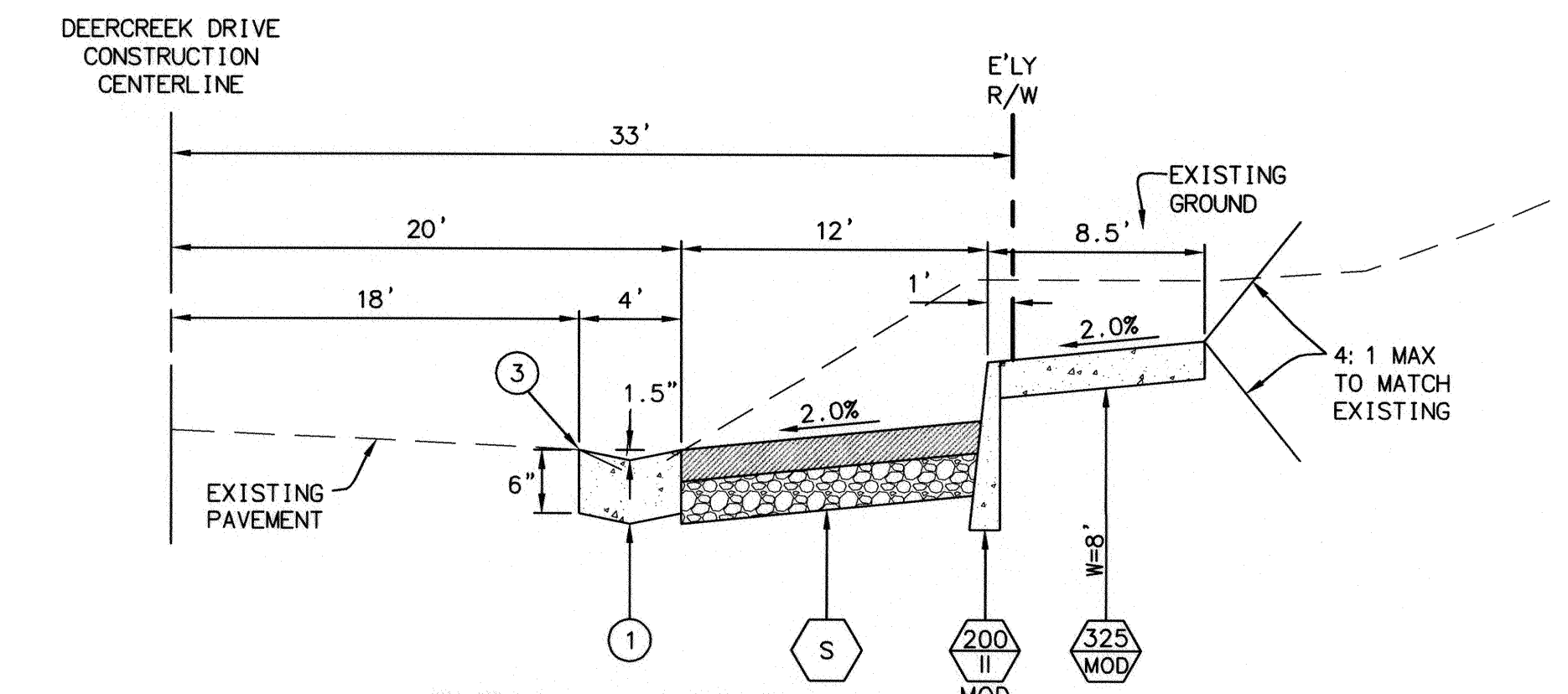

TYPICAL SECTION
N.T.S.

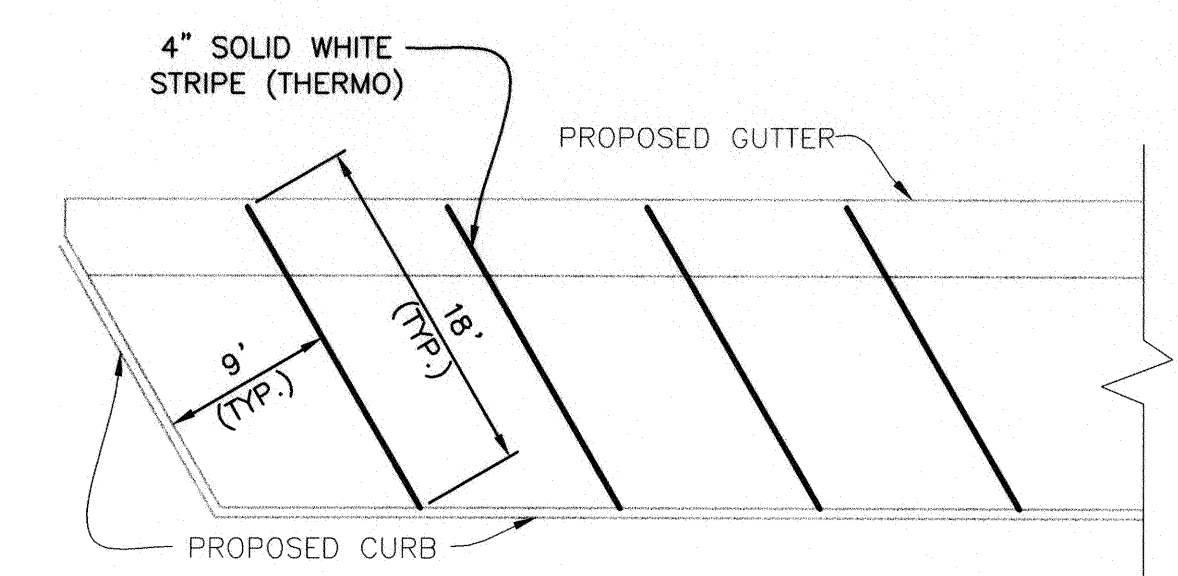

PARKING STRIPE DETAIL
N.T.S.

<p>BENCHMARK E8-F3 P.K. NAIL AND CITY ENGINEERING TAG ON THE SIDEWALK OVER THE WESTERLY WALL OF A CATCH BASIN ALONG THE SOUTHERLY CURB OF ORANGE TERRACE PKWY, 100 FEET EASTERLY OF TRAUTWEIN ROAD. THE MARK IS 2 FEET SOUTHERLY OF THE FACE OF CURB. ELEVATION: 1667.648 1445.15 NGVD 1929</p>	<p>Under Ground Service Alert of Southern California Call: TOLL FREE 1-800-227-2600 TWO WORKING DAYS BEFORE YOU DIG</p>	<p>ENGINEER IN RESPONSIBLE CHARGE <i>Philip Hanawa</i> Name: PHILIP HANAWA R.C.E. No. 44747 EXPIRES: 3-31-12 DATE: 4/29/2011</p>	<p>CITY OF RIVERSIDE, CALIFORNIA DEPARTMENT OF PUBLIC WORKS</p> <p>APPROVED BY: <i>[Signature]</i> DATE: 4/29/11 CONSTRUCTION ADMIN. <i>[Signature]</i> DATE: 5/26/11 TRAFFIC DIVISION <i>[Signature]</i> DATE: 4/29/11 STREETS SERVICES <i>[Signature]</i> DATE: 4/29/11 PRINCIPAL ENGINEER</p>	<p>STREET IMPROVEMENTS DEERCREEK DRIVE IMPROVEMENTS FROM ORANGE TERRACE PKWY TO GROVE COMMUNITY DRIVE</p>	<p>DESIGN WORK ORDER NO.: 1019535 CONSTR. WORK ORDER NO.: XXXXX R-4207 SHEET 1 OF 4 FILE NAME: R4207-01.DWG</p>
--	--	---	---	---	--

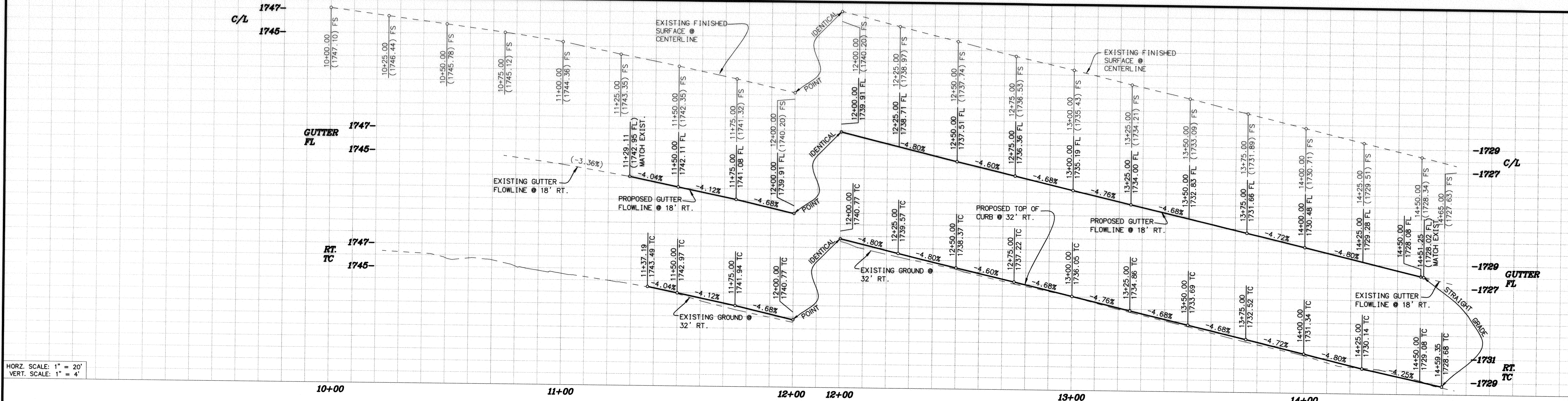

HORZ. SCALE: 1" = 20'
VERT. SCALE: 1" = 4'

LINE	LENGTH	BEARING
L1	16.15	S59°43'00"W
L2	322.16	N00°17'00"W
L3	322.16	S00°17'00"E
L4	16.20	S59°43'00"W

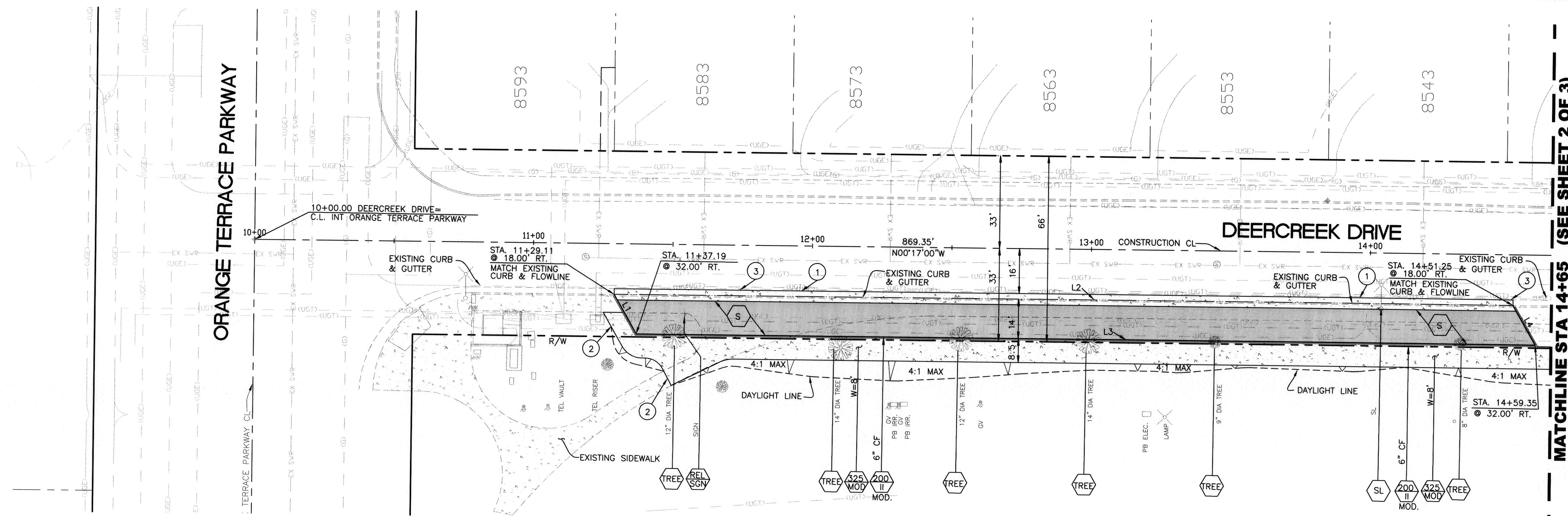

(SEE SHEET 2 OF 3)

MATCHLINE STA 14+65

BENCHMARK E8-F3
P.K. NAIL AND CITY ENGINEERING TAG ON THE SIDEWALK OVER THE WESTERLY WALL OF A CATCH BASIN ALONG THE SOUTHERLY CURB OF ORANGE TERRACE PKWY, 100 FEET EASTERLY OF TRAUTWEIN ROAD, THE MARK IS 2 FEET SOUTHERLY OF THE FACE OF CURB.
ELEVATION: 1667.648 1663.15 NGVD 1929

Under Ground Service Alert of Southern California
Call: TOLL FREE 1-800-227-2600
TWO WORKING DAYS BEFORE YOU DIG

ENGINEER IN RESPONSIBLE CHARGE
Name: PHILIP HANNAWAY
R.C.E. No. 44747 EXPIRES: 3-31-12
DATE: 4/21/11

DESIGNED BY: CS DRAWN BY: CS CHECKED BY: PH

CITY OF RIVERSIDE, CALIFORNIA
DEPARTMENT OF PUBLIC WORKS
APPROVED BY: [Signature]
ENGINEERING MANAGER
CONSTRUCTION ADMIN.
TRAFFIC DIVISION
STREETS SERVICES
PRINCIPAL ENGINEER

STREET IMPROVEMENTS
DEERCREEK DRIVE IMPROVEMENTS
FROM ORANGE TERRACE PKWY TO GROVE COMMUNITY DRIVE
ORANGE TERRACE PARKWAY TO STA 14+65
HORIZ. SCALE: VERT. SCALE:

DESIGN WORK ORDER NO.: 1019535
CONSTR. WORK ORDER NO.: XXXXX
R-4207
SHEET **2** OF **4**
FILE NAME: R4207-02

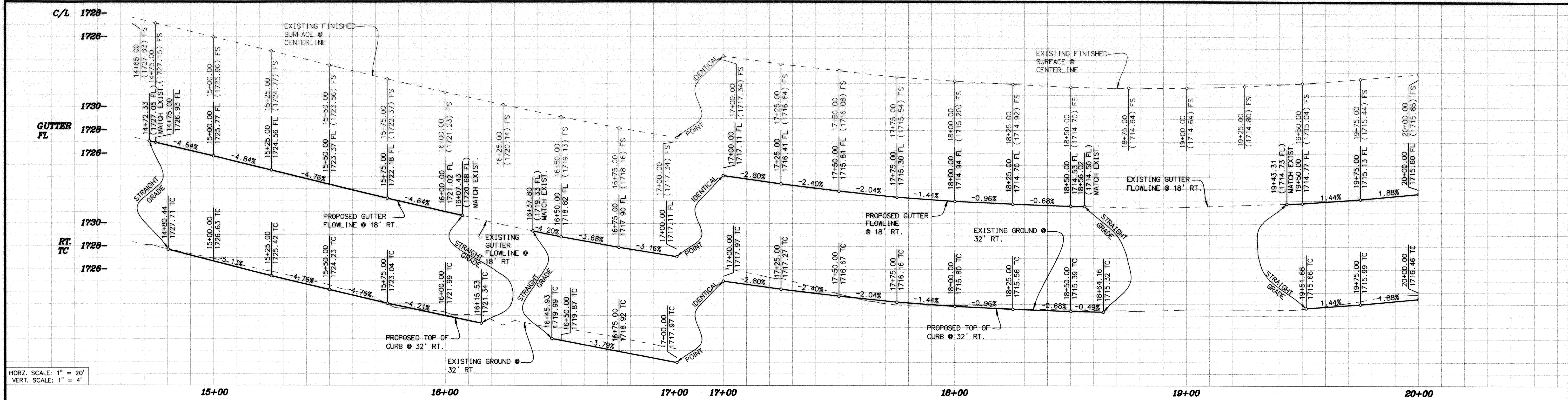

HORZ. SCALE: 1" = 20'
VERT. SCALE: 1" = 4'

LINE	LENGTH	BEARING
L5	16.21	S59°43'00"W
L6	135.13	N00°17'00"E
L7	135.10	S00°17'00"E
L8	16.22	S59°45'59"W
L9	218.24	N00°17'00"E
L10	16.26	S59°43'00"W
L11	218.24	S00°17'00"E
L12	16.29	S59°43'00"W
L13	16.10	S68°00'04"W

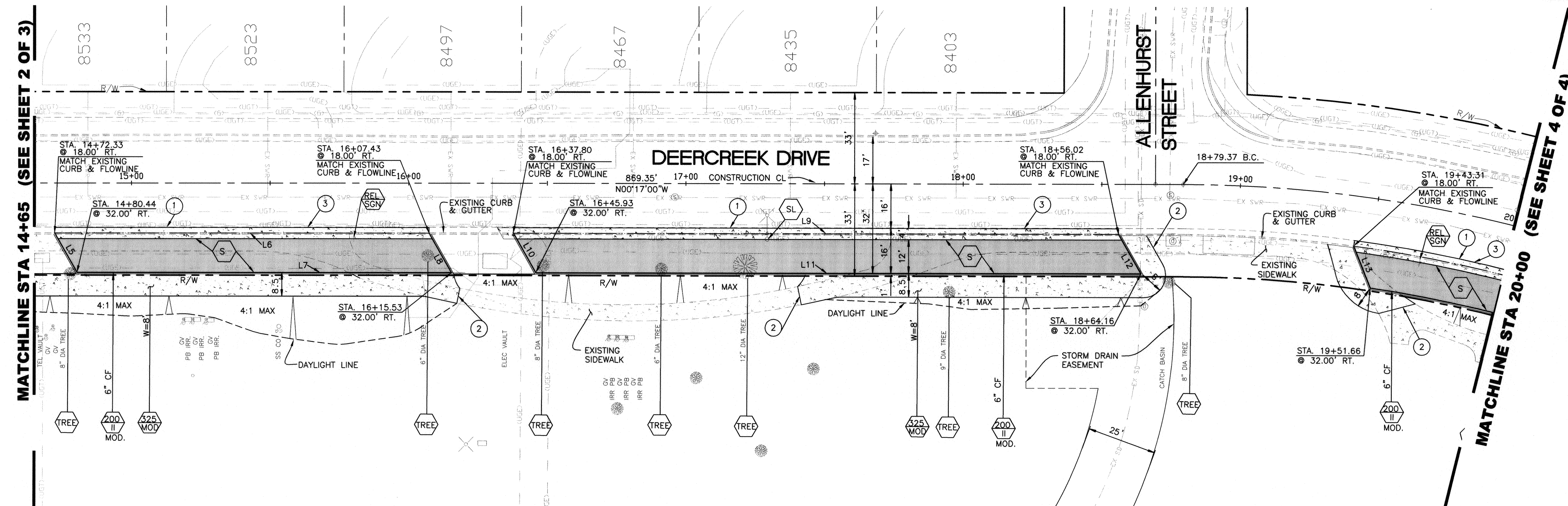

MATCHLINE STA 14+65 (SEE SHEET 2 OF 3)

MATCHLINE STA 20+00 (SEE SHEET 4 OF 4)

BENCHMARK E8-F3
P.K. NAIL AND CITY ENGINEERING TAG ON THE SIDEWALK OVER THE WESTERLY WALL OF A CATCH BASIN ALONG THE SOUTHERLY CURB OF ORANGE TERRACE PKWY, 100 FEET EASTERLY OF TRAUTWEIN ROAD. THE MARK IS 2 FEET SOUTHERLY OF THE FACE OF CURB.
ELEVATION: 1667.648 1665.15 NGVD 1929

Under Ground Service Alert
Call: TOLL FREE 1-800-227-2600
TWO WORKING DAYS BEFORE YOU DIG

ENGINEER IN RESPONSIBLE CHARGE
Name: Philip H. ...
R.C.E. No. 63753 EXPIRES: 9-30-12
DATE: 4/24/2011



MARK	REVISIONS	APPR.	DATE

CITY OF RIVERSIDE, CALIFORNIA
DEPARTMENT OF PUBLIC WORKS
APPROVED BY: [Signature]
CONSTRUCTION ADMIN.
DATE: 4/24/11

STREET IMPROVEMENTS
DEERCREEK DRIVE IMPROVEMENTS
FROM ORANGE TERRACE PKWY TO GROVE COMMUNITY DRIVE
DEERCREEK DRIVE (STA 14+65 TO 20+00)
HORIZ. SCALE: VERT. SCALE:

DESIGN WORK ORDER NO.: 1019535
CONSTR. WORK ORDER NO.: XXXXX
R-4207
SHEET **3** OF **4**
FILE NAME: R4207-03.DWG

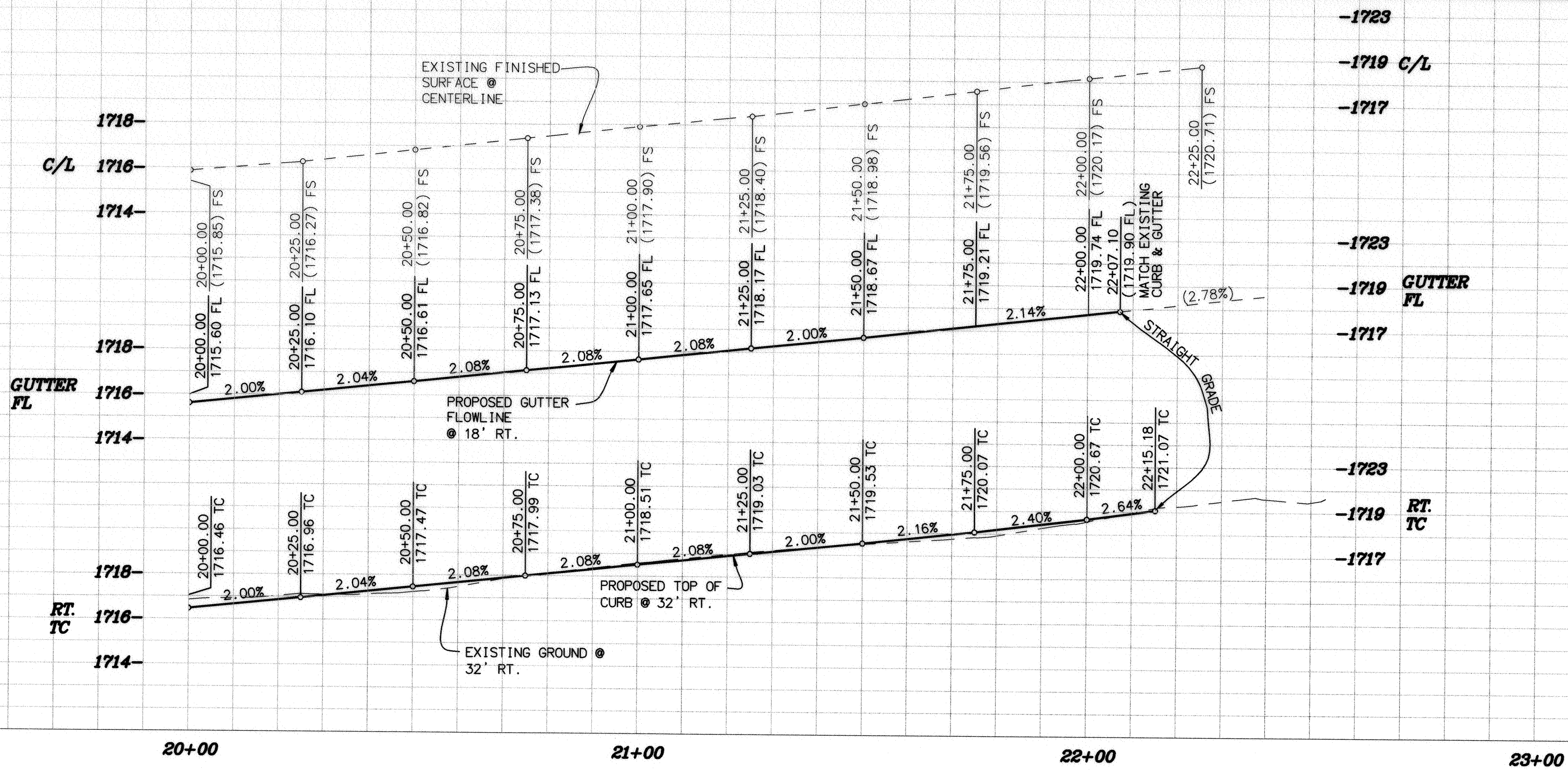

HORZ. SCALE: 1" = 20'
VERT. SCALE: 1" = 4'

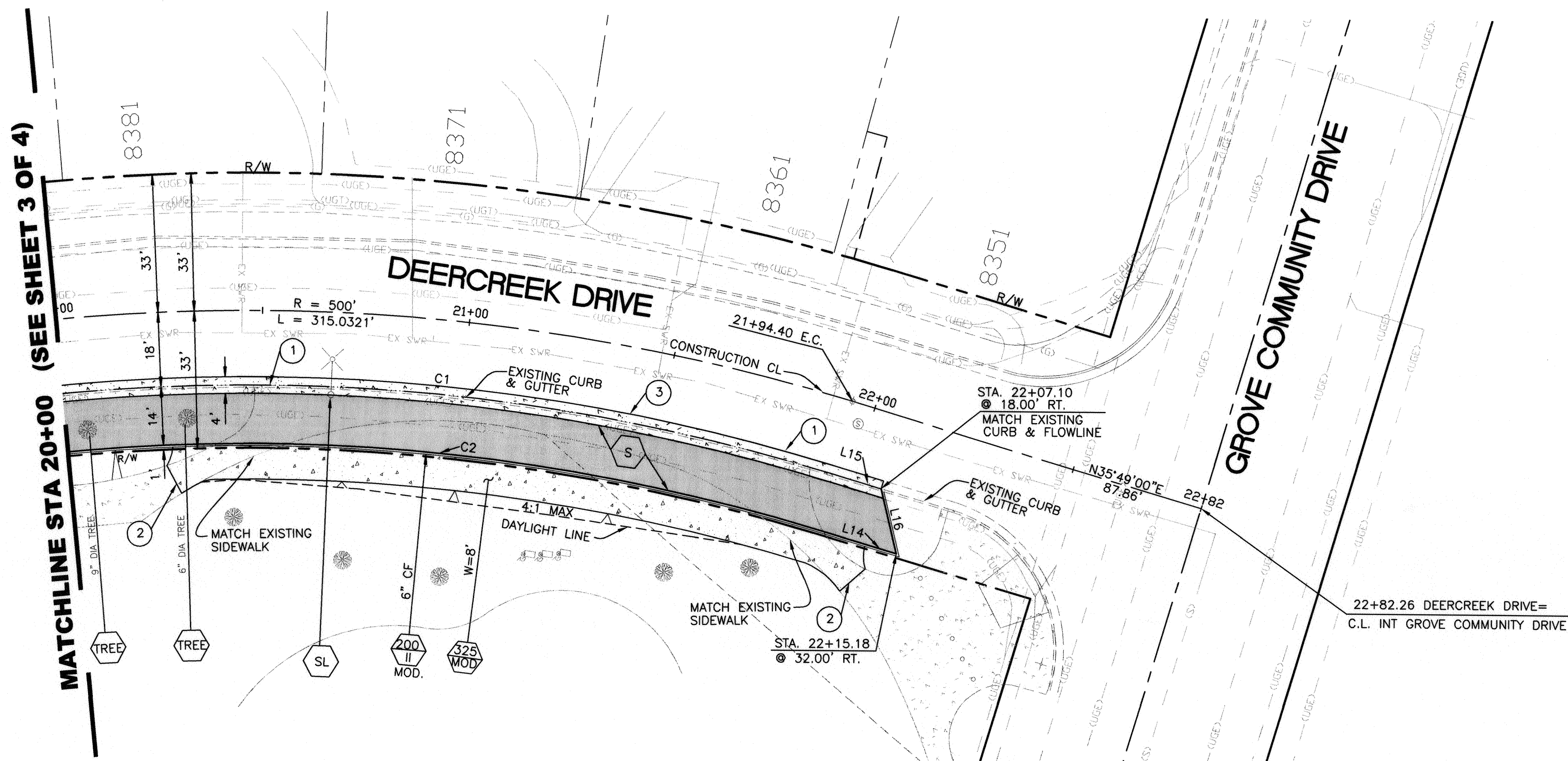

CURVE TABLE				
CURVE	LENGTH	RADIUS	DELTA	TANGENT
C1	242.04	482.00	28°46'19"	123.63
C2	227.20	468.00	27°48'56"	115.89

LINE TABLE		
LINE	LENGTH	BEARING
L14	20.78	S35°49'00"W
L15	12.70	S35°49'00"W
L16	16.20	S84°11'00"E

BENCHMARK E8-F3
P.K. NAIL AND CITY ENGINEERING TAG ON THE SIDEWALK OVER THE WESTERLY WALL OF A CATCH BASIN ALONG THE SOUTHERLY CURB OF ORANGE TERRACE PKWY, 100 FEET EASTERLY OF TRAUTWEIN ROAD, THE MARK IS 2 FEET SOUTHERLY OF THE FACE OF CURB.
ELEVATION: 1667.648 165.15 NGVD 1929

Under Ground Service Alert
Call: TOLL FREE 1-800-227-2600
TWO WORKING DAYS BEFORE YOU DIG

ENGINEER IN RESPONSIBLE CHARGE
Name: *Philip Hanon*
R.C.E. No. 44747 EXPIRES: 3-31-12
DATE: 4/29/2011



DESIGNED BY: CS DRAWN BY: CS CHECKED BY: PH

CITY OF RIVERSIDE, CALIFORNIA
DEPARTMENT OF PUBLIC WORKS
APPROVED BY: [Signature] DATE: 4/29/11
ENGINEERING MANAGER: PH
CONSTRUCTION ADMN.: DC
TRAFFIC DIVISION: [Signature]
STREETS SERVICES: [Signature]
PRINCIPAL ENGINEER: [Signature]

STREET IMPROVEMENTS
DEERCREEK DRIVE IMPROVEMENTS
FROM ORANGE TERRACE PKWY TO GROVE COMMUNITY DRIVE
STA 20+00 TO GROVE COMMUNITY DRIVE
HORIZ. SCALE: VERT. SCALE:

DESIGN WORK ORDER NO.: 1019535
CONSTR. WORK ORDER NO.: XXXXXX
R-4207
SHEET 4 OF 4
FILE NAME: R4207-04.DWG