

PUBLIC WORKS DEPARTMENT VAN BUREN BOULEVARD STREET MAINTENANCE FROM GARFIELD STREET TO WELLS AVENUE

CONSTRUCTION NOTES:

- NUMBERS ABOVE 100 IN A HEXAGON ON THE PLAN REFER TO THE RESPECTIVE STANDARD DRAWING AND SHALL BE CONSTRUCTED ACCORDINGLY. UNLESS MODIFICATIONS ARE NOTED ON THE PLAN OR COVER SHEET. ANY NUMBER SHOWN BELOW THE STANDARD DRAWING NUMBER INDICATES THE SPECIFIC ALTERNATE TO BE CONSTRUCTED.
- ADJ. ADJUST TO GRADE, DESCRIPTION PER PLAN (MH) SEWER OR STORM DRAIN. (GV) GATE VALVE. (WM) WATER METER. (MON. WELL) MONITORING WELL. (PB) PULLBOX.
- CIR. COLD IN-PLACE RECYCLE THE UPPER 0.25' OF THE EXISTING ASPHALT PAVEMENT.
- OL. CONSTRUCT A.R.H.M.-GG AC OVERLAY (0.1' MIN. THICKNESS) FOLLOWING COLD IN-PLACE RECYCLE.
- S. CONSTRUCT 0.10' A.R.H.M.-GG AC OVERLAY OVER 0.60' (B-PG-64-10) DGAC OVER 1.0' CRUSHED MISCELLANEOUS BASE.
- G1. COLD MILL EXISTING A.C. PAVEMENT TO A MINIMUM DEPTH OF 0.1' BELOW GUTTER LIP DAYLIGHTING OVER 6'.
- G2. COLD MILL EXISTING A.C. PAVEMENT TO A MINIMUM DEPTH OF 0.1' DAYLIGHTING OVER 10'.
- MOD. 200. REMOVE EXISTING CURB AND GUTTER AND REPLACE WITH NEW 6" CURB AND GUTTER PER CITY OF RIVERSIDE STD. DWG. NO. 200 TYPE I. WIDTH OF GUTTER SHALL BE MODIFIED TO BE 5' WIDE.
- MOD. 325. REMOVE EXISTING AC SIDEWALK AND REPLACE WITH PCC PER CITY OF RIVERSIDE STD. DWG. NO. 325. WIDTH OF SIDEWALK SHALL BE MODIFIED AS SHOWN ON PLAN AND AS DIRECTED BY ENGINEER IN FIELD.
- PIP. PROTECT IN PLACE. DESCRIPTION PER PLAN. SGN= SIGN, WM= WATER METER, LGT= STREET LIGHT, PP= POWER POLE, PB= PULLBOX, CLF= CHAIN LINK FENCE
- SL. RELOCATE EXISTING STREET LIGHT 2' BEHIND NEW CURB FACE PER PUBLIC UTILITIES DEPARTMENT, ELECTRIC DIVISION GUIDELINES.
- W1. 3/4" WATER SERVICE TO BE ADJUSTED BY RIVERSIDE PUBLIC UTILITIES DEPARTMENT, WATER DIVISION.
- W2. 3/4" WATER SERVICE TO BE SHORTENED BY RIVERSIDE PUBLIC UTILITIES DEPARTMENT, WATER DIVISION.
- W3. 3/4" WATER SERVICE TO BE RELOCATED BY RIVERSIDE PUBLIC UTILITIES DEPARTMENT, WATER DIVISION.
- W4. 3/4", 1" OR 2" WATER SERVICE TO BE EXTENDED BY RIVERSIDE PUBLIC UTILITIES DEPARTMENT, WATER DIVISION.
- REL. CONTRACTOR TO EXTEND EXISTING FIRE SERVICE ABOVE GROUND TO BEHIND RIGHT OF WAY PER RIVERSIDE PUBLIC UTILITIES DEPARTMENT, WATER DIVISION GUIDELINES.
- E. SEE ELECTRIC PLANS FOR ALL ELECTRIC FACILITY RELOCATIONS.
- TR. FOR RELOCATION/REMOVAL OF TRAFFIC FACILITY, SEE SIGNAL AND STRIPING PLANS.
- TEL. TELEPHONE FACILITIES TO BE RELOCATED BY AT&T.
- REM. EXISTING TREE TO BE REMOVED BY CITY FORCES PRIOR TO CONSTRUCTION.
- 1. SAWCUT AND REMOVE ALL EXISTING IMPROVEMENTS AS INDICATED.
- 2. RECONSTRUCT EXISTING CHAIN LINK FENCE AND GATES AS NECESSARY ON RIGHT OF WAY. CONTRACTOR TO FURNISH AND INSTALL NEW POSTS AND USE EXISTING FENCE.
- 3. FURNISH AND INSTALL NEW GUARD RAIL TO REPLACE EXISTING GUARD RAIL IN KIND BEHIND NEW CURB AND GUTTER. PROVIDE MINIMUM OF 4' OF CLEARANCE BETWEEN GUARD RAIL POSTS AND BACK OF NEW SIDEWALK.
- 4. RECONSTRUCT EXISTING PLANTERS AND IRRIGATION SYSTEM IN-KIND TO BACK OF PROPOSED IMPROVEMENTS.
- 5. MATCHUP TO EXISTING DRIVEWAY WITH 6" THICK AC PAVEMENT OVER 95% COMPACTED NATIVE.
- 6. MATCHUP TO EXISTING DRIVEWAY WITH 6" THICK PCC CONCRETE OVER COMPACTED NATIVE.
- 7. GRADE AT 2:1 MAX TO MATCH EXISTING WITHIN SLOPE EASEMENT. HYDROSEED ALL EXPOSED AREAS WITHIN PROJECT LIMITS.
- 8. CONSTRUCT CURB OPENING ONLY TO MATCH WIDTH OF EXISTING DRIVEWAY PER RIVERSIDE CITY STD. 302.
- 9. CONSTRUCT RETAINING CURB MONOLITHIC WITH SIDEWALK (HEIGHT VARIES 4" TO 12").

INSTALL CAGE & CONCRETE FOUNDATION PER CITY STD 2002
REPLACE CONTROLLER WITH IRRIGATION CONTROLLER MC-24 PLUS

PUBLIC UTILITIES DEPARTMENT NOTE:
 CONTRACTOR TO GIVE CITY WATER DIVISION FIVE(5) WORKING DAYS WRITTEN NOTICE PRIOR TO START OF CONSTRUCTION AND ALLOW CITY FIFTEEN(15) WORKING DAYS FOR COMPLETION OF WORK. (951-351-6368)

CITY WATER DEPARTMENT NOTE:
 A MINIMUM COVER OF 24" SHALL BE MAINTAINED ABOVE ALL WATER LINES DURING ALL EXCAVATION, BACKFILL AND COMPACTION ACTIVITIES DURING STREET IMPROVEMENTS. CONTACT TONI REDMAN @951-826-2126 IF COVER IS REDUCED BEYOND THIS OR FOR ANY OTHER QUESTIONS REGARDING THIS REQUIREMENT.

REMOVE & REPLACE DAMAGED STAMPED CONCRETE WITHIN MEDIAN. EXACT LOCATIONS TO BE FIELD VERIFIED DURING CONSTRUCTION

RELOCATE IRRIGATION AND/OR VALVES AND PULLBOX BEHIND PROPOSED SIDEWALK AND MODIFY EXISTING IRRIGATION SYSTEM AS NEEDED.

RELOCATE BUS BENCH & SIGN TO STATION 49400 AS SHOWN ON PLAN

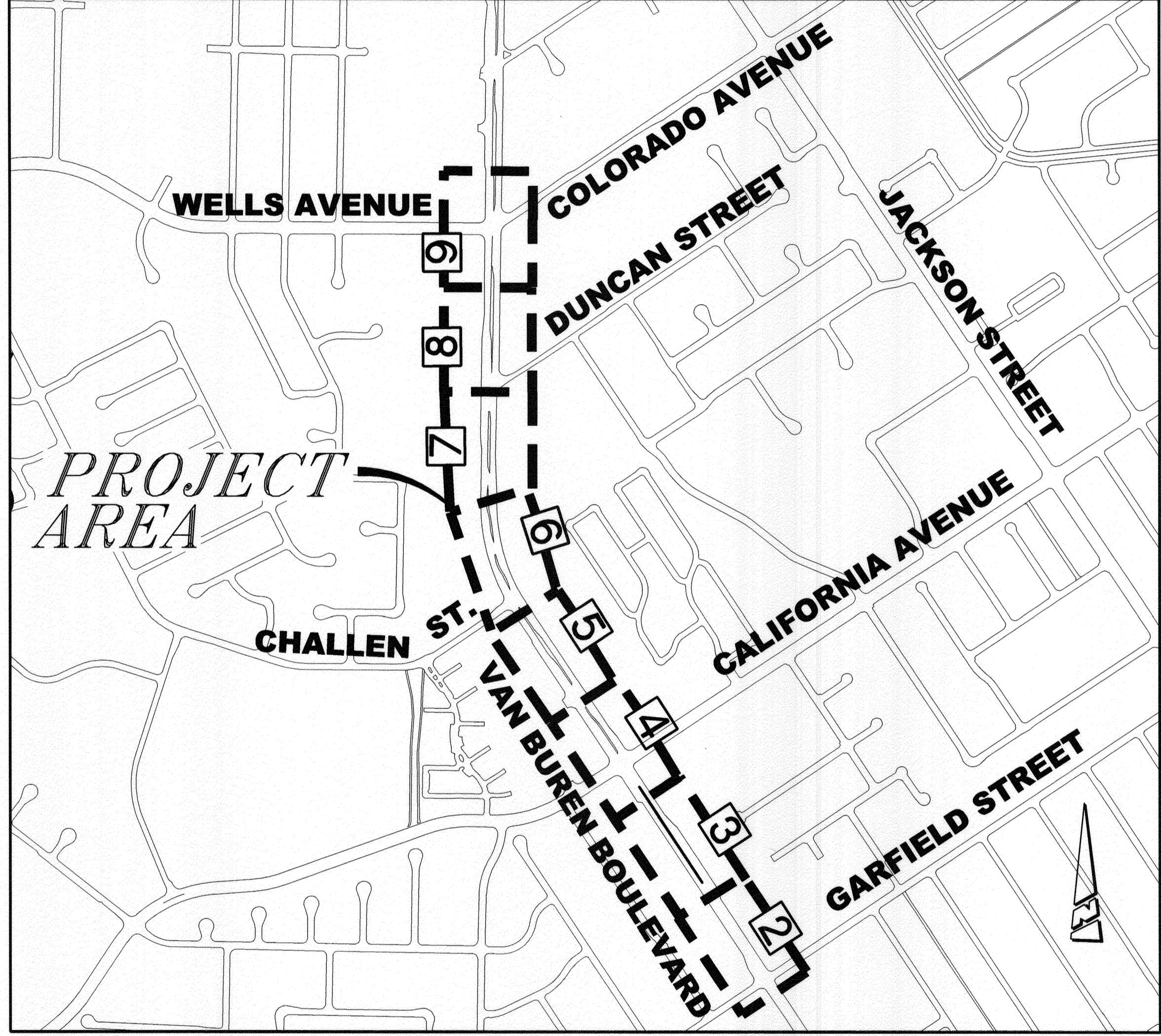

LOCATION/ INDEX MAP
N.T.S.

GENERAL NOTES:

1. PRIME CONTRACTOR BIDDING THIS PROJECT SHALL HAVE A CLASS "A" OR CLASS "C-12" LICENSE.
2. EXISTING UTILITIES SHOWN ON THIS PLAN ARE PLOTTED FROM UTILITY RECORDS. THE CONTRACTOR IS REQUIRED TO TAKE DUE PRECAUTIONARY MEASURES TO LOCATE AND PROTECT ALL UTILITIES WITHIN THE CONSTRUCTION WORK AREAS WHETHER OR NOT SHOWN ON THE PLAN. MH'S & WATER VALVES SHALL BE "TIED OUT" PRIOR TO PAVEMENT WORK FOR SUBSEQUENT ADJUSTMENT WORK. FIRE HYDRANTS MUST BE LOCATED DURING CONSTRUCTION FOR BLUE MARKER INSTALLATIONS.
3. CONSTRUCTION SHALL BE IN ACCORDANCE WITH THE CITY OF RIVERSIDE DEPARTMENT OF PUBLIC WORKS, STANDARD DRAWINGS AND THE "STANDARD SPECIFICATIONS FOR PUBLIC WORKS CONSTRUCTION", 2009 EDITION.
4. ALL COLD MILLING SHALL TAKE PLACE PRIOR TO PAVEMENT REMOVAL AND REPLACEMENT.
5. NEW STRUCTURAL SECTION FOR ALL PAVEMENT REMOVALS SHALL BE 0.60' (B-PG-64-10) DGAC OVER 1.0' CRUSHED MISCELLANEOUS BASE. DOES NOT INCLUDE OVERLAY.
6. ANY TEMPORARY TRAFFIC CONTROL STRIPING OBLITERATED AND/OR BADLY WORN DURING CONSTRUCTION SHALL BE RESTORED BY THE CONTRACTOR WITHIN ONE DAY AFTER NOTIFICATION FROM THE CITY INSPECTOR.
7. WHERE NEW PAVEMENT IS TO JOIN THE EXISTING PAVEMENT, THE EDGE OF THE EXISTING PAVEMENT SHALL BE TRIMMED IN A SMOOTH AND STRAIGHT LINE. CONSTRUCT MATCH-UP PAVING AS DIRECTED IN THE FIELD TO PRODUCE A SMOOTH SECTION.
8. SURVEY STAKING REQUESTS AND GRADE SHEETS ARE REQUIRED FOR THE REPLACEMENT OF ALL CURBS AND/OR GUTTER OVER 50' IN LENGTH. SURVEY REQUESTS SHALL BE SUBMITTED AFTER THE EXISTING IMPROVEMENTS HAVE BEEN REMOVED. CONTRACTOR SHALL ALLOW 4 WORKING DAYS AFTER REQUESTING SURVEY TO SCHEDULE SURVEY AND PROCESS GRADE SHEETS. CONTRACTOR SHALL PROVIDE TRAFFIC CONTROL FOR ALL REQUIRED CONSTRUCTION SURVEY WORK BY CITY PERSONNEL.
9. CONTRACTOR SHALL REPLACE ALL DAMAGED STRIPING IN KIND.
10. THIS PROJECT HAS APPROXIMATELY 10 RECONSTRUCTED WHEELCHAIR RAMPS. MOST RAMPS REQUIRE THE REMOVAL AND REPLACEMENT OF APPROXIMATELY 100 TO 150 SF OF RAMP AREA, 50 TO 100 SF OF SIDEWALK, 30 LF OF CURB AND GUTTER, 30 LF OF NEW RETAINING CURB. SOME RAMPS MAY REQUIRE APPROXIMATELY 200 SF OF ASPHALT CONCRETE PAVEMENT REMOVAL AND REPLACEMENT FOR CROSS-FALL. THESE QUANTITIES ARE APPROXIMATE AND MAY CHANGE ACCORDING TO EACH RAMP TYPE AND SITE CONDITIONS. RAMPS SHALL BE CONSTRUCTED PER CITY STANDARDS, ADA REQUIREMENTS AND AS DIRECTED BY THE ENGINEER. AREAS FOR REMOVAL SHALL BE MARKED BY THE CONTRACTOR AND ACCEPTED BY THE CITY ENGINEER AT THE TIME OF CONSTRUCTION. FOR LIST OF RAMP LOCATIONS AND TYPES, SEE SPECIAL PROVISIONS.

LEGEND

- RECONSTRUCT AC PAVEMENT OR PCC. DESCRIPTION PER PLAN.
- PAVEMENT REHABILITATION PER PLAN
- NEW PCC PER PLAN

SHEET INDEX:

SHEET NO.	DESCRIPTION
1	TITLE SHEET
2	STA 10+00 TO 16+00
3	STA 16+00 TO 22+00
4	STA 22+00 TO 28+00
5	STA 28+00 TO 33+00
6	STA 33+00 TO 39+00
7	STA 39+00 TO 44+50
8	STA 44+50 TO 50+00
9	STA 50+00 TO 54+00

EXISTING UNDERGROUND UTILITIES:

UTILILITY	SYMBOL
SANITARY SEWER	EX SWR
WATER LINE	EX WTR
STORM DRAIN	EX SD
UNDERGROUND GAS	(HGC)
CABLE TV	(HCC)

CURVE TABLE				
CURVE	LENGTH	RADIUS	DELTA	TANGENT
1	144.28	1500.50	05°30'33"	72.19
2	33.84	35.00	55°23'40"	18.37
3	43.27	27.00	91°14'17"	27.87
4	55.41	35.00	90°42'39"	35.44
5	33.84	35.00	55°23'31"	18.37

EXISTING TOPOGRAPHY:

- MONITORING WELL
- SANITARY SEWER M.H.
- STORM DRAIN M.H.
- WATER GATE VALE
- ELECTRIC M.H.
- TELEPHONE M.H.
- WATER METER
- ELECTRICAL TEST STATION (PIPELINE)
- FIRE HYDRANT
- IRRIGATION METER
- BLOW-OFF VALVE
- TRAFFIC SIGN
- POWER POLE
- GUY ANCHOR
- STREET LIGHT ON MAST ARM
- PCC PAVEMENT
- BUILDING
- PALM TREE
- MISC. TREE
- TOP OF SLOPE
- TOE OF SLOPE
- DIRECTION DRAINAGE FLOW
- EDGE OF PAVEMENT

BENCHMARK F4-D3
 P.K. NAIL AND CITY ENGINEER TAG IN THE MOST EASTERLY CURB RETURN OF VAN BUREN BLVD. AND GARFIELD ST.
 ELEVATION: 773.933

Under Ground Service Alert of Southern California
 Call: TOLL FREE 1-800-227-2600
 TWO WORKING DAYS BEFORE YOU DIG

ENGINEER IN RESPONSIBLE CHARGE
 Edward Lora
 R.C.E. No. 63753 EXPIRES: 9-30-12
 DATE: February 16, 2012

RELOCATE BUS STOP
 DESIGNED BY: CS DRAWN BY: CS CHECKED BY: EL

CITY OF RIVERSIDE, CALIFORNIA DEPARTMENT OF PUBLIC WORKS
 APPROVED BY: [Signature] DATE: 2/17/12
 CONSTRUCTION ADMIN. DATE: 2/17/12
 TRAFFIC DIVISION DATE: 2/17/12
 SURVEY DATE: 2/17/12
 LANDSCAPING

STREET IMPROVEMENTS
 VAN BUREN BOULEVARD FROM GARFIELD STREET TO WELLS AVENUE

CONSTR. WORK ORDER NO.: 1201403
R-4210
 SHEET 1 OF 9
 FILE NAME:

AS-BUILT 7-15-14 DC
 INDEXED 7-15-14 DC

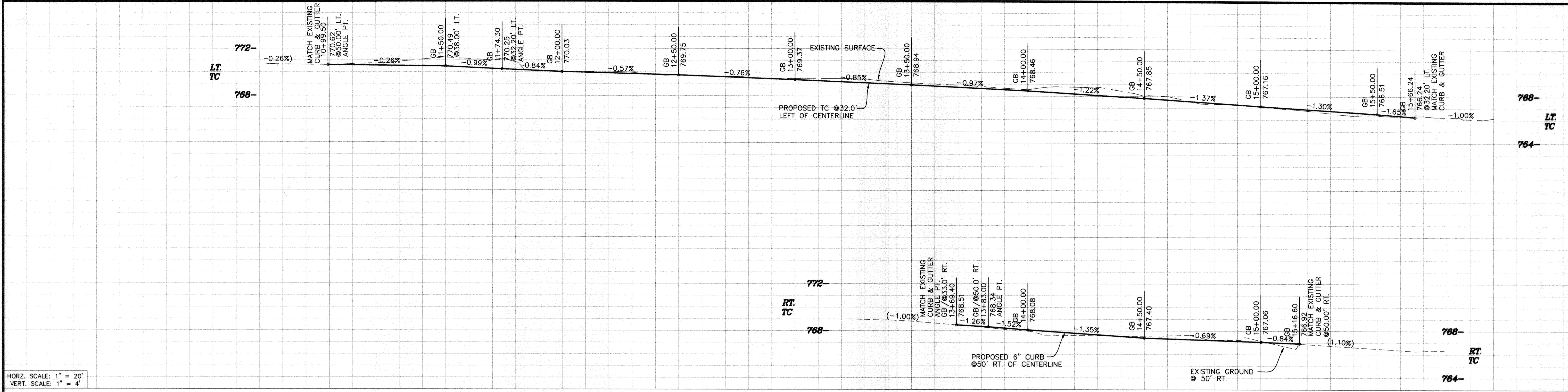

HORZ. SCALE: 1" = 20'
VERT. SCALE: 1" = 4'

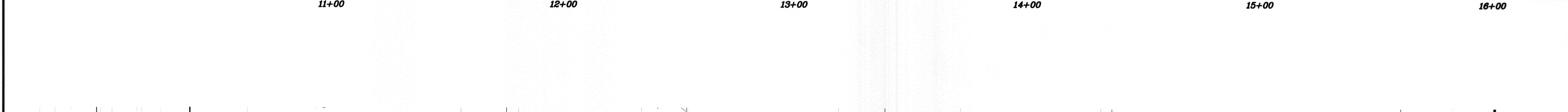

GARFIELD ST

VAN BUREN BLVD

MATCHLINE STA 16+00 (SEE SHEET 3 OF 9)

BENCHMARK F4-D3
P.K. NAIL AND CITY ENGINEER TAG IN THE MOST
EASTERLY CURB RETURN OF VAN BUREN BLVD

HORZ. SCALE: 1" = 20'
VERT. SCALE: 1" = 4'

16+00 17+00 18+00 19+00 20+00 21+00 22+00

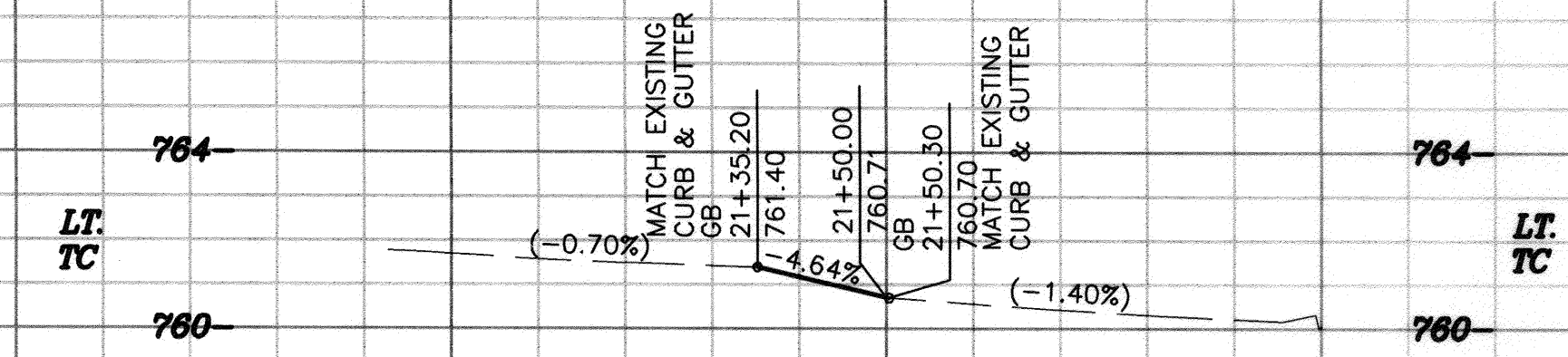
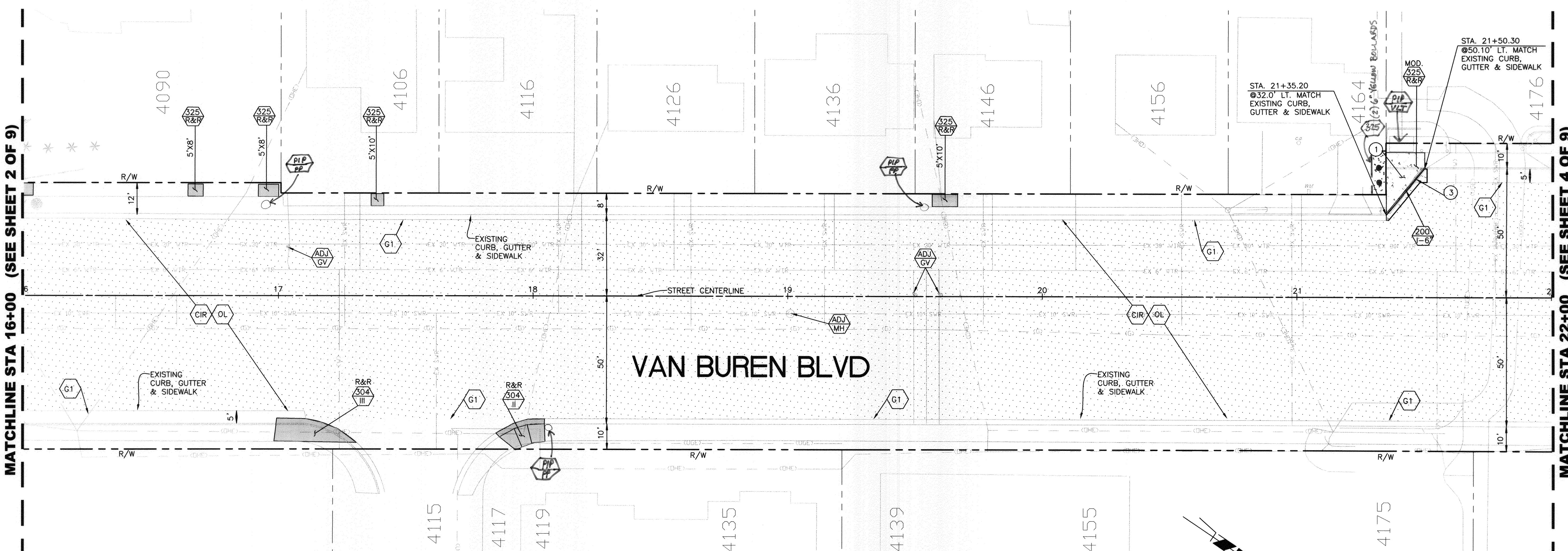

MATCHLINE STA 16+00 (SEE SHEET 2 OF 9)

MATCHLINE STA 22+00 (SEE SHEET 4 OF 9)

BENCHMARK F4-D3
P.K. NAIL AND CITY ENGINEER TAG IN THE MOST EASTERLY CURB RETURN OF VAN BUREN BLVD. AND GARFIELD ST.
ELEVATION: 773.933

Under Ground Service Alert of Southern California
Call: TOLL FREE 1-800-227-2600
TWO WORKING DAYS BEFORE YOU DIG

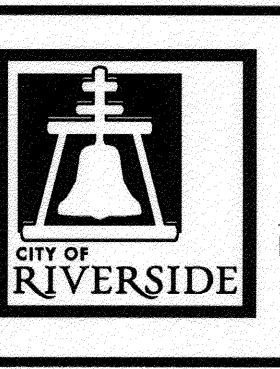

ENGINEER IN RESPONSIBLE CHARGE
Edward Lora
Name: Edward Lora
R.C.E. No. 63753 EXPIRES: 9-30-12
DATE: February 16, 2012

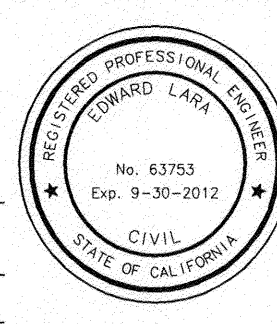

MARK	REVISIONS	APPR.	DATE

DESIGNED BY: CS DRAWN BY: CS CHECKED BY: EL

CITY OF RIVERSIDE, CALIFORNIA DEPARTMENT OF PUBLIC WORKS			
APPROVED BY	BY	DATE	APPROVED BY
ENGINEERING MANAGER	<i>FM</i>	2/13/12	<i>[Signature]</i>
CONSTRUCTION ADMIN.	<i>AG</i>	2/13/12	CITY ENGINEER
TRAFFIC DIVISION	<i>AW</i>	2-12-12	
SURVEY	<i>S</i>	2/11/12	DATE: 2/13/12
LANDSCAPING			

STREET IMPROVEMENTS
VAN BUREN BOULEVARD
FROM GARFIELD STREET TO WELLS AVENUE

CONSTR. WORK ORDER NO.: 1201403
R-4210
SHEET **3** OF **9**
FILE NAME: R4207-02

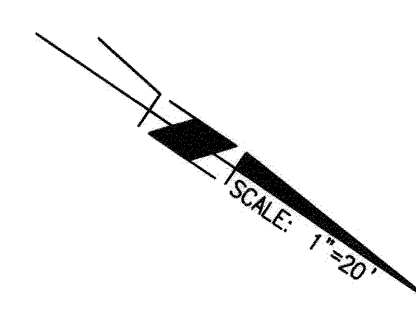

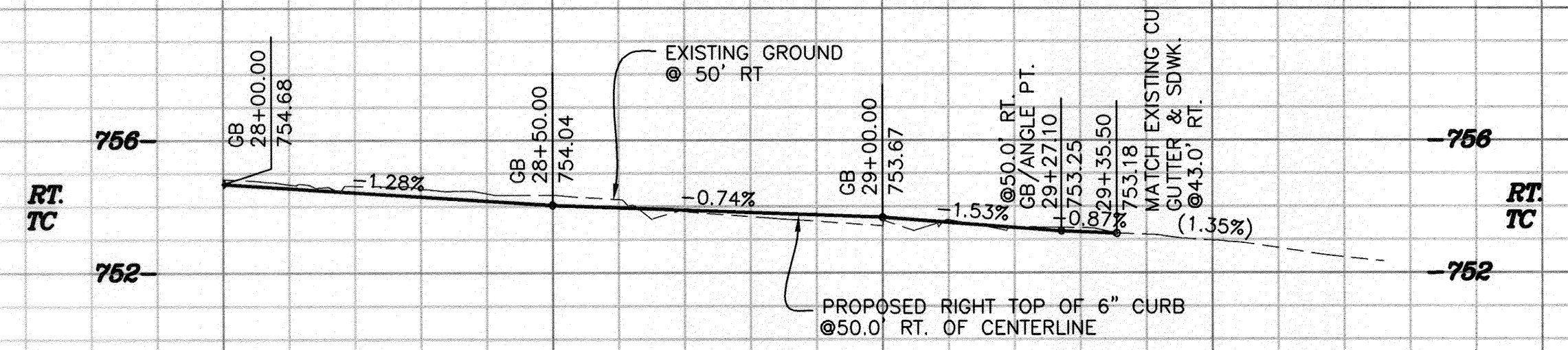

HORZ. SCALE: 1" = 20'
VERT. SCALE: 1" = 4'

28+00 29+00 30+00 31+00 32+00 33+00

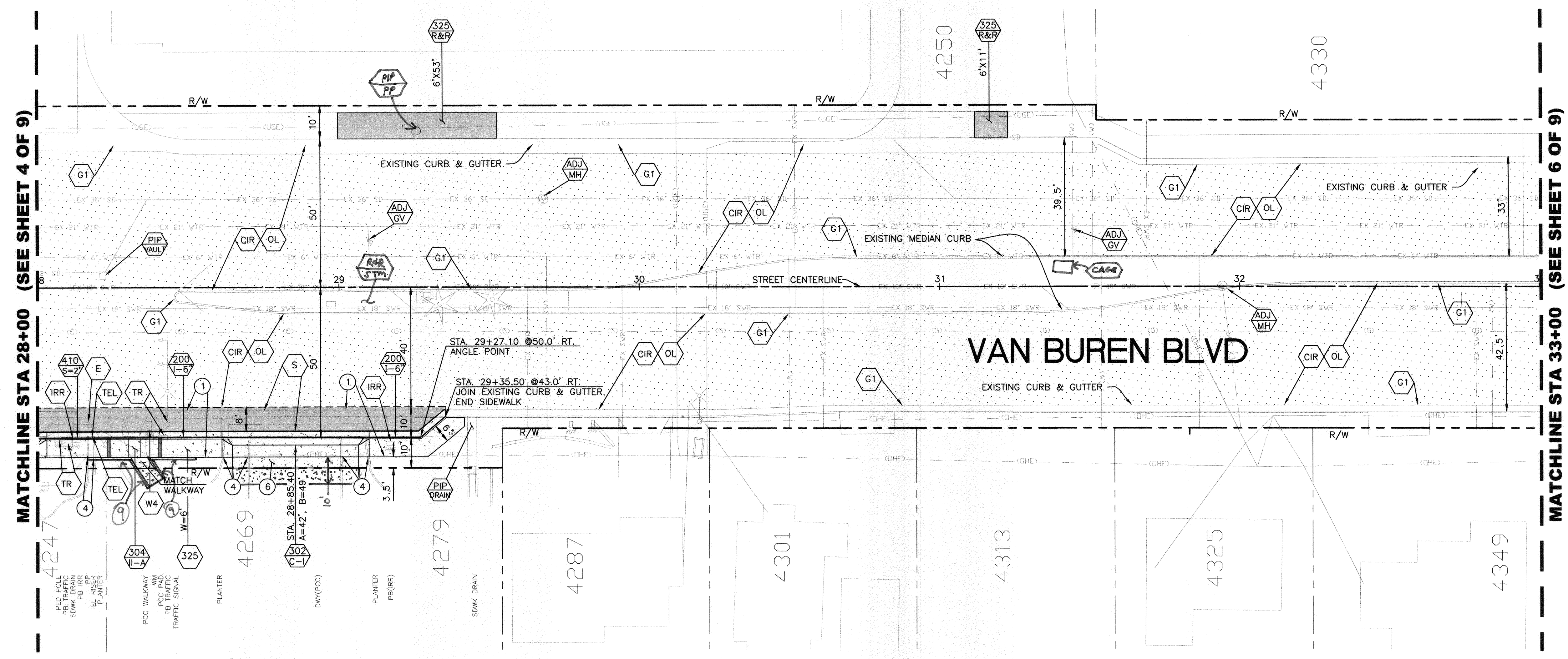

MATCHLINE STA 28+00 (SEE SHEET 4 OF 9)

MATCHLINE STA 33+00 (SEE SHEET 6 OF 9)

BENCHMARK F4-D3
P.K. NAIL AND CITY ENGINEER TAG IN THE MOST
EASTERLY CURB RETURN OF VAN BUREN BLVD. AND
GARFIELD ST.
ELEVATION: 773.933

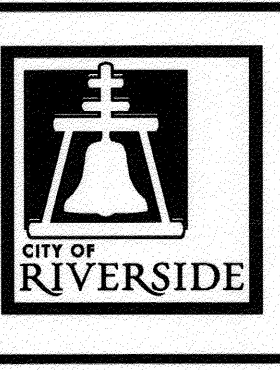
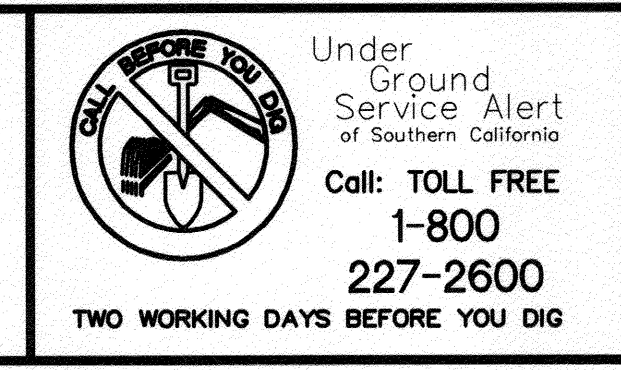

ENGINEER IN RESPONSIBLE CHARGE
Edward Lane
Name: Edward Lane
R.C.E. No. 63753 EXPIRES: 9-30-12
DATE: February 16, 2012

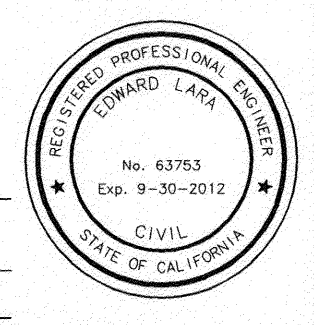

MARK	REVISIONS	APPR.	DATE

CITY OF RIVERSIDE, CALIFORNIA DEPARTMENT OF PUBLIC WORKS			
APPROVED BY	BY	DATE	APPROVED BY
ENGINEERING MANAGER	Fm	2/17/12	<i>[Signature]</i>
CONSTRUCTION ADMIN.	DG	2/17/12	CITY ENGINEER
TRAFFIC DIVISION	E.H.	2-17-12	
SURVEY	CS	2/17/12	DATE: 2/17/12
LANDSCAPING			

STREET IMPROVEMENTS
VAN BUREN BOULEVARD
FROM GARFIELD STREET
TO WELLS AVENUE

CONSTR. WORK ORDER NO.: 1201403
R-4210
SHEET **5** OF **9**
FILE NAME: R4207-02

HORZ. SCALE: 1" = 20'
 VERT. SCALE: 1" = 4'

33+00

34+00

35+00

36+00

37+00

38+00

39+00

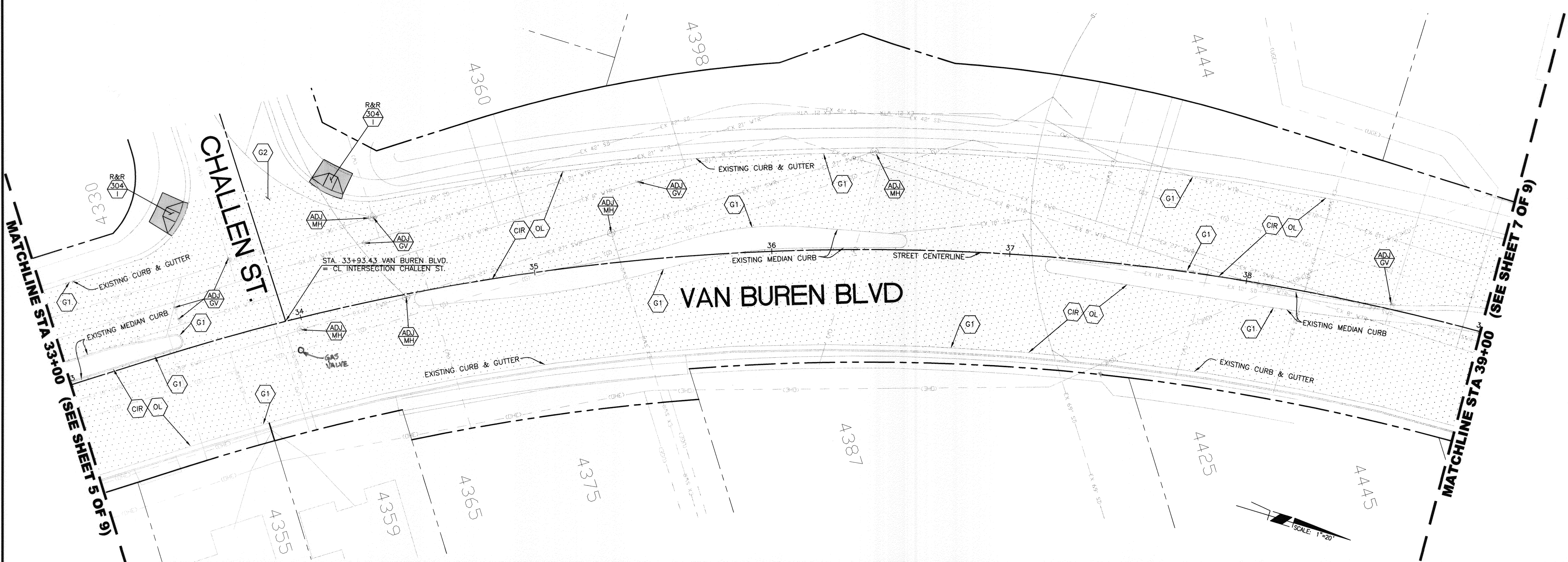

MATCHLINE STA 33+00 (SEE SHEET 5 OF 9)

MATCHLINE STA 39+00 (SEE SHEET 7 OF 9)

BENCHMARK F4-D3
 P.K. NAIL AND CITY ENGINEER TAG IN THE MOST
 EASTERLY CURB RETURN OF VAN BUREN BLVD. AND
 GARFIELD ST.
 ELEVATION: 773.933

Under
 Ground
 Service Alert
 of Southern California
 Call: TOLL FREE
 1-800
 227-2600
 TWO WORKING DAYS BEFORE YOU DIG

**ENGINEER IN
 RESPONSIBLE CHARGE**
Edward Lara
 Name
 R.C.E. No. 63753 EXPIRES: 9-30-12
 DATE: February 16, 2012

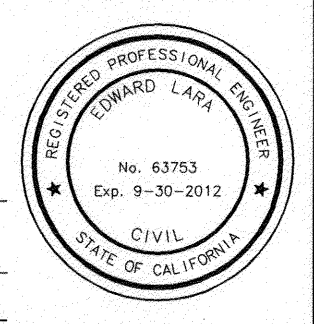

MARK	REVISIONS	APPR.	DATE

DESIGNED BY: CS DRAWN BY: CS CHECKED BY: EL

CITY OF RIVERSIDE, CALIFORNIA DEPARTMENT OF PUBLIC WORKS			
APPROVED BY	BY	DATE	APPROVED BY
ENGINEERING MANAGER	FM	2/17/12	<i>[Signature]</i>
CONSTRUCTION ADMIN.	DC	2/17/12	CITY ENGINEER
TRAFFIC DIVISION	CS	2-17-12	DATE: 2/17/12
SURVEY	CS	2/17/12	
LANDSCAPING			

STREET IMPROVEMENTS
VAN BUREN BOULEVARD
 FROM GARFIELD STREET
 TO WELLS AVENUE

CONSTR. WORK ORDER NO.: 1201403
R-4210
 SHEET **6** OF **9**
 FILE NAME: R4207-02

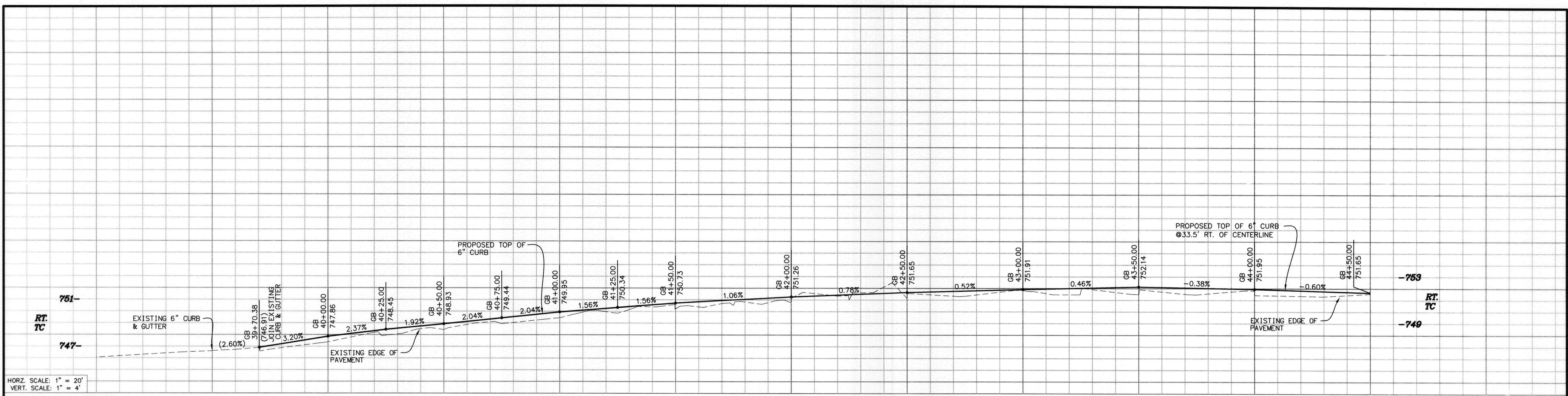

HORZ. SCALE: 1" = 20'
 VERT. SCALE: 1" = 4'

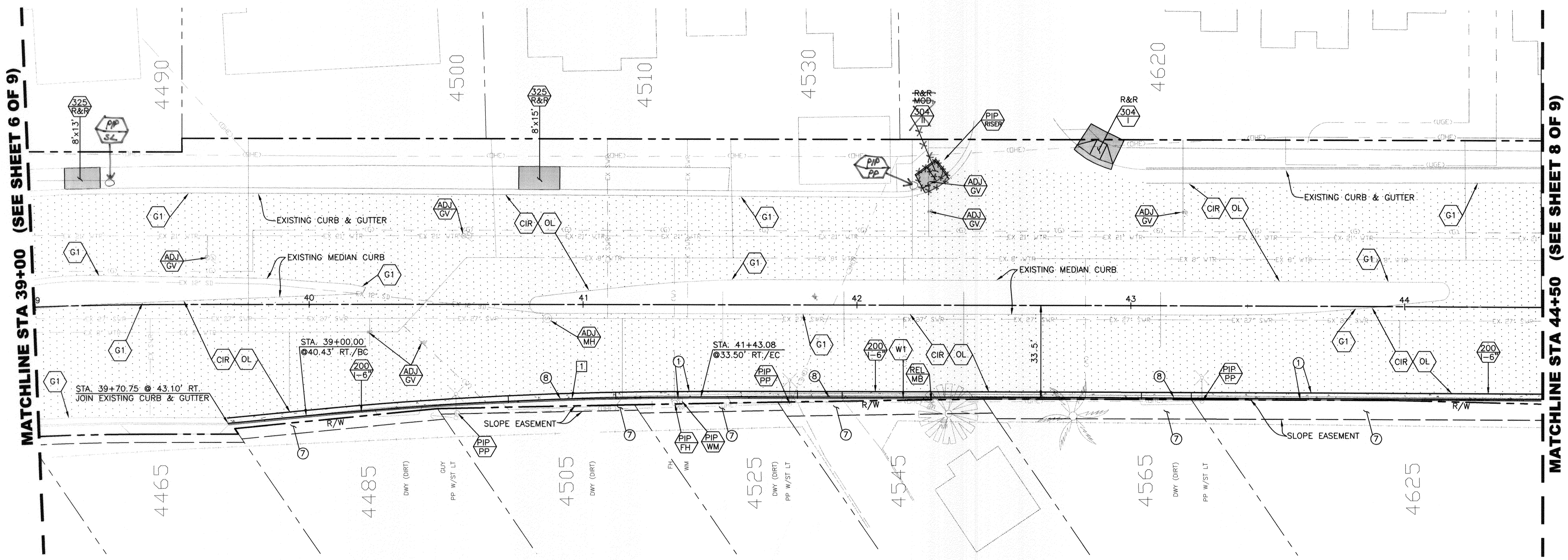

BENCHMARK F4-D3
 P.K. NAIL AND CITY ENGINEER TAG IN THE MOST
 EASTERLY CURB RETURN OF VAN BUREN BLVD. AND
 GARFIELD ST.
 ELEVATION: 773.933

Under Ground
 Service Alert
 of Southern California
 Call: TOLL FREE
 1-800
 227-2600
 TWO WORKING DAYS BEFORE YOU DIG

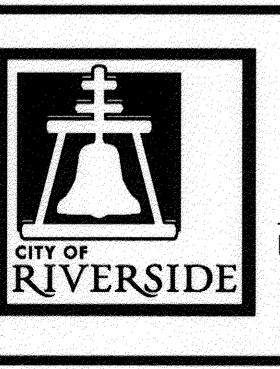

ENGINEER IN RESPONSIBLE CHARGE
Edward Lora
 Name
 R.C.E. No. 63753 EXPIRES: 9-30-12
 DATE: February 16, 2012

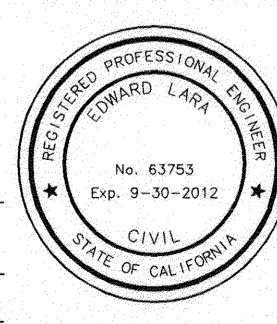

MARK	REVISIONS	APPR.	DATE

DESIGNED BY: CS DRAWN BY: CS CHECKED BY: EL

CITY OF RIVERSIDE, CALIFORNIA DEPARTMENT OF PUBLIC WORKS			
APPROVED BY:	BY:	DATE:	APPROVED BY:
ENGINEERING MANAGER	EM	2/17/12	<i>[Signature]</i>
CONSTRUCTION ADMIN.	CC	2/17/12	CITY ENGINEER
TRAFFIC DIVISION	TD	2-12-12	
SURVEY		2/17/12	DATE: 2/21/2012
LANDSCAPING			

STREET IMPROVEMENTS
VAN BUREN BOULEVARD
 FROM GARFIELD STREET
 TO WELLS AVENUE

CONSTR. WORK ORDER NO.: 1201403
R-4210
 SHEET **7** OF **9**
 FILE NAME: R4207-02

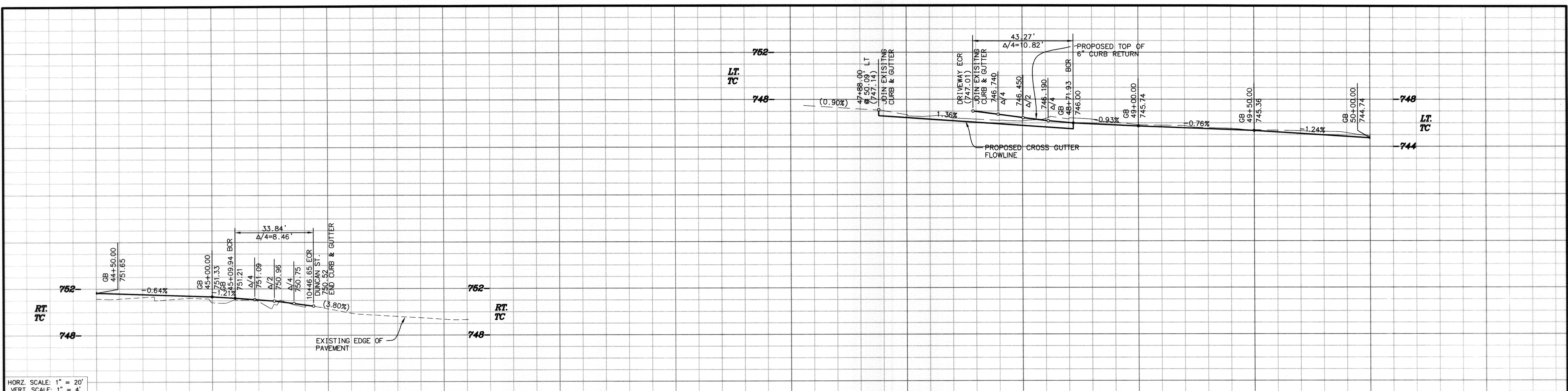

HORIZ. SCALE: 1" = 20'
VERT. SCALE: 1" = 4'

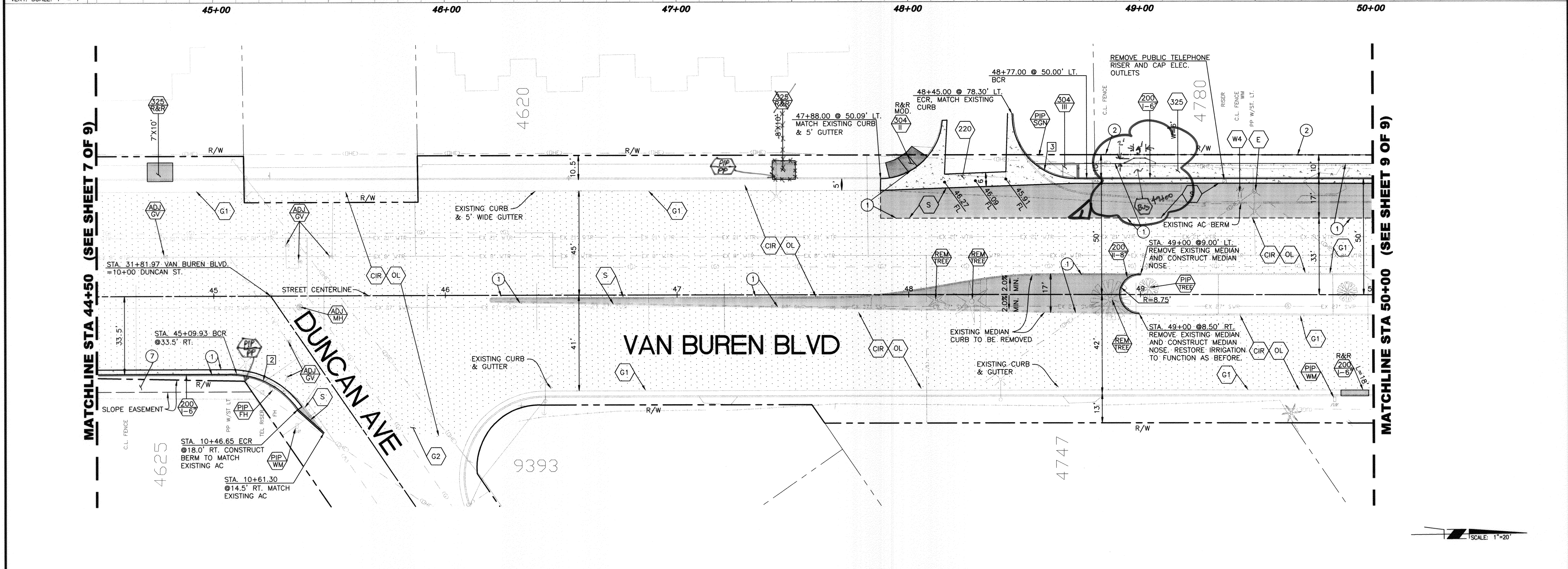

MATCHLINE STA 44+50 (SEE SHEET 7 OF 9)

MATCHLINE STA 50+00 (SEE SHEET 9 OF 9)

SCALE: 1"=20'

<p>BENCHMARK F4-D3</p> <p>P.K. NAIL AND CITY ENGINEER TAG IN THE MOST EASTERLY CURB RETURN OF VAN BUREN BLVD. AND GARFIELD ST.</p> <p>ELEVATION: 773.933</p>	<p>Under Ground Service Alert of Southern California</p> <p>Call: TOLL FREE 1-800-227-2600</p> <p>TWO WORKING DAYS BEFORE YOU DIG</p>	<p>ENGINEER IN RESPONSIBLE CHARGE</p> <p><i>Edward Lora</i></p> <p>Name: Edward Lora</p> <p>R.C.E. No. 63753 EXPIRES: 9-30-12</p> <p>DATE: February 16, 2012</p>	<p>DESIGNED BY: CS DRAWN BY: CS CHECKED BY: EL</p>	<p>CITY OF RIVERSIDE, CALIFORNIA</p> <p>DEPARTMENT OF PUBLIC WORKS</p>		<p>STREET IMPROVEMENTS</p> <p>VAN BUREN BOULEVARD</p> <p>FROM GARFIELD STREET TO WELLS AVENUE</p>	<p>CONSTR. WORK ORDER NO.: 1201403</p> <p>R-4210</p> <p>SHEET 8 OF 9</p> <p>FILE NAME: R4207-02</p>
				<p>APPROVED BY: <i>FM</i> DATE: 2/17/12</p> <p>CONSTRUCTION ADMIN. DATE: 2/17/12</p> <p>TRAFFIC DIVISION: <i>CS</i> DATE: 2/17/12</p> <p>SURVEY DATE: 2/17/12</p> <p>LANDSCAPING DATE: 2/17/12</p>	<p>APPROVED BY: <i>Handwritten Signature</i> DATE: 2/17/12</p> <p>CITY ENGINEER</p>		

