

RIVERSIDE

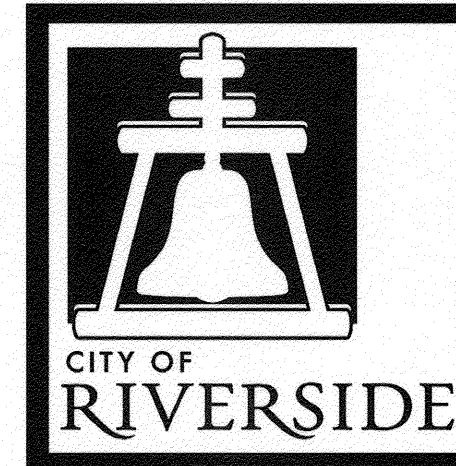

CALIFORNIA

PUBLIC WORKS DEPARTMENT

2012/2013

MINOR STREETS MAINTENANCE, PHASE 2

GENERAL CONSTRUCTION NOTES:

1. THE CONTRACTOR SHALL PROVIDE AND MAINTAIN TRAFFIC CONTROL AS INDICATED IN THE ASSOCIATED PROJECT SPECIAL PROVISIONS.
2. CONSTRUCTION SHALL BE IN ACCORDANCE WITH THE CITY OF RIVERSIDE STANDARD DRAWINGS AND STANDARD SPECIFICATIONS FOR PUBLIC WORKS CONSTRUCTION, 2012 EDITION.
3. EXISTING UTILITIES SHOWN ON THIS PLAN ARE PLOTTED FROM UTILITY RECORDS. THE CONTRACTOR IS REQUIRED TO TAKE DUE PRECAUTIONARY MEASURES TO LOCATE AND PROTECT ALL UTILITIES WHETHER OR NOT SHOWN ON THIS PLAN.
4. CONFLICTING UTILITIES SHOWN WITHIN CONSTRUCTION AREA WILL BE RELOCATED PRIOR TO CONSTRUCTION.
5. ALL STREET PULL BOXES, AFFECTED BY CONSTRUCTION, SHALL BE ADJUSTED TO THE PROPOSED GRADE.
6. PRIME CONTRACTOR BIDDING THIS WORK SHALL HAVE A CLASS "A" OR "C-12".
7. ANY DISTRESSED EXISTING PAVEMENT SHALL BE REMOVED AND REPLACED AS DIRECTED BY ENGINEERING PRIOR TO PLACEMENT OF ARAM.

SPECIFIC CONSTRUCTION NOTES:

- NUMBERS ABOVE 100 IN A HEXAGON ON THE PLAN REFER TO THE RESPECTIVE STANDARD DRAWING AND SHALL BE CONSTRUCTED ACCORDINGLY. UNLESS MODIFICATIONS ARE NOTED ON THE PLAN OR COVER SHEET, ANY NUMBER SHOWN BELOW THE STANDARD DRAWING NUMBER INDICATES THE SPECIFIC ALTERNATE TO BE CONSTRUCTED.
- ADJUST EXISTING FACILITY TO GRADE. THE FOLLOWING IS THE LEGEND: GV = GATE VALVE; MH = MANHOLE COVER (D = STORM DRAIN; S = SEWER); CO = CLEANOUT; WM = WATER METER; GM = GAS METER; TEL = TELECOMMUNICATIONS; IRR = IRRIGATION BOX; TV = CATV RISER
- 0.12' DEEP MIN. LINEAR COLD MILL OF EXISTING AC PAVEMENT. XX = WIDTH(FEET) OF LINEAR COLD MILL AS INDICATED ON PLANS.
- FULL-DEPTH COLD MILL OF AC PAVEMENT TO EXISTING BASE OR SUBGRADE AND REPLACE WITH NEW DGAC PAVEMENT. REPLACEMENT DEPTH TO MATCH EXISTING AC THICKNESS (BASE OR SUBGRADE SHALL BE REMOVED AND COMPACTED AS NECESSARY TO INSTALL 0.25' MIN. REPLACEMENT DGAC.
- CONSTRUCT SYSTEM 1 ARAM PER DETAIL AND AS DESCRIBED IN THE SPECIAL PROVISIONS.
- OVERLAY WITH NEW DGAC PAVEMENT TO A DEPTH PER PLAN.
- CONSTRUCT TYPE 2 SLURRY SEAL AS DESCRIBED IN SPECIAL PROVISIONS.
- PROTECT IN PLACE EXISTING FACILITY. THE FOLLOWING IS THE LEGEND: CB = CATCH BASIN; SL = STREET LIGHT; PP = POWER POLE; WM = WATER METER; FH = FIRE HYDRANT; TR = TREE; RMP = WHEELCHAIR RAMP; INLET = CURB SIDE INLET; DWY = CONCRETE DRIVEWAY
- CONTRACTOR SHALL COMPLETELY REMOVE AND RECONSTRUCT A NEW SIGNAL FOUNDATION FOR THE EXISTING TYPE 1A TRAFFIC POLE. CONTRACTOR SHALL FURNISH AND INSTALL A TEMPORARY FOUNDATION FOR THE EXISTING POLE. THIS WORK SHALL BE DONE BY A TRAFFIC SIGNAL CONTRACTOR.

CONSTRUCTION LEGEND:

- SLURRY SEAL OR ARAM AND SLURRY SEAL PER PLAN
- CONCRETE SURFACE
- CM1 - COLDMILL WIDTH PER PLAN
- CM3 - FULL DEPTH DGAC REMOVAL AND REPLACEMENT
- 3.5" THICK COLORED STAMPED CONCRETE. (SEE SPECIAL PROVISIONS)

EXISTING TOPOGRAPHY:

- SANITARY SEWER M.H.
- STORM DRAIN M.H.
- WATER GATE VALE
- ELECTRIC M.H.
- TELEPHONE M.H.
- WATER METER
- FIRE HYDRANT
- IRRIGATION METER
- BLOW-OFF VALVE
- TRAFFIC SIGN
- POWER POLE
- GUY ANCHOR
- STREET LIGHT ON MAST ARM
- ELECTRICAL TEST STATION (PIPELINE)

STREET SHEET INDEX: (R-4247)

SHEET NO.	DESCRIPTION
1	TITLE SHEET & NOTES
2	PROJECT AREA 1: (OLYMPIA, LEUCADIA, MENDOCINO, PRESIDIO, TANFORAN, EUREKA AND CARDIFF)
3	PROJECT AREA 1: (VERONA, FALLSVALE, ASTORIA, SAN JOAQUIN, HILLSBOROUGH, OLYMPIA AND JAMAICA)
4	PROJECT AREA 2: (OLD RANCH-EAST, OLD RANCH-WEST)
5	PROJECT AREA 3: (PALM)
6	PROJECT AREA 3 & 4: (PALM, TEQUESQUITE, WONG AND PINE)

TRAFFIC SHEET INDEX: (XL-709)

SHEET NO.	DESCRIPTION
1	SIGNING & STRIPING PLAN (PROJECT AREA 4)
2	SIGNING & STRIPING PLAN (PROJECT AREA 4)

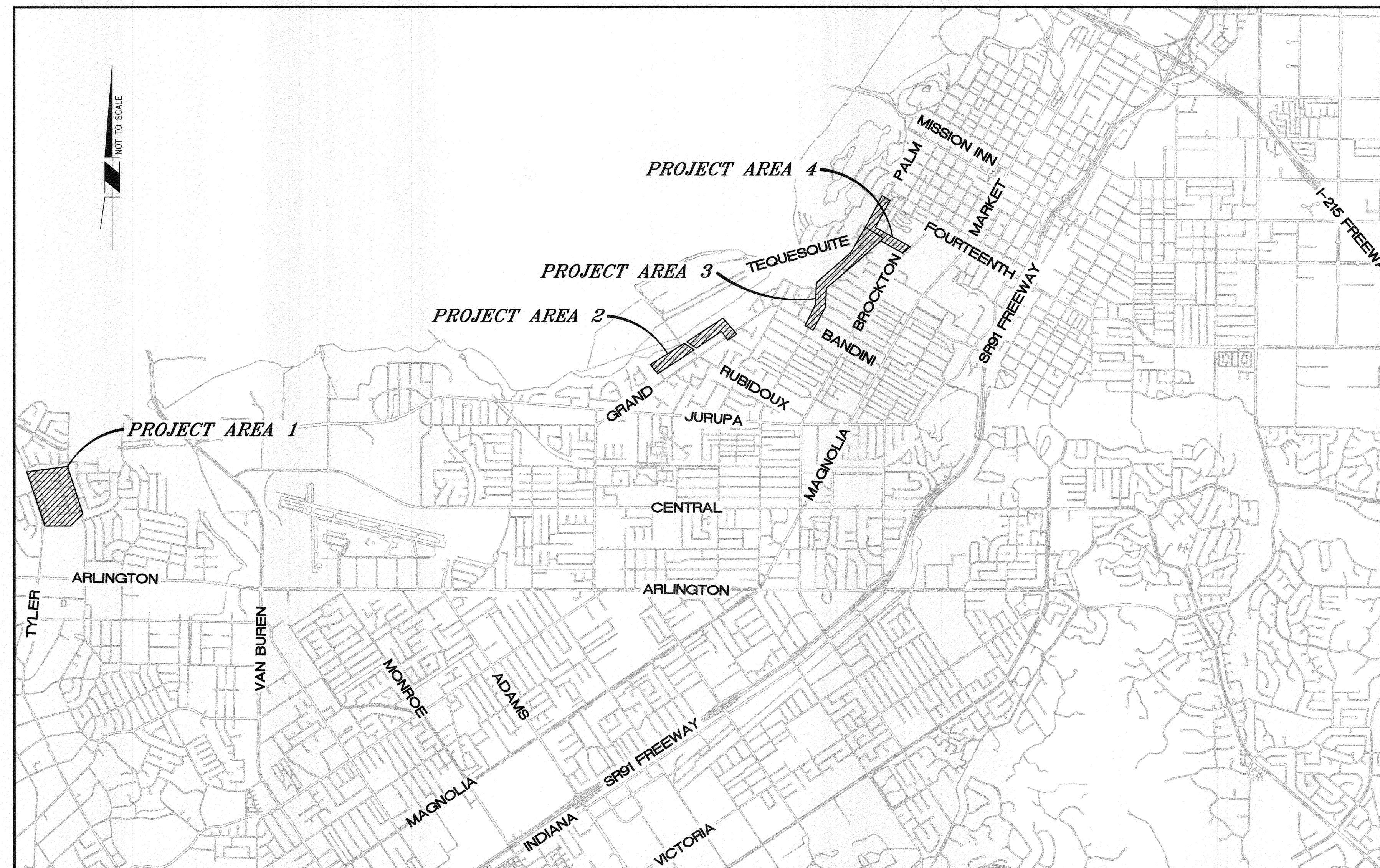

VICINITY MAP

SCALE: NOT TO SCALE

LEGEND:

PROJECT LOCATION

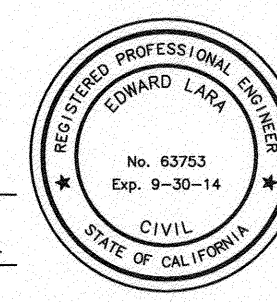
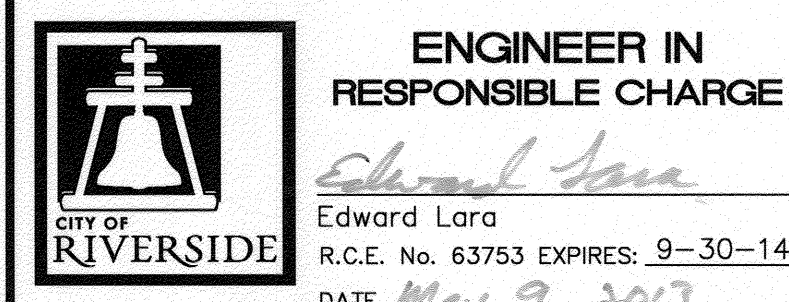

MARK	REVISIONS	APPR.	DATE

CITY OF RIVERSIDE, CALIFORNIA DEPARTMENT OF PUBLIC WORKS			
APPROVED BY	BY	DATE	APPROVED BY
ENGINEERING MANAGER	EL	5/9/13	
CONSTRUCTION ADMIN.	DC	5/9/13	CITY ENGINEER
TRAFFIC DIVISION		5/9/13	
STREETS			DATE 5/9/2013

STREET MAINTENANCE	
2012/2013 MINOR STREETS MAINTENANCE, PHASE 2	
TITLE SHEET AND NOTES	
HORIZ. SCALE: N/A	VERT. SCALE: N/A

DESIGN WORK ORDER NO.: 1303003	CONSTR. WORK ORDER NO.: 1324991
R-4247	
SHEET 1 OF 6	
FILE NAME: R4247-01.DWG	

AS-BUILT 10-27-15 DC

INDEXED 10-27-15 DC

SIGN QUANTITIES - THIS SHEET									
SIGN NUMBER	SIGN CODE	PANEL SIZE (IN)	INSTALL ROADSIDE SIGN(S)			INSTALL STREET NAME SIGN	RELOCATE ROADSIDE SIGN(S) OR SNS		REMOVE SIGN(S)
			NO POST	ONE POST	TWO POST		NO POST	ONE POST	
02-01	R1-1	30X30		1					1
02-02	SNS	9"				1			1
02-03	"NEIGH WATCH"	-							1
02-04	R1-1	30X30		1					1
02-05	SNS	9"				1			1
02-06	SNS	9"				1			1
02-07	R1-1	30X30		1					1
02-08	SNS	9"				1			1
02-09	SNS	-							1
02-10	R1-1	30X30		1					1
02-11	SNS	9"				1			1
02-12	SNS	9"				1			1
02-13	R1-1	30X30		1					1
02-14	R1-1	30X30		1					1
02-15	SNS	9"				1			1
02-16	R1-1	30X30		1					1
02-17	SNS	9"				1			1
02-18	R1-1	-							1
GRAND TOTAL:				7		8			14

SEE CITY OF RIVERSIDE STD DWG NO. 664 FOR ROADSIDE SIGNS
 SEE CITY OF RIVERSIDE STD DWG NO. 662 FOR STREET NAME SIGNS
 SNS = STREET NAME SIGN
 * = THE SIZE SHALL MATCH THE EXISTING

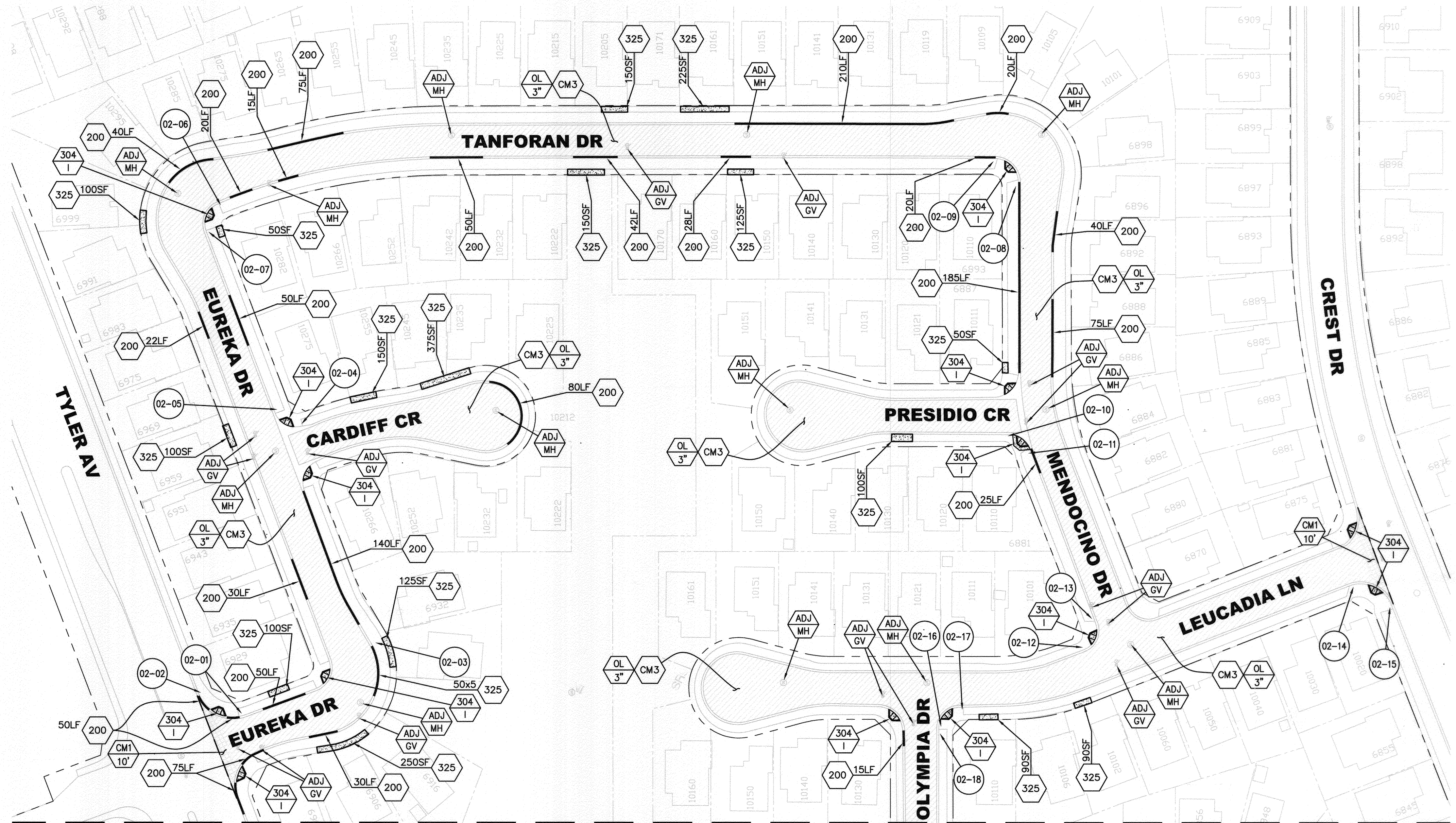

MATCH LINE - SEE SHEET 3

PAVEMENT MARKING QUANTITIES - THIS SHEET			
LOCATION	"STOP" LEGEND	12" WHITE LIMIT LINE	DETAIL 22
EUREKA & TYLER	1	25 L.F.	50 L.F.
EUREKA & CARDIFF	1	25 L.F.	-
EUREKA & TANFORAN (*)	2	40 L.F.	245 L.F.
TANFORAN & MENDOCINO (*)	2	40 L.F.	245 L.F.
MENDOCINO & PRESIDIO	1	25 L.F.	-
MENDOCINO & LEUCADIA	1	25 L.F.	-
LEUCADIA & CREST	1	25 L.F.	-
LEUCADIA & OLYMPIA	1	25 L.F.	-

- NOTE:
1. ALL STRIPING SHALL BE THERMOPLASTIC AND CONFORM TO THE STATE OF CALIFORNIA "CALTRANS" 2010 STANDARD PLANS AND SPECIFICATIONS FOR PAVEMENT DELINEATION.
 2. LIMIT LINES SHALL NEVER BE INSTALLED IN CROSS GUTTERS.
 3. ALL CAT TRACKING SHALL BE APPROVED BY THE ENGINEER OR HIS REPRESENTATIVE BEFORE FINAL DELINEATION WILL BE INSTALLED.
 4. (*) = SEE TYPICAL 2-WAY STOP DETAIL FOR STRIPING LAYOUT

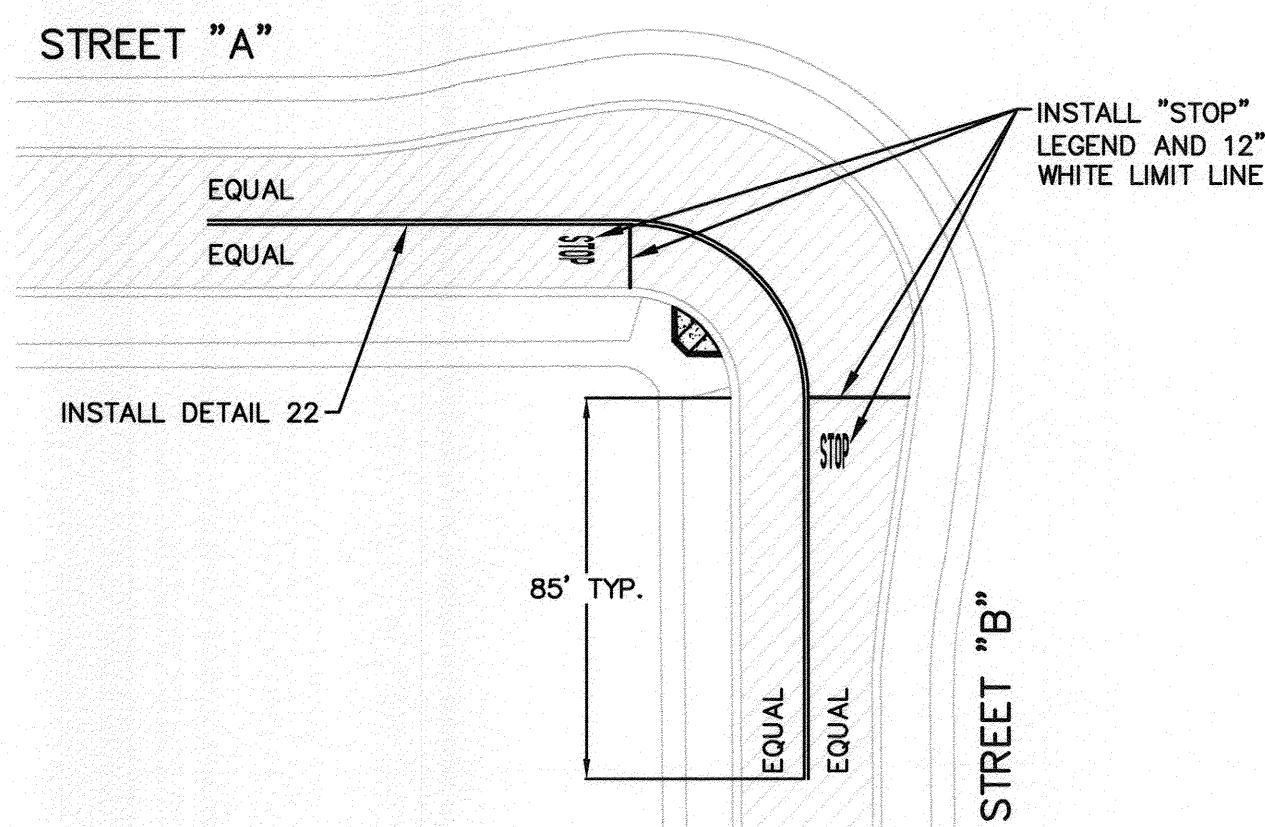

TYPICAL 2-WAY STOP DETAIL:

N.T.S.

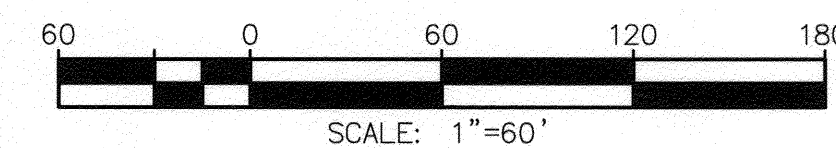

Under Ground Service Alert of Southern California
 Call: TOLL FREE 1-800-227-2600
 TWO WORKING DAYS BEFORE YOU DIG

ENGINEER IN RESPONSIBLE CHARGE
 Edward Lara
 R.C.E. No. 63753 EXPIRES: 9-30-14
 DATE: May 9, 2013

MARK	REVISIONS	APPR.	DATE

CITY OF RIVERSIDE, CALIFORNIA
 DEPARTMENT OF PUBLIC WORKS

APPROVED BY ENGINEERING MANAGER CONSTRUCTION ADMIN. TRAFFIC DIVISION	BY FM JC L.W.	DATE 5/9/13 5/9/13 5-9-13	APPROVED BY CITY ENGINEER
DESIGNED BY: DMC			DRAWN BY: DMC
CHECKED BY: EL			DATE: 5/8/2013

STREET MAINTENANCE
 2012/2013
 MINOR STREETS MAINTENANCE, PHASE 2
 PROJECT AREA 1
 HORIZ. SCALE: 1"=60' VERT. SCALE: N/A

DESIGN WORK ORDER NO.: 1303003
 CONSTR. WORK ORDER NO.: 1324991
 R-4247
 SHEET 2 OF 6
 FILE NAME: R4247-02.DWG

SIGN QUANTITIES - THIS SHEET

SIGN NUMBER	SIGN CODE	PANEL SIZE (IN)	INSTALL ROADSIDE SIGN(S)			INSTALL STREET NAME SIGN	RELOCATE ROADSIDE SIGN(S) OR SNS		REMOVE SIGN(S)
			NO POST	ONE POST	TWO POST		NO POST	ONE POST	
03-01	SNS	9"				1			
03-02	R1-1	30X30		1				1	
	SNS	-						1	
03-03	R1-1	30X30		1					
03-04	SNS	9"				1		1	
03-05	"THRU STREET"	-						1	
03-06	SNS	9"				1		1	
03-07	SNS	-						1	
03-08	SNS	9"				1(*)			
03-09	SNS	9"				1			
03-10	R1-1	30X30		1				1	
03-11	SNS	-						1	
03-12	SNS	9"				1			
03-13	R1-1	30X30		1				1	
03-14	SNS	-						1	
03-15	SNS	9"				1			
03-16	R1-1	30X30		1				1	
	SNS	-						1	
03-17	SNS	9"				1			
03-18	R1-1	30X30	1					1	
	SNS	-						1	
03-19	"THRU STREET"	-						1	
03-20	SNS	9"				1			
03-21	SNS	9"				1			
GRAND TOTAL:			1	5		10		15	

SEE CITY OF RIVERSIDE STD DWG NO. 664 FOR ROADSIDE SIGNS
 SEE CITY OF RIVERSIDE STD DWG NO. 662 FOR STREET NAME SIGNS
 SNS = STREET NAME SIGN
 * = MOUNT NEW SIGN ON EXISTING POST

PAVEMENT MARKING QUANTITIES - THIS SHEET

LOCATION	"STOP" LEGEND	12" WHITE LIMIT LINE
VERONA & TYLER	1	25 L.F.
VERONA & ASTORIA	1	25 L.F.
ASTORIA & FALLSVALE	-	-
FALLSVALE & SAN JOAQUIN	-	-
SAN JOAQUIN & HILLSBOROUGH	1	25 L.F.
HILLSBOROUGH & CREST	1	25 L.F.
HILLSBOROUGH & OLYMPIA	1	25 L.F.
OLYMPIA & JAMAICA	1	25 L.F.
OLYMPIA & OLYMPIA (EAST)	-	-
OLYMPIA & OLYMPIA (WEST)	-	-

- NOTE:
- ALL STRIPING SHALL BE THERMOPLASTIC AND CONFORM TO THE STATE OF CALIFORNIA "CALTRANS" 2010 STANDARD PLANS AND SPECIFICATIONS FOR PAVEMENT DELINEATION.
 - LIMIT LINES SHALL NEVER BE INSTALLED IN CROSS GUTTERS.
 - ALL CAT TRACKING SHALL BE APPROVED BY THE ENGINEER OR HIS REPRESENTATIVE BEFORE FINAL DELINEATION WILL BE INSTALLED.

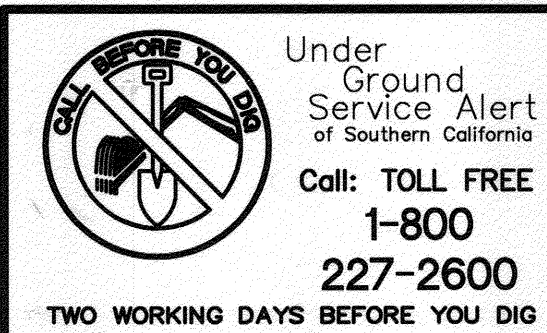
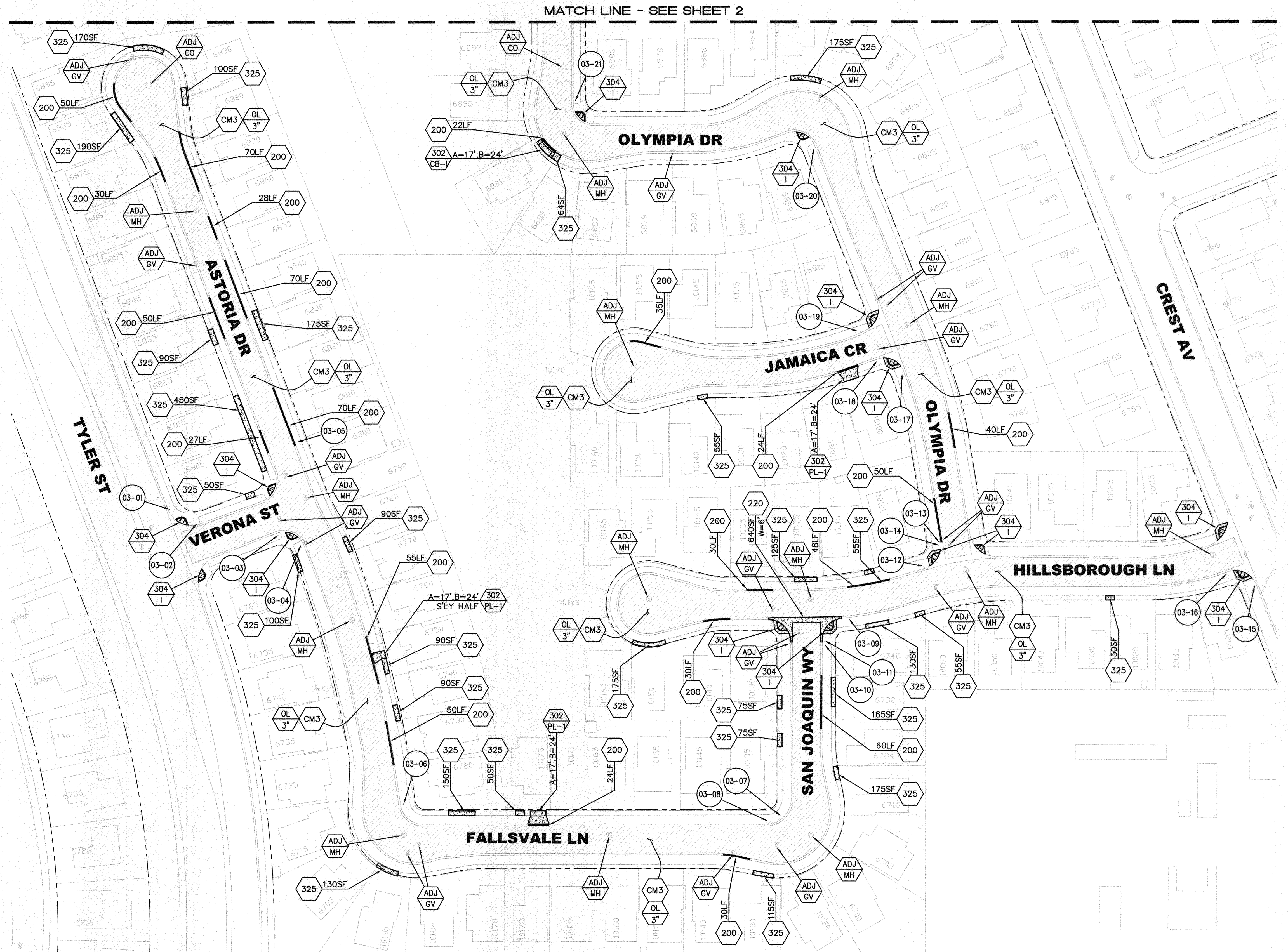
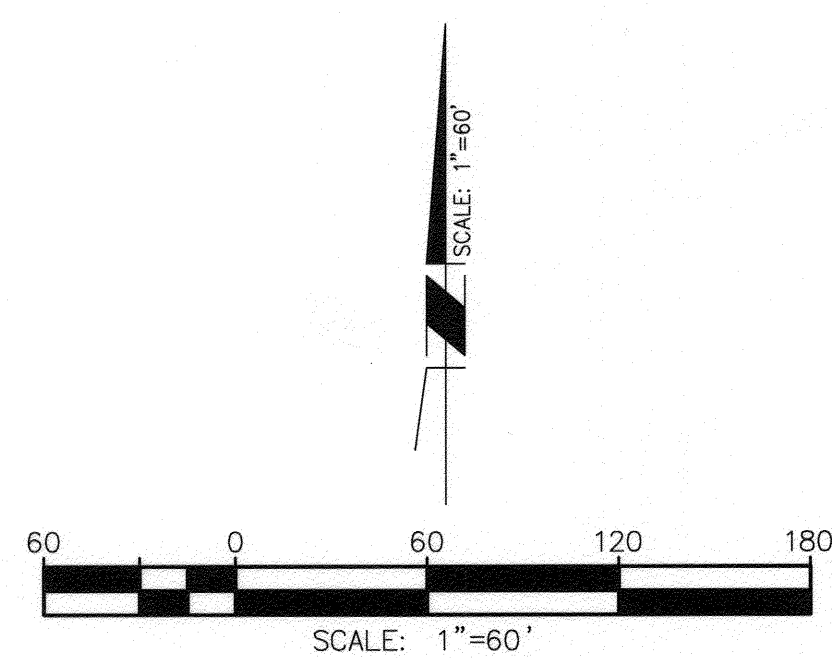

ENGINEER IN RESPONSIBLE CHARGE
 Edward Lara
 Edward Lara
 R.C.E. No. 63753 EXPIRES: 9-30-14
 DATE: May 9, 2013

MARK	REVISIONS	APPR.	DATE

CITY OF RIVERSIDE, CALIFORNIA
DEPARTMENT OF PUBLIC WORKS

APPROVED BY: *[Signature]* DATE: 5/9/13
 BY: *[Signature]* DATE: 5/9/13
 CONSTRUCTION ADMIN. DATE: 5-2-13
 TRAFFIC DIVISION
 STREETS

STREET MAINTENANCE
 2012/2013
MINOR STREETS MAINTENANCE, PHASE 2
 PROJECT AREA 1
 HORIZ. SCALE: 1"=60' VERT. SCALE: N/A

DESIGN WORK ORDER NO.: 1303003
 CONSTR. WORK ORDER NO.: 1324991
R-4247
 SHEET **3** OF **6**
 FILE NAME: R4247-03.DWG

SIGN QUANTITIES - THIS SHEET							
SIGN NUMBER	SIGN CODE	PANEL SIZE (IN)	INSTALL ROADSIDE SIGN(S)			RELOCATE ROADSIDE SIGN(S) OR SNS	REMOVE SIGN(S)
			NO POST	ONE POST	TWO POST		
04-01	SNS	-					1
04-01	"NEIGH WATCH"	-					1
04-02	SNS	9"				1	
GRAND TOTAL:						1	2

SEE CITY OF RIVERSIDE STD DWG NO. 664 FOR ROADSIDE SIGNS
 SEE CITY OF RIVERSIDE STD DWG NO. 662 FOR STREET NAME SIGNS
 SNS = STREET NAME SIGN

PAVEMENT MARKING QUANTITIES - THIS SHEET		
LOCATION	"STOP" LEGEND	12" WHITE LIMIT LINE
OLD RANCH & RUBIDOUX	1	25 L.F.
GLORIETTA & GRAND	1	25 L.F.

- NOTE:
1. ALL STRIPING SHALL BE THERMOPLASTIC AND CONFORM TO THE STATE OF CALIFORNIA "CALTRANS" 2010 STANDARD PLANS AND SPECIFICATIONS FOR PAVEMENT DELINEATION.
 2. LIMIT LINES SHALL NEVER BE INSTALLED IN CROSS GUTTERS.
 3. ALL CAT TRACKING SHALL BE APPROVED BY THE ENGINEER OR HIS REPRESENTATIVE BEFORE FINAL DELINEATION WILL BE INSTALLED.

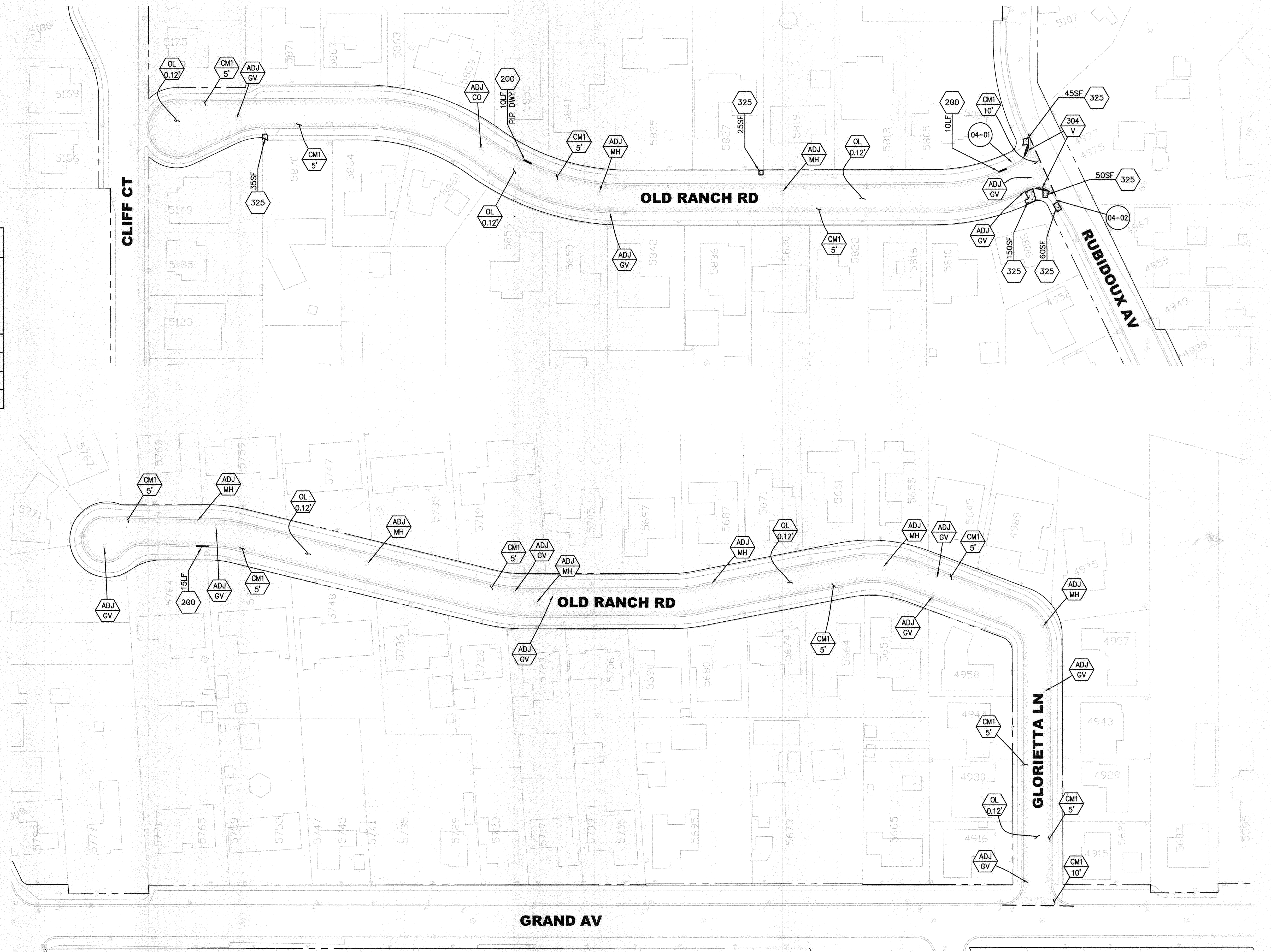

<p>Under Ground Service Alert of Southern California Call: TOLL FREE 1-800-227-2600 TWO WORKING DAYS BEFORE YOU DIG</p>	<p>ENGINEER IN RESPONSIBLE CHARGE Edward Lara R.C.E. No. 63753 EXPIRES: 9-30-14 DATE: May 9, 2013</p>	<p>CITY OF RIVERSIDE, CALIFORNIA DEPARTMENT OF PUBLIC WORKS</p>		<p>STREET MAINTENANCE 2012/2013 MINOR STREETS MAINTENANCE, PHASE 2 PROJECT AREA 2</p>		<p>DESIGN WORK ORDER NO.: 1303003 CONSTR. WORK ORDER NO.: 1324991 R-4247 SHEET 4 OF 6 FILE NAME: R4247-04.DWG</p>
		<p>APPROVED BY: <i>[Signature]</i> ENGINEERING MANAGER: 5/9/13 F.M. CONSTRUCTION ADMIN.: DC 5/9/13 TRAFFIC DIVISION: J.H. 5-9-13 DATE: 5/9/2013</p>	<p>APPROVED BY: <i>[Signature]</i> CITY ENGINEER</p>	<p>HORIZ. SCALE: 1"=60' VERT. SCALE: N/A</p>		

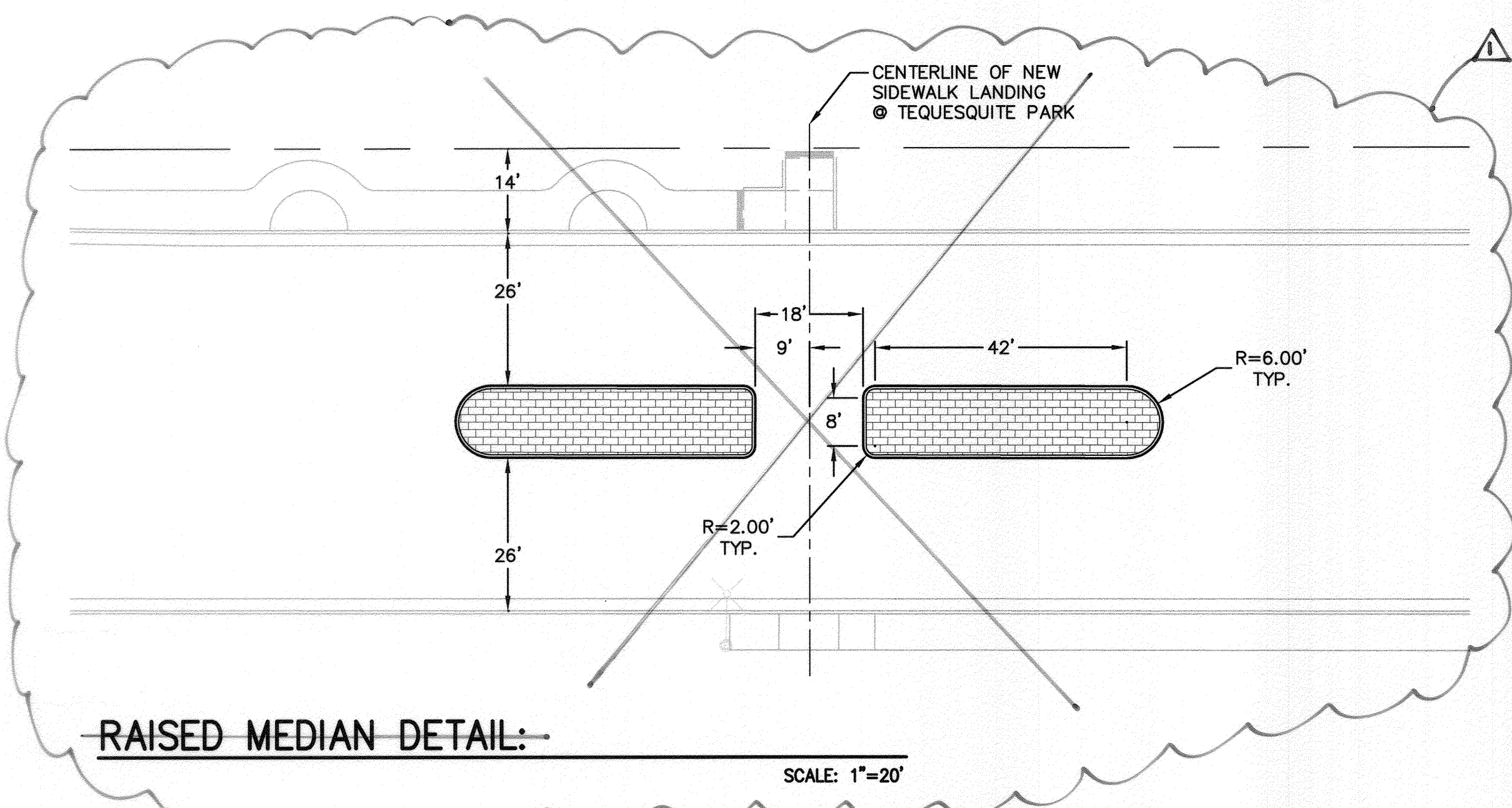

SIGN QUANTITIES - THIS SHEET

SIGN NUMBER	SIGN CODE	PANEL SIZE (IN)	INSTALL ROADSIDE SIGN(S)			INSTALL STREET NAME SIGN	RELOCATE ROADSIDE SIGN(S) OR SNS		REMOVE SIGN(S)
			NO POST	ONE POST	TWO POST		NO POST	ONE POST	
05-01	SNS	9"				1			
05-02	SNS	-						1	
	R1-1	-					1		
05-03	R1-1	-					1		
05-04	SNS	-						1	
05-05	SNS	9"				1			
05-06	SNS	-						1	
05-07	SNS	9"				1			
GRAND TOTAL:						3	2	3	

PAVEMENT MARKING QUANTITIES - THIS SHEET

LOCATION	"STOP" LEGEND	12" WHITE LIMIT LINE
ELMWOOD & PALM	2	40 L.F.
BEECHWOOD & PALM	1	30 L.F.

NOTE:
 1. ALL STRIPING SHALL BE THERMOPLASTIC AND CONFORM TO THE STATE OF CALIFORNIA "CALTRANS" 2010 STANDARD PLANS AND SPECIFICATIONS FOR PAVEMENT DELINEATION.
 2. LIMIT LINES SHALL NEVER BE INSTALLED IN CROSS GUTTERS.
 3. ALL CAT TRACKING SHALL BE APPROVED BY THE ENGINEER OR HIS REPRESENTATIVE BEFORE FINAL DELINEATION WILL BE INSTALLED.

SEE CITY OF RIVERSIDE STD DWG NO. 664 FOR ROADSIDE SIGNS
 SEE CITY OF RIVERSIDE STD DWG NO. 662 FOR STREET NAME SIGNS
 SNS = STREET NAME SIGN

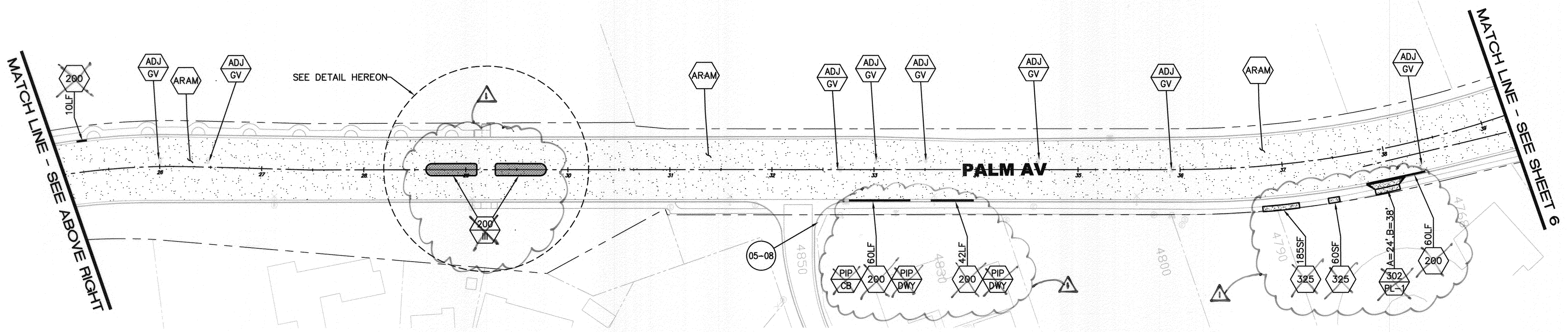
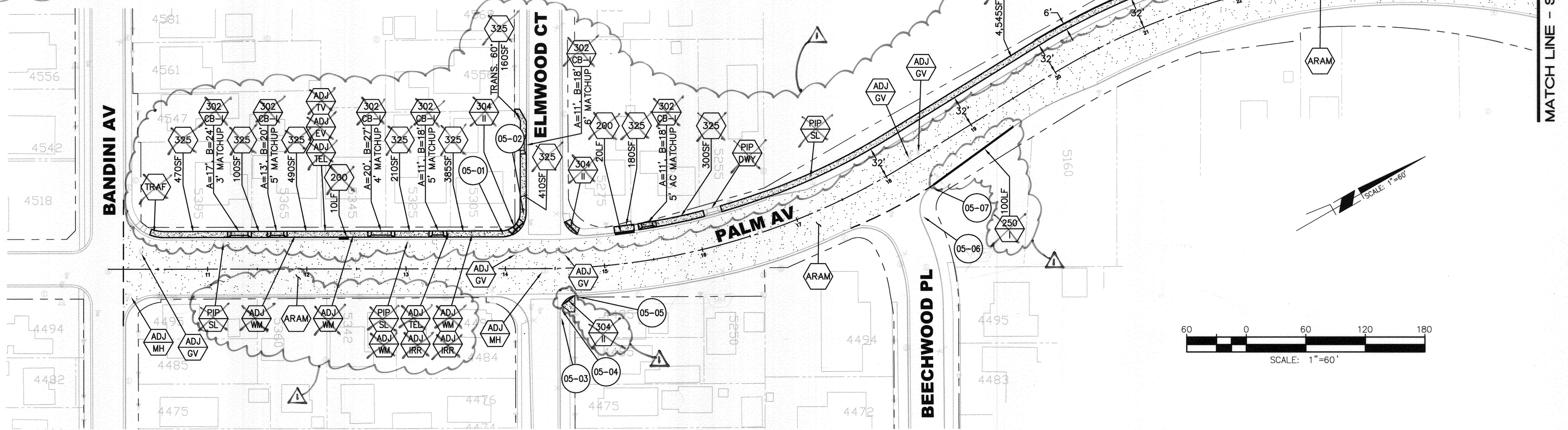

<p>Under Ground Service Alert of Southern California Call: TOLL FREE 1-800-227-2600 TWO WORKING DAYS BEFORE YOU DIG</p>	<p>ENGINEER IN RESPONSIBLE CHARGE Edward Lara R.C.E. No. 63753 EXPIRES: 9-30-14 DATE: May 9, 2013</p>	<p align="center">CITY OF RIVERSIDE, CALIFORNIA DEPARTMENT OF PUBLIC WORKS</p>		<p align="center">STREET MAINTENANCE</p>		<p align="center">DESIGN WORK ORDER NO: 1303003 CONSTR. WORK ORDER NO: 1324991</p>
		<p>AND TRAFFIC POLE MOD. MEDIAN ISLANDS, W/L RAMP DELETE S/W DWY, C&G</p>		<p>APPROVED BY: ENGINEERING MANAGER FM 5/9/13 CONSTRUCTION ADMIN. DC 5/9/13 TRAFFIC DIVISION SH 5-9-13</p>		
<p>DESIGNED BY: DMC DRAWN BY: DMC CHECKED BY: EL</p>		<p>APPROVED BY: CITY ENGINEER [Signature] DATE: 5/9/13</p>		<p align="center">R-4247</p> <p align="center">SHEET 5 OF 6</p> <p align="center">FILE NAME: R4247-05.DWG</p>		

MATCH LINE - SEE BELOW RIGHT

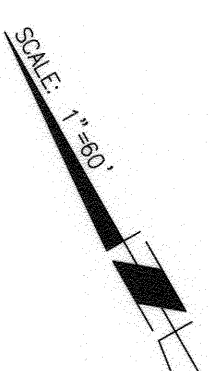
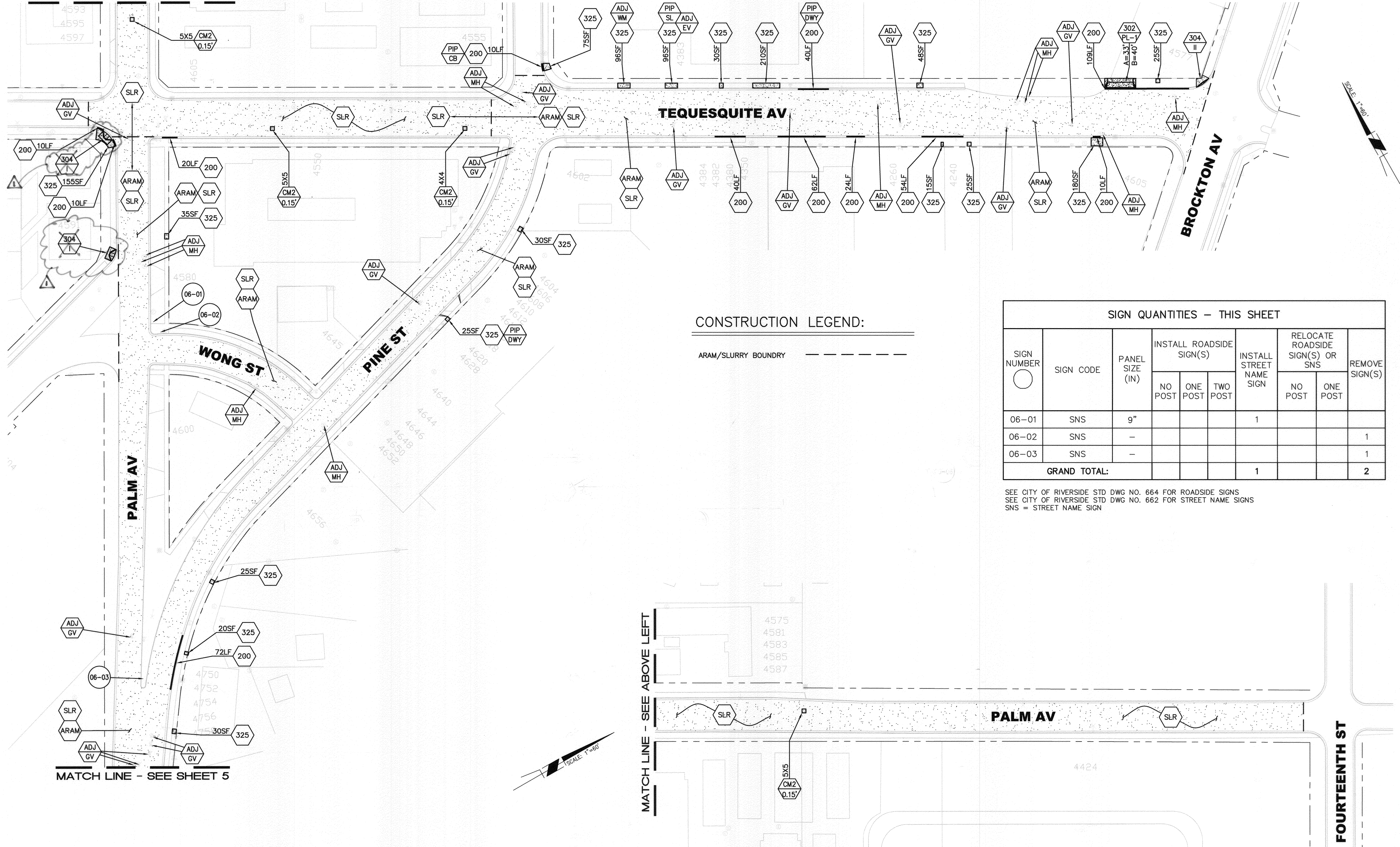

CONSTRUCTION LEGEND:

ARAM/SLURRY BOUNDRY - - - - -

SIGN QUANTITIES - THIS SHEET

SIGN NUMBER	SIGN CODE	PANEL SIZE (IN)	INSTALL ROADSIDE SIGN(S)			INSTALL STREET NAME SIGN	RELOCATE ROADSIDE SIGN(S) OR SNS		REMOVE SIGN(S)
			NO POST	ONE POST	TWO POST		NO POST	ONE POST	
06-01	SNS	9"				1			
06-02	SNS	-						1	
06-03	SNS	-						1	
GRAND TOTAL:						1		2	

SEE CITY OF RIVERSIDE STD DWG NO. 664 FOR ROADSIDE SIGNS
 SEE CITY OF RIVERSIDE STD DWG NO. 662 FOR STREET NAME SIGNS
 SNS = STREET NAME SIGN

MATCH LINE - SEE SHEET 5

MATCH LINE - SEE ABOVE LEFT

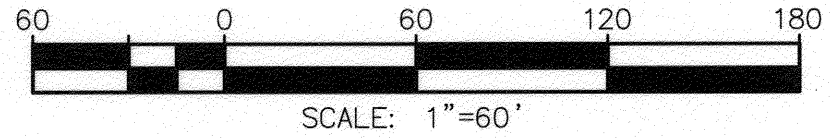

Under Ground Service Alert
 of Southern California
 Call: TOLL FREE
1-800-227-2600
 TWO WORKING DAYS BEFORE YOU DIG

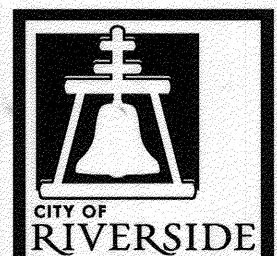

ENGINEER IN RESPONSIBLE CHARGE
Edward Lara
 Edward Lara
 R.C.E. No. 63753 EXPIRES: 9-30-14
 DATE: May 9, 2013

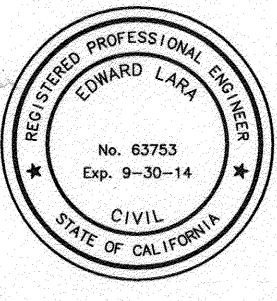

MARK: DELETE W.C. RAMPS APPR. DATE: FM 6/7/13
 DESIGNED BY: DMC DRAWN BY: DMC CHECKED BY: EL

CITY OF RIVERSIDE, CALIFORNIA
DEPARTMENT OF PUBLIC WORKS
 APPROVED BY: FM DATE: 5/9/13
 ENGINEERING MANAGER
 CONSTRUCTION ADMIN.: DC DATE: 5/9/13
 TRAFFIC DIVISION: A.H. DATE: 5-9-13
 STREETS: _____
 DATE: 5/9/2013

STREET MAINTENANCE
2012/2013
MINOR STREETS MAINTENANCE, PHASE 2
PROJECT AREA 3 AND 4
 HORIZ. SCALE: 1"=60' VERT. SCALE: N/A

DESIGN WORK ORDER NO.: 1303003
 CONSTR. WORK ORDER NO.: 1324991
R-4247
 SHEET **6** OF **6**
 FILE NAME: R4247-06.DWG