

NOTE: All distances shown on right curb are true curb line distances. Stations shown on the right curb are construction stations.

B.M. ELEV. 108956 S&T IN POLE #16936J 100' NLY OF INTERSECTION GLENHAVEN & BENEDICT.
 FB. V-1/5-8-66-67, 617/51-60, 657/50-51, R-74/75
 SCALE: HOR. 1" = 50'
 VERT. 1" = 10'

PROFILE	DATE
NO. 1	
BY	

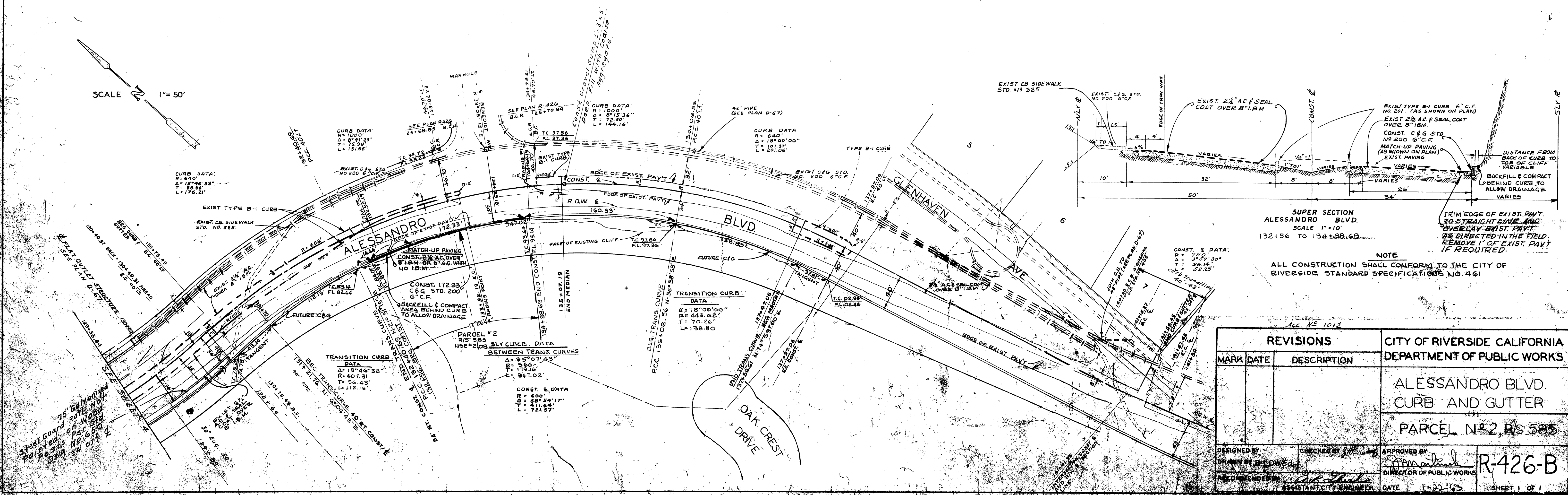

REVISIONS		CITY OF RIVERSIDE CALIFORNIA DEPARTMENT OF PUBLIC WORKS	
MARK	DATE	DESCRIPTION	
		ALESSANDRO BLVD. CURB AND GUTTER	
		PARCEL N#2, R/S 585	
DESIGNED BY	CHECKED BY	APPROVED BY	R-426-B
DRAWN BY		DIRECTOR OF PUBLIC WORKS	
RECOMMENDED BY	ASSISTANT CITY ENGINEER	DATE	1-23-63
			SHEET 1 OF 1

PLAN	DATE
NO. 1	
BY	

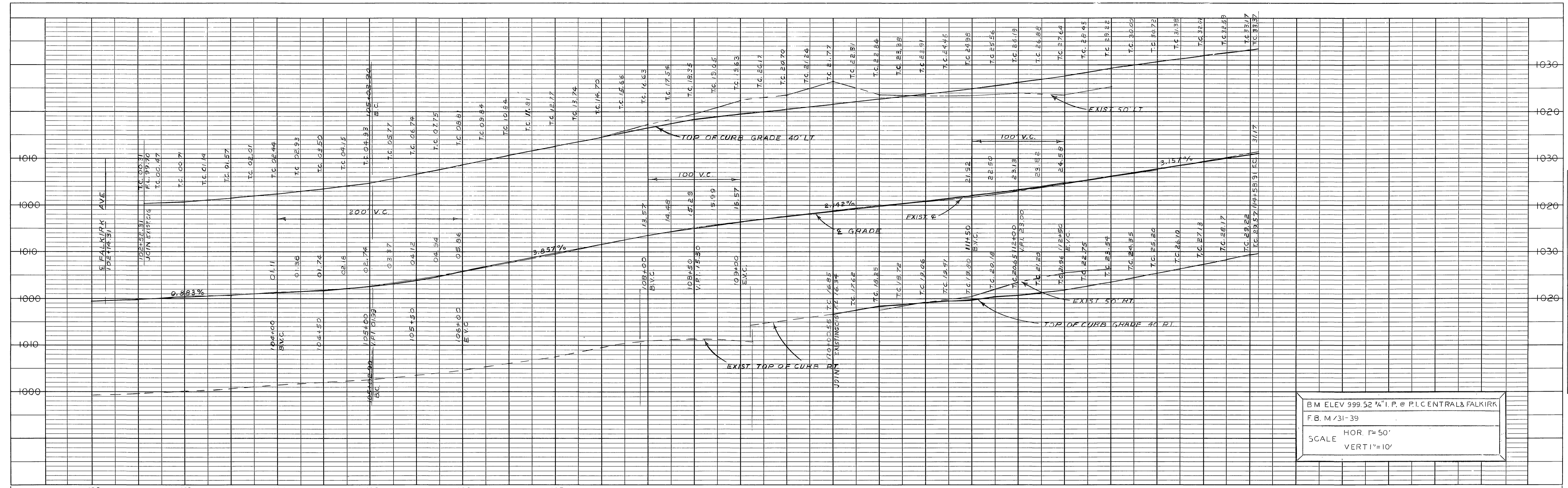

B.M. ELEV 999.52 1/4" I.P. @ P.I. CENTRAL & FALKIRK
 F.B. M/31-39
 SCALE HOR. 1"=50'
 VERT. 1"=10'

PROFILE	SURVEYED	BY	DATE
NOTE BOOK	GRADES CHECKED		
NO.	R.M.'S. NOTED		
	STRUCTURE NOTATIONS CHKD.		

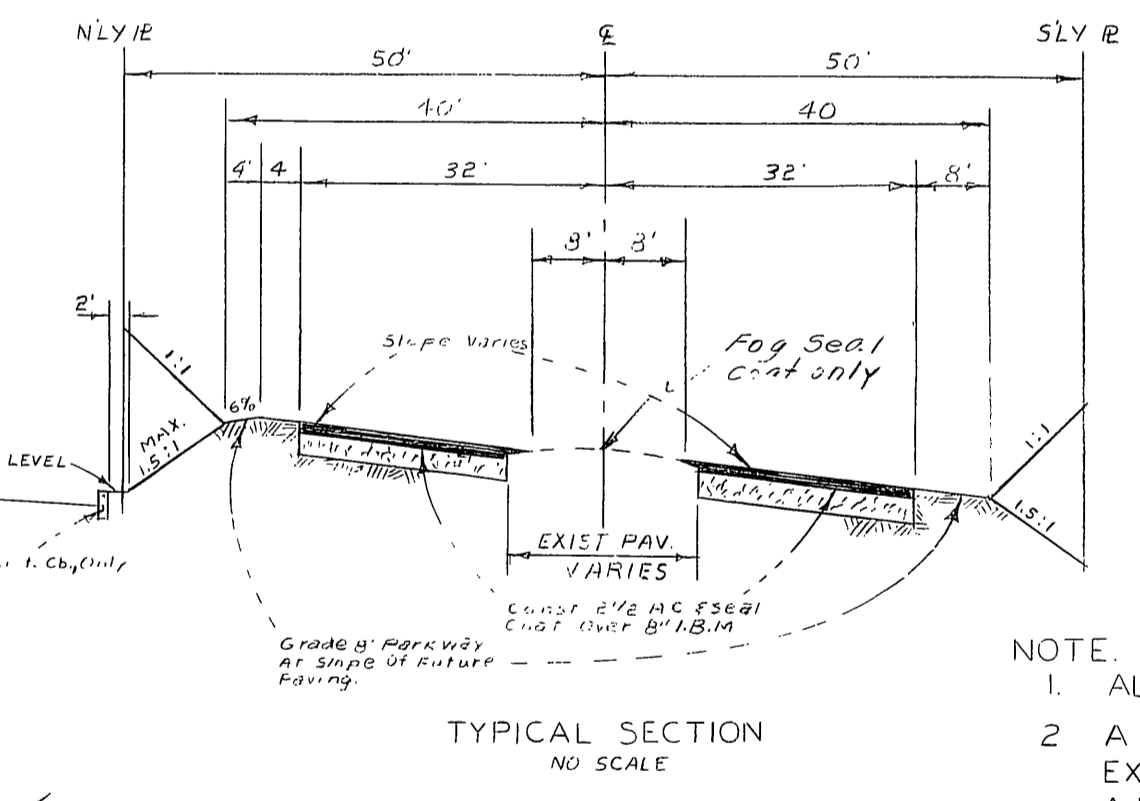
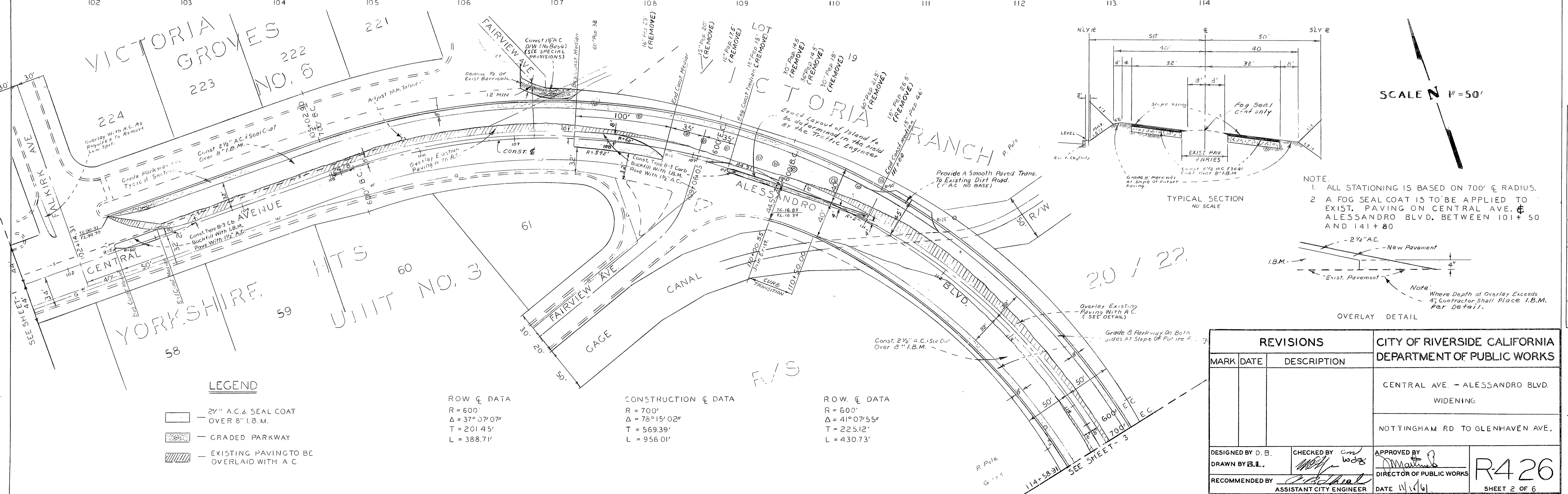

NOTE:
 1. ALL STATIONING IS BASED ON 700' @ RADIUS.
 2. A FOG SEAL COAT IS TO BE APPLIED TO EXIST. PAVING ON CENTRAL AVE. & ALESSANDRO BLVD. BETWEEN 101+50 AND 141+80

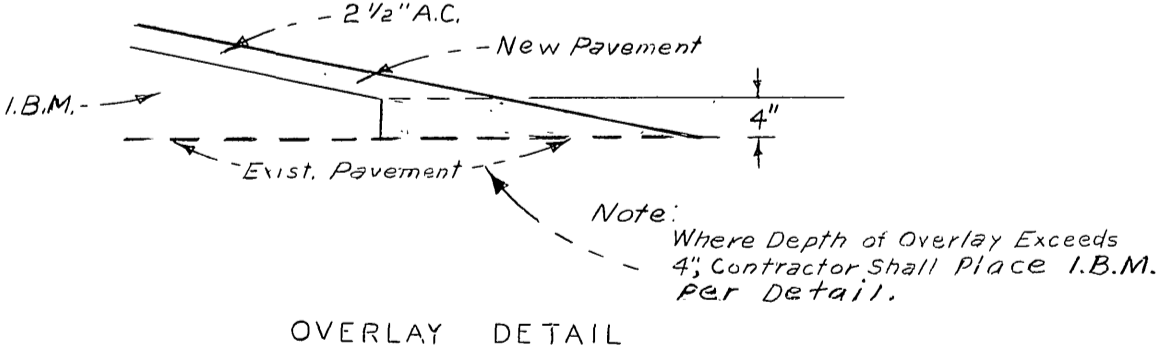

LEGEND

	2 1/2" A.C. & SEAL COAT OVER 8" I.B.M.
	GRADED PARKWAY
	EXISTING PAVING TO BE OVERLAID WITH A.C.

ROW & DATA

R = 600'
Δ = 37° 07' 07"
T = 201.45'
L = 388.71'

CONSTRUCTION & DATA

R = 700'
Δ = 78° 15' 02"
T = 569.39'
L = 956.01'

ROW & DATA

R = 600'
Δ = 41° 07' 55"
T = 225.12'
L = 430.73'

REVISIONS			CITY OF RIVERSIDE CALIFORNIA DEPARTMENT OF PUBLIC WORKS
MARK	DATE	DESCRIPTION	
			CENTRAL AVE. - ALESSANDRO BLVD. WIDENING
			NOTTINGHAM RD TO GLENHAVEN AVE.
DESIGNED BY D. B.	CHECKED BY <i>cm</i>	APPROVED BY <i>[Signature]</i>	R-426 SHEET 2 OF 6
DRAWN BY <i>[Signature]</i>	<i>[Signature]</i>	DIRECTOR OF PUBLIC WORKS	
RECOMMENDED BY <i>[Signature]</i>	ASSISTANT CITY ENGINEER	DATE 11/1/61	

PLAN	SURVEYED	BY	DATE
NOTE BOOK	ALIGNMENT CHECKED		
NO.	RT. OF WAY CHECKED		

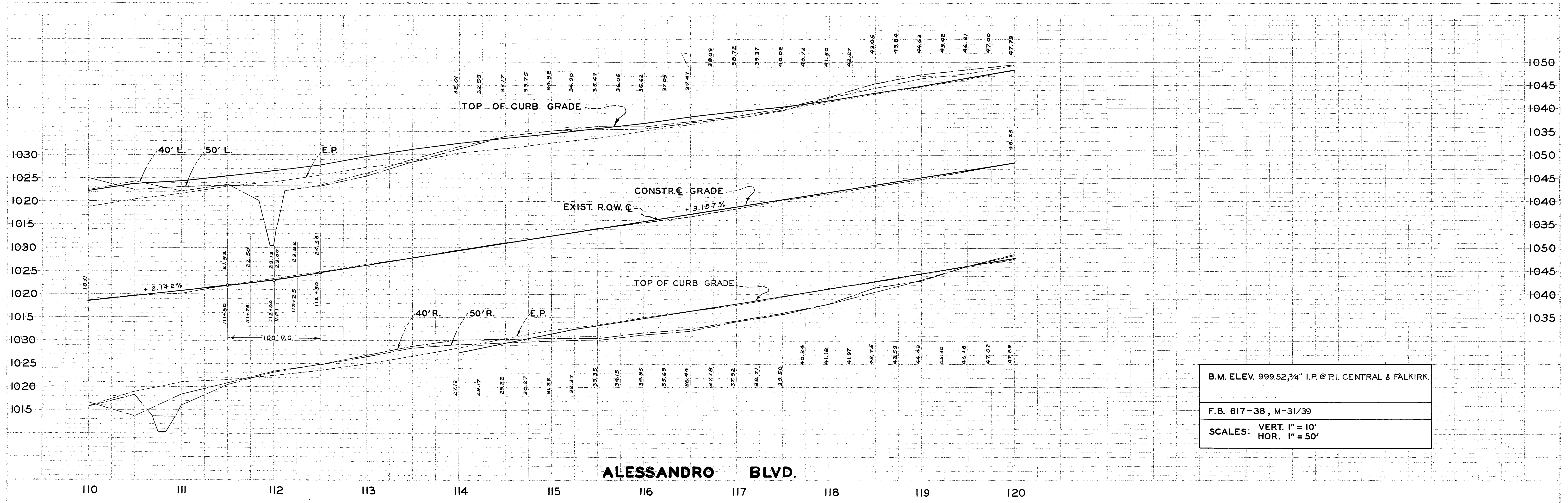

B.M. ELEV. 999.52, 3/4" I.P. @ P.I. CENTRAL & FALKIRK.
 F.B. 617-38, M-31/39
 SCALES: VERT. 1" = 10'
 HOR. 1" = 50'

ALESSANDRO BLVD.

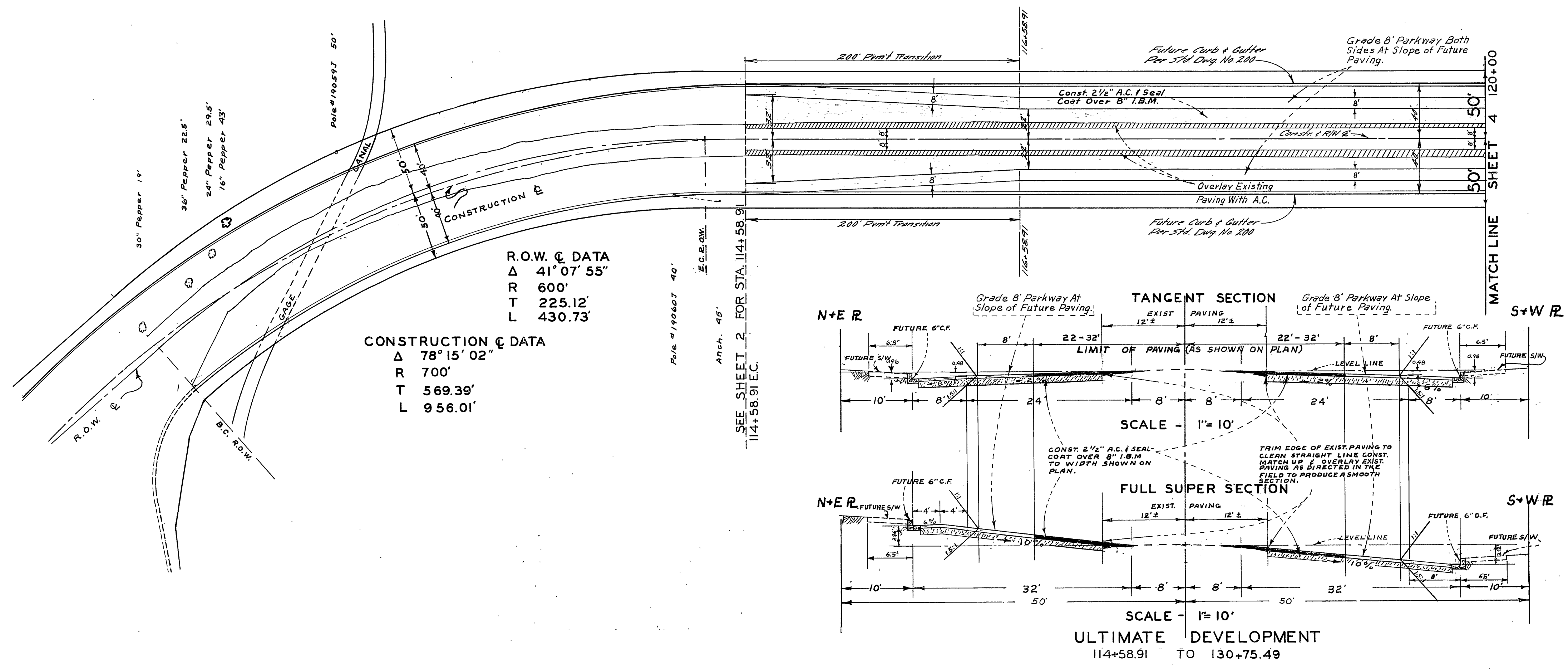

LEGEND

- EXISTING PAVING TO BE OVERLAID WITH A.C.
- 2 1/2" A.C. & SEAL COAT OVER 8" I.B.M.
- GRADED PARKWAY.
- REMOVE & REPLACE EXISTING PAVING.

SCALE 1" = 50'

REVISIONS		CITY OF RIVERSIDE CALIFORNIA	
MARK	DATE	DESCRIPTION	DEPARTMENT OF PUBLIC WORKS

CENTRAL AVE. - ALESSANDRO BLVD.
 WIDENING
 NOTTINGHAM RD. TO GLENHAVEN AVE.

DESIGNED BY: W.D.G.V.H. CHECKED BY: W.D.G.V.H. DRAWN BY: B.L. APPROVED BY: [Signature] DATE: 11/15/61

R-426

INDEXED 1960

1060
1055
1050
1045
1060
1055
1050
1045
1060
1055
1050
1045

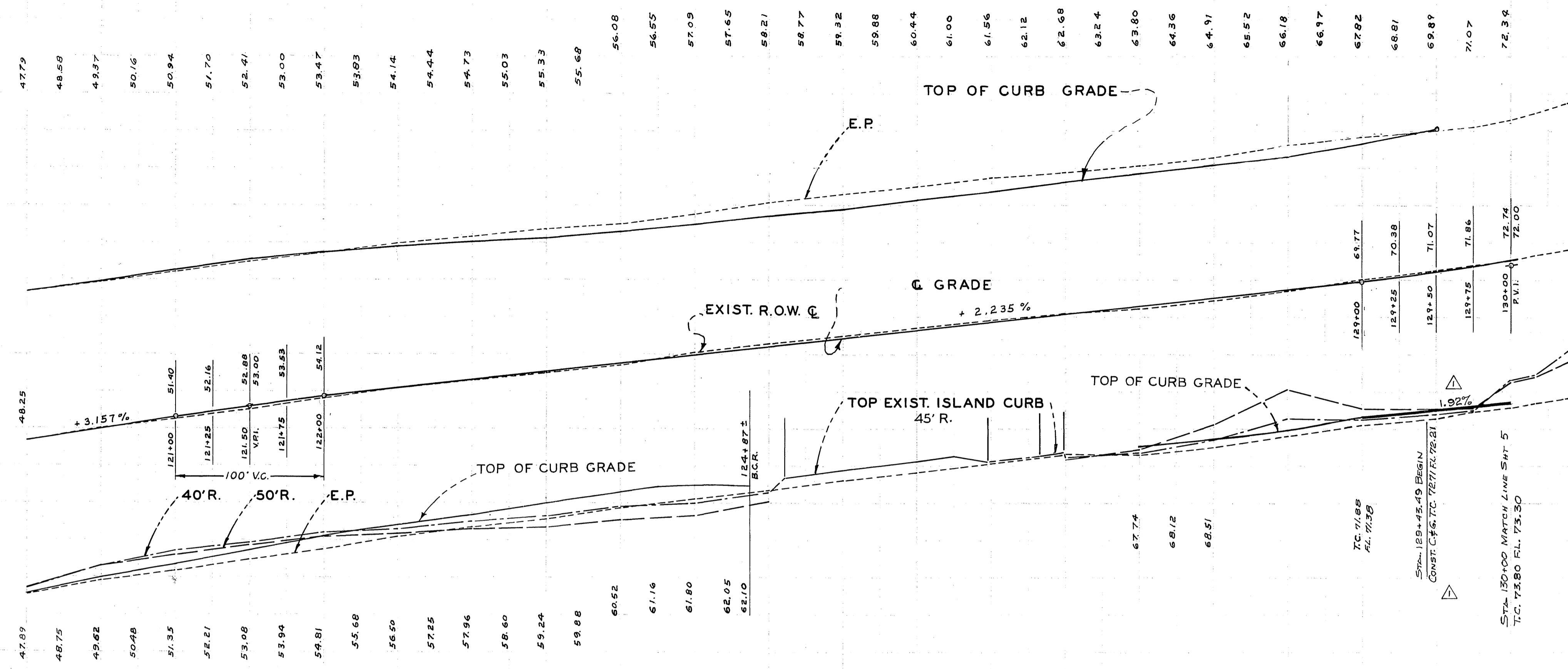

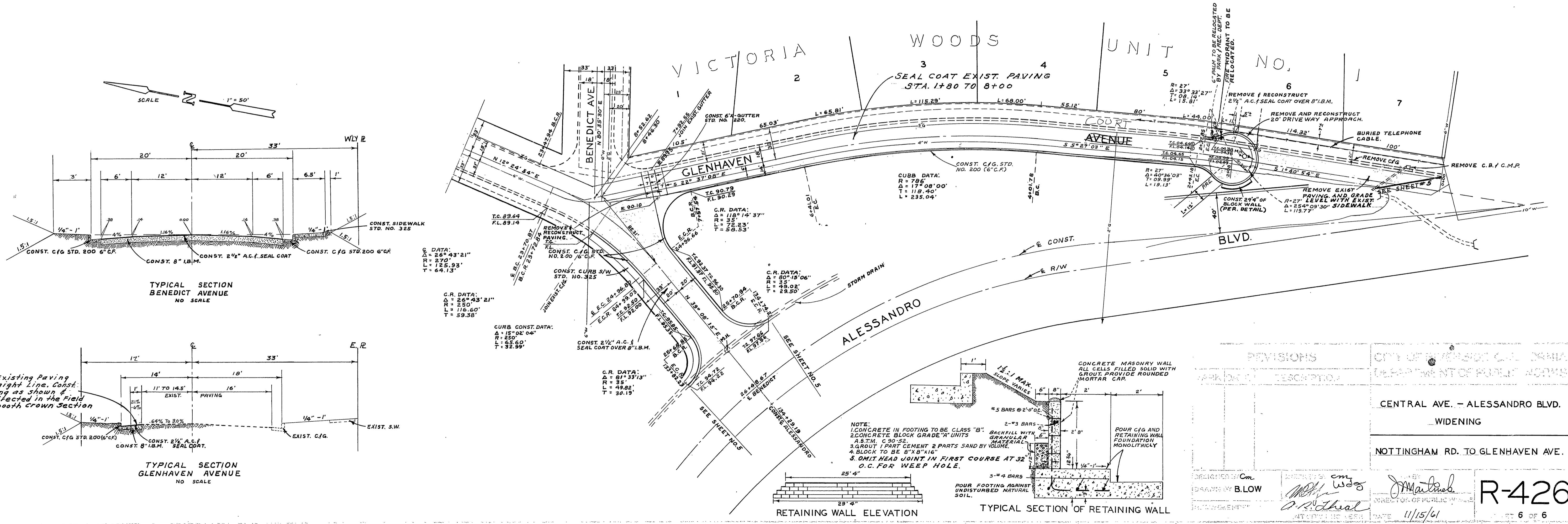
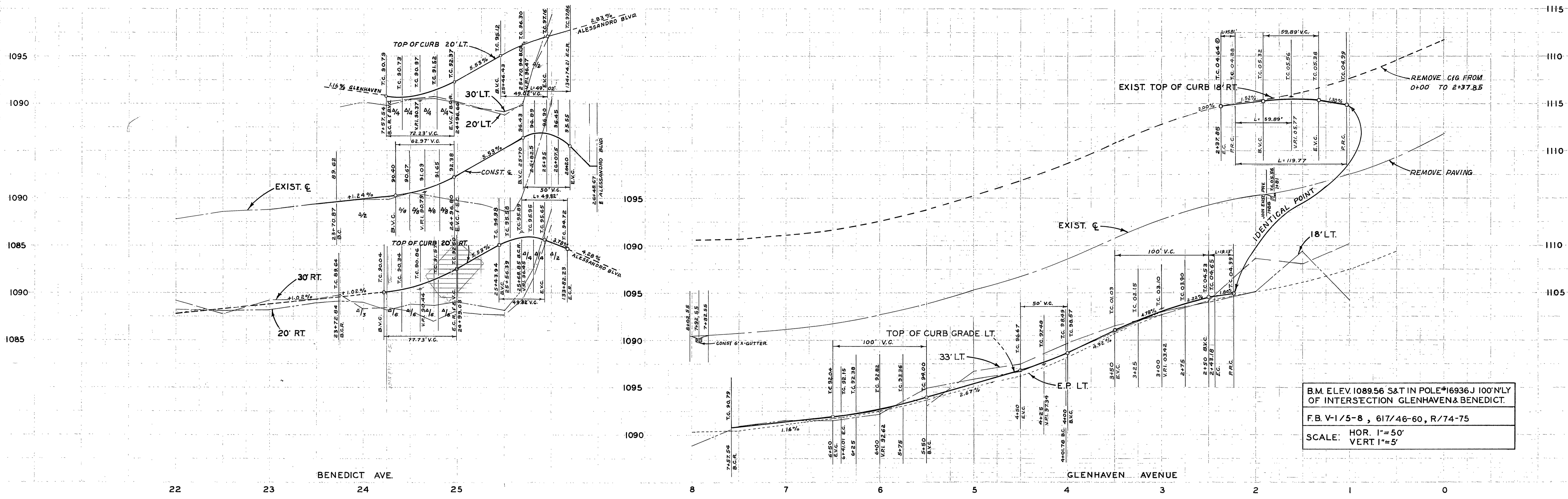

PROVISIONS

CITY OF WASHINGTON, D.C. ENGINEER

DEPARTMENT OF PUBLIC WORKS

CENTRAL AVE. - ALESSANDRO BLVD.

WIDENING

NOTTINGHAM RD. TO GLENHAVEN AVE.

DESIGNED BY: Cm

DRAWN BY: B.LOW

DATE: 11/15/61

R-426

INDEXED 1965