

GENERAL CONSTRUCTION NOTES:

- 1 THE CONTRACTOR SHALL PROVIDE AND MAINTAIN TRAFFIC AS INDICATED IN THE ASSOCIATED PROJECT SPECIAL PROVISIONS.
- 2 CONSTRUCTION SHALL BE IN ACCORDANCE WITH THE CITY OF RIVERSIDE STANDARD DRAWINGS AND STANDARD SPECIFICATIONS FOR PUBLIC WORKS CONSTRUCTION, 2012 EDITION.
- 3 EXISTING UTILITIES SHOWN ON THIS PLAN ARE PLOTTED FROM UTILITY RECORDS. THE CONTRACTOR IS REQUIRED TO TAKE DUE PRECAUTIONARY MEASURES TO LOCATE AND PROTECT ALL UTILITIES WHETHER OR NOT SHOWN ON THIS PLAN.
- 4 CONFLICTING UTILITIES SHOWN WITHIN CONSTRUCTION AREA WILL BE RELOCATED PRIOR TO CONSTRUCTION.
- 5 ALL STREET PULL BOXES, GATE VALVES, MANHOLES, ETC, AFFECTED BY CONSTRUCTION, SHALL BE ADJUSTED TO THE PROPOSED GRADE.
- 6 PRIME CONTRACTOR BIDDING THIS WORK SHALL HAVE A CLASS "A" OR "C-12".
- 7 THE SEAM BETWEEN PASSES OF THE AC OVERLAY SHALL COINCIDE, AS CLOSE AS POSSIBLE, TO THE LANE LINES.
- 8 COLD MILLING SHALL BE AS DESCRIBED ON THE PLANS AND SPECIAL PROVISIONS OR AS DIRECTED BY THE ENGINEER.
- 9 ANY DISTRESSED EXISTING PAVEMENT SHALL BE REMOVED AND REPLACED AS DIRECTED BY THE ENGINEERING AFTER COLD-MILLING AND PRIOR TO PLACEMENT OF DGAC.
- 10 CONTRACTOR SHALL REMOVE ALL VEGETATION WITHIN ALL SIDEWALK PANELS WITHIN THE PROJECT LIMITS.
- 11 ALL EXISTING IMPROVEMENTS INCLUDING, BUT NOT LIMITED TO, CURB, GUTTERS, CROSS GUTTERS, SIDEWALK, DRIVEWAYS, PARKWAY CULVERTS, INLETS, ETC, SHALL BE PROTECTED IN PLACE UNLESS OTHERWISE NOTED.
- 12 EXISTING IRRIGATION SHALL BE PROTECTED OR MODIFIED, INCLUDING FURNISHING NEW MATERIALS, AS NECESSARY TO CONSTRUCT NEW CONCRETE IMPROVEMENTS.
- 13 ALL FENCE POSTS SHALL BE PROTECTED OR MODIFIED AS NECESSARY IF POST FOUNDATION IS WITHIN A SIDEWALK PANEL THAT HAS BEEN CALLED OUT FOR REPLACEMENT.
- 14 FOR ALLEY WAY DRIVEWAY APPROACHES, CONTRACTOR SHALL CONSTRUCT AC PAVEMENT OVERLAY BEHIND DRIVEWAYS TO PROVIDE ADEQUATE FLOW LINES.
- 15 ADEQUATE FLOW LINES SHALL BE MAINTAINED AT ALL LOCATIONS.

CONSTRUCTION NOTES:

- REMOVE AND REPLACE IN KIND EXISTING FACILITY. NUMBERS ABOVE 100 IN A HEXAGON ON THE PLAN REFER TO THE RESPECTIVE STANDARD DRAWING AND SHALL BE CONSTRUCTED ACCORDINGLY. ANY NOTE SHOWN BELOW THE STANDARD DRAWING NUMBER INDICATES THE SPECIFIC TYPE, ACTION, OR MODIFICATION TO BE CONSTRUCTED. DIMENSIONS OF NEW FACILITY SHALL BE MODIFIED AS NECESSARY, EXCLUDING ADA REQUIREMENTS, TO MATCH EXISTING FACILITY REMOVED.
- ADJUST TO GRADE, DESCRIPTION PER PLAN: (MH) MANHOLE. (GV) GATE VALVE. (WM) WATER METER. (PB) PULLBOX. (ETS) ELECTRICAL TESTING STATION. (CO) CLEAN OUT.
- PROTECT IN PLACE, DESCRIPTION PER PLAN: (MH) MANHOLE. (GV) GATE VALVE. (WM) WATER METER. (PB) PULLBOX. (SL) STREET LIGHT. (MB) MAILBOX. (PP) POWER POLE. (CB) CATCH BASIN. (GUT) CROSS GUTTER & SPANDREL UNLESS OTHERWISE NOTED. (SPN) SPANDREL. (BRM) AC BERM.
- REMOVE, FILL AND GRADE TO CONSTRUCT NEW IMPROVEMENTS INDICATED. DESCRIPTION PER PLAN: (RMP) WHEELCHAIR RAMP.
- REMOVE AND REPLACE, DESCRIPTION PER PLAN: (SLC) STREET LIGHT CAP.
- 0.12" MIN. DEPTH LINEAR COLD MILL OF EXISTING AC PAVEMENT. AT LOCATIONS SPECIFIED TO RECEIVE ARAM, PROVIDE VARIABLE DEPTH COLDMILLING TO TRANSITION FROM 0.15" AT GUTTER LIP/JUNCTION TO 0" DEPTH AT THE MILL WIDTH INDICATED. (XX) = WIDTH OF LINEAR COLD MILL AS INDICATED ON PLANS.
- VARIABLE AREA COLD MILL OF EXISTING AC PAVEMENT. (XX) = DEPTH OF VARIABLE AREA COLD MILL AS INDICATED ON PLANS.
- FULL-DEPTH COLD MILL OF AC PAVEMENT (EXISTING DEPTH VARIES 2.5" TO 5.5") TO EXISTING BASE OR SUBGRADE AND REPLACE WITH NEW DGAC PAVEMENT. REPLACEMENT DEPTH TO MATCH EXISTING AC THICKNESS (3" MINIMUM SHALL BE INSTALLED). CONTRACTOR TO REMOVE EXISTING BASE/SUBGRADE AS NECESSARY TO CONSTRUCT 3" DGAC.
- CONSTRUCT ASPHALT RUBBER AND AGGREGATE MEMBRANE AFTER COLD MILLING AND BEFORE OVERLAYING WITH 0.12" DGAC
- OVERLAY DGAC PAVEMENT. REPLACEMENT DEPTH SHALL MATCH AC THICKNESS TO BE REMOVED UNLESS OTHERWISE NOTED. 0.12 MIN. OR AS INDICATED ON THE PLAN.
- CONSTRUCT DRIVEWAY PER CITY STD 302 WITH THE FOLLOWING MODIFICATION (XX): (P-I) = TYPE PROPERTY LINE-I. (C-I) = TYPE CURB-I. (M1) = REPLACE IN KIND.
- CONSTRUCT WHEELCHAIR RAMP PER CITY STD 304 WITH THE FOLLOWING TYPE: (I) = TYPE I. (II) = TYPE II. (II-A) = TYPE II-A. (IV) = TYPE IV. (VII) = TYPE VII.
- CONSTRUCT SIDEWALK PER CITY STD 325 WITH THE FOLLOWING MODIFICATION (XX): (M1) = CONSTRUCT PROPERTY LINE SIDEWALK WITH THICKNESS OF 6". (M2) = CONSTRUCT AND GRADE/DEPRESS SIDEWALK TO MATCH THE ELEVATION OF EXISTING ALLEY WAY AND DRIVEWAY APPROACH BETWEEN 3751 PINE ST AND 4406 MISSION INN AV. ADD RETAINING CURB IF NECESSARY.
- CONTRACTOR SHALL TRIM OR REMOVE EXISTING VEGETATION/SHRUB/PLANT WHICH IS ENCRDACHING INTO SIDEWALK AREA. CONTRACTOR SHALL NOT COMPLETE ANY REMOVALS ON PRIVATE PROPERTY.
- CONTRACTOR SHALL SAWCUT TOP OF THE EXISTING DAMAGED INLET, DOWEL AND EPOXY INTO THE EXISTING REMAINING INLET WALLS AND RECONSTRUCT TOP PER CITY STD 406 MODIFIED AS NECESSARY TO MATCH EXISTING IN KIND.
- CONTRACTOR SHALL GRIND TEMPORARY AC MATCH UP BEFORE CONSTRUCTING ANY IMPROVEMENTS INDICATED ON THE PLANS
- CONSTRUCT 2"x4" REDWOOD HEADER ADJACENT TO AC R&R AREAS THAT OCCUR AT THE EDGE OF PAVEMENT.
- FURNISH, INSTALL, RELOCATE, AND/OR REMOVE SIGN AND POST PER THE SIGN QUANTITIES TABLE. X = SHEET NUMBER. Y = LOCATION NUMBER.

EXISTING TOPOGRAPHY:

- SANITARY SEWER M.H.
- STORM DRAIN M.H.
- ELECTRIC M.H.
- WATER M.H.
- GATE VALVE
- ELECTRICAL TEST STATION (GAS)
- FIRE HYDRANT

RIVERSIDE CALIFORNIA

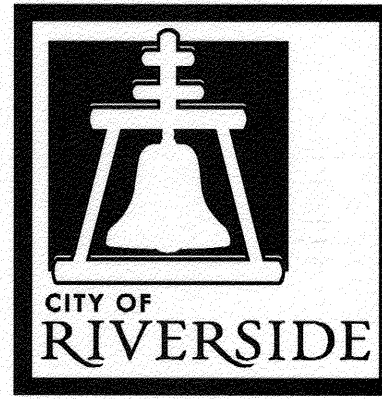

**PUBLIC WORKS DEPARTMENT
2013/2014 MINOR STREETS
MAINTENANCE, PHASE 1**

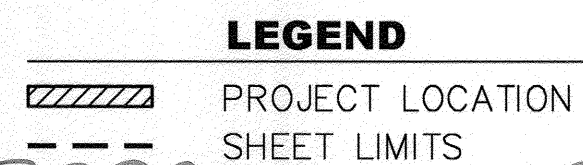
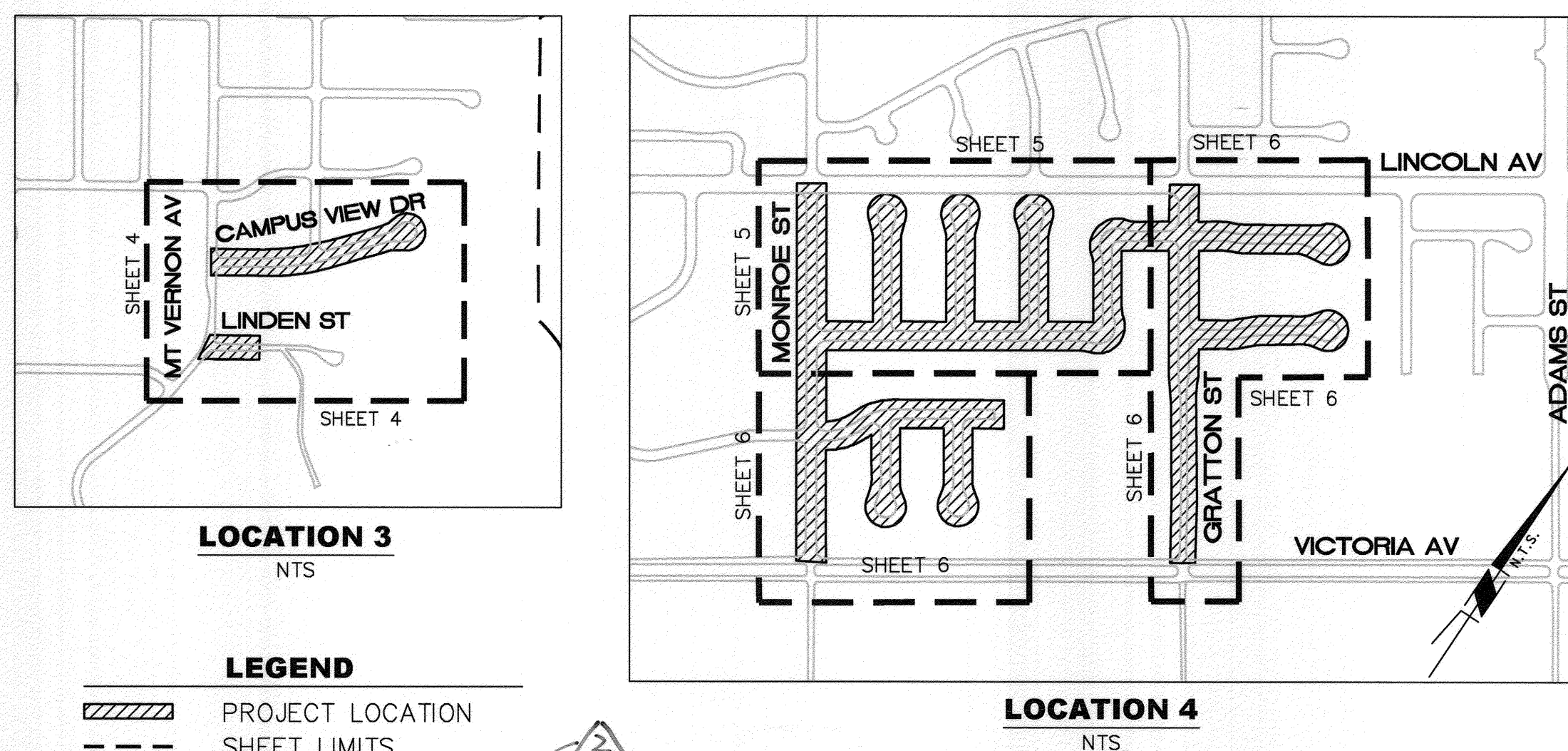
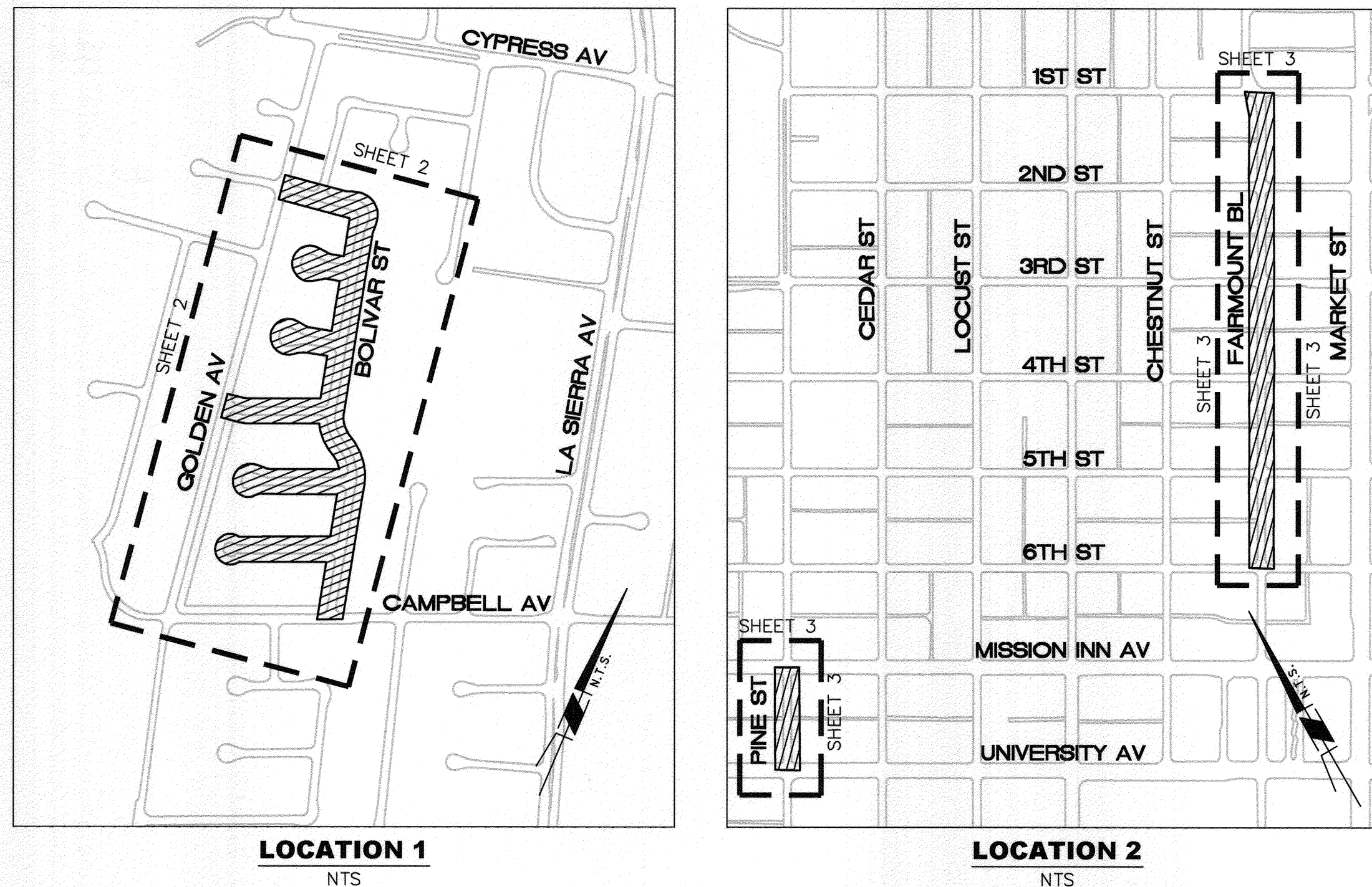

LOCATION 6
6141 JONES AVENUE, RIVERSIDE, CA 92505.
THE IMPROVEMENTS AT THIS LOCATION
WILL BE CONSTRUCTED PER ADDENDUM NO. 2.

LOCATION 5
"WESTERLY SIDE OF SHELBY DRIVE FROM CALIFORNIA
AVENUE TO 135 FT NORTHERLY OF CALIFORNIA AVENUE."
IMPROVEMENTS GENERALLY INCLUDE NEW CONCRETE SIDEWALK,
DRIVEWAY, AND WALKWAY AND RECONSTRUCTION OF THE
EXISTING CURB AND GUTTER DRIVEWAY DEPRESSION.

SIGNING AND STRIPING GENERAL NOTES:

1. SIGNING AND STRIPING INSTALLATIONS SHALL CONFORM TO THE CALIFORNIA MANUAL ON UNIFORM TRAFFIC CONTROL DEVICES (CA MUTCD), THE STATE OF CALIFORNIA DEPARTMENT OF TRANSPORTATION (CALTRANS) STANDARD PLANS AND SPECIFICATIONS DATED 2010, AND ALL ADDENDUMS THERETO, AND THE CITY OF RIVERSIDE PUBLIC WORKS DEPARTMENT STANDARD DRAWINGS, CURRENT EDITION.
2. ALL STRIPING, MARKINGS, AND LEGENDS SHALL BE REFLECTORIZED THERMOPLASTIC UNLESS OTHERWISE NOTED. THE CONTRACTOR SHALL PROVIDE AND INSTALL RAISED PAVEMENT MARKERS FOR ALL STRIPING. STRIPING, MARKINGS AND LEGENDS SHALL CONFORM TO THE 2010 CALTRANS STANDARD PLANS A20A THRU A20D AND A24A THRU A24E.
3. PRIOR TO FINAL ACCEPTANCE OF STREET IMPROVEMENTS, ALL PAVEMENT STRIPING AND STENCILING WITHIN THE PERIMETER OF THE CONSTRUCTION AREA SHALL BE RESTORED TO LIKE NEW CONDITION, IN A MANNER MEETING THE APPROVAL OF THE CITY OF RIVERSIDE.
4. THE CONTRACTOR SHALL RE-STRIP EXISTING STRIPING AND CURB MARKINGS OBLITERATED BY NEW CONSTRUCTION, WHETHER OR NOT SHOWN ON THE PLANS FOR REPLACEMENT, AT NO COST TO THE CITY.
5. AT LOCATIONS WHERE EXISTING PAINTED CURB IS TO BE RECONSTRUCTED, THE CONTRACTOR SHALL PAINT THE NEW CURB AS SHOWN ON THE PLANS WITHIN 10 WORKING DAYS OF CURB CONSTRUCTION OR AS DIRECTED BY ENGINEER. THE PAINT SHALL BE WATER-BASED WITH 2-YEAR GUARANTEE AGAINST COLOR FADING. PRIOR TO THE START OF CONSTRUCTION, THE CONTRACTOR SHALL SUBMIT TO THE CITY WRITTEN PROOF OF THE MANUFACTURER'S 2-YEAR GUARANTEE.
6. ALL NEW STRIPING SHALL BE "CAT TRACKED" AND APPROVED BY THE ENGINEER PRIOR TO FINAL INSTALLATION. THE CONTRACTOR SHALL NOTIFY THE ENGINEER AFTER COMPLETING LAYOUT AND AT LEAST 3 WORKING DAYS BEFORE COMMENCING INSTALLATION OF STRIPING, MARKINGS AND MARKERS.
7. TRAFFIC SIGN FACE SHALL BE 3M DIAMOND GRADE DG3 REFLECTIVE SHEETING (ASTM XI) OR APPROVED EQUAL WITH PROTECTIVE GRAFFITI OVERLAY FILM OR AS OTHERWISE NOTED.
8. ALL WARNING SIGNS SHALL HAVE A FLUORESCENT YELLOW BACKGROUND AND SCHOOL SIGNS NOTED SHALL HAVE A FLUORESCENT YELLOW-GREEN BACKGROUND.
9. SIGNS SHALL BE STANDARD SIZE UNLESS NOTED OTHERWISE. PRIOR TO INSTALLATION, NEW SIGNS SHALL BE APPROVED BY THE CITY OF RIVERSIDE. EXACT LOCATIONS OF SIGNS SHALL BE DETERMINED BY THE CITY ENGINEER.
10. SALVAGED SIGNS AND SIGN POSTS SHALL BE DELIVERED TO THE CITY OF RIVERSIDE SIGN DEPARTMENT.
11. STRIPING SHALL BE APPLIED WITHIN 48 HOURS OF SURFACE COURSE REPLACEMENT ON STREETS OPEN TO THE PUBLIC. IN NO CASE SHALL A NEWLY PAVED STREET OPEN TO THE PUBLIC BE LEFT UNSTRIPED OVER A WEEKEND OR HOLIDAY.
12. CONTRACTOR SHALL INSTALL NEW SIGN(S) AND/OR POST(S) PER CITY OF RIVERSIDE STANDARD DRAWING No. 664, SEE SPECIFICATIONS.
13. CONTRACTOR SHALL INSTALL NEW STREET NAME SIGNS AND POST PER CITY OF RIVERSIDE STANDARD DRAWING No. 662, SEE SPECIFICATIONS.
14. ALL CONFLICTING STRIPING, PAVEMENT MARKINGS, LEGENDS, AND RAISED PAVEMENT MARKERS SHALL BE REMOVED EVEN IF NOT SHOWN ON PLANS. REMOVALS OF PAINTED STRIPING, PAVEMENT MARKINGS AND LEGENDS SHALL BE DONE BY WET SANDBLASTING. REMOVALS OF THERMOPLASTIC STRIPING, PAVEMENT MARKINGS AND LEGENDS SHALL BE REMOVED BY WET SANDBLASTING, GRINDING OR OTHER APPROVED METHOD AND SHALL NOT DAMAGE THE PAVEMENT. "BLACK OUT" OF EXISTING DELINEATION IS NOT PERMITTED. ALL DAMAGED PAVEMENT DUE TO REMOVALS SHALL BE REPAIRED AS NECESSARY TO MAINTAIN A SMOOTH AND UNIFORM SURFACE OR AS DIRECTED BY THE ENGINEER. ALL STRIPING REMOVALS AND LEGENDS SHALL BE "FOG SEALED".
15. WHERE APPLICABLE, OUTBOUND LANE LINE DETAILS SHALL COMMENCE AT THE CROSSWALK, MEANING THE PAINTED PORTION OF THE DETAIL SHALL JOIN THE CROSSWALK.

SHEET INDEX: STREET IMPROVEMENTS (R-4262)

SHEET NO.	DESCRIPTION
1.	TITLE SHEET AND NOTES
2.	LOCATION 1 (ANAHEIM ST, BOLIVAR ST, PECAN PL, KIPLING CT, DOHENY DR, BLEEKER CT, AND REDDIFORD CT)
3.	LOCATION 2 (FAIRMOUNT BL, PINE ST)
4.	LOCATION 3 (CAMPUS VIEW DR, LINDEN ST)
5.	LOCATION 4 (MONROE ST, TURLOCK DR, DONOVAN CT, FENWICK PL, SULKY CT, AND SHALIMAR PL)
6.	LOCATION 4 (MONROE ST, TROPICANA DR, LEATHERWOOD CT, SPICEWOOD LN, GRATTON ST, SHALIMAR PL, AND WILLIAMSBURG PL)
7.	SIGN AND STRIPING QUANTITIES (ALL LOCATIONS EXCEPT FAIRMOUNT BL)

SHEET INDEX: SIGN AND STRIPING PLANS (XL-612)

SHEET NO.	DESCRIPTION
1.	SIGN AND STRIPING PLAN - FAIRMOUNT BLVD FROM MISSION INN AVE TO FIRST ST

LEGEND:

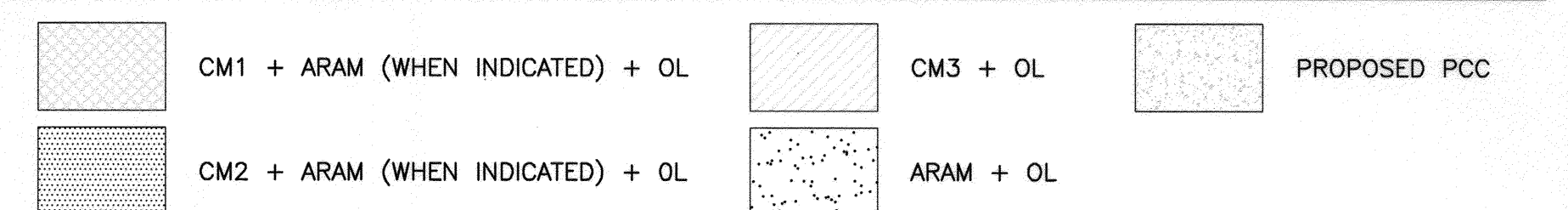

Under Ground Service Alert of Southern California
Call: TOLL FREE 1-800-227-2600
TWO WORKING DAYS BEFORE YOU DIG

ENGINEER IN RESPONSIBLE CHARGE
Edward Lara
R.C.E. No. 83753 EXPIRES: 9-30-14
DATE August 22, 2013

CITY OF RIVERSIDE, CALIFORNIA DEPARTMENT OF PUBLIC WORKS

APPROVED BY	BY	DATE	APPROVED BY
ENGINEERING MANAGER	BA	8/29/13	Edward Lara
CONSTRUCTION ADMIN.	BA	8/29/13	CITY ENGINEER
TRAFFIC DIVISION	BA	8/29/13	
STREETS DIVISION			

DESIGNED BY: TYH DRAWN BY: BA CHECKED BY: EL

STREET MAINTENANCE

2013/2014 MINOR STREETS MAINTENANCE, PHASE 1

TITLE SHEET AND NOTES

HORIZ. SCALE: NA VERT. SCALE: NA

DESIGN WORK ORDER NO.: 1321931
CONSTR. WORK ORDER NO.: 1321932

R-4262

SHEET 1 OF 7

FILE NAME: R4262-01.DWG

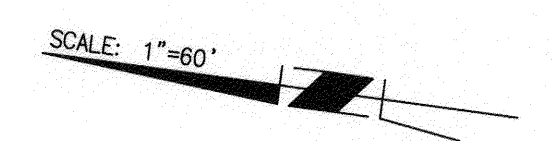
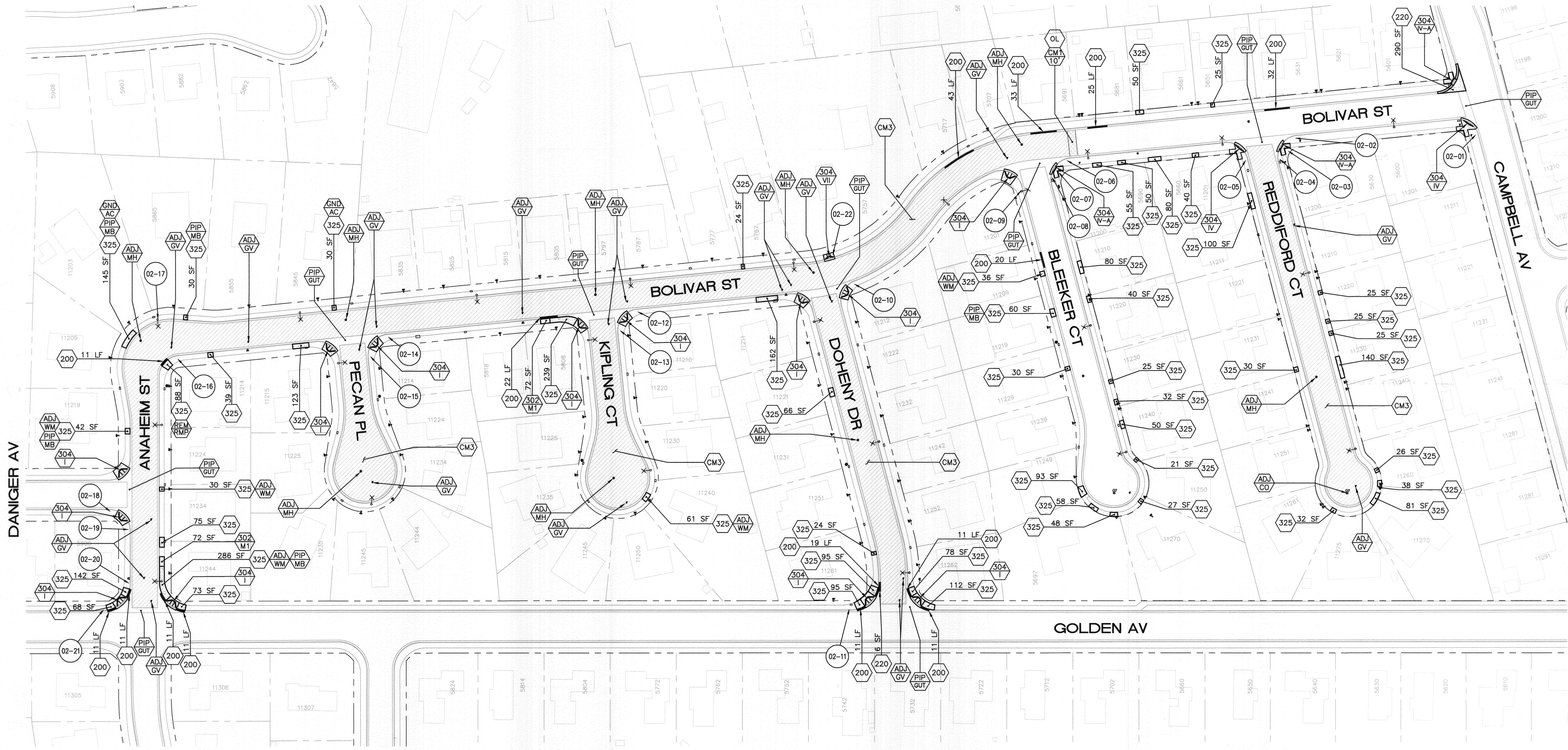

NOTE: SEE SHEET 7 FOR SIGN AND STRIPING IMPROVEMENTS REFERENCED HEREON.

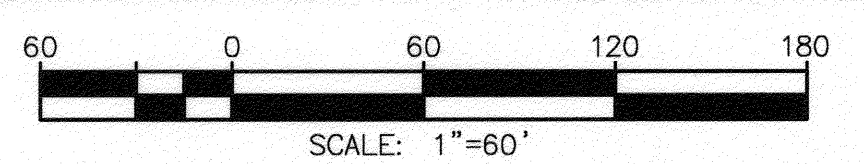

Under Ground Service Alert
of Southern California
Call: TOLL FREE
1-800
227-2600
TWO WORKING DAYS BEFORE YOU DIG

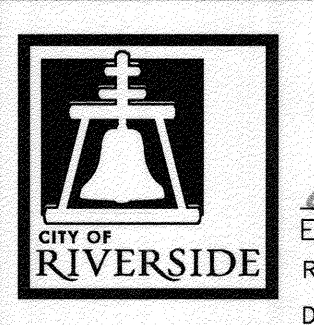

ENGINEER IN RESPONSIBLE CHARGE
Edward Lara
Edward Lara
R.C.E. No. 63753 EXPIRES: 9-30-14
DATE *August 22, 2013*

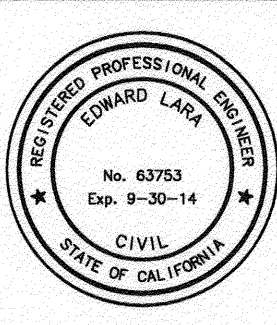

MARK	CORRECTED DRAWING #	APPR. DATE	DESIGNED BY	DRAWN BY	CHECKED BY
			TYH	BA	EL

CITY OF RIVERSIDE, CALIFORNIA DEPARTMENT OF PUBLIC WORKS					
APPROVED BY	BY	DATE	APPROVED BY	DATE	
ENGINEERING MANAGER	EM	8/22/13	CITY ENGINEER	8/29/13	
CONSTRUCTION ADMIN.	CA	8/29/13			
TRAFFIC DIVISION	TR				
STREETS DIVISION	SD				

STREET MAINTENANCE
2013/2014 MINOR STREETS MAINTENANCE, PHASE 1
LOCATION 1
HORIZ. SCALE: 1"=60' VERT. SCALE: NA

DESIGN WORK ORDER NO.: 1321931
CONSTR. WORK ORDER NO.: 1321932
R-4262
SHEET **2** OF **7**
FILE NAME: R4262-02.DWG

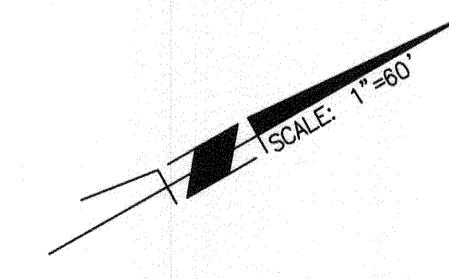
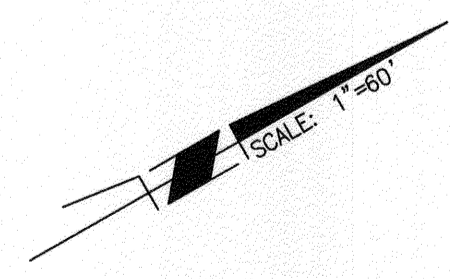
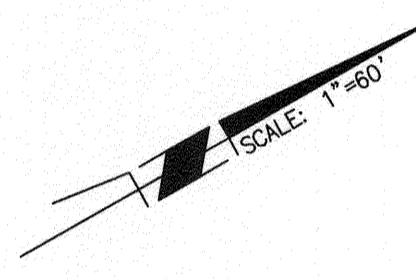
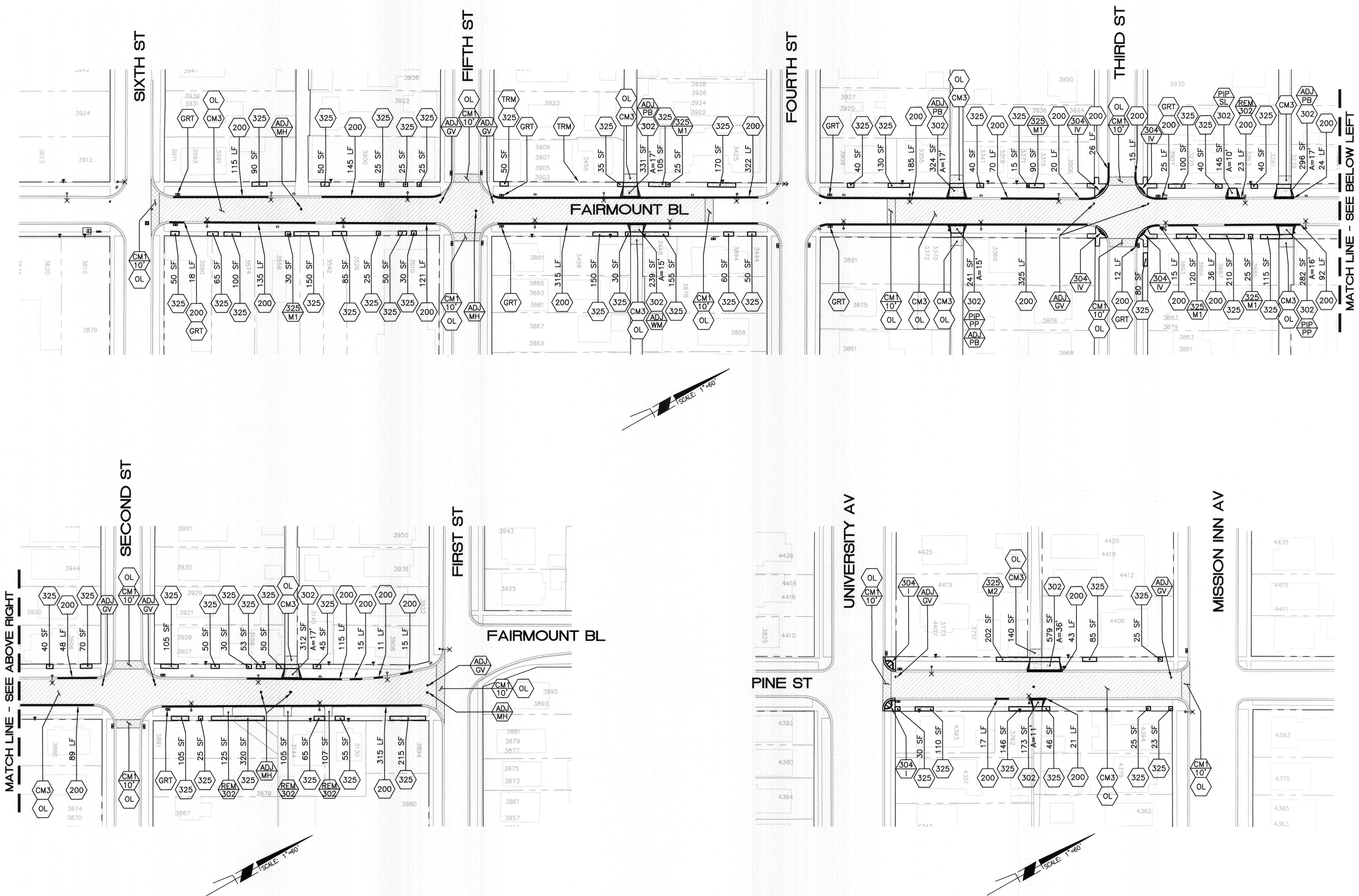

NOTE: FOR FAIRMOUNT BLVD – SEE XL-612 FOR SIGN AND STRIPING IMPROVEMENTS REFERENCED HEREON.
 FOR PINE ST – SEE SHEET 7 FOR SIGN AND STRIPING IMPROVEMENTS REFERENCED HEREON.

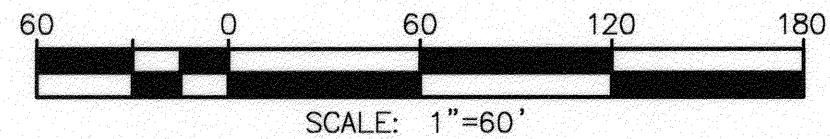

Under Ground Service Alert
 of Southern California
 Call: TOLL FREE 1-800-227-2600
TWO WORKING DAYS BEFORE YOU DIG

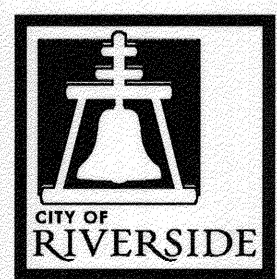

ENGINEER IN RESPONSIBLE CHARGE
 Edward Lara
 R.C.E. No. 63753 EXPIRES: 9-30-14
 DATE August 23, 2013

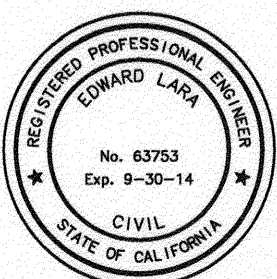

DESIGNED BY	TYH	DRAWN BY	BA	CHECKED BY	EL
APPROVED BY	[Signature]				
DATE	8/29/13				

CITY OF RIVERSIDE, CALIFORNIA DEPARTMENT OF PUBLIC WORKS					
APPROVED BY	BY	DATE	APPROVED BY	BY	DATE
ENGINEERING MANAGER	FM	8/29/13	CITY ENGINEER	[Signature]	8/29/13
CONSTRUCTION ADMIN.	DC	8/29/13			
TRAFFIC DIVISION	BAH	8-23-13			
STREETS DIVISION					

STREET MAINTENANCE	
2013/2014 MINOR STREETS MAINTENANCE, PHASE 1	
LOCATION 2	
HORIZ. SCALE: 1"=60'	VERT. SCALE: NA

DESIGN WORK ORDER NO.: 1321931
 CONSTR. WORK ORDER NO.: 1321932
R-4262
 SHEET 3 OF 7
 FILE NAME: R4262-03.DWG

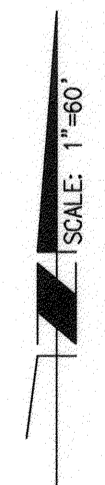
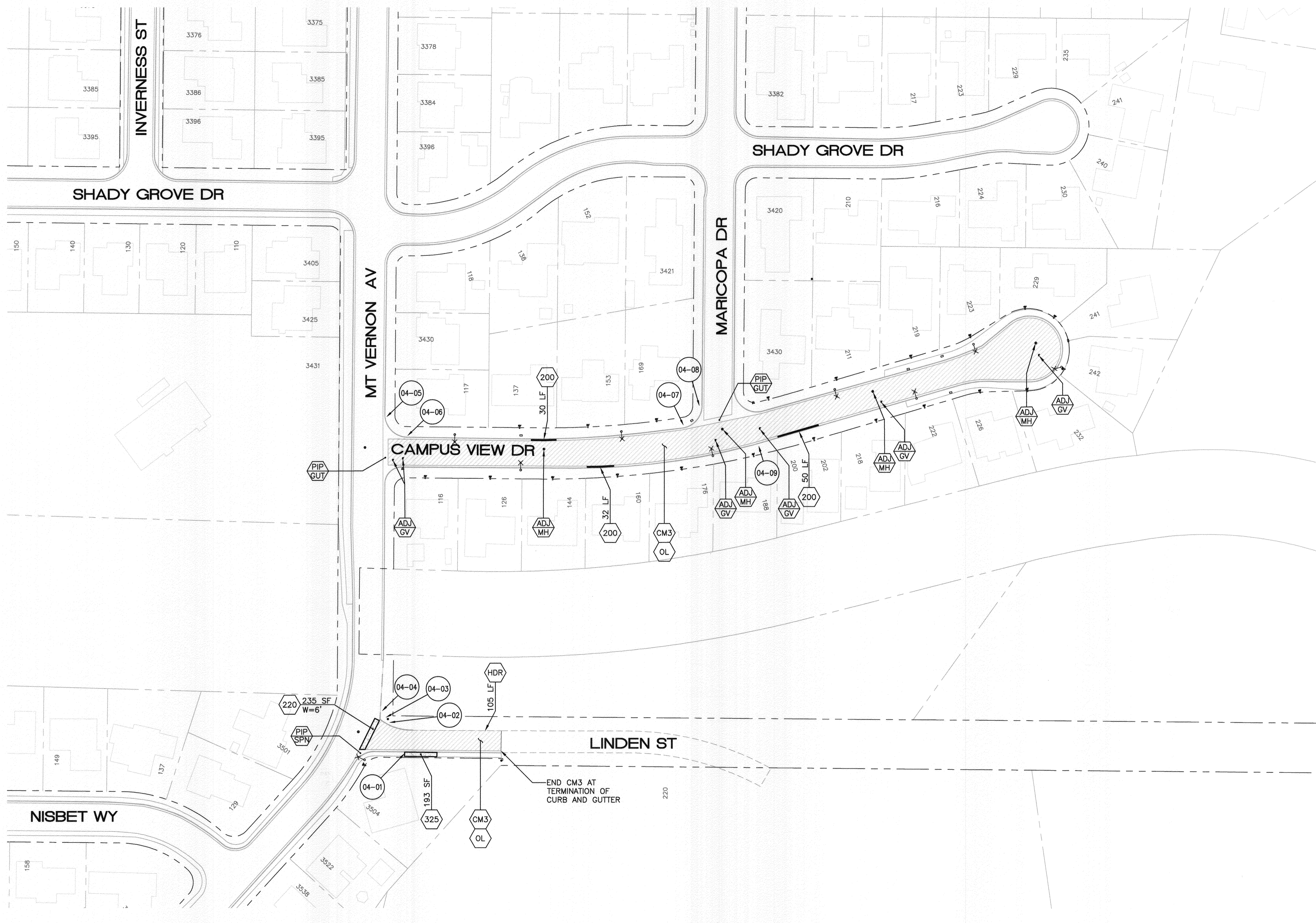

NOTE: SEE SHEET 7 FOR SIGN AND STRIPING IMPROVEMENTS REFERENCED HEREON.

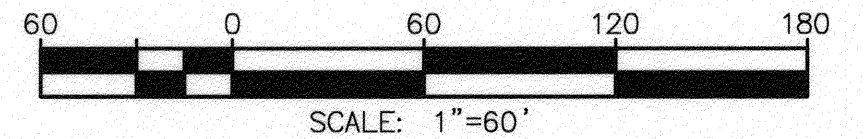

Under Ground Service Alert of Southern California
 Call: TOLL FREE 1-800-227-2600
 TWO WORKING DAYS BEFORE YOU DIG

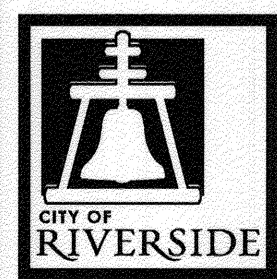

ENGINEER IN RESPONSIBLE CHARGE
Edward Lara
 Edward Lara
 R.C.E. No. 63753 EXPIRES: 9-30-14
 DATE August 22, 2013

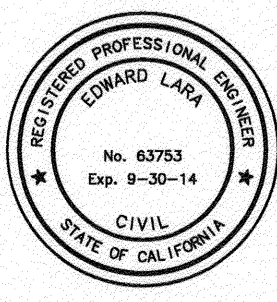

DESIGNED BY	TYH	DRAWN BY	BA	CHECKED BY	EL
MARK	CORRECTED DRAWING #				
REVISIONS					
APPR. DATE					

CITY OF RIVERSIDE, CALIFORNIA DEPARTMENT OF PUBLIC WORKS			
APPROVED BY	BY	DATE	APPROVED BY
ENGINEERING MANAGER	FM	8/27/13	<i>[Signature]</i>
CONSTRUCTION ADMIN.	DC	8/29/13	CITY ENGINEER
TRAFFIC DIVISION	E.H.	8-29-13	
STREETS DIVISION			DATE: 8/29/2013

STREET MAINTENANCE
 2013/2014 MINOR STREETS MAINTENANCE, PHASE 1
 LOCATION 3
 HORIZ. SCALE: 1"=60' VERT. SCALE: NA

DESIGN WORK ORDER NO.: 1321931
 CONSTR. WORK ORDER NO.: 1321932
R-4262
 SHEET 4 OF 7
 FILE NAME: R4262-04.DWG

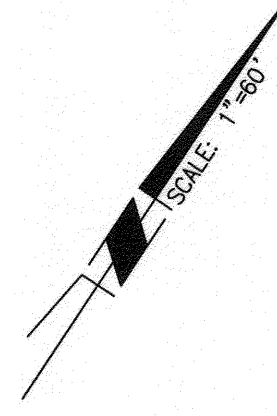
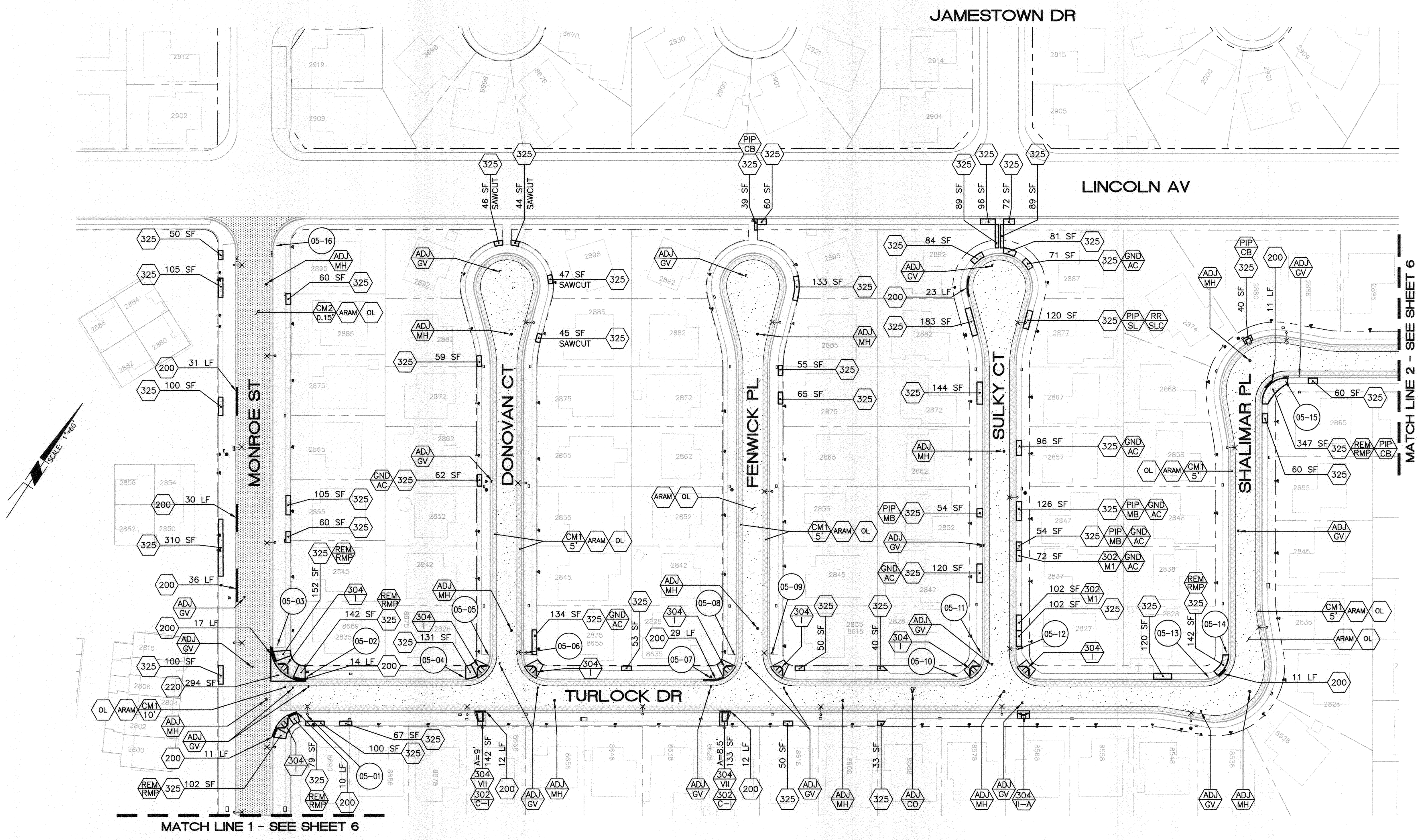

MATCH LINE 1 - SEE SHEET 6

MATCH LINE 2 - SEE SHEET 6

NOTE: SEE SHEET 7 FOR SIGN AND STRIPING IMPROVEMENTS REFERENCED HEREON.

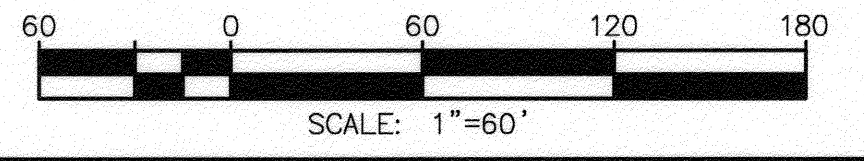

Under Ground Service Alert of Southern California
 Call: TOLL FREE 1-800-227-2600
 TWO WORKING DAYS BEFORE YOU DIG

ENGINEER IN RESPONSIBLE CHARGE
 Edward Lara
 Edward Lara
 R.C.E. No. 63753 EXPIRES: 9-30-14
 DATE August 22, 2013

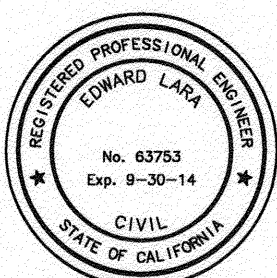

MARK	REVISIONS	APPR.	DATE
DESIGNED BY	TYH	DRAWN BY	BA
CHECKED BY	EL		

**CITY OF RIVERSIDE, CALIFORNIA
 DEPARTMENT OF PUBLIC WORKS**

APPROVED BY	BY	DATE	APPROVED BY	DATE
ENGINEERING MANAGER	Fm	8/22/13	[Signature]	8/22/13
CONSTRUCTION ADMIN.	JG	8/22/13	CITY ENGINEER	
TRAFFIC DIVISION	L.H.	8-22-13	DATE	8/22/2013
STREETS DIVISION				

STREET MAINTENANCE

2013/2014 MINOR STREETS MAINTENANCE, PHASE 1

LOCATION 4

HORIZ. SCALE: 1"=60' VERT. SCALE: NA

DESIGN WORK ORDER NO: 1321931
 CONSTR. WORK ORDER NO: 1321932

R-4262

SHEET **5** OF **7**

FILE NAME: R4262-05.DWG

MATCH LINE 1 - SEE SHEET 5

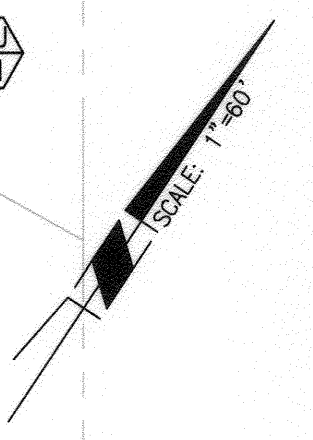
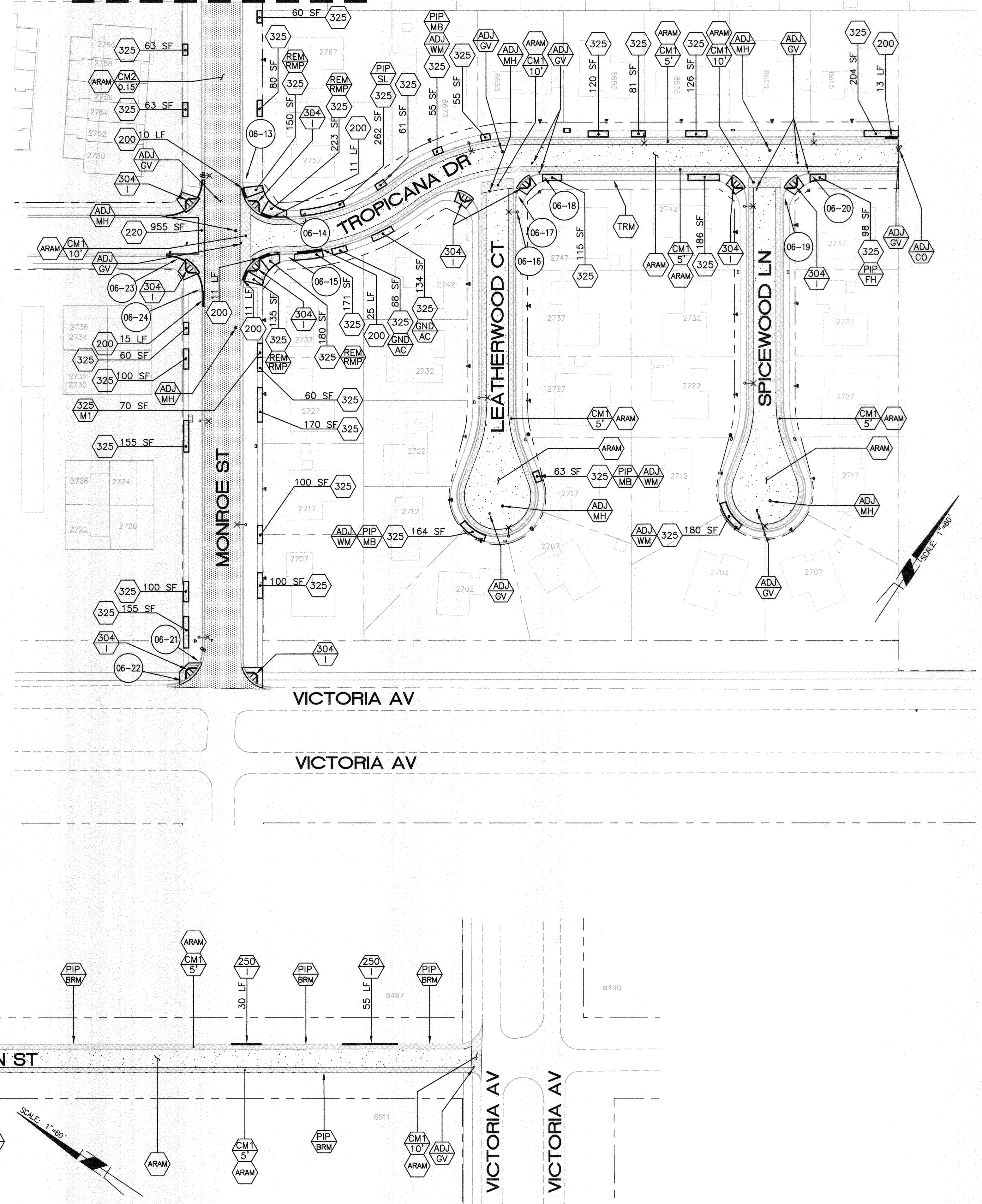

LINCOLN AV

SHALIMAR PL

WILLIAMSBURG PL

GRATTON ST

VICTORIA AV

VICTORIA AV

VICTORIA AV

VICTORIA AV

MATCH LINE 2 - SEE SHEET 5

NOTE: SEE SHEET 7 FOR SIGN AND STRIPING IMPROVEMENTS REFERENCED HEREON.

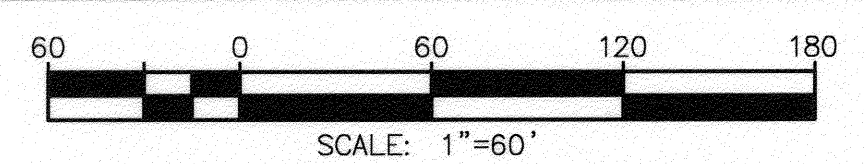

Under Ground Service Alert
 of Southern California
 Call: TOLL FREE 1-800 227-2600
 TWO WORKING DAYS BEFORE YOU DIG

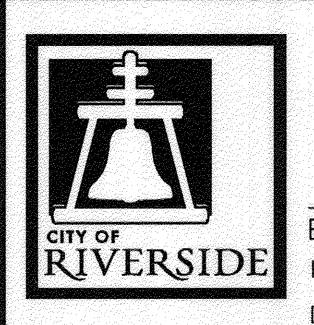

ENGINEER IN RESPONSIBLE CHARGE
 Edward Lara
 R.C.E. No. 63753 EXPIRES: 9-30-14
 DATE: August 22, 2013

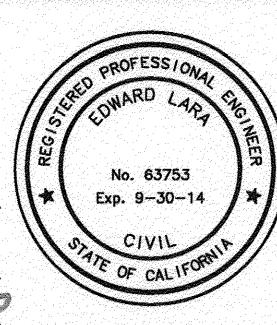

DESIGNED BY	TYH	DRAWN BY	BA	CHECKED BY	EL
APPROVED BY	[Signature]				
DATE	8/29/13				

CITY OF RIVERSIDE, CALIFORNIA DEPARTMENT OF PUBLIC WORKS			
APPROVED BY	BY	DATE	APPROVED BY
ENGINEERING MANAGER	EM	8/29/13	[Signature]
CONSTRUCTION ADMIN.	CA	8/29/13	CITY ENGINEER
TRAFFIC DIVISION	TRF	8-29-13	DATE: 8/29/2013
STREETS DIVISION	STR		

STREET MAINTENANCE	
2013/2014 MINOR STREETS MAINTENANCE, PHASE 1	
LOCATION 4	
HORIZ. SCALE: 1"=60'	VERT. SCALE: NA

DESIGN WORK ORDER NO.: 1321931	CONSTR. WORK ORDER NO.: 1321932
R-4262	
SHEET 6 OF 7	
FILE NAME: R4262-06.DWG	

PAVEMENT MARKING QUANTITIES - SHEET 2		
LOCATION	"STOP" LEGEND	12" WHITE LIMIT LINE
BOLIVAR & CAMPBELL	1	25 L.F.
REDDIFORD & BOLIVAR	1	25 L.F.
BLEEKER & BOLIVAR	1	25 L.F.
DOHENY & BOLIVAR	3	75 L.F.
DOHENY & GOLDEN	1	25 L.F.
KIPLING & BOLIVAR	1	25 L.F.
PECAN & BOLIVAR	1	25 L.F.
DANGER & ANAHEIM	1	25 L.F.
ANAHEIM & GOLDEN	1	25 L.F.
GRAND TOTAL	242 S.F.	200 L.F.

PAVEMENT MARKING QUANTITIES - SHEET 4		
LOCATION	"STOP" LEGEND	12" WHITE LIMIT LINE
LINDEN & MT. VERNON	1	20 L.F.
CAMPUS VIEW & MT VERNON	1	25 L.F.
MARICOPA & CAMPUS VIEW	1	25 L.F.
GRAND TOTAL	66 S.F.	70 L.F.

NOTE: ALL STREETS WITH AN EXISTING CROSS GUTTER SHALL HAVE THE LIMIT LINES/CROSSWALKS INSTALLED AT THE EDGE OF THE CROSS GUTTER UNLESS OTHERWISE NOTED

PAVEMENT MARKING QUANTITIES - SHEET 5					
LOCATION	"STOP" LEGEND	12" WHITE LIMIT LINE	DETAIL 22	DETAIL 38	TYPE IV ARROW
TURLOCK & MONROE	1	25 L.F.	-	-	-
DONOVAN & TURLOCK	1	25 L.F.	-	-	-
FENWICK & TURLOCK	1	25 L.F.	-	-	-
SULKY & TURLOCK	1	25 L.F.	-	-	-
MONROE & LINCOLN	2	100 L.F.	-	100 L.F.	2
MONROE & VICTORIA	1	115 L.F.	-	-	-
MONROE BETWEEN LINCOLN & VICTORIA	-	-	1184 L.F.	-	-
GRAND TOTAL	154 S.F.	315 L.F.	1184 L.F.	100 L.F.	30 S.F.

PAVEMENT MARKING QUANTITIES - SHEET 6		
LOCATION	"STOP" LEGEND	12" WHITE LIMIT LINE
GRATTON & VICTORIA	1	15 L.F. (*)
WILLIAMSBURG & GRATTON	1	25 L.F.
SHALIMAR & GRATTON	2	50 L.F.
GRATTON & LINCOLN	1	25 L.F. (**)
TROPICANA & MONROE	2	50 L.F.
LEATHERWOOD & TROPICANA	1	25 L.F.
SPICEWOOD & TROPICANA	1	25 L.F.
GRAND TOTAL	198 S.F.	190 L.F.

(*) = INSTALLED BEHIND THE BIKE PATHWAY OF TRAVEL
 (**) = INSTALLED AT CURB PROLOGATION

PAVEMENT MARKING QUANTITIES - SHEET 3 (PINE STREET ONLY)						
LOCATION	"STOP" LEGEND	12" WHITE LIMIT LINE	DETAIL 9	DETAIL 38	TYPE IV ARROW	TYPE I ARROW (10')
UNIVERSITY TO MISSION INN	2	140 L.F.	120 L.F.	100 L.F.	2	2
GRAND TOTAL	44 S.F.	140 L.F.	120 L.F.	100 L.F.	30 S.F.	28 S.F.

PAVEMENT MARKING QUANTITIES - SHEET 5 (ADDITIONAL LOCATIONS NOT SHOWN ON PLAN)		
LOCATION	"STOP" LEGEND	12" WHITE LIMIT LINE
LORENZO & SANTA ANA	1	30 L.F.
CYPRESS & SANTA ANA	1	30 L.F.
GRAND TOTAL	44 S.F.	60 L.F.

SIGN QUANTITIES - SHEET 6									
SIGN NUMBER	SIGN CODE	PANEL SIZE (IN)	INSTALL ROADSIDE SIGN(S)			INSTALL STREET NAME SIGN	RELOCATE ROADSIDE SIGN(S) OR SNS		REMOVE SIGN(S)
			NO POST	ONE POST	TWO POST		NO POST	ONE POST	
06-01	R1-1	30X30		1					1
06-02	SNS	9"				1			1
06-03	R1-1	30X30		1					1
06-04	W14-1	-							1
	W14-2	30X30	1						
06-05	"NEIGHBOR"	-							1
06-06	R1-1	-						1	
	SNS	-							1
06-07	SNS	9"				1			
06-08	"NEIGHBOR"	-							1
06-09	SNS	9"				1			1
06-10	R1-1	30X30		1					1
	W14-1	-							1
	W14-2	30X30		1					
06-11	WR26 MOD.	-						1	
	"NEIGHBOR"	-							1
06-12	SNS	9"				1			1
06-13	R1-1	30X30		1					1
06-14	W14-1	-							1
	W14-2	30X30		1					
06-15	"NEIGHBOR"	-							1
06-16	R1-1	30X30		1					1
06-17	SNS	9"				1			1
06-18	R1-1	30X30		1					1
06-19	SNS	9"				1			1
06-20	R1-1	-							1(*)
06-21	SNS	9"				1			
06-22	R1-1	-							1(*)
06-23	SNS	-							1
06-24	SNS	9"				1			
GRAND TOTAL:			1	8		7	1	2	17

SEE CITY OF RIVERSIDE STD DWG NO. 664 FOR ROADSIDE SIGNS
 SEE CITY OF RIVERSIDE STD DWG NO. 662 FOR STREET NAME SIGNS
 SNS = STREET NAME SIGN
 (*) = REPLACE POST

SIGN QUANTITIES - SHEET 2									
SIGN NUMBER	SIGN CODE	PANEL SIZE (IN)	INSTALL ROADSIDE SIGN(S)			INSTALL STREET NAME SIGN	RELOCATE ROADSIDE SIGN(S) OR SNS		REMOVE SIGN(S)
			NO POST	ONE POST	TWO POST		NO POST	ONE POST	
02-01	SNS	9"				1			1
02-02	SNS	9"				1			
02-03	SNS	-							1
02-04	R1-1	30X30		1					
02-05	*	-							1
02-06	SNS	9"				1			
02-07	SNS	-							1
02-08	R1-1	30X30		1					
02-09	W14-1	-							1
	W14-2	30X30	1						
02-10	SNS	9"				1			1
02-11	SNS	9"				1			1
02-12	SNS	9"				1			1
02-13	R1-1	30X30		1					
02-14	SNS	9"				1			1
02-15	R1-1	30X30		1					
02-16	SNS	9"				1			1
02-17	"NEIGHBOR"	-							1
02-18	R1-1	30X30		1					
02-19	SNS	9"				1			1
02-20	R1-1	-							1(**)
02-21	SNS	9"				1			1
02-22	R1-1	-							1(**)
GRAND TOTAL:			1	5		10	2		13

SEE CITY OF RIVERSIDE STD DWG NO. 664 FOR ROADSIDE SIGNS
 SEE CITY OF RIVERSIDE STD DWG NO. 662 FOR STREET NAME SIGNS
 SNS = STREET NAME SIGN
 * = REMOVE EXISTING POST
 ** = REPLACE EXISTING POST

SIGN QUANTITIES - SHEET 4									
SIGN NUMBER	SIGN CODE	PANEL SIZE (IN)	INSTALL ROADSIDE SIGN(S)			INSTALL STREET NAME SIGN	RELOCATE ROADSIDE SIGN(S) OR SNS		REMOVE SIGN(S)
			NO POST	ONE POST	TWO POST		NO POST	ONE POST	
04-01	W14-1	-							1
	W14-2	30,30	1						
04-02	R1-1	30X30		1					
04-03	SNS	-							1
04-04	SNS	9"				1			
04-05	SNS	9"				1			
04-06	SNS	-							1
04-07	SNS	9"				1			
04-08	R1-1	30X30		1					
	SNS	-							1
04-09	W14-1	-							1
	W14-2	30X30		1					
GRAND TOTAL:			1	3		3			5

SEE CITY OF RIVERSIDE STD DWG NO. 664 FOR ROADSIDE SIGNS
 SEE CITY OF RIVERSIDE STD DWG NO. 662 FOR STREET NAME SIGNS
 SNS = STREET NAME SIGN

SIGN QUANTITIES - SHEET 5									
SIGN NUMBER	SIGN CODE	PANEL SIZE (IN)	INSTALL ROADSIDE SIGN(S)			INSTALL STREET NAME SIGN	RELOCATE ROADSIDE SIGN(S) OR SNS		REMOVE SIGN(S)
			NO POST	ONE POST	TWO POST		NO POST	ONE POST	
05-01	"NEIGHBOR"	-							1
05-02	R1-1	30X30		1					1
05-03	SNS	9"				1			1
05-04	SNS	9"				1			
05-05	R1-1	30X30		1					1
	SNS	9"							1
05-06	"NEIGHBOR"	-							1
05-07	SNS	9"				1			
05-08	R1-1	30X30		1					
	SNS	-							1
05-09	W14-1	-							1
	W14-2	30X30	1						
05-10	SNS	9"				1			
05-11	R1-1	30X30		1					
	SNS	-							1
05-12	"NEIGHBOR"	-							1
	W14-1	-							1
05-13	W14-2	30X30	1						
	SNS	9"				1			
05-14	SNS	-							1
05-15	SNS	9"				1			
05-16	R1-1	-							1(*)
GRAND TOTAL:			2	4		6	1		11

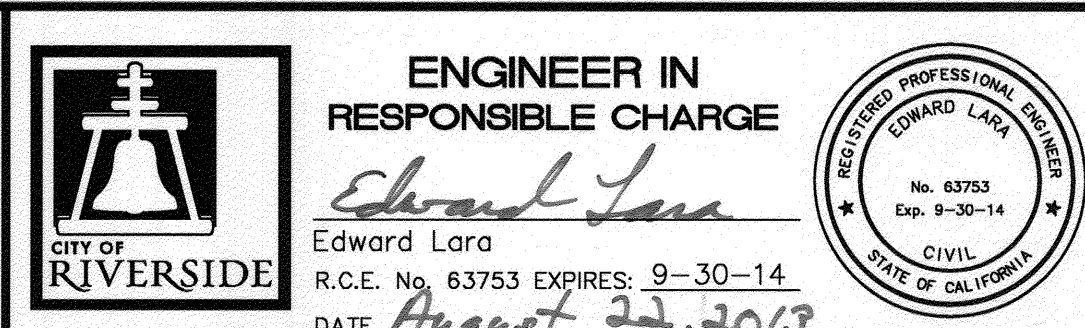

CITY OF RIVERSIDE, CALIFORNIA
 DEPARTMENT OF PUBLIC WORKS

APPROVED BY: [Signature] DATE: 8/29/13
 ENGINEERING MANAGER

CONSTRUCTION ADMIN. [Signature] DATE: 8-29-13
 TRAFFIC DIVISION

STREETS DIVISION

DESIGNED BY: DMC DRAWN BY: DMC CHECKED BY: EL

STREET MAINTENANCE
 2013/2014 MINOR STREETS MAINTENANCE, PHASE 1

SIGN AND STRIPING QUANTITIES

HORIZ. SCALE: NA VERT. SCALE: NA

DESIGN WORK ORDER NO: 1321931
 CONSTR. WORK ORDER NO: 1321932

R-4262

SHEET 7 OF 7

FILE NAME: R4262-07.DWG