

GENERAL CONSTRUCTION NOTES:

- 1 THE CONTRACTOR SHALL PROVIDE AND MAINTAIN TRAFFIC AS INDICATED IN THE ASSOCIATED PROJECT SPECIAL PROVISIONS.
- 2 CONSTRUCTION SHALL BE IN ACCORDANCE WITH THE CITY OF RIVERSIDE STANDARD DRAWINGS AND STANDARD SPECIFICATIONS FOR PUBLIC WORKS CONSTRUCTION, 2012 EDITION.
- 3 EXISTING UTILITIES SHOWN ON THIS PLAN ARE PLOTTED FROM UTILITY RECORDS. THE CONTRACTOR IS REQUIRED TO TAKE DUE PRECAUTIONARY MEASURES TO LOCATE AND PROTECT ALL UTILITIES WHETHER OR NOT SHOWN ON THIS PLAN.
- 4 ALL STREET PULL BOXES, AFFECTED BY CONSTRUCTION, SHALL BE ADJUSTED TO THE PROPOSED GRADE.
- 5 PRIME CONTRACTOR BIDDING THIS WORK SHALL HAVE A CLASS "A" OR "C-12".
- 6 THE SEAM BETWEEN PASSES OF THE AC OVERLAY SHALL COINCIDE, AS CLOSE AS POSSIBLE, TO THE LANE LINES.
- 7 COLD MILLING SHALL BE AS DESCRIBED ON THE PLANS AND SPECIAL PROVISIONS OR AS DIRECTED BY THE ENGINEER.
- 8 ANY DISTRESSED EXISTING PAVEMENT SHALL BE REMOVED AND REPLACED AS DIRECTED BY THE ENGINEERING AFTER COLD-MILLING AND PRIOR TO PLACEMENT OF DGAC.
- 9 CONTRACTOR SHALL REMOVE ALL VEGETATION AND CLEAR ALL DIRT WITHIN ALL SIDEWALK PANELS WITHIN THE PROJECT LIMITS.
- 10 ALL EXISTING IMPROVEMENTS SHOWN HEREON SHALL BE PROTECTED IN PLACE UNLESS OTHERWISE NOTED.
- 11 EXISTING IRRIGATION SHALL BE PROTECTED OR MODIFIED, INCLUDING FURNISHING NEW MATERIALS, AS NECESSARY TO CONSTRUCT NEW CONCRETE IMPROVEMENTS.
- 12 SEE STRIPING & TRAFFIC SIGNAL PLANS FOR REMOVAL, REPLACEMENT, AND RELOCATION OF EXISTING SIGNING, STRIPING, LOOPS, AND TRAFFIC EQUIPMENT.

CONSTRUCTION NOTES:

- ADJ. REMOVE AND REPLACE IN KIND EXISTING FACILITY, NUMBERS ABOVE 100 IN A HEXAGON ON THE PLAN REFER TO THE RESPECTIVE STANDARD DRAWING AND SHALL BE CONSTRUCTED ACCORDINGLY. ANY NOTE SHOWN BELOW THE STANDARD DRAWING NUMBER INDICATES THE SPECIFIC TYPE, ACTION, OR MODIFICATION TO BE CONSTRUCTED. WHERE NO MODIFICATION OR TYPE IS INDICATED, THE DIMENSIONS OF NEW FACILITY SHALL BE MODIFIED AS NECESSARY, EXCLUDING ADA REQUIREMENTS, TO MATCH EXISTING FACILITY REMOVED.
- ADJ. ADJUST TO GRADE, DESCRIPTION PER PLAN. (MH) ELECTRIC, TELEPHONE, SEWER OR STORM DRAIN. (GV) GATE VALVE. (ETS) ELECTRIC TEST STATION. (WM) WATER METER. (PB) PULLBOX. (VLT) ELECTRIC OR WATER VAULT, TYPE PER PLAN.
- PIP. PROTECT IN PLACE, DESCRIPTION PER PLAN. (MH) SEWER OR STORM DRAIN. (GV) GATE VALVE. (WM) WATER METER. (PB) PULLBOX. (SL) STREET LIGHT. (TR) TRAFFIC SIGNAL EQUIPMENT. (TRE) TREE. (DWY) DRIVEWAY. (CO) CLEANOUT. (CB) CATCH BASIN. (AV) AIR VALVE. (CRB) CURB.
- REM. REMOVE EXISTING IMPROVEMENT. (CRB) REMOVE EXISTING MEDIAN CURB AND STAMPED CONCRETE AS NECESSARY IN ORDER TO BUILD NEW MEDIAN. (CLVT) REMOVE REMAINING ASPHALT CULVERT BEHIND CURB. (TRE) REMOVE TREE.
- GRD. ("---" AS FOLLOWS):
 - M1 = GRADE DIRT SLOPE FROM 0.5' BEHIND NEW 6" SIDEWALK TO RIGHT-OF-WAY (12' FROM CURB FACE). CONTRACTOR SHALL NOTIFY ENGINEER PRIOR TO CONCRETE POUR IF SLOPE GRADE EXCEEDS 3:1 WITH MAXIMUM 18" RETAINING CURB. FURNISH, INSTALL, AND ESTABLISH HYDROSEED FOR 365 DAYS.
 - M2 = STRAIGHT GRADE DIRT SLOPE FROM BEHIND ASPHALT CURB TO NEW SIDEWALK. FILL IN ANY DEPRESSIONS AND HOLES. REMOVE ALL BRUSH AND VEGETATION. PROTECT PALM TREES IN PLACE. FURNISH, INSTALL, AND ESTABLISH HYDROSEED FOR 365 DAYS.
- RET. CURB. CONSTRUCT RETAINING CURB (0"-18" MAX.) AS NECESSARY FOR KEEPING SLOPE BEHIND AT UNDER 3:1. CURB SHALL BE POURED MONOLITHIC WITH THE ADJOINING SIDEWALK.
- BUS. CONSTRUCT 60' LONG BY 12' WIDE CONCRETE BUS PAD (BUS PAD WIDTH MEASURED FROM MONOLITHIC CURB FACE), UNLESS OTHERWISE INDICATED ON PLANS. BASE OR SUBGRADE OR EXISTING PAD SHALL BE REMOVED AND COMPACTED AS NECESSARY TO INSTALL BUS PAD PER DETAIL IN PART 10 OF THE SPECIFICATIONS. ENGINEER SHALL BE NOTIFIED PRIOR TO POURING NEW CONCRETE.
- MED. CONSTRUCT NEW MEDIAN OPENING WITH DIMENSIONS AS SHOWN ON PLAN (NOSE RADIUS OF 5'). MODIFY EXISTING LANDSCAPE AND IRRIGATION TO FIT WITHIN NEW MEDIAN. CONSTRUCT 3.5" THICK COLORED STAMPED CONCRETE AROUND EDGE OF MEDIAN. COLOR AND PATTERN SHALL MATCH EXISTING MEDIAN. REMOVE AND RECONSTRUCT EXISTING STAMPED CONCRETE AS NECESSARY TO MEET EXISTING JOINS. CONSTRUCT NEW TYPE-II CURB FLOWLINE AT 1.5% DOWNGRADE FROM MEDIAN NOSE EC(STA 13+26.29) TO MEDIAN NOSE BC(STA 13+25.46). STRAIGHT GRADE FLOWLINE FROM MEDIAN NOSE BC(STA 13+25.46) TO EC/JOIN(STA 13+75.00).
- 200. CONSTRUCT/RECONSTRUCT PCC CURB AND GUTTER PER CITY STANDARD 200 MATCHING THE EXISTING TYPE AND HEIGHT. ("---" AS FOLLOWS):
 - M1 = RECONSTRUCT TYPE I-6" CURB TO STRAIGHT GRADE FROM CURB RETURN TO SANTIAGO ESTATES DRIVEWAY.
- 302. CONSTRUCT/RECONSTRUCT DRIVEWAY APPROACH PER CITY STANDARD 302. ("---" AS FOLLOWS):
 - PL-1= TYPE PL-I; PL-2= TYPE PL-II;
 - C-1= TYPE CURB-I; C-2= TYPE CURB-II;
- 304. CONSTRUCT/RECONSTRUCT WHEELCHAIR RAMP PER CITY STANDARD 304. ("---" AS FOLLOWS):
 - I=TYPE I; II=TYPE II; II-A=TYPE II-A; III=TYPE III; V=TYPE V;
 - M1 = CONSTRUCT TYPE II RAMP, MODIFIED TO ROTATE ALONG RETURN AS NECESSARY TO PROVIDE 4' WIDE LANDING WITHIN PUBLIC R/W AND TO CONSTRUCT RETAINING CURB TO ELIMINATE NORTHERLY WING.
 - M2 = CONSTRUCT (2) MODIFIED TYPE I RAMP. INSTALL WINGS ON ROADSIDE ONLY AND CONSTRUCT RETAINING CURB ON OPPOSITE SIDE. RECONSTRUCT AND DROP CURB HEIGHT DOWN AROUND THE RETURN IN ORDER INSTALL SHARED 4' WIDE LANDING AT TOP OF 8.33% MAXIMUM RAMP.
 - M3 = CONSTRUCT MODIFIED TYPE I RAMP. PROTECT IN PLACE AIR VALVES AND ADJUST WATER METER WITHIN NEW RAMP. REMOVE ASPHALT PATCH AROUND NORTHERLY AIR VALVE AND CONSTRUCT NEW RAMP AROUND IT.
 - M4 = CONSTRUCT MODIFIED TYPE III RAMP. INSTALL RETAINING CURB ON EACH SIDE OF RAMP TO CONFORM WITH EXISTING CONCRETE DIMENSIONS.
- 325. CONSTRUCT/RECONSTRUCT PCC SIDEWALK PER CITY STANDARD 325. ("---" AS FOLLOWS):
 - M1 = RECONSTRUCT PCC SIDEWALK TO MEET NEW CURB GRADE.
- 405. CONSTRUCT NEW CATCH BASIN TOP PER CITY STANDARD 405. ("---" AS FOLLOWS):
 - M1 = SAWCUT AND REMOVE THE TOP 24" OF THE EXISTING CATCH BASIN. PROTECT IN PLACE THE EXISTING R.C.P. CONNECTION AND MAINTAIN EXISTING "V" DEPTH. DOWEL INTO EXISTING BOX WALLS AND INSTALL NEW REBAR. INSTALL WITH NEW CURB AND GUTTER.
 - M2 = RECONSTRUCT GUTTER APRON ONLY IN FRONT OF CATCH BASIN, PROTECTING CATCH BASIN OPENING IN PLACE. SAWCUT BELOW TOP OF CURB AND IN FRONT OF TOP OF THE BOX AT THE BOTTOM OF THE APRON. DOWEL INTO EXISTING CATCH BASIN WALL AND POUR NEW APRON.
- W1. CONTRACTOR SHALL COORDINATE WATER VAULT TO BE ADJUSTED BY RIVERSIDE PUBLIC UTILITIES, WATER DIVISION.

NOTE:

** ALL UTILITY FACILITIES SHALL BE ADJUSTED TO GRADE AND PAINTED, UNLESS OTHERWISE NOTED, WITHIN NEW DGAC AREAS. **

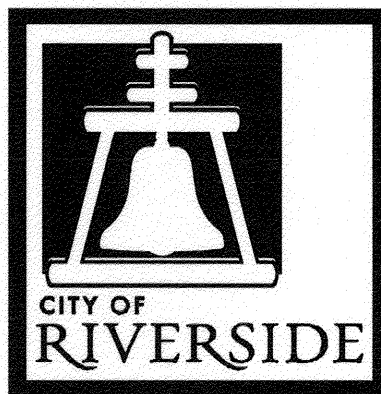

RIVERSIDE

CITY OF RIVERSIDE

CALIFORNIA

PUBLIC WORKS DEPARTMENT

2014/2015 ARTERIAL STREETS MAINTENANCE

PHASE 1

CANYON CREST DRIVE, SPRUCE STREET AND MAIN STREET

CONSTRUCTION NOTES (CONTINUED):

- CM1. 0.12' DEEP MIN. LINEAR COLD MILL OF EXISTING AC PAVEMENT. ("---" AS FOLLOWS):
 - "---" = WIDTH(FEET) OF LINEAR COLD MILL AS INDICATED ON PLANS
- CM2. VARIABLE AREA COLD MILL OF EXISTING AC PAVEMENT. ("---" AS FOLLOWS):
 - "---" = DEPTH(FEET) OF VARIABLE AREA COLD MILL.
- CM3. VARIABLE AREA FULL DEPTH COLD MILL TO REMOVE EXISTING PAVEMENT SECTION DOWN TO BASE MATERIAL OR NATIVE SOIL (DEPTHS WILL VARY).
- DG. OVERLAY EXISTING PAVEMENT WITH DGAC PAVEMENT BETWEEN EDGES OF PAVEMENT OR AS OTHERWISE INDICATED ON PLAN. ("---" = DEPTH PER PLAN OR AS FOLLOWS):
 - M1 = OVERLAY VARIABLE AMOUNT (0.33' MINIMUM) OF DGAC OVERLAY TO STRAIGHT GRADE FROM NEW EDGE OF PAVEMENT TO 13' LT OF NEW CURBFACE. PROVIDE A SMOOTH TRANSITION INTO THE INTERSECTION AND AROUND THE CURB RETURN.
 - M2 = OVERLAY VARIABLE AMOUNT (0.33' MINIMUM) OF DGAC OVERLAY FROM IOWA CENTERLINE TO E'LY AND W'LY SPRUCE STREET CURB RETURNS. IMPROVE TRANSITION ACROSS INTERSECTION BY FEATHERING IN OVERLAY FROM IOWA CENTERLINE TO LIMIT LINES ON SPRUCE STREET.
 - M3 = REPLACEMENT OF EXISTING PAVEMENT SECTION WITH FULL-DEPTH DGAC OVER NATIVE SOIL/BASE. NATIVE SOIL AND/OR BASE SHALL BE REMOVED AND COMPACTED AS NECESSARY TO INSTALL 1.0' MIN. REPLACEMENT DGAC PAVEMENT SECTION. RAISE PAVEMENT ELEVATION AT 8' RT OF CENTERLINE TO ACHIEVE MINIMUM 1.5% CROSSFALL TO 8' LT OF CENTERLINE.
 - M4 = OVERLAY VARIABLE AMOUNT (0.12' MINIMUM) OF DGAC OVERLAY FROM EACH SIDE OF "M3" LIMITS TO 20' LT AND RT OF CENTERLINE TO ACHIEVE MINIMUM 1.5% CROSSFALL.
 - FD = REPLACEMENT OF EXISTING PAVEMENT SECTION WITH FULL-DEPTH DGAC OVER NATIVE SOIL/BASE. NATIVE SOIL AND/OR BASE SHALL BE REMOVED AND COMPACTED AS NECESSARY TO INSTALL 0.55' MIN. REPLACEMENT PAVEMENT SECTION (0.25' MIN. REPLACEMENT ON ATLANTA AVENUE). REPLACEMENT DGAC THICKNESS SHALL ACCOUNT FOR FINAL 0.12' ARHM CAP WHEN REQUIRED.
- OL. OVERLAY EXISTING PAVEMENT WITH 0.12' MIN. DEPTH (FT) ARHM OVERLAY BETWEEN EDGES OF PAVEMENT OR AS OTHERWISE INDICATED ON PLAN.
- S1. REMOVE 2,250 SF OF EXISTING MEDIAN AND REPLACE WITH NEW PAVEMENT SECTION OF 1.0' DGAC OVER 90% COMPACTED NATIVE SOIL. EXISTING PAVEMENT AND NATIVE SOIL SHALL BE REMOVED AND COMPACTED AS NECESSARY TO INSTALL NEW 1.0' MIN. PAVEMENT SECTION.

CONSTRUCTION LEGEND:

- CM1 COLDMILL TYPE CM1 & 0.12' ARHM OVERLAY
- CM3/DG FULL DEPTH COLDMILL TYPE CM3, NEW DGAC PAVEMENT & 0.12' ARHM OVERLAY
- CM2/DG AND/OR OL COLDMILL TYPE CM2, NEW DGAC PAVEMENT (DEPTH PER PLAN) & 0.12' ARHM OVERLAY
- PROPOSED CONCRETE SURFACE

EXISTING TOPOGRAPHY:

- SANITARY SEWER M.H.
- STORM DRAIN M.H.
- ELECTRIC M.H.
- WATER M.H.
- M.H.
- GATE VALE
- ELECTRIC STRUCTURES
- FIRE HYDRANT
- ELECTROLYSIS TEST STATION
- POWER POLE/STREET LIGHT

STREET IMPROVEMENT PLAN INDEX (R-4292)

SHEET NO.	DESCRIPTION
1	TITLE SHEET AND NOTES
2	CANYON CREST DRIVE (ALESSANDRO - VIA VISTA)
3	SPRUCE STREET (CHICAGO AVE - IOWA AVE)
4	SPRUCE STREET (IOWA AVE - RUSTIN AVE)
5	MAIN STREET (COLUMBIA AVE - WITT AVE)

STRIPING PLAN INDEX (XL-350,XL-242,& XL-576A)

PLAN NO.	# OF SHEETS	DESCRIPTION
XL-350	3	CANYON CREST DRIVE (ALESSANDRO - VIA VISTA)
XL-242	3	SPRUCE STREET (CHICAGO - RUSTIN)
XL-576A	1	MAIN STREET (COLUMBIA - WITT)

LOCATION 1 MAP / SHEET INDEX
CANYON CREST DRIVE (ALESSANDRO - VIA VISTA)

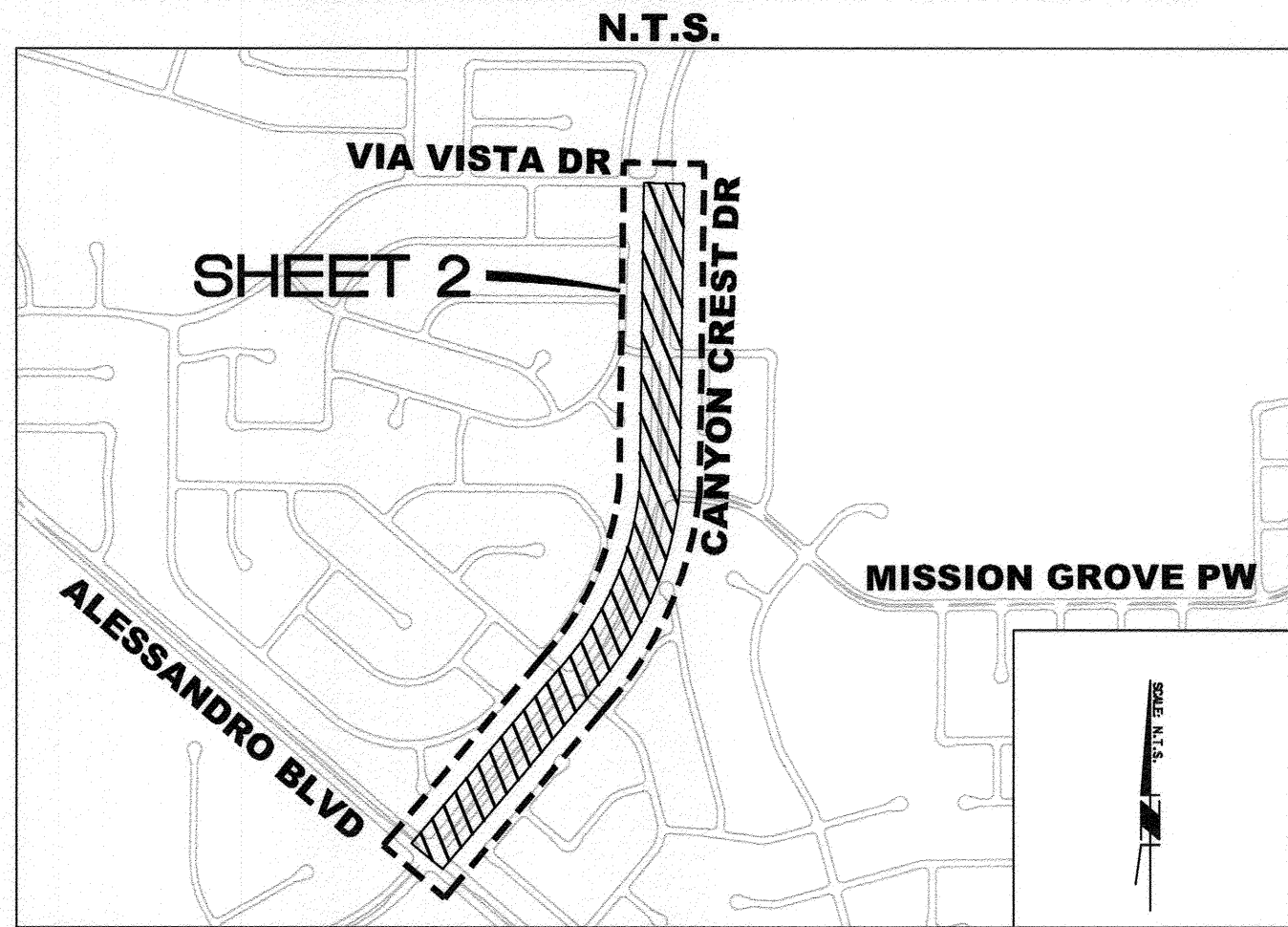

LOCATION 2 MAP / SHEET INDEX
SPRUCE STREET (CHICAGO - RUSTIN)

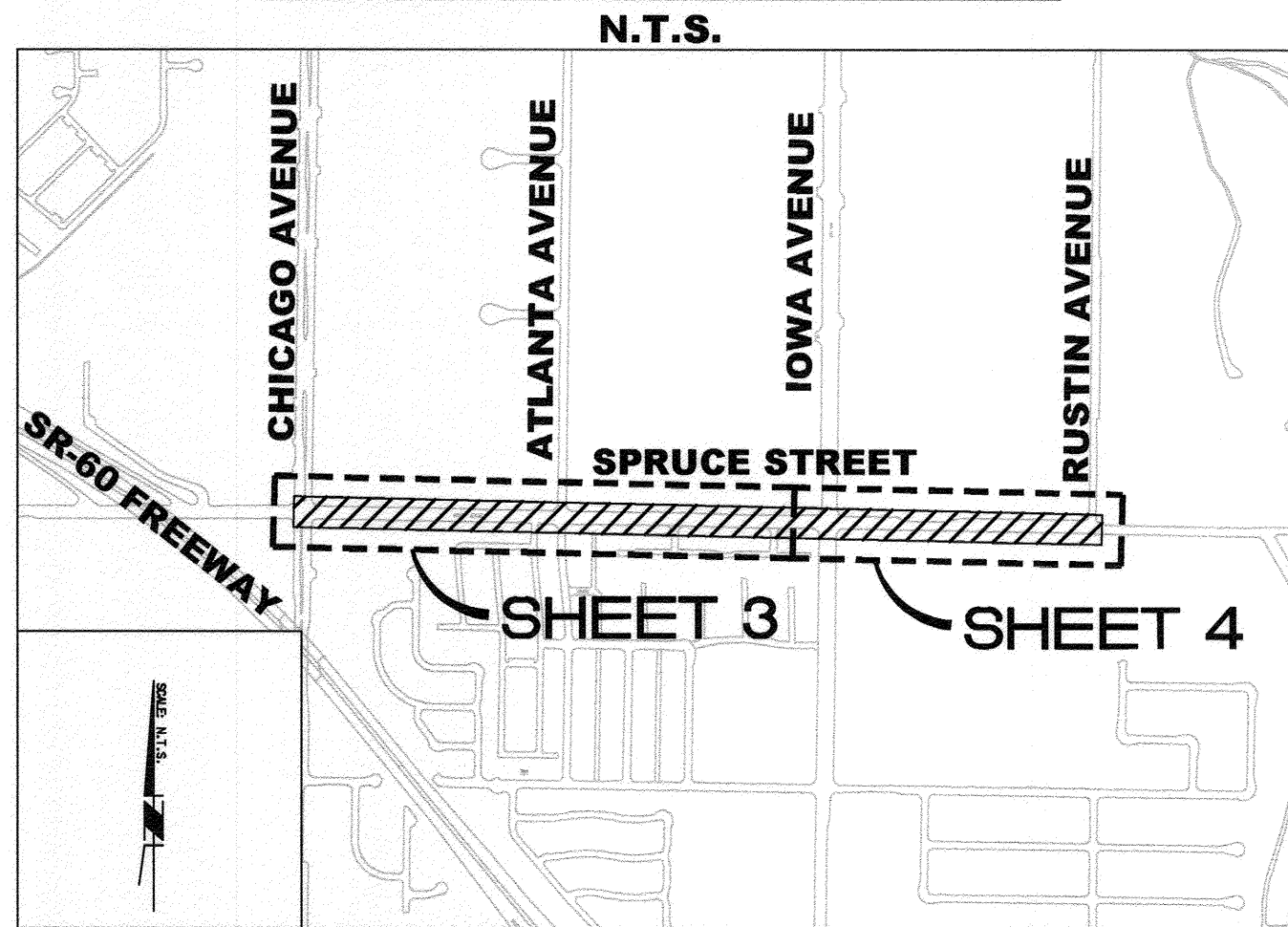

LOCATION 3 MAP / SHEET INDEX
MAIN STREET (COLUMBIA - WITT)

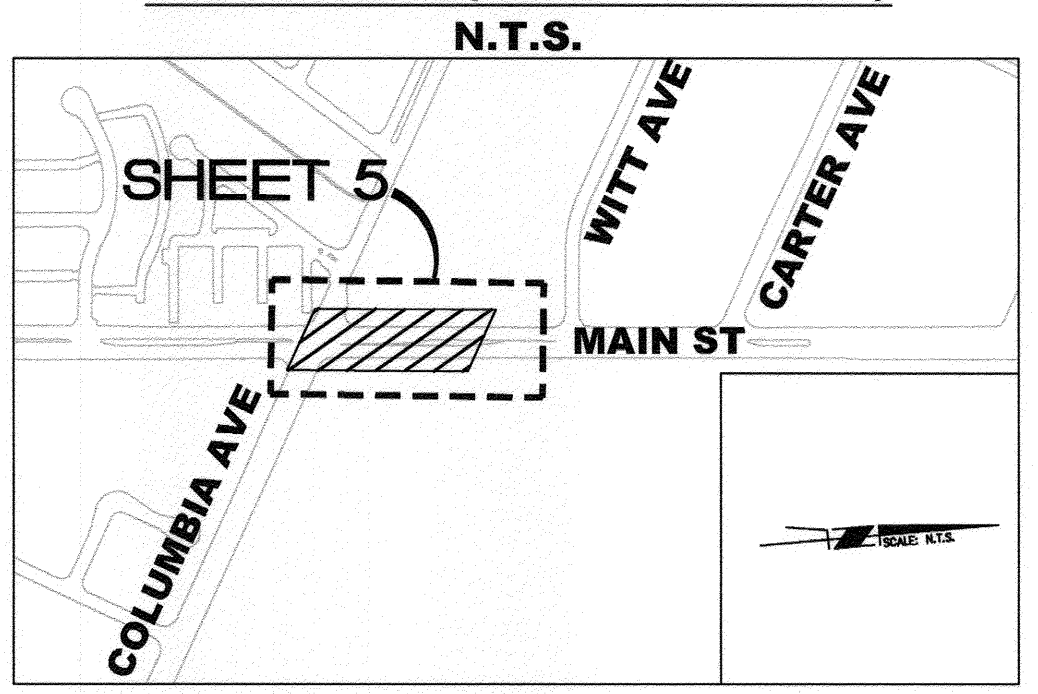

LOCATION MAP LEGEND

- PROJECT LOCATION
- SHEET LIMITS

Under Ground Service Alert of Southern California
Call: TOLL FREE 1-800-227-2600
TWO WORKING DAYS BEFORE YOU DIG

ENGINEER IN RESPONSIBLE CHARGE
Edward Lara
R.C.E. No. 63753 EXPIRES: 9-30-14
DATE August 14, 2014

REGISTERED PROFESSIONAL ENGINEER
EDWARD LARA
No. 63753
Exp. 9-30-14
CIVIL
STATE OF CALIFORNIA

MARK	REVISIONS	APPR.	DATE

CITY OF RIVERSIDE, CALIFORNIA
DEPARTMENT OF PUBLIC WORKS

APPROVED BY: [Signature] DATE: 8/22/14
CONSTRUCTION ADMIN. [Signature]
TRAFFIC DIVISION [Signature]
SURVEY [Signature]
STREETS

STREET MAINTENANCE
2014/2015 ARTERIAL STREETS MAINTENANCE
CANYON CREST DRIVE, SPRUCE STREET, AND MAIN STREET

TITLE SHEET AND NOTES
HORIZ. SCALE: VERT. SCALE: NA

DESIGN WORK ORDER NO.: 1501755
CONSTR. WORK ORDER NO.: 1422360

R-4292

SHEET 1 OF 5

FILE NAME: R4292-01.DWG

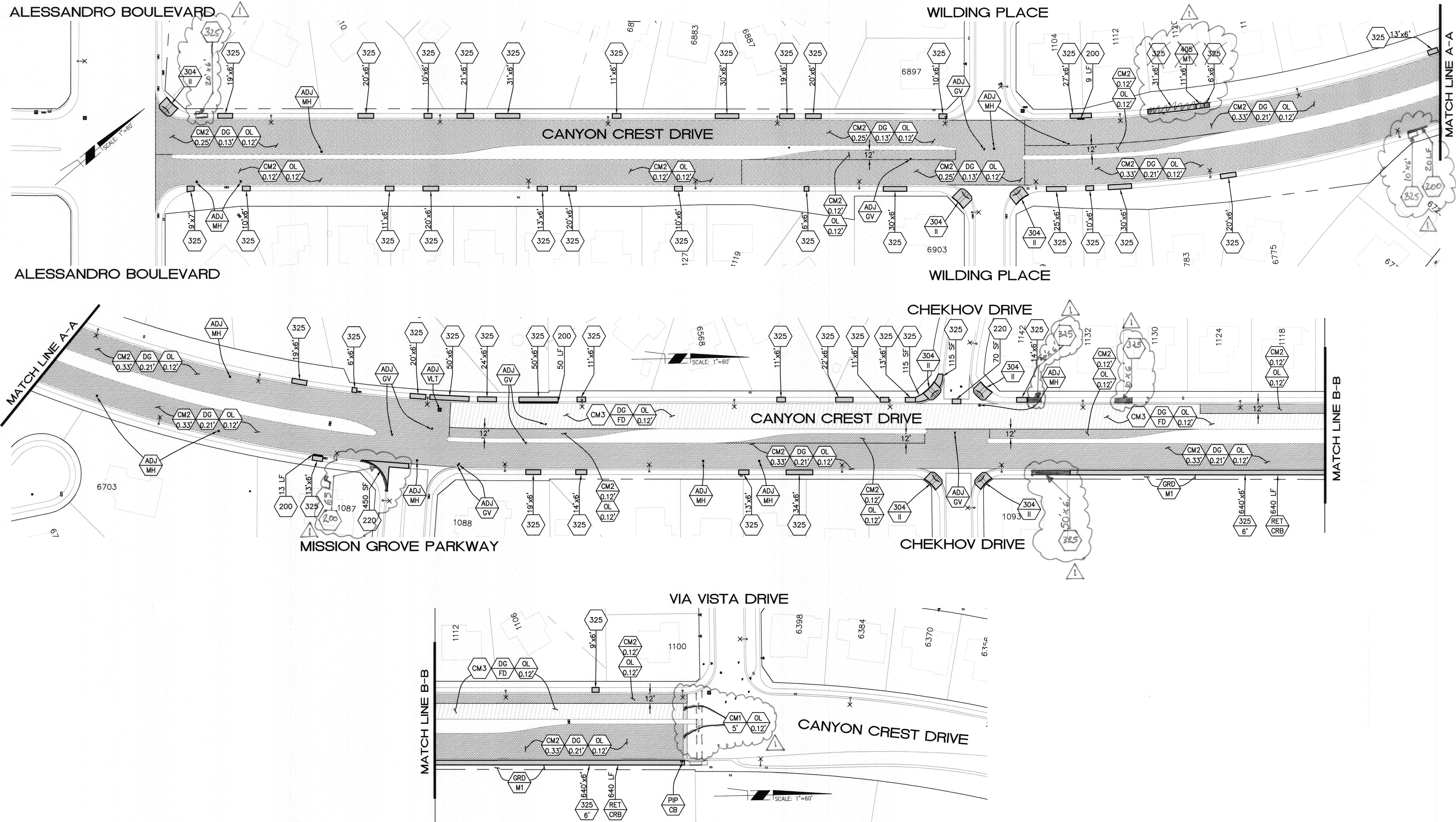

NOTE:

** ALL UTILITY FACILITIES SHALL BE ADJUSTED TO GRADE AND PAINTED, UNLESS OTHERWISE NOTED, WITHIN NEW DGAC AREAS. **

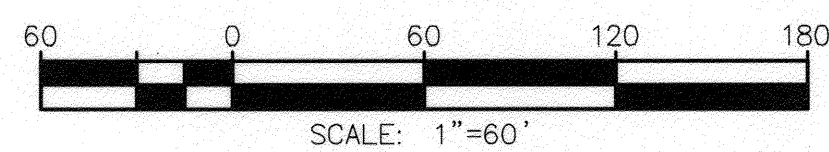

Under Ground Service Alert of Southern California
 Call: TOLL FREE 1-800-227-2600
 TWO WORKING DAYS BEFORE YOU DIG

ENGINEER IN RESPONSIBLE CHARGE
 Edward Lara
 R.C.E. No. 63753 EXPIRES: 9-30-14
 DATE: August 14, 2014

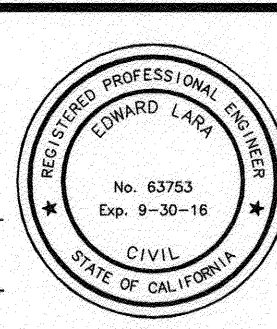

MARK	REVISIONS	APPR.	DATE
Δ	Revised Per AS-Built (15-1103)	R-1	8/12/14

CITY OF RIVERSIDE, CALIFORNIA DEPARTMENT OF PUBLIC WORKS			
APPROVED BY	BY	DATE	APPROVED BY
ENGINEERING MANAGER	EM	8/11/14	CITY ENGINEER
CONSTRUCTION ADMIN.	DC	8/22/14	
TRAFFIC DIVISION	TH	8.21.14	
SURVEY			
STREETS			

STREET MAINTENANCE	
2014/2015 ARTERIAL STREETS MAINTENANCE	
CANYON CREST DRIVE, SPRUCE STREET, AND MAIN STREET	
CANYON CREST DRIVE (ALESSANDRO-VIA VISTA)	
HORIZ. SCALE: 1"=60'	VERT. SCALE: NA

DESIGN WORK ORDER NO.: 1501755	CONSTR. WORK ORDER NO.: 1422360
R-4292	
SHEET 2 OF 5	
FILE NAME: R4292-02.DWG	

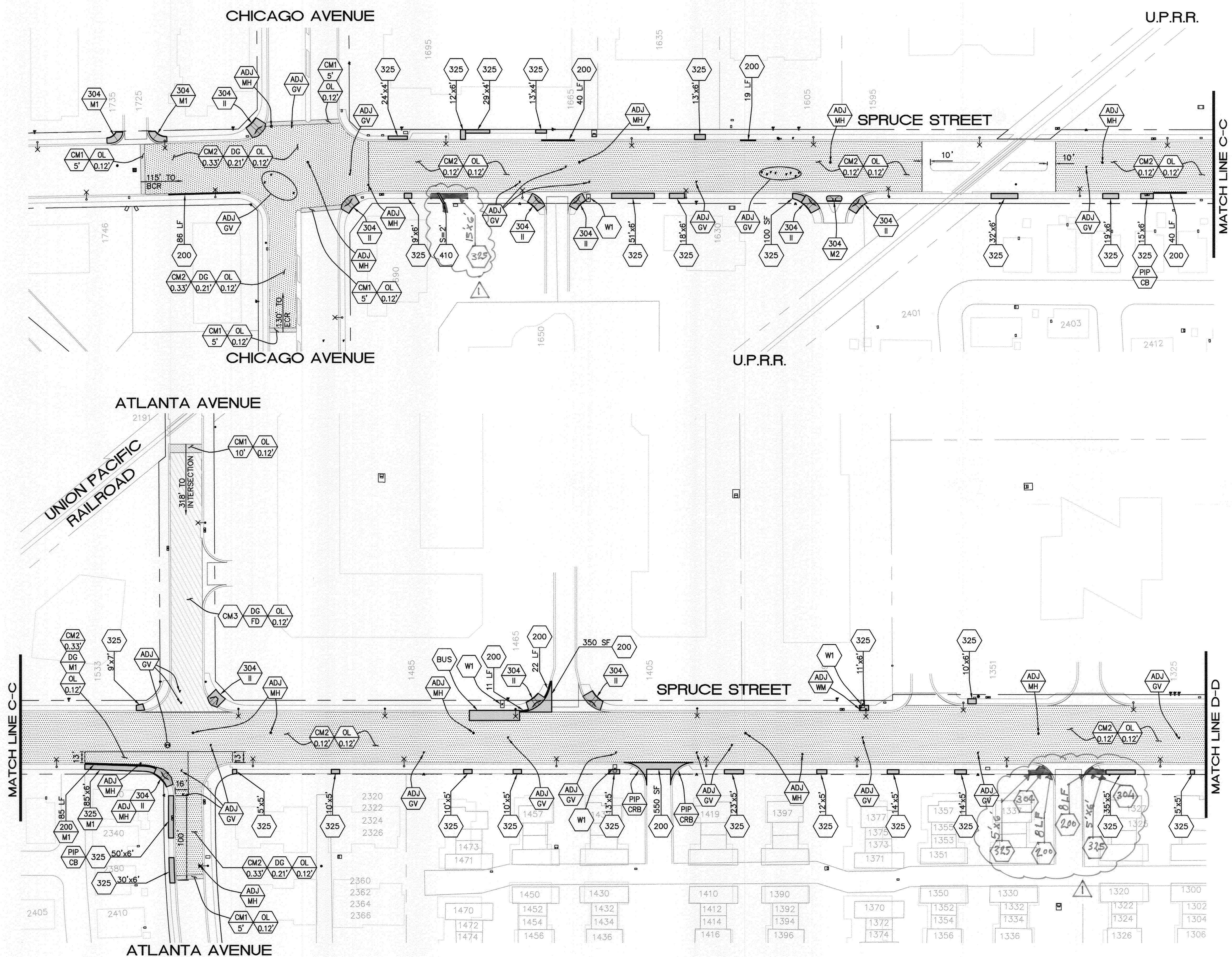

NOTE:
 ** ALL UTILITY FACILITIES SHALL BE ADJUSTED TO GRADE AND PAINTED, UNLESS OTHERWISE NOTED, WITHIN NEW DGAC AREAS. **

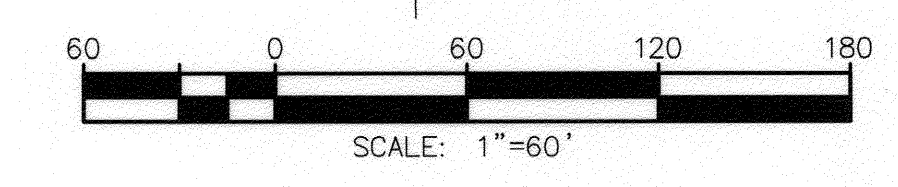

Under Ground Service Alert
 of Southern California
 Call: TOLL FREE
1-800-227-2600
TWO WORKING DAYS BEFORE YOU DIG

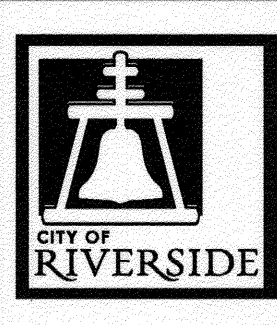

ENGINEER IN RESPONSIBLE CHARGE
Edward Lara
 Edward Lara
 R.C.E. No. 63753 EXPIRES: 9-30-14
 DATE: August 14, 2014

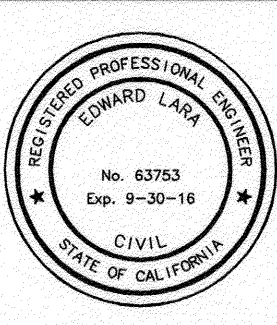

MARK	REVISIONS	APPR.	DATE
	Revised Per As-Built (15-1103)		

CITY OF RIVERSIDE, CALIFORNIA DEPARTMENT OF PUBLIC WORKS			
APPROVED BY	BY	DATE	APPROVED BY
ENGINEERING MANAGER	FM	8/15/14	
CONSTRUCTION ADMIN.	AC	8/22/14	
TRAFFIC DIVISION	ES	8-21-14	
SURVEY		8/22/14	
STREETS			

STREET MAINTENANCE
 2014/2015 ARTERIAL STREETS
 MAINTENANCE
 CANYON CREST DRIVE, SPRUCE STREET,
 AND MAIN STREET
 SPRUCE STREET (CHICAGO AVE - IOWA AVE)
 HORIZ. SCALE: 1"=60' VERT. SCALE: NA

DESIGN WORK ORDER NO.: 1501755
 CONSTR. WORK ORDER NO.: 1422360
R-4292
 SHEET **3** OF **5**
 FILE NAME: R4292-03.DWG

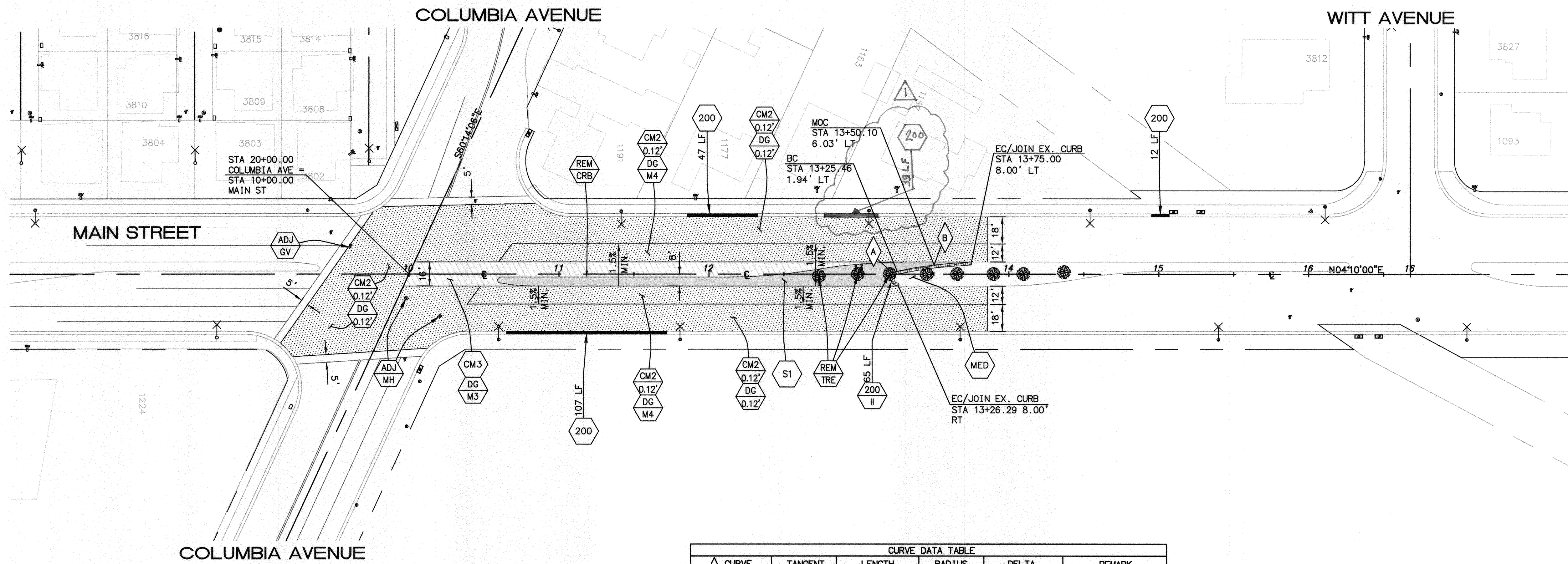

CURVE DATA TABLE					
◇ CURVE	TANGENT	LENGTH	RADIUS	DELTA	REMARK
A	60.27'	14.88'	5.00'	170°30'52"	MEDIAN NOSE
B	25.05'	49.97'	290.85'	09°50'38"	MEDIAN N'LY CURB

NOTE:

** ALL UTILITY FACILITIES SHALL BE ADJUSTED TO GRADE AND PAINTED, UNLESS OTHERWISE NOTED, WITHIN NEW DGAC AREAS. **

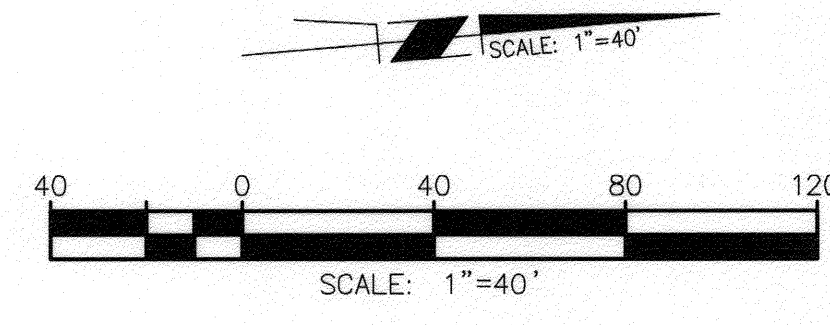

Under Ground Service Alert of Southern California
Call: TOLL FREE 1-800-227-2600
TWO WORKING DAYS BEFORE YOU DIG

ENGINEER IN RESPONSIBLE CHARGE
Edward Lara
Edward Lara
R.C.E. No. 63753 EXPIRES: 9-30-14
DATE *August 14, 2014*

CITY OF RIVERSIDE, CALIFORNIA
DEPARTMENT OF PUBLIC WORKS

APPROVED BY: *Fm* BY: *DC* DATE: *8/15/14*
CONSTRUCTION ADMIN. *8/22/14*
TRAFFIC DIVISION *P. 21-14*
SURVEY *8/22/14*

DESIGNED BY: *RO* DRAWN BY: *RO* CHECKED BY: *EL*

STREET MAINTENANCE
2014/2015 ARTERIAL STREETS MAINTENANCE
CANYON CREST DRIVE, SPRUCE STREET, AND MAIN STREET

APPROVED BY: *[Signature]*
CITY ENGINEER

DATE: *8/22/2014*

DESIGN WORK ORDER NO.: 1501755
CONSTR. WORK ORDER NO.: 1422360

R-4292

SHEET **5** OF **5**

FILE NAME: R4292-05.DWG