

GENERAL CONSTRUCTION NOTES:

- 1 THE CONTRACTOR SHALL PROVIDE AND MAINTAIN TRAFFIC AS INDICATED IN THE ASSOCIATED PROJECT SPECIAL PROVISIONS.
- 2 CONSTRUCTION SHALL BE IN ACCORDANCE WITH THE CITY OF RIVERSIDE STANDARD DRAWINGS AND STANDARD SPECIFICATIONS FOR PUBLIC WORKS CONSTRUCTION, 2012 EDITION.
- 3 EXISTING UTILITIES SHOWN ON THIS PLAN ARE PLOTTED FROM UTILITY RECORDS. THE CONTRACTOR IS REQUIRED TO TAKE DUE PRECAUTIONARY MEASURES TO LOCATE AND PROTECT ALL UTILITIES WHETHER OR NOT SHOWN ON THIS PLAN.
- 4 CONFLICTING UTILITIES SHOWN WITHIN CONSTRUCTION AREA WILL BE RELOCATED PRIOR TO CONSTRUCTION.
- 5 ALL STREET PULL BOXES, GATE VALVES, MANHOLES, ETC, AFFECTED BY CONSTRUCTION, SHALL BE ADJUSTED TO THE PROPOSED GRADE.
- 6 PRIME CONTRACTOR BIDDING THIS WORK SHALL HAVE A CLASS "A" OR "C-12".
- 7 THE SEAM BETWEEN PASSES OF THE AC OVERLAY SHALL COINCIDE, AS CLOSE AS POSSIBLE, TO THE LANE LINES.
- 8 COLD MILLING SHALL BE AS DESCRIBED ON THE PLANS AND SPECIAL PROVISIONS OR AS DIRECTED BY THE ENGINEER.
- 9 ANY DISTRESSED EXISTING PAVEMENT SHALL BE REMOVED AND REPLACED AS DIRECTED BY THE ENGINEERING AFTER COLD-MILLING AND PRIOR TO PLACEMENT OF DGAC.
- 10 CONTRACTOR SHALL REMOVE ALL VEGETATION WITHIN ALL SIDEWALK PANELS WITHIN THE PROJECT LIMITS.
- 11 ALL EXISTING IMPROVEMENTS INCLUDING, BUT NOT LIMITED TO, CURB GUTTERS, CROSS GUTTERS, SIDEWALK, DRIVEWAYS, PARKWAY CULVERTS, INLETS, ETC, SHALL BE PROTECTED IN PLACE UNLESS OTHERWISE NOTED.
- 12 EXISTING IRRIGATION SHALL BE PROTECTED OR MODIFIED, INCLUDING FURNISHING NEW MATERIALS, AS NECESSARY TO CONSTRUCT NEW CONCRETE IMPROVEMENTS.
- 13 ALL FENCE POSTS SHALL BE PROTECTED OR MODIFIED AS NECESSARY IF POST FOUNDATION IS WITHIN A SIDEWALK PANEL THAT HAS BEEN CALLED OUT FOR REPLACEMENT.
- 14 FOR ALLEY WAY DRIVEWAY APPROACHES, CONTRACTOR SHALL CONSTRUCT AC PAVEMENT OVERLAY BEHIND DRIVEWAYS TO PROVIDE ADEQUATE FLOW LINES.
- 15 ADEQUATE FLOW LINES SHALL BE MAINTAINED AT ALL LOCATIONS.

CONSTRUCTION NOTES:

- ADJ. ADJUST TO GRADE, DESCRIPTION PER PLAN: (MH) MANHOLE, (GV) GATE VALVE, (WM) WATER METER, (PB) PULLBOX, (ETS) ELECTRICAL TESTING STATION, (CO) CLEAN OUT, (VLT) VAULT.
- PIP. PROTECT IN PLACE, DESCRIPTION PER PLAN: (MH) MANHOLE, (GV) GATE VALVE, (WM) WATER METER, (PB) PULLBOX, (SL) STREET LIGHT, (MB) MAILBOX, (PP) POWER POLE, (CB) CATCH BASIN, (GUT) CROSS GUTTER & SPANDREL UNLESS OTHERWISE NOTED, (SPN) SPANDREL, (BRM) AC BERM.
- CM1. 0.12" MIN. DEPTH LINEAR COLD MILL OF EXISTING AC PAVEMENT. AT LOCATIONS SPECIFIED TO RECEIVE ARAM, PROVIDE VARIABLE DEPTH COLDMILLING TO TRANSITION FROM 0.15" AT GUTTER LIP/JUNCTION TO DEPTH AT THE MILL WIDTH INDICATED. (XX) = WIDTH OF LINEAR COLD MILL AS INDICATED ON PLANS.
- CM2. VARIABLE AREA COLD MILL OF EXISTING AC PAVEMENT. (XX) = DEPTH OF VARIABLE AREA COLD MILL AS INDICATED ON PLANS.
- CM3. FULL-DEPTH COLD MILL OF AC PAVEMENT TO EXISTING BASE OR SUBGRADE AND REPLACE WITH NEW DGAC PAVEMENT. CONTRACTOR TO REMOVE EXISTING BASE/SUBGRADE AS NECESSARY TO CONSTRUCT THE REQUIRED PAVEMENT DEPTH.
- ARAM. CONSTRUCT ASPHALT RUBBER AND AGGREGATE MEMBRANE.
- SLR. CONSTRUCT SLURRY SEAL, TYPE II.
- DG. OVERLAY DGAC PAVEMENT. REPLACEMENT DEPTH SHALL MATCH AC THICKNESS TO BE REMOVED UNLESS OTHERWISE NOTED. 0.12 MIN. OR AS INDICATED ON THE PLAN.
- 302. CONSTRUCT DRIVEWAY PER CITY STD 302 WITH THE FOLLOWING MODIFICATION (XX): (M1) CONSTRUCT PARTIAL DRIVEWAY TO MATCH EXISTING DRIVEWAY TYPE, DIMENSIONS, AND GRADE. PROTECT IN PLACE EXISTING C&G, SIDEWALK, AND DRIVEWAY. (M2) = CONTRACTOR SHALL SAWCUT THE EXISTING DRIVEWAY AT THE FIRST SCORE LINE LOCATED ON PRIVATE PROPERTY AND RECONSTRUCT THE DRIVEWAY TO STRAIGHT GRADE UP TO THE BACK OF NEW DRIVEWAY APPROACH. (M3) = AT 10347 JORDAN DR, CONTRACTOR SHALL SAWCUT THE EXISTING DRIVEWAY AT APPROXIMATELY 9' BEHIND THE DRIVEWAY AND CONSTRUCT THE DRIVEWAY PER CITY STANDARD. CONTRACTOR SHALL ALSO REMOVE THE TREE STUMP BY THE MAILBOX AND BACKFILL WITH TOPSOIL TO MATCH EXISTING GRADE. (M4) = AT 11250 YEARLING ST., CONTRACTOR SHALL SAWCUT THE EXISTING DRIVEWAY AT APPROXIMATELY 11' BEHIND THE DRIVEWAY. CONTRACTOR SHALL PROTECT IN PLACE EXISTING STAMPED CONCRETE BRICKS AND CONSTRUCT VARIABLE HEIGHT RETAINING CURBS AROUND IT MONOLITHICALLY WITH THE NEW DRIVEWAY MATCH UP. (M5) = AT 2965 Balfore St., CONTRACTOR SHALL COORDINATE WITH THE ENGINEER PRIOR TO STARTING CONSTRUCTION.
- 304. CONSTRUCT PEDESTRIAN RAMP PER CITY STD 304 WITH THE FOLLOWING TYPE: (I) = TYPE I, (II) = TYPE II, (II-A) = TYPE II-A, (III) = TYPE III, (IV) = TYPE IV, (V) = TYPE V, (VI) = TYPE VI, (VI) = TYPE VII. (M1) = CONSTRUCT TYPE II-A RAMP PER CITY STD 304. IF THE RETAINING CURB CANNOT BE BUILT DUE TO INTERFERENCE FROM EXISTING CONDITIONS, CONTRACTOR SHALL SHORTEN THE TOP OF LANDING FROM 4' TO 3.5' TO ACCOMMODATE THE RETAINING CURB WITHIN THE SIDEWALK. (M2) = CONSTRUCT TYPE I RAMP PER CITY STD 304 AND REPLACE BOTH WINGS WITH VARIABLE RETAINING CURBS.
- 325. CONSTRUCT SIDEWALK PER CITY STD 325 WITH THE FOLLOWING MODIFICATION (XX): (M1) = CONSTRUCT PROPERTY LINE SIDEWALK WITH THICKNESS OF 6".
- BUS. BUS PAD SHALL BE CONSTRUCTED TO THE DIMENSIONS SHOWN ON THE PLAN (MINIMUM 60' LONG UNLESS OTHERWISE NOTED AND 12' WIDE MEASURED FROM MONOLITHIC CURB FACE). BASE OR SUBGRADE SHALL BE REMOVED AND COMPACTED AS NECESSARY TO INSTALL BUS PAD PER DETAIL IN PART 10 OF THE SPECIAL PROVISIONS.
- SPD. CONSTRUCT 14" WIDE LOCAL SPEED HUMP PER DETAIL IN PART 10 OF THE SPECIAL PROVISIONS.
- REMA. CONTRACTOR SHALL FULLY REMOVE TREE TRUNK, STUMP, AND ROOTS TO ONE FOOT BELOW FINISHED SURFACE.

RIVERSIDE CALIFORNIA

PUBLIC WORKS DEPARTMENT

2014/2015 MINOR STREETS

MAINTENANCE, PHASE 1

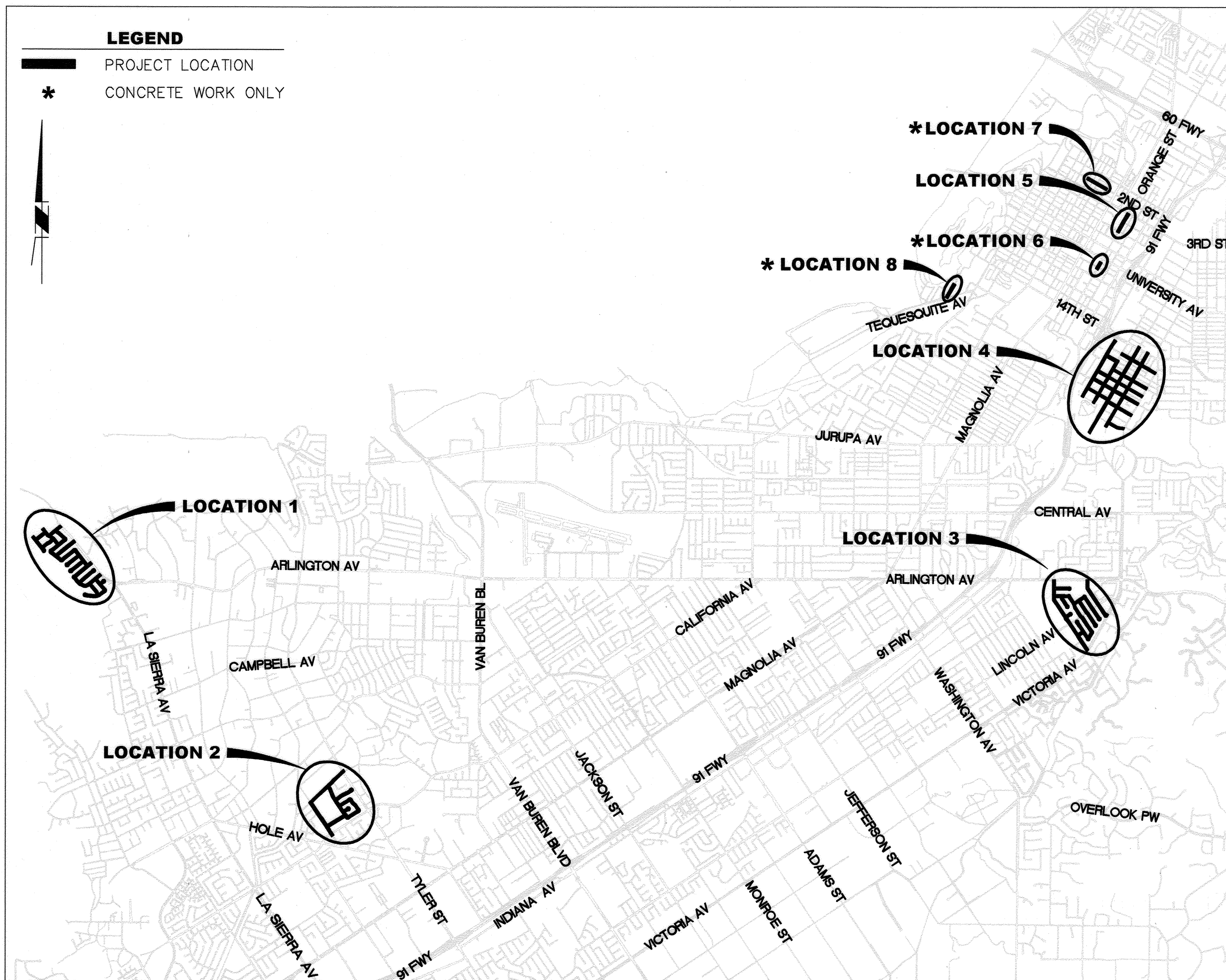
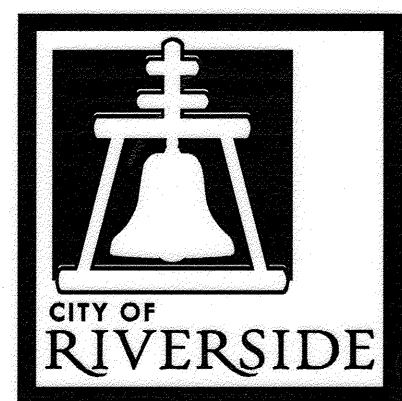

LEGEND:

- CM1 + AC TREATMENT AS INDICATED
- CM2 + AC TREATMENT AS INDICATED
- CM3 + AC TREATMENT AS INDICATED
- SLURRY AND/OR ARAM
- PROPOSED PCC

EXISTING TOPOGRAPHY:

- Sanitary Sewer M.H.
- Storm Drain M.H.
- Electric M.H.
- Water M.H.
- Gate Valve
- Electrical Test Station (Gas)
- Fire Hydrant

SIGNING AND STRIPING GENERAL NOTES:

1. SIGNING AND STRIPING INSTALLATIONS SHALL CONFORM TO THE CALIFORNIA MANUAL ON UNIFORM TRAFFIC CONTROL DEVICES (CA MUTCD) THE STATE OF CALIFORNIA DEPARTMENT OF TRANSPORTATION (CALTRANS) STANDARD PLANS AND SPECIFICATIONS DATED 2010, AND ALL ADDENDUMS THERETO, AND THE CITY OF RIVERSIDE PUBLIC WORKS DEPARTMENT STANDARD DRAWINGS, CURRENT EDITION.
2. ALL STRIPING, MARKINGS, AND LEGENDS SHALL BE REFLECTORIZED THERMOPLASTIC UNLESS 1 OTHERWISE NOTED. THE CONTRACTOR SHALL PROVIDE AND INSTALL RAISED PAVEMENT MARKERS FOR ALL STRIPING, STRIPING MARKINGS AND LEGENDS SHALL CONFORM TO THE 2010 CALTRANS STANDARD PLANS A20A THRU A20D AND A24A THRU A24E.
3. PRIOR TO FINAL ACCEPTANCE OF STREET IMPROVEMENTS, ALL PAVEMENT STRIPING AND STENCILING CONDITION, IN A MANNER MEETING THE APPROVAL OF THE CITY OF RIVERSIDE.
4. THE CONTRACTOR SHALL RE-STRIP EXISTING STRIPING AND CURB MARKINGS OBLITERATED BY NEW CONSTRUCTION, WHETHER OR NOT SHOWN ON THE PLANS FOR REPLACEMENT, AT NO COST TO THE CITY.
5. AT LOCATIONS WHERE EXISTING PAINTED CURB IS TO BE RECONSTRUCTED, THE CONTRACTOR SHALL PAINT THE NEW CURB AS SHOWN ON THE PLANS WITHIN 10 WORKING DAYS OF CURB CONSTRUCTION OR AS DIRECTED BY ENGINEER. THE PAINT SHALL BE WATER-BASED WITH 2-YEAR GUARANTEE AGAINST COLOR FADING. PRIOR TO THE START OF CONSTRUCTION, THE CONTRACTOR SHALL SUBMIT TO THE CITY WRITTEN PROOF OF THE MANUFACTURER'S 2-YEAR GUARANTEE.
6. ALL NEW STRIPING SHALL BE "CAT TRACKED" AND APPROVED BY THE ENGINEER PRIOR TO FINAL INSTALLATION. THE CONTRACTOR SHALL NOTIFY THE ENGINEER AFTER COMPLETING LAYOUT AND AT LEAST 3 WORKING DAYS BEFORE COMMENCING INSTALLATION OF STRIPING, MARKINGS AND MARKERS.
7. TRAFFIC SIGN FACE SHALL BE 3M DIAMOND GRADE DG3 REFLECTIVE SHEETING (ASTM XI) OR APPROVED EQUAL WITH PROTECTIVE GRAFTITI OVERLAY FILM OR AS OTHERWISE NOTED.
8. ALL WARNING SIGNS SHALL HAVE A FLUORESCENT YELLOW BACKGROUND AND SCHOOL SIGNS NOTED SHALL HAVE A FLUORESCENT YELLOW-GREEN BACKGROUND.
9. SIGNS SHALL BE STANDARD SIZE UNLESS NOTED OTHERWISE. PRIOR TO INSTALLATION, NEW SIGNS SHALL BE APPROVED BY THE CITY OF RIVERSIDE. EXACT LOCATIONS OF SIGNS SHALL BE DETERMINED BY THE CITY ENGINEER.
10. SALVAGED SIGNS AND SIGN POSTS SHALL BE DELIVERED TO THE CITY OF RIVERSIDE SIGN DEPARTMENT.
11. STRIPING SHALL BE APPLIED WITHIN 48 HOURS OF SURFACE COURSE REPLACEMENT ON STREETS OPEN TO THE PUBLIC. IN NO CASE SHALL A NEWLY PAVED STREET OPEN TO THE PUBLIC BE LEFT UNSTRIPED OVER A WEEKEND OR HOLIDAY.
12. CONTRACTOR SHALL INSTALL NEW SIGN(S) AND/OR POST(S) PER CITY OF RIVERSIDE STANDARD DRAWING No. 664, SEE SPECIFICATIONS.
13. CONTRACTOR SHALL INSTALL NEW STREET NAME SIGNS AND POST PER CITY OF RIVERSIDE STANDARD DRAWING No. 662, SEE SPECIFICATIONS.
14. ALL EXISTING STRIPING, PAVEMENT MARKINGS, LEGENDS, AND RAISED PAVEMENT MARKERS SHALL BE REMOVED EVEN IF NOT SHOWN ON PLANS. REMOVALS OF PAINTED STRIPING, PAVEMENT MARKINGS AND LEGENDS SHALL BE DONE BY WET SANDBLASTING. REMOVALS OF THERMOPLASTIC STRIPING, PAVEMENT MARKINGS AND LEGENDS SHALL BE REMOVED BY WET SANDBLASTING, GRINDING OR OTHER APPROVED METHOD AND SHALL NOT DAMAGE THE PAVEMENT. "BLACK OUT" OF EXISTING DELINEATION IS NOT PERMITTED. ALL DAMAGED PAVEMENT DUE TO REMOVALS SHALL BE REPAIRED AS NECESSARY TO MAINTAIN A SMOOTH AND UNIFORM SURFACE OR AS DIRECTED BY THE ENGINEER. ALL STRIPING REMOVALS AND LEGENDS SHALL BE "FOG SEALED".
15. WHERE APPLICABLE, OUTBOUND LANE LINE DETAILS SHALL COMMENCE AT THE CROSSWALK, MEANING THE PAINTED PORTION OF THE DETAIL SHALL JOIN THE CROSSWALK.

SHEET INDEX: STREET IMPROVEMENTS (R-4299)

| SHEET NO. | DESCRIPTION |
|-----------|--|
| 1. | TITLE SHEET AND NOTES |
| 2. | LOCATION 1 (FAIRHAVEN DR, MERIDIAN WY, AINSLEY AV, MEAGAN LN, SWENSON ST, BENTLEY ST, CADBURY DR, YEARLING ST, COOLWATER DR, SPRINGFIELD ST, BUFFALO DR) |
| 3. | LOCATION 1 (SPRINGFIELD ST, PLATTE DR, SWEETWATER DR, HEATHCLIFF DR, TABBIE CT, SIAMSE PL, BLACKBERRY PL, AND CATSPA W DR) |
| 4. | LOCATION 2 (MOBLEY AV, COOK AV, MEREDITH ST, AND ADRIANA AV) |
| 5. | LOCATION 2 (MOBLEY AV, BRANIGAN WY, MEREDITH ST, JORDAN DR, KENYON CT, AND JUPITER DR) |
| 6. | LOCATION 3 (HORACE ST, HAVERHILL CT, WESTRIDGE RD, LUCERNE PL, DUQUESNE ST, BALFORE ST, SANDBERG ST, AND BELHAVEN PL) |
| 7. | LOCATION 3 (HORACE ST, SALMEN WY, MOORGATE PL, WESTRIDGE RD, SANBERG ST, BALFORE ST, AND ANNA ST) |
| 8. | LOCATION 4 (DENTON ST, PROSPECT AV, PLEASANT ST, COMMERCE ST, COTTAGE ST, HOWARD AV, AND PARK AV) |
| 9. | LOCATION 4 (DATES ST, CRIDGE ST, COMMERCE ST, HOWARD AV, AND PARK AV) |
| 10. | LOCATION 5 (ORANGE ST) |
| 11. | LOCATION 4 (DENTON ST, PROSPECT AV, PLEASANT ST, COTTAGE ST, GROVE AV, AND FOREST ST) |
| 11. | LOCATION 4 (WOODBINE ST, DATES ST, CRIDGE ST, AND GROVE AV) |

ADDITIONAL PROJECT LOCATIONS (1)

- LOCATION 6 POST OFFICE AT 3890 ORANGE STREET (BETWEEN UNIVERSITY AND 9TH STREET). CONTRACTOR SHALL CONSTRUCT PER THE "DOWNTOWN POST OFFICE EXHIBIT" IN PART 10 OF THE SPECIAL PROVISIONS. GENERAL WORK INCLUDES R&R OF APPROXIMATELY 2,885 SF OF SIDEWALK, 145 LF OF CURB AND GUTTER, 1 PEDESTRIAN RAMP, 6 TREE STUMPS REMOVAL, 4 24" PLANTER BOX KOELREUTERIA BIPINNATA, 32 1 GALLON STAR JASMINE, AND MODIFY EXISTING / INSTALL NEW IRRIGATION SYSTEM. **DO NOT REMOVE ONE TREE LOCATED ON PRIVATE PROPERTY**
- LOCATION 7 2ND STREET BETWEEN BROCKTON AVENUE AND FAIRMOUNT BLVD. GENERAL WORK INCLUDES R&R OF APPROXIMATELY 600 LF OF CURB AND GUTTER, 132 SF OF CROSS GUTTER (6'X22'), 250 SF OF ALLEY WAY DRIVEWAY, AND 80 SF OF M1 SIDEWALK WITH 6" THICKNESS. EXACT LOCATIONS WILL BE MARKED BY THE ENGINEER PRIOR TO THE START OF THE CONSTRUCTION.
- LOCATION 8 SAN ANDREAS AVENUE BETWEEN TEQUESQUITE AVENUE AND GLENWOOD DRIVE. GENERAL WORK INCLUDES APPROXIMATELY 5,275 SF OF NEW SIDEWALK, R&R OF 1,150 SF OF SIDEWALK, 247 SF OF DRIVEWAY, 28 LF OF CURB AND GUTTER, AND MODIFY EXISTING / INSTALL NEW IRRIGATION SYSTEM.

NOTE (1): CONCRETE MAINTENANCE WORK ONLY

STRIPING PLAN INDEX

| PLAN NO. | NO. OF SHEETS | DESCRIPTION |
|----------|---------------|-------------|
| XL-730 | 1-4 | LOCATION 4 |
| | 5 | LOCATION 5 |
| | 6-7 | LOCATION 2 |
| | 8-10 | LOCATION 1 |
| | 11-13 | LOCATION 3 |

Under Ground Service Alert of Southern California
Call: TOLL FREE 1-800-227-2600
TWO WORKING DAYS BEFORE YOU DIG

ENGINEER IN RESPONSIBLE CHARGE
Edward Lara
Edward Lara
R.C.E. No. 63753 EXPIRES: 9-30-16
DATE December 15, 2014

CITY OF RIVERSIDE, CALIFORNIA
DEPARTMENT OF PUBLIC WORKS

APPROVED BY: *Em* DATE: 12/19/14
CONSTRUCTION ADMIN. OC DATE: 12/19/14
TRAFFIC DIVISION SH DATE: 12-18-14
STREETS DIVISION
SUBMITTED

STREET MAINTENANCE

2014/2015 MINOR STREETS MAINTENANCE, PHASE 1

TITLE SHEET AND NOTES

HORIZ. SCALE: NA VERT. SCALE: NA

DESIGN WORK ORDER NO.: 1423500
CONSTR. WORK ORDER NO.: 1423501

R-4299

SHEET 1 OF 11

FILE NAME: R4291-01.DWG

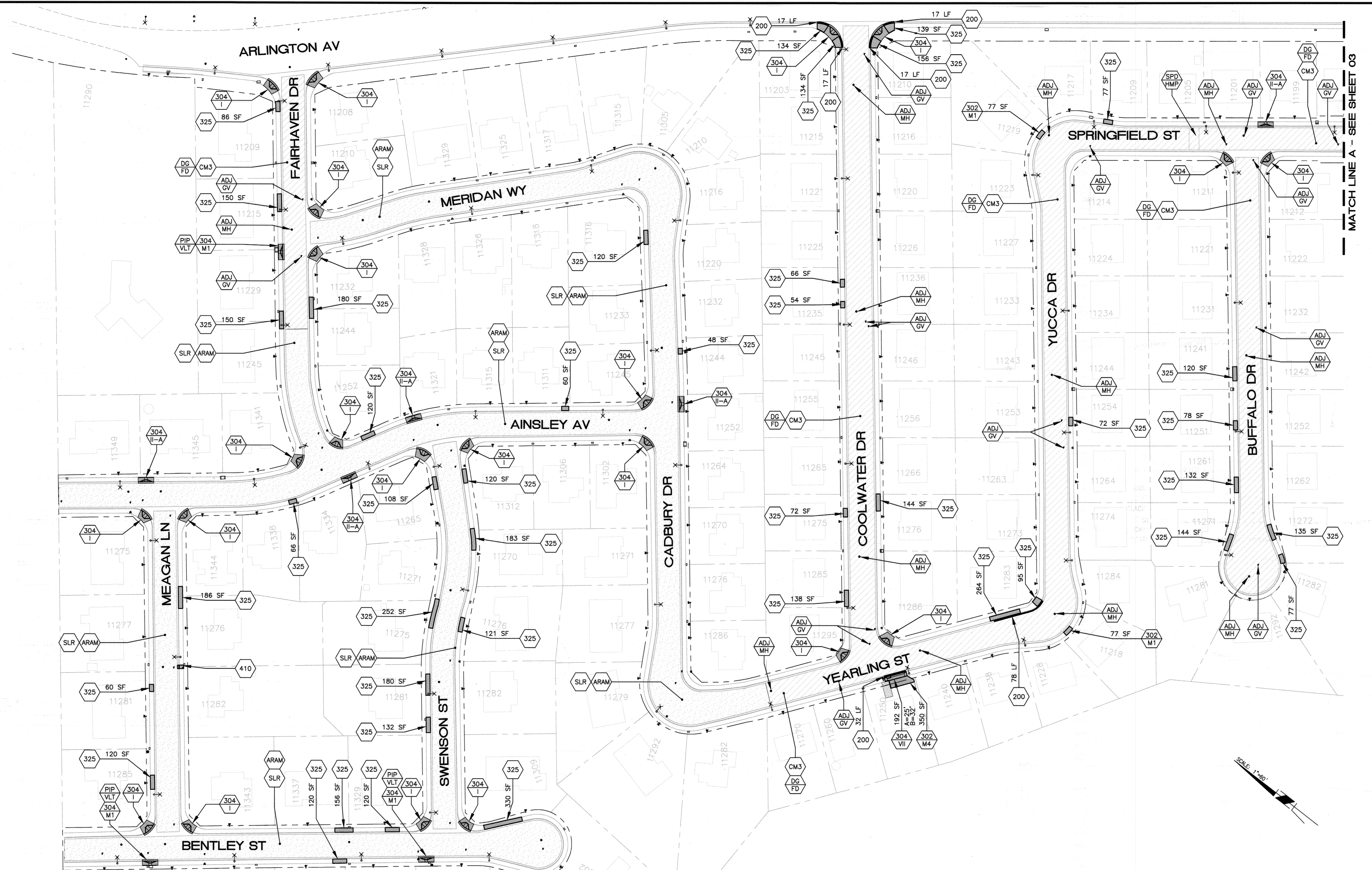

MATCH LINE A - SEE SHEET 03

NOTE: SEE SHEET XL-730 FOR SIGN AND STRIPING IMPROVEMENTS REFERENCED HEREON.

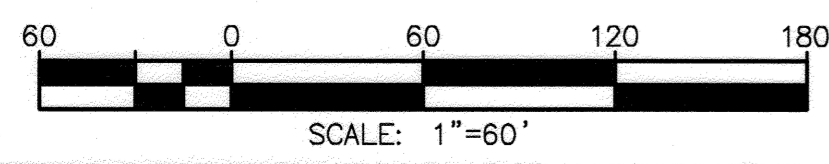

Under Ground Service Alert
 of Southern California
 Call: TOLL FREE
1-800-227-2600
TWO WORKING DAYS BEFORE YOU DIG

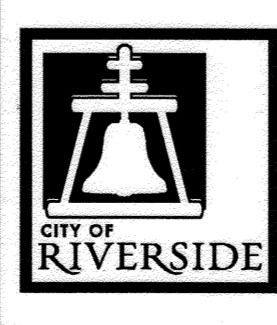

ENGINEER IN RESPONSIBLE CHARGE
Edward Lara
 Edward Lara
 R.C.E. No. 63753 EXPIRES: 9-30-16
 DATE: *December 18, 2014*



| MARK | REVISIONS | APPR. | DATE |
|------|-----------|-------|------|
| | | | |
| | | | |
| | | | |

CITY OF RIVERSIDE, CALIFORNIA
DEPARTMENT OF PUBLIC WORKS

| | | | |
|---|---|---|--|
| APPROVED BY ENGINEERING MANAGER CONSTRUCTION ADMIN. TRAFFIC DIVISION | BY <i>FN</i> <i>DC</i> <i>2014</i> | DATE <i>12/18/14</i> <i>12/18/14</i> <i>12-13-14</i> | APPROVED BY <i>Michael S. D.</i> CITY ENGINEER |
| DESIGNED BY: <i>TYH</i> | | DRAWN BY: <i>TYH</i> | |
| CHECKED BY: <i>EL</i> | | DATE: <i>12/18/14</i> | |

STREET MAINTENANCE
2014/2015 MINOR STREETS MAINTENANCE, PHASE 1
LOCATION 1
 HORIZ. SCALE: 1"=60' | VERT. SCALE: NA

DESIGN WORK ORDER NO.: 1423500
 CONSTR. WORK ORDER NO.: 1423501
R-4299
 SHEET **2** OF **11**
 FILE NAME: R4299-02.DWG

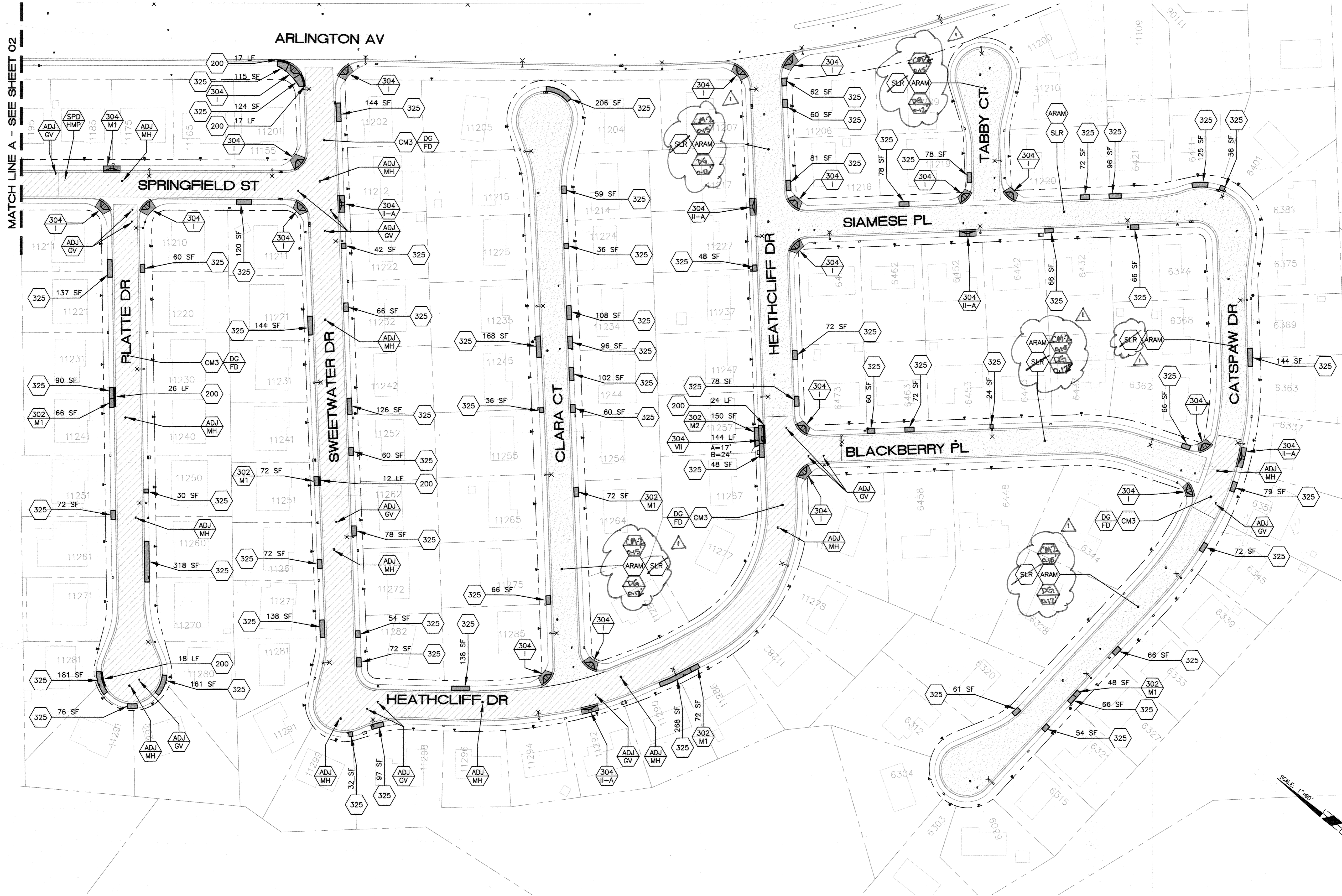

MATCH LINE A - SEE SHEET 02

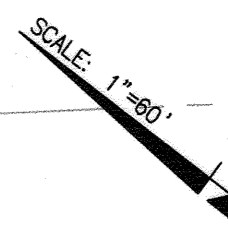

NOTE: SEE SHEET XL-730 FOR SIGN AND STRIPING IMPROVEMENTS REFERENCED HEREON.

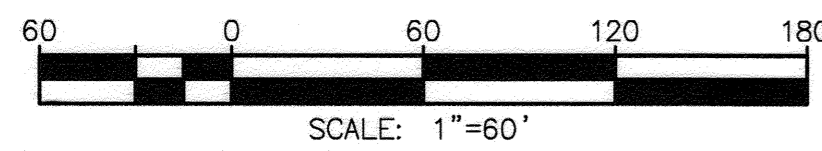

Under Ground Service Alert
 of Southern California
 Call: TOLL FREE 1-800-227-2600
 TWO WORKING DAYS BEFORE YOU DIG

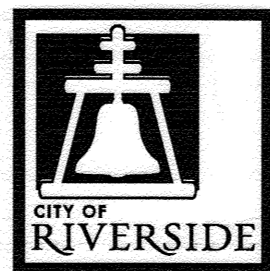

ENGINEER IN RESPONSIBLE CHARGE

 Edward Lara
 R.C.E. No. 63753 EXPIRES: 9-30-16
 DATE: December 18, 2014

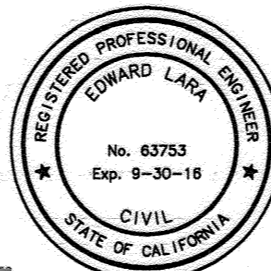

| | | | | | |
|--|-----|----------|-----|------------|----|
| DESIGNED BY | TYH | DRAWN BY | TYH | CHECKED BY | EL |
| APPROVED BY: ENGINEERING MANAGER CONSTRUCTION ADMIN. TRAFFIC DIVISION DATE: 12/18/14 | | | | | |

| | | | |
|---|----|----------|---------------|
| CITY OF RIVERSIDE, CALIFORNIA DEPARTMENT OF PUBLIC WORKS | | | |
| APPROVED BY | BY | DATE | APPROVED BY |
| CONSTRUCTION ADMIN. | EM | 12/18/14 | |
| TRAFFIC DIVISION | EL | 12-13-14 | CITY ENGINEER |
| DATE: 12/18/2014 | | | |

| | |
|--|-----------------|
| STREET MAINTENANCE | |
| 2014/2015 MINOR STREETS MAINTENANCE, PHASE 1 | |
| LOCATION 1 | |
| HORIZ. SCALE: 1"=60' | VERT. SCALE: NA |

DESIGN WORK ORDER NO.: 1423500
 CONSTR. WORK ORDER NO.: 1423501
R-4299
 SHEET **3** OF **11**
 FILE NAME: R4299-03.DWG

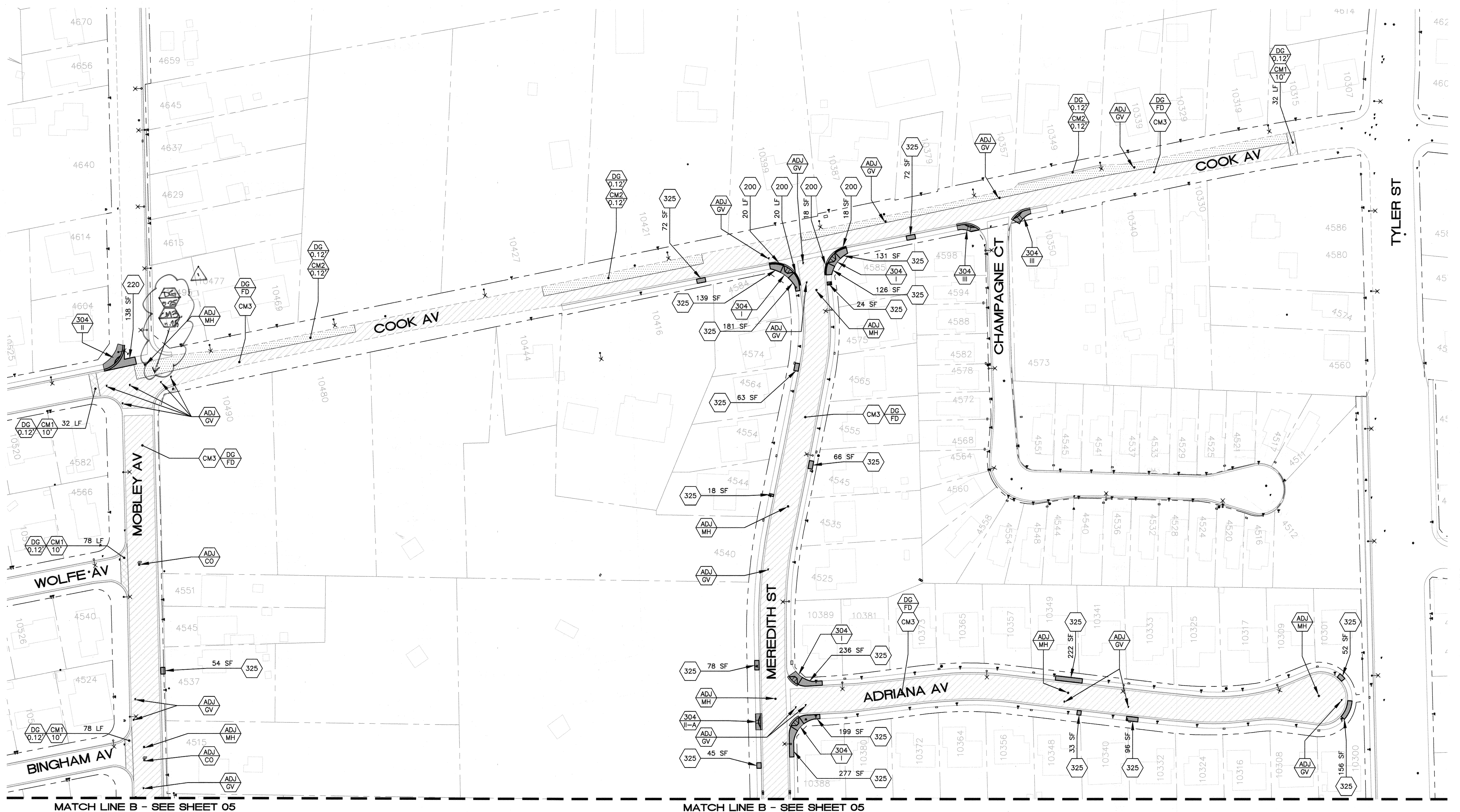

MATCH LINE B - SEE SHEET 05

MATCH LINE B - SEE SHEET 05

NOTE: SEE SHEET XL-730 FOR SIGN AND STRIPING IMPROVEMENTS REFERENCED HEREON.

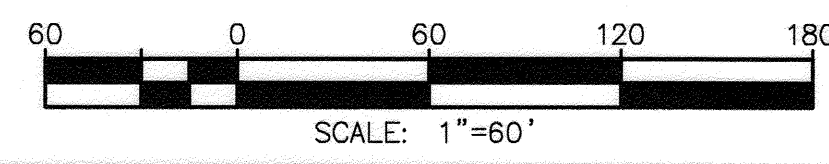

Under Ground Service Alert of Southern California
 Call: TOLL FREE 1-800-227-2600
 TWO WORKING DAYS BEFORE YOU DIG

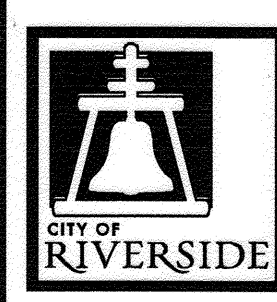

ENGINEER IN RESPONSIBLE CHARGE
Edward Lara
 Edward Lara
 R.C.E. No. 63753 EXPIRES: 9-30-16
 DATE: December 15, 2014

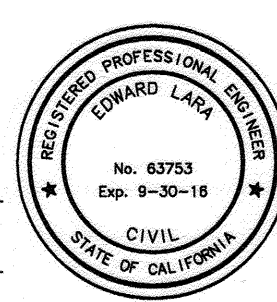

| | | | | | |
|--|-----|----------|-----|------------|----|
| DESIGNED BY | TYH | DRAWN BY | TYH | CHECKED BY | EL |
| AS-BUILT CHANGES REVISIONS: <i>EL</i> 12/18/14 APPR. DATE: 12-18-14 SURVEYOR | | | | | |

| | | | |
|---|------------|----------|--------------------|
| CITY OF RIVERSIDE, CALIFORNIA DEPARTMENT OF PUBLIC WORKS | | | |
| APPROVED BY | BY | DATE | APPROVED BY |
| ENGINEERING MANAGER | <i>Fm</i> | 12/18/14 | <i>Edward Lara</i> |
| CONSTRUCTION ADMIN. | <i>DC</i> | 12/18/14 | CITY ENGINEER |
| TRAFFIC DIVISION | <i>Kan</i> | 12-18-14 | |
| DATE | 12/19/2014 | | |

| | |
|--|-----------------|
| STREET MAINTENANCE | |
| 2014/2015 MINOR STREETS MAINTENANCE, PHASE 1 | |
| LOCATION 2 | |
| HORIZ. SCALE: 1"=60' | VERT. SCALE: NA |

| | |
|--------------------------------|---------------------------------|
| DESIGN WORK ORDER NO.: 1423500 | CONSTR. WORK ORDER NO.: 1423501 |
| R-4299 | |
| SHEET 4 OF 11 | |
| FILE NAME: R4299-04.DWG | |

MATCH LINE B - SEE SHEET 04

MATCH LINE B - SEE SHEET 04

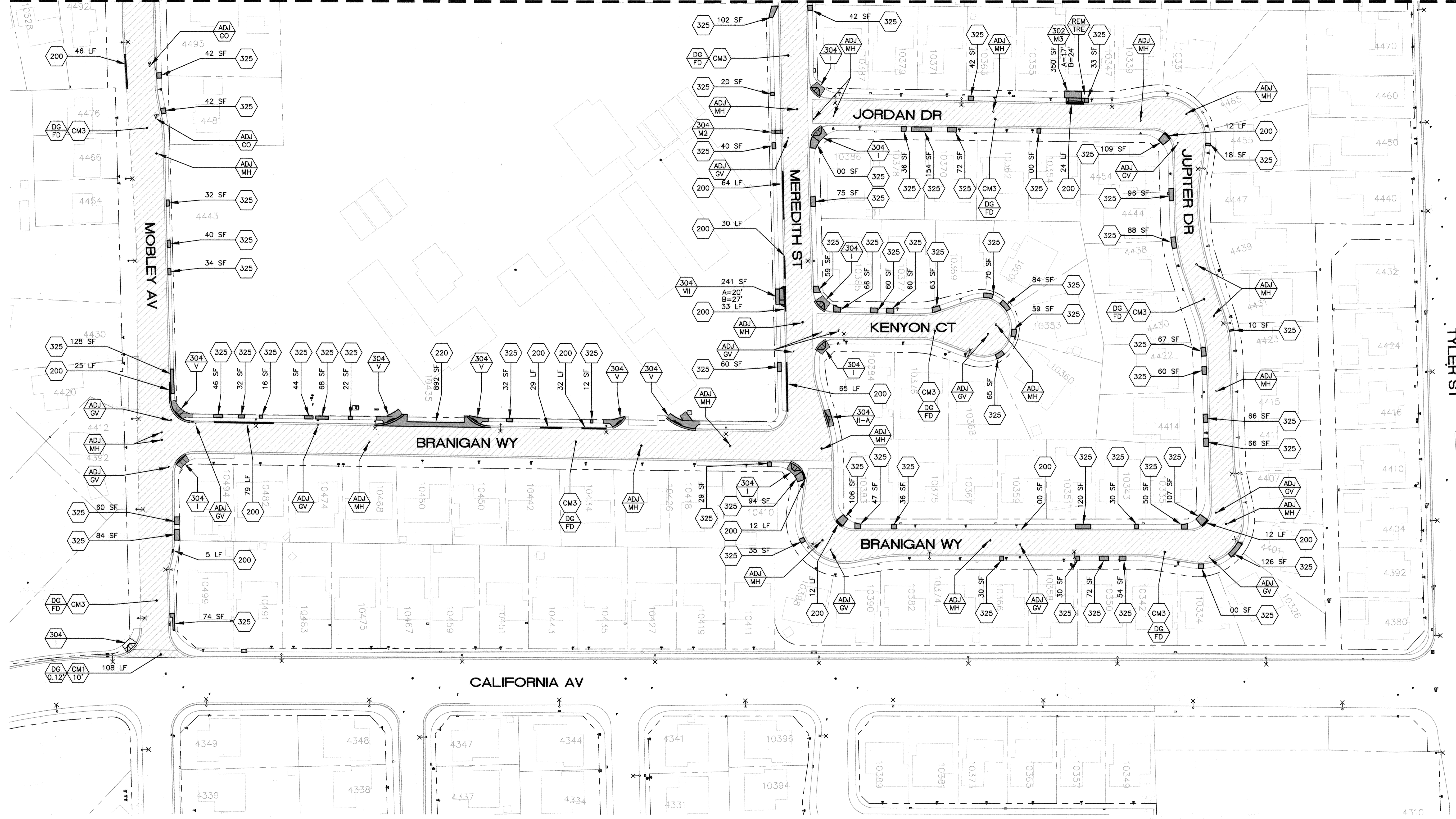

NOTE: SEE SHEET XL-730 FOR SIGN AND STRIPING IMPROVEMENTS REFERENCED HEREON.

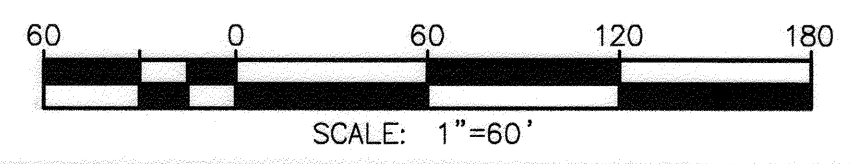

Under Ground Service Alert of Southern California
 Call: TOLL FREE 1-800 227-2600
 TWO WORKING DAYS BEFORE YOU DIG

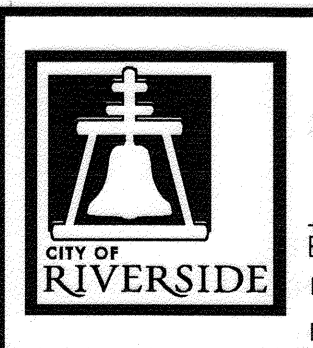

ENGINEER IN RESPONSIBLE CHARGE
 Edward Lara
 R.C.E. No. 63753 EXPIRES: 9-30-16
 DATE: December 15, 2014

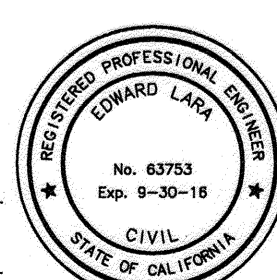

| MARK | REVISIONS | APPR. | DATE |
|------|-----------|-------|------|
| | | | |
| | | | |
| | | | |

CITY OF RIVERSIDE, CALIFORNIA
DEPARTMENT OF PUBLIC WORKS

| | | | |
|---------------------|----|----------|------------------|
| APPROVED BY | BY | DATE | APPROVED BY |
| ENGINEERING MANAGER | Fm | 12/19/14 | [Signature] |
| CONSTRUCTION ADMIN. | DC | 12/18/14 | CITY ENGINEER |
| TRAFFIC DIVISION | Am | 12-18-14 | |
| STREETS | | | DATE: 12/19/2014 |

DESIGNED BY: TYH DRAWN BY: TYH CHECKED BY: EL

STREET MAINTENANCE
2014/2015 MINOR STREETS MAINTENANCE, PHASE 1
LOCATION 2
 HORIZ. SCALE: 1"=60' VERT. SCALE: NA

DESIGN WORK ORDER NO.: 1423500
 CONSTR. WORK ORDER NO.: 1423501
R-4299
 SHEET **5** OF **11**
 FILE NAME: R4299-05.DWG

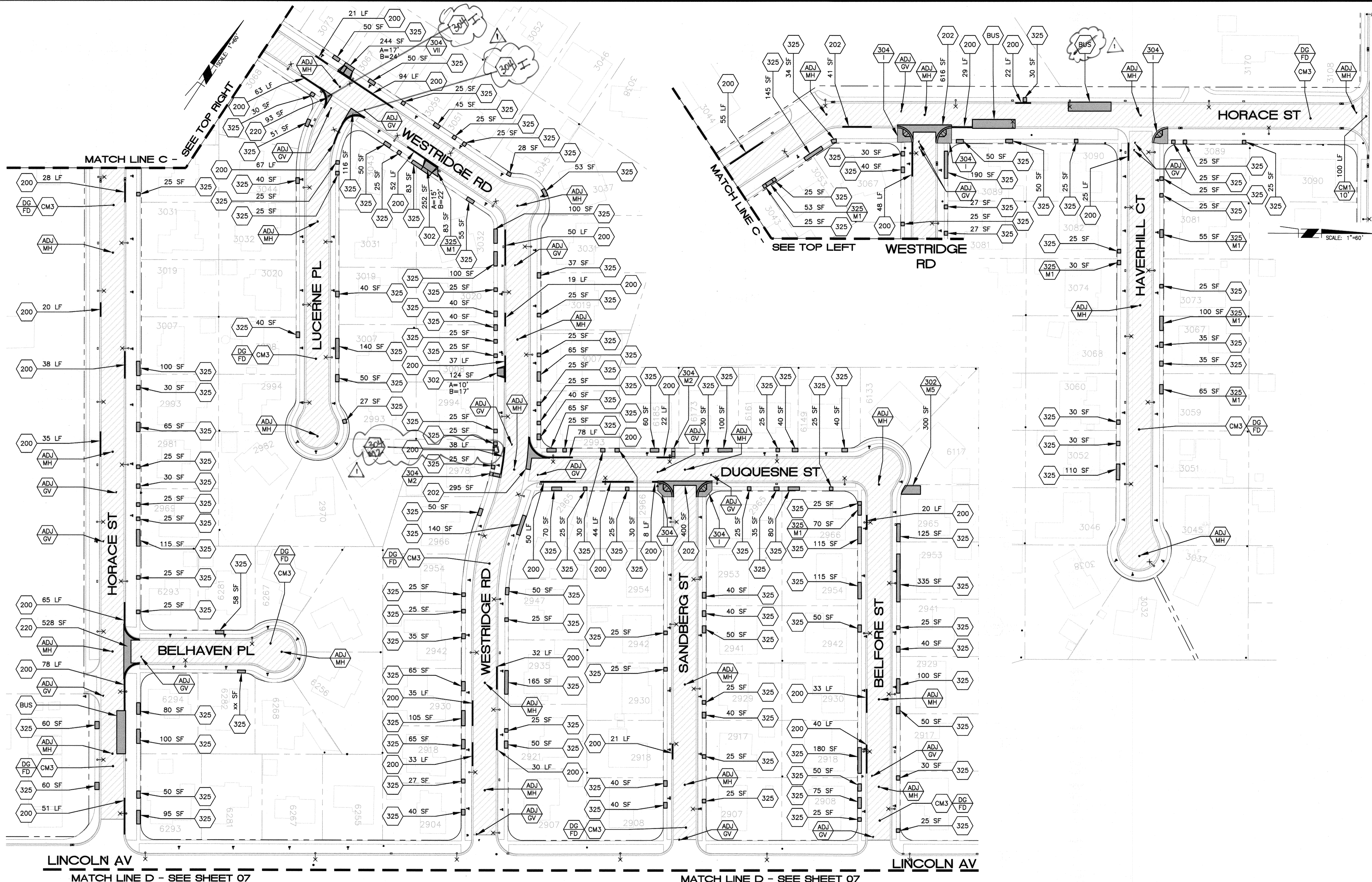

ARLINGTON AV.

SCALE: 1"=60'

NOTE: SEE SHEET XL-730 FOR SIGN AND STRIPING IMPROVEMENTS REFERENCED HEREON.

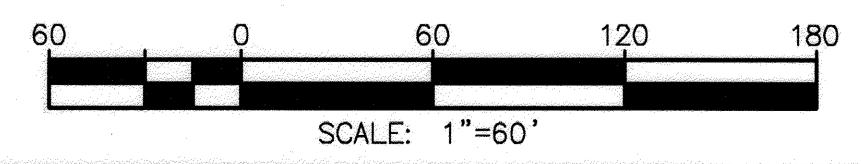

Under Ground Service Alert of Southern California
 Call: TOLL FREE 1-800-227-2600
 TWO WORKING DAYS BEFORE YOU DIG

ENGINEER IN RESPONSIBLE CHARGE
 Edward Lara
 R.C.E. No. 83753 EXPIRES: 9-30-16
 DATE: December 18, 2014

| | | | |
|--------------|------------------|------------|----------|
| MARK | REVISIONS | APPR. | DATE |
| A | AS-BUILT CHANGES | S.L. Dwyer | 12/18/14 |
| DESIGNED BY: | TYH | DRAWN BY: | TYH |
| CHECKED BY: | EL | | |

CITY OF RIVERSIDE, CALIFORNIA
DEPARTMENT OF PUBLIC WORKS

| | | | |
|---------------------|----------|---------------|----------|
| APPROVED BY | DATE | APPROVED BY | DATE |
| ENGINEERING MANAGER | 12/18/14 | CITY ENGINEER | 12/18/14 |
| CONSTRUCTION ADMIN. | 12/18/14 | | |
| TRAFFIC DIVISION | 12-18-14 | | |

DATE: 12/18/2014

STREET MAINTENANCE
2014/2015 MINOR STREETS MAINTENANCE, PHASE 1
LOCATION 3

DESIGN WORK ORDER NO.: 1423500
 CONSTR. WORK ORDER NO.: 1423501
R-4299
 SHEET **6** OF **11**
 FILE NAME: R4299-06.DWG

MATCH LINE D - SEE SHEET 06

MATCH LINE D - SEE SHEET 06

MATCH LINE E - SEE BOTTOM RIGHT

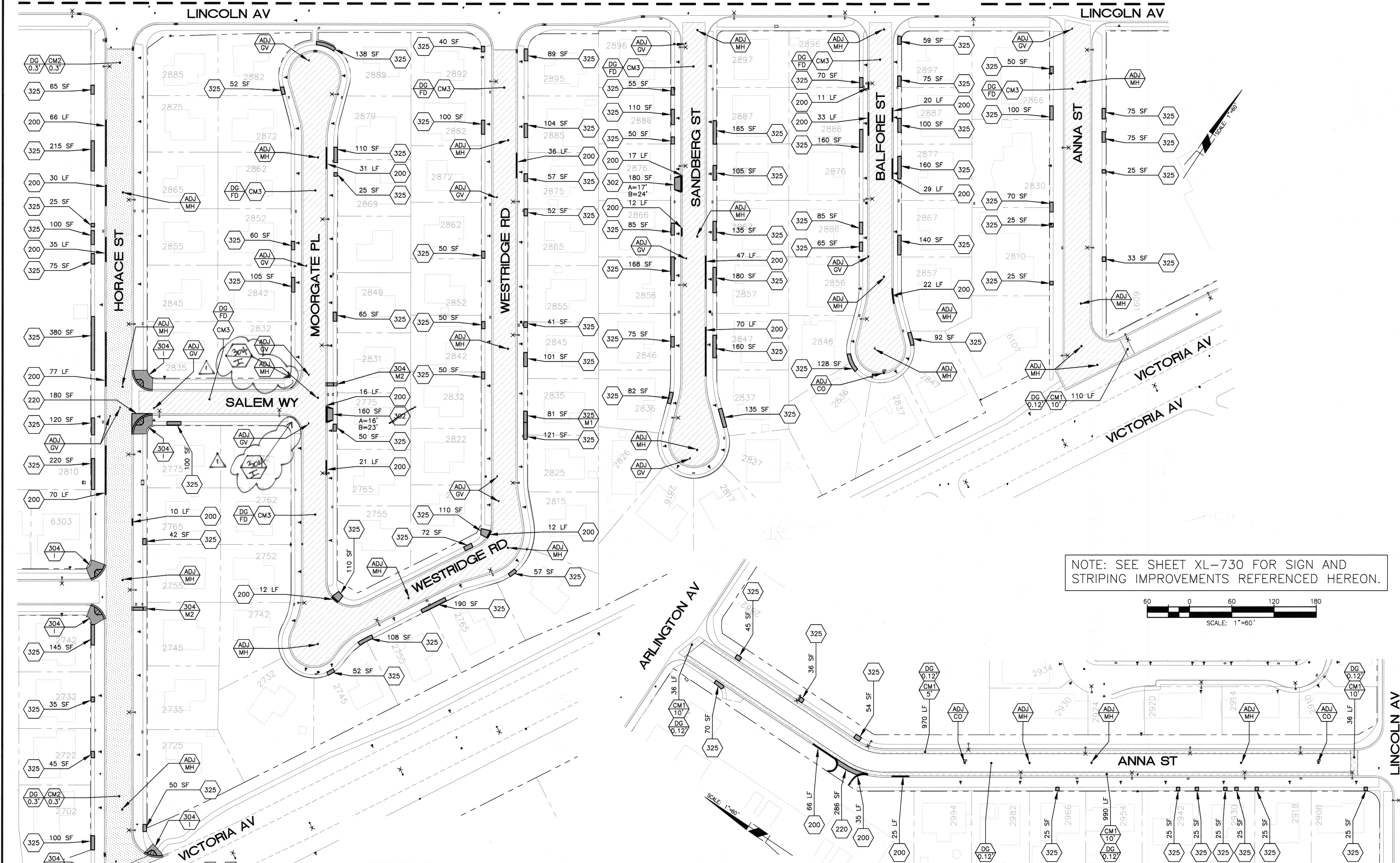

NOTE: SEE SHEET XL-730 FOR SIGN AND STRIPING IMPROVEMENTS REFERENCED HEREON.

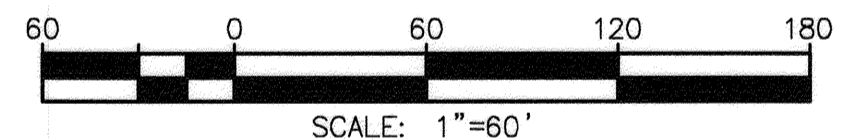

Under Ground Service Alert of Southern California
 Call: TOLL FREE 1-800 227-2600
 TWO WORKING DAYS BEFORE YOU DIG

ENGINEER IN RESPONSIBLE CHARGE
 Edward Lara
 R.C.E. No. 63753 EXPIRES: 9-30-16
 DATE: December 15, 2014

| | | | | | |
|-------------|-----|----------|-----|------------|----|
| DESIGNED BY | TYH | DRAWN BY | TYH | CHECKED BY | EL |
|-------------|-----|----------|-----|------------|----|

CITY OF RIVERSIDE, CALIFORNIA
 DEPARTMENT OF PUBLIC WORKS

| | | | |
|---------------------|----|----------|-------------|
| APPROVED BY | BY | DATE | APPROVED BY |
| ENGINEERING MANAGER | Fn | 12/17/14 | Edward Lara |
| CONSTRUCTION ADMIN. | DG | 12/18/14 | |
| TRAFFIC DIVISION | | 12-13-14 | |

DATE: 12/19/2014

STREET MAINTENANCE

2014/2015 MINOR STREETS MAINTENANCE, PHASE 1

LOCATION 3

HORIZ. SCALE: 1"=60' VERT. SCALE: NA

DESIGN WORK ORDER NO.: 1423500
 CONSTR. WORK ORDER NO.: 1423501

R-4299

SHEET 7 OF 11

FILE NAME: R4299-07.DWG

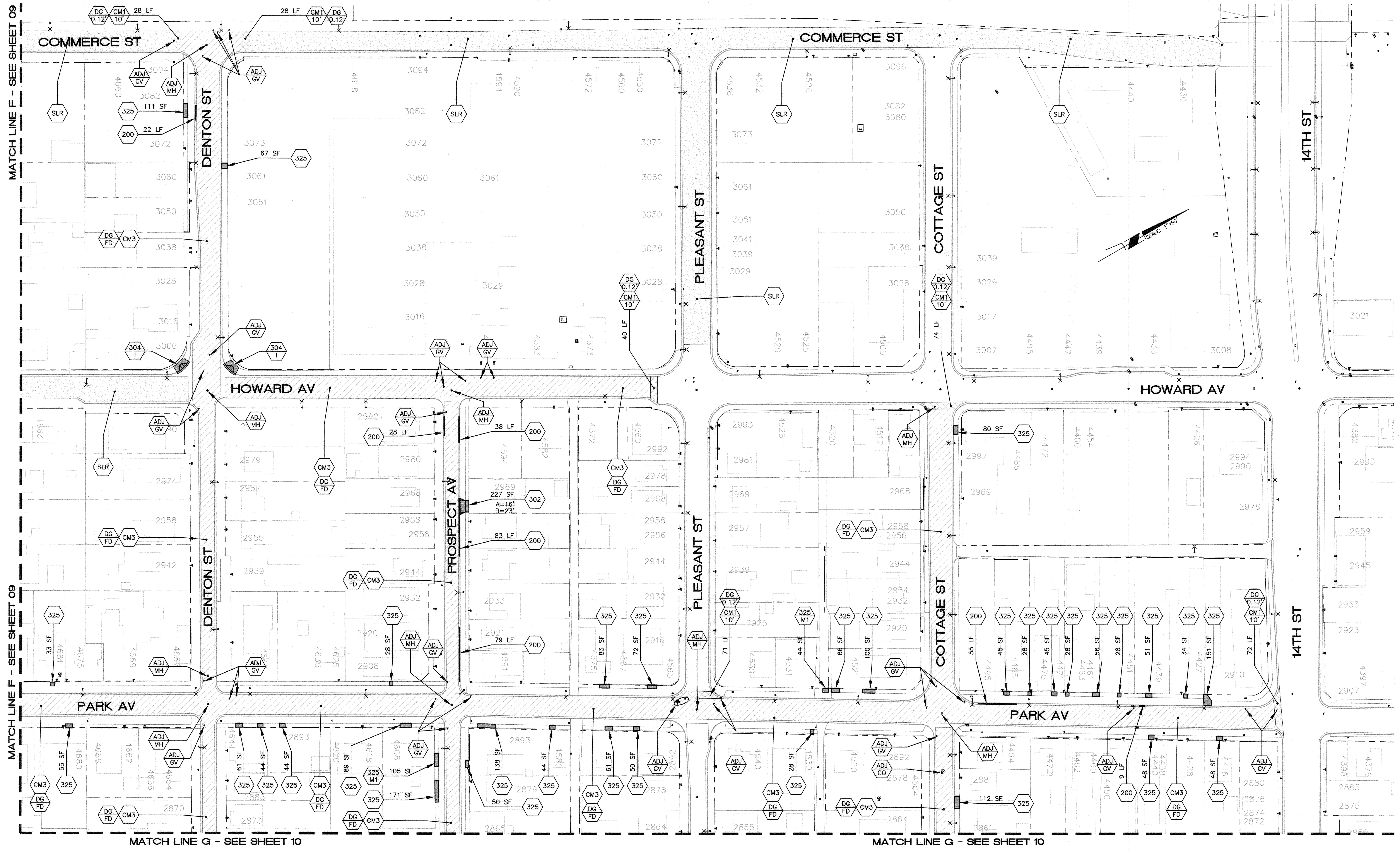

NOTE: SEE SHEET XL-730 FOR SIGN AND STRIPING IMPROVEMENTS REFERENCED HEREON.

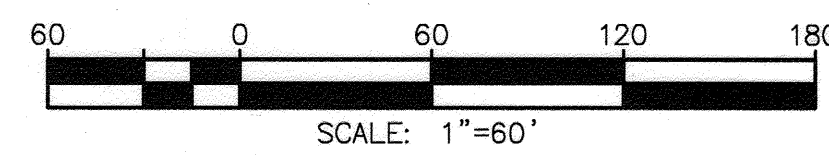

Under Ground Service Alert of Southern California
 Call: TOLL FREE 1-800-227-2600
 TWO WORKING DAYS BEFORE YOU DIG

ENGINEER IN RESPONSIBLE CHARGE
 Edward Lara
 R.C.E. No. 63753 EXPIRES: 9-30-16
 DATE: December 15, 2014

| MARK | REVISIONS | APPR. | DATE |
|------|-----------|-------|------|
| | | | |
| | | | |
| | | | |

DESIGNED BY: TYH DRAWN BY: TYH CHECKED BY: EL

CITY OF RIVERSIDE, CALIFORNIA
 DEPARTMENT OF PUBLIC WORKS

| | | | | |
|---------------------|------|----------|---------------|----------|
| APPROVED BY | BY | DATE | APPROVED BY | DATE |
| ENGINEERING MANAGER | Fm | 12/18/14 | CITY ENGINEER | 12/18/14 |
| CONSTRUCTION ADMIN. | DC | 12/18/14 | | |
| TRAFFIC DIVISION | Fm H | 12-12-14 | | |
| STREETS | | | | |
| SURVEYOR | | | | |

DATE: 12/18/2014

STREET MAINTENANCE
 2014/2015 MINOR STREETS MAINTENANCE, PHASE 1
 LOCATION 4
 HORIZ. SCALE: 1"=60' VERT. SCALE: NA

DESIGN WORK ORDER NO.: 1423500
 CONSTR. WORK ORDER NO.: 1423501
R-4299
 SHEET **8** OF **11**
 FILE NAME: R4299-08.DWG

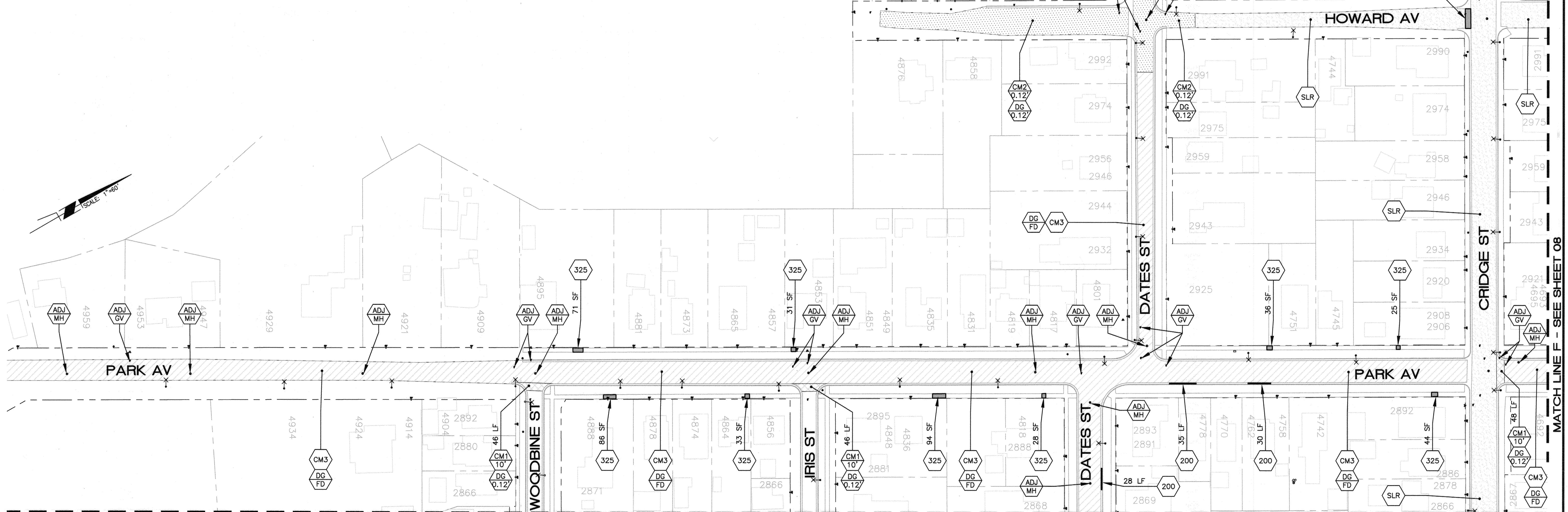
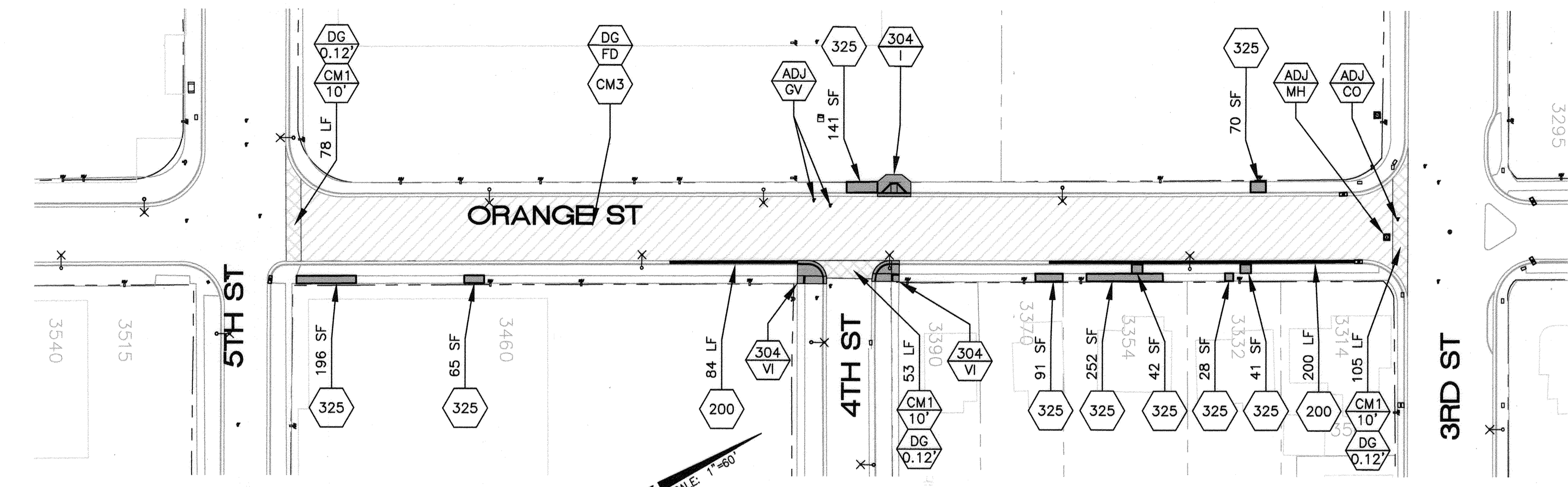

NOTE: SEE SHEET XL-730 FOR SIGN AND STRIPING IMPROVEMENTS REFERENCED HEREON.

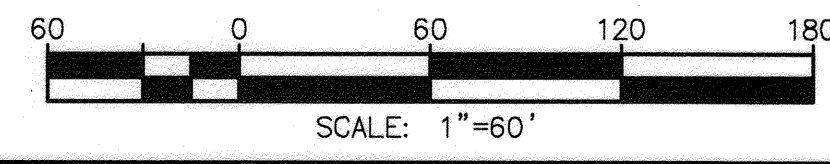

Under Ground Service Alert of Southern California
 Call: TOLL FREE 1-800 227-2600
 TWO WORKING DAYS BEFORE YOU DIG

ENGINEER IN RESPONSIBLE CHARGE
 Edward Lara
 R.C.E. No. 63753 EXPIRES: 9-30-16
 DATE: December 15, 2014

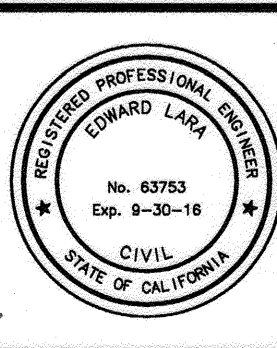

| MARK | REVISIONS | APPR. | DATE |
|------|-----------|-------|------|
| | | | |
| | | | |

CITY OF RIVERSIDE, CALIFORNIA
DEPARTMENT OF PUBLIC WORKS

APPROVED BY: *[Signature]* DATE: 12/17/14
 CONSTRUCTION ADMIN. DATE: 12/18/14
 TRAFFIC DIVISION DATE: 12-18-14

STREET MAINTENANCE
2014/2015 MINOR STREETS MAINTENANCE, PHASE 1
LOCATION 4 AND 5
 HORIZ. SCALE: 1"=60' VERT. SCALE: NA

DESIGN WORK ORDER NO.: 1423500
 CONSTR. WORK ORDER NO.: 1423501
R-4299
 SHEET **9** OF **11**
 FILE NAME: R4299-09.DWG

MATCH LINE F - SEE SHEET 08

MATCH LINE F - SEE SHEET 08

MATCH LINE H - SEE SHEET 11

LOCATION 4

MATCH LINE H - SEE SHEET 11

MATCH LINE G - SEE SHEET 08

MATCH LINE G - SEE SHEET 08



MATCH LINE I - SEE SHEET 11

MATCH LINE I - SEE SHEET 11

NOTE: SEE SHEET XL-730 FOR SIGN AND STRIPING IMPROVEMENTS REFERENCED HEREON.

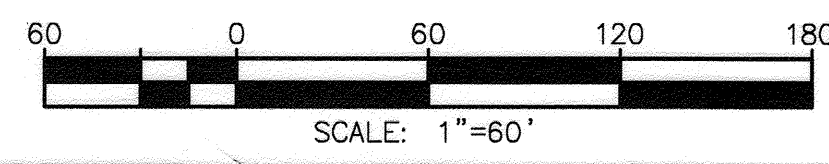

Under Ground Service Alert of Southern California
Call: TOLL FREE 1-800 227-2600
TWO WORKING DAYS BEFORE YOU DIG

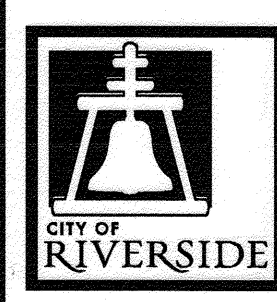

ENGINEER IN RESPONSIBLE CHARGE
Edward Lara
R.C.E. No. 63753 EXPIRES: 9-30-16
DATE: December 15, 2014

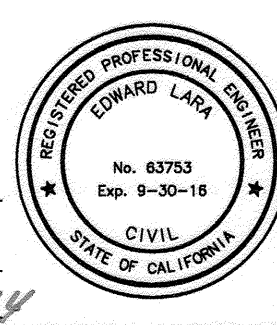

| | | | | | |
|------------------|------------------|----------|------|------------|----|
| DESIGNED BY | TYH | DRAWN BY | TYH | CHECKED BY | EL |
| MARK | AS-BUILT CHANGES | | | | |
| REVISIONS | 5.0.0.19.0 | | | | |
| APPR. | DATE | APPR. | DATE | | |
| TRAFFIC DIVISION | SURVEYOR | | | | |

| | | | |
|---|------------------|----------|-------------|
| CITY OF RIVERSIDE, CALIFORNIA DEPARTMENT OF PUBLIC WORKS | | | |
| APPROVED BY | BY | DATE | APPROVED BY |
| ENGINEERING MANAGER | EM | 12/17/14 | EDWARD LARA |
| CONSTRUCTION ADMIN. | DC | 12/18/14 | |
| TRAFFIC DIVISION | SM | 12-18-14 | |
| STREETS | DATE: 12/18/2014 | | |

| | |
|--|-----------------|
| STREET MAINTENANCE | |
| 2014/2015 MINOR STREETS MAINTENANCE, PHASE 1 | |
| LOCATION 4 | |
| HORIZ. SCALE: 1"=60' | VERT. SCALE: NA |

| | |
|---------------------------------|-------------------------|
| DESIGN WORK ORDER NO.: 1423500 | R-4299 |
| CONSTR. WORK ORDER NO.: 1423501 | |
| SHEET 10 OF 11 | FILE NAME: R4299-10.DWG |

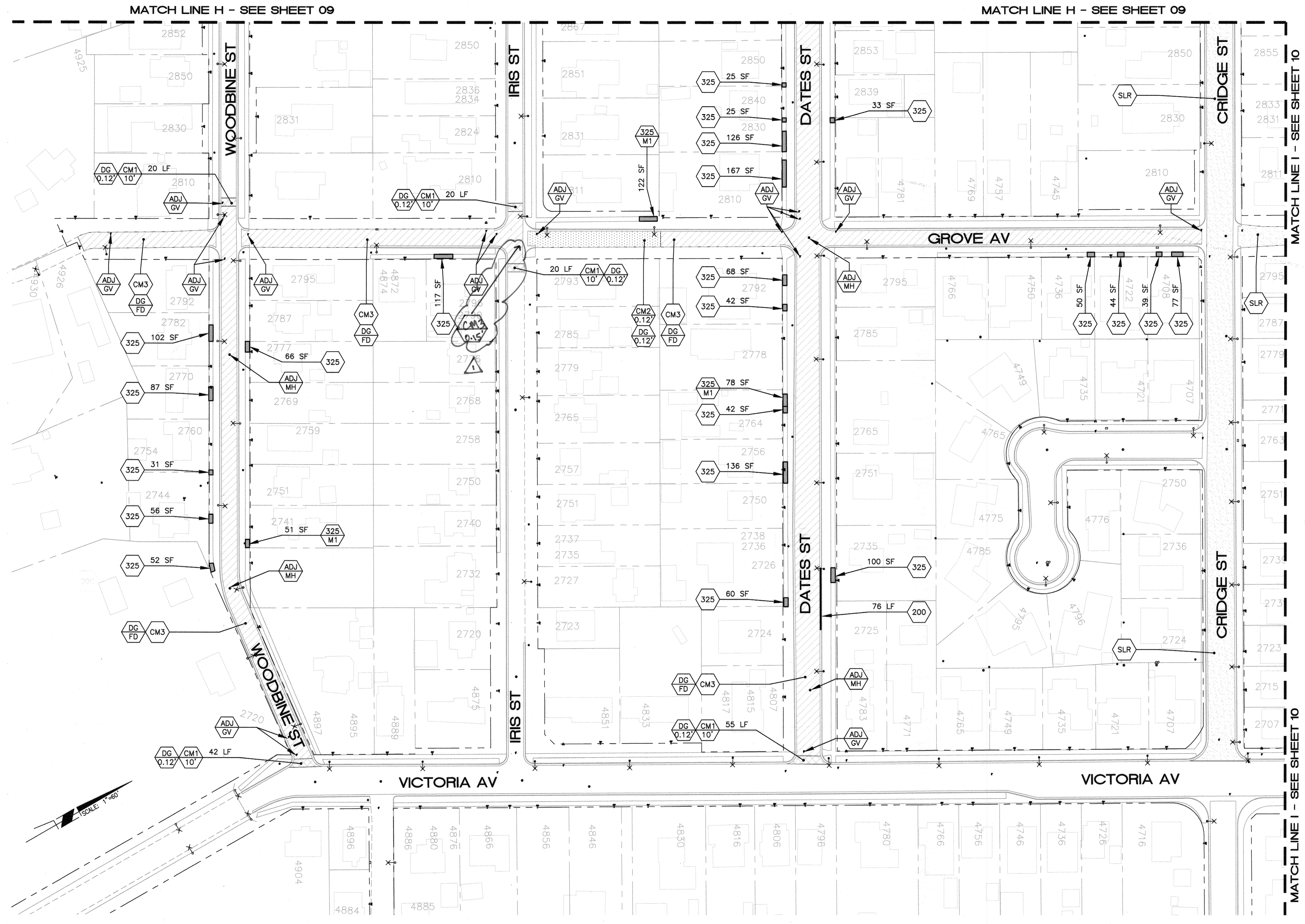

NOTE: SEE SHEET XL-730 FOR SIGN AND STRIPING IMPROVEMENTS REFERENCED HEREON.

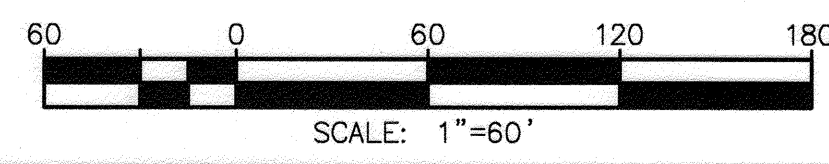

Under Ground Service Alert
 of Southern California
 Call: TOLL FREE 1-800-227-2600
TWO WORKING DAYS BEFORE YOU DIG

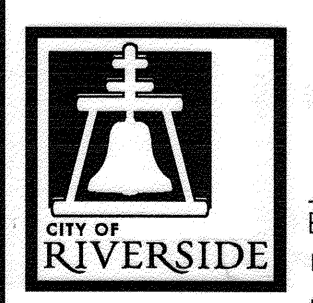

ENGINEER IN RESPONSIBLE CHARGE
Edward Lara
 Edward Lara
 R.C.E. No. 63753 EXPIRES: 9-30-16
 DATE December 15, 2014

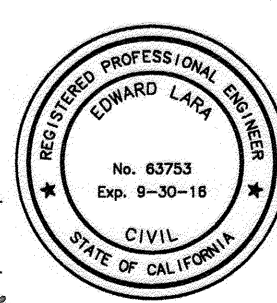

| DESIGNED BY | TYH | DRAWN BY | TYH | CHECKED BY | EL | | | | | | | | | | | | |
|-------------|--|------------------|-----|------------|----|-----|------|-------------|---|----------|------------------|---|----------|------------------|---|----------|------------------|
| MARK | AS-BUILT CHANGES | | | | | | | | | | | | | | | | |
| REVISIONS | <table border="1"> <tr> <th>NO.</th> <th>DATE</th> <th>DESCRIPTION</th> </tr> <tr> <td>1</td> <td>12/11/14</td> <td>AS-BUILT CHANGES</td> </tr> <tr> <td>2</td> <td>12/18/14</td> <td>AS-BUILT CHANGES</td> </tr> <tr> <td>3</td> <td>12-18-14</td> <td>AS-BUILT CHANGES</td> </tr> </table> | | | | | NO. | DATE | DESCRIPTION | 1 | 12/11/14 | AS-BUILT CHANGES | 2 | 12/18/14 | AS-BUILT CHANGES | 3 | 12-18-14 | AS-BUILT CHANGES |
| NO. | DATE | DESCRIPTION | | | | | | | | | | | | | | | |
| 1 | 12/11/14 | AS-BUILT CHANGES | | | | | | | | | | | | | | | |
| 2 | 12/18/14 | AS-BUILT CHANGES | | | | | | | | | | | | | | | |
| 3 | 12-18-14 | AS-BUILT CHANGES | | | | | | | | | | | | | | | |

| | | | |
|---|----|----------|-----------------|
| CITY OF RIVERSIDE, CALIFORNIA DEPARTMENT OF PUBLIC WORKS | | | |
| APPROVED BY | BY | DATE | APPROVED BY |
| ENGINEERING MANAGER | En | 12/11/14 | <i>Michael</i> |
| CONSTRUCTION ADMIN. | DC | 12/18/14 | CITY ENGINEER |
| TRAFFIC DIVISION | SM | 12-18-14 | DATE 12/19/2014 |
| STREETS | | | |
| SURREY | | | |

| | |
|--|-----------------|
| STREET MAINTENANCE | |
| 2014/2015 MINOR STREETS MAINTENANCE, PHASE 1 | |
| LOCATION 4 | |
| HORIZ. SCALE: 1"=60' | VERT. SCALE: NA |

DESIGN WORK ORDER NO.: 1423500
 CONSTR. WORK ORDER NO.: 1423501
R-4299
 SHEET **11** OF **11**
 FILE NAME: R4299-11.DWG

AS-BUILT 7-17-18