

NOTES:

- EXISTING ASPHALT CONCRETE PAVEMENT WITHIN SAWCUT LIMITS TO BE REMOVED ENTIRELY. GRADE TO DRAIN NEW ASPHALT CONCRETE PAVEMENT. MATCH SLOPE OF STREET TO THE EXTENT FEASIBLE.
- EXISTING BALLAST TO REMAIN.
- EXISTING RIGHT OF WAY LINES SHOWN ON THIS SHEET IS BASED ON COUNTY GIS MAP AND HAVE NOT BEEN FIELD VERIFIED.
- CONTRACTOR TO SUBMIT TRAFFIC CONTROL AND DETOUR PLANS FOR APPROVAL BY CITY.
- ALL STRIPING AND PAVEMENT MARKINGS SHALL BE HOT MELT THERMOPLASTIC AND SHALL CONFORM TO THE CALTRANS STANDARD SPECIFICATIONS.
- REMOVAL OF EXISTING STRIPING AND PAVEMENT MARKINGS SHALL BE DONE BY WET SANDBLASTING AND/OR GRINDING. BLACK OUT OF REMOVAL AREAS IS NOT PERMITTED. CONTRACTOR SHALL "FOG SEAL" ALL STRIPPING REMOVALS INCLUDING LANE MARKINGS AND PAVEMENT LEGENDS. FOG SEAL SPREAD SHALL BE CONTAINED WITHIN A UNIFORM RECTANGULAR AREA COVERING THE REMOVED STRIPING/PAVEMENT MARKING.

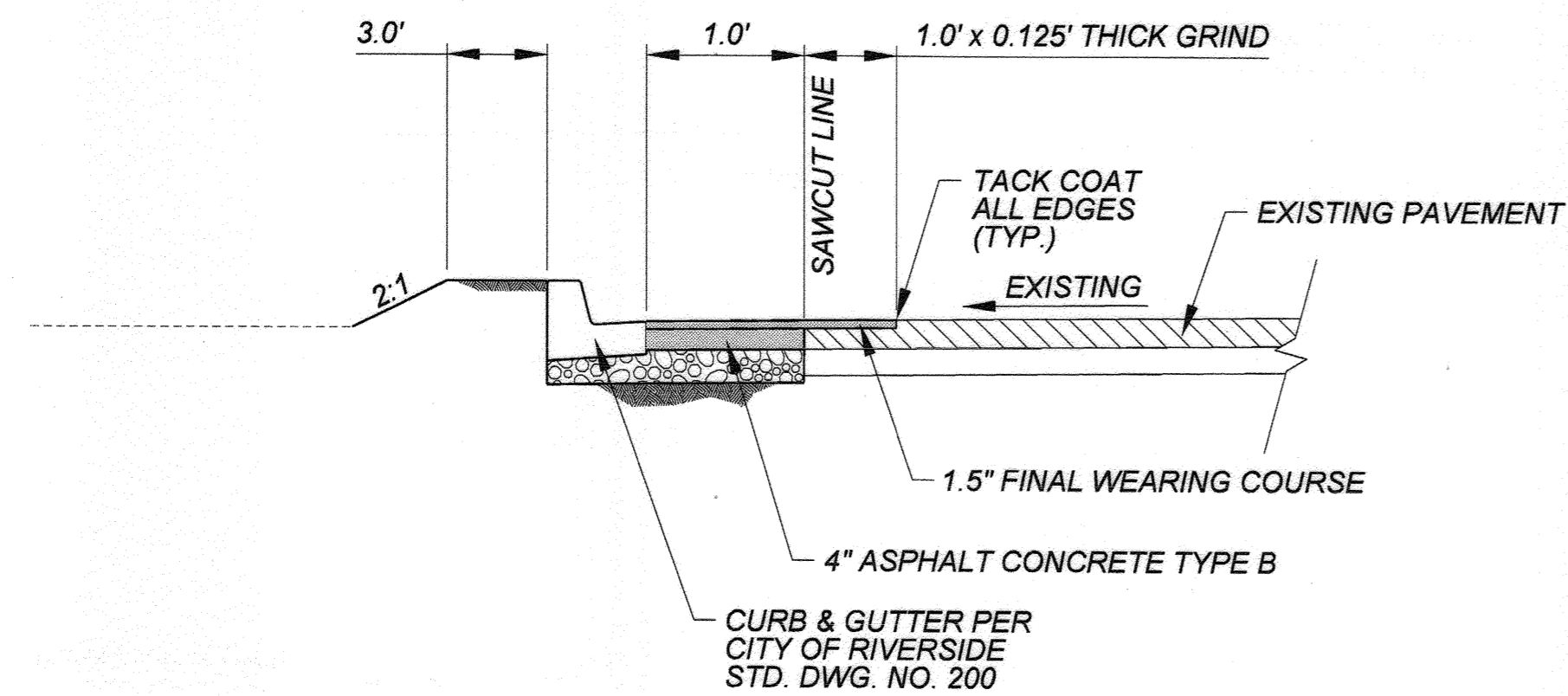

ROADWAY SECTION BB - LOOKING NORTH
NTS

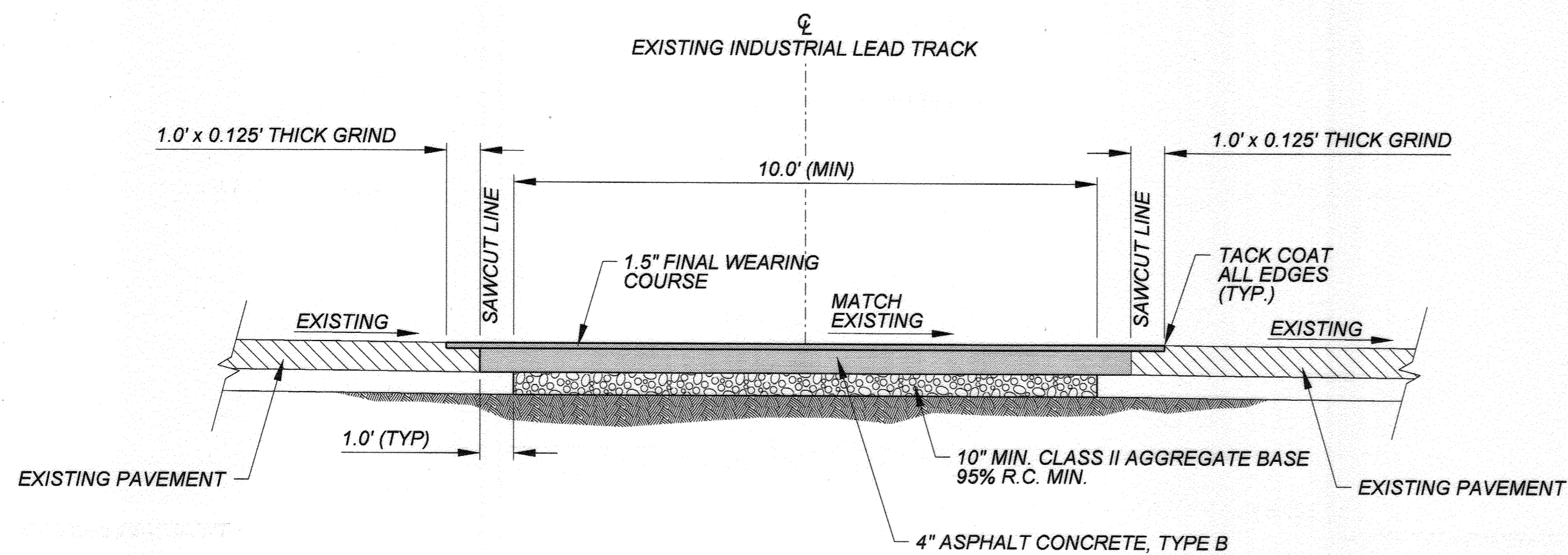

ROADWAY SECTION AA - LOOKING EAST
NTS

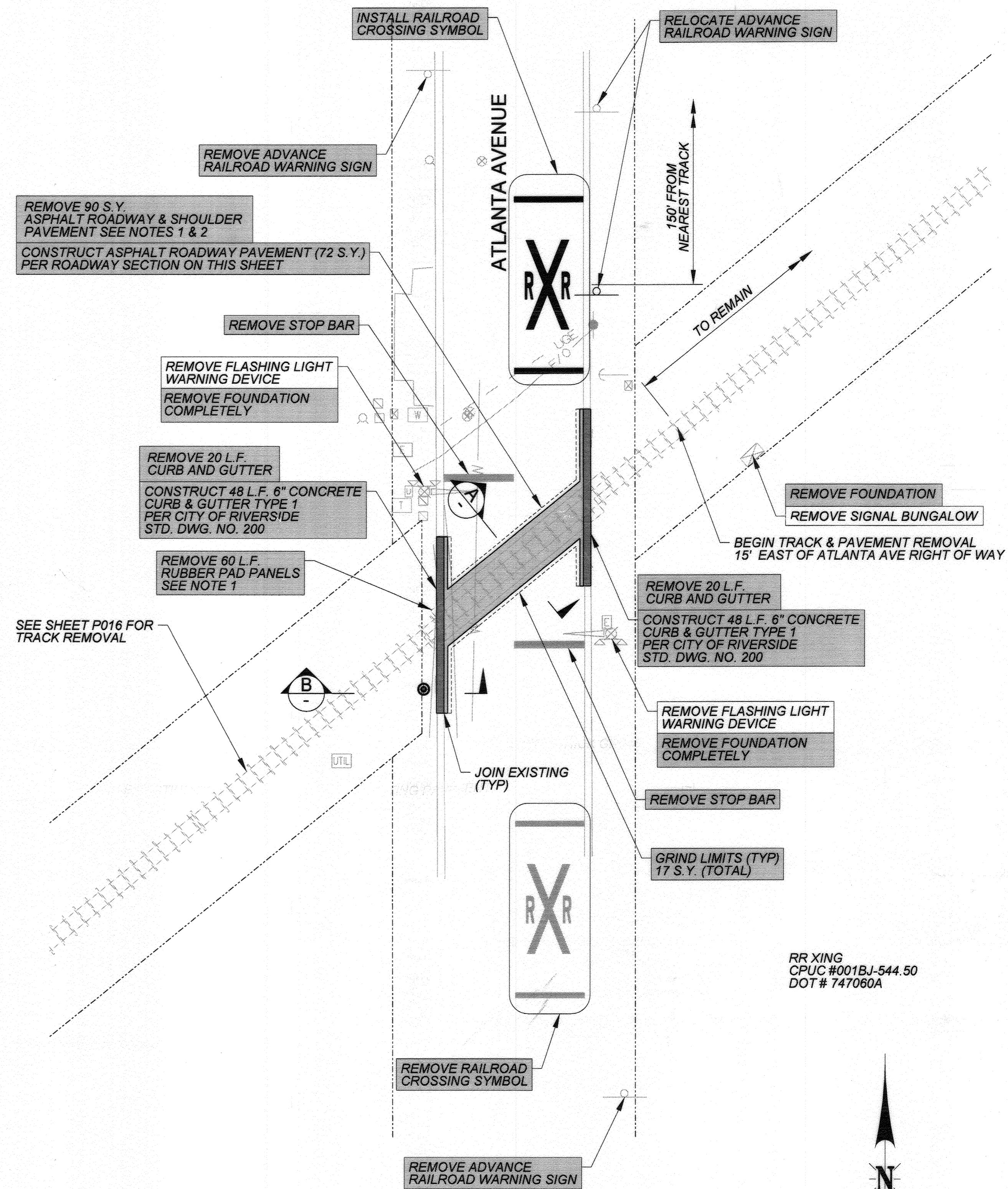

RR XING
CPUC #001BJ-544.50
DOT # 747060A

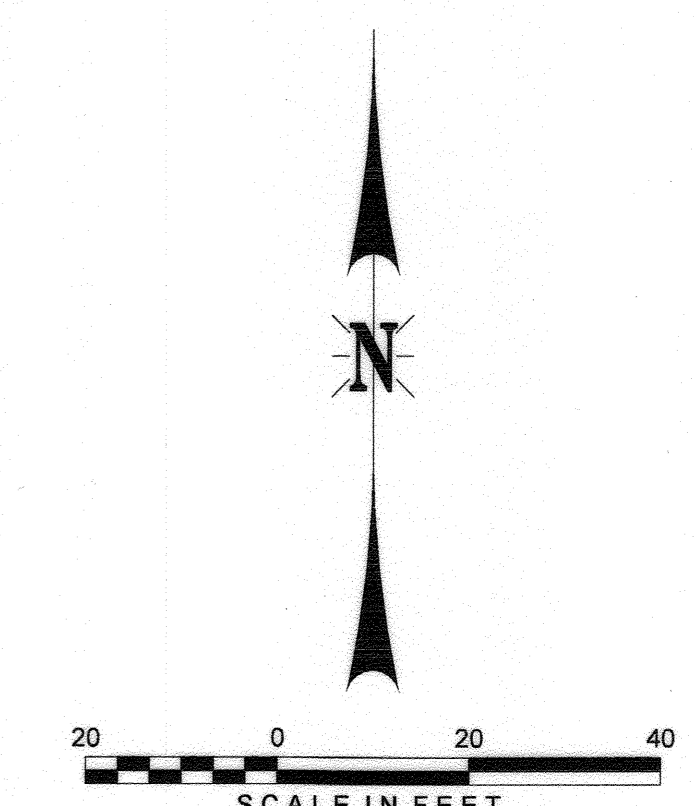

CITY OF RIVERSIDE, CALIFORNIA PUBLIC WORKS DEPARTMENT			
APPROVED BY	BY	DATE	APPROVED BY
ENGINEERING MANAGER	SM	7-2-12	
TRAFFIC ENGINEER	L.H.	9-11-12	
CAPITAL PROJECT			
			CITY ENGINEER/PUBLIC WORKS DIRECTOR
			DATE 9/18/2013

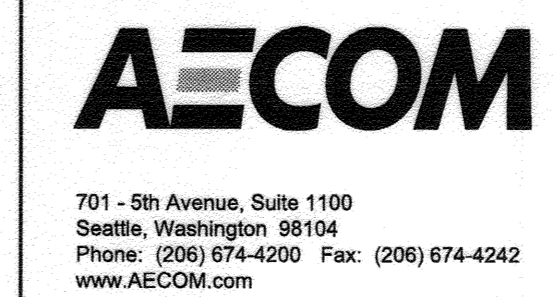

DRAWN BY: HPH
CHECKED BY: LMM
DATE: 8-19-2013
SHEET NUMBER: R011 of R017

UNION PACIFIC RAILROAD
Office of Assistant Vice President
Engineering Design
LOCATION & DESCRIPTION: COLTON TO RIVERSIDE, CA
MP 538.95 TO MP 545.80, RIVERSIDE INDUSTRIAL LEAD
RELOCATE INDUSTRIAL LEAD
SHEET TITLE: GRADE CROSSING - ATLANTA AVENUE

sscolor-tablet\$
 UPRRpen.tbl
 P:\Trons\60241731 - UP Riverside IndustrialLead\CADD\Civil\Sheet\Roll-Atlanta-RC.TD.dgn
 UPRR-11x17.PLT
 8/27/2013