

- NOTES:**
- EXISTING ASPHALT CONCRETE PAVEMENT WITHIN SAWCUT LIMITS TO BE REMOVED ENTIRELY. GRADE TO DRAIN NEW ASPHALT CONCRETE PAVEMENT. MATCH SLOPE OF STREET TO THE EXTENT FEASIBLE.
 - EXISTING BALLAST TO REMAIN.
 - EXISTING RIGHT OF WAY LINES SHOWN ON THIS SHEET IS BASED ON COUNTY GIS MAP AND HAVE NOT BEEN FIELD VERIFIED.
 - CONTRACTOR TO SUBMIT TRAFFIC CONTROL AND DETOUR PLANS FOR APPROVAL BY CITY.
 - ALL STRIPING AND PAVEMENT MARKINGS SHALL BE HOT MELT THERMOPLASTIC AND SHALL CONFORM TO THE CALTRANS STANDARD SPECIFICATIONS.
 - REMOVAL OF EXISTING STRIPING AND PAVEMENT MARKINGS SHALL BE DONE BY WET SANDBLASTING AND/OR GRINDING. BLACK OUT OF REMOVAL AREAS IS NOT PERMITTED. CONTRACTOR SHALL "FOG SEAL" ALL STRIPPING REMOVALS INCLUDING LANE MARKINGS AND PAVEMENT LEGENDS. FOG SEAL SPREAD SHALL BE CONTAINED WITHIN A UNIFORM RECTANGULAR AREA COVERING THE REMOVED STRIPING/PAVEMENT MARKING.

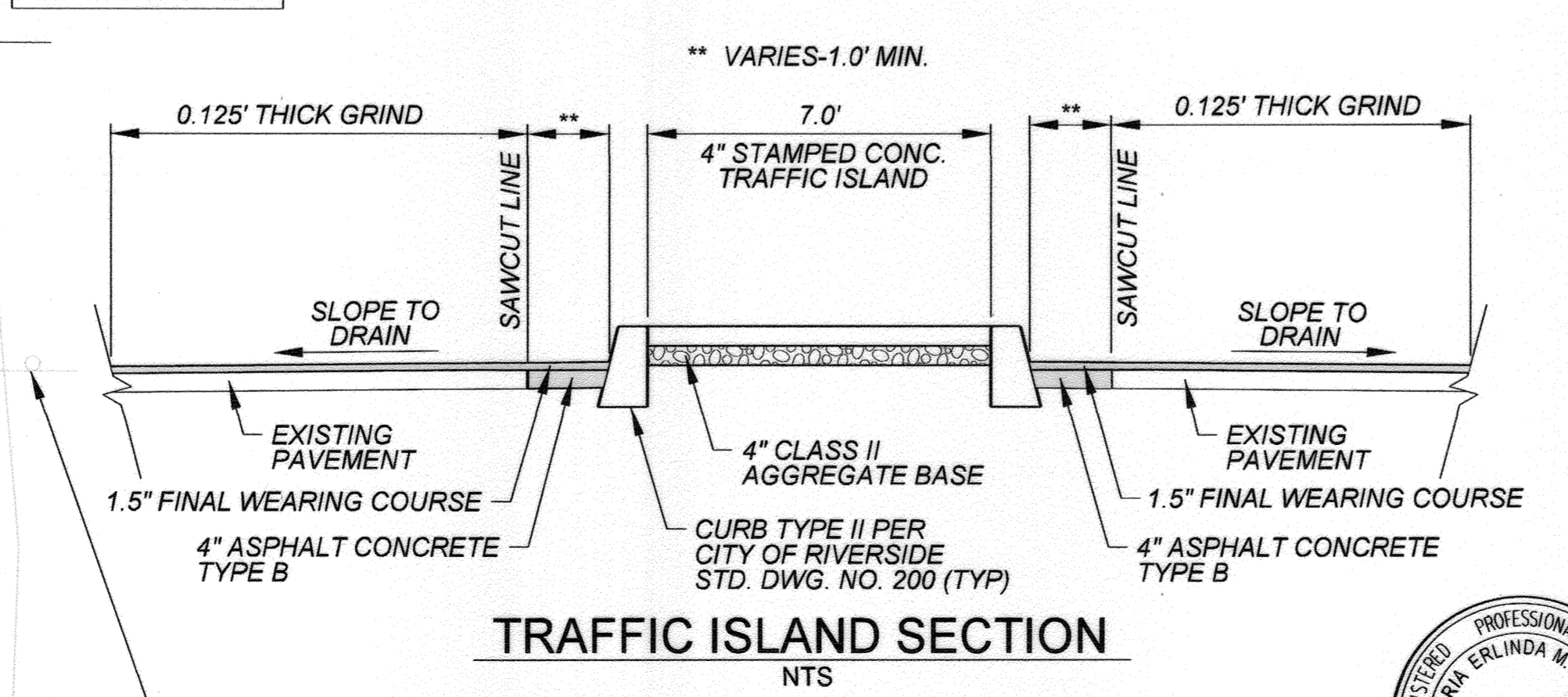

**CITY OF RIVERSIDE, CALIFORNIA
PUBLIC WORKS DEPARTMENT**

APPROVED BY	BY	DATE	APPROVED BY
ENGINEERING MANAGER	E.M.	6/5/19	[Signature]
TRAFFIC ENGINEER	[Signature]	5-21-19	CITY ENGINEER/PUBLIC WORKS DIRECTOR
CAPITAL PROJECT			DATE 6/5/2019

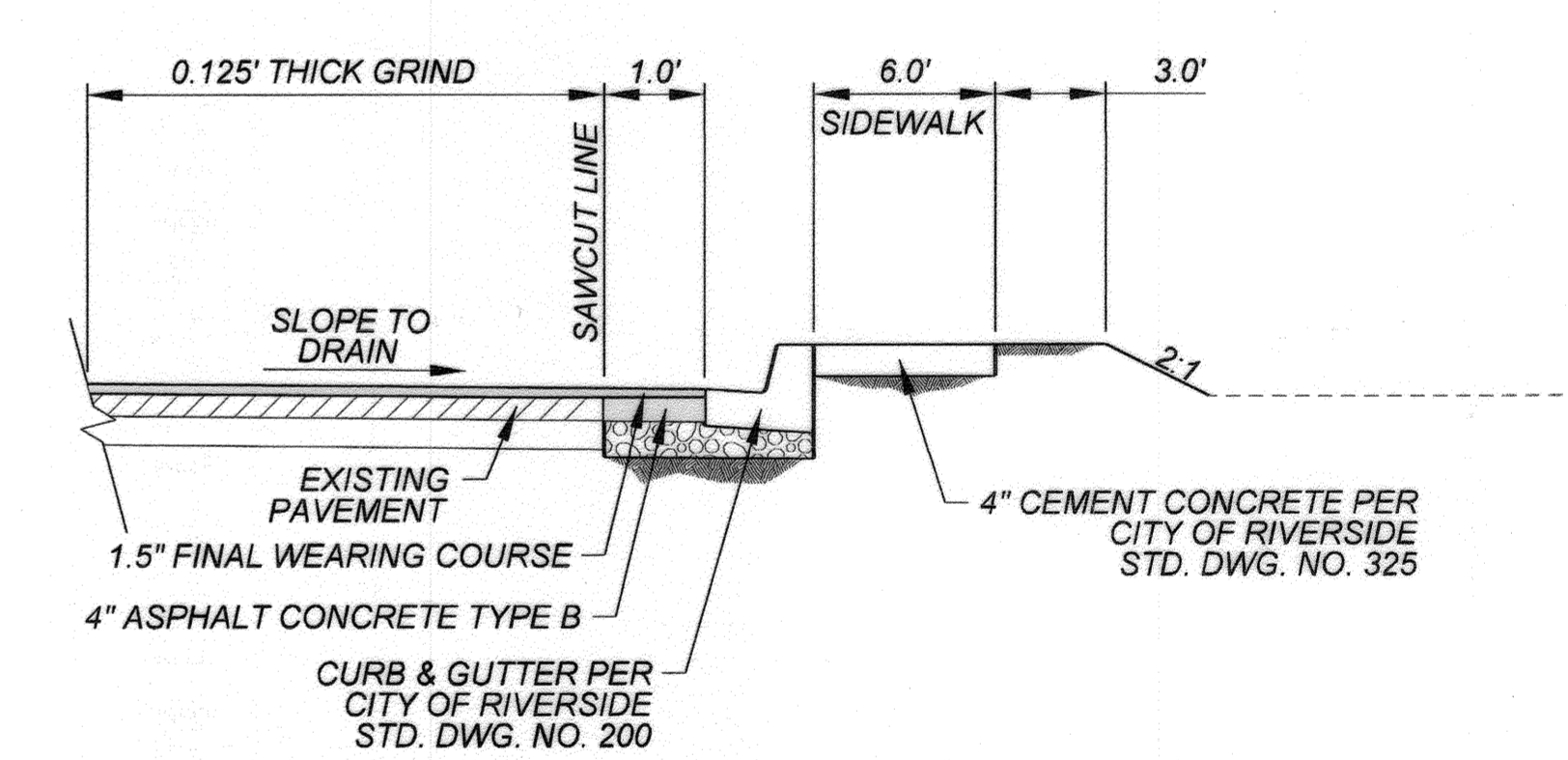
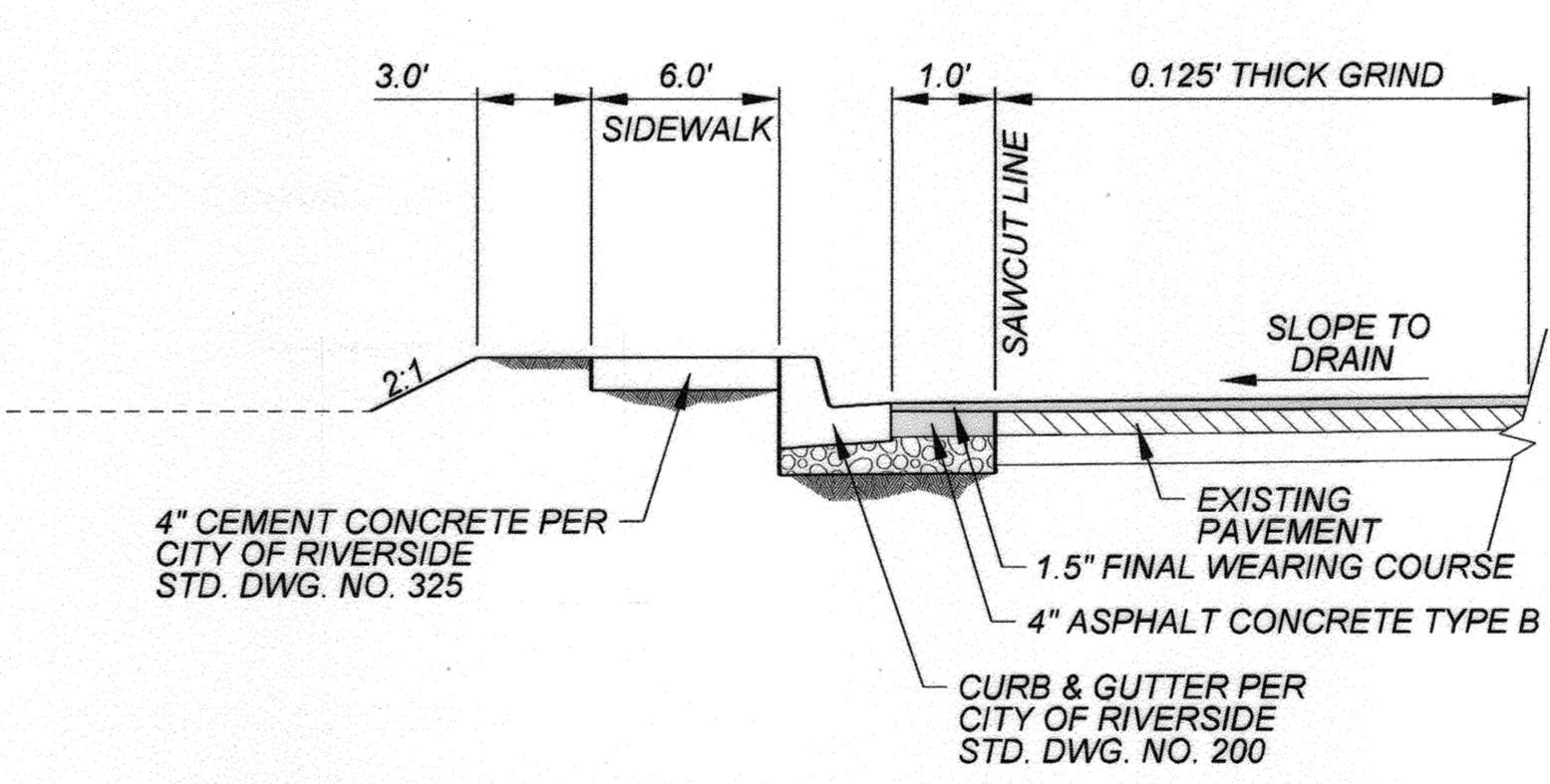
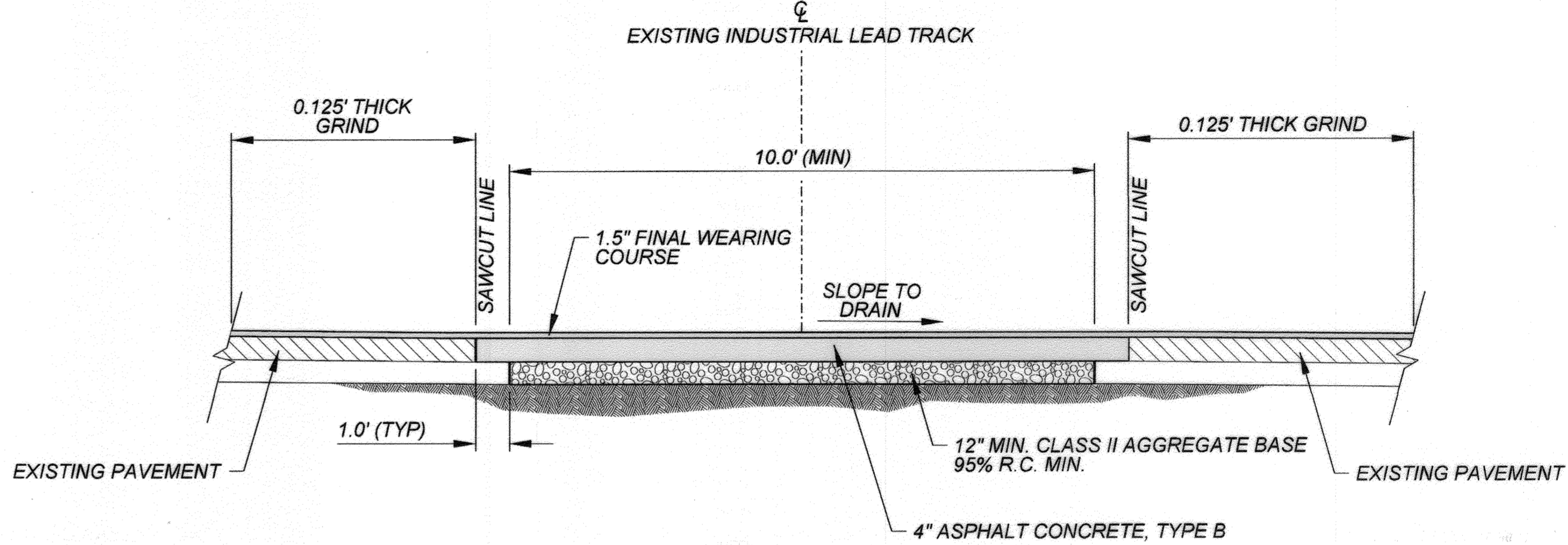

DRAWN BY: HPH	UNION PACIFIC RAILROAD Office of Assistant Vice President Engineering Design
CHECKED BY: LMM	
DATE: 5-27-2014	
SHEET NUMBER: R013 of R017	
LOCATION & DESCRIPTION: COLTON TO RIVERSIDE, CA MP 538.95 TO MP 545.80, RIVERSIDE INDUSTRIAL LEAD RELOCATE INDUSTRIAL LEAD	
SHEET TITLE: GRADE CROSSING - CHICAGO AVENUE	

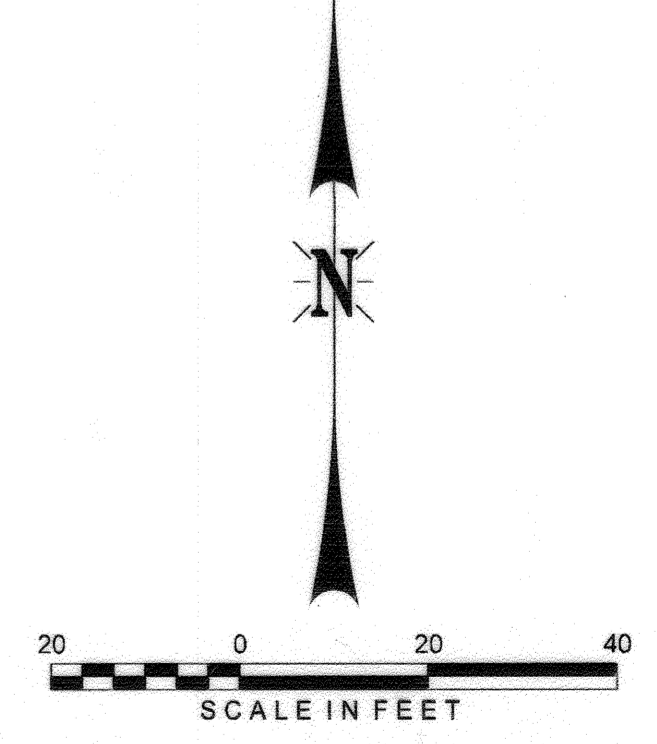

s:\colortab\es6
 U:\r\pen\tdl
 U:\p\chris\604731-UP Riverside Industrial\Lead\CADD\Civil\Sneer\R013-Chicago-RCTD.dgn
 U:\p\chris\604731-UP Riverside Industrial\Lead\CADD\Civil\Sneer\R013-Chicago-RCTD.dgn
 5/27/2014