

**CURB RETURN DATA**

STATION	EXISTING ELEVATION	PROPOSED ELEVATION	DIFFERENCE
1	87.55	87.00	0.55
2	87.51	87.00	0.51
3	87.57	87.00	0.57
4	87.50	87.00	0.50
5	87.58	87.00	0.58
6	87.53	87.00	0.53

**QUANTITY ESTIMATE**

ITEM	DESCRIPTION	AMOUNT	UNIT
1	CURB & GUTTER, 1/2" x 6" x 24"	4016	LF
2	2" PLANT WITH SURFACING & SEAL COAT	26,460	SF
3	IMPORTED BASE MATERIAL	483	CY
4	EXCAVATION	1,700	CY
5	2 1/2" REDWOOD HEADER	45	LF
6	REMOVE CONCRETE CURB, GUTTER	270	LF
7	2 1/2" REDWOOD HEADER	3	LF
8	REMOVE CONCRETE SIDEWALK, 6" x 6"	21,180	SF
9	REMOVE CONCRETE SIDEWALK, 6" x 6"	10,500	SF
10	REMOVE CONCRETE SIDEWALK, 6" x 6"	21,180	SF

**GENERAL NOTES**

- IT SHALL BE RESPONSIBILITY OF THE CONTRACTOR TO CLEAR THE RIGHT OF WAY IN ACCORDANCE WITH THE PROVISIONS OF LAW AS IT APPLICABLE TO THIS PROJECT INCLUDING THE REMOVAL OF OBSTACLES AND FENCES AND AT NO EXTRA COST TO THE CITY.
- CONSTRUCTION SHALL BE IN ACCORDANCE WITH THE CITY OF RIVERSIDE DEPT. OF PUBLIC WORKS SPECIFICATIONS AND 400 AND 700 STANDARD DRAWINGS.
- TRIM EDGE OF EXISTING PAVING WHERE NEW PAVING JOINS EXISTING PAVING TO CLEAN UP EXISTING CURB, GUTTER, SIDEWALK, AND OVERLAP EXISTING PAVING AS DIRECTED IN FIELD TO PROTECT THE CIRCUMFERENCE.
- AT ALL EXISTING DIST. AND CON. DRIVES OR HOLES, RELOCATE AT PREVIOUS DEPTH AS DIRECTED IN FIELD. CEASE TO WORK UNTIL DRIVE AT PREVIOUS DEPTH IS ACCEPTABLE. OTHERWISE, NOTES.
- RELOCATE EXISTING SIGNS AND MARKERS AS DIRECTED IN FIELD. REMOVE AND REPAIR AS DIRECTED IN FIELD.
- REMOVE EXIST. SIDEWALK AT FIELD AND REPLACE AS DIRECTED IN FIELD.

REVISIONS		CITY OF RIVERSIDE, CALIFORNIA DEPARTMENT OF PUBLIC WORKS
MARK	DATE	
		<b>FERN AVE - CARY ST. IMPROVEMENT DISTRICT</b>  <b>FERN AVE</b> <b>GRACE ST. to MADISON ST.</b>

DESIGNED BY: [Signature] CHECKED BY: [Signature]  
DRAWN BY: [Signature] RECOMMENDED BY: [Signature]  
ASSISTANT CITY ENGINEER

APPROVED BY: [Signature]  
DIRECTOR OF PUBLIC WORKS

R-431  
DATE: [ ]/ [ ]/ [ ]  
SHEET 1 OF 2

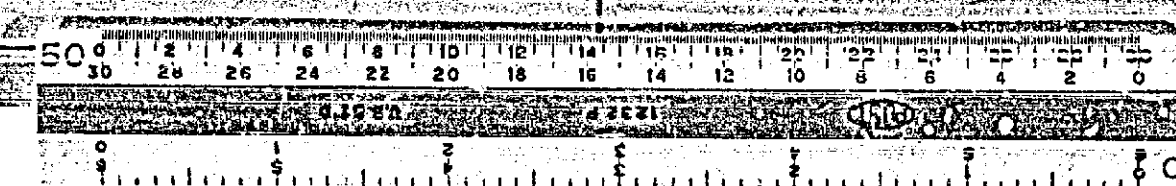

**PROFILE**  
NOTES:  
1. ELEVATIONS ARE IN FEET.  
2. VERTICAL CURVES ARE SHOWN BY DASHED LINES.  
3. GRADES ARE IN PERCENTS.  
4. SEE PLAN FOR STATIONING.

**PLAN**  
NOTES:  
1. ALL DIMENSIONS ARE IN FEET.  
2. SEE PROFILE FOR ELEVATIONS.  
3. SEE GENERAL NOTES FOR CONSTRUCTION DETAILS.

FIELD BOOKS:  
1911 ACT No 6/40  
BENCH MARKS:  
5' x 1" IN EASTWOOD CURB MEDIAN ST. SOUTHERLY OF FERN, ELEV. 880.05  
" ON FIRE HYDRANT SOUTH EAST CORNER OF FERN & CARY, ELEV. 881.84  
" ON FIRE HYDRANT SOUTH EAST CORNER OF FERN & GRACE, ELEV. 881.01

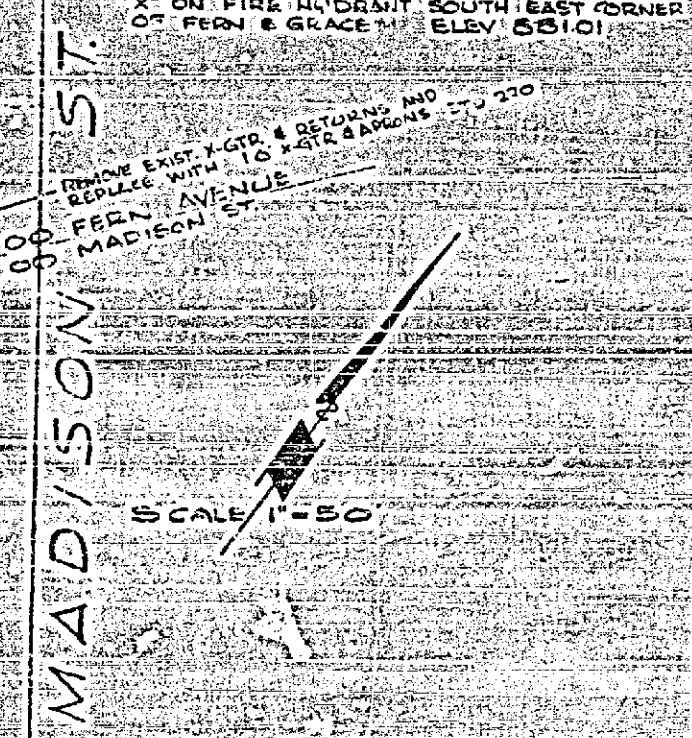

APPROVED BY: [Signature]  
DATE: [ ]/ [ ]/ [ ]

DWG No. 260-220-A



PLATE 1: PLAN PROFILE OF H.A.R. STANBARD  
 REVISED & REDESIGNED  
 H.A.R. STANBARD ENGINEERING CO., NEW YORK

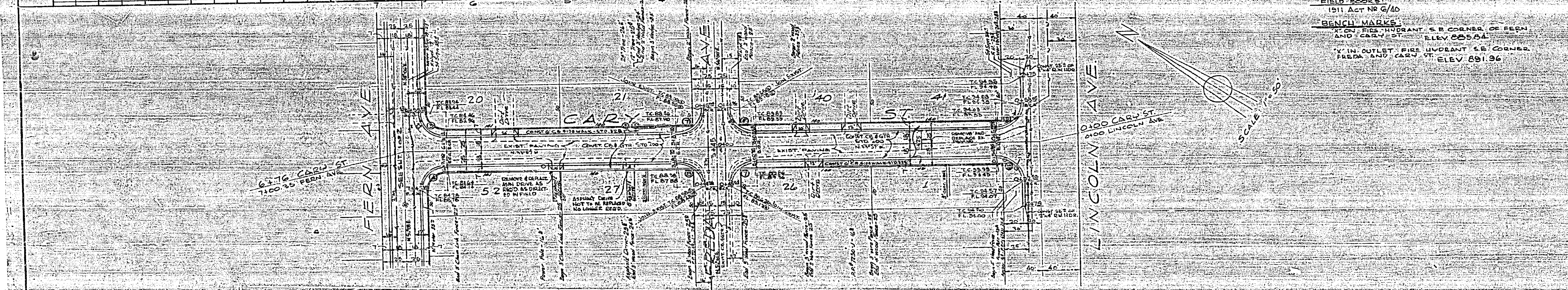
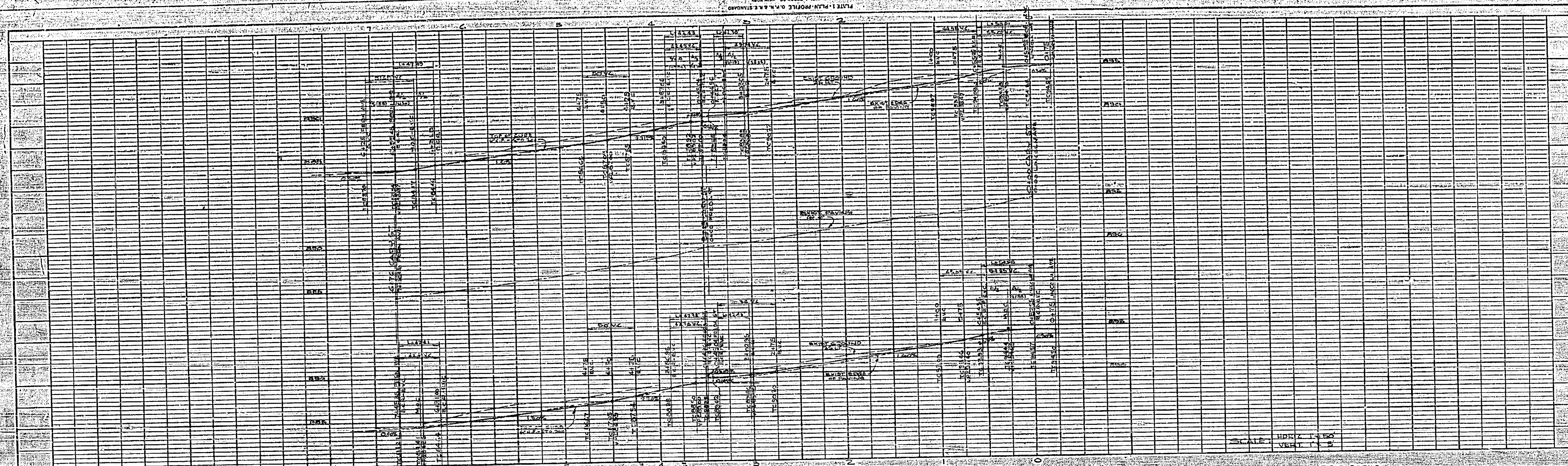

FIELD BOOKS -  
 1911 ACT NR 6/40  
 BENCH MARKS -  
 1. ON FIRE HYDRANT S.E. CORNER OF FERN  
 AND CARY ST. ELEV 855.84  
 2. IN OUTLET FIRE HYDRANT S.E. CORNER  
 FERN AND CARY ST. ELEV 851.96

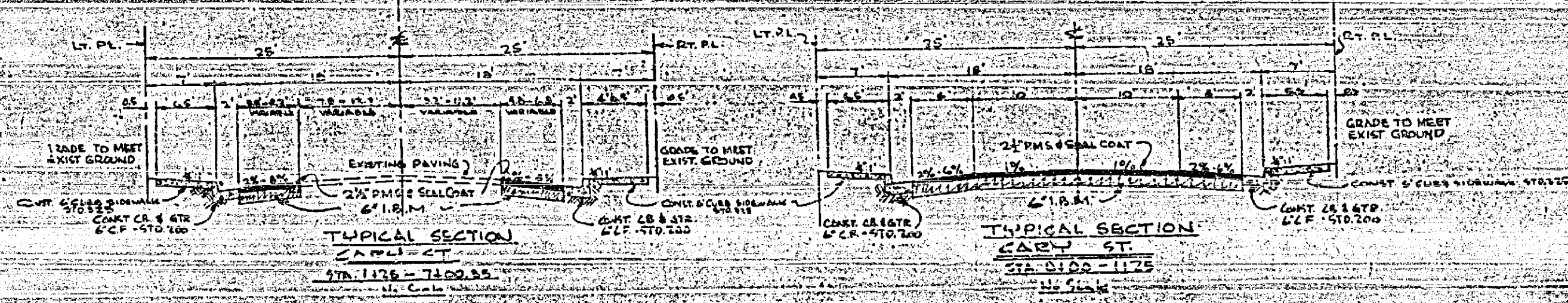
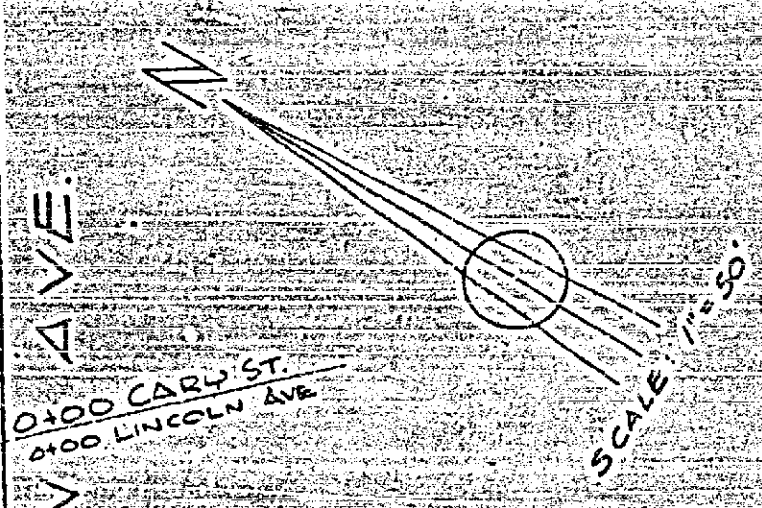

NO.	R.	START	END	L.
3	27	65° 57' 00"	22.98	42.35
4	27	30° 00' 00"	27.00	42.41
7	27	30° 02' 30"	27.02	42.43
8	27	65° 54' 30"	24.99	42.38
9	25	30° 03' 00"	25.03	52.01
10	25	65° 57' 00"	24.97	54.55

SEE SHEET 1 FOR GENERAL NOTES

REVISIONS			CITY OF RIVERSIDE, CALIFORNIA DEPARTMENT OF PUBLIC WORKS
MARK	DATE	DESCRIPTION	

**CARY ST.  
FERN AVE. & LINCOLN AVE**

DESIGNED BY J.L.	CHECKED BY J.L.	APPROVED BY R. J. [Signature]	2-431
DRAWN BY [Signature]	RECOMMENDED BY [Signature]	DIRECTOR OF PUBLIC WORKS	
ASSISTANT CITY ENGINEER			SHEET 2 OF 2

NO.	DATE	DESCRIPTION

NO.	DATE	DESCRIPTION

Dwg No. 60-220A