

GENERAL NOTES

- NO PERSON SHALL PERFORM ANY CONSTRUCTION ACTIVITY OR INSTALL ANY OBJECTS WITHIN PUBLIC RIGHTS-OF-WAY OR EASEMENTS OF THE CITY OF RIVERSIDE WITHOUT A VALID CONSTRUCTION PERMIT OR A STREET OPENING PERMIT OR AN ENCROACHMENT PERMIT ISSUED BY THE CITY'S PUBLIC WORKS DEPARTMENT.
- IT SHALL BE THE RESPONSIBILITY OF THE CONTRACTOR TO CLEAR THE RIGHT-OF-WAY IN ACCORDANCE WITH THE PROVISIONS OF LAW AS IT AFFECTS THE EACH UTILITY INCLUDING IRRIGATION LINES AND APPURTENANCES AND AT NO COST TO THE CITY.
- CONSTRUCTION SHALL BE IN ACCORDANCE WITH THE CITY OF RIVERSIDE DEPARTMENT OF PUBLIC WORKS STANDARD DRAWINGS, ITS SUPPLEMENTAL NOTES, AND THE STANDARD SPECIFICATIONS FOR PUBLIC WORKS CONSTRUCTION, CURRENT EDITION.
- THE PRIVATE ENGINEER SIGNING THESE PLANS IS RESPONSIBLE FOR ASSURING THE ACCURACY AND ACCEPTABILITY OF THE WORK HEREON. IN THE EVENT OF DISCREPANCIES ARISING DURING CONSTRUCTION, THE PRIVATE ENGINEER SHALL BE RESPONSIBLE FOR DETERMINING AN ACCEPTABLE SOLUTION AND REVISING THE PLANS FOR APPROVAL BY THE CITY.
- THE DEVELOPER SHALL BE RESPONSIBLE FOR PRESERVING OR RE-ESTABLISHING AND REFERENCING SURVEY MONUMENTS DESTROYED, DISTURBED OR BURIED AS A RESULT OF CONSTRUCTION SHOWN HEREON.
- ALL FLAGGED ELEVATIONS SHALL BE STAKED IN THE FIELD BY THE PRIVATE ENGINEER.
- WHERE NEW PAVEMENT IS TO JOIN THE EXISTING PAVEMENT, THE EDGE OF THE EXISTING PAVEMENT SHALL BE TRIMMED IN A SMOOTH AND STRAIGHT LINE. CONSTRUCT MATCH-UP PAVING AS SHOWN ON THE PLANS AND OVERLAY PAVING AS DIRECTED IN THE FIELD TO PRODUCE A SMOOTH SECTION.
- ON ALL AREAS WITHIN PUBLIC RIGHTS-OF-WAY WHERE THE FILL IS ONE (1) FOOT OR GREATER, A LETTER WILL BE REQUIRED FROM THE SOILS ENGINEER CERTIFYING THE COMPACTION OF THE FILL BELOW SUBGRADE, PRIOR TO THE ISSUANCE OF THE CONSTRUCTION PERMIT/CUT SHEETS.
- ALL TRAFFIC SIGNS SHALL BE INSTALLED PRIOR TO THE OPENING THE STREETS TO TRAFFIC.
- ANY TRAFFIC CONTROL STRIPING OBLITERATED AND/OR BADLY WORN DURING CONSTRUCTION SHALL BE RESTORED BY THE CONTRACTOR WITHIN FIVE DAYS AFTER NOTIFICATION OF THE CITY INSPECTORS.
- FINAL STRIPING FOR TRAFFIC CONTROL AND/OR PAVEMENT MARKING TO BE THE RESPONSIBILITY OF THE DEVELOPER.
- THE CONTRACTOR SHALL CALL IN A LOCATION REQUEST TO UNDERGROUND SERVICE ALERT (USA), PHONE #1-800-227-2600, TWO WORKING DAYS BEFORE DIGGING. NO CONSTRUCTION PERMIT WILL BE ISSUED BY THE PUBLIC WORKS DEPARTMENT INVOLVING EXCAVATION FOR UNDERGROUND FACILITIES UNLESS THE APPLICANT HAS BEEN PROVIDED IN INQUIRY IDENTIFICATION NO. BY USA.
- QUANTITIES SHOWN ARE FOR INFORMATION ONLY AND THE CITY OF RIVERSIDE IS NOT RESPONSIBLE FOR THEIR ACCURACY.
- IN PAVEMENT OVERLAY AREAS, ANY DISTRESSED EXISTING PAVEMENT SHALL BE REMOVED AND REPLACED AS DIRECTED BY THE INSPECTOR PRIOR TO OVERLAYING WITH A.C. PAVEMENT.
- EXISTING UTILITIES SHOWN ON THE PLAN ARE PLOTTED FROM UTILITY RECORDS. THE CONTRACTOR IS REQUIRED TO TAKE DUE PRECAUTIONARY MEASURES TO LOCATE AND PROTECT ALL UTILITIES WHETHER OR NOT SHOWN ON THIS PLANS.

WORK TO BE DONE

THESE IMPROVEMENTS CONSIST OF THE FOLLOWING WORK TO BE DONE ACCORDING TO THESE PLANS, THE CURRENT CITY OF RIVERSIDE STANDARDS AND SPECIFICATIONS AND THE LATEST EDITION OF THE STANDARD SPECIFICATIONS FOR PUBLIC WORK CONSTRUCTION ('GREEN BOOK').

PRIVATE ENGINEER'S NOTE TO CONTRACTOR

ALL CONTRACTORS AND SUBCONTRACTORS PERFORMING WORK SHOWN ON OR RELATED TO THESE PLANS SHALL CONDUCT THEIR OPERATIONS SO THAT ALL EMPLOYEES ARE PROVIDED A SAFE PLACE TO WORK AND THE PUBLIC IS PROTECTED. ALL CONTRACTORS AND SUBCONTRACTORS SHALL COMPLY WITH THE OCCUPATIONAL SAFETY AND HEALTH REGULATIONS OF THE U.S. DEPARTMENT OF LABOR AND THE STATE OF CALIFORNIA DEPARTMENT OF INDUSTRIAL RELATIONS CONSTRUCTION SAFETY ORDERS. THE CIVIL ENGINEER SHALL NOT BE RESPONSIBLE IN ANY WAY FOR THE CONTRACTOR'S AND SUBCONTRACTOR'S COMPLIANCE WITH SAID REGULATIONS AND ORDERS.

CONTRACTOR FURTHER AGREES THAT HE SHALL ASSUME SOLE AND COMPLETE RESPONSIBILITY FOR JOB-SITE CONDITIONS DURING THE COURSE OF CONSTRUCTION OF THIS PROJECT, INCLUDING SAFETY OF ALL PERSONS AND PROPERTY. THAT THIS REQUIREMENT SHALL APPLY CONTINUOUSLY AND NOT BE LIMITED TO NORMAL WORKING HOURS, AND THAT THE CONTRACTOR SHALL DEFEND, INDEMNIFY AND HOLD THE OWNER AND CIVIL ENGINEER HARMLESS FROM ANY AND ALL LIABILITY, REAL OR ALLEGED, IN CONNECTION WITH THE PERFORMANCE OF WORK ON THIS PROJECT, EXCEPTION FOR LIABILITY ARISING FROM THE SOLE NEGLIGENCE OF THE OWNER OR ENGINEER.

THE EXISTENCE AND APPROXIMATE LOCATIONS OF ANY UNDERGROUND UTILITIES OR STRUCTURES SHOWN ON THESE PLANS ARE OBTAINED BY A SEARCH OF THE AVAILABLE RECORDS. THE CIVIL ENGINEER ASSUMES NO LIABILITY AS TO THE EXACT LOCATION OF SAID LINES NOR FOR UTILITY OR IRRIGATION LINES WHOSE LOCATIONS ARE NOT SHOWN. THE CONTRACTOR SHALL BE RESPONSIBLE FOR NOTIFYING ALL UTILITY AND IRRIGATION COMPANIES PRIOR TO WORK OR EXCAVATION TO DETERMINE THE EXACT LOCATIONS OF ALL LINES AFFECTING THIS WORK, WHETHER OR NOT SHOWN HERE ON, AND FOR ANY DAMAGE OR PROTECTION TO THESE LINES.

800 AT 32' LEFT

800 AT 3' LEFT

800 AT 32' LEFT

800 AT 3' LEFT

PROFILE SCALE:

HORIZ: 1"=20'
VERT: 1"=2'

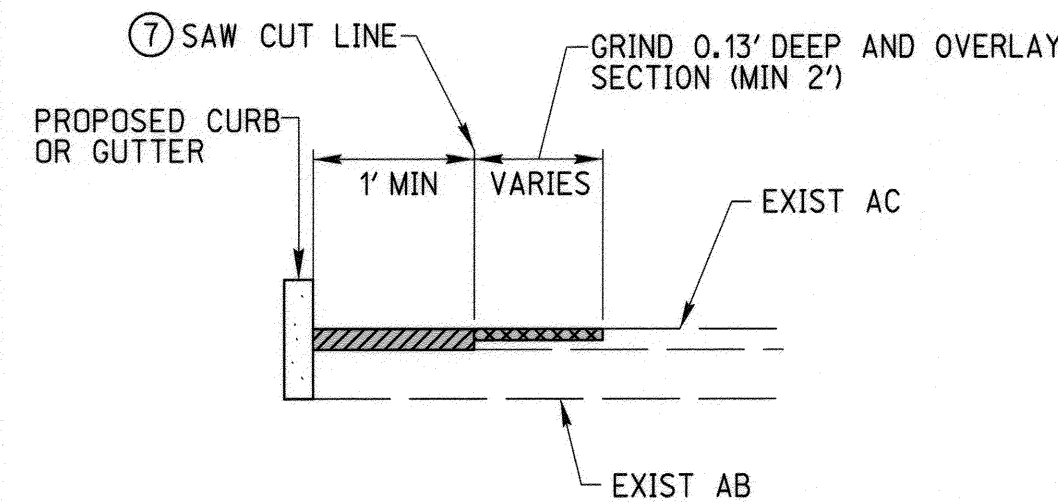

GRIND AND OVERLAY DETAIL

NOT TO SCALE

REFERENCE DRAWINGS

- R-749 (REFERENCE STREET PLANS)
- R-2500 (REFERENCE STREET PLANS)
- R-3441 (REFERENCE STREET PLANS)

LEGEND

- CENTERLINE _____
- EDGE OF PAVEMENT _____
- PROPOSED A.C. PAVEMENT _____
- EXISTING IMPROVEMENTS TO BE REMOVED _____
- GRIND AND OVERLAY _____
- CURB AND GUTTER _____
- EXISTING WATERLINE _____
- EXISTING SEWER _____
- EXISTING ELECTRICAL _____

ABBREVIATIONS

- GRADE BREAK _____ GB
- TOP OF CURB ELEVATION _____ TC
- FINISHED SURFACE ELEVATION _____ FS
- FINISHED GRADE ELEVATION _____ FG
- CENTERLINE _____ CL
- RIGHT-OF-WAY _____ R/W
- EDGE OF PAVEMENT _____ EP
- PLANTER AREA _____ PA

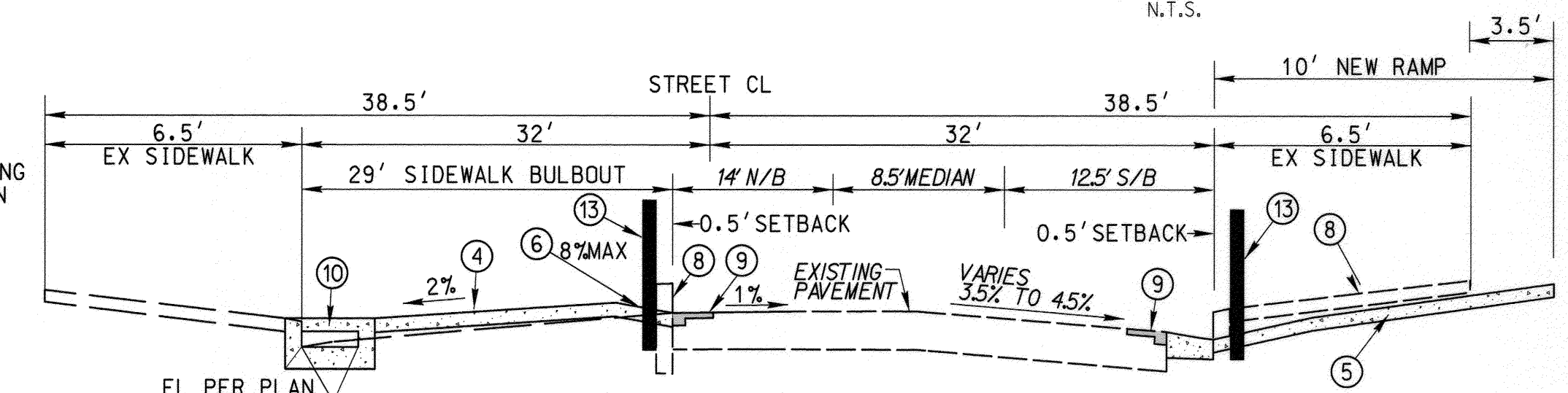
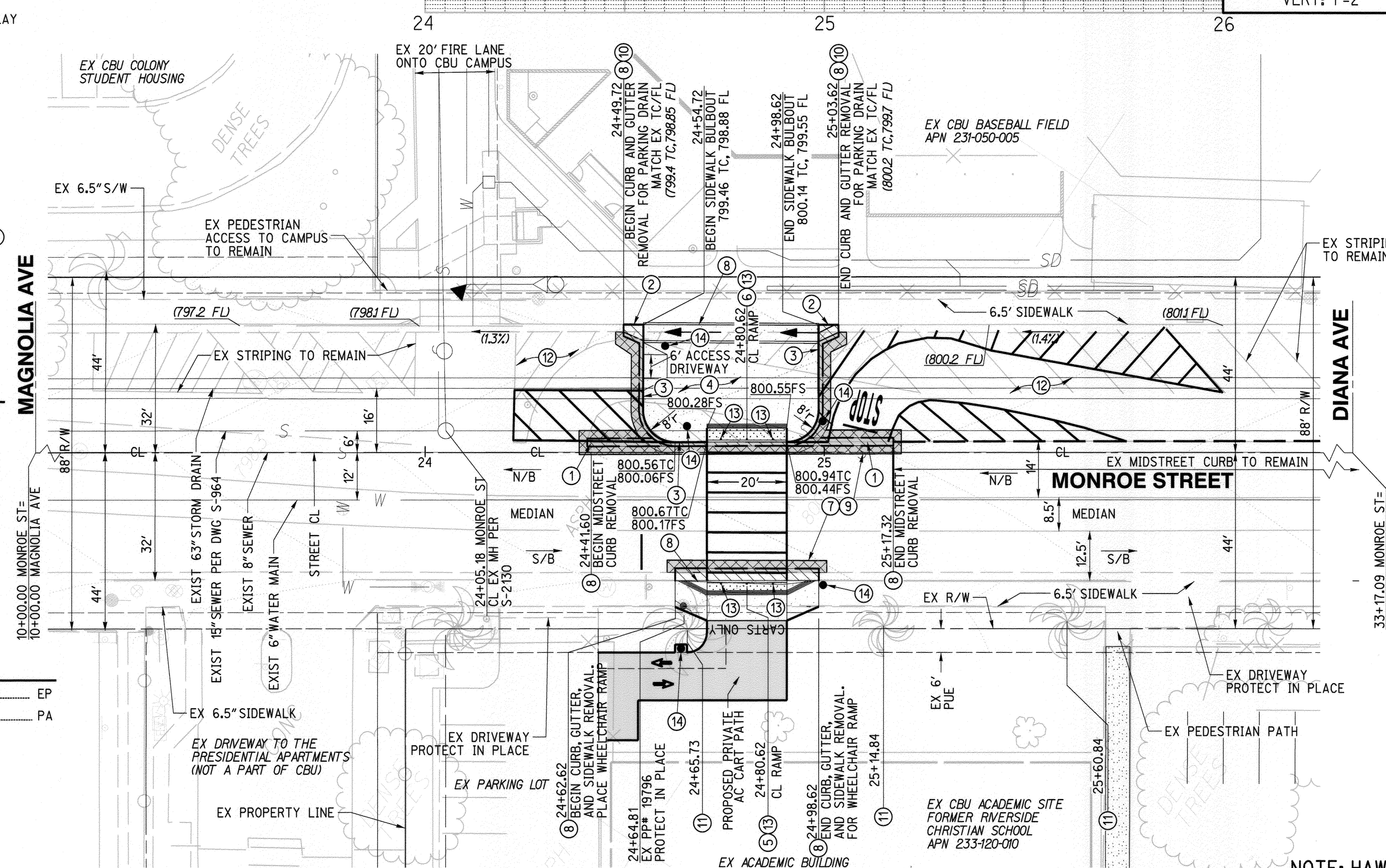

MONROE STREET TYPICAL SECTION

SECTION IS LOOKING (UPSTATION)
24+62.72 TO 24+90.62
NOT TO SCALE

CONSTRUCTION NOTES AND QUANTITY ESTIMATES

- PLACE 2 1/2" AC OVER 6" CLASS II AGGREGATE BASE PER SOILS REPORT #1091: R VALUE 59 400 SF (REF STREET IMP PLAN R-2500)
- CONSTRUCT 6" CURB AND GUTTER TYPE I PER CITY OF RIVERSIDE STD 200 95 LF
- CONSTRUCT 6" CURB TYPE II PER CITY OF RIVERSIDE STD 200 10 LF
- CONSTRUCT SIDEWALK PER CITY OF RIVERSIDE STD 325 1,300 SF
- CONSTRUCT WHEELCHAIR RAMP PER CITY OF RIVERSIDE STD DWG NO 304 (TYPE IIA) 1 EA
- CONSTRUCT WHEELCHAIR RAMP PER CITY OF RIVERSIDE STD DWG NO 304 (TYPE IV-A) 1 EA
- SAWCUT AND REMOVE EXISTING AC PAVEMENT 230 LF
- REMOVE EXISTING CURB, GUTTER, AND SIDEWALK 90 LF
- GRIND AND OVERLAY PER DETAIL ON THIS SHEET 660 SF
- CONSTRUCT PARKWAY DRAIN PER APWA STD 151-1 (S=4') 44 LF
- PROTECT EX TREE IN PLACE
- EX STRIPING TO BE REMOVED PER STRIPING PLAN XL-737
- PLACE 6" DIAMETER CONCRETE FILLED STEEL BOLLARD SPACED AT 6' O.C. 6 EA
- PROPOSED SIGN, POLE, OR POST PER SIGNAL PLAN X-548 AND SIGNING/STRIPING PLAN XL-737

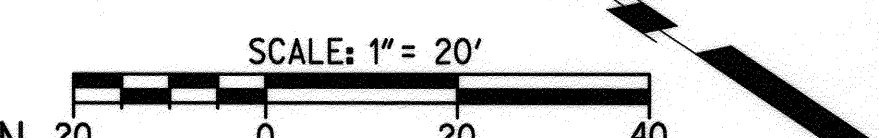

NOTE: HAWK SIGNAL, SIGNING AND STRIPING PER SEPARATE PLAN 20

CITY OF RIVERSIDE
WATER DEPARTMENT
Reviewed for conflicts only

CAUTION:
EXACT LOCATION OF EXISTING UNDERGROUND FACILITIES IS UNKNOWN. CONTRACTOR TO VERIFY IN FIELD.

811
Know what's below.
Call before you dig.
Call at least 2 working days prior to excavating.

REGISTERED PROFESSIONAL ENGINEER
ROBERT A. STOCKTON
No. C033591
Exp. 6-30-16
CIVIL
STATE OF CALIFORNIA

PREPARED UNDER THE DIRECTION OF
ROBERT A. STOCKTON
REGISTERED CIVIL ENGINEER NO. C033591
EXPIRATION DATE 6-30-16

RICK
ENGINEERING COMPANY
1770 IOWA AVENUE, STE. 100
RIVERSIDE, CA 92507
PHONE: (951) 782-0707
FAX: (951) 782-0723
CITY BUSINESS TAX CERTIFICATE NO. 35225 EXP. DATE 7/31/16

MARK	REVISIONS	APPR	DATE
DESIGNED BY	JOB	DRAWN BY	JOB
CHECKED BY	KMW	DATE	10/6/2015

CITY OF RIVERSIDE
PUBLIC WORKS DEPARTMENT
APPROVED BY: [Signature]
PRINCIPAL ENGINEER
TRAFFIC DIVISION
DATE: 10/6/2015

STREET IMPROVEMENT PLAN
MONROE STREET
AT
CALIFORNIA BAPTIST UNIVERSITY
PW15-0432
R-4352
SHEET 1 OF 1
FILE NO.