

RIVERSIDE

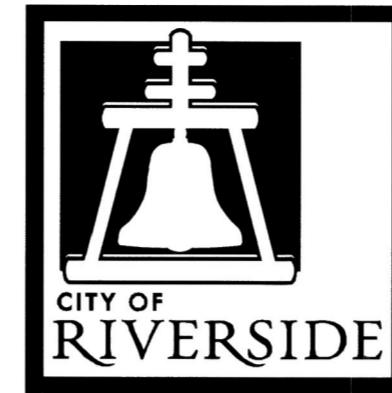

CALIFORNIA

PUBLIC WORKS DEPARTMENT

PALM AVENUE SIDEWALK IMPROVEMENTS

GENERAL NOTES:

1. THE CONTRACTOR SHALL PROVIDE AND MAINTAIN TRAFFIC AS INDICATED IN THE ASSOCIATED PROJECT SPECIAL PROVISIONS.
2. CONSTRUCTION SHALL BE IN ACCORDANCE WITH THE CITY OF RIVERSIDE STANDARD DRAWINGS AND STANDARD SPECIFICATIONS FOR PUBLIC WORKS CONSTRUCTION, 2012 EDITION.
3. EXISTING UTILITIES SHOWN ON THIS PLAN ARE PLOTTED FROM UTILITY RECORDS. THE CONTRACTOR IS REQUIRED TO TAKE DUE PRECAUTIONARY MEASURES TO LOCATE AND PROTECT ALL UTILITIES WHETHER OR NOT SHOWN ON THIS PLAN.
4. CONFLICTING UTILITIES SHOWN WITHIN CONSTRUCTION AREA WILL BE RELOCATED PRIOR TO CONSTRUCTION.
5. ALL STREET PULL BOXES, GATE VALVES, MANHOLES, ETC, AFFECTED BY CONSTRUCTION, SHALL BE ADJUSTED TO THE PROPOSED GRADE.
6. PRIME CONTRACTOR BIDDING THIS WORK SHALL HAVE A CLASS "A" OR "C-8".
7. CONTRACTOR SHALL REMOVE ALL VEGETATION WITHIN ALL SIDEWALK PANELS WITHIN THE PROJECT LIMITS.
8. ALL EXISTING IMPROVEMENTS INCLUDING, BUT NOT LIMITED TO, CURB, GUTTERS, CROSS GUTTERS, SIDEWALK, DRIVEWAYS, PARKWAY CULVERTS, INLETS, ETC, SHALL BE PROTECTED IN PLACE UNLESS OTHERWISE NOTED.
9. EXISTING IRRIGATION SHALL BE PROTECTED OR MODIFIED, INCLUDING FURNISHING NEW MATERIALS, AS NECESSARY TO CONSTRUCT NEW CONCRETE IMPROVEMENTS.
10. ALL FENCE POSTS SHALL BE PROTECTED OR MODIFIED AS NECESSARY IF POST FOUNDATION IS WITHIN A SIDEWALK PANEL THAT HAS BEEN CALLED OUT FOR REPLACEMENT.
11. ADEQUATE FLOW LINES SHALL BE MAINTAINED AT ALL LOCATIONS.
12. CONTRACTOR SHALL GRIND AND OVERLAY EXISTING PAVEMENT AS REQUIRED ADJACENT TO 5% MAX. WHEELCHAIR RAMP BOTTOM LANDING INDICATED ON STANDARD DRAWING NO 304. CONTRACTOR SHALL GRIND AND OVERLAY AS NECESSARY BEYOND LANDING TO JOIN EXISTING PAVEMENT TO PROVIDE A FINISHED JOIN GRADE OF 16% MAXIMUM.
13. CONTRACTOR SHALL RECONSTRUCT EXISTING SIDEWALK OR ADD NEW SIDEWALK PER CITY STANDARD 325 AS NECESSARY TO ADEQUATELY JOIN NEW RAMP TO BE CONSTRUCTED PER CITY STD 304, WHETHER INDICATED OR NOT.
14. COLD MILLING SHALL BE AS DESCRIBED ON THE PLANS AND SPECIAL PROVISIONS OR AS DIRECTED BY THE ENGINEER.
15. ANY DISTRESSED EXISTING PAVEMENT SHALL BE REMOVED AND REPLACED AS DIRECTED BY THE ENGINEER AFTER COLD-MILLING AND PRIOR TO PLACEMENT OF DGAC.

LEGEND:

- PROPOSED PCC
- CM2/DG
- FIRE HYDRANT
- POWER POLE AND LUMINAIRE
- STORM DRAIN CATCH BASIN
- WATER METER

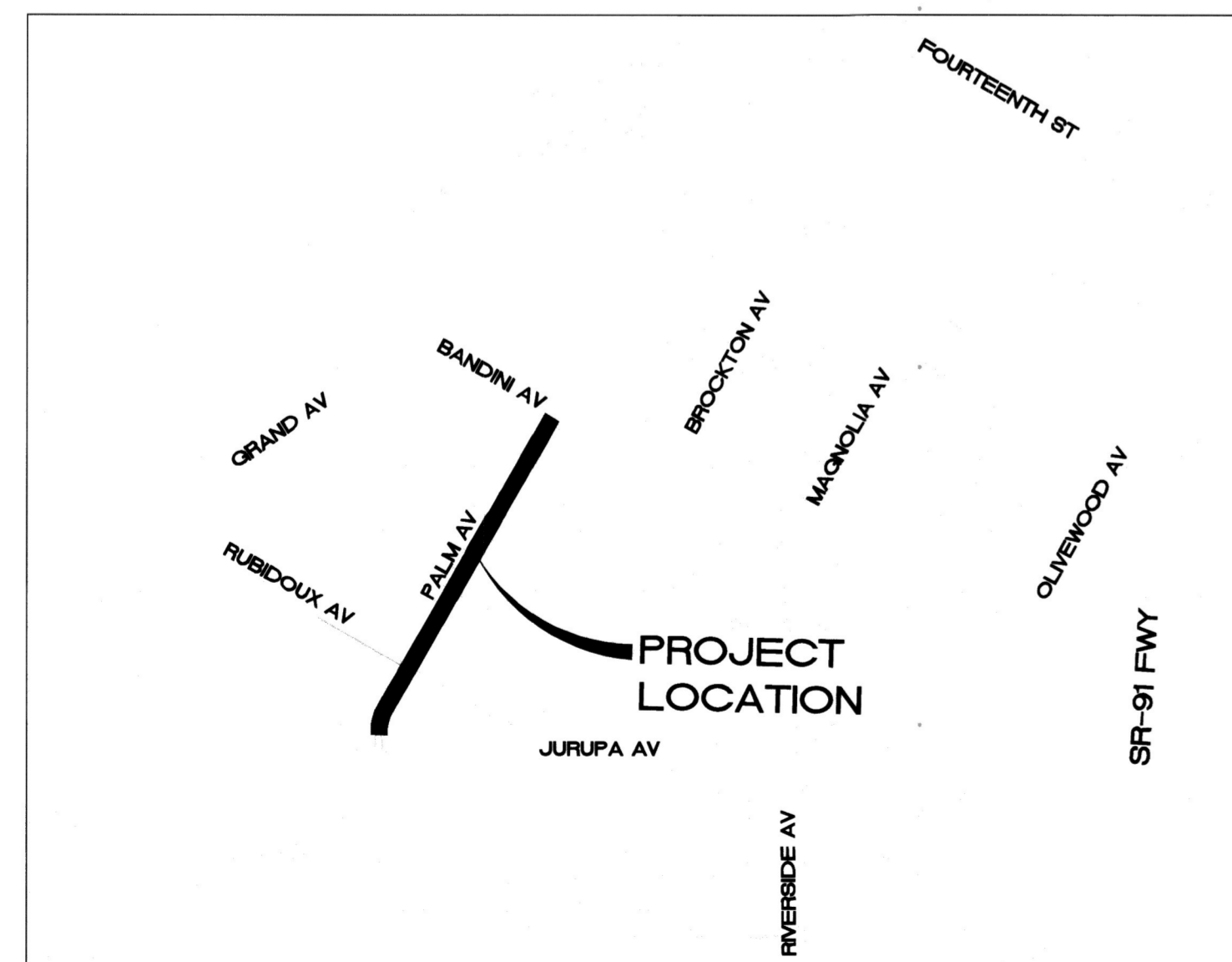

VICINITY MAP

NTS

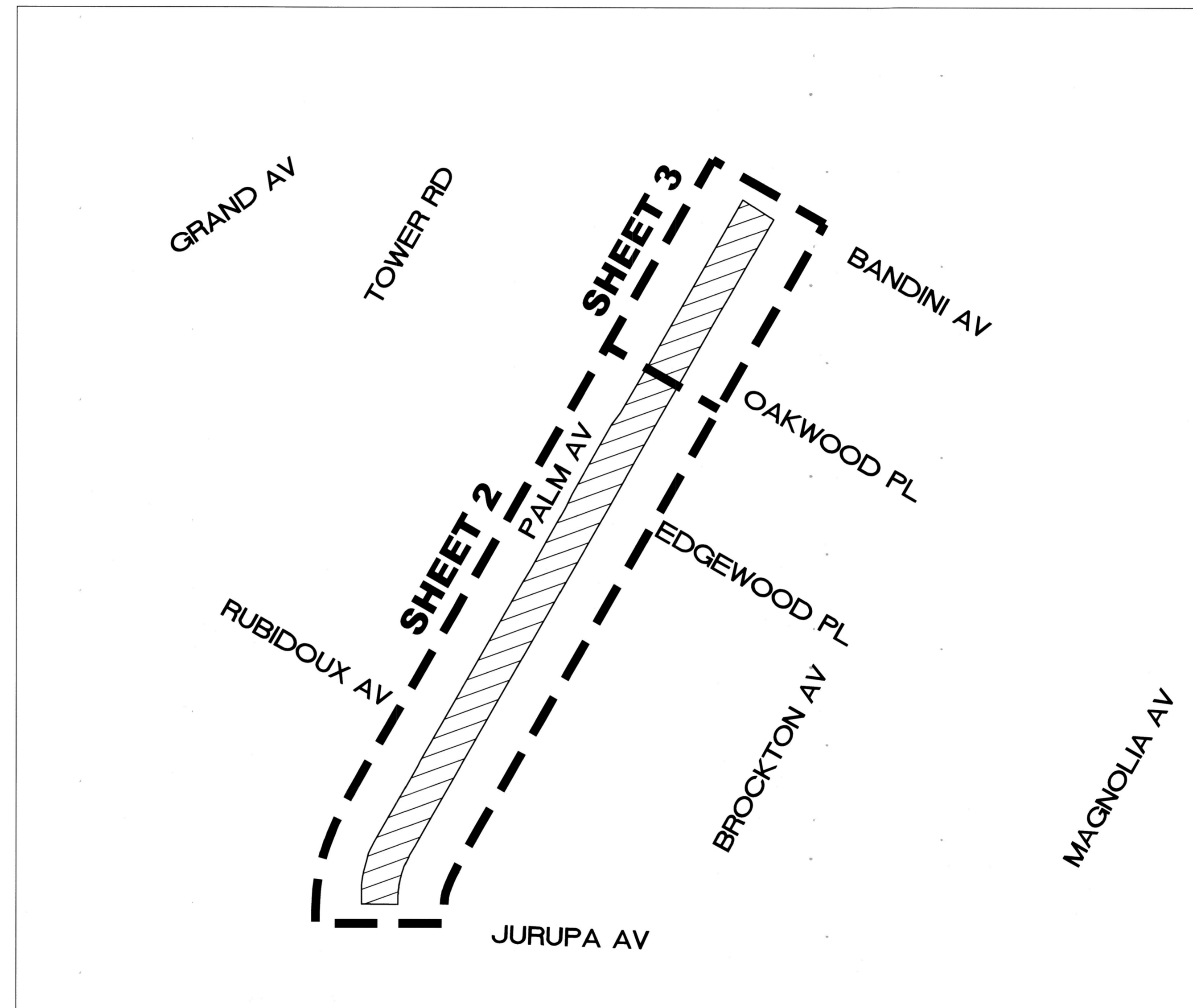

LOCATION MAP

NTS

LEGEND

- PROJECT LOCATION

CONSTRUCTION NOTES:

- REMOVE AND REPLACE IN KIND EXISTING FACILITY. NUMBERS ABOVE 100 IN A HEXAGON ON THE PLAN REFER TO THE RESPECTIVE STANDARD DRAWING AND SHALL BE CONSTRUCTED ACCORDINGLY. ANY NOTE SHOWN BELOW THE STANDARD DRAWING NUMBER INDICATES THE SPECIFIC TYPE, ACTION, OR MODIFICATION TO BE CONSTRUCTED. DIMENSIONS OF NEW FACILITY SHALL BE MODIFIED AS NECESSARY, EXCLUDING ADA REQUIREMENTS, TO MATCH EXISTING FACILITY REMOVED.
- ADJUST TO GRADE, DESCRIPTION PER PLAN (---): (WM) WATER METER. (PB) PULLBOX.
- PROTECT IN PLACE, DESCRIPTION PER PLAN (---): (PP) POWER POLE. (TR) TREE. (PED) ELECTRICAL PEDESTAL. (SGN) SIGN. (WM) WATER METER. (CLF) CHAIN LINK FENCE. (CB) CATCH BASIN. (GUY) GUY WIRE. (FNC) FENCE. (FH) FIRE HYDRANT. (S2) APARTMENT COMPLEX SIGN. REMOVE EXISTING LANDSCAPING AS NECESSARY TO MAINTAIN 1 FT DISTANCE BETWEEN SIGN AND PROPOSED SIDEWALK. (RMP) PEDESTRIAN RAMP.
- RELOCATE EXISTING TO PROPOSED LOCATION, DESCRIPTION PER PLAN (---): (SL) RELOCATE TRAFFIC SIGNAL PULLBOX OUT OF PROPOSED DRIVEWAY WING. (GUY) GUY WIRE.
- REMOVE EXISTING, DESCRIPTION PER PLAN (---): (T1) CLASS I TREE AND ROOTS. (T2) CLASS II TREE AND ROOTS. (TR) TREE AND ROOTS LESS THAN 6" IN DIAMETER AS DEFINED IN SPECIAL PROVISIONS. (SHR) SHRUB. (BDR) LANDSCAPE BORDER. (GRV) GRAVEL. (CCT) CACTUS. (CON) PORTLAND CEMENT CONCRETE, SAWCUT AS NECESSARY.
- CONSTRUCT CURB AND GUTTER PER CITY STD 200 WITH THE FOLLOWING TYPE (---): (I) = TYPE I. (M1) = TYPE I WITH PERVIOUS CONCRETE GUTTER.
- CONSTRUCT DRIVEWAY PER CITY STD 302 WITH THE FOLLOWING TYPE (---): (PL1) = TYPE PL-1. (C1) TYPE CURB-1. (M1) = CONSTRUCT FRONT 2' SECTION AT 5% SLOPE. MATCHUP 4' SECTION WITH EXISTING CONCRETE 6' BEHIND BACK OF CURB AT SLOPE NO GREATER THAN 2%. (M2) = CONSTRUCT 2' AND 4' SECTIONS AT NO GREATER THAN 2% SLOPE TO MATCHUP WITH EXISTING CONCRETE 6' BEHIND BACK OF CURB. (M3) = CONSTRUCT SHARED DRIVEWAY PER DIMENSIONS NOTED ON PLAN. CONSTRUCT RETAINING CURB BETWEEN EXISTING DRIVEWAYS. CONSTRUCT INDIVIDUAL DRIVEWAY MATCHUP AS SHOWN.
- CONSTRUCT PEDESTRIAN RAMP PER CITY STD 304 OR WITH THE FOLLOWING MODIFICATION (---): (M1) = TYPE I MODIFIED TO CONSTRUCT RAMP AND SOUTHERLY WING ONLY. CONSTRUCT RETAINING CURB ON NORTH SIDE OF RAMP AS NECESSARY. (M2) = TYPE I ROTATED EASTERLY AROUND CURB RADIUS TO PROTECT EXISTING CATCH BASIN IN PLACE. (M3) = TYPE IV-A ROTATED EASTERLY AROUND CURB RADIUS TO PROTECT EXISTING CATCH BASIN IN PLACE. (M4) = TYPE IV-A ROTATED EASTERLY AROUND CURB RADIUS AND MODIFIED TO CONSTRUCT NORTHERLY WING ONLY. CONSTRUCT RETAINING CURB ON SOUTH SIDE OF RAMP AS NECESSARY. (M5) = TYPE V MODIFIED TO CONSTRUCT NORTHERLY WING ONLY. CONSTRUCT RETAINING CURB ON SOUTH SIDE OF RAMP AS NECESSARY TO PROTECT EXISTING TRAFFIC SIGNAL POLE AND PULLBOXES IN PLACE.
- CONSTRUCT SIDEWALK PER CITY STD 325 WITH THE FOLLOWING TYPE OR MODIFICATION (---): (CRB) = CONSTRUCT CURBSIDE SIDEWALK PER STD. PLANS. (RET) = CONSTRUCT RETAINING CURB BEHIND SIDEWALK. INCLUDES CURB HEIGHTS UP TO 18". (M1) = JOIN WITH EXISTING 5' WIDE PROPERTY LINE SIDEWALK AND TRANSITION TO 6' WIDE CURBSIDE SIDEWALK. (M2) = CONSTRUCT 4.5' WIDE CURBSIDE SIDEWALK. CONSTRUCT RETAINING CURB AS NOTED ON PLANS.
- COLD MILL 0.12' OF EXISTING AC PAVEMENT.
- OVERLAY EXISTING PAVEMENT SECTION WITH DGAC AT VARIABLE DEPTH ASPHALT REPLACEMENT TO PROVIDE SMOOTH TRANSITION TO MATCH EXISTING PAVEMENT SURFACE AND PROPOSED CURB AND GUTTER ELEVATION.
- TRIM EXISTING TO PROVIDE ACCESS FOR PROPOSED IMPROVEMENTS, DESCRIPTION PER PLAN (---): (HDG) HEDGE. (TR) TREE.
- PLANT NEW TREE AS DESCRIBED IN SPECIAL PROVISIONS.
- CONSTRUCT NEW SLOPED WALKWAY TO MATCHUP WITH EXISTING WALKWAY.
- REMOVE EXISTING STREET NAME SIGN. INSTALL NEW STREET NAME SIGN PER CITY STD. 662.

SHEET INDEX

SHEET NO.	SHEET NAME (LIMITS)
1	VICINITY MAP, LOCATION MAP, GENERAL NOTES, AND CONSTRUCTION NOTES
2	PALM AVENUE SIDEWALK IMPROVEMENTS (JURUPA AVENUE TO OAKWOOD PLACE)
3	PALM AVENUE SIDEWALK IMPROVEMENTS (OAKWOOD PLACE TO BANDINI AVENUE)

Under Ground Service Alert of Southern California
Call: TOLL FREE 1-800-227-2600
TWO WORKING DAYS BEFORE YOU DIG



ENGINEER IN RESPONSIBLE CHARGE

Thuy Nguyen
R.C.E. No. 64751 EXPIRES: 6-30-17
DATE: 11/01/17

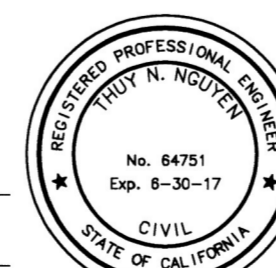

MARK	REVISIONS	APPR.	DATE

CITY OF RIVERSIDE, CALIFORNIA DEPARTMENT OF PUBLIC WORKS			
APPROVED BY	BY	DATE	APPROVED BY
ENGINEERING MANAGER	SL	6/26/17	CHY-ENGINEER
CONSTRUCTION ADMIN.	DC	7/10/17	
TRAFFIC DIVISION	NM	6/22/17	
STREETS DIVISION			
SURVEY			
DESIGNED BY: BL	DRAWN BY: BL	CHECKED BY: TN	DATE: 7/17/17

SIDEWALK IMPROVEMENTS		DESIGN WORK ORDER NO: 1516644
PALM AVENUE SIDEWALK IMPROVEMENTS		CONSTR. WORK ORDER NO: 1516644
TITLE SHEET		R-4367
HORIZ. SCALE: N/A		VERT. SCALE: N/A
FILE NAME: R4367-01.DWG		

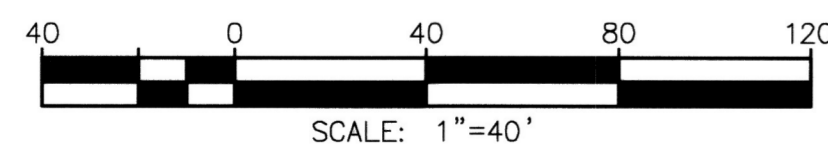
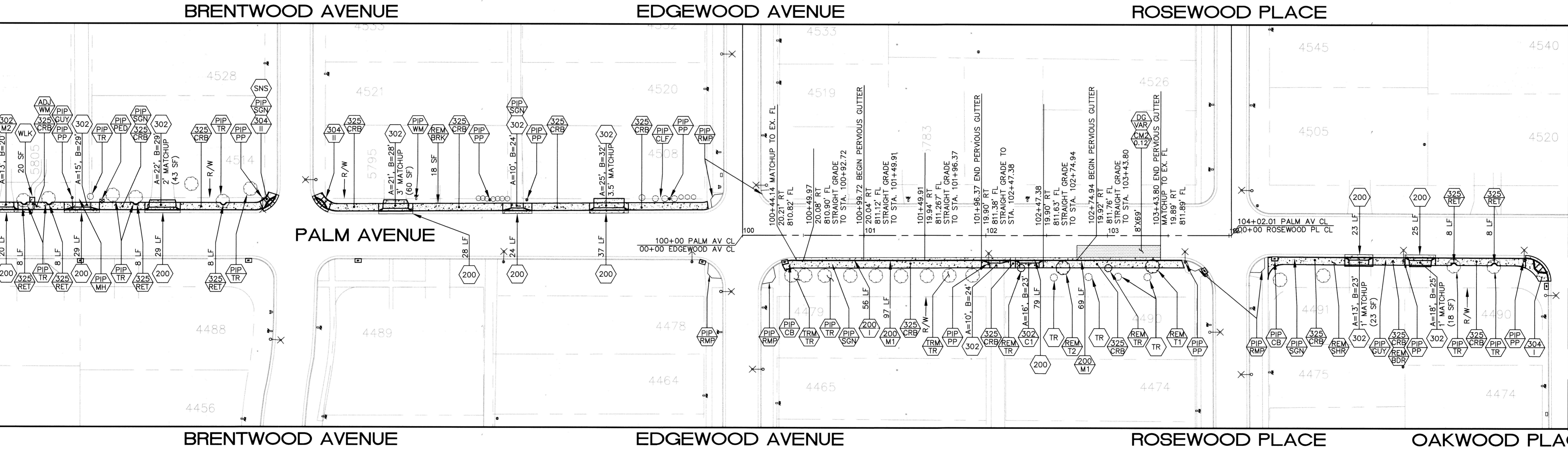
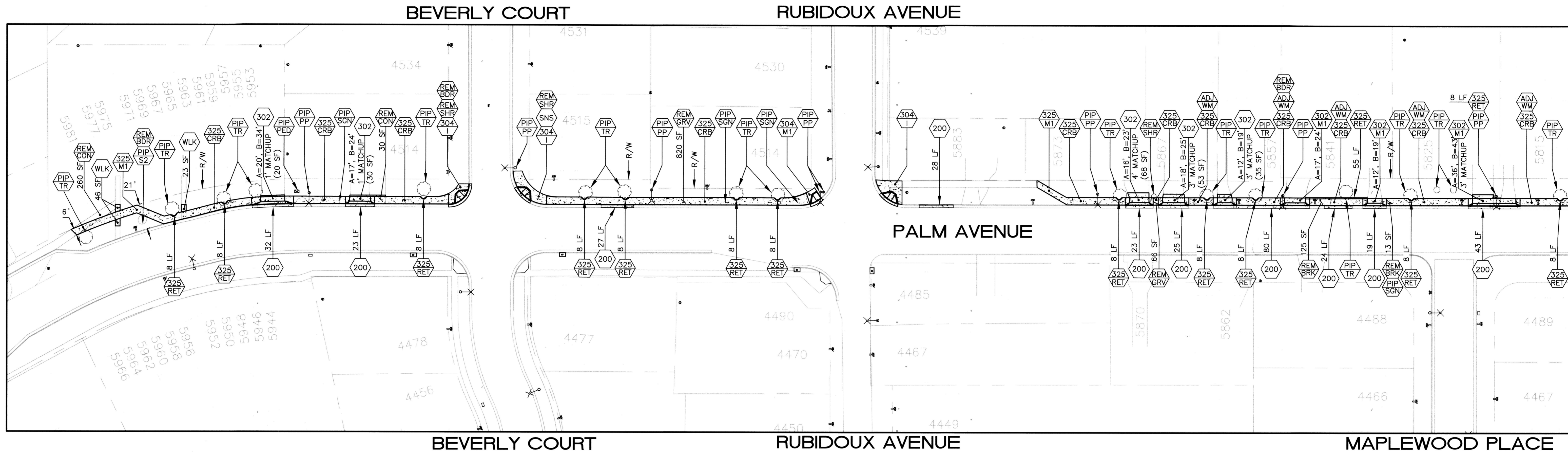

BENCHMARK: H6-H3
 P.K. NAIL AND CITY ENGINEER TAG IN THE SOUTHERLY CURB OF BROCKTON AVENUE 60 FEET EASTERLY OF THE CENTERLINE INTERSECTION OF MAPLEWOOD PLACE AND BROCKTON AVENUE. ELEV - 822.844 (NAVD 29)

Under Ground Service Alert of Southern California
 Call: TOLL FREE 1-800-227-2600
 TWO WORKING DAYS BEFORE YOU DIG



ENGINEER IN RESPONSIBLE CHARGE
Thuy Nguyen
 Thuy Nguyen
 R.C.E. No. 64751 EXPIRES: 6-30-17
 DATE: 11/11/17



MARK	REVISIONS	APPR.	DATE

CITY OF RIVERSIDE, CALIFORNIA
 DEPARTMENT OF PUBLIC WORKS

APPROVED BY	BY	DATE	APPROVED BY
ENGINEERING MANAGER	<i>E.L.</i>	6-26-2017	<i>[Signature]</i>
CONSTRUCTION ADMIN.	<i>DL</i>	7-10-17	CITY ENGINEER
TRAFFIC DIVISION	<i>NM</i>	6-22-17	DATE
STREETS DIVISION			
SURVEY			

DESIGN WORK ORDER NO. 1516644	R-4367
CONSTR. WORK ORDER NO. 1516644	
PALM AVENUE SIDEWALK IMPROVEMENTS	
JURUPA AVENUE TO OAKWOOD PLACE	
HORIZ. SCALE: 1"=40' VERT. SCALE: N/A	
SHEET 2 OF 3	
FILE NAME: R4367-02.DWG	

OAKWOOD PLACE

LINWOOD PLACE

BANDINI AVENUE

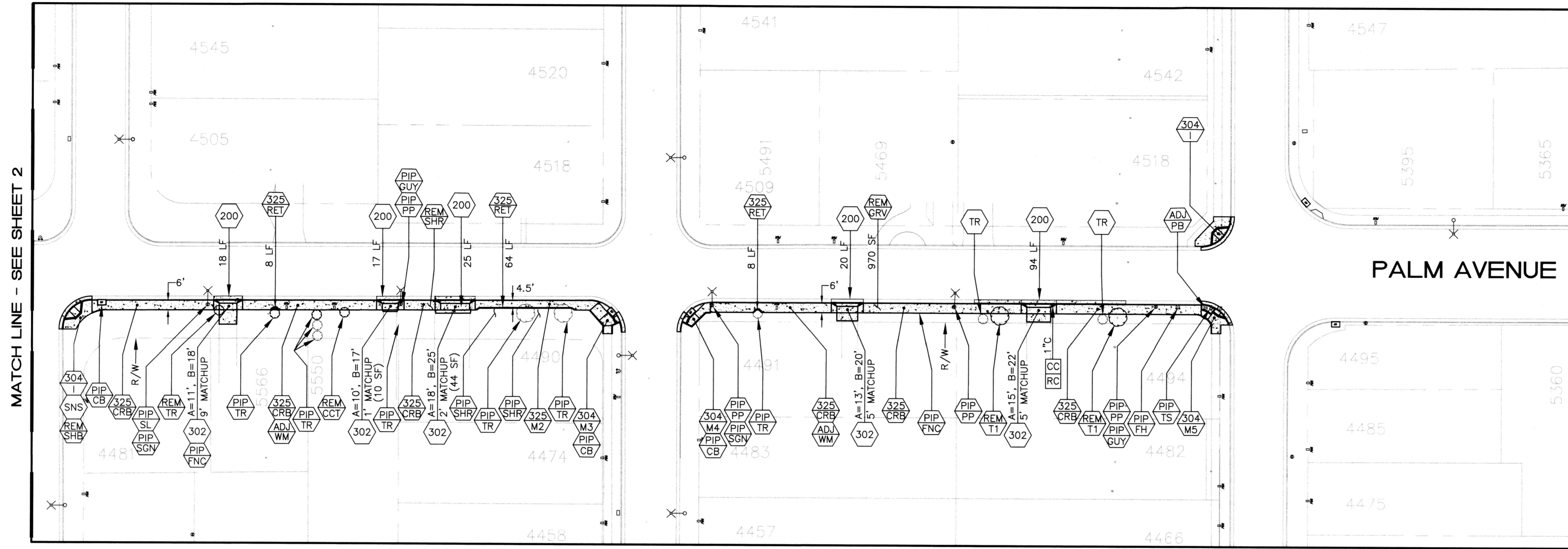

OAKWOOD PLACE

LINWOOD PLACE

BANDINI AVENUE

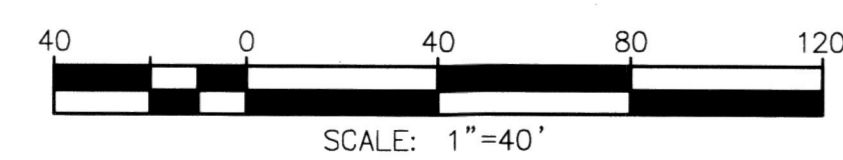
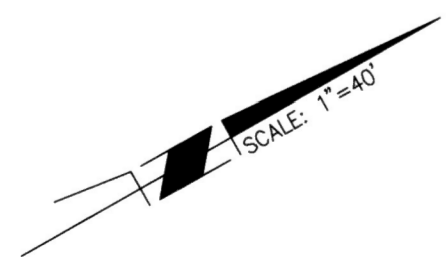

Under Ground Service Alert of Southern California
Call: TOLL FREE 1-800 227-2600
TWO WORKING DAYS BEFORE YOU DIG



ENGINEER IN RESPONSIBLE CHARGE
Thuy Nguyen
R.C.E. No. 64751 EXPIRES: 6-30-17
DATE: 11/17/17



MARK	REVISIONS	APPR.	DATE

CITY OF RIVERSIDE, CALIFORNIA DEPARTMENT OF PUBLIC WORKS			
APPROVED BY	BY	DATE	APPROVED BY
ENGINEERING MANAGER	<i>EL</i>	6-26-2017	<i>[Signature]</i>
CONSTRUCTION ADMIN.	<i>DC</i>	7/18/17	CITY-ENGINEER
TRAFFIC DIVISION	NM	06-21-17	
STREETS DIVISION			DATE: 7/17/17
SURVEY			

SIDEWALK IMPROVEMENTS	
PALM AVENUE SIDEWALK IMPROVEMENTS	
OAKWOOD PLACE TO BANDINI AVENUE	
HORIZ. SCALE: 1"=40'	VERT. SCALE: N/A

DESIGN WORK ORDER NO.: 1516644	CONSTR. WORK ORDER NO.: 1516644
R-4367	
SHEET 3 OF 3	
FILE NAME: R4367-03.DWG	