

# RIVERSIDE

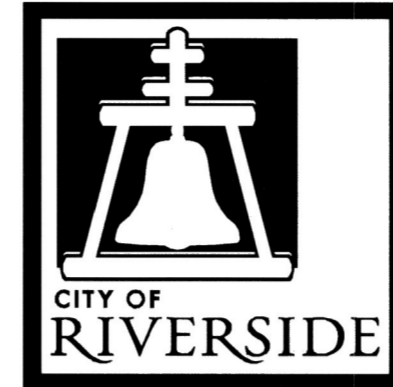

# CALIFORNIA

## PUBLIC WORKS DEPARTMENT

# 2015/2016 CDBG - WARD 6 SIDEWALK IMPROVEMENTS FOR PICKER STREET AT TREY AVENUE A HUD FUNDED PROJECT

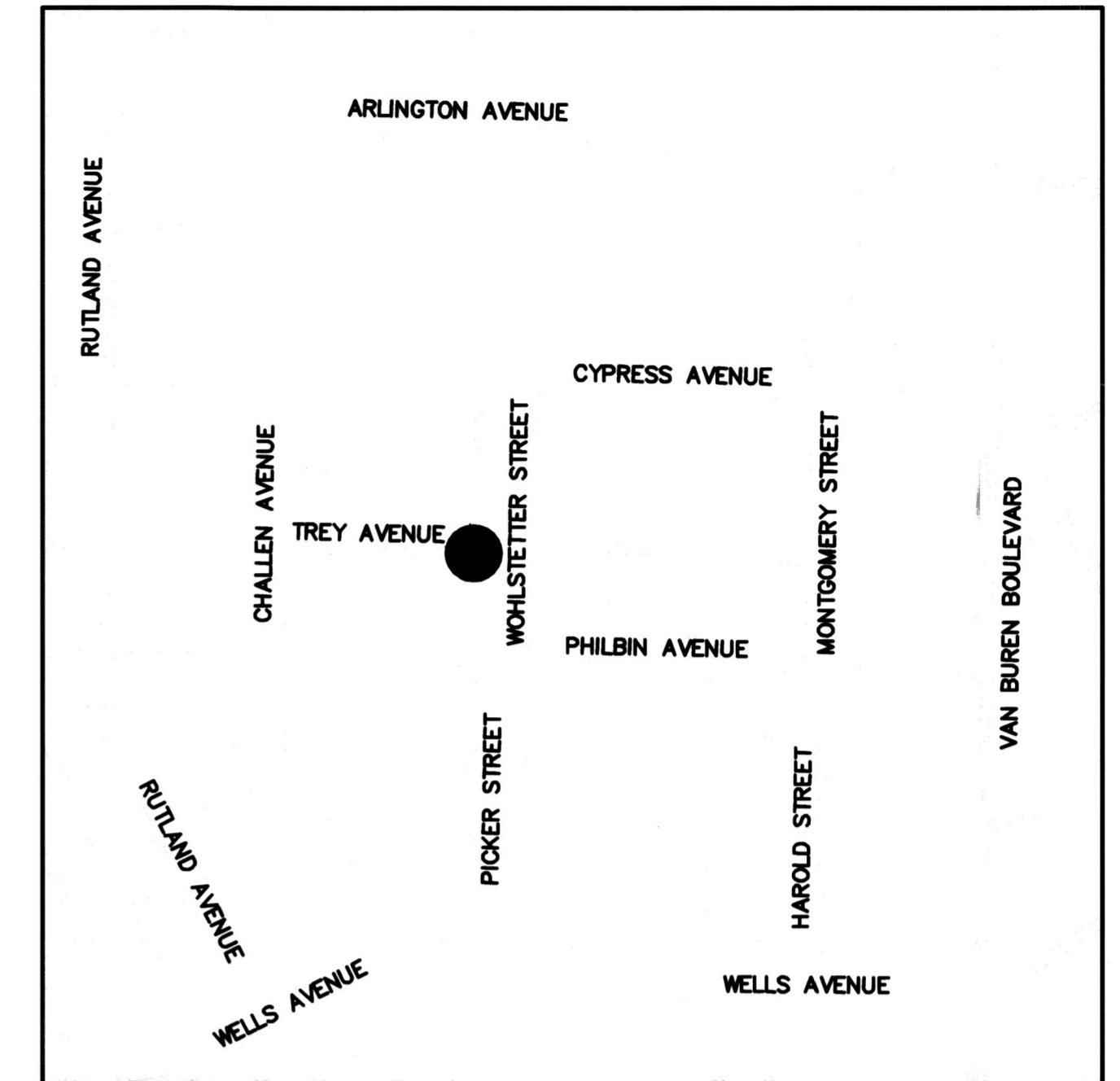

● = PROJECT LOCATION

AREA MAP  
NTS

### GENERAL CONSTRUCTION NOTES:

1. THE CONTRACTOR SHALL PROVIDE AND MAINTAIN TRAFFIC CONTROL AS INDICATED IN THE ASSOCIATED PROJECT SPECIAL PROVISIONS.
2. CONSTRUCTION SHALL BE IN ACCORDANCE WITH THE CITY OF RIVERSIDE STANDARD DRAWINGS AND STANDARD SPECIFICATIONS FOR PUBLIC WORKS CONSTRUCTION, 2012 EDITION.
3. EXISTING UTILITIES SHOWN ON THIS PLAN ARE PLOTTED FROM UTILITY RECORDS. THE CONTRACTOR IS REQUIRED TO TAKE DUE PRECAUTIONARY MEASURES TO LOCATE AND PROTECT ALL UTILITIES WHETHER OR NOT SHOWN ON THIS PLAN.
4. CONFLICTING UTILITIES SHOWN WITHIN CONSTRUCTION AREA WILL BE RELOCATED PRIOR TO CONSTRUCTION.
5. ALL STREET PULL BOXES, AFFECTED BY CONSTRUCTION, SHALL BE ADJUSTED TO THE PROPOSED GRADE.
6. PRIME CONTRACTOR BIDDING THIS WORK SHALL HAVE A CLASS "A" OR "C-8" LICENSE.
7. THE SEAM BETWEEN PASSES OF THE AC OVERLAY SHALL COINCIDE, AS CLOSE AS POSSIBLE, TO THE LANE LINES.
8. COLD MILLING SHALL BE AS DESCRIBED ON THE PLANS AND SPECIAL PROVISIONS OR AS DIRECTED BY THE ENGINEER.
9. ANY DISTRESSED EXISTING PAVEMENT SHALL BE REMOVED AND REPLACED AS DIRECTED BY THE ENGINEERING AFTER COLD-MILLING AND PRIOR TO PLACEMENT OF DGAC.
10. CONTRACTOR SHALL REMOVE ALL VEGETATION WITHIN ALL SIDEWALK PANELS WITHIN THE PROJECT LIMITS.
11. ALL EXISTING IMPROVEMENTS SHOWN HEREON SHALL BE PROTECTED IN PLACE UNLESS OTHERWISE NOTED.
12. EXISTING IRRIGATION SHALL BE PROTECTED OR MODIFIED AS NECESSARY TO CONSTRUCT NEW CONCRETE IMPROVEMENTS.
13. ALL FENCE POSTS SHALL BE PROTECTED OR MODIFIED AS NECESSARY IF POST FOUNDATION IS WITHIN A SIDEWALK PANEL THAT HAS BEEN CALLED OUT FOR REPLACEMENT.

### CONSTRUCTION NOTES:

- REMOVE AND REPLACE IN KIND EXISTING FACILITY OR INSTALL NEW FACILITY. NUMBERS ABOVE 100 IN A HEXAGON ON THE PLAN REFER TO THE RESPECTIVE STANDARD DRAWING AND SHALL BE CONSTRUCTED ACCORDINGLY. ANY NOTE SHOWN BELOW THE STANDARD DRAWING NUMBER INDICATES THE SPECIFIC TYPE, ACTION, OR MODIFICATION TO BE CONSTRUCTED. WHERE NO MODIFICATION OR TYPE IS INDICATED, THE DIMENSIONS OF NEW FACILITY SHALL BE MODIFIED AS NECESSARY, EXCLUDING ADA REQUIREMENTS, TO MATCH EXISTING FACILITY REMOVED.
- PIP --- PROTECT IN PLACE EXISTING FACILITY. DESCRIPTION (---) PER PLAN. PB=PULLBOX, CB=CATCH BASIN, MH=MANHOLE, GV=GATE VALVE.
- 304 M1 CONSTRUCT NEW PEDESTRIAN RAMP PER CITY STD. 304, MODIFY TO HAVE RETAINING CURBS ON EACH SIDE
- REL CLF REMOVE EXISTING SECTION OF CHAIN LINK FENCE FROM THE CORNER, BACK TO THE FIRST EXISTING POST IN EACH DIRECTION. INSTALL A NEW SECTION BETWEEN THESE TWO POSTS TO ACCOMMODATE THE CONSTRUCTION OF THE NEW PEDESTRIAN RAMP.
- REL MB RELOCATE EXISTING BANK OF (3) MAILBOXES OUT OF THE PROPOSED DRIVEWAY.

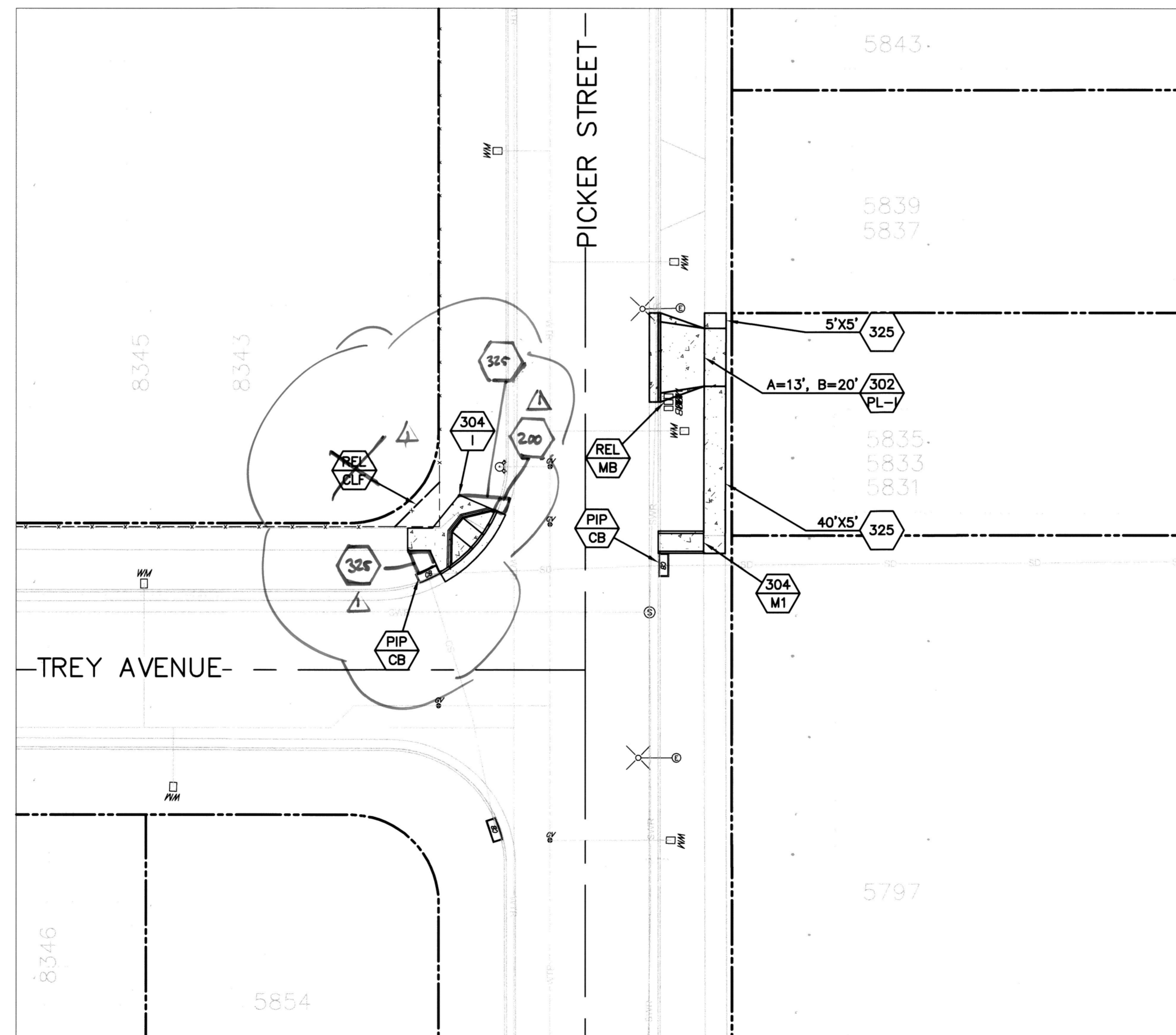

### EXISTING TOPOGRAPHY:

- ⊙ SANITARY SEWER M.H.
- ⊙ STORM DRAIN M.H.
- ⊙ ELECTRIC M.H.
- ⊙ WATER M.H.
- ⊙ GATE VALVE
- ⊙ ELECTRICAL TEST STATION (GAS)
- ⊙ FIRE HYDRANT

### LEGEND:



As Built 5/09/23 B.0

As-Built 7-19-18

	<b>ENGINEER IN RESPONSIBLE CHARGE</b> Deborah Y. Anderson R.C.E. No. 56408 EXPIRES: 6-30-17 DATE 08/25/2016		CITY OF RIVERSIDE, CALIFORNIA DEPARTMENT OF PUBLIC WORKS		DESIGN WORK ORDER NO.: 1624156 CONSTR. WORK ORDER NO.: 1624157
	DESIGNED BY: EL DRAWN BY: DC CHECKED BY: DA	APPROVED BY: <i>FM</i> DATE: 8/29/16 CONSTRUCTION ADMIN. <i>DC</i> DATE: 8-29-16 TRAFFIC DIVISION <i>JK</i> DATE: 8-29-16 STREETS SERVICES SURVEYOR	APPROVED BY: <i>[Signature]</i> DATE: 9/30/16 CITY ENGINEER	SIDWALK IMPROVEMENTS 2015/2016 CDBG - WARD 6 PICKER STREET AT TREY AVENUE TITLE SHEET HORIZ. SCALE: 1"=20' VERT. SCALE: N/A	
			R-4375 SHEET 1 OF 1 FILE NAME: R4375-1.DWG		