

IOWA AVENUE
BETWEEN
CITRUS AVE. and VILLA ST.

ROAD NO. 3038-P WORK ORDER NO.
SURVEY NO. 2869 FIELD BOOK NO. 816

A.G. KEITH, COUNTY SURVEYOR AND ROAD COMMISSIONER
RIVERSIDE COUNTY

SCALE 1" = 50'

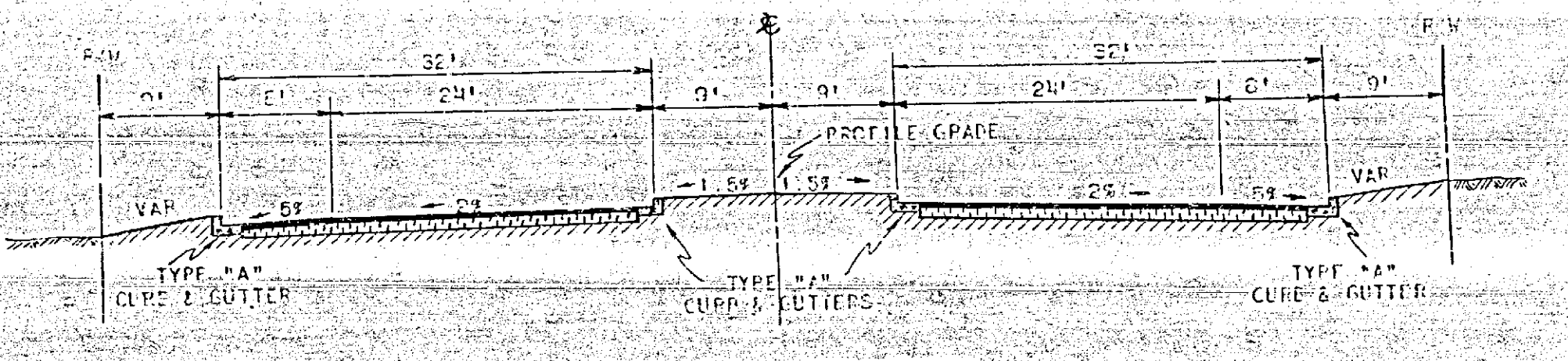
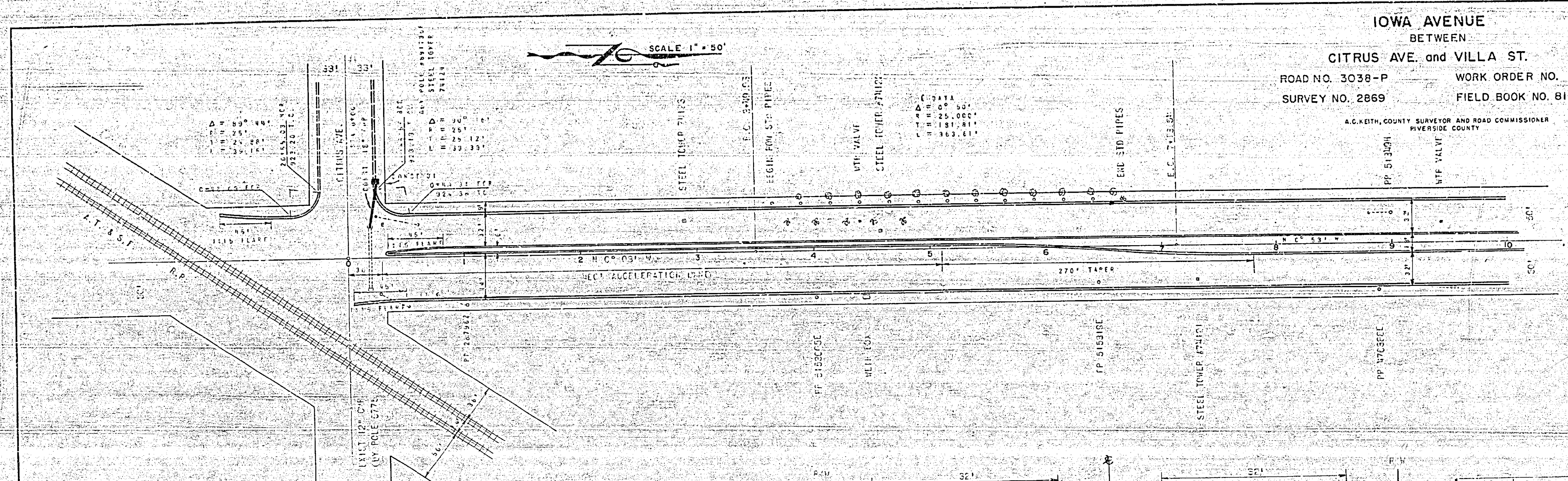

Sta.	0	1	2	3	4	5	6	7	8	9	10	Elev.
930												930
925												925
920												920
Cu. Exc.												
Yds. Emb.												

R-438

SCALE 1" = 50'

IOWA AVENUE
 BETWEEN
 CITRUS AVE. and VILLA ST.
 ROAD NO. 3038-P WORK ORDER NO.
 SURVEY NO. 2869. FIELD BOOK NO. 816
 A.C. KEITH, COUNTY SURVEYOR AND ROAD COMMISSIONER
 RIVERSIDE COUNTY

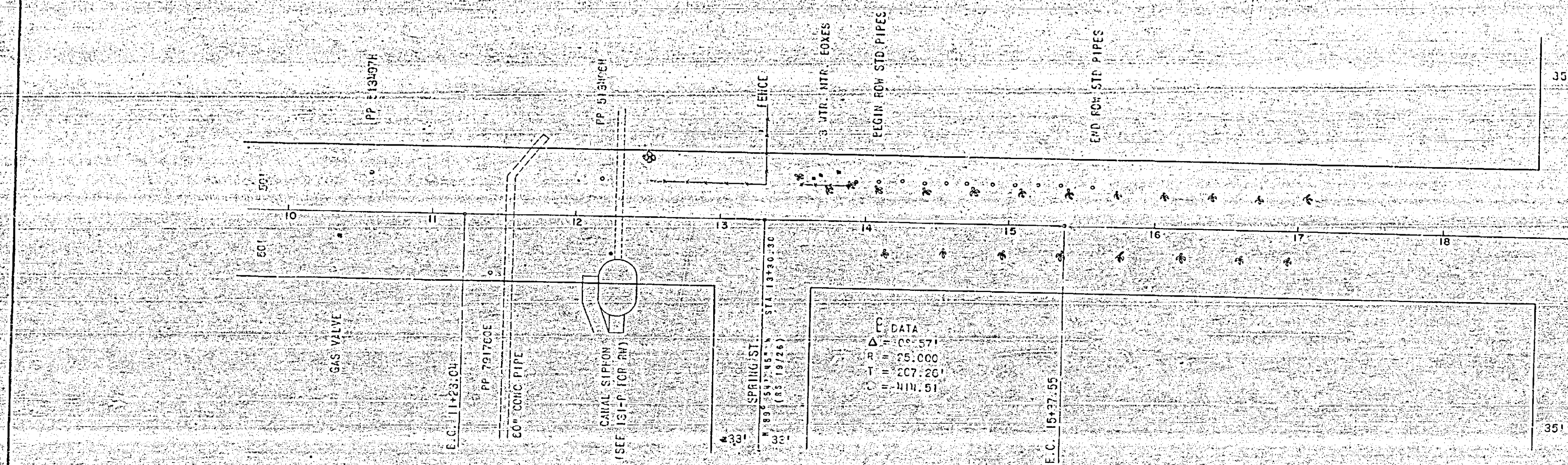

DATA
 Δ = 00.571
 R = 25.000
 T = 207.261
 C = 114.51

Sta.	10	11	12	13	14	15	16	17	18
925									
920									
915									
910									

