

845 CL (EXIST.)

845 CL (EXIST.)

845 EP (EXIST.)

845 EP (EXIST.)

845 TC RIGHT

845 TC RIGHT

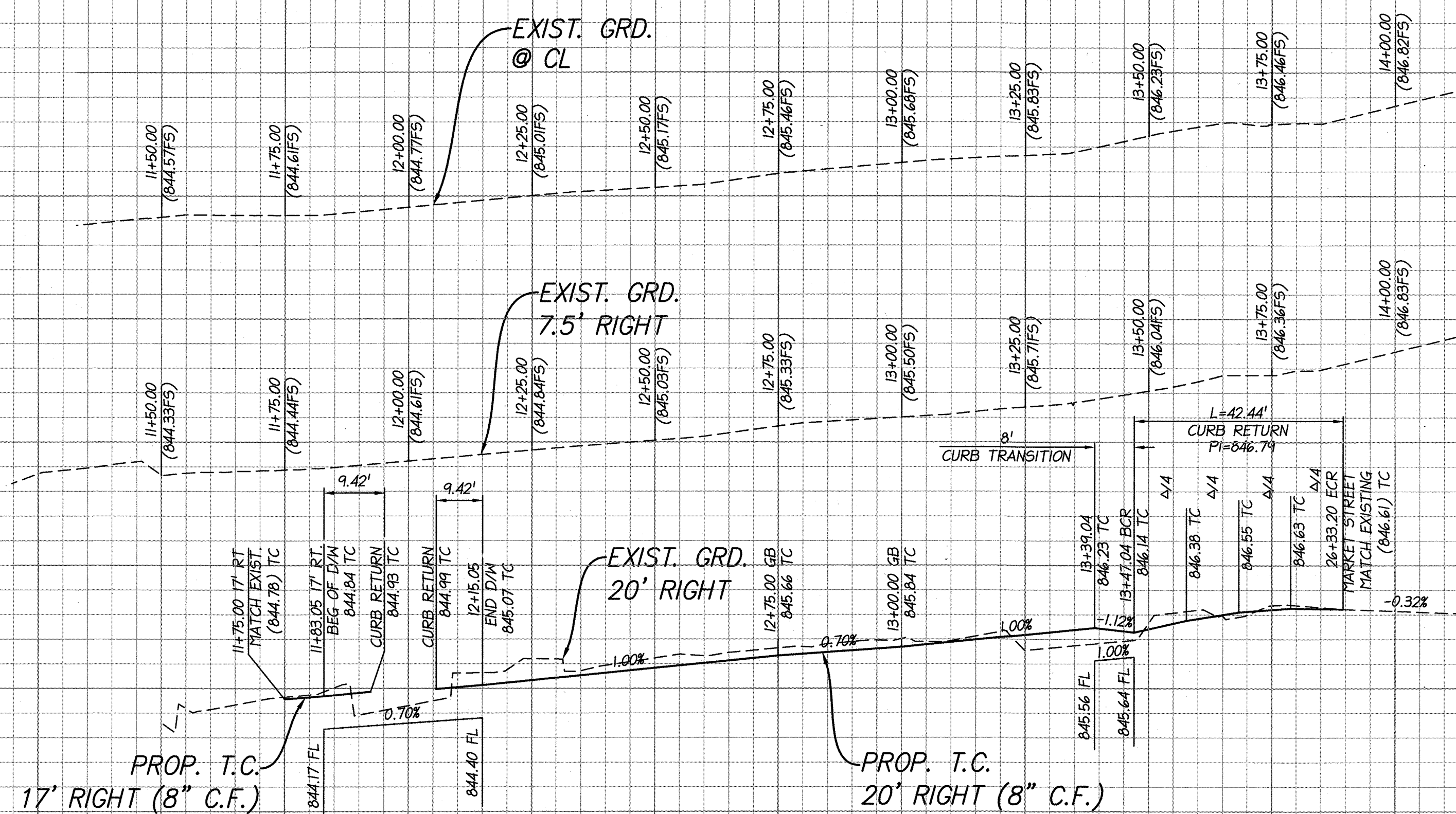

PROFILE SCALE
 HORZ: 1" = 20'
 VERT: 1" = 2'

12 13 14

CONSTRUCTION NOTES

- ① CONSTRUCT _____ A.C. OVER _____ CLASS II AGGREGATE BASE.
- ② CONSTRUCT 8" CURB AND GUTTER TYPE I PER CITY OF RIVERSIDE STD. DWG. NO. 200.
- ③ CONSTRUCT CONCRETE SIDEWALK PER CITY OF RIVERSIDE STD. DWG. NO. 325.
- ④ CONSTRUCT DRIVEWAY APPROACH PER CITY OF RIVERSIDE STD. DWG. NO. 302 (MODIFIED).
- ⑤ CONSTRUCT PEDESTRIAN RAMP PER CITY OF RIVERSIDE STD. DWG. NO. 304 TYPE I.
- ⑥ CONSTRUCT SAWCUT, COLD PLANE AND OVERLAY PER DETAIL ON SHEET 2.
- ⑦ INSTALL LANDSCAPE PER LANDSCAPE ARCHITECT PLANS.
- ⑧ CONSTRUCT 6" CURB AND GUTTER TYPE I PER CITY OF RIVERSIDE STD. DWG. NO. 200.
- ⑨ CONSTRUCT CURB AND GUTTER TYPE I TRANSITION PER CITY OF RIVERSIDE STD. DWG. NO. 210.
- ⑩ REMOVE EXISTING CURB & GUTTER.
- ⑪ CONSTRUCT ALLEY PAVING PER CITY OF RIVERSIDE STD. DWG. NO. 110. _____ A.C. OVER _____ CLASS II AGGREGATE BASE.
- ⑫ EXISTING STREET LIGHT TO BE RELOCATED BY DEVELOPER @ DEVELOPER'S EXPENSE.
- ⑬ EXISTING TREE TO BE PROTECT IN PLACE.
- ⑭ SEWER LATERAL WITH P/L C.O. PER CITY STD. DWG. 562.
- ⑮ EXISTING DRIVEWAY TO BE REMOVED.
- ⑯ SEWER TRENCH BACKFILL PER CITY STD. DWG. 453
- ⑰ RELOCATE TRAFFIC SIGNAL PER TRAFFIC SIGNAL PLAN DWG X-144C.
- ⑱ CONSTRUCT DRIVEWAY APPROACH PER CITY OF RIVERSIDE STD. DWG. NO. 302. A=31', B=45'.

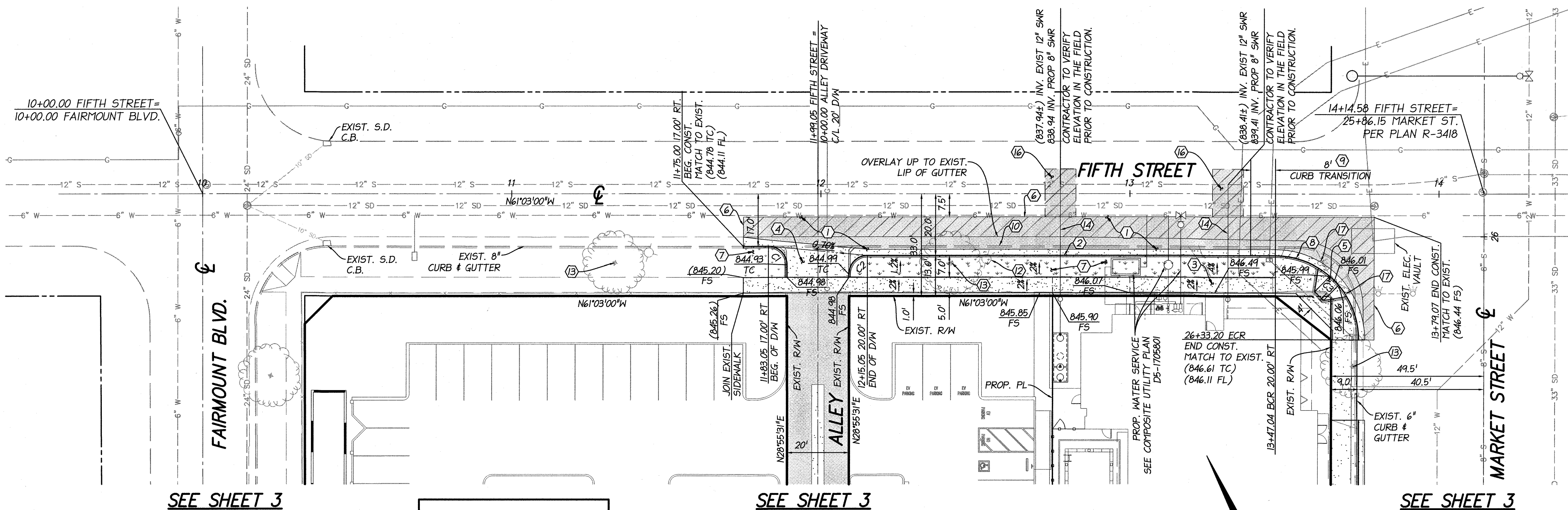

SEE SHEET 3

SEE SHEET 3

SEE SHEET 3

CURVE TABLE			
CURVE #	LENGTH	RADIUS	DELTA
C1	9.42'	6.00'	89°58'31"
C2	9.42'	6.00'	90°01'29"
C3	42.44'	27.00'	90°03'00"

FIFTH STREET

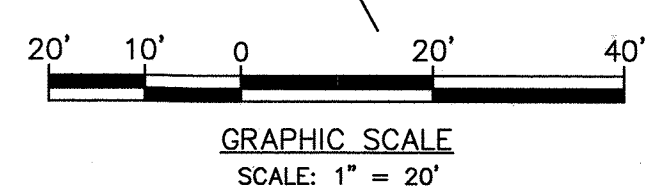

BENCHMARK: 17-13 1929 ELEV. = 854.513
 CITY OF RIVERSIDE
 CHASED SQUARE IN THE TOP OF A CURB AT THE BACK OF THE SIDEWALK AT THE SOUTHEAST CORNER OF ORANGE STREET AND SIXTH STREET.

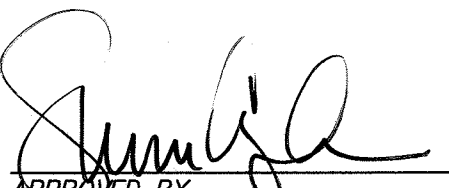
CITY OF RIVERSIDE PUBLIC UTILITIES
 DEPARTMENT—ELECTRIC OVERHEAD & UNDERGROUND

 APPROVED BY ELECTRIC ENGINEERING
 DATE 6-15-17

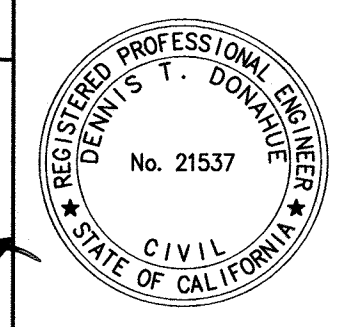
CITY OF RIVERSIDE PUBLIC UTILITIES
 WATER DEPARTMENT REVIEW FOR WATER CONFLICTS

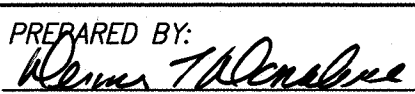
 APPROVED BY WATER ENGINEERING
 DATE 6/15/2017



CITY BUSINESS CERTIFICATE NO. 0021337, EXP. 10/31/2017
PSOMAS
 1500 IOWA AVENUE, SUITE 210
 RIVERSIDE, CA 92507
 (951) 787-8421 WWW.PSOMAS.COM
 PREPARED BY:  R.C.E. NO. 21537
 DATE: 06-13-17

MARK DESIGNED BY _____ DRAWN BY _____ CHECKED BY _____
 REVISIONS _____
 APPR. DATE _____

CITY OF RIVERSIDE, CALIFORNIA PUBLIC WORKS DEPARTMENT
 APPROVED BY _____ BY DATE _____
 ENGINEERING MANAGER _____
 TRAFFIC ENGINEERING _____
 DATE 6/20/17

CITY OF RIVERSIDE STREET IMPROVEMENT PLAN HAMPTON INN FIFTH STREET PLAN AND PROFILE

PW16-0568
 R-4394
 SHEET 2 OF 3
 J.N. 4G9E030100

HORIZ. SCALE: AS NOTED VERT. SCALE: AS NOTED

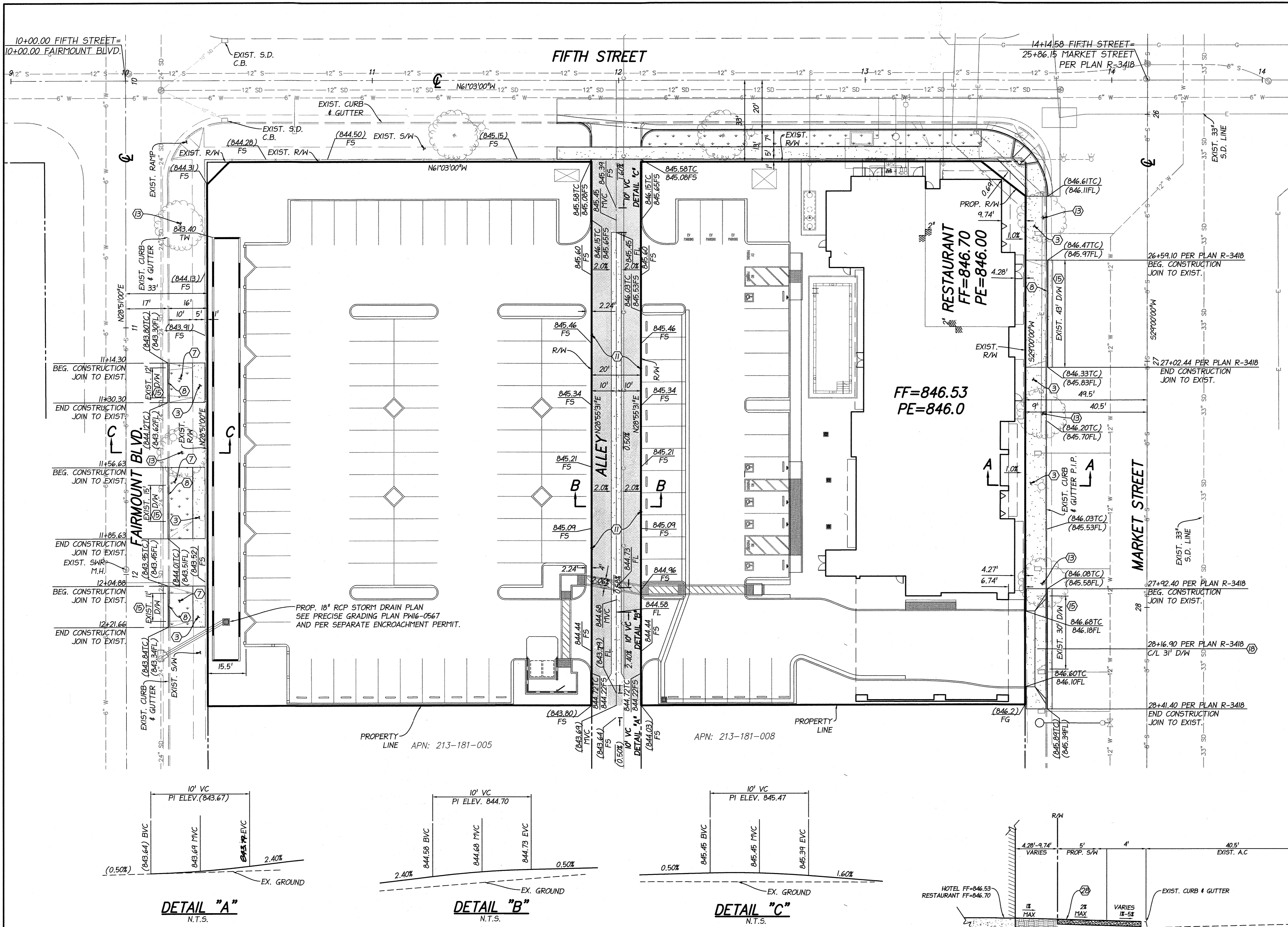

CONSTRUCTION NOTES

- ① CONSTRUCT _____ A.C. OVER _____ CLASS II AGGREGATE BASE.
- ② CONSTRUCT 8" CURB AND GUTTER TYPE I PER CITY OF RIVERSIDE STD. DWG. NO. 200.
- ③ CONSTRUCT CONCRETE SIDEWALK PER CITY OF RIVERSIDE STD. DWG. NO. 325.
- ④ CONSTRUCT DRIVEWAY APPROACH PER CITY OF RIVERSIDE STD. DWG. NO. 302 (MODIFIED).
- ⑤ CONSTRUCT PEDESTRIAN RAMP PER CITY OF RIVERSIDE STD. DWG. NO. 304 TYPE I.
- ⑥ CONSTRUCT SAWCUT, COLD PLANE AND OVERLAY PER DETAIL ON SHEET 2.
- ⑦ INSTALL LANDSCAPE PER LANDSCAPE ARCHITECT PLANS.
- ⑧ CONSTRUCT 6" CURB AND GUTTER TYPE I PER CITY OF RIVERSIDE STD. DWG. NO. 200.
- ⑨ CONSTRUCT CURB AND GUTTER TYPE I TRANSITION PER CITY OF RIVERSIDE STD. DWG. NO. 210.
- ⑩ REMOVE EXISTING CURB & GUTTER.
- ⑪ CONSTRUCT ALLEY PAVING PER CITY OF RIVERSIDE STD. DWG. NO. 110. _____ A.C. OVER _____ CLASS II AGGREGATE BASE.
- ⑫ EXISTING STREET LIGHT TO BE RELOCATED BY DEVELOPER @ DEVELOPER'S EXPENSE.
- ⑬ EXISTING TREE TO BE PROTECT IN PLACE.
- ⑭ SEWER LATERAL WITH P/L C.O. PER CITY STD. DWG. 562.
- ⑮ EXISTING DRIVEWAY TO BE REMOVED.
- ⑯ SEWER TRENCH BACKFILL PER CITY STD. DWG. 453
- ⑰ RELOCATE TRAFFIC SIGNAL PER TRAFFIC SIGNAL PLAN DWG X-144C.
- ⑱ CONSTRUCT DRIVEWAY APPROACH PER CITY OF RIVERSIDE STD. DWG. NO. 302. A=31', B=45'.

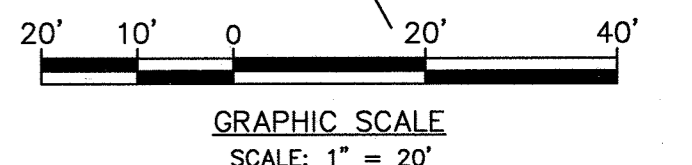
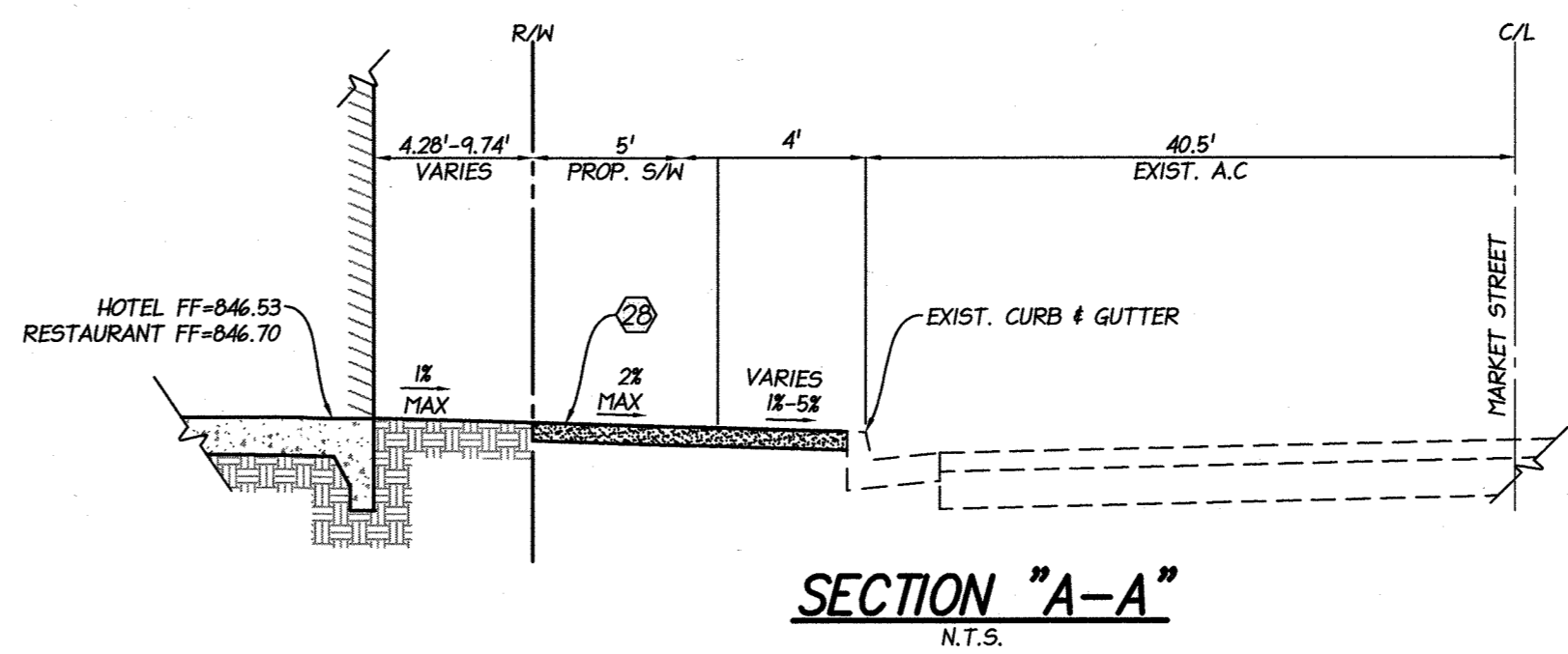
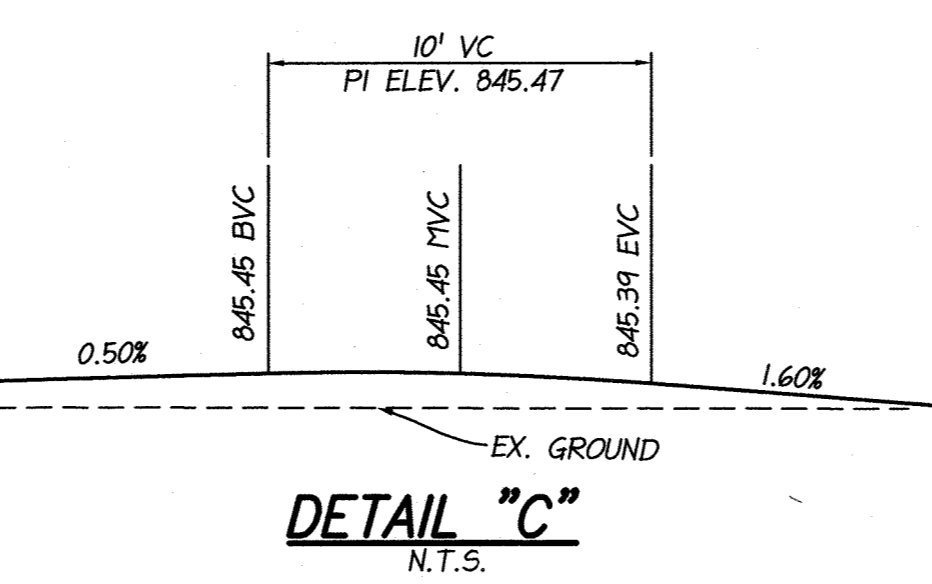
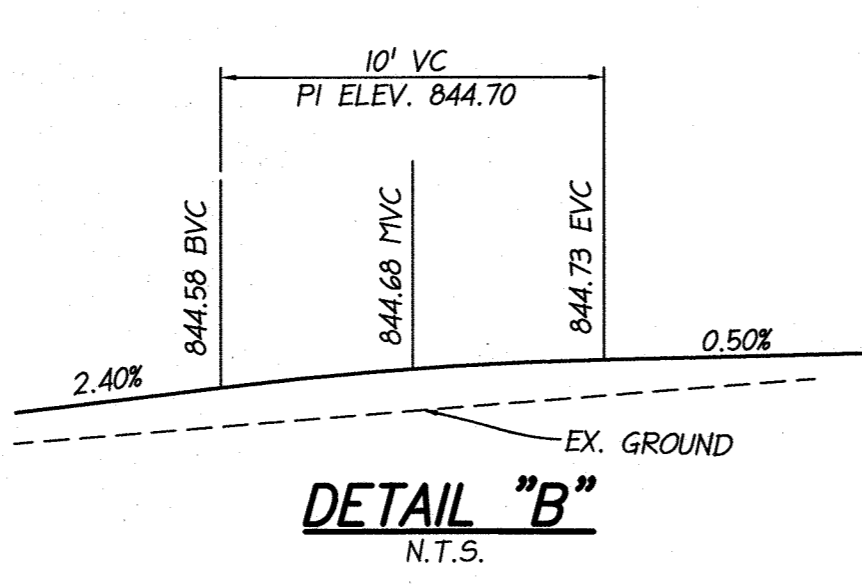
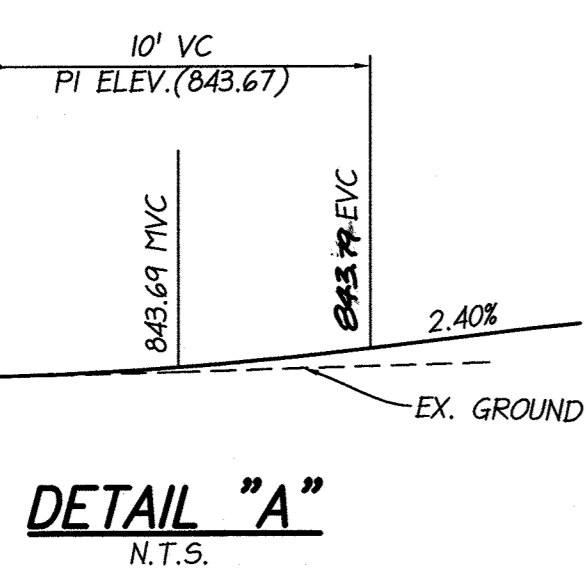
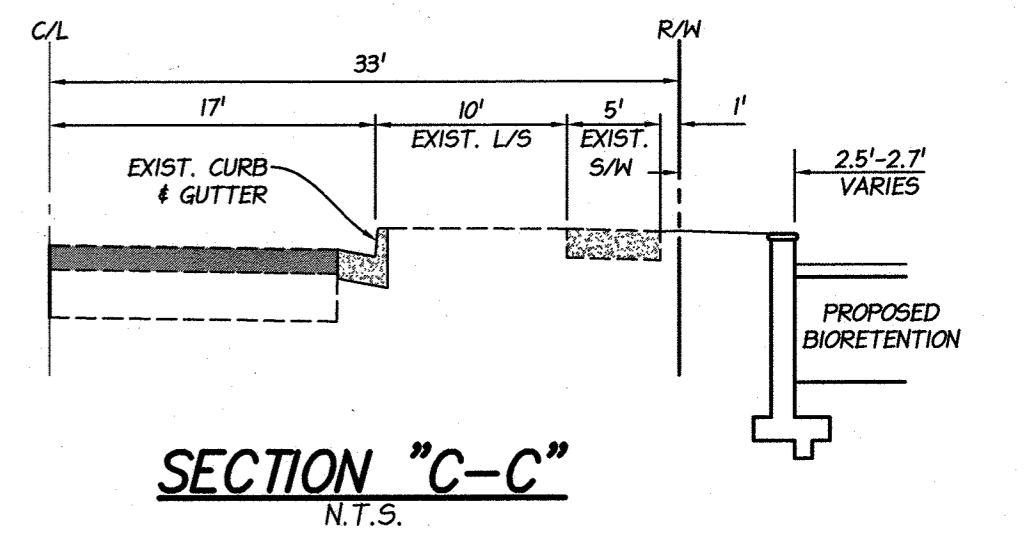
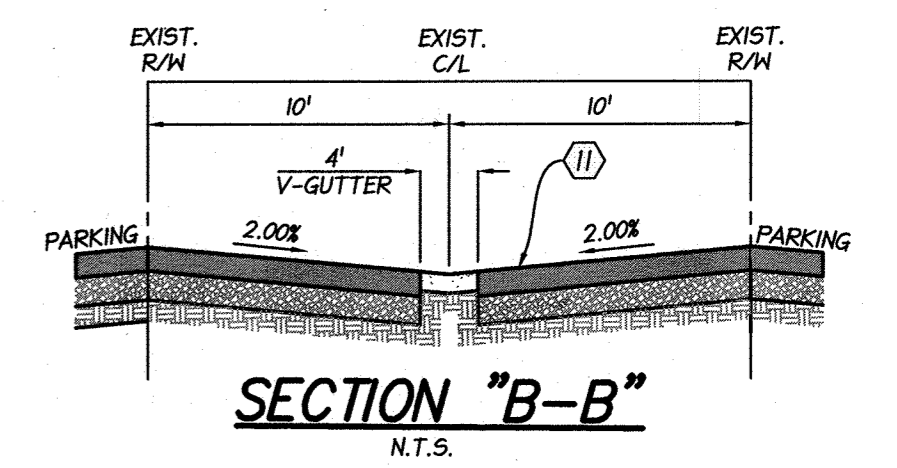

DIGALERT
DIAL BEFORE YOU DIG
TWO WORKING DAYS BEFORE YOU DIG
TOLL FREE 1-800-227-2600
A PUBLIC SERVICE BY UNDERGROUND SERVICE ALERT

BENCHMARK: 17-13 1929 ELEV. = 854.513
CITY OF RIVERSIDE
CHISELED SQUARE IN THE TOP OF A CURB AT THE BACK OF THE SIDEWALK, AT THE SOUTHEAST CORNER OF ORANGE STREET AND SIXTH STREET.

CITY OF RIVERSIDE PUBLIC UTILITIES
DEPARTMENT-ELECTRIC OVERHEAD & UNDERGROUND
APPROVED BY: *[Signature]*
DATE: 6-15-17

CITY OF RIVERSIDE PUBLIC UTILITIES
WATER DEPARTMENT REVIEW FOR WATER CONFLICTS
APPROVED BY: *[Signature]*
DATE: 6/15/2017

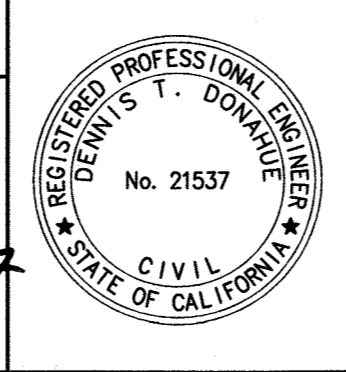

CITY BUSINESS CERTIFICATE NO. 0021337, EXP. 10/31/2017
PSOMAS
1500 IOWA AVENUE, SUITE 210
RIVERSIDE, CA 92507
(951) 787-8421 WWW.PSOMAS.COM
PREPARED BY: *[Signature]* R.C.E. NO. 21537
DATE: 06-13-17

MARK	REVISIONS	APPR. DATE
DESIGNED BY	DRAWN BY	CHECKED BY

CITY OF RIVERSIDE, CALIFORNIA
PUBLIC WORKS DEPARTMENT
APPROVED BY: *[Signature]* BY DATE: *[Signature]*
ENGINEERING MANAGER
TRAFFIC ENGINEERING
CITY ENGINEER/PW DIRECTOR
DATE: 6/12/17

CITY OF RIVERSIDE
STREET IMPROVEMENT PLAN
HAMPTON INN
FAIRMOUNT BLVD., MARKET ST. & ALLEY IMPROVEMENTS
HORIZ. SCALE: AS NOTED VERT. SCALE: AS NOTED

PW16-0568
R-4394
SHEET 3 OF 3
J.N. 4GR030100