

# RIVERSIDE

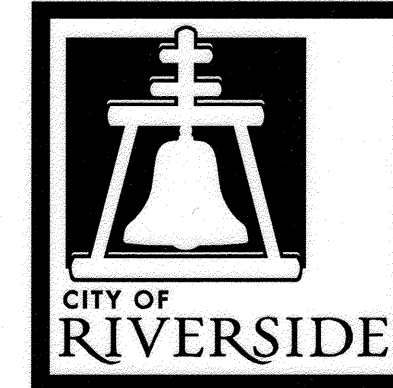

# CALIFORNIA

## PUBLIC WORKS DEPARTMENT

# 2015/2016 CDBG - WARD 1 STREET IMPROVEMENTS FOR HOLDING ST FROM ORANGE STREET TO THE END AND LIME ST FROM HOLDING ST TO FIRST ST A HUD FUNDED PROJECT

### GENERAL CONSTRUCTION NOTES:

- THE CONTRACTOR SHALL PROVIDE AND MAINTAIN TRAFFIC AS INDICATED IN THE ASSOCIATED PROJECT SPECIAL PROVISIONS.
- CONSTRUCTION SHALL BE IN ACCORDANCE WITH THE CITY OF RIVERSIDE STANDARD DRAWINGS AND STANDARD SPECIFICATIONS FOR PUBLIC WORKS CONSTRUCTION, 2012 EDITION.
- EXISTING UTILITIES SHOWN ON THIS PLAN ARE PLOTTED FROM UTILITY RECORDS. THE CONTRACTOR IS REQUIRED TO TAKE DUE PRECAUTIONARY MEASURES TO LOCATE AND PROTECT ALL UTILITIES WHETHER OR NOT SHOWN ON THIS PLAN.
- CONFLICTING UTILITIES SHOWN WITHIN CONSTRUCTION AREA WILL BE RELOCATED PRIOR TO CONSTRUCTION.
- ALL STREET PULL BOXES, AFFECTED BY CONSTRUCTION, SHALL BE ADJUSTED TO THE PROPOSED GRADE.
- PRIME CONTRACTOR BIDDING THIS WORK SHALL HAVE A CLASS "A" OR "C-8".
- THE SEAM BETWEEN PASSES OF THE AC OVERLAY SHALL COINCIDE, AS CLOSE AS POSSIBLE, TO THE LANE LINES.
- COLD MILLING SHALL BE AS DESCRIBED ON THE PLANS AND SPECIAL PROVISIONS OR AS DIRECTED BY THE ENGINEER.
- ANY DISTRESSED EXISTING PAVEMENT SHALL BE REMOVED AND REPLACED AS DIRECTED BY THE ENGINEERING AFTER COLD-MILLING AND PRIOR TO PLACEMENT OF DGAC.
- CONTRACTOR SHALL REMOVE ALL VEGETATION WITHIN ALL SIDEWALK PANELS WITHIN THE PROJECT LIMITS.
- ALL EXISTING IMPROVEMENTS SHOWN HEREON SHALL BE PROTECTED IN PLACE UNLESS OTHERWISE NOTED.
- EXISTING IRRIGATION SHALL BE PROTECTED OR MODIFIED AS NECESSARY TO CONSTRUCT NEW CONCRETE IMPROVEMENTS.
- ALL FENCE POSTS SHALL BE PROTECTED OR MODIFIED AS NECESSARY IF POST FOUNDATION IS WITHIN A SIDEWALK PANEL THAT HAS BEEN CALLED OUT FOR REPLACEMENT.

### CONSTRUCTION NOTES:

- NUMBERS ABOVE 100 IN A HEXAGON ON THE PLAN REFER TO THE RESPECTIVE STANDARD DRAWING AND SHALL BE CONSTRUCTED ACCORDINGLY. UNLESS MODIFICATIONS ARE NOTED ON THE PLAN OR COVER SHEET. ANY NUMBER SHOWN BELOW THE STANDARD DRAWING NUMBER INDICATES THE SPECIFIC ALTERNATE TO BE CONSTRUCTED.
- PROTECT IN PLACE EXISTING FACILITY. DESCRIPTION (--) PER PLAN. PB=PULLBOX, CB=CATCH BASIN, MH=MANHOLE, GV=GATE VALVE.
- ADJUST TO GRADE, DESCRIPTION PER PLAN. (MH) SEWER OR STORM DRAIN. (GV) GATE VALVE. (ETS) ELECTRIC TEST STATION
- PROVIDE VARIABLE DEPTH COLDMILLING TO TRANSITION FROM 0.12' AT GUTTER LIP/JOINT TO 0' DEPTH AT THE MILL WIDTH INDICATED. (XX) = WIDTH OF LINEAR COLD MILL AS INDICATED ON PLANS.
- COLD MILL EXISTING AC PAVEMENT. (DEPTH = 0.12').
- CONSTRUCT ASPHALT RUBBERIZED AGGREGATE MEMBRANE PRIOR TO AC PAVEMENT OVERLAY
- OVERLAY ARAM WITH 0.15' AC PAVEMENT
- CONSTRUCT CONCRETE STABILIZED PULVERIZED BASE PRIOR TO DGAC PAVEMENT. CONTRACTOR SHALL PULVERIZE AND BLEND THE EXISTING AC, BASE MATERIAL, AND NATIVE SOIL TO A DEPTH OF 13 INCHES. REMOVE A MINIMUM OF 3 INCHES EXCESS. CEMENT TREAT PULVERIZED MATERIALS IN-PLACE, GRADE AND COMPACT TO MATCH EXISTING GRADES, MICRO-CRACK AND PRIME COAT PRIOR TO PAVING.
- CONSTRUCT DGAC PAVEMENT AT A MIN. DEPTH OF 0.25'.
- CONSTRUCT NEW PCC SIDEWALK PER CITY STANDARD 325, THICKNESS SHALL BE 6".
- TRIM BACK EXISTING HEDGES FROM THE PATH OF THE EXISTING SIDEWALK.
- INSTALL 12" SOLID WHITE THERMOPLASTIC LIMIT LINE, LOCATION VERIFIED BY ENGINEER
- INSTALL SOLID WHITE THERMOPLASTIC "STOP" LEGEND, LOCATION VERIFIED BY ENGINEER
- REMOVE AND SALVAGE STREET NAME SIGN. INSTALL NEW BREAK AWAY SIGN POST, RE-USE EXISTING STOP SIGN.
- INSTALL NEW STREET NAME SIGN ON NEW POST, PER CITY STANDARD 662.
- DISPOSE OF EXISTING WOOD OR METAL SIGN POST. INSTALL NEW SIGN POST, RE-USE EXISTING STOP SIGN.
- REMOVE AND SALVAGE STREET NAME SIGN FROM EXISTING STREET LIGHT

### EXISTING TOPOGRAPHY:

- SANITARY SEWER M.H.
- STORM DRAIN M.H.
- ELECTRIC M.H.
- WATER M.H.
- GATE VALVE
- ELECTRICAL TEST STATION (GAS)
- FIRE HYDRANT

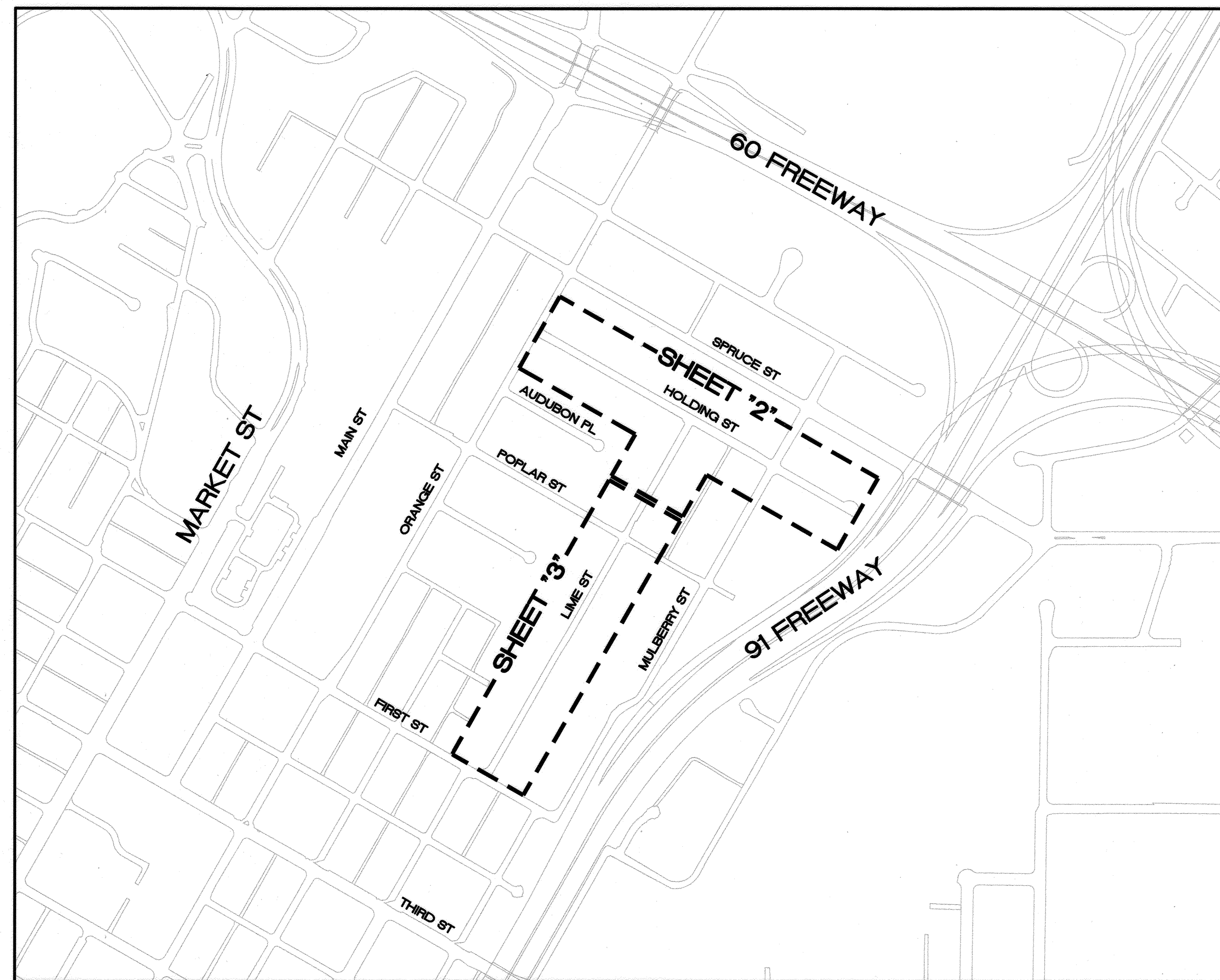

LOCATION MAP

NTS

### STRIPING GENERAL NOTES:

- SIGNING AND STRIPING INSTALLATIONS SHALL CONFORM TO THE 2014 CALIFORNIA MANUAL ON UNIFORM TRAFFIC CONTROL DEVICES (CA MUTCD), THE STATE OF CALIFORNIA DEPARTMENT OF TRANSPORTATION (CALTRANS) STANDARD PLANS AND SPECIFICATIONS DATED 2010, AND ALL ADDENDUMS THERETO, AND THE CITY OF RIVERSIDE PUBLIC WORKS DEPARTMENT STANDARD DRAWINGS, CURRENT EDITION.
- ALL STRIPING, MARKINGS, AND LEGENDS SHALL BE REFLECTORIZED THERMOPLASTIC UNLESS OTHERWISE NOTED. THE CONTRACTOR SHALL PROVIDE AND INSTALL RAISED PAVEMENT MARKERS FOR ALL STRIPING. STRIPING, MARKINGS AND LEGENDS SHALL CONFORM TO THE LATEST CALTRANS STANDARD PLANS A20A THRU A20D AND A24A THRU A24E.
- PRIOR TO FINAL ACCEPTANCE OF STREET IMPROVEMENTS, ALL PAVEMENT STRIPING AND STENCILING WITHIN THE PERIMETER OF THE CONSTRUCTION AREA SHALL BE RESTORED TO LIKE NEW CONDITION, IN A MANNER MEETING THE APPROVAL OF THE CITY OF RIVERSIDE.
- THE CONTRACTOR SHALL RE-STRIP EXISTING STRIPING AND CURB MARKINGS OBLITERATED BY NEW CONSTRUCTION, WHETHER OR NOT SHOWN ON THE PLANS FOR REPLACEMENT, AT NO COST TO THE CITY.
- AT LOCATIONS WHERE EXISTING PAINTED CURB IS TO BE RECONSTRUCTED, THE CONTRACTOR SHALL PAINT THE NEW CURB AS SHOWN ON THE PLANS WITHIN 10 WORKING DAYS OF CURB CONSTRUCTION OR AS DIRECTED BY ENGINEER. THE PAINT SHALL BE WATER-BASED WITH 2-YEAR GUARANTEE AGAINST COLOR FADING. PRIOR TO THE START OF CONSTRUCTION, THE CONTRACTOR SHALL SUBMIT TO THE CITY WRITTEN PROOF OF THE MANUFACTURER'S 2-YEAR GUARANTEE.
- ALL NEW STRIPING SHALL BE "CAT TRACKED" AND APPROVED BY THE ENGINEER PRIOR TO FINAL INSTALLATION. THE CONTRACTOR SHALL NOTIFY THE ENGINEER AFTER COMPLETING LAYOUT AND AT LEAST 3 WORKING DAYS BEFORE COMMENCING INSTALLATION OF STRIPING, MARKINGS AND MARKERS.
- STRIPING SHALL BE APPLIED WITHIN 48 HOURS OF SURFACE COURSE REPLACEMENT ON STREETS OPEN TO THE PUBLIC. IN NO CASE SHALL A NEWLY PAVED STREET OPEN TO THE PUBLIC BE LEFT UNSTRIPED OVER A WEEKEND OR HOLIDAY.

### SHEET INDEX: STREET IMPROVEMENTS

SHEET NO.	DESCRIPTION
1	TITLE SHEET
2	HOLDING STREET/LIME STREET MAINTENANCE PLAN
3	LIME STREET MAINTENANCE PLAN

### LEGEND:

- COLDMILL - TYPE CM1 (0.15') + ARAM (0.03') + AC PAVEMENT (0.12')
- ARAM (0.03') + DGAC PAVEMENT (0.12')
- COLDMILL - TYPE CM2 (0.15') + ARAM (0.03') + AC PAVEMENT (0.12')
- CSPB (0.83') + DGAC PAVEMENT (0.25')
- PROPOSED PCC

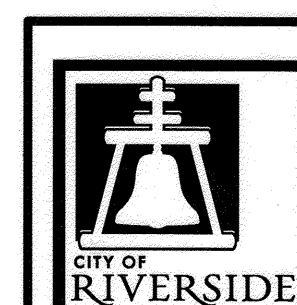

ENGINEER IN RESPONSIBLE CHARGE

Deborah V. Anderson  
R.C.E. No. 56408 EXPIRES: 6-30-17  
DATE 5/24/17

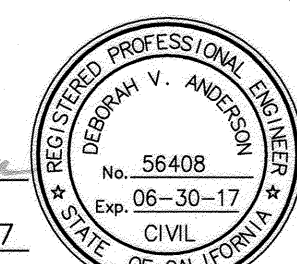

MARK	REVISIONS	APPR.	DATE

CITY OF RIVERSIDE, CALIFORNIA DEPARTMENT OF PUBLIC WORKS			
APPROVED BY	BY	DATE	APPROVED BY
ENGINEERING MANAGER	Em	5/25/17	Deborah V. Anderson
CONSTRUCTION ADMIN.	Dc	5/30/17	CITY ENGINEER
TRAFFIC DIVISION			
STREETS SERVICES			
SURVEYOR			

STREET IMPROVEMENTS	
2015/2016 CDBG - WARD 1 HOLDING ST FROM ORANGE ST TO END OF ST AND LIME ST FROM HOLDING ST TO FIRST ST	
TITLE SHEET	
HORIZ. SCALE: N/A	VERT. SCALE: N/A

AS-BUILT 7-20-18  
DESIGN WORK ORDER NO.: 1724633  
CONSTR. WORK ORDER NO.: 1724634  
**R-4406**  
SHEET 1 OF 3  
FILE NAME: R4406-1.DWG



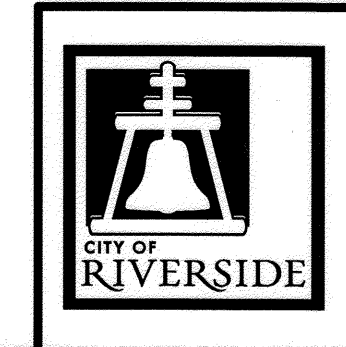
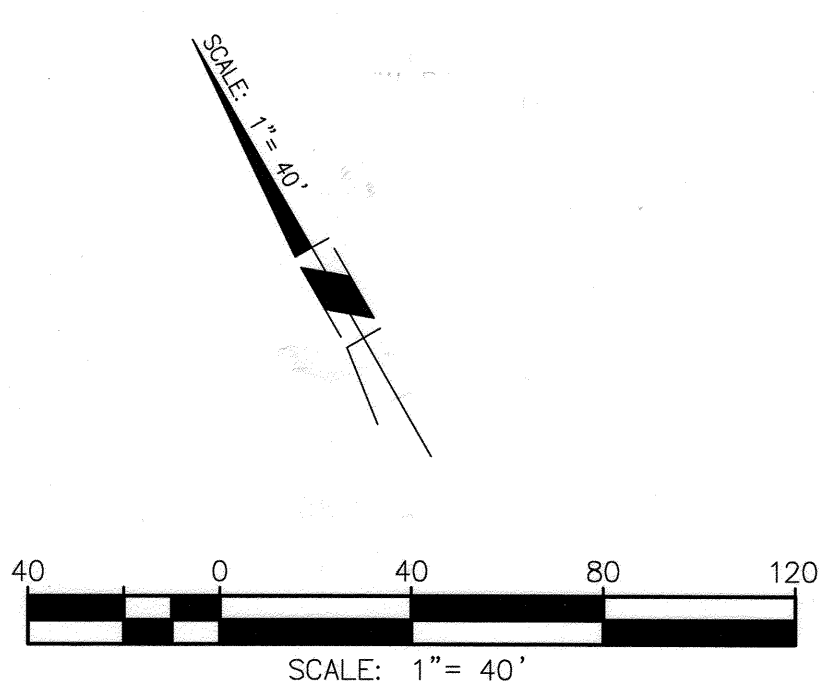
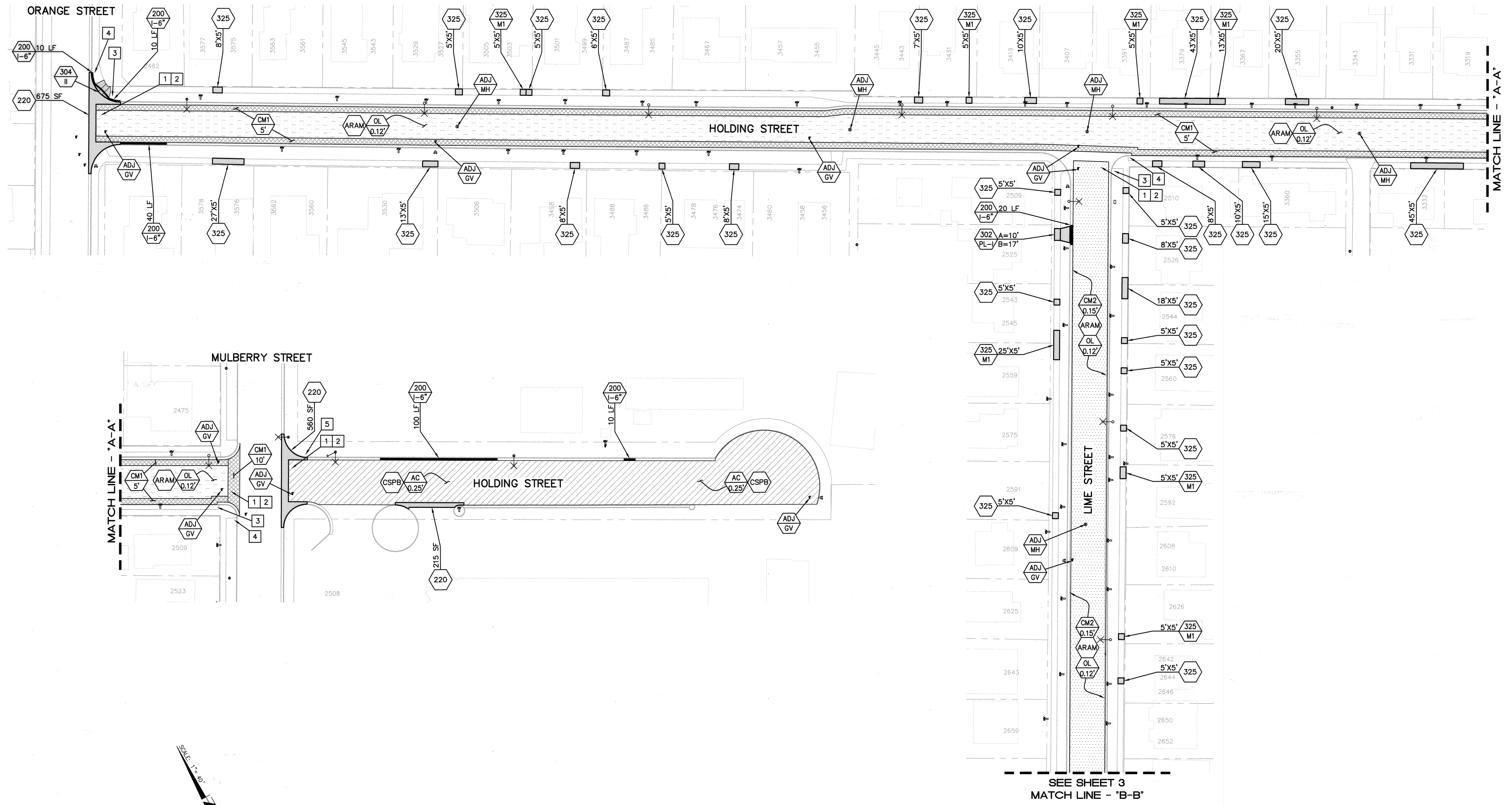

**ENGINEER IN RESPONSIBLE CHARGE**  
*Deborah V. Anderson*  
 Deborah V. Anderson  
 R.C.E. No. 56408 EXPIRES: 6-30-17  
 DATE: 5/24/17

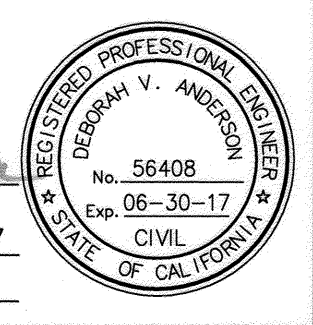

MARK	REVISIONS	APPR.	DATE

**CITY OF RIVERSIDE, CALIFORNIA**  
**DEPARTMENT OF PUBLIC WORKS**

APPROVED BY	BY	DATE	APPROVED BY
ENGINEERING MANAGER	EM	5/25/17	<i>[Signature]</i>
CONSTRUCTION ADMIN.	DC	5/24/17	CITY ENGINEER

TRAFFIC DIVISION  
 STREETS SERVICES  
 SURVEYOR

DATE: 5/31/17

**STREET IMPROVEMENTS**  
**2015/2016 CDBG - WARD 1**  
**HOLDING ST FROM ORANGE ST**  
**TO END OF ST AND LIME ST FROM**  
**HOLDING ST TO FIRST ST**  
**ORANGE TO END AND HOLDING TO POPLAR**  
 HORIZ. SCALE: 1"=40' VERT. SCALE: N/A

DESIGN WORK ORDER NO.: 1724633  
 CONSTR. WORK ORDER NO.: 1724634  
**R-4406**  
 SHEET **2** OF **3**  
 FILE NAME: R4406-2.DWG

SEE SHEET 3  
 MATCH LINE - "B-B"



