

GENERAL NOTES:

- NO PERSON SHALL PERFORM ANY CONSTRUCTION ACTIVITY OR INSTALL ANY OBJECTS WITHIN THE PUBLIC RIGHTS-OF-WAY OR EASEMENTS OF THE CITY OF RIVERSIDE WITHOUT A VALID CONSTRUCTION PERMIT OR, A STREET OPENING PERMIT OR AN ENCROACHMENT PERMIT ISSUED BY THE CITY'S PUBLIC WORKS DEPARTMENT.
- IT SHALL BE THE RESPONSIBILITY OF THE CONTRACTOR TO CLEAR THE RIGHT OF WAY IN ACCORDANCE WITH THE PROVISIONS OF LAW AS IT AFFECTS EACH UTILITY INCLUDING IRRIGATION LINES AND APPURTENANCES AND AT NO COST TO THE CITY.
- CONSTRUCTION SHALL BE IN ACCORDANCE WITH THE CITY OF RIVERSIDE DEPARTMENT OF PUBLIC WORKS, STANDARD DRAWINGS, ITS SUPPLEMENTAL NOTES AND THE STANDARD SPECIFICATIONS FOR PUBLIC WORKS CONSTRUCTION, CURRENT EDITION.
- THE PRIVATE ENGINEER SIGNING THESE PLANS IS RESPONSIBLE FOR ASSURING THE ACCURACY AND ACCEPTABILITY OF THE WORK HEREON. IN THE EVENT OF DISCREPANCIES ARISING DURING CONSTRUCTION, THE PRIVATE ENGINEER SHALL BE RESPONSIBLE FOR DETERMINING AN ACCEPTABLE SOLUTION AND REVISIONS TO THE PLANS FOR APPROVAL BY THE CITY.
- QUANTITIES SHOWN ARE FOR INFORMATION ONLY AND THE CITY OF RIVERSIDE IS NOT RESPONSIBLE FOR THEIR ACCURACY.
- THE DEVELOPER SHALL BE RESPONSIBLE FOR PRESERVING OR RE-ESTABLISHING AND REFERENCING SURVEY MONUMENTS DESTROYED, DISTURBED, OR BURIED AS A RESULT OF CONSTRUCTION SHOWN HEREON.
- SEE "STREET LIGHTING PLANS" FOR QUANTITY AND LOCATION OF REQUIRED STREET LIGHTS.
- ALL FLAGGED ELEVATIONS SHALL BE STAKED IN THE FIELD BY THE PRIVATE ENGINEER.
- WHERE NEW PAVEMENT IS TO JOIN EXISTING PAVEMENT, THE EDGE OF THE EXISTING PAVEMENT SHALL BE TRIMMED IN A SMOOTH STRAIGHT LINE. CONSTRUCT MATCH-UP PAVING AS SHOWN ON THE PLANS AND OVERLAY PAVING AS DIRECTED IN THE FIELD TO PRODUCE A SMOOTH SECTION.
- CONSTRUCT DRIVEWAY APPROACHES PER STANDARD DRAWING 302. EXACT SIZE AND LOCATION TO BE STAKED AS SHOWN PRIOR TO CONSTRUCTION OF THE CURB AND GUTTER.
- ALL OVERHANGING TREE LIMBS THAT ARE LESS THAN 14' ABOVE THE STREET GRADE SHALL BE TRIMMED BACK.
- ON ALL AREAS WITHIN THE PUBLIC RIGHT-OF-WAY WHERE THE FILL IS ONE (1) FOOT OR GREATER, A LETTER WILL BE REQUIRED FROM THE SOILS ENGINEER, CERTIFYING THE COMPACTION OF THE FILL BELOW SUB-GRADE, PRIOR TO ISSUANCE OF THE CONSTRUCTION PERMIT/CUT SHEETS.
- ANY TRAFFIC CONTROL STRIPING OBLITERATED AND/OR BADLY WORN DURING CONSTRUCTION SHALL BE RESTORED BY THE CONTRACTOR WITHIN FIVE DAYS AFTER NOTIFICATION FROM THE CITY INSPECTORS.
- FINAL STRIPING FOR TRAFFIC CONTROL AND/OR PAVEMENT MARKING TO BE THE RESPONSIBILITY OF THE DEVELOPER.
- THE CONTRACTOR SHALL CALL IN A LOCATION REQUEST TO UNDERGROUND SERVICE ALERT (USA), PHONE # 1-800-227-2600, TWO WORKING DAYS BEFORE DIGGING. NO CONSTRUCTION PERMIT WILL BE ISSUED BY THE PUBLIC WORKS DEPARTMENT INVOLVING EXCAVATION FOR UNDERGROUND FACILITIES UNLESS THE APPLICANT HAS BEEN PROVIDED AN INQUIRY IDENTIFICATION NUMBER BY USA.
- THE CONTRACTOR SHALL ARRANGE FOR A SOIL TEST TO BE MADE BY A SOILS ENGINEER AFTER THE STREETS HAVE BEEN PREPARED TO ROUGH GRADE AND PRIOR TO CURB AND GUTTER CONSTRUCTION. DEPTH OF BASE MATERIAL AND A.C. PAVING SHALL BE DETERMINED BY THE CITY OF RIVERSIDE DESIGN STANDARDS AND TEST PROCEDURES.
- ALL TRAFFIC SIGNS SHALL BE INSTALLED PRIOR TO OPENING THE STREETS TO TRAFFIC.
- THE CONTRACTOR SHALL COORDINATE TRENCHING FOR CABLE TELEVISION WITH OTHER TRENCHING WITHIN THE SUBDIVISION.
- IN PAVEMENT OVERLAY AREAS, ANY DISTRESSED EXISTING PAVEMENT SHALL BE REMOVED AND REPLACED AS DIRECTED BY THE INSPECTOR PRIOR TO OVERLAY WITH A.C. PAVING.
- SEE PLAN X-144C FOR TRAFFIC SIGNAL IMPROVEMENTS.

PRIVATE ENGINEER'S NOTES:

- UNLESS SPECIFIED IN THE PROJECT SPECIFIC CONSTRUCTION DOCUMENTS, ALL CONSTRUCTION SHOWN HEREON SHALL BE IN ACCORDANCE WITH THE GOVERNING AGENCY ADOPTED VERSION OF THE UNIFORM BUILDING CODE, THE "STANDARD SPECIFICATIONS FOR PUBLIC WORKS CONSTRUCTION" (CURRENT EDITION) AND THE "STANDARD PLANS FOR PUBLIC WORKS CONSTRUCTION" (CURRENT EDITION).
- THE EXISTENCE AND LOCATION OF ANY UNDERGROUND UTILITY PIPES OR STRUCTURES SHOWN ON THESE PLANS WERE OBTAINED BY A SEARCH OF AVAILABLE RECORDS. THESE LOCATIONS ARE APPROXIMATE AND SHALL BE CONFIRMED IN THE FIELD BY THE CONTRACTOR, SO THAT ANY NECESSARY ADJUSTMENTS CAN BE MADE IN ALIGNMENT AND/OR GRADE OF THE PROPOSED IMPROVEMENTS. THE CONTRACTOR IS REQUIRED TO TAKE DUE PRECAUTIONARY MEASURES TO PROTECT ANY UTILITY LINES SHOWN AND ANY OTHER LINES NOT OF RECORD OR NOT SHOWN ON THESE PLANS.
- PRIOR TO CONSTRUCTION, THE CONTRACTOR SHALL VERIFY THE HORIZONTAL AND VERTICAL POSITION OF ALL POINTS OF CONNECTION TO EXISTING STRUCTURES. THIS SHALL INCLUDE BOTH ABOVE GROUND AND BELOW GROUND POINTS OF CONNECTION. THE ENGINEER SHALL BE NOTIFIED OF ANY DISCREPANCIES PRIOR TO BEGINNING CONSTRUCTION.
- THICKNESS OF PAVEMENT AND BASE MATERIAL SHOWN HEREON IS PRELIMINARY ONLY. FINAL PAVEMENT SECTION TO BE DETERMINED BY SOILS TEST AND RECOMMENDED BY THE SOILS ENGINEER UPON COMPLETION OF ROUGH GRADING.
- CONSTRUCTION CONTRACTOR AGREES THAT IN ACCORDANCE WITH GENERALLY ACCEPTED CONSTRUCTION PRACTICES, CONSTRUCTION CONTRACTOR WILL BE REQUIRED TO ASSUME SOLE AND COMPLETE RESPONSIBILITY FOR JOB SITE CONDITIONS DURING THE COURSE OF CONSTRUCTION OF THE PROJECT, INCLUDING SAFETY OF ALL PERSONS AND PROPERTY; THAT THIS REQUIREMENT SHALL BE MADE TO APPLY CONTINUOUSLY AND NOT BE LIMITED TO NORMAL WORKING HOURS.
- THE PRIVATE ENGINEER SIGNING THESE PLANS IS RESPONSIBLE FOR ASSURING THE ACCURACY AND ACCEPTABILITY OF THE DESIGN HEREON. IN THE EVENT OF DISCREPANCIES ARISING AFTER APPROVAL OR DURING CONSTRUCTION, THE PRIVATE ENGINEER SHALL BE RESPONSIBLE FOR DETERMINING AN ACCEPTABLE SOLUTION AND REVISIONS TO THE PLANS ACCORDINGLY.

STREET IMPROVEMENT PLAN

MAGNOLIA AVENUE (WB)

GALLERIA & TYLER

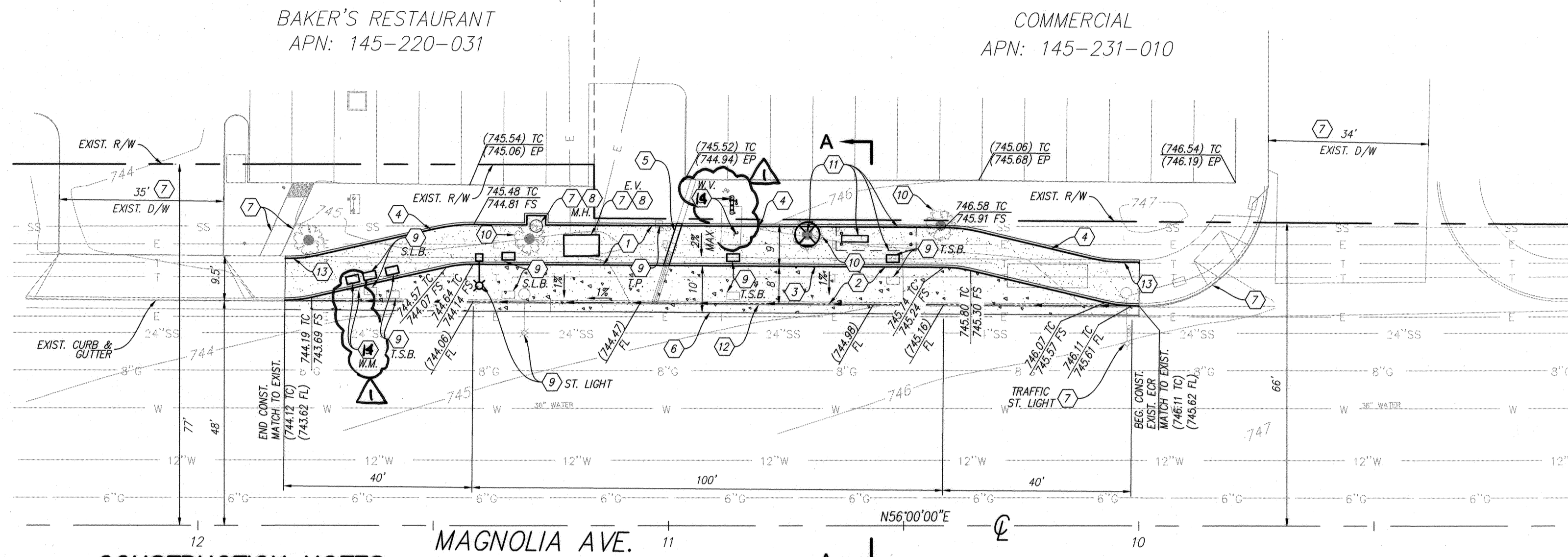

CONSTRUCTION NOTES

- CONSTRUCT CONCRETE SIDEWALK PER CITY OF RIVERSIDE DWG. STD. NO. 325. 1,434 S.F.
- CONSTRUCT 8" PCC BUS TURNOUT PER RTA BUS STOP DESIGN GUIDELINES DATE AUGUST, 2015 (MONOLITHIC WITH CURB). 1,483 S.F.
- CONSTRUCT 6" CURB ONLY PER CITY OF RIVERSIDE DWG. STD. NO. 200, TYPE II (MONOLITHIC WITH BUS PAD). 184 L.F.
- CONSTRUCT 8" CURB ONLY PER CITY OF RIVERSIDE DWG. STD. NO. 200, TYPE II. 168 L.F.
- REMOVE PORTION OF PARKWAY DRAIN PER PLAN AND REPLACE PARKWAY DRAIN PER CITY OF RIVERSIDE STD. NO. 410. 10 L.F.
- SAWCUT, COLD PLANE AND OVERLAY PER DETAIL ON HEREON. 363 S.F.
- PROTECT IN PLACE PER PLAN.
- ADJUST TO GRADE.
- TO BE REMOVED AND RELOCATED BY CONTRACTOR.
- REMOVE EXISTING TREE (STUMP AND ROOTS TO BE GROUND DOWN/REMOVED TO MIN. 18" BELOW GRADE).
- REMOVE, STORE, AND REINSTALL TRASH RECEPTACLE, BUS SHELTER, AND BENCH PER RTA BUS STOP DESIGN GUIDELINES DATE AUGUST, 2015. 1 EA.
- REMOVE EXISTING 6" CURB & GUTTER. 181 L.F.
- CONSTRUCT CURB TRANSITION TO 0" CURB FACE PER RIVERSIDE STD. DWG. NO. 210. 16 L.F.
- TO BE REMOVED AND RELOCATED BY CITY FORCES.

NOTE:

- SEE TYPICAL BUS STOP LAYOUT FOR BENCH, SHELTER, TRASH RECEPTACLE PLACEMENT AND SIDEWALK INSTALLATION.
- CENTERLINE AND RIGHT OF WAY DISTANCE OBTAINED FROM AVAILABLE RECORD INFORMATION AND CONSIDERED APPROXIMATE.
- DESIGN CRITERIA FROM RTA BUS STOP DESIGN GUIDELINES DATED AUGUST, 2015.
- LIMITS OF SIDEWALK REMOVAL AND INSTALLATION ARE APPROXIMATE. CONTRACTOR TO VERIFY AND INCREASE WORK LIMITS TO NEXT JOINT AS NEEDED.

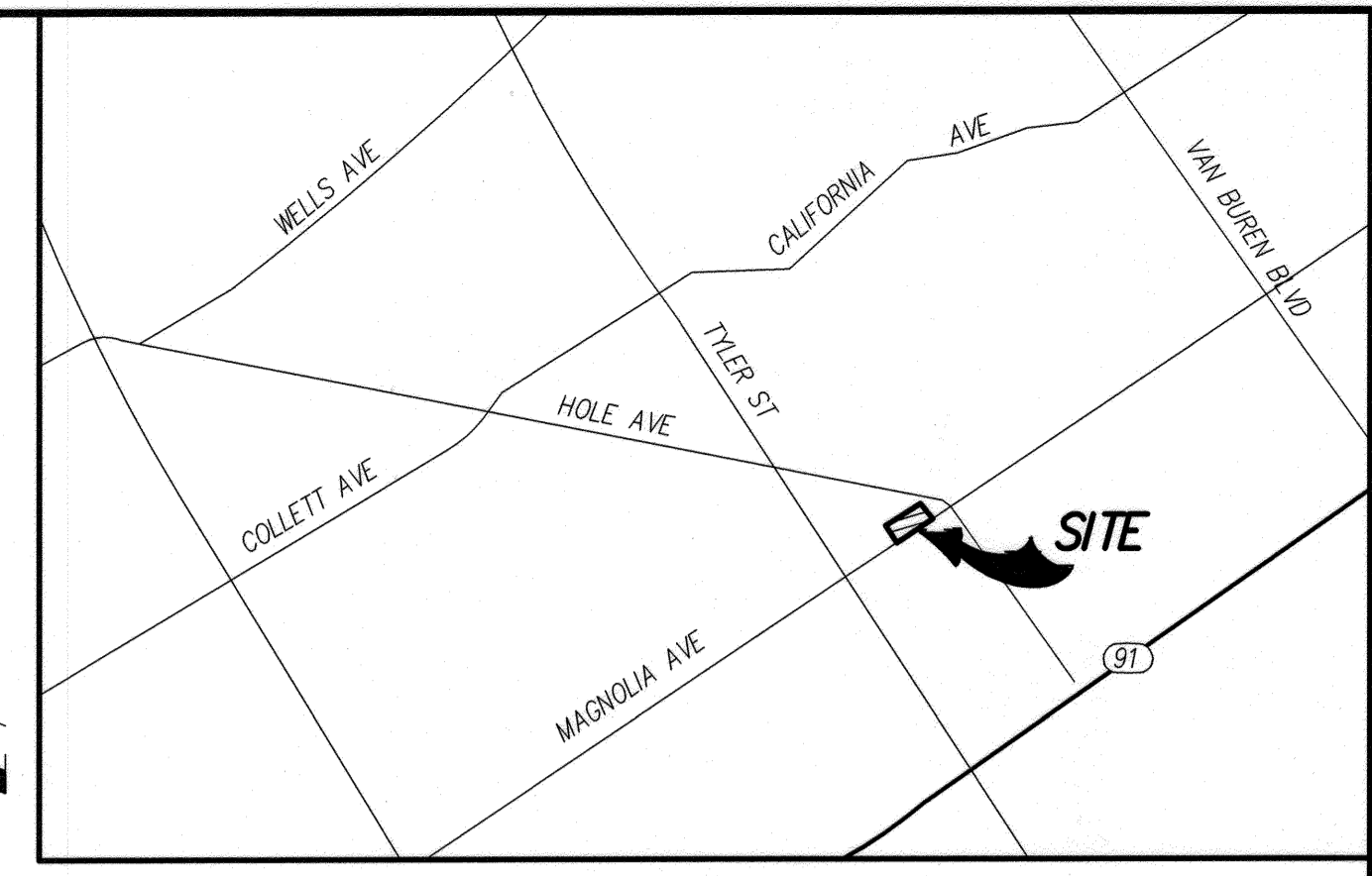

VICINITY MAP
NOT TO SCALE

OWNER
RIVERSIDE TRANSIT AGENCY
1825 THIRD STREET
RIVERSIDE, CA 92517
PHONE: 951-965-5000

ENGINEER
PSOMAS
1500 IOWA AVENUE, STE 210
RIVERSIDE, CA 92507
(951) 787-8421
CONTACT: ANDREW WALKER

TOPOGRAPHY SOURCE
EXISTING TOPOGRAPHY IS BASED ON FIELD SURVEY DONE BY PSOMAS IN NOVEMBER 2016.

BASIS OF BEARINGS:
THE BASIS OF BEARING FOR THIS SURVEY IS BASED UPON THE NORTH AMERICAN DATUM OF 1983 (NAD83) OF THE CALIFORNIA COORDINATE SYSTEM OF 1983 (CCS83), ZONE VI, 2011.00 EPOCH.

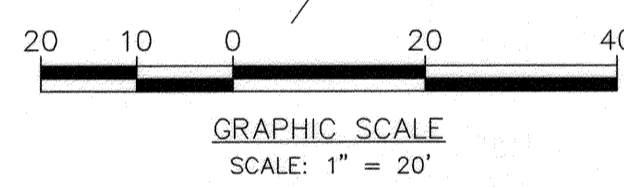

GRAPHIC SCALE
SCALE: 1" = 20'

LEGEND

- EXISTING PROPERTY LINE
- PROPOSED RIGHT OF WAY
- EXISTING RIGHT OF WAY
- EXISTING CENTERLINE
- PROPOSED CURB
- EXISTING CURB
- PROPOSED SIDEWALK
- EXISTING SIDEWALK
- EXISTING EASEMENT
- EXISTING CONTOUR MAJOR
- EXISTING CONTOUR MINOR
- EXISTING BUILDING
- EXISTING CONCRETE
- EXISTING EDGE OF PAVEMENT
- EXISTING SPOT ELEVATION
- EXISTING SPOT ELEVATION
- C/L
- R/W
- S/W
- M.H.
- F.H.
- EXIST.
- T.B.R.
- GB
- PROP.
- N.T.S.
- L/S
- P.I.P.
- R&R
- RET.
- DP.
- GI
- O.D.D.
- G.P.
- ST.
- W.M.
- P.B.
- FL
- FS
- FG
- FF
- TC
- W.V.
- EG
- T.S.B.
- S.L.B.
- T.P.
- E.V.
- TRASH RECEPTACLE

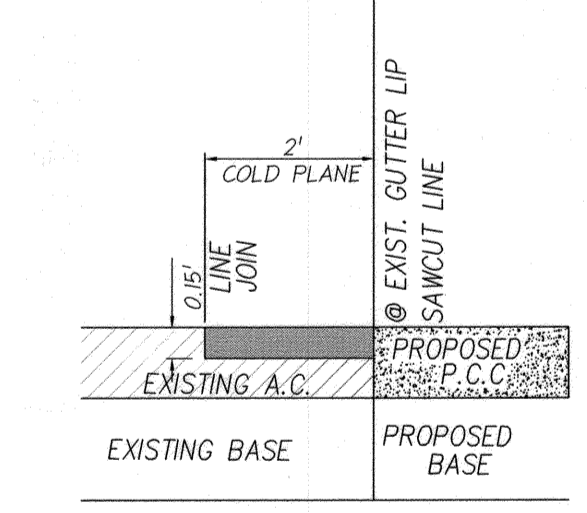

COLD PLANE DETAIL
NOT TO SCALE

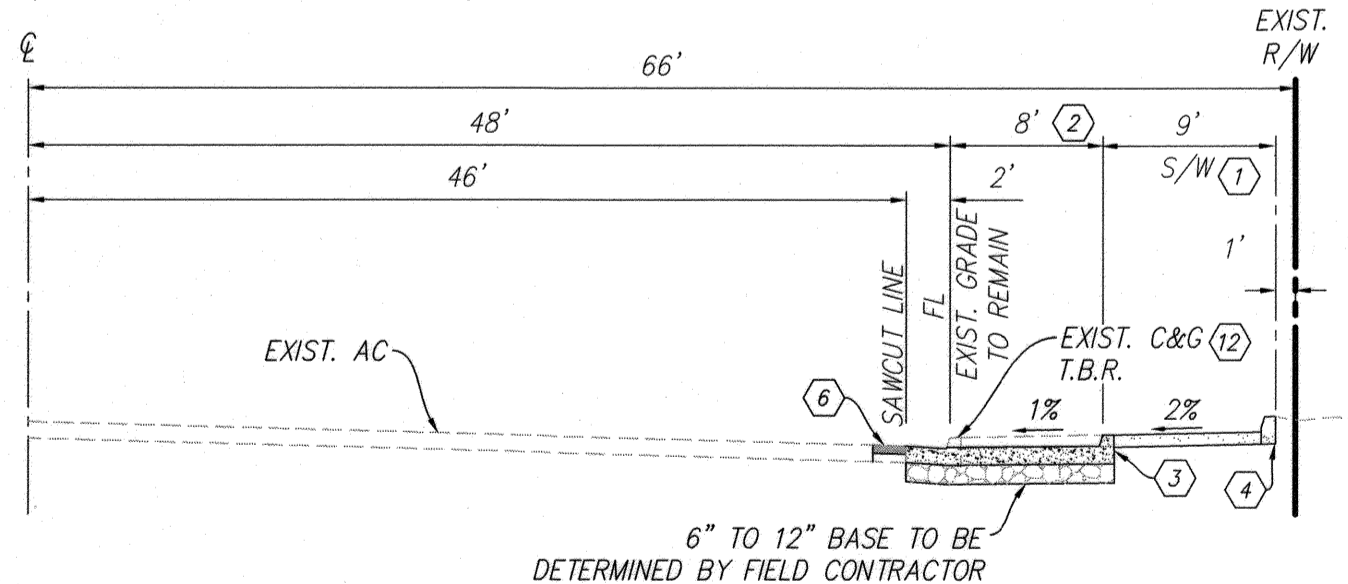

SECTION A-A
NOT TO SCALE

CURVE TABLE					LINE TABLE	
CURVE #	LENGTH	RADIUS	TANGENT	DELTA	LINE #	DISTANCE
C1	5.74'	25'	2.88'	13° 09' 09"	L1	29.39'
					L2	100.00'
					L3	1.50'

DIGALERT
TWO WORKING DAYS BEFORE YOU DIG
TOLL FREE 1-800-227-2600
A PUBLIC SERVICE BY UNDERGROUND SERVICE ALERT

BENCHMARK: (DATUM: 1929)
601-26-68 1929 ELEV. = 742.243
A STANDARD CITY OF RIVERSIDE BRASS DISK STAMPED "601-26-68" SET IN A CONCRETE POST AT THE BACK OF SIDEWALK OF THE EASTERLY CORNER OF MAGNOLIA AVENUE AND TYLER STREET, 65.5 FEET SOUTHEAST OF THE CENTERLINE OF MAGNOLIA AVENUE, 52.0 FEET NORTHEAST OF THE CENTERLINE OF TYLER STREET IN THE ASPHALT PARKING LOT OF A GASOLINE STATION.

CITY OF RIVERSIDE PUBLIC UTILITIES
DEPARTMENT-ELECTRIC OVERHEAD & UNDERGROUND

APPROVED BY: *[Signature]* 12/21/17
DATE

CITY OF RIVERSIDE PUBLIC UTILITIES
WATER DEPARTMENT REVIEW FOR WATER CONFLICTS

APPROVED BY: *[Signature]* 12/21/2017
DATE

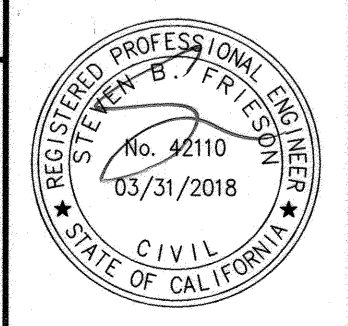

CITY BUSINESS CERTIFICATE NO. 0021337, EXP. 10/31/2018

PSOMAS
1500 IOWA AVENUE, SUITE 210
RIVERSIDE, CA 92507
(951) 787-8421 WWW.PSOMAS.COM

PREPARED BY: _____ R.C.E. NO. 42110
DATE: 12/21/2017

REVD CONSTRUCTION NOTES

MARK	REVISIONS	APPR. DATE

DESIGNED BY: _____ DRAWN BY: _____ CHECKED BY: _____

CITY OF RIVERSIDE, CALIFORNIA
PUBLIC WORKS DEPARTMENT

APPROVED BY: *[Signature]* BY DATE: 1/19/18
TRAFFIC ENGINEERING: *[Signature]* CHIEF ENGINEER/PW DIRECTOR

DATE: 1/19/18

CITY OF RIVERSIDE
STREET IMPROVEMENT PLAN
MAGNOLIA AVENUE (WB)
GALLERIA & TYLER
BUS TURNOUT

PW17-0485
R-4418
SHEET 1 of 1
J.N. 5RTA01800

HORIZ. SCALE: AS NOTED VERT. SCALE: AS NOTED