

GENERAL CONSTRUCTION NOTES:

1. THE CONTRACTOR SHALL PROVIDE AND MAINTAIN TRAFFIC CONTROL AS INDICATED IN THE ASSOCIATED PROJECT SPECIAL PROVISIONS.
2. CONSTRUCTION SHALL BE IN ACCORDANCE WITH THE CITY OF RIVERSIDE STANDARD DRAWINGS AND STANDARD SPECIFICATIONS FOR PUBLIC WORKS CONSTRUCTION, 2012 EDITION.
3. EXISTING UTILITIES SHOWN ON THIS PLAN ARE PLOTTED FROM UTILITY RECORDS. THE CONTRACTOR IS REQUIRED TO TAKE DUE PRECAUTIONARY MEASURES TO LOCATE AND PROTECT ALL UTILITIES WHETHER OR NOT SHOWN ON THIS PLAN.
4. CONFLICTING UTILITIES SHOWN WITHIN CONSTRUCTION AREA WILL BE RELOCATED PRIOR TO CONSTRUCTION.
5. ALL STREET PULL BOXES, AFFECTED BY CONSTRUCTION, SHALL BE ADJUSTED TO THE PROPOSED GRADE.
6. PRIME CONTRACTOR BIDDING THIS WORK SHALL HAVE A CLASS "A" OR "C-8" LICENSE.
7. THE SEAM BETWEEN PASSES OF THE AC OVERLAY SHALL COINCIDE, AS CLOSE AS POSSIBLE, TO THE LANE LINES.
8. COLD MILLING SHALL BE AS DESCRIBED ON THE PLANS AND SPECIAL PROVISIONS OR AS DIRECTED BY THE ENGINEER.
9. ANY DISTRESSED EXISTING PAVEMENT SHALL BE REMOVED AND REPLACED AS DIRECTED BY THE ENGINEER AFTER COLD-MILLING AND PRIOR TO PLACEMENT OF DGAC.
10. CONTRACTOR SHALL REMOVE ALL VEGETATION WITHIN ALL SIDEWALK PANELS WITHIN THE PROJECT LIMITS.
11. ALL EXISTING IMPROVEMENTS SHOWN HEREON SHALL BE PROTECTED IN PLACE UNLESS OTHERWISE NOTED.
12. EXISTING IRRIGATION SHALL BE PROTECTED OR MODIFIED AS NECESSARY TO CONSTRUCT NEW CONCRETE IMPROVEMENTS.

CONSTRUCTION NOTES:

- REMOVE AND REPLACE IN KIND EXISTING FACILITY, NUMBERS ABOVE 100 IN A HEXAGON ON THE PLAN REFER TO THE RESPECTIVE STANDARD DRAWING AND SHALL BE CONSTRUCTED ACCORDINGLY. ANY NOTE SHOWN BELOW THE STANDARD DRAWING NUMBER INDICATES THE SPECIFIC TYPE, ACTION, OR MODIFICATION TO BE CONSTRUCTED. WHERE NO MODIFICATION OR TYPE IS INDICATED, THE DIMENSIONS OF NEW FACILITY SHALL BE MODIFIED AS NECESSARY, EXCLUDING ADA REQUIREMENTS, TO MATCH EXISTING FACILITY REMOVED.
- PROTECT IN PLACE EXISTING FACILITY. DESCRIPTION (XX) PER PLAN. (PB)=PULLBOX; (CB)=CATCH BASIN; (MH)=MANHOLE; (GV)=GATE VALVE; (GUY)=GUY WIRE; (SGN)=STREET SIGN; (EL)=ELECTRICAL POLE, (TRE)=TREE; (FH)=FIRE HYDRANT; (TEL)=TELEPHONE RISER
- ADJUST TO GRADE, DESCRIPTION PER PLAN. (MH)=SEWER OR STORM DRAIN MANHOLE; (GV)=GATE VALVE; (ETS)=ELECTRIC TEST STATION; (WM)=WATER METER BOX; (CO)=CLEAN OUT.
- REMOVE AND REPLACE EXISTING IMPROVEMENTS WITH 6" CONCRETE. PROTECT IN PLACE EXISTING GARAGE FOUNDATION AND RECONSTRUCT BRICK PATH AS NECESSARY.
- REMOVE AND REPLACE WATER METER BOX AND LID. CITY TO PROVIDE BOX AND LID.
- CONSTRUCT 0.21' DGAC OVER 0.50' CLASS II CRUSHED AGGREGATE BASE (CAB). CAP WITH 0.12' DGAC AFTER THE CM1 COLDMILL HAS BEEN COMPLETED.
- PROVIDE VARIABLE DEPTH COLDMILLING TO TRANSITION FROM 0.12' AT GUTTER LIP/JOINT TO 0' DEPTH AT THE 8'-10' MILL WIDTH INDICATED.
- COMPLETELY REMOVE EXISTING AC, BASE, NATIVE MATERIAL AND/OR EXISTING IMPROVEMENT TO CONSTRUCT THE PROPOSED PAVEMENT SECTION.
- OVERLAY AREA WITH DGAC AT A DEPTH PER PLAN.
- CONSTRUCT MONOLITHIC RETAINING CURB (0"-18") AT THE BACK OF THE SIDEWALK PER CITY STANDARD 200.
- REMOVE EXISTING TREE AND ROOT SYSTEM. BACK FILL AND COMPACT VOID AS NECESSARY.
- COMPLETELY REMOVE AND DISPOSE OF THE EXISTING VINYL FENCING AND CONCRETE FOUNDATIONS. INSTALL NEW WHITE VINYL FENCING IN KIND WITH NEW CONCRETE FOUNDATIONS. RE-USE ANY RAILING POSTS OR CROSSBARS IF POSSIBLE.
- RELOCATE EXISTING TRAFFIC SIGN AND NEW POST TO PROPOSED LOCATION.
- REMOVE AND REPLACE EXISTING SECTION OF CHAIN LINK FENCING. DISPOSE OF REMOVED PORTION AND INSTALL NEW SECTION IN-KIND AND CONNECT TO EXISTING FENCE.
- REMOVE AND REPLACE EXISTING SECTION OF RETAINING WALL. DISPOSE OF THE REMOVED PORTION AND INSTALL THE NEW SECTION PER CITY STANDARD TYPE 2, 6" HEEL. HEIGHT = APPROX. 4'. FINISH TO MATCH EXISTING WALL AND PAINT TO BE COORDINATED WITH PROPERTY OWNER.
- COMPLETELY REMOVE AND DISPOSE OF THE EXISTING WROUGHT IRON FENCING. INSTALL NEW WROUGHT IRON FENCING IN KIND AND PAINT AS NECESSARY.
- GRADE AT 5% FROM THE PROPOSED DRAINAGE SWALE TO THE NEW RETAINING CURB OR EXISTING BLOCK WALL AND AT A 3:1 SLOPE UPSTREAM TO DIVERT WATER TOWARD NEW DRAIN.
- CONTRACTOR SHALL COORDINATE WITH RIVERSIDE PUBLIC UTILITIES DEPARTMENT TO PROVIDE ACCESS FOR THE RELOCATION OF THE EXISTING WATER METER. CONTRACTOR SHALL RE-CONNECT.
- CONTRACTOR SHALL COORDINATE WITH THE APPROPRIATE UTILITY PURVEYOR TO RELOCATE OR ADJUST TO GRADE THE EXISTING FACILITY, PER PLAN.
- COMPLETELY REMOVE AND DISPOSE OF THE EXISTING ASPHALT DRIVEWAY.
- RECONSTRUCT THE EXISTING SEWER LATERALS TO A DEPTH IN WHICH TO CLEAR THE PROPOSED DRIVEWAY. PROTECT IN PLACE THE FACILITY ENTERING THE RESIDENCE.
- ADJUST EXISTING CHAIN LINK GATES AFTER THE CONCRETE DRIVEWAY MATCHUP HAS BEEN COMPLETED.
- RELOCATE EXISTING CHAIN LINK GATES AFTER THE AC DRIVEWAY MATCHUP AND BLOCK WALL HAS BEEN COMPLETED.
- MODIFY EXISTING CHAIN LINK FENCING AND INSTALL NEW GATE(S) AFTER THE AC DRIVEWAY MATCHUP HAS BEEN COMPLETED.

RIVERSIDE

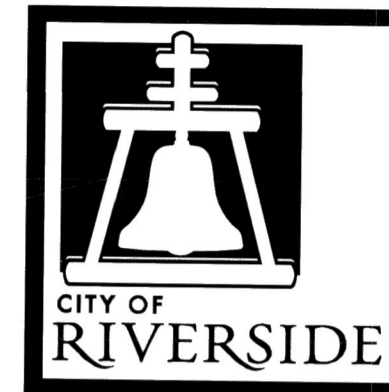

CALIFORNIA

PUBLIC WORKS DEPARTMENT

**2017/2018 CDBG - WARD 6
SIDEWALK IMPROVEMENTS FOR
COOK AVENUE
FROM MOBLEY AVENUE TO TYLER STREET
A HUD FUNDED PROJECT**

SIGNING/STRIPING GENERAL NOTES:

1. SIGNING AND STRIPING INSTALLATIONS SHALL CONFORM TO THE 2014 CALIFORNIA MANUAL ON UNIFORM TRAFFIC CONTROL DEVICES (CA MUTCD), THE STATE OF CALIFORNIA DEPARTMENT OF TRANSPORTATION (CALTRANS) STANDARD PLANS AND SPECIFICATIONS DATED 2015, AND ALL ADDENDUMS THERETO, AND THE CITY OF RIVERSIDE PUBLIC WORKS DEPARTMENT STANDARD DRAWINGS, CURRENT EDITION.
2. ALL STRIPING, MARKINGS, AND LEGENDS SHALL BE REFLECTORIZED THERMOPLASTIC UNLESS OTHERWISE NOTED. THE CONTRACTOR SHALL PROVIDE AND INSTALL RAISED PAVEMENT MARKERS FOR ALL STRIPING, STRIPING, MARKINGS AND LEGENDS SHALL CONFORM TO THE LATEST CALTRANS STANDARD PLANS A20A THRU A20D AND A24A THRU A24E.
3. PRIOR TO FINAL ACCEPTANCE OF STREET IMPROVEMENTS, ALL PAVEMENT STRIPING AND STENCILING WITHIN THE PERIMETER OF THE CONSTRUCTION AREA SHALL BE RESTORED TO LIKE NEW CONDITION, IN A MANNER MEETING THE APPROVAL OF THE CITY OF RIVERSIDE.
4. THE CONTRACTOR SHALL RE-STRIP EXISTING STRIPING AND CURB MARKINGS OBLITERATED BY NEW CONSTRUCTION, WHETHER OR NOT SHOWN ON THE PLANS FOR REPLACEMENT, AT NO COST TO THE CITY.
5. AT LOCATIONS WHERE EXISTING PAINTED CURB IS TO BE RECONSTRUCTED, THE CONTRACTOR SHALL PAINT THE NEW CURB AS SHOWN ON THE PLANS WITHIN 10 WORKING DAYS OF CURB CONSTRUCTION OR AS DIRECTED BY ENGINEER. THE PAINT SHALL BE WATER-BASED WITH 2-YEAR GUARANTEE AGAINST COLOR FADING. PRIOR TO THE START OF CONSTRUCTION, THE CONTRACTOR SHALL SUBMIT TO THE CITY WRITTEN PROOF OF THE MANUFACTURER'S 2-YEAR GUARANTEE.
6. ALL NEW STRIPING SHALL BE "CAT TRACKED" AND APPROVED BY THE ENGINEER PRIOR TO FINAL INSTALLATION. THE CONTRACTOR SHALL NOTIFY THE ENGINEER AFTER COMPLETING LAYOUT AND AT LEAST 3 WORKING DAYS BEFORE COMMENCING INSTALLATION OF STRIPING, MARKINGS AND MARKERS.
7. TRAFFIC SIGN FACE SHALL BE 3M DIAMOND GRADE D03 REFLECTIVE SHEETING (ASTM XI) OR APPROVED EQUAL WITH PROTECTIVE GRAFFITI OVERLAY FILM OR AS OTHERWISE NOTED.
8. SIGNS SHALL BE STANDARD SIZE UNLESS NOTED OTHERWISE. PRIOR TO INSTALLATION, NEW SIGNS SHALL BE APPROVED BY THE CITY OF RIVERSIDE. EXACT LOCATIONS OF SIGNS SHALL BE DETERMINED BY THE CITY ENGINEER.
9. ALL EXISTING SIGNS AND POSTS TO BE REMOVED SHALL BE DELIVERED TO THE CITY OF RIVERSIDE SIGN DEPARTMENT.
10. STRIPING SHALL BE APPLIED WITHIN 48 HOURS OF SURFACE COURSE REPLACEMENT ON STREETS OPEN TO THE PUBLIC. IN NO CASE SHALL A NEWLY PAVED STREET OPEN TO THE PUBLIC BE LEFT UNSTRIPED OVER A WEEKEND OR HOLIDAY.
11. CONTRACTOR SHALL INSTALL NEW SIGN(S) AND/OR POST(S) PER CITY OF RIVERSIDE STANDARD DRAWING No. 664, SEE SPECIFICATIONS.
12. CONTRACTOR SHALL INSTALL NEW STREET NAME SIGNS AND POST PER CITY OF RIVERSIDE STANDARD DRAWING No. 662, SEE SPECIFICATIONS.
13. ALL CONFLICTING STRIPING, PAVEMENT MARKINGS, LEGENDS, AND RAISED PAVEMENT MARKERS SHALL BE REMOVED EVEN IF NOT SHOWN ON PLANS. REMOVALS OF PAINTED STRIPING, PAVEMENT MARKINGS AND LEGENDS SHALL BE DONE BY WET SANDBLASTING. REMOVALS OF THERMOPLASTIC STRIPING, PAVEMENT MARKINGS AND LEGENDS SHALL BE REMOVED BY WET SANDBLASTING, GRINDING OR OTHER APPROVED METHOD AND SHALL NOT DAMAGE THE PAVEMENT. "BLACK OUT" OF EXISTING DELINEATION IS NOT PERMITTED. ALL DAMAGED PAVEMENT DUE TO REMOVALS SHALL BE REPAIRED AS NECESSARY TO MAINTAIN A SMOOTH AND UNIFORM SURFACE OR AS DIRECTED BY THE ENGINEER. ALL STRIPING REMOVALS AND LEGENDS SHALL BE "FOG SEALED".

EXISTING TOPOGRAPHY:

- SANITARY SEWER M.H.
- STORM DRAIN M.H.
- ELECTRIC M.H.
- WATER M.H.
- GATE VALVE
- ELECTRICAL TEST STATION (GAS)
- FIRE HYDRANT
- WATER METER

LEGEND:

- COLDMILL - CM1 (0.12') + DGAC PAVEMENT (0.12')
- FULL DEPTH AC DRIVEWAY MATCHUP
- PROPOSED (0.21') DGAC PAVEMENT OVER (0.50') CLASS II CAB
- PROPOSED PCC

SHEET INDEX:

SHEET NO.	DESCRIPTION
1	LOCATION MAP, GENERAL NOTES, CONSTRUCTION NOTES AND SIGN/STRIPING NOTES
2	MOBLEY AVENUE TO 10444 COOK AVENUE
3	CHAMPAGNE COURT TO TYLER STREET

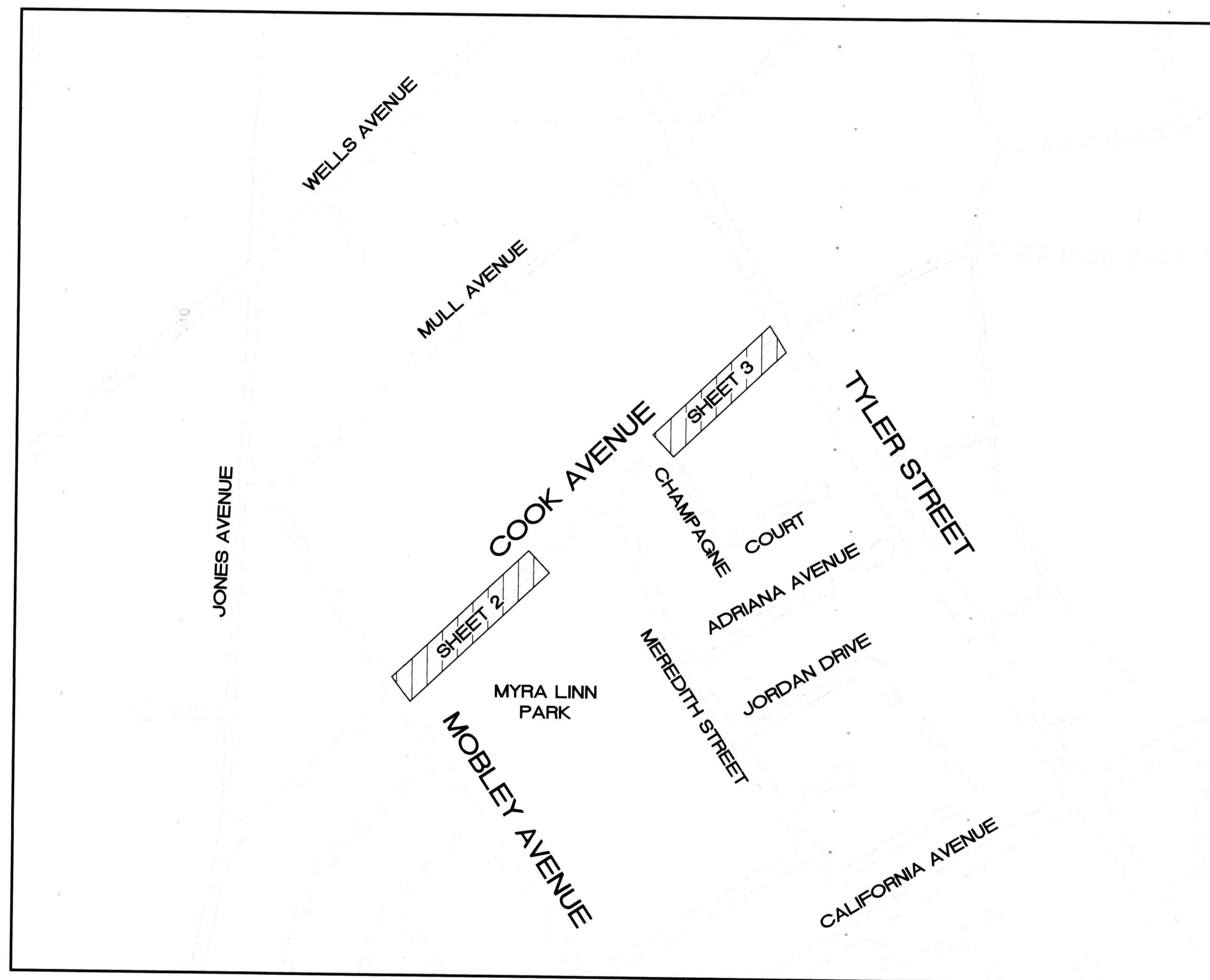

LOCATION MAP
NTS

= PROJECT LOCATION

<p>ENGINEER IN RESPONSIBLE CHARGE EDWARD LARA R.C.E. No. 63753 EXPIRES: 9-30-20 DATE February 25, 2019</p>		<p>CITY OF RIVERSIDE, CALIFORNIA DEPARTMENT OF PUBLIC WORKS</p>		<p>SIDEWALK IMPROVEMENTS DESIGN WORK ORDER NO.: 1820212 CONSTR. WORK ORDER NO.: 1820213</p>	
		<p>APPROVED BY: <i>[Signature]</i> DATE: 2/26/19 ENGINEERING MANAGER: <i>[Signature]</i> CONSTRUCTION ADMIN. <i>[Signature]</i> TRAFFIC DIVISION: <i>[Signature]</i> STREETS SERVICES: <i>[Signature]</i> SURVEYOR: <i>[Signature]</i></p>		<p>APPROVED BY: <i>[Signature]</i> DATE: MARCH 5, 2019 CITY ENGINEER</p>	
<p>2017/2018 CDBG - WARD 6 COOK AVENUE FROM MOBLEY AVENUE TO TYLER STREET</p>				<p>R-4439</p>	
<p>LOCATION MAP AND CONSTRUCTION NOTES</p>				<p>SHEET 1 OF 3</p>	
<p>HORIZ. SCALE: N/A VERT. SCALE: N/A</p>				<p>FILE NAME: R4439-T.DWG</p>	

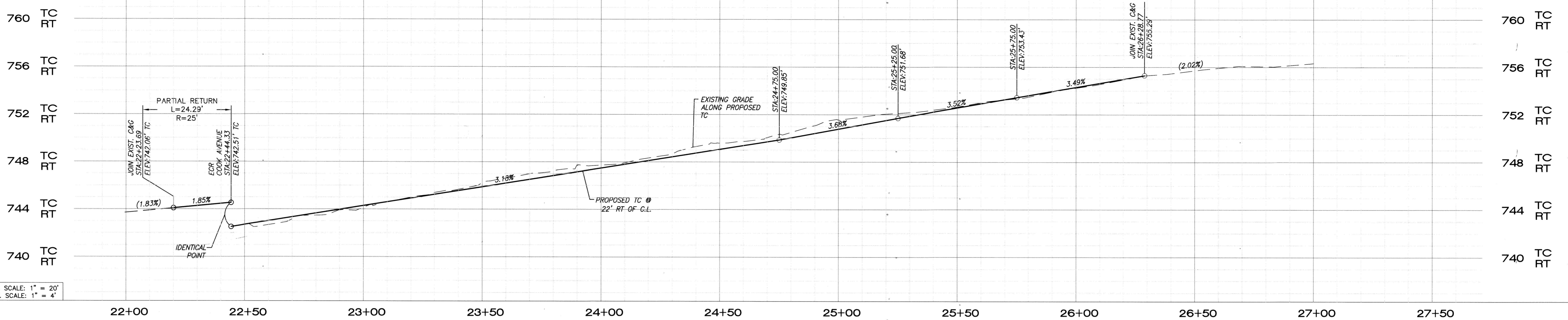

HORIZ. SCALE: 1" = 20'
VERT. SCALE: 1" = 4'

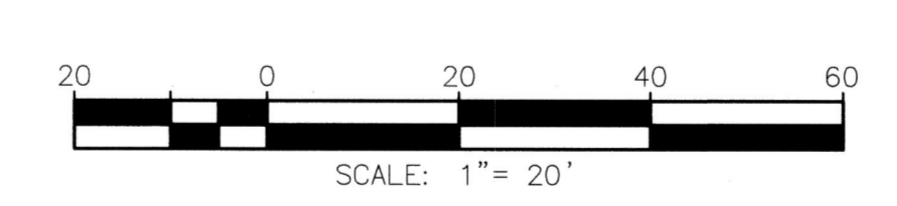
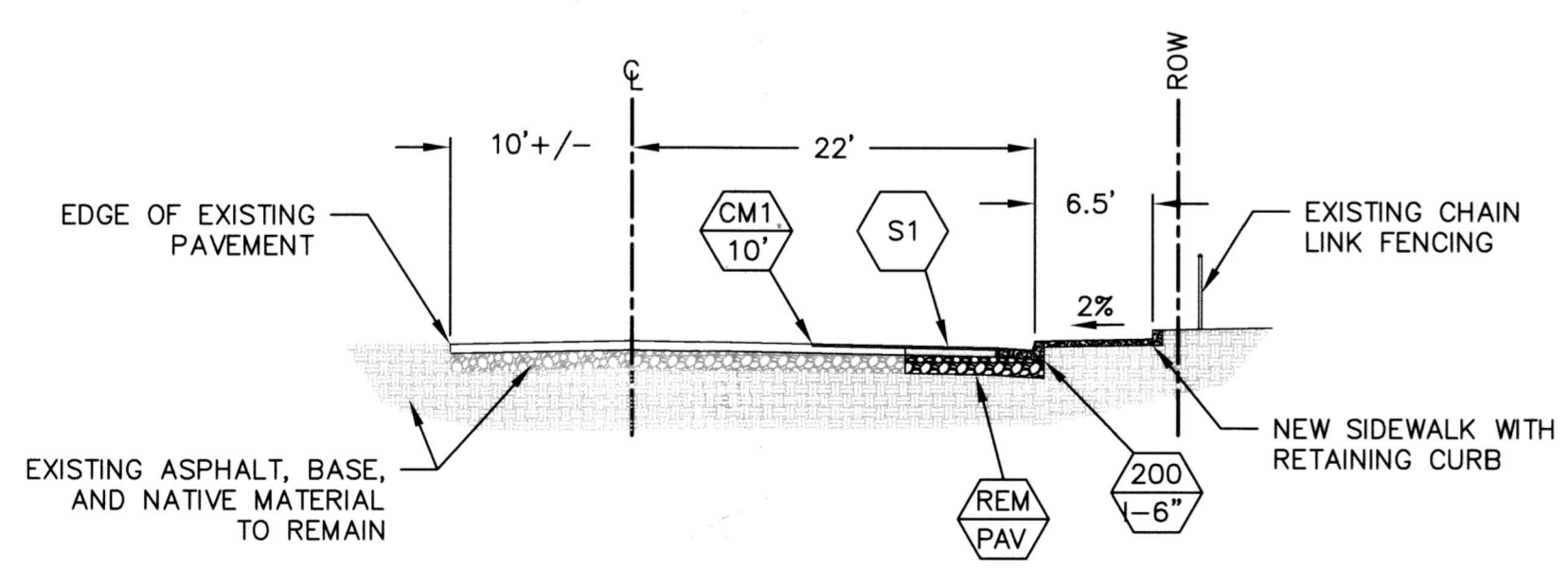
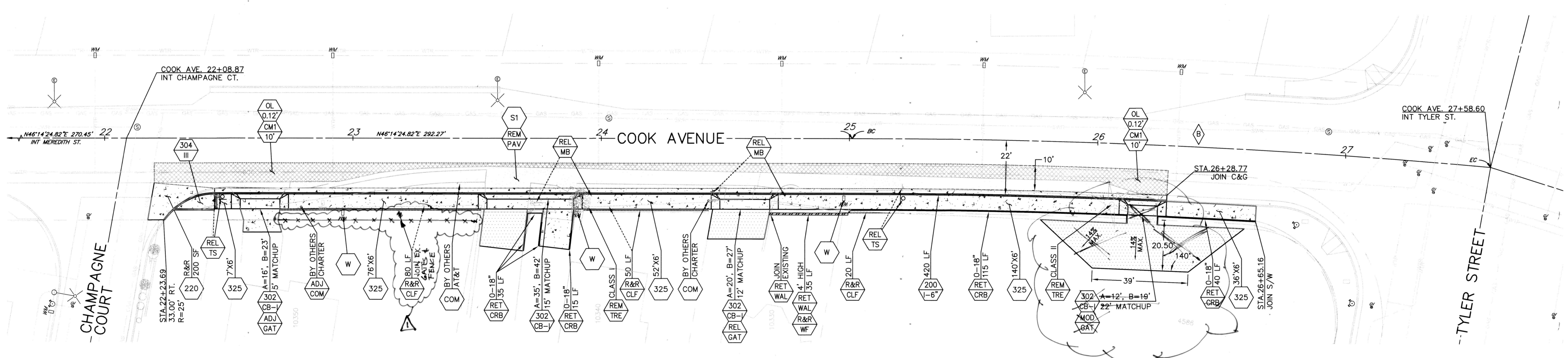

CURVE DATA TABLE				
CURVE	TANGENT	LENGTH	RADIUS	DELTA
B	128.82'	257.47'	2845.21'	S48°48'31.67W"

COOK AVENUE AT 25+50.00:

SCALE: 1" = 10'

BENCHMARK: F3-K3

P.K. NAIL AND CITY ENGINEER TAG IN THE WESTERLY CURB TYLER ST. 64.5 FEET SOUTHERLY OF THE CENTERLINE INTERSECTION OF TYLER STREET AND OCAMPO STREET

ELEV. - 754.979 (NGVD 1929)

As Built 5/08/23 B.O

<p>ENGINEER IN RESPONSIBLE CHARGE Edward Lara R.C.E. No. 63753 EXPIRES: 9-30-20 DATE February 25, 2019</p>		<p>CITY OF RIVERSIDE, CALIFORNIA DEPARTMENT OF PUBLIC WORKS</p>		<p>SIDEWALK IMPROVEMENTS 2017/2018 CDBG - WARD 6 COOK AVENUE FROM MOBLEY AVENUE TO TYLER STREET</p>		<p>DESIGN WORK ORDER NO.: 1820212 CONSTR. WORK ORDER NO.: 1820213</p>
		<p>APPROVED BY: <i>EM</i> DATE: 2/26/19 CONSTRUCTION ADMIN. DATE: 3/1/19 TRAFFIC DIVISION DATE: 3/1/19 STREETS SERVICES SURVEYOR DATE: 2/27/19</p>	<p>APPROVED BY: <i>DC</i> DATE: March 5, 2019 CITY ENGINEER</p>	<p>R-4439 SHEET 3 OF 3 FILE NAME: R4439-3.DWG</p>		