

**GENERAL NOTES**

- No person shall perform any construction activity or install any objects within the public rights-of-way or easements of the City of Riverside without a valid Construction Permit or, a Street Opening Permit or an Encroachment Permit issued by the City's Public Works Department. It shall be the responsibility of the contractor to clear the right of way in accordance with the provisions of law as it affects each utility including irrigation lines and appurtenances and at no cost to the City.
- Construction shall be in accordance with the City of Riverside Department of Public Works, Standard Drawings, its Supplemental Notes and the Standard Specifications for Public Works Construction, current edition.
- The private engineer signing these plans is responsible for assuring the accuracy and acceptability of the work hereon. In the event of discrepancies arising during construction, the private engineer shall be responsible for determining an acceptable solution and revising the plans for approval by the City (This note required on all plans.)
- Quantities shown are for information only and the City of Riverside is not responsible for their accuracy.
- The developer shall be responsible for preserving or re-establishing and re-erecting survey monuments destroyed, disturbed or buried as a result of construction shown hereon.
- All flagged elevations shall be staked in the field by the private engineer.
- Where new pavement is to join the existing pavement, the edge of the existing pavement shall be trimmed in a smooth and straight line. Construct match-up paving as shown on the plans and overlay paving as directed in the field to produce a smooth section.
- Construct driveway approaches per Standard Drawing 302. Exact size and location to be staked by the Private Engineer prior to construction of the curb and gutter.
- The subdivider shall arrange for a soil test to be made by a soils engineer after the streets have been prepared to rough grade and prior to curb and gutter construction. Depth of base material and A.C. paving shall be determined by the City of Riverside design standards and test procedures.
- On all areas within public right of way where the fill is one (1) foot or greater, a letter will be required from the soils engineer, certifying the compaction of the fill below subgrade, prior to issuance of the Construction Permit/Cut Sheets.
- Any traffic control striping obliterated and/or badly worn during construction shall be restored by the contractor within five days after notification from the City Inspectors.
- Final striping for traffic control and/or pavement marking to be the responsibility of the developer.
- The contractor shall call in a location request to Underground Service Alert (USA), Phone # 1-800-227-2600, two working days before digging. No construction permit will be issued by the Public Works Department involving excavation for underground facilities unless the applicant has been provided an inquiry identification number by U.S.A.
- In pavement overlay areas, any distressed existing pavement shall be removed and replaced as directed by the Inspector prior to overlaying with A.C. paving.
- The contractor shall coordinate trenching for cable television with other trenching within the subdivision.

**CONSTRUCTION NOTES:**

- CONSTRUCT 6" CONC. CURB & GUTTER PER CITY STD. 200 TYPE 1
- CONSTRUCT PAVEMENT STRUCTURAL SECTION OF FULL DEPTH AC OVER COMPACTED NATIVE SOIL PER SOILS REPORT
- INSTALL TYPE F-1 MARKERS @ 10' O.C.
- CONSTRUCT 5' WIDE PROPERTY LINE SIDEWALK PER CITY STD. 325
- CONSTRUCT DRIVE APPROACH PER CITY STD. 302, TYPE PL-1 (A=25.66', B=39.66') COMMERCIAL DRIVEWAY

**QUANTITIES:**

104 L.F.
2,276 S.F.
2 EA.
713 S.F.
1 EA.

**LEGEND:**

(100.00)	EXISTING ELEVATION
100.10	PROPOSED ELEVATION
T.B.M.	TEMPORARY BENCH MARK
INV.	INVERT ELEVATION
T.C.	TOP OF CURB
F.L.	FLOW LINE
L.T.S.	LIGHT STANDARD
T.S.	TRAFFIC SIGNAL
TEL.	TELEPHONE/PEDESTAL
S.W.	SIDEWALK
L.S.	LANDSCAPING
W.M.	WATER METER
P.P.	POWER POLE
S.M.H.	SEWER MANHOLE
F.H.	FIRE HYDRANT
E.P.	EDGE OF PAVEMENT
RT.	RIGHT
V.C.	VERTICAL CURVE
B.V.C.	BEGIN VERTICAL CURVE
E.V.C.	END VERTICAL CURVE
C.F.	CURB FACE
P.I.	POINT OF INTERSECTION
EX.	EXISTING

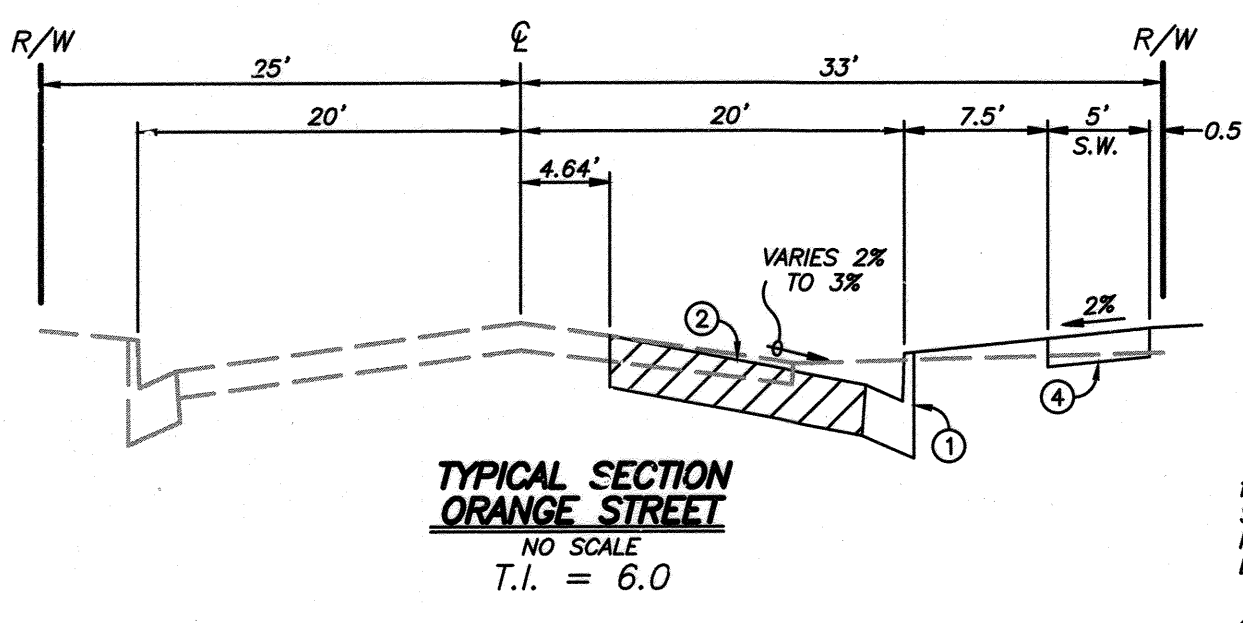
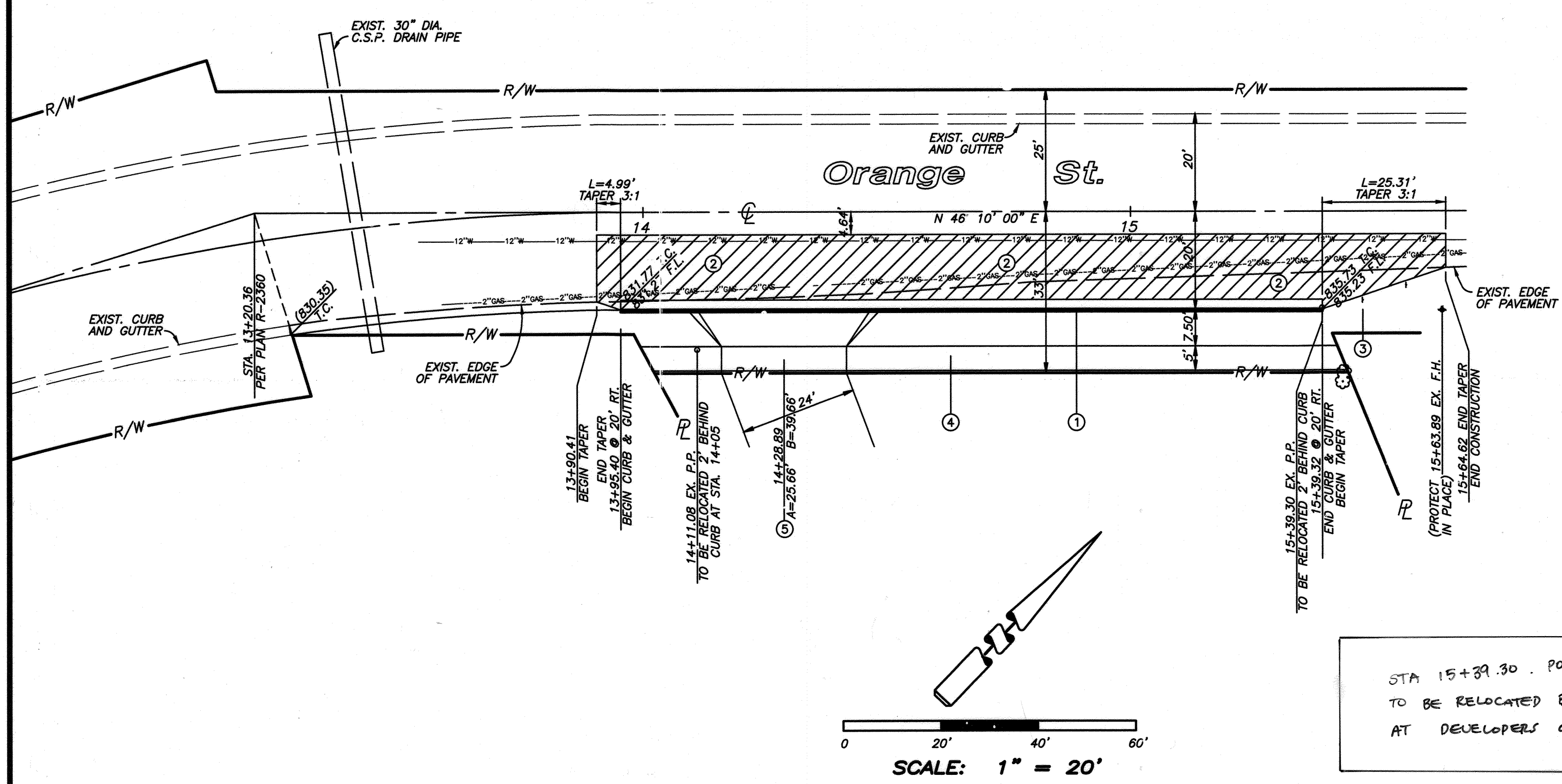

**PRIVATE ENGINEER'S NOTICE TO CONTRACTOR**

- THE EXISTENCE AND LOCATION OF ANY UNDERGROUND UTILITY PIPES OR STRUCTURES SHOWN ON THIS PLAN ARE OBTAINED BY A SEARCH OF AVAILABLE RECORDS. TO THE BEST OF OUR KNOWLEDGE THERE ARE NO EXISTING UTILITIES EXCEPT AS SHOWN ON THESE PLANS. THE CONTRACTOR IS REQUIRED TO TAKE DUE PRECAUTIONARY MEASURES TO PROTECT THE UTILITIES SHOWN AND ANY OTHER LINES OR STRUCTURES NOT SHOWN ON THESE PLANS.
- ALL CONTRACTORS AND SUBCONTRACTORS PERFORMING WORK SHOWN ON OR RELATED TO THESE PLANS SHALL CONDUCT THEIR OPERATIONS SO THAT ALL EMPLOYEES ARE PROVIDED A SAFE PLACE TO WORK AND THE PUBLIC IS PROTECTED. ALL CONTRACTORS AND SUBCONTRACTORS SHALL COMPLY WITH THE "OCCUPATIONAL SAFETY AND HEALTH REGULATIONS" OF THE U.S. DEPARTMENT OF LABOR, AND WITH THE STATE OF CALIFORNIA DEPARTMENT OF INDUSTRIAL RELATIONS' "CONSTRUCTION SAFETY ORDERS".
- THE CIVIL ENGINEER SHALL NOT BE RESPONSIBLE IN ANY WAY FOR THE CONTRACTORS' AND SUBCONTRACTORS' COMPLIANCE WITH THE "OCCUPATIONAL SAFETY AND HEALTH REGULATIONS" OF THE U.S. DEPARTMENT OF LABOR OR WITH THE STATE OF CALIFORNIA DEPARTMENT OF INDUSTRIAL RELATIONS' "CONSTRUCTION SAFETY ORDERS".
- CONTRACTOR FURTHER AGREES THAT HE SHALL ASSUME SOLE AND COMPLETE RESPONSIBILITY FOR JOB SITE CONDITIONS DURING THE COURSE OF CONSTRUCTION OF THIS PROJECT, INCLUDING SAFETY OF ALL PERSONS AND PROPERTY; THAT THIS REQUIREMENT SHALL APPLY CONTINUOUSLY AND NOT BE LIMITED TO NORMAL WORKING HOURS; AND THAT THE CONTRACTOR SHALL DEFEND, INDEMNIFY AND HOLD THE OWNER AND THE ENGINEER HARMLESS FROM ANY LIABILITY, REAL OR ALLEGED, IN CONNECTION WITH THE PERFORMANCE OF WORK ON THIS PROJECT, EXCEPT FOR LIABILITY ARISING FROM THE SOLE NEGLIGENCE OF THE OWNER OR THE ENGINEER.
- THE CONTRACTOR SHALL CHECK ALL DRAWINGS, SPECIFICATIONS AND ESTIMATED QUANTITIES FURNISHED HIM IMMEDIATELY UPON THEIR RECEIPT, AND SHALL PROMPTLY NOTIFY THE OWNER OF ANY DISCREPANCIES THEREIN. SHOULD ANY ERRORS, OMISSIONS, AMBIGUITIES OR DISCREPANCIES BE FOUND ON THE DRAWINGS, SPECIFICATIONS, OR ESTIMATED QUANTITIES TO WHICH THE CONTRACTOR FAILED TO CALL ATTENTION BEFORE SUBMITTING HIS BID, THEN THE OWNER WILL INTERPRET THE INTENT OF THE DRAWINGS OR SPECIFICATIONS AND THE CONTRACTOR WILL PERFORM THE WORK IN ACCORDANCE WITH SUCH INTERPRETATION.
- IT SHALL BE THE CONTRACTOR'S RESPONSIBILITY TO CERTIFY DIMENSIONS AND CONDITIONS AT THE JOB SITE, AND CROSSCHECK DETAILS AND DIMENSIONS SHOWN ON THE DRAWING. THE ENGINEER SHALL BE NOTIFIED IMMEDIATELY OF ANY DISCREPANCIES FOUND.

**VICINITY MAP**

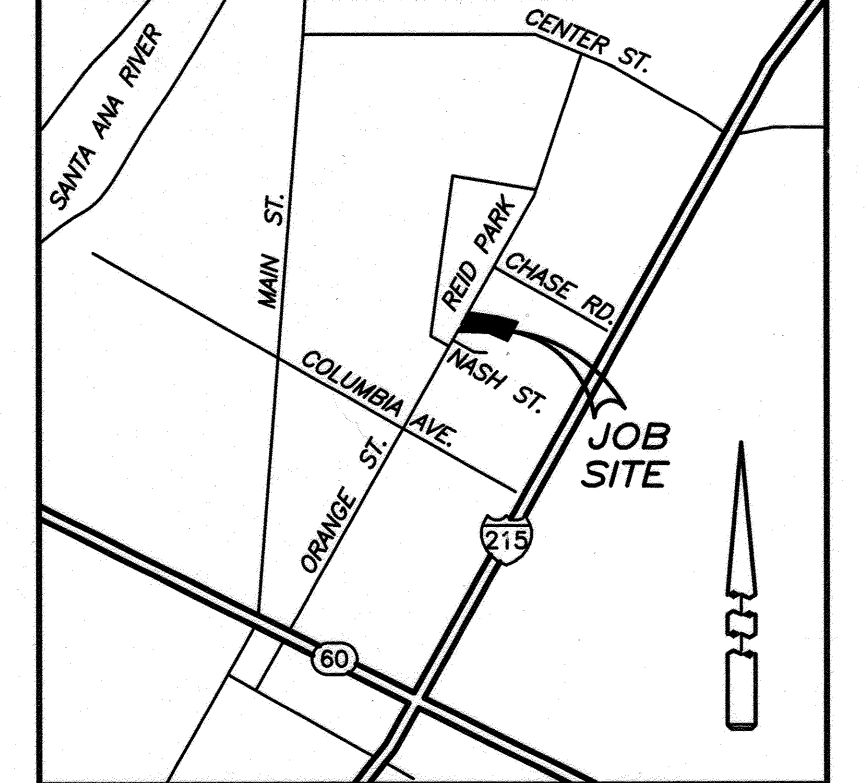

**IMPORTANT NOTICE**  
 Section 4216/4217 of the Government Code requires a Dig Alert Identification Number to be issued before a permit to excavate will be valid. For your Dig Alert ID, Number call CALL TOLL FREE 48 HOURS BEFORE YOU DIG UNDERGROUND SERVICE ALERT 1-800-227-2600

**CITY OF RIVERSIDE PUBLIC UTILITIES - WATER**  
 APPROVED BY: [Signature] DATE: 3/1/2019

**CITY OF RIVERSIDE PUBLIC UTILITIES - ELECTRIC**  
 APPROVED BY: [Signature] DATE: 3/1/19

**KZL Engineering**  
 811 Riedel Ave. (714) 726-6907 Fullerton, CA 92831 kurtleavitt@gmail.com  
 KURT LEAVITT R.C.E. 49320 EXP. 9-30-20

**BENCHMARK: J7-C2**  
 Brass Disk stamped "J7-C" in a monument well at the centerline intersection of Nash Street and Orange Street.  
 ELEV. 833.132 (NAVD 1988)

MARK	REVISIONS	APPR.	DATE

**CITY OF RIVERSIDE PUBLIC WORKS DEPARTMENT**  
 APPROVED BY: [Signature] DATE: 3/1/19  
 ENGINEERING MANAGER: [Signature] DATE: 3/1/19  
 TRAFFIC DIVISION: [Signature] DATE: 3/1/19

**TITLE SHEET AND PLAN SHEET**  
**978 ORANGE STREET**  
 EASTERLY SIDE FROM 205' TO 349' NORTHERLY OF NASH STREET PARCEL MAP NO. 36960  
 HORIZ. SCALE: 1" = 20' VERT. SCALE: 1" = 2'

PW18-0911  
**R-4476**  
 SHEET 1 OF 2  
 J.N. 15-001ST



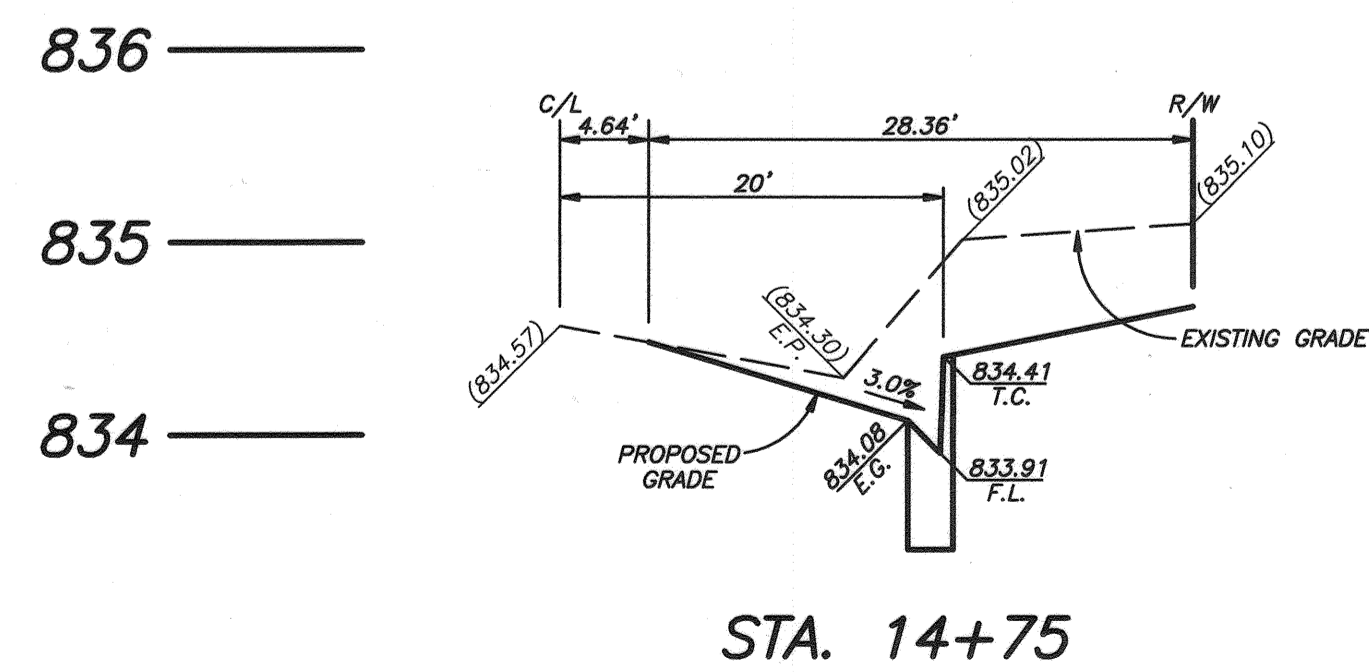
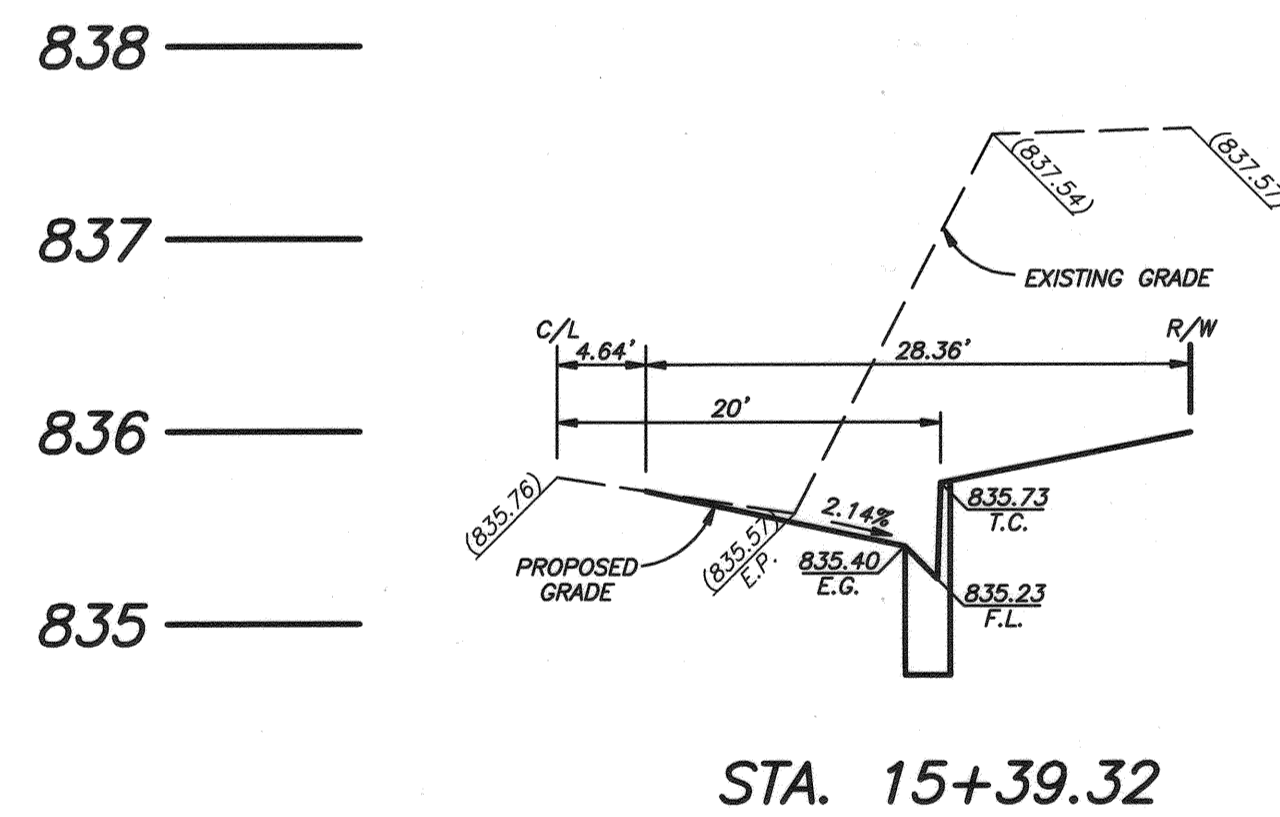
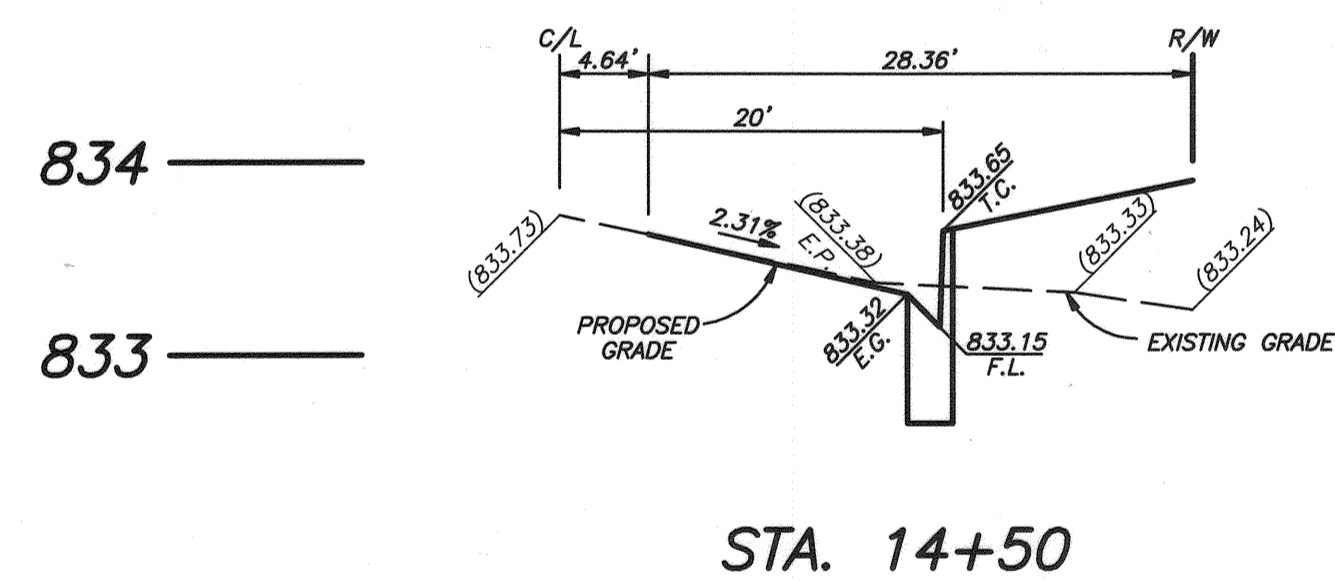
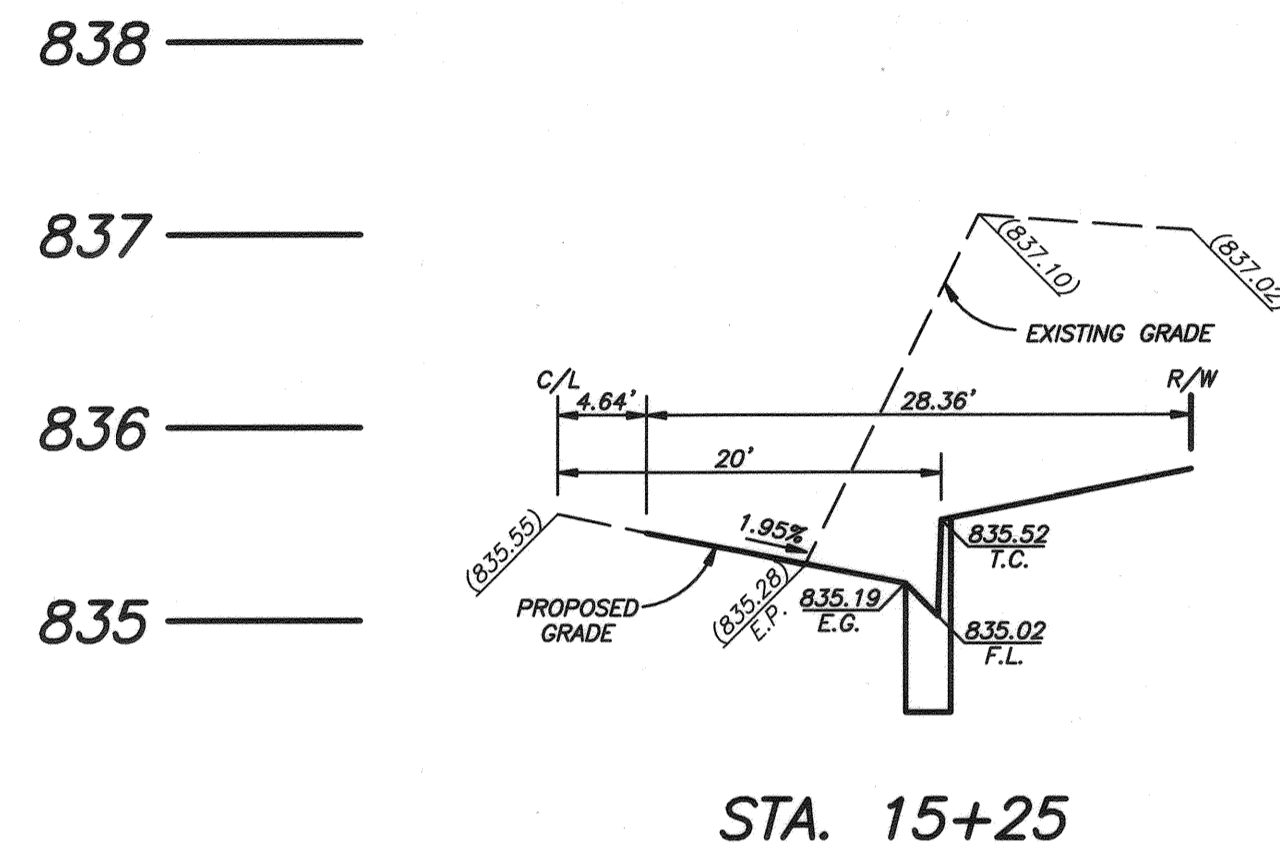
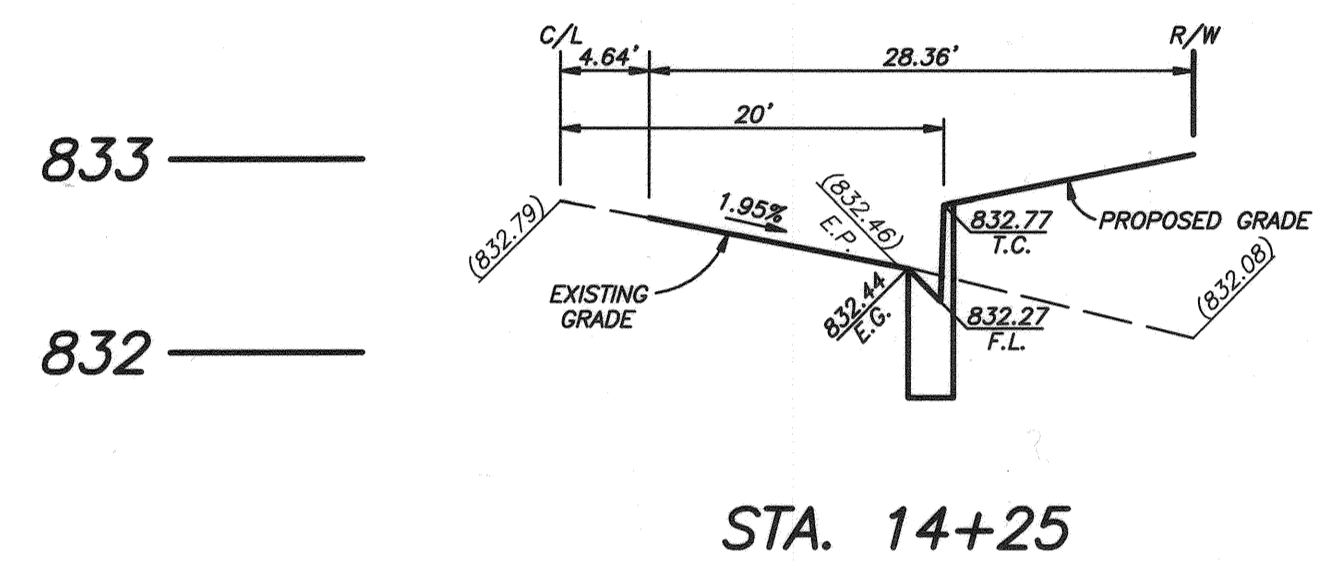
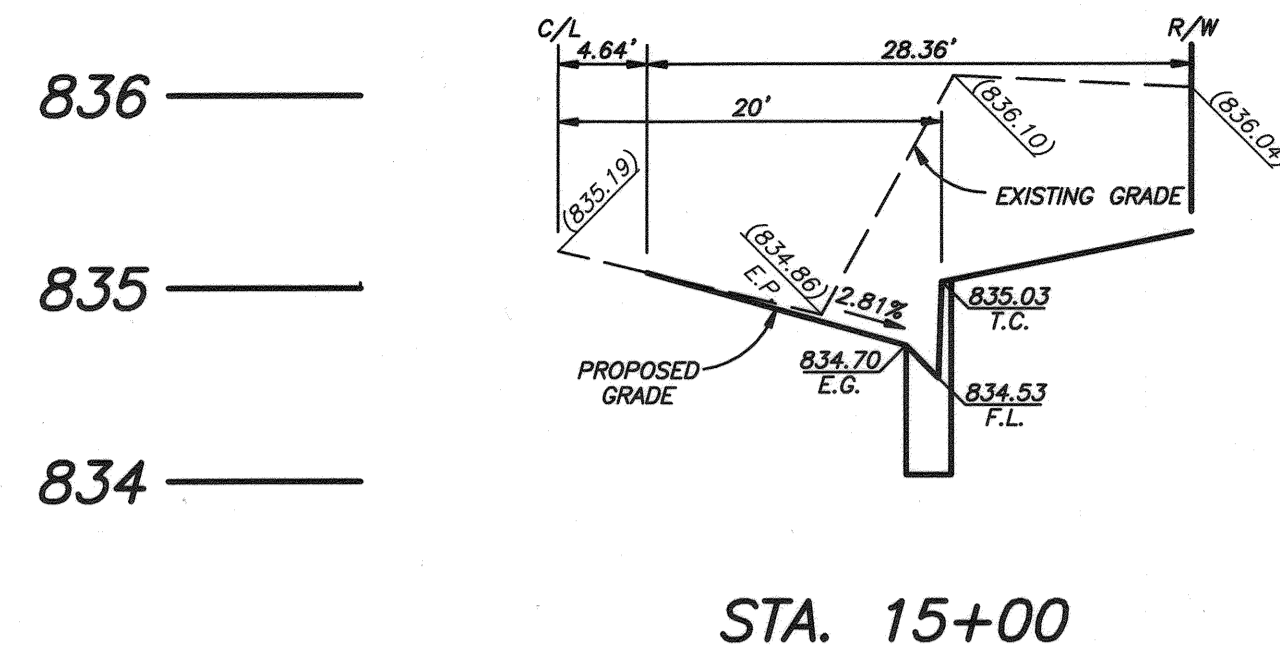
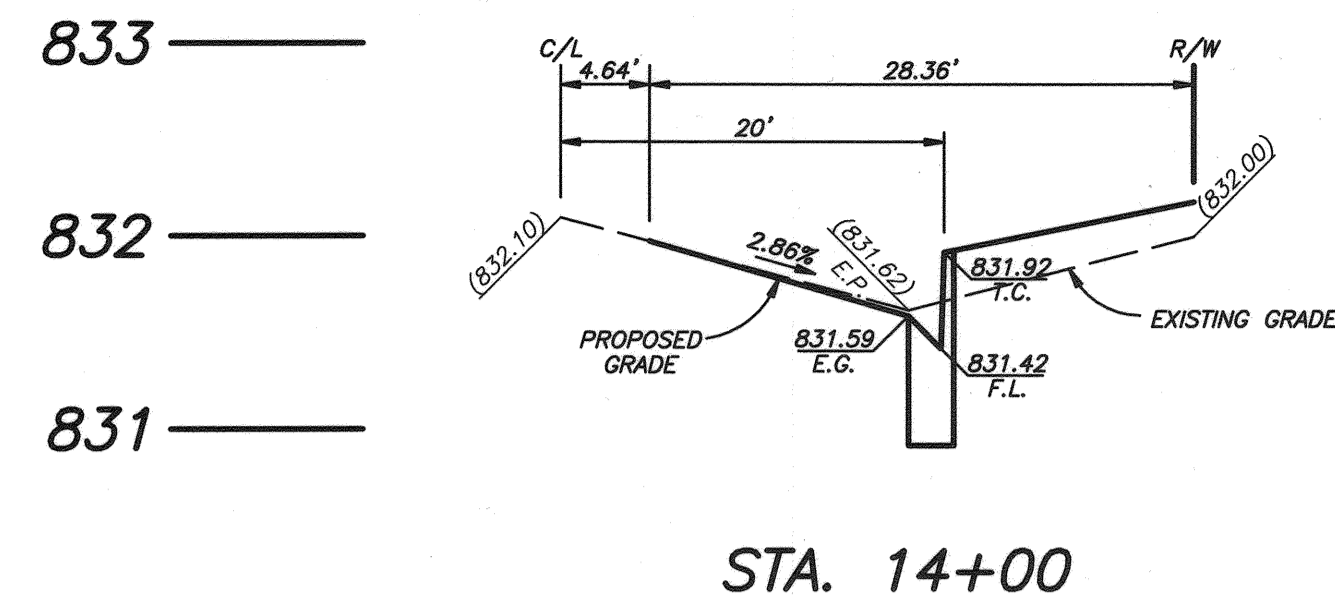

**CROSS-SECTIONS**

HORIZ. SCALE: 1" = 10'  
VERT. SCALE: 1" = 1'

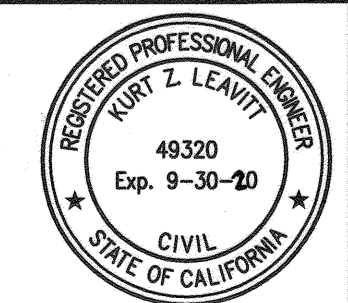
CITY OF RIVERSIDE PUBLIC UTILITIES - WATER  APPROVED BY _____ DATE _____	CITY OF RIVERSIDE PUBLIC UTILITIES - ELECTRIC  APPROVED BY _____ DATE _____	<b>KZL Engineering</b> 811 Riedel Ave. (714) 726-6907 Fullerton, CA 92831 kurtleavitt@gmail.com  KURT LEAVITT R.C.E. 49320 EXP. 9-30-20 DATE 2/8/19		<b>BENCHMARK: J7-C2</b> Brass Disk stamped "J7-C" in a monument well at the centerline intersection of Nash Street and Orange Street. ELEV. 833.132 (NAVD 1988)	DESIGNED BY <u>KZL</u> DRAWN BY <u>KZL</u> CHECKED BY <u>KZL</u>	<b>CITY OF RIVERSIDE</b> <b>PUBLIC WORKS DEPARTMENT</b>		<b>CROSS SECTIONS</b> <b>978 ORANGE STREET</b>		PW18-0911
						APPROVED BY _____ DATE <u>3/8/19</u> BY <u>[Signature]</u> ENGINEERING MANAGER TRAFFIC DIVISION	APPROVED BY _____ DATE <u>3/9/19</u> BY <u>[Signature]</u> CITY ENGINEER	EASTERLY SIDE FROM 205' TO 349' NORTHERLY OF NASH STREET PARCEL MAP NO. 36960	R-4476 SHEET <u>2</u> OF <u>2</u>	J.N. 15-001XS