

- NOTES**
- Adopted from Plan R-422 prepared by J.F. Davidson-Civil Engineer, Riverside, California.
 - This Contract includes I.B.M., P.M.S., Seal Coat, Redwood Headers and Raising manholes to grade.
 - Shaded area indicates present construction.

APPROVED *[Signature]* 1-10-61
 PLANK SUPERINTENDENT

REVISIONS		
MARK	DATE	DESCRIPTION
①	5-22-61	Change grade on Braemar Avenue at Pine St.
②	May 21	Place width changed from 28' to 40' and Change Grade M.H. and Change Grade E.P. 10'11' added

DESIGNED BY *[Signature]* CHECKED BY *[Signature]*
 RECOMMENDED BY *[Signature]*

CITY OF RIVERSIDE, CALIFORNIA
 DEPARTMENT OF PUBLIC WORKS

**TEQUESQUITE AVENUE
 PAVING**

FROM PALM AVE TO BROCKTON AVENUE

HORIZ. SCALE 1"=40' VERT. SCALE 1"=4'

APPROVED BY *[Signature]*
 Director of Public Works

NO. R-478
 DATE 5-7-61 SHEET 1 OF 2

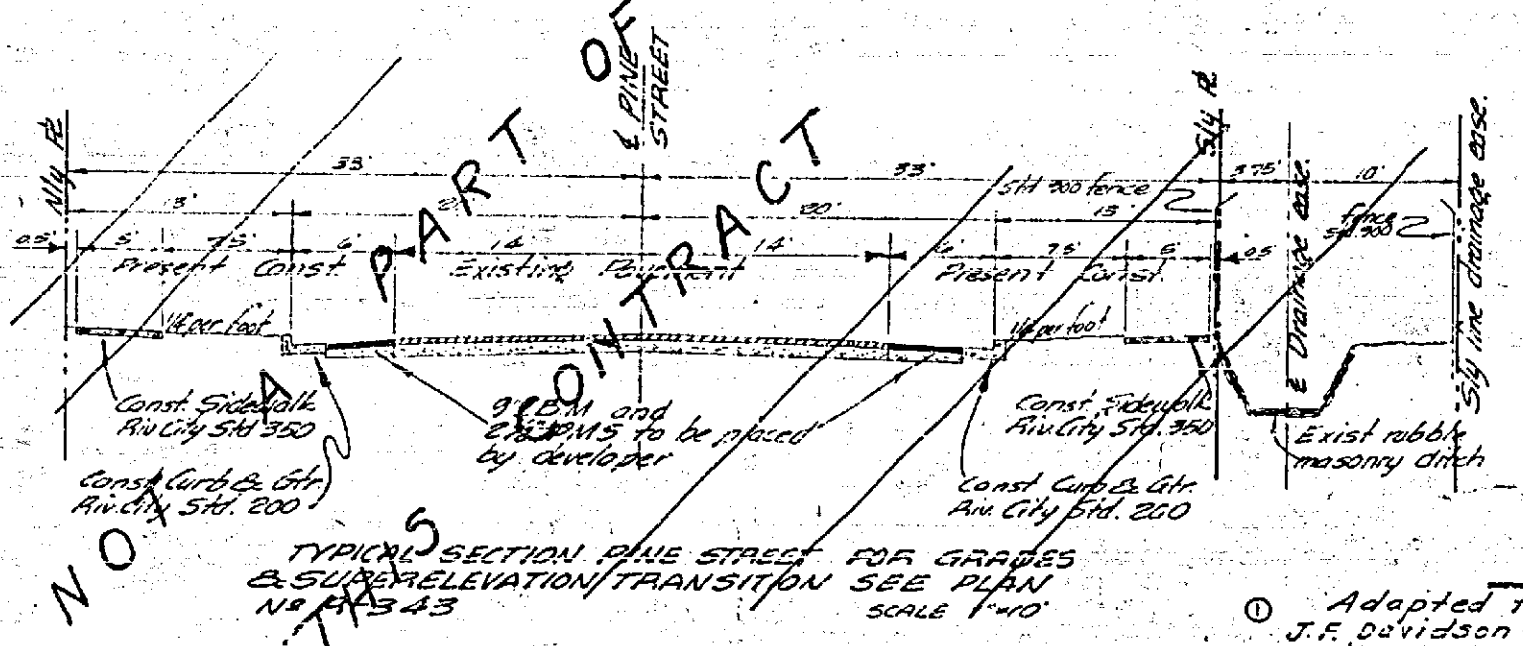
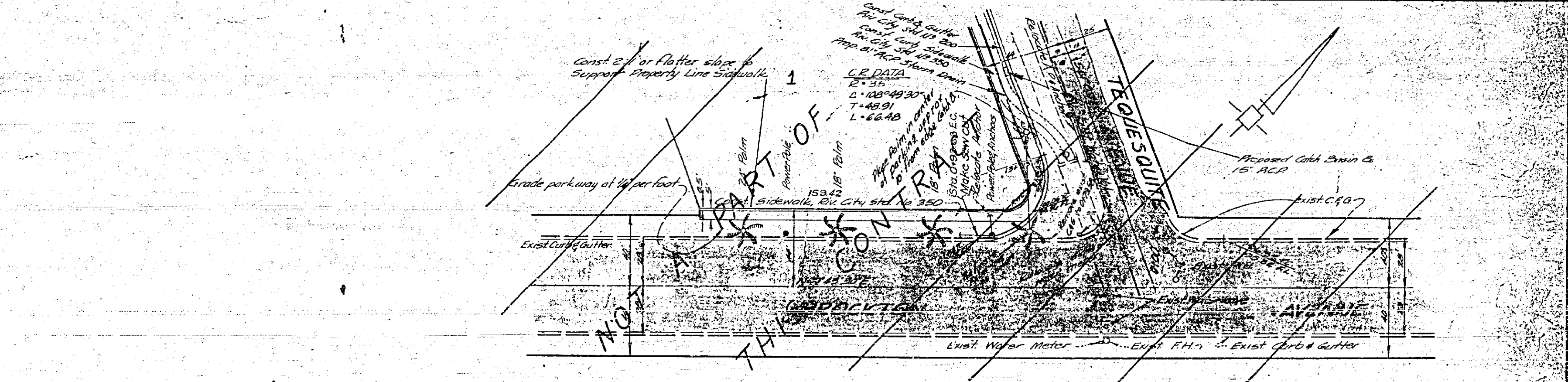
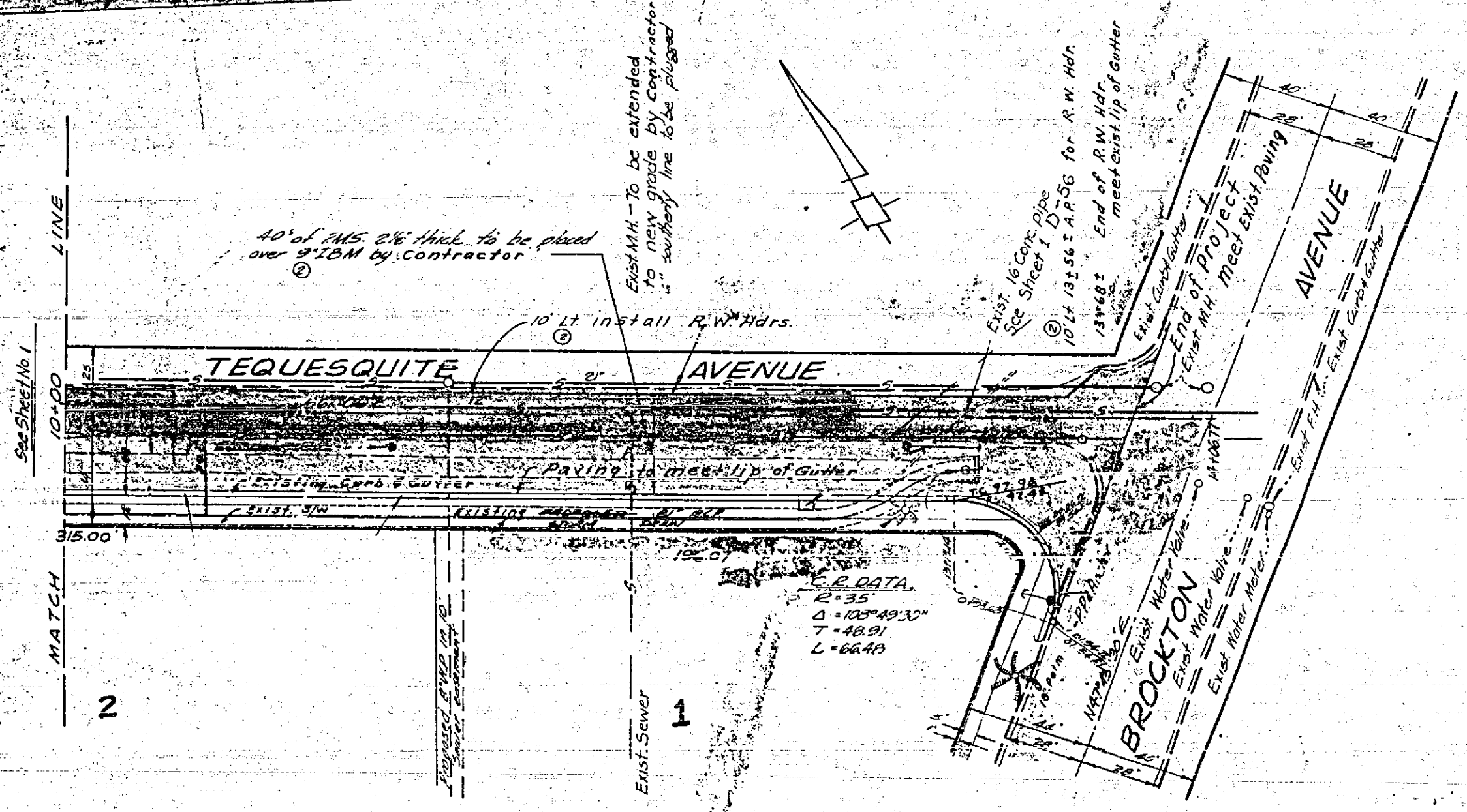
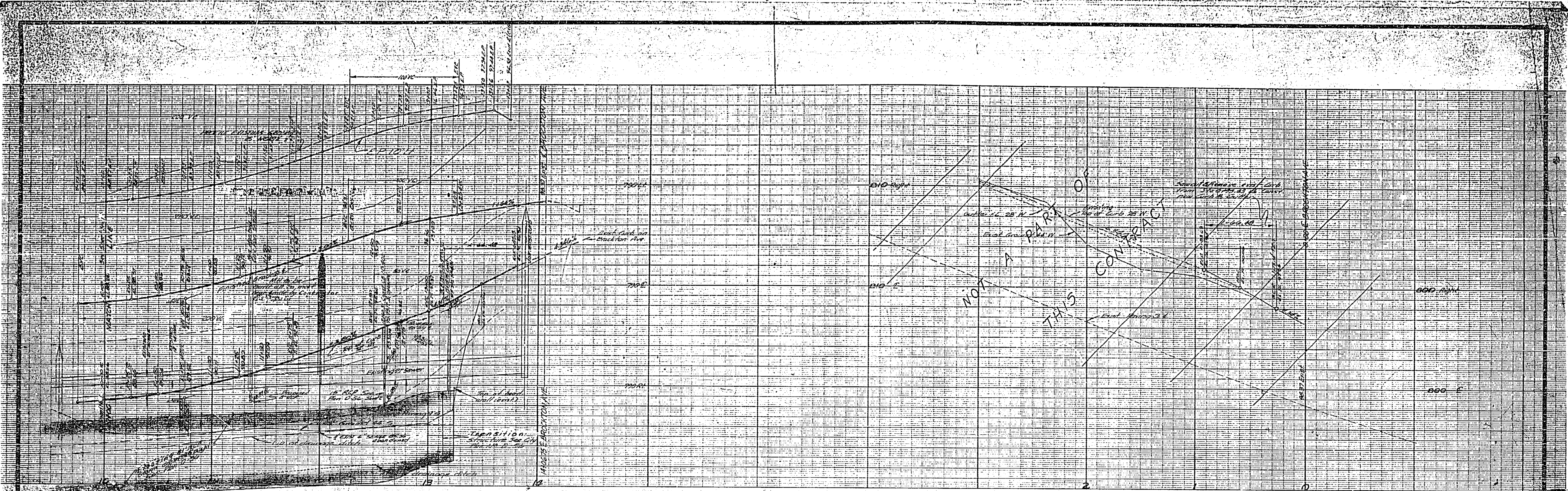

- NOTES**
- 1 Adopted from Plan R-422 prepared by J.F. Davidson - Civil Engineer, Riverside, California.
 - 2 This Contract includes 1.5 M. P.M.S. Seal coat, red wood headers, and raising manholes to grade.
 - 3 Shaded area indicates present construction to be 9" 1.5 M. 2 1/2" P.M.S. and seal coat.

REVISIONS	
MARK	DESCRIPTION
1	Final with changes from 10/16/60 per Change Order No. 1, 2, 3, 4, 5, 6, 7, 8, 9, 10, 11, 12, 13, 14, 15, 16, 17, 18, 19, 20, 21, 22, 23, 24, 25, 26, 27, 28, 29, 30, 31, 32, 33, 34, 35, 36, 37, 38, 39, 40, 41, 42, 43, 44, 45, 46, 47, 48, 49, 50, 51, 52, 53, 54, 55, 56, 57, 58, 59, 60, 61, 62, 63, 64, 65, 66, 67, 68, 69, 70, 71, 72, 73, 74, 75, 76, 77, 78, 79, 80, 81, 82, 83, 84, 85, 86, 87, 88, 89, 90, 91, 92, 93, 94, 95, 96, 97, 98, 99, 100.

APPROVED *Edith B. ...* 1-10-61
 PARK SUPERINTENDENT

CITY OF RIVERSIDE, CALIFORNIA
 DEPARTMENT OF PUBLIC WORKS

**TEQUESQUITE AVENUE
 PAVING**

FROM PALM AVE TO BROCKTON
 AVENUE

HORIZ. SCALE 1"=40' VERT. SCALE 1"=4'

APPROVED BY *...*
 Director of Public Works

DESIGNED BY *...*
 DRAWN BY *...*

CHECKED BY *...*

RECOMMENDED BY *...*
 ASSIST. CITY ENGINEER

DATE 9-7-61 SHEET 2 OF 3

NO. R-440