

RIVERSIDE

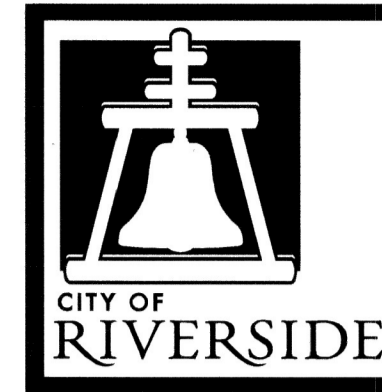

CALIFORNIA

PUBLIC WORKS DEPARTMENT BONITA AVE SIDEWALK IMPROVEMENTS

GENERAL CONSTRUCTION NOTES:

1. THE CONTRACTOR SHALL PROVIDE AND MAINTAIN TRAFFIC AS INDICATED IN THE ASSOCIATED PROJECT SPECIAL PROVISIONS.
2. CONSTRUCTION SHALL BE IN ACCORDANCE WITH THE CITY OF RIVERSIDE STANDARD DRAWINGS AND STANDARD SPECIFICATIONS FOR PUBLIC WORKS CONSTRUCTION, 2012 EDITION.
3. EXISTING UTILITIES SHOWN ON THIS PLAN ARE PLOTTED FROM UTILITY RECORDS. THE CONTRACTOR IS REQUIRED TO TAKE DUE PRECAUTIONARY MEASURES TO LOCATE AND PROTECT ALL UTILITIES WHETHER OR NOT SHOWN ON THIS PLAN.
4. CONFLICTING UTILITIES SHOWN WITHIN CONSTRUCTION AREA WILL BE RELOCATED PRIOR TO CONSTRUCTION.
5. ALL STREET PULL BOXES, GATE VALVES, MANHOLES, ETC, AFFECTED BY CONSTRUCTION, SHALL BE ADJUSTED TO THE PROPOSED GRADE.
6. PRIME CONTRACTOR BIDDING THIS WORK SHALL HAVE A CLASS "A" OR "C-8" AND "C-12".
7. CONTRACTOR SHALL REMOVE ALL VEGETATION WITHIN ALL SIDEWALK PANELS WITHIN THE PROJECT LIMITS.
8. ALL EXISTING IMPROVEMENTS INCLUDING, BUT NOT LIMITED TO, CURB, GUTTERS, CROSS GUTTERS, SIDEWALK, DRIVEWAYS, PARKWAY CULVERTS, INLETS, ETC, SHALL BE PROTECTED IN PLACE UNLESS OTHERWISE NOTED.
9. EXISTING IRRIGATION SHALL BE PROTECTED OR MODIFIED, INCLUDING FURNISHING NEW MATERIALS, AS NECESSARY TO CONSTRUCT NEW CONCRETE IMPROVEMENTS.
10. ALL FENCE POSTS SHALL BE PROTECTED OR MODIFIED AS NECESSARY IF POST FOUNDATION IS WITHIN A SIDEWALK PANEL THAT HAS BEEN CALLED OUT FOR REPLACEMENT.
11. ADEQUATE FLOW LINES SHALL BE MAINTAINED AT ALL LOCATIONS.
12. CONTRACTOR SHALL GRIND AND OVERLAY EXISTING PAVEMENT AS REQUIRED ADJACENT TO 5% MAX. PEDESTRIAN RAMP BOTTOM LANDING INDICATED ON STANDARD DRAWING NO 304. CONTRACTOR SHALL GRIND AND OVERLAY AS NECESSARY BEYOND LANDING TO JOIN EXISTING PAVEMENT TO PROVIDE A FINISHED JOIN GRADE OF 16% MAXIMUM.
13. CONTRACTOR SHALL RECONSTRUCT EXISTING SIDEWALK OR ADD NEW SIDEWALK PER CITY STANDARD 325 AS NECESSARY TO ADEQUATELY JOIN NEW RAMP TO BE CONSTRUCTED PER CITY STD 304, WHETHER INDICATED OR NOT.

EXISTING TOPOGRAPHY:

- ⊙ SANITARY SEWER M.H. Ⓞ GATE VALVE ⊕ ELECTRIC M.H.
- ⊙ STORM DRAIN M.H. Ⓞ ELECTRICAL TEST STATION (GAS)
- ⊙ FIRE HYDRANT ⊕ WATER M.H.

LEGEND:

- NEW 4" A.C. OVER NATIVE
- PROPOSED PCC

ABBREVIATION:

- CG CURB AND GUTTER
- CF CURB FACE
- C/L CENTERLINE
- DWY DRIVEWAY
- EX. EXISTING
- FH FIRE HYDRANT
- FL FLOW LINE
- FS FINISH SURFACE
- GB GRADE BREAK
- GV GATE VALVE
- M.H. MANHOLE
- M.U. MATCH-UP
- N.T.S. NOT TO SCALE
- TC TOP OF CURB

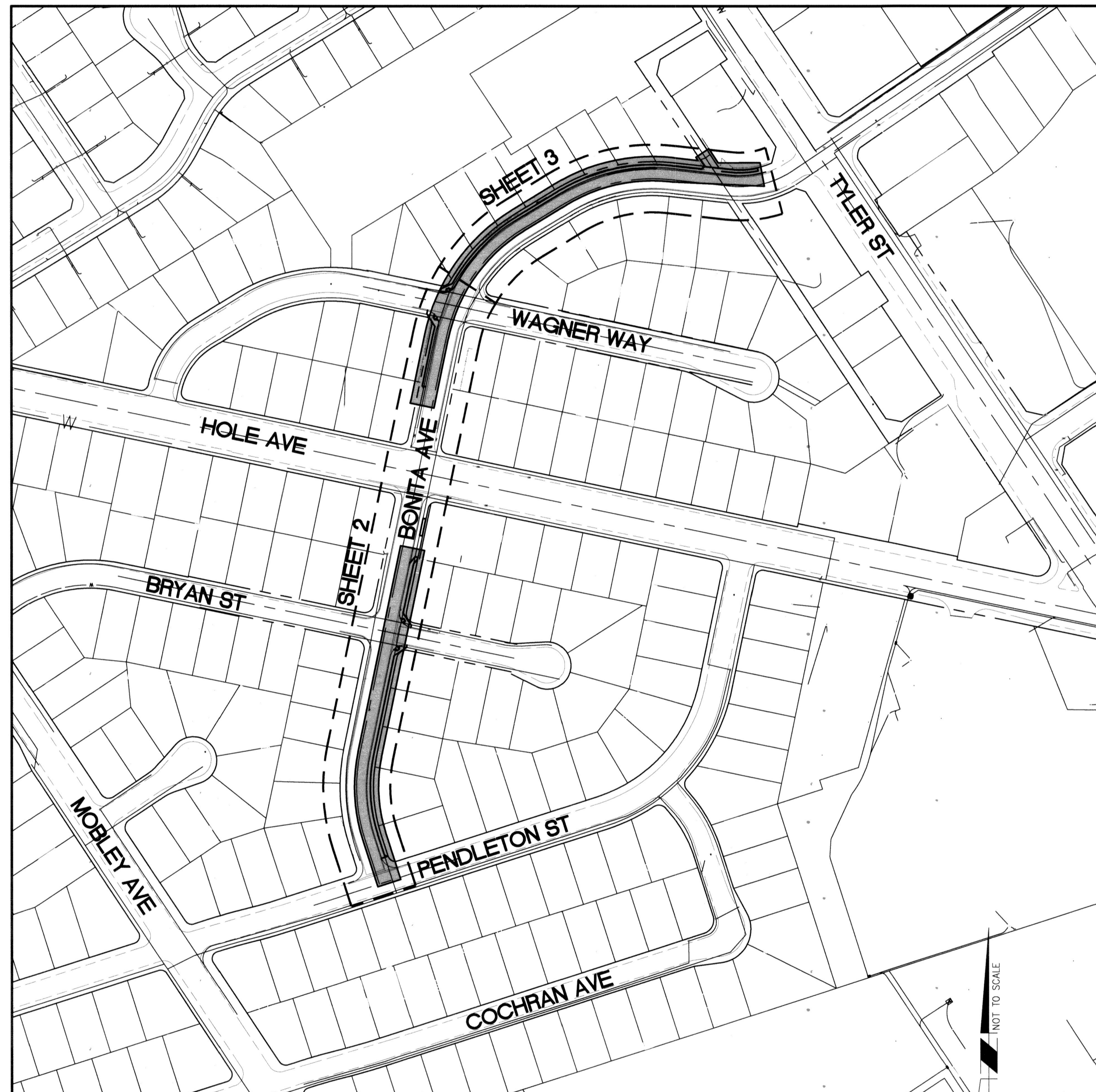

INDEX MAP

NTS

LEGEND

- ▬ PROJECT LOCATION
- - - SHEET LIMITS

CONSTRUCTION NOTES:

- ⬡ REMOVE AND REPLACE IN KIND EXISTING FACILITY. NUMBERS ABOVE 100 IN A HEXAGON ON THE PLAN REFER TO THE RESPECTIVE STANDARD DRAWING AND SHALL BE CONSTRUCTED ACCORDINGLY. ANY NOTE SHOWN BELOW THE STANDARD DRAWING NUMBER INDICATES THE SPECIFIC TYPE, ACTION, OR MODIFICATION TO BE CONSTRUCTED. DIMENSIONS OF NEW FACILITY SHALL BE MODIFIED AS NECESSARY, EXCLUDING ADA REQUIREMENTS, TO MATCH EXISTING FACILITY REMOVED.
- Ⓜ ADJUST TO GRADE, DESCRIPTION PER PLAN (---):
(WM) WATER METER (GV) GAS GATE VALVE & WATER GATE VALVE (SL) STREET LIGHT (PB) PULLBOX. (GM) MODIFY GATE AND GATE MOTOR FOR FULLY FUNCTIONAL GATE. (MH) SEWER AND/OR STORM DRAIN MANHOLE
- Ⓜ PROTECT IN PLACE, DESCRIPTION PER PLAN (---):
(MB) MAILBOX (GT) CHAIN LINK OR WROUGHT IRON GATE. (CLF) CHAIN LINK FENCE (WIF) WROUGHT-IRON FENCE AND/OR MASONRY WALL (TR) TREE. (SGN) STREET SIGN, (DWY) DRIVEWAY (BW) BLOCK WALL (PB) ELECTRIC PULL BOX (SWD) SIDEWALK DRAIN (PP) POWER POLE (SL) STREET LIGHT (COR) CURB CORE DRAIN (RIS) RISER (GAS, AT&T, ETC.)
- Ⓜ RELOCATE EXISTING TO PROPOSED LOCATION, DESCRIPTION PER PLAN (---):
(MB) MAILBOX. (CLF) CHAIN LINK FENCE. (GT) CHAIN LINK OR WROUGHT IRON GATE. (WM) WATER METER (WATER SERVICE SHALL BE EXTENDED AND WATER METER SHALL BE RELOCATED BY CITY FORCES. CONTACT CITY CONSTRUCTION SUPERINTENDENT AT 951-351-6368 TO SCHEDULE METER RELOCATION. PLEASE ALLOW 2 WEEKS FOR CONSTRUCTION SCHEDULING). (SGN) STREET SIGNS (STOP SIGN, SPEED LIMITS ETC.) SEE SIGNING AND STRIPING PLANS (MP) MASONRY PILASTERS AND WROUGHT IRON FENCING PER MASONRY PILASTER STD. PLAN. (FH) FIRE HYDRANT. (PP) POWER POLE-BY CITY FORCES. (CO) CLEAN-OUT.
- Ⓜ REMOVE EXISTING AND REPLACE WITH NEW AT PROPOSED LOCATION, DESCRIPTION PER PLAN.
(MB) MAILBOX. (CLF) CHAIN LINK FENCE. (SHR) SHRUB (GP) GUY POLE-BY CITY FORCE (XG) CROSS GUTTER (BPW) BLOCK PLANTER WALL (SGN) STREET SIGN AND POST. (SW) SIDEWALK PANEL (CG) CURB AND GUTTER
- Ⓜ REMOVE EXISTING, DESCRIPTION PER PLAN (---):
(T1) CLASS I TREE AND ROOTS. (T2) CLASS II TREE AND ROOTS. (T3) CLASS III TREE AND ROOTS. (SHR) SHRUB. (BDR) LANDSCAPE BORDER. (STP) STEPPED WALKWAY (PLN) PLANTER. (PVR) BRICK PAVERS. (RET) RETAINING WALL (XG) CROSS GUTTER (CG) CURB AND GUTTER (BW) BLOCK WALL (SGN) STREET SIGN AND POST (PIP) PIPE (MH) MANHOLE (SEWER, STORM DRAIN MANHOLE)
- Ⓜ CONSTRUCT 6" CURB ONLY PER CITY STD. 200
(II) = TYPE II
- Ⓜ CONSTRUCT DRIVEWAY PER CITY STD 302 WITH THE FOLLOWING MODIFICATIONS (---):
(C1) = CONSTRUCT TYPE CURB-1 DRIVEWAY PER STD. PLANS
- Ⓜ CONSTRUCT WHEELCHAIR RAMP PER CITY STD 304 WITH THE FOLLOWING TYPE OR MODIFICATION (---):
(I) = TYPE I. (VII) = TYPE VII @ MID BLOCK DWY
- Ⓜ CONSTRUCT SIDEWALK PER CITY STD 325 WITH THE FOLLOWING TYPE OR MODIFICATION (---):
(STD) = CONSTRUCT CURBSIDE SIDEWALK PER STD. PLANS.
(RET) = CONSTRUCT RETAINING CURB BEHIND SIDEWALK. INCLUDES CURB HEIGHTS UP TO 18".
- Ⓜ REMOVE EXISTING AND CONSTRUCT 4" A.C. (DWY) = OVER COMPACTED NATIVE
- Ⓜ CONSTRUCT NEW STEPPED WALKWAY TO MATCHUP WITH EXISTING WALKWAY. MINIMUM/MAXIMUM RISE ON STEPS SHALL BE 4"/7". RUN SHALL BE 10".

SHEET INDEX

SHEET NO.	SHEET NAME (LIMITS)
1.	TITLE SHEET
2.	BONITA AVE STA. 10+00.00 TO 21+00.00
3.	BONITA AVE STA. 21+00.00 TO 26+84.44

As Builts 5/09/23 13.0

<p>Under Ground Service Alert of Southern California Call: TOLL FREE 1-800-227-2600 TWO WORKING DAYS BEFORE YOU DIG</p>	<p>ENGINEER IN RESPONSIBLE CHARGE</p> <p>Farshid Mohammadi R.C.E. No. 51304 EXPIRES: 6-30-22 DATE: 7/21/20</p>		<p>CITY OF RIVERSIDE, CALIFORNIA DEPARTMENT OF PUBLIC WORKS</p>		<p>SIDEWALK IMPROVEMENTS</p>	<p>DESIGN WORK ORDER NO.: 1931286 CONSTR. WORK ORDER NO.: XXXXXX</p>
			<p>APPROVED BY: [Signature]</p> <p>ENGINEERING MANAGER: DC 7/28/20</p> <p>CONSTRUCTION ADMIN. MA 7-22-20</p> <p>TRAFFIC DIVISION: CS 7/22/20</p> <p>SURVEY: [Signature]</p> <p>STREETS: [Signature]</p>	<p>APPROVED BY: [Signature]</p> <p>CITY ENGINEER</p> <p>DATE: 7-28-2020</p>	<p>BONITA AVENUE SIDEWALK IMPROVEMENTS</p>	<p>R-4499</p>
			<p>TITLE SHEET</p>		<p>SHEET 1 OF 3</p>	<p>FILE NAME: R4499-01.DWG</p>
			<p>HORIZ. SCALE: 1"=20' VERT. SCALE: NA</p>			

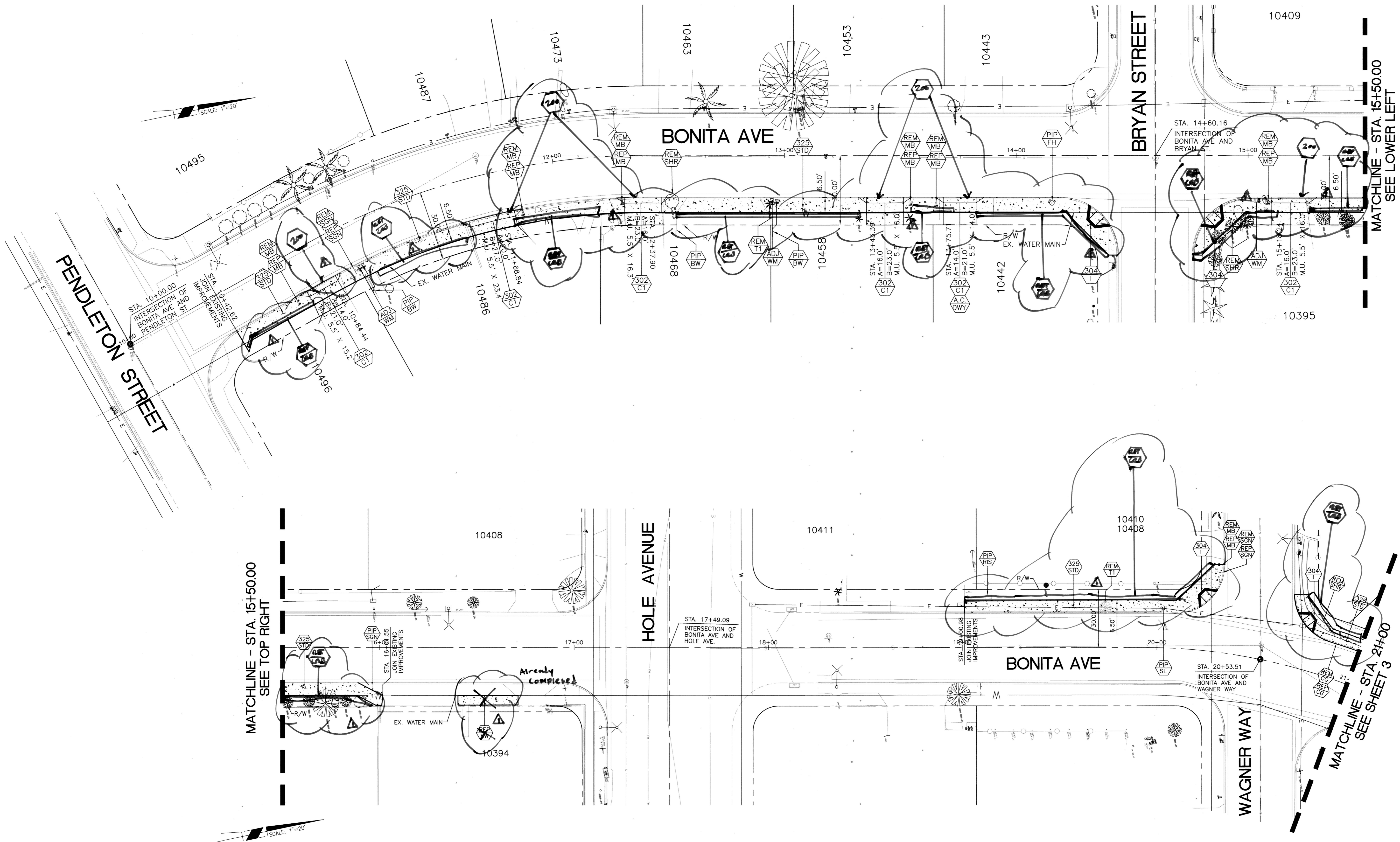

As Built 5/09/23 B.O

Under Ground Service Alert of Southern California
 Call: TOLL FREE 1-800-227-2600
 TWO WORKING DAYS BEFORE YOU DIG

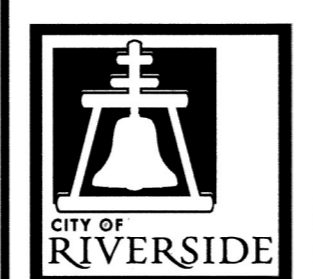

ENGINEER IN RESPONSIBLE CHARGE
 Farshid A. Mohammadi
 R.C.E. No. 51304 EXPIRES: 6-30-22
 DATE: 7/2/20

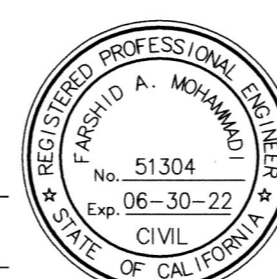

MARK	REVISIONS	APPR.	DATE
△	Concrete revision	CC	7/2/20

CITY OF RIVERSIDE, CALIFORNIA DEPARTMENT OF PUBLIC WORKS			
APPROVED BY	BY	DATE	APPROVED BY
ENGINEERING MANAGER	DC	7/2/20	CITY ENGINEER
CONSTRUCTION ADMIN.	NM	7-22-20	
TRAFFIC DIVISION	CS	7/22/20	
SURVEY			DATE: 7-28-2020
STREETS			

SIDEWALK IMPROVEMENTS
BONITA AVENUE
SIDEWALK IMPROVEMENTS
 STA. 10+00.00 TO 21+00.00
 HORIZ. SCALE: 1"=20' VERT. SCALE: NA

DESIGN WORK ORDER NO.: 1931286
 CONSTR. WORK ORDER NO.: XXXXXX
R-4499
 SHEET **2** OF **3**
 FILE NAME: R4499-02.DWG

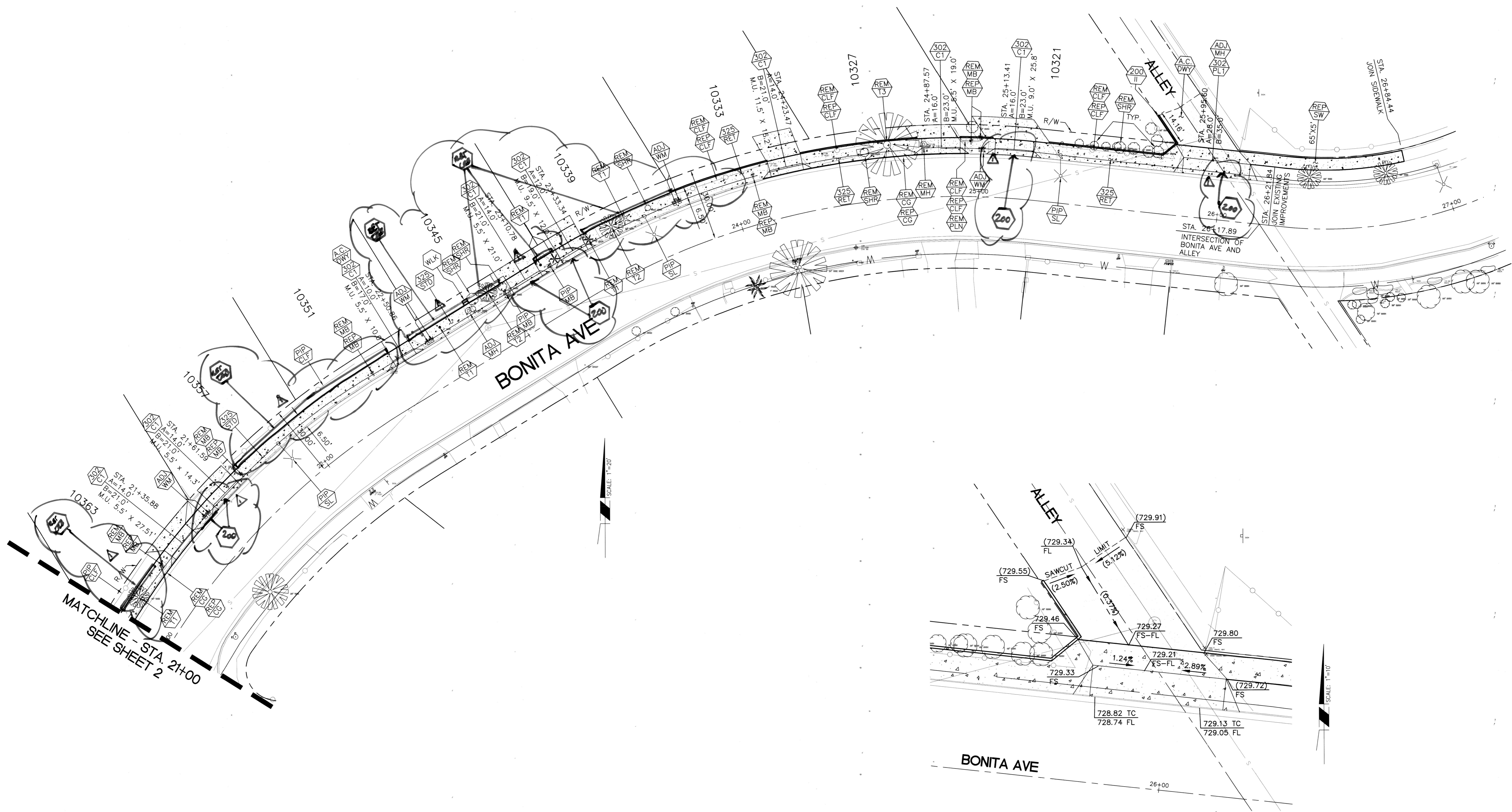

MATCHLINE - STA. 21+00
SEE SHEET 2

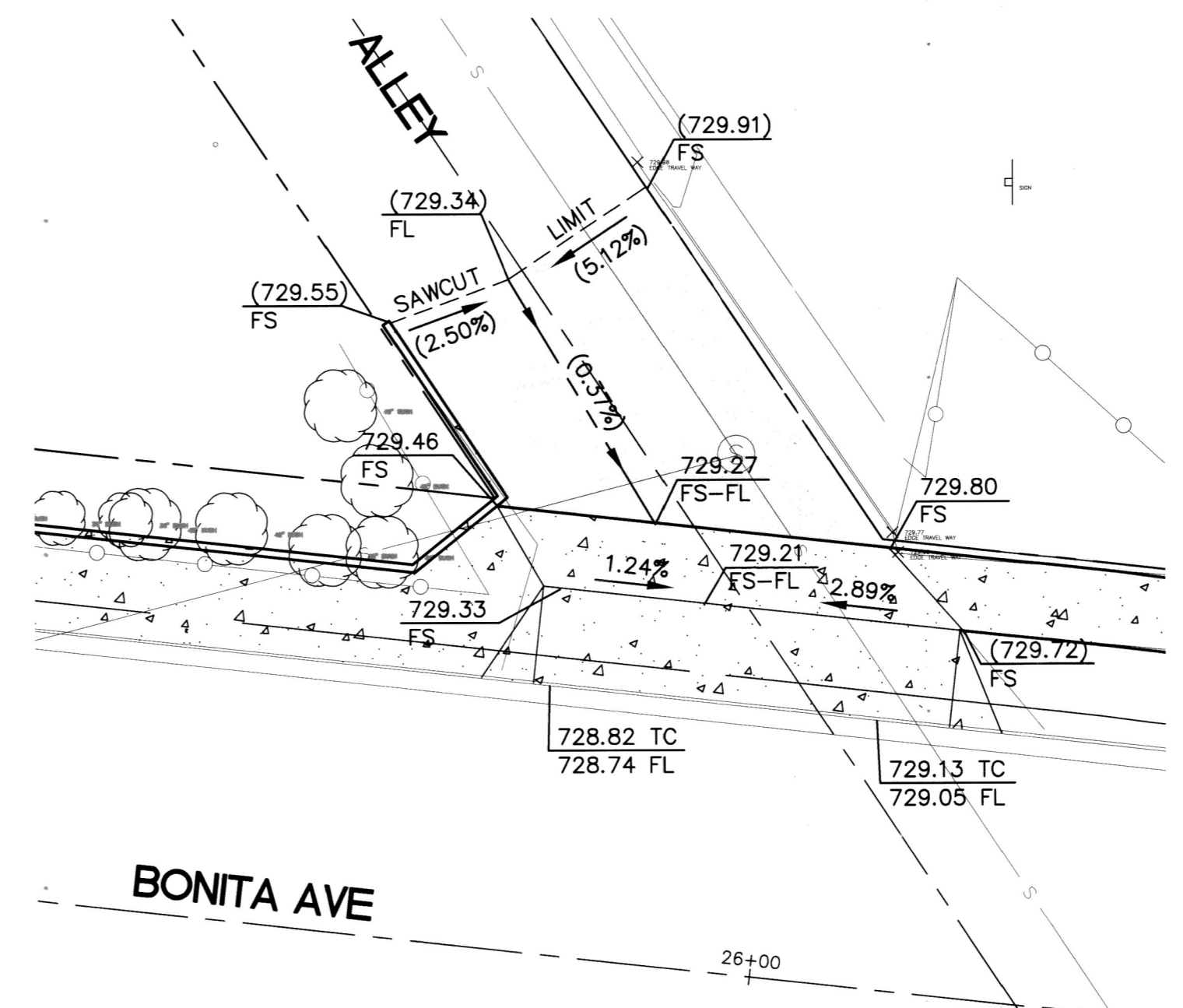

ALLEY DRIVEWAY DETAIL
SCALE: 1"=10'

As Built 5109/23 B.O

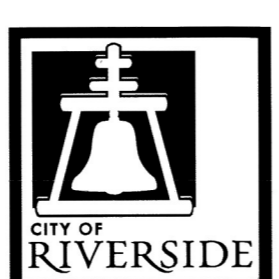

ENGINEER IN RESPONSIBLE CHARGE
Farshid A. Mohammadi
R.C.E. No. 51304 EXPIRES: 6-30-22
DATE: 7/24/20

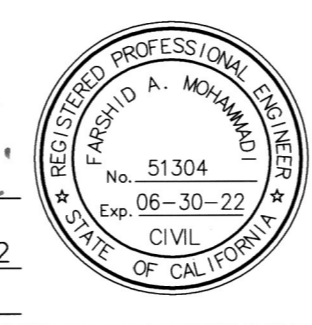

DESIGNED BY	CG	DRAWN BY	CG	CHECKED BY	FM
MARK	REVISIONS	APPR.	DATE		
	Concrete revisions	CG	6/16/20		

CITY OF RIVERSIDE, CALIFORNIA DEPARTMENT OF PUBLIC WORKS					
APPROVED BY	BY	DATE	APPROVED BY	BY	DATE
ENGINEERING MANAGER	DC	7/29/20	CITY ENGINEER	[Signature]	7-24-2020
CONSTRUCTION ADMIN.	NA	7-21-20			
TRAFFIC DIVISION	CS	7/22/20			
SURVEY					
STREETS					

SIDEWALK IMPROVEMENTS
BONITA AVENUE
SIDEWALK IMPROVEMENTS
STA. 21+00.00 TO 26+84.44
HORIZ. SCALE: 1"=20' VERT. SCALE: NA

DESIGN WORK ORDER NO.: 1931286
CONSTR. WORK ORDER NO.: XXXXXX
R-4499
SHEET **3** OF **3**
FILE NAME: R4499-03.DWG