

PROFILE
HORIZ. SCALE 1"=40'
VERT. SCALE 1"=4'

STREET NAME SIGN SCHEDULE

A	GREENFIELD AVE. 5900
	BURGUNDY DR. 4600
B	BURGUNDY DR. 4600
	NORMANDIE PL. 5900

PLAN
SCALE 1"=40'

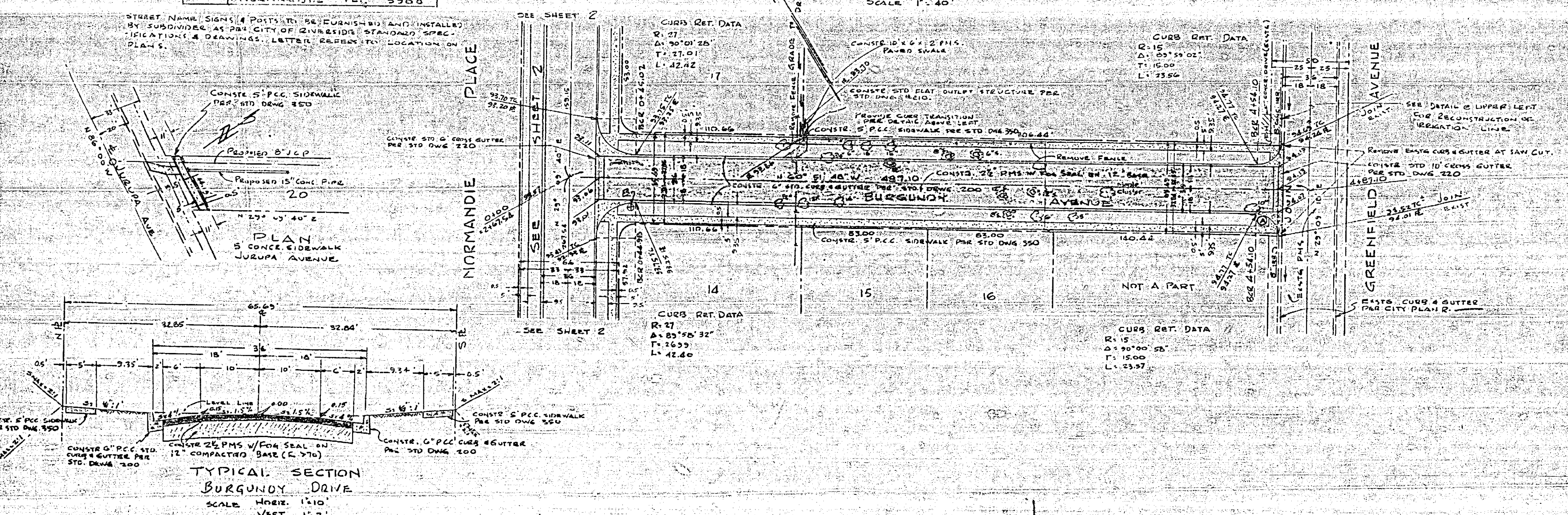

TYPICAL SECTION
BURGUNDY DRIVE
SCALE HORIZ. 1"=10'
VERT. 1"=3'

- GENERAL NOTES
1. ALL CONSTRUCTION IS TO BE DONE TO STANDARD D.W.G.S. AND SPECIFICATIONS OF THE CITY OF RIVERSIDE.
 2. IF THE SUBDIVIDER DESIRES TO REDUCE THE REQUIREMENTS ON IMPROVED BASE MATERIAL, ADDITIONAL SOIL TESTS MAY BE TAKEN AT SUBDIVIDER'S EXPENSE AFTER STREETS ARE PREPARED TO GRADE. SUBDIVIDER WILL CONTACT INSPECTION DIVISION, CITY OF RIVERSIDE, BEFORE TESTING. THE CITY WILL MAKE A TEST OF BASE MATERIAL IN PLACE BEFORE PAVING CAN BE INSTALLED. RESULT OF THIS TEST MUST INDICATE THAT THE BASE MATERIAL IS SATISFACTORY TO THE INSPECTION DIVISION.
 3. TRIM EDGES OF EXISTING PAVING TO CLEAN, STRAIGHT LINE. CONSTRUCT MATCH-UP PAVING AND OVERLAY EXISTING PAVING AS DIRECTED IN THE FIELD TO PRODUCE SMOOTH CROWN SECTION.
 4. ALL TREES AND STUMPS LOCATED WITHIN THE RIGHT OF WAY OF BURGUNDY DRIVE AND NORMANDIE PLACE SHALL BE REMOVED AND DISPOSED OF IN A MANNER SATISFACTORY TO THE CITY OF RIVERSIDE.
 5. A 5" P.C.C. CONCRETE SIDEWALK SHALL BE CONSTRUCTED ON THE N.W. SIDE OF JURUPA AVENUE ADJACENT TO LOT 20. AT A GRADE CONFORMING TO THE EXIST. CURB. THE FRONT OF WALK SHALL BE 0.75' FROM THE EXIST. CURB. THE REAR OF WALK SHALL BE 0.5' OF THE N.W. PROPERTY LINE. SEE PLAN AT LEFT HEREON.

DESIGNED BY: [Signature]
CHECKED BY: [Signature]
APPROVED BY: [Signature]
DATE: [Date]

REVISIONS

MARK	DATE	DESCRIPTION

CITY OF RIVERSIDE CALIFORNIA
DEPARTMENT OF PUBLIC WORKS

STREET PLAN & PROFILE
BURGUNDY AVENUE
TRACT NO. 2181

SCALE: 1"=40' HORIZ. 1"=4' VERT.

R-456
SHEET 1 OF 2