

BM ELEV 865.88 - S&L IN W CURB OF MARY ST NEAR CB NW CORNER OF INTER WITH INDIANA AVE.  
 FB 612/33-37 U/38-45  
 SCALE: HOR 1"=50'  
 VERT 1"=5'

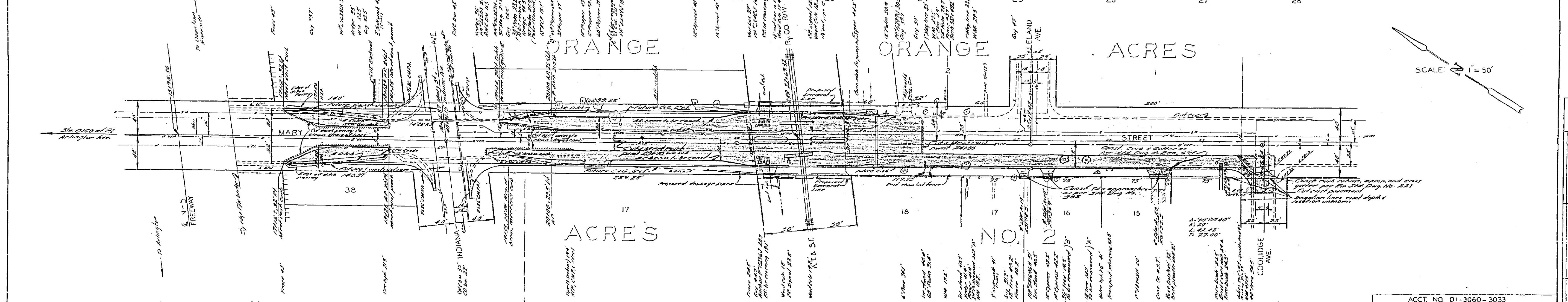

Estimated Qty Quantities

For Removal	35' R.C.P.	160 LF
(A) 6" 18" Diameter	15" R.C.P.	30 LF
(B) 18" 36" Diameter	18" W.C.M.P.	30 LF
(C) Over 36" Diameter	Remove & Relay Culvert	16 LF
Rebar, Poly Bars	Coll. Basin w/ Straining	1 LF
Rebar, Expansion	Shim Drain Openout	1 LF
Impacted Earth	Adjust Man. to Grade	1 LF
Aggregate Base Material	Flexible Drainage pipe	1 LF
Asphalt Concrete	Markers	5 LF
A.C. Base		
Curb & Gutter 6" OC		
8-1 Curb		
Cross Slope & Apron		
Drainage Approaches		
Subgrade		
Finished Hauling		

SEE SHEET 2 FOR DETAILS  
 IN THIS SECTION

APPROVED: *Edith S. Hendley*  
 CIVIL ENGR.  
 11-9-62

REVISIONS		
MARK	DATE	DESCRIPTION
2		Added notes regarding existing conditions and proposed changes to the plan view.

ACCT. NO. 01-3060-3033  
 CITY OF RIVERSIDE CALIFORNIA  
 DEPARTMENT OF PUBLIC WORKS  
 MARY ST. WIDENING  
 FREEWAY TO COOLIDGE AVE.  
 A.T.&S.F. CROSSING NO. 2B-13.0

DESIGNED BY: [Signature]  
 DRAWN BY: [Signature]  
 CHECKED BY: [Signature]  
 RECOMMENDED BY: [Signature]  
 APPROVED BY: [Signature]  
 DIRECTOR OF PUBLIC WORKS  
 DATE: 11/1/62  
 SHEET 1 OF 3

PROFILE

DATE	
BY	
CHECKED	
APPROVED	

PLAN

DATE	
BY	
CHECKED	
APPROVED	

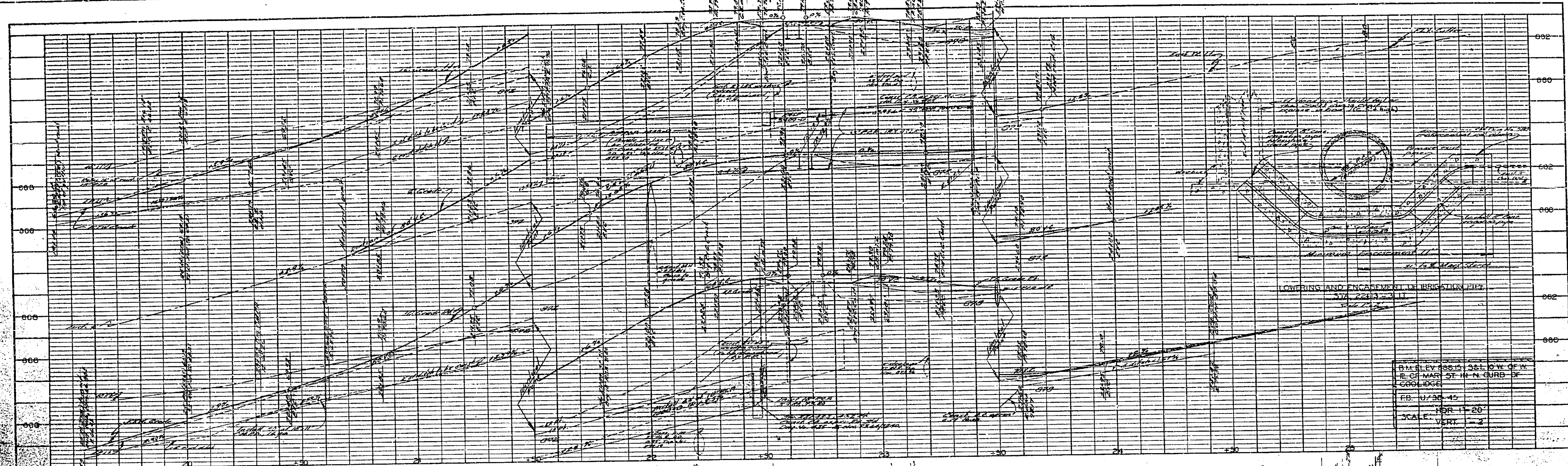
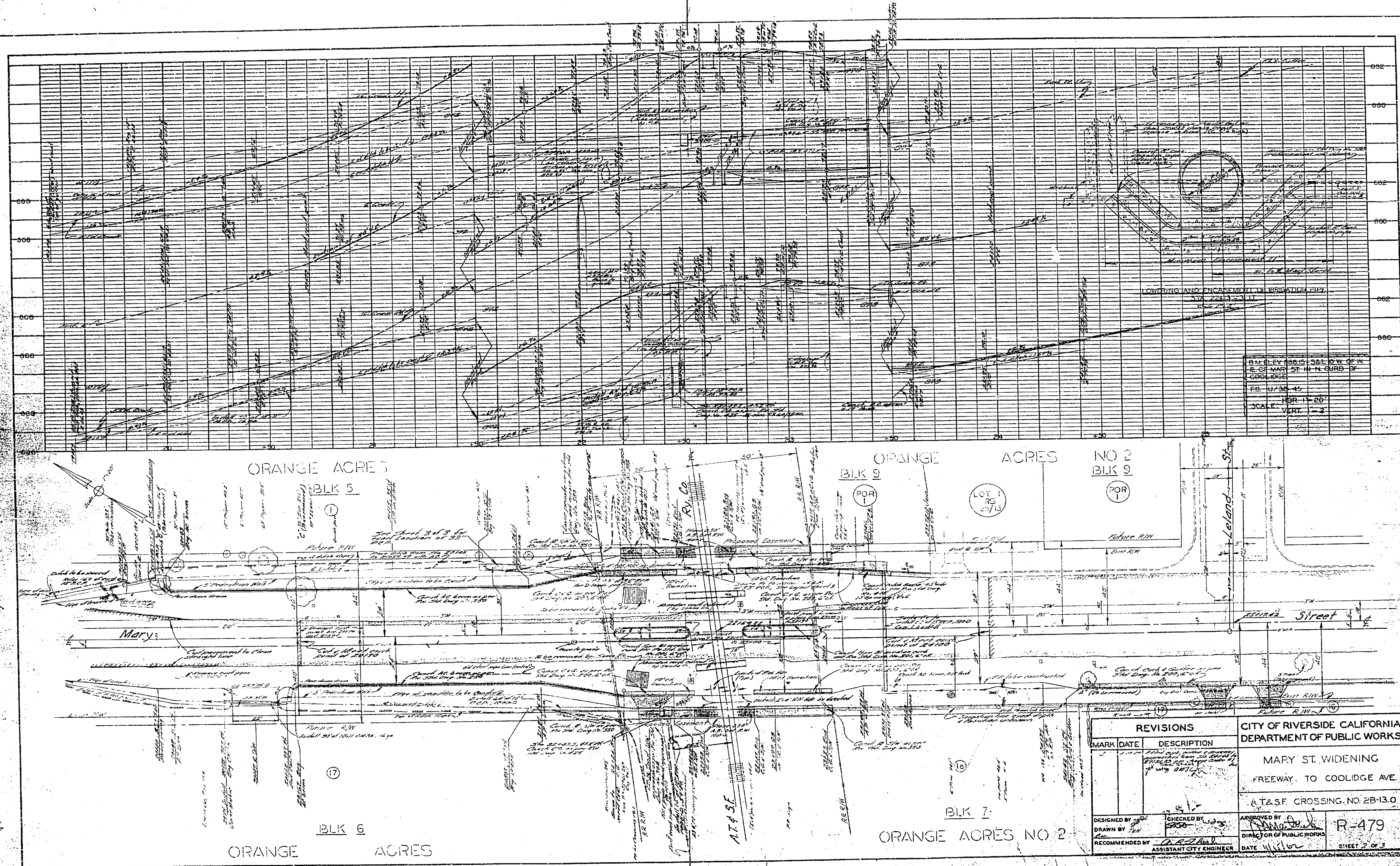

PROFILE	SHEETED	DATE
NOTE BOOK	CHECKED	
NO.		
DATE		

R.M. & E.V. 188-13-3 SEE CIV. OF M.  
 R. OF MAR. ST. IN N. CURB OF  
 COOLIDGE  
 FB. 11/30-45  
 HOR. 11-20  
 SCALE VERT. 1"=4'

<b>REVISIONS</b> MARK   DATE   DESCRIPTION		CITY OF RIVERSIDE CALIFORNIA DEPARTMENT OF PUBLIC WORKS	
		MARY ST. WIDENING FREEWAY TO COOLIDGE AVE. A.T. & S.F. CROSSING, NO. 2B-13.0	
DESIGNED BY DRAWN BY RECOMMENDED BY	CHECKED BY DATE	APPROVED BY DIRECTOR OF PUBLIC WORKS	R-479 SHEET 2 OF 3

PLAN	SHEETED	DATE
NOTE BOOK	CHECKED	
NO.		
DATE		

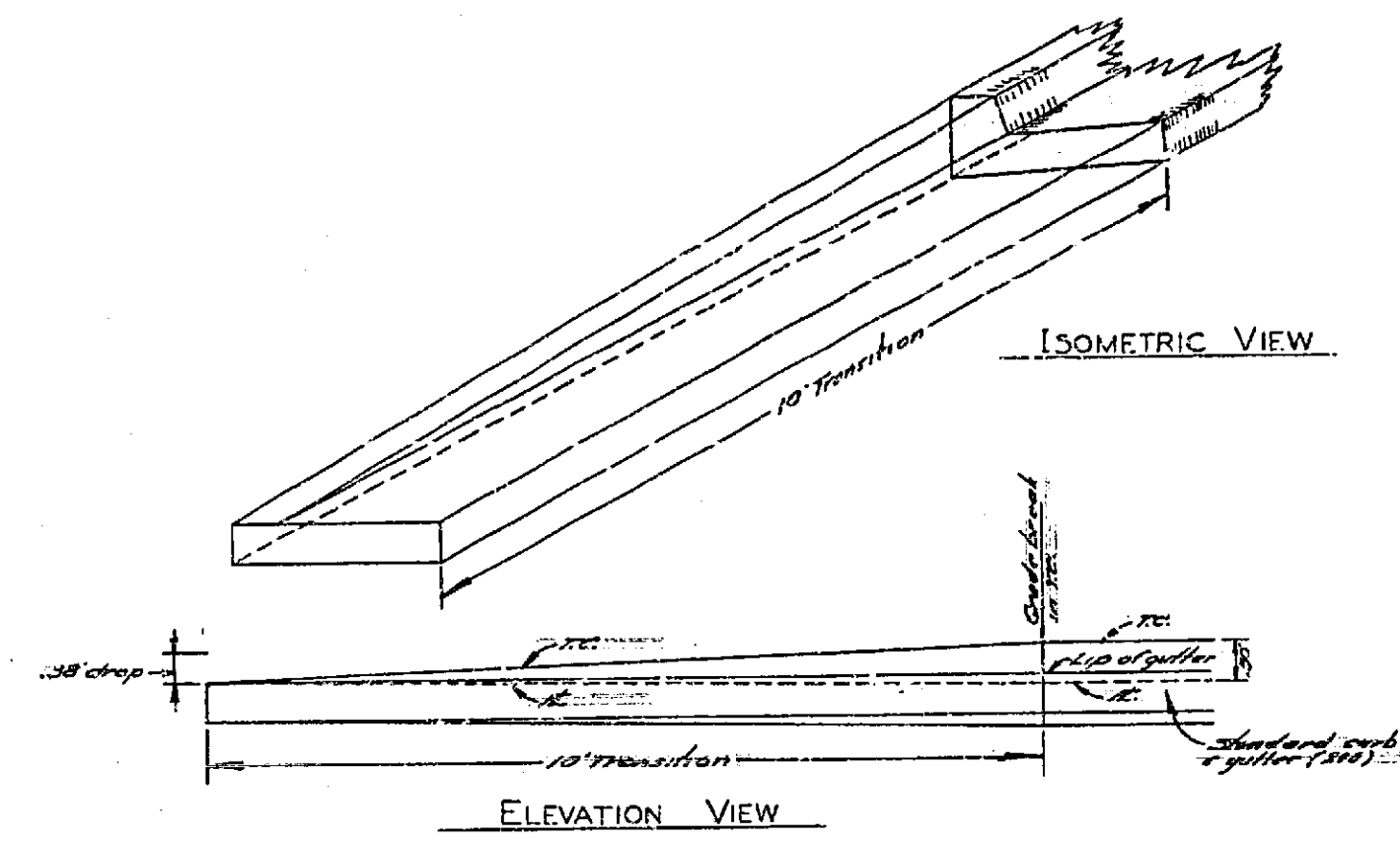

TYPICAL TRANSITION OF STD. CURB & GUTTER  
FROM 6" TO 0" CURB FACE  
Scale 1"=2'

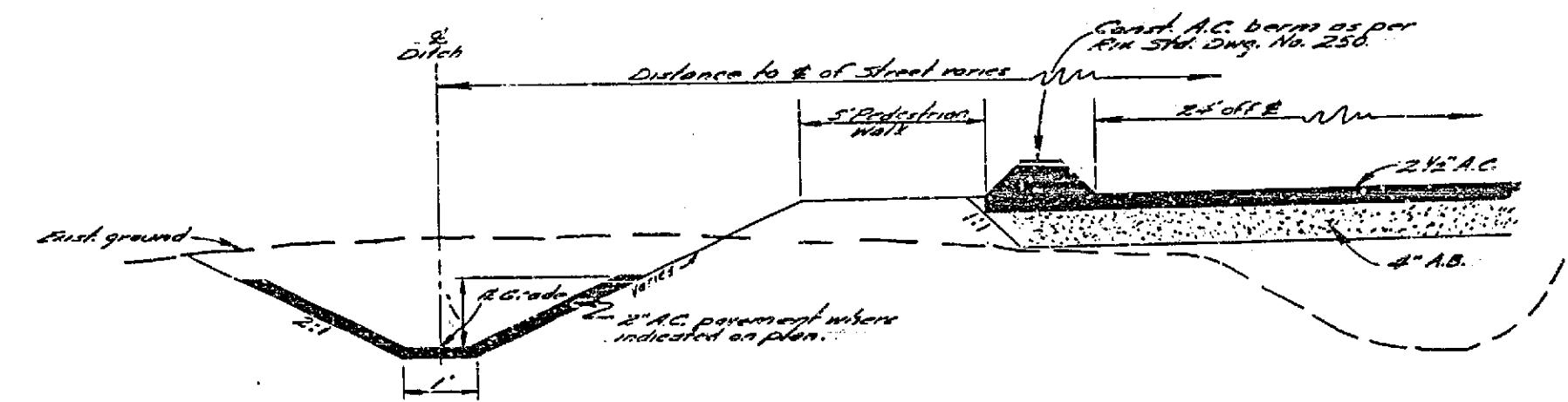
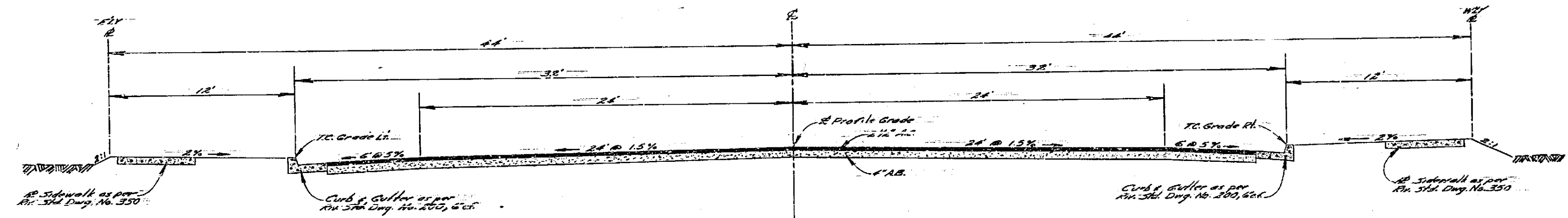
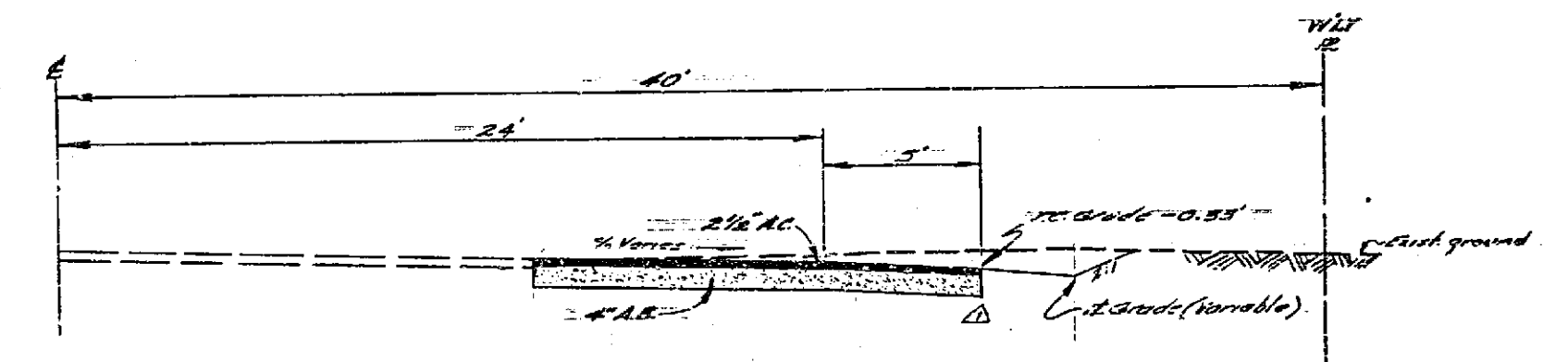
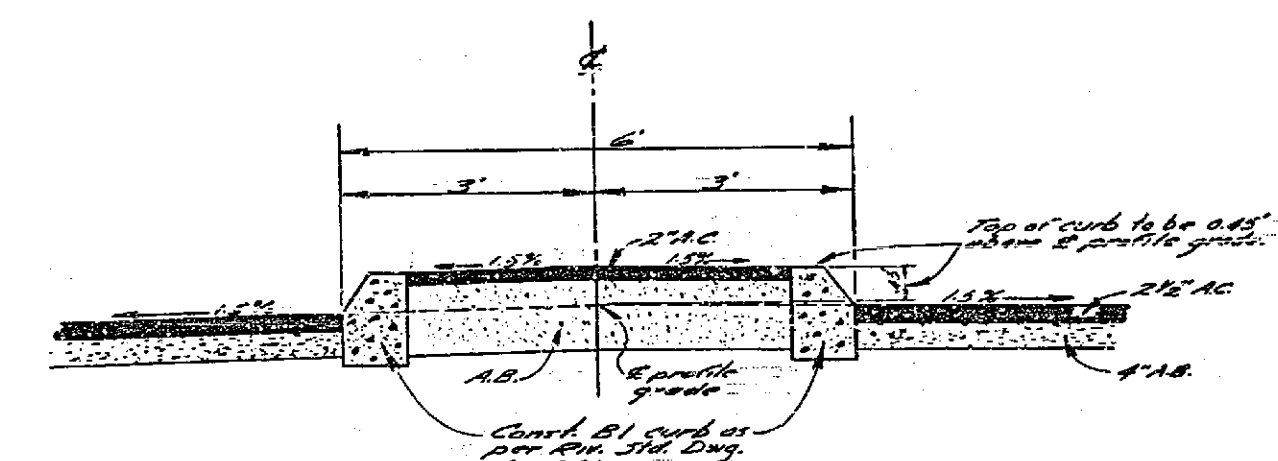
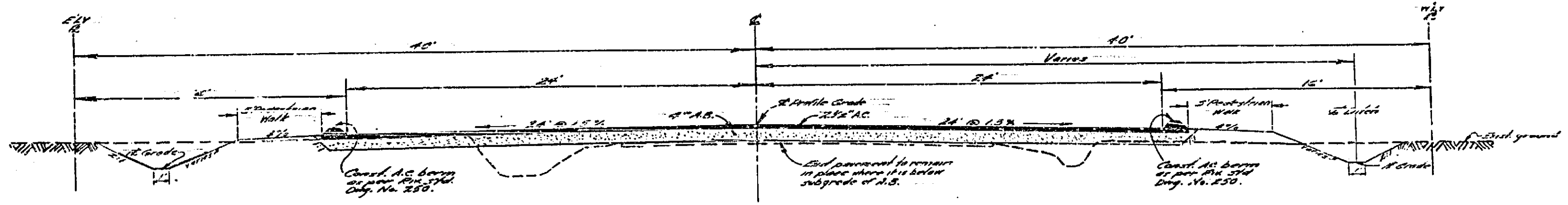
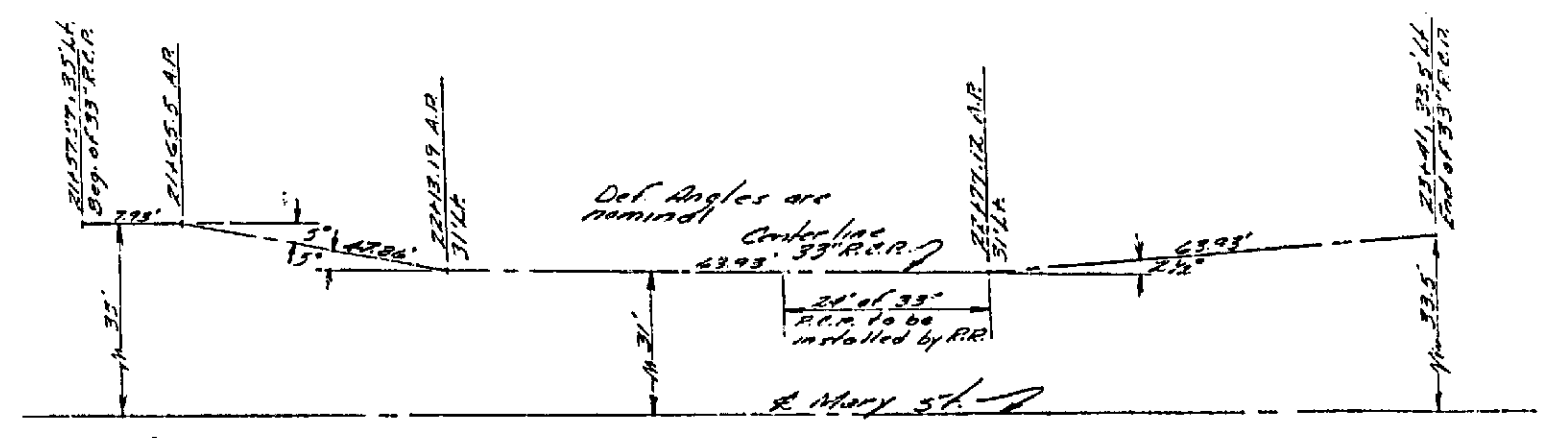
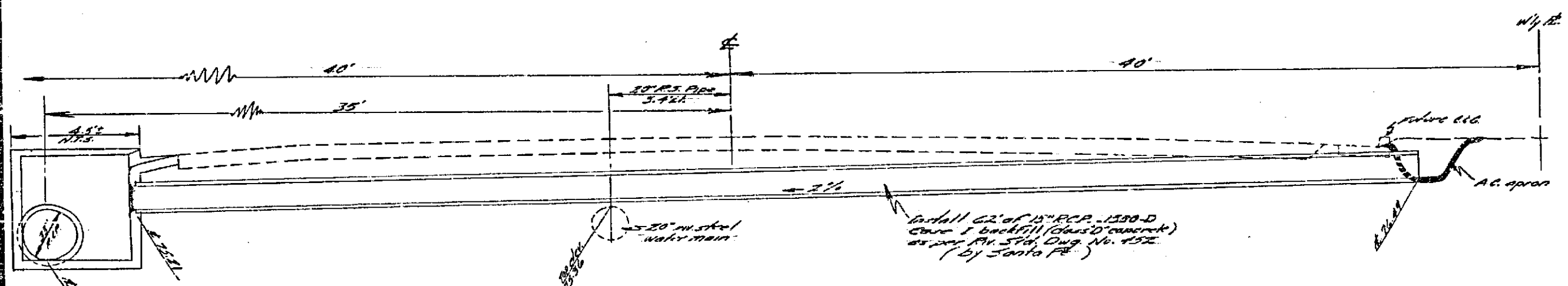
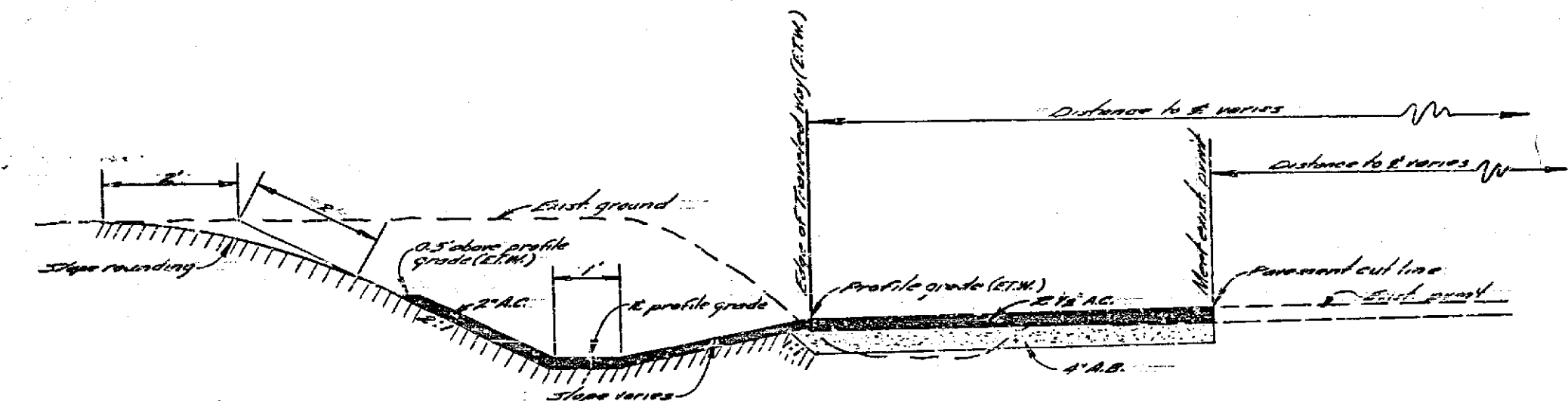

ACCT NO. 01-3060-3033		
CITY OF RIVERSIDE CALIFORNIA DEPARTMENT OF PUBLIC WORKS		
MARY ST WIDENING FREEWAY TO COOLIDGE AVE.		
A.T. & S.F. CROSSING NO. 218-130		
DESIGNED BY	CHECKED BY	APPROVED BY
DRAWN BY	ASSISTANT CITY ENGINEER	DIRECTOR OF PUBLIC WORKS
RECOMMENDED BY	DATE	R-479
		SHEET 3 OF 3