

B.M. 511. in M.M. Ch. Est. at
 Peters & Madison Elev. 869.56
 F.B. 2/13-46 519/56
 Scale: 1" = 50' Hor.
 1" = 5' Vert.

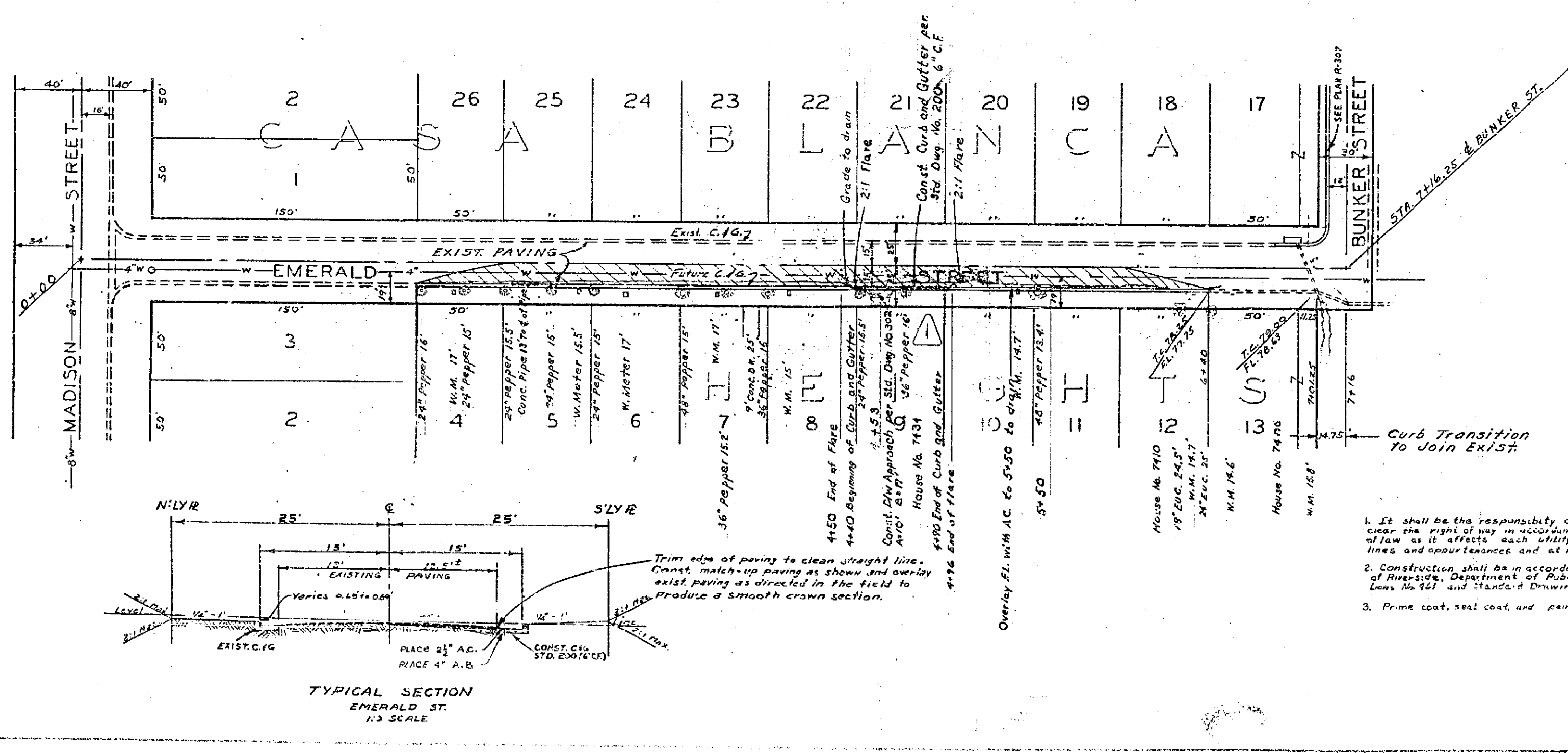

Shading Legend

- Concrete Construction
- Place 2 1/2" A.C. over 4" A.B. From 4+40 to 4+50
- Overlay Exist. Pavement with A.C.

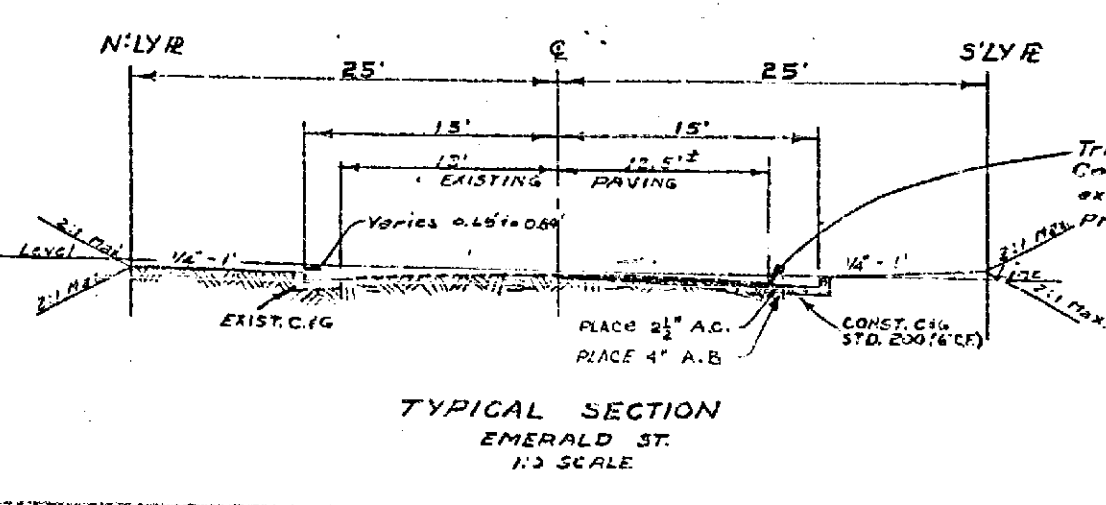
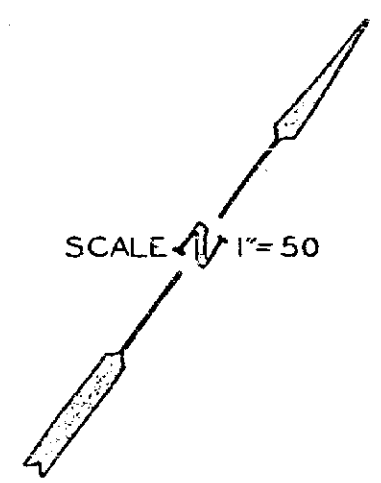

- It shall be the responsibility of the contractor to clear the right of way in accordance with the provisions of law as it affects each utility including irrigation lines and appearance and set as cost to the City.
- Construction shall be in accordance with the City of Riverside, Department of Public Works, Specifications for 1st and 2nd Class Contractors.
- Prime coat, seal coat, and prime binder are required.

REVISIONS		CITY OF RIVERSIDE CALIFORNIA DEPARTMENT OF PUBLIC WORKS	
MARK	DATE	DESCRIPTION	
△	11-30-41	Shown improvements for House No. 7424	
		EMERALD STREET MADISON ST. TO BUNKER ST.	
DESIGNED BY	CHECKED BY	APPROVED BY	R-482A SHEET 1 OF 1
DRAWN BY		DIRECTOR OF PUBLIC WORKS	
RECOMMENDED BY	ASSISTANT CITY ENGINEER	DATE	