

PROFILE	DATE
NO. 1	
NO. 2	
NO. 3	
NO. 4	
NO. 5	
NO. 6	
NO. 7	
NO. 8	
NO. 9	
NO. 10	
NO. 11	
NO. 12	
NO. 13	
NO. 14	
NO. 15	
NO. 16	
NO. 17	
NO. 18	
NO. 19	
NO. 20	
NO. 21	
NO. 22	
NO. 23	
NO. 24	
NO. 25	
NO. 26	
NO. 27	
NO. 28	
NO. 29	
NO. 30	
NO. 31	
NO. 32	
NO. 33	
NO. 34	
NO. 35	
NO. 36	
NO. 37	
NO. 38	
NO. 39	
NO. 40	
NO. 41	
NO. 42	
NO. 43	
NO. 44	
NO. 45	
NO. 46	
NO. 47	
NO. 48	
NO. 49	
NO. 50	

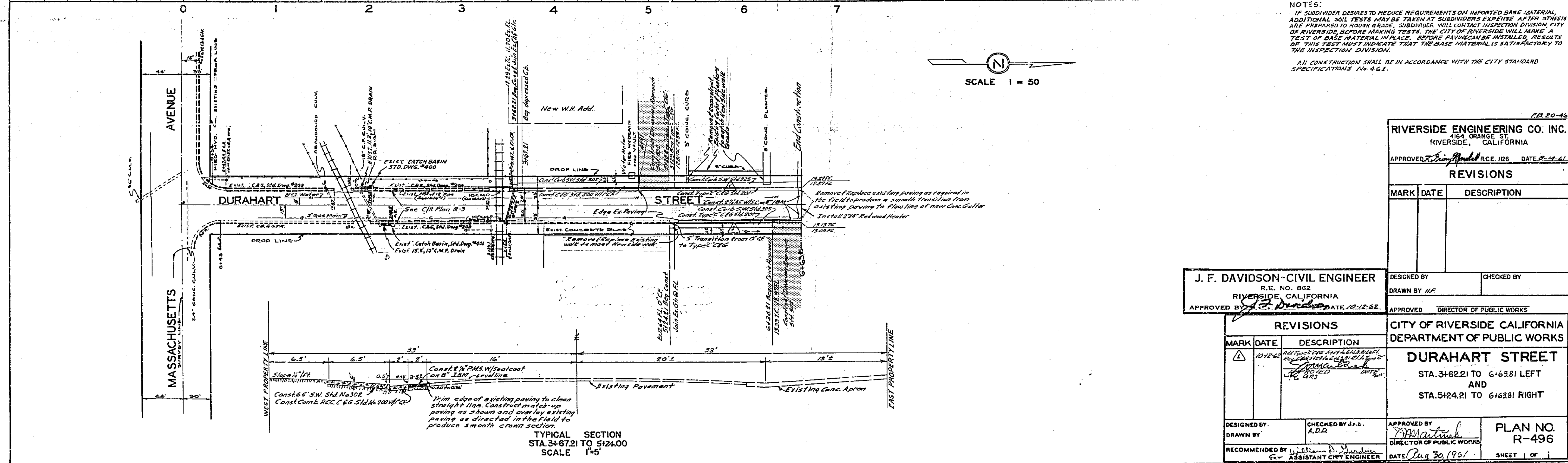
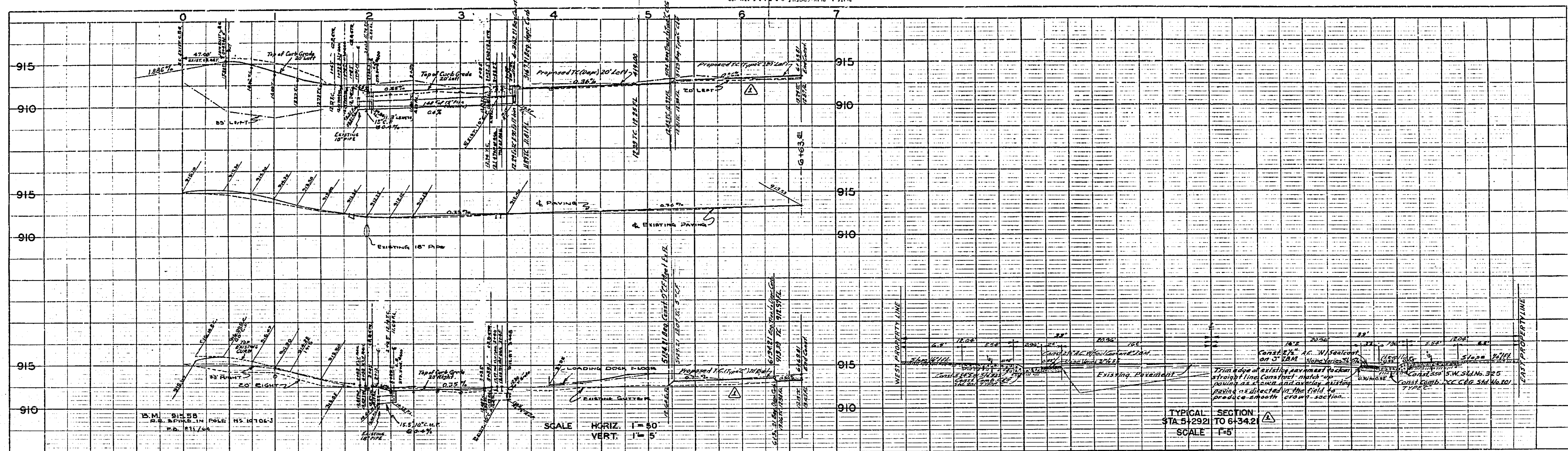

NOTES:  
 IF SUBDIVIDER DESIRES TO REDUCE REQUIREMENTS ON IMPORTED BASE MATERIAL, ADDITIONAL SOIL TESTS MAY BE TAKEN AT SUBDIVIDERS EXPENSE AFTER STREETS ARE PREPARED TO ROAD GRADE. SUBDIVIDER WILL CONTACT INSPECTION DIVISION, CITY OF RIVERSIDE, BEFORE MAKING TESTS. THE CITY OF RIVERSIDE WILL MAKE A TEST OF BASE MATERIAL IN PLACE. BEFORE PAVING CAN BE INSTALLED, RESULTS OF THIS TEST MUST INDICATE THAT THE BASE MATERIAL IS SATISFACTORY TO THE INSPECTION DIVISION.  
 ALL CONSTRUCTION SHALL BE IN ACCORDANCE WITH THE CITY STANDARD SPECIFICATIONS No. 461.

SCALE 1" = 50'

RIVERSIDE ENGINEERING CO. INC.  
 4184 ORANGE ST.  
 RIVERSIDE, CALIFORNIA

APPROVED: *[Signature]* R.C.E. 1126 DATE 8-14-61

REVISIONS		
MARK	DATE	DESCRIPTION

J. F. DAVIDSON-CIVIL ENGINEER  
 R.E. NO. 882  
 RIVERSIDE, CALIFORNIA  
 APPROVED BY: *[Signature]* DATE 12-12-62

DESIGNED BY: \_\_\_\_\_ CHECKED BY: \_\_\_\_\_  
 DRAWN BY: *MF*  
 APPROVED: \_\_\_\_\_ DIRECTOR OF PUBLIC WORKS

REVISIONS		
MARK	DATE	DESCRIPTION
△	10-12-62	ALL TYPING AND DIMENSIONS REVISOR'S CORRECTIONS TO BE MADE BY DATE 10-12-62

CITY OF RIVERSIDE, CALIFORNIA  
 DEPARTMENT OF PUBLIC WORKS  
**DURAHART STREET**  
 STA. 3+622.21 TO 6+638.81 LEFT  
 AND  
 STA. 5+24.21 TO 6+638.1 RIGHT

DESIGNED BY: \_\_\_\_\_ CHECKED BY: *d.s.b. A.D.R.*  
 DRAWN BY: *MF*  
 RECOMMENDED BY: *William D. Davidson* DATE *Aug 30, 1961*  
 ASSISTANT CIVIL ENGINEER  
 PLAN NO. R-496  
 SHEET 1 OF 1

