

PALMER AVA  
1027.45  
1021.45  
1021.45

1027.45  
1021.45  
1021.45

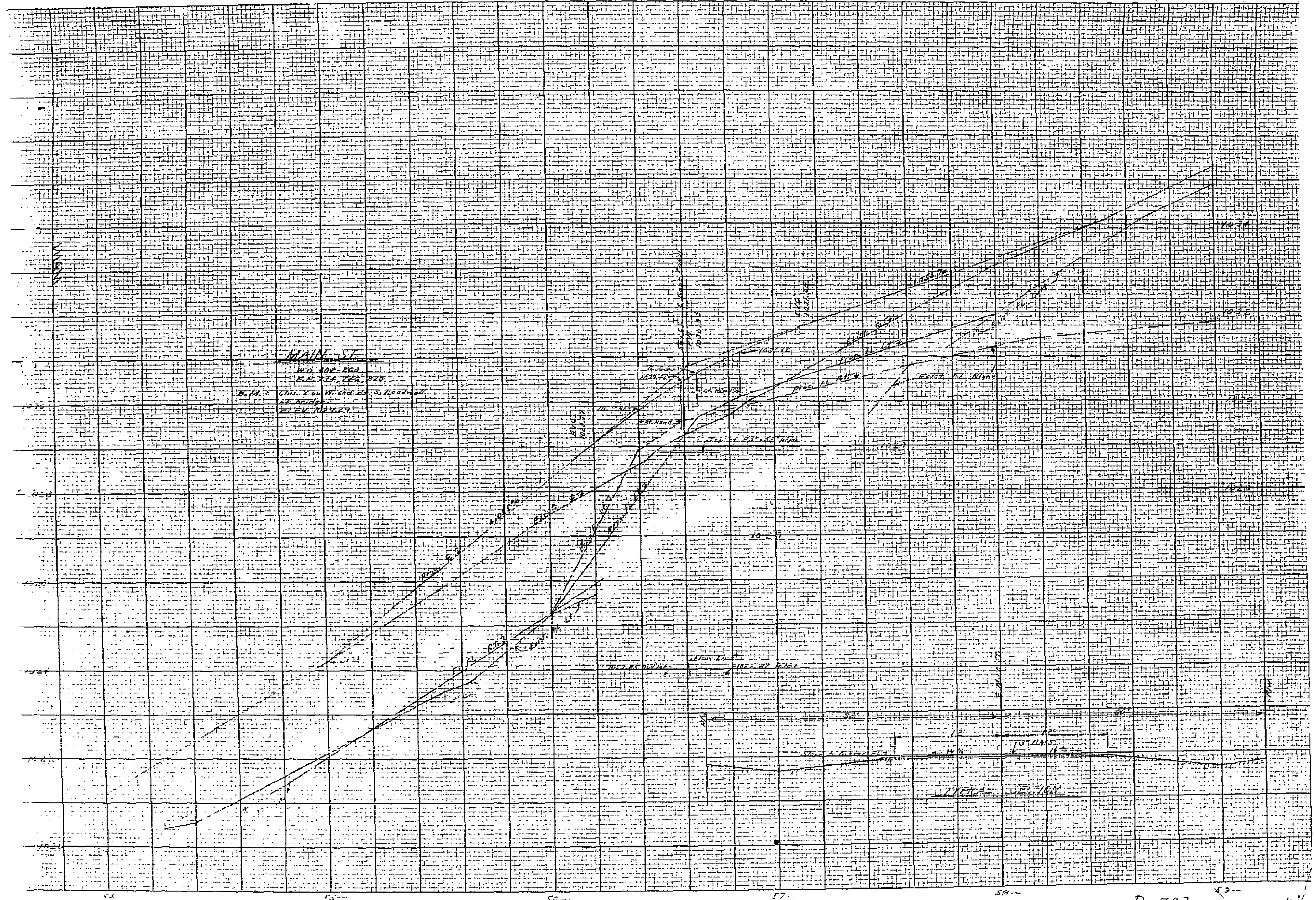

MAIN ST

W.D. 100-100

E.L. 102.29, 102.29

ELEV. 102.29

THIS IS ON W. END OF OLD HEADWALL

ELEV. 102.29

ELEV. 102.29

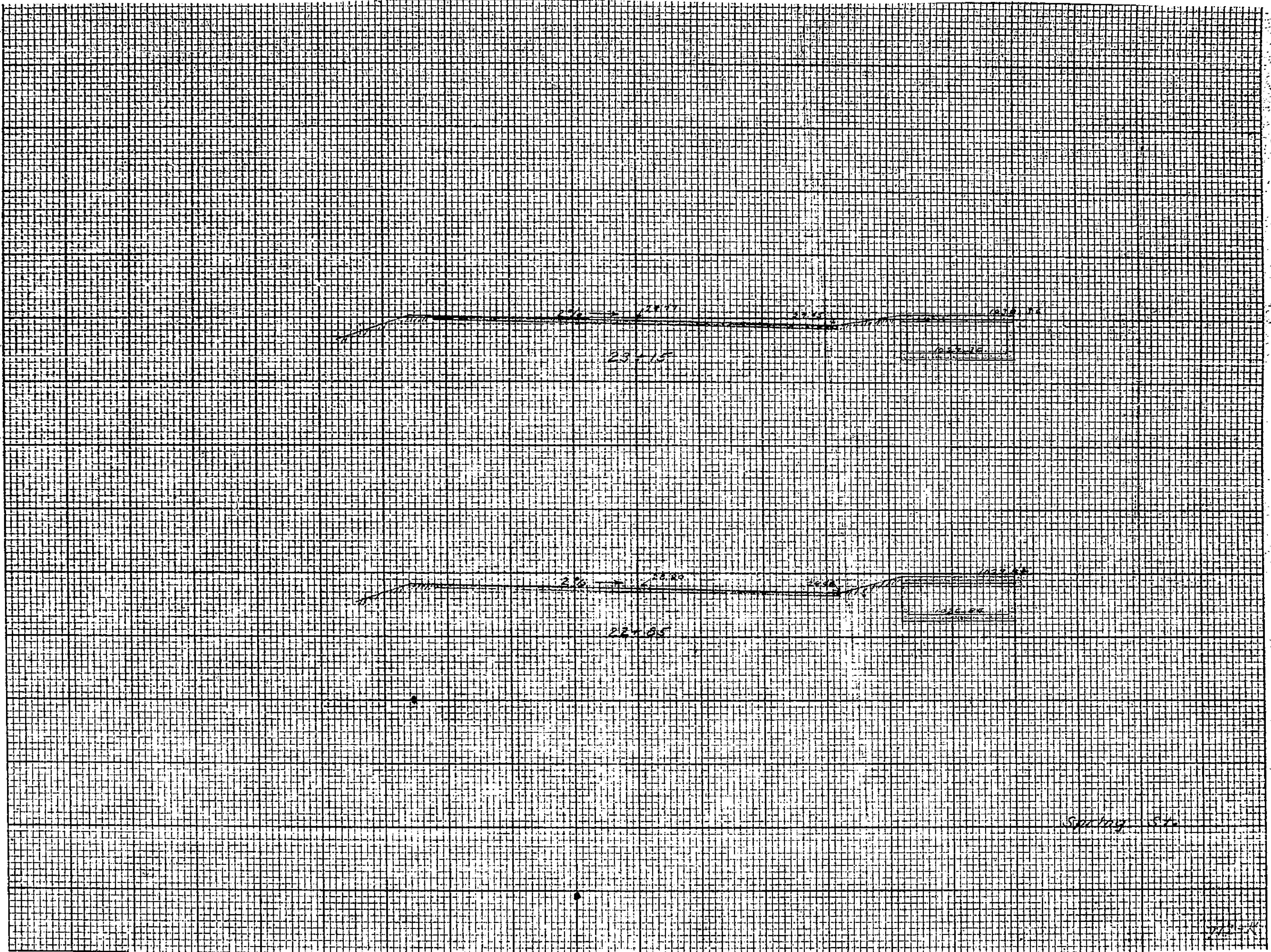

BEE 10x0

16

R. 507

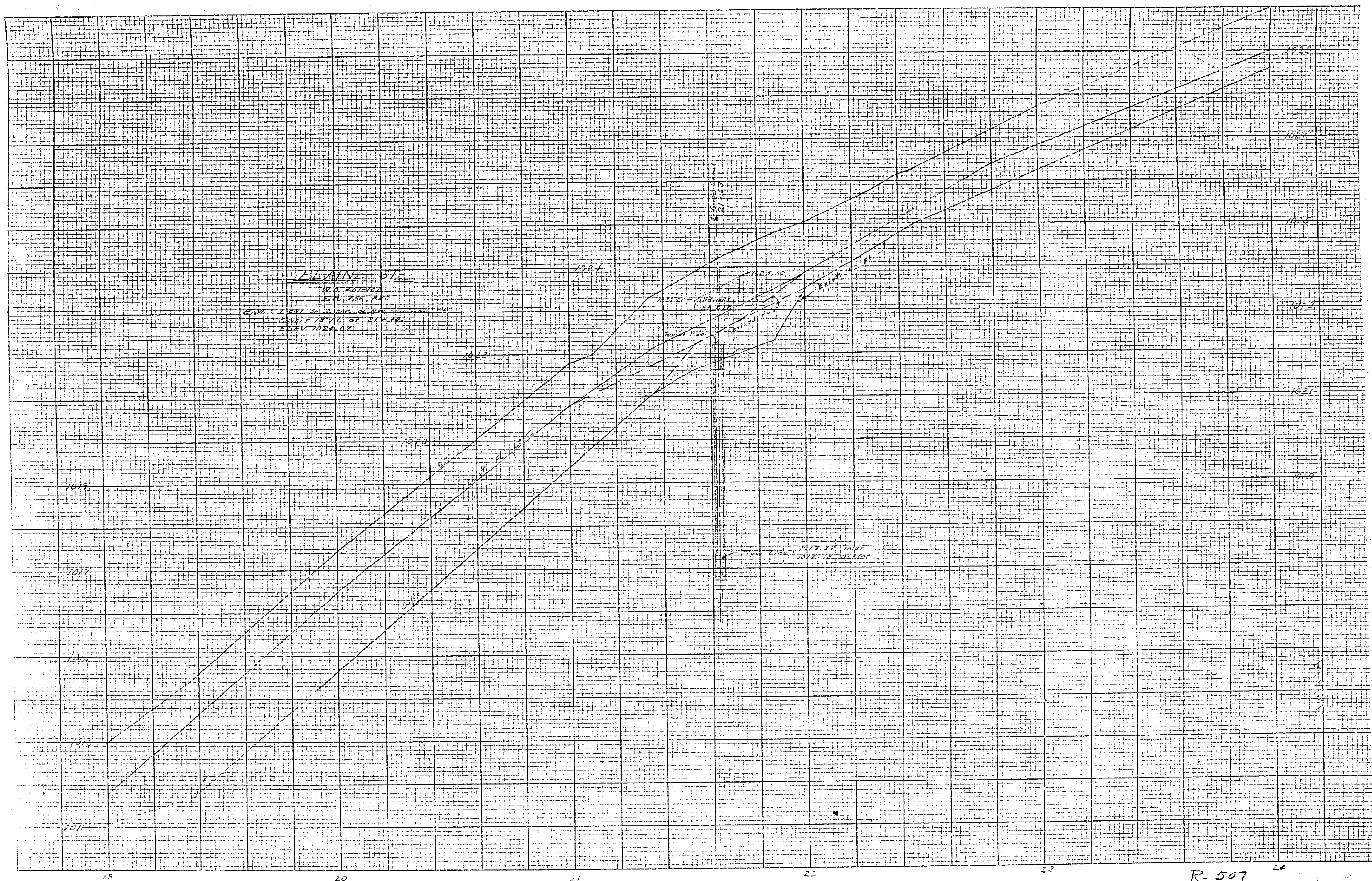

APPROVED 1959  
GAGE CANAL CO.

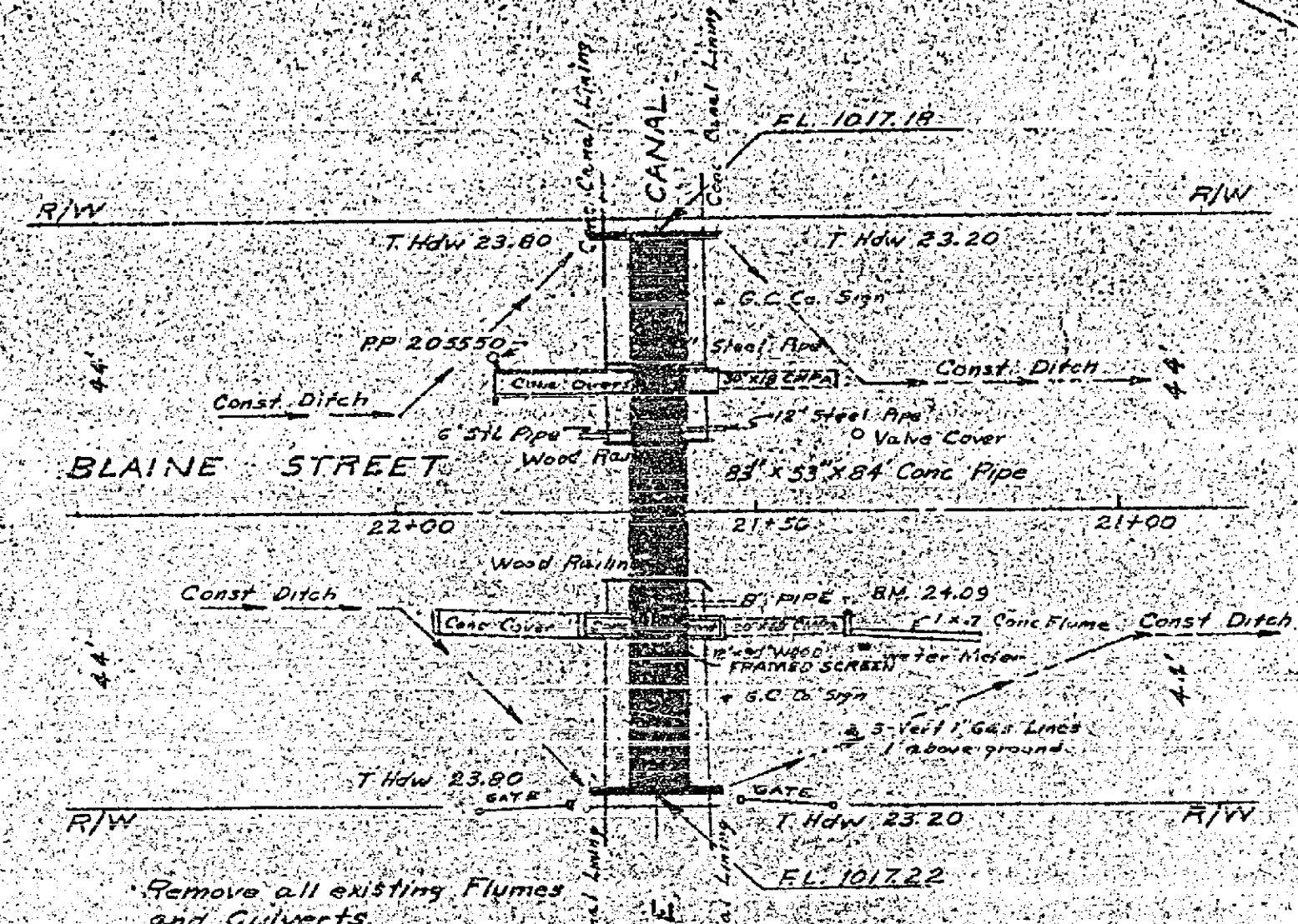

Remove all existing Flumes and Culverts.

BLAINE STREET  
CROSSING OF GAGE CANAL  
STATION 21+53

IN CITY

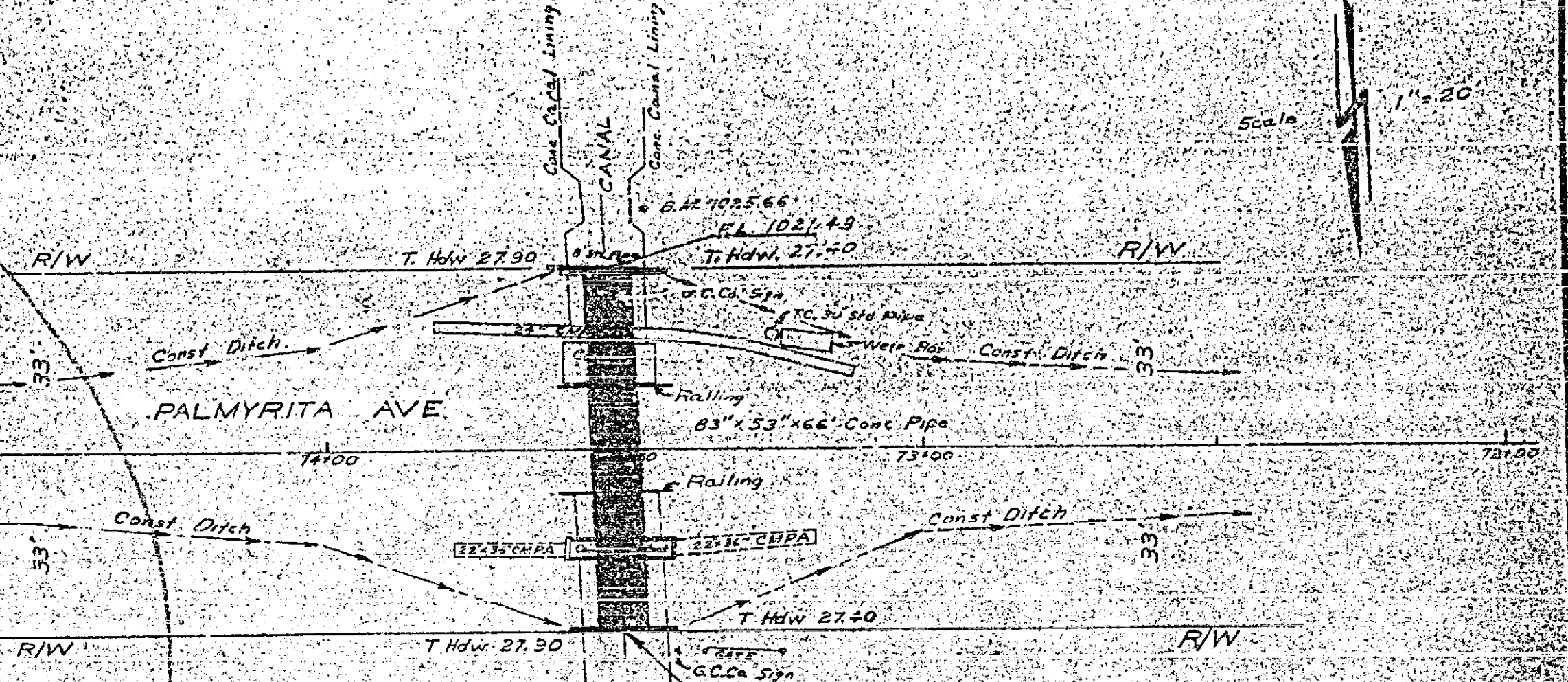

Remove all existing Flumes and Culverts.

PALMYRITA AVE  
CROSSING OF GAGE CANAL  
STATION 73+52

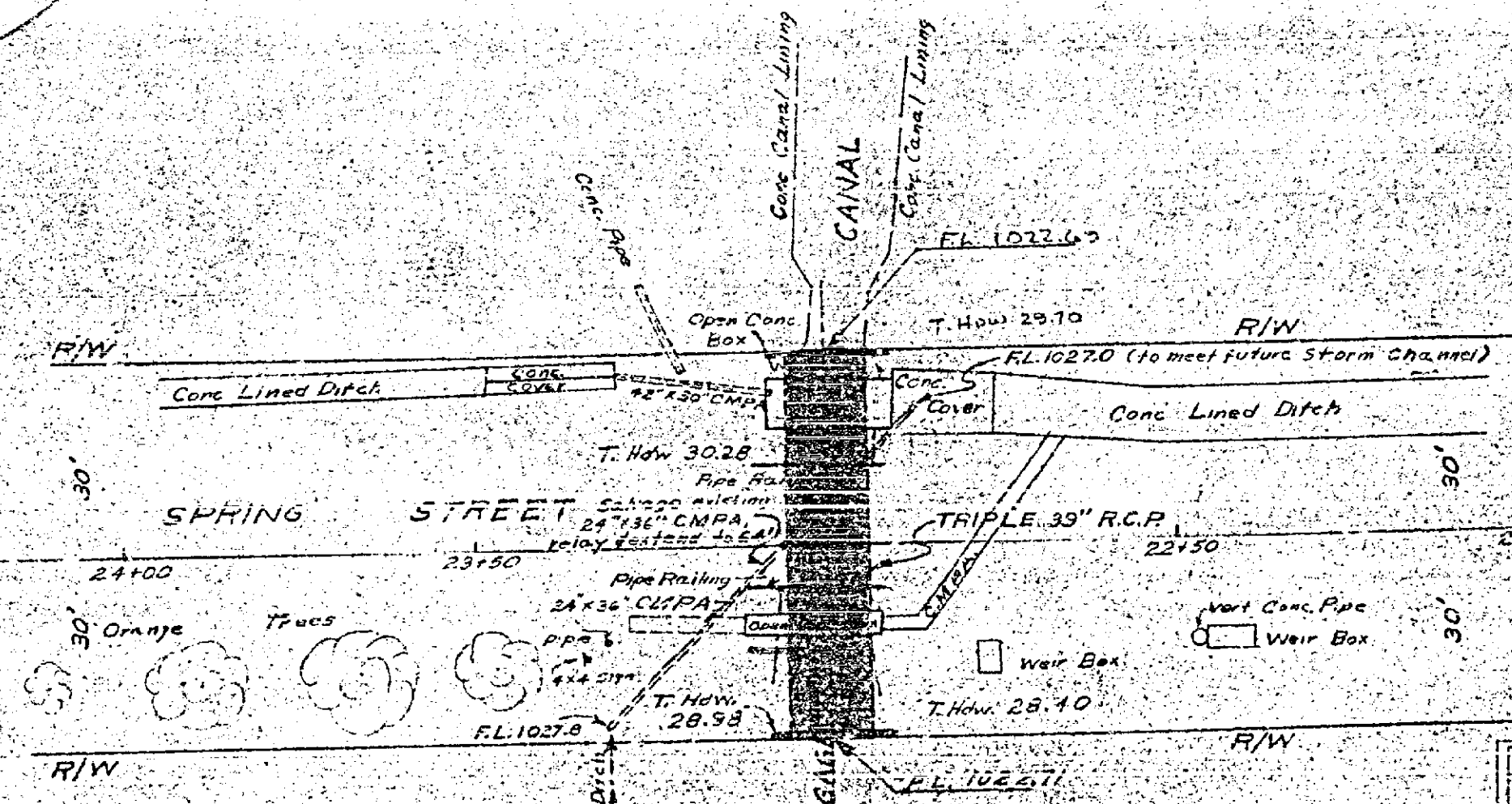

Remove all existing Flumes and Culverts.

SPRING STREET  
CROSSING OF GAGE CANAL  
STATION 23+00

RECEIVED  
AUG 25 1961  
DEPT. OF PUBLIC WORKS

LQ-HED PIPE CROSSINGS  
GAGE CANAL  
A.C. Keith, County Surveyor & Road Comm.  
Riverside County  
October 1959

R-507

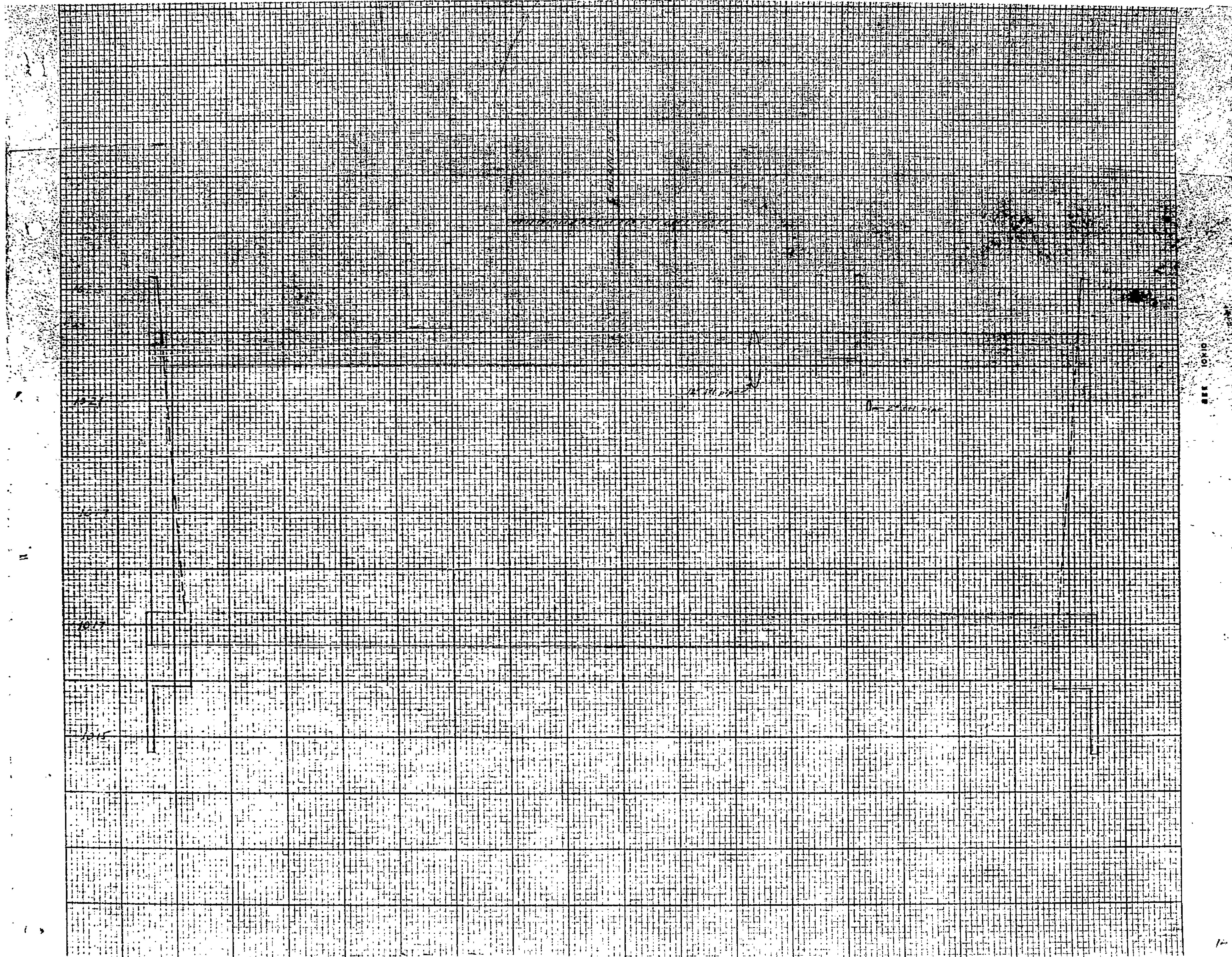

SEE TOP



APPROVED 1959  
GAGE CANAL CO.

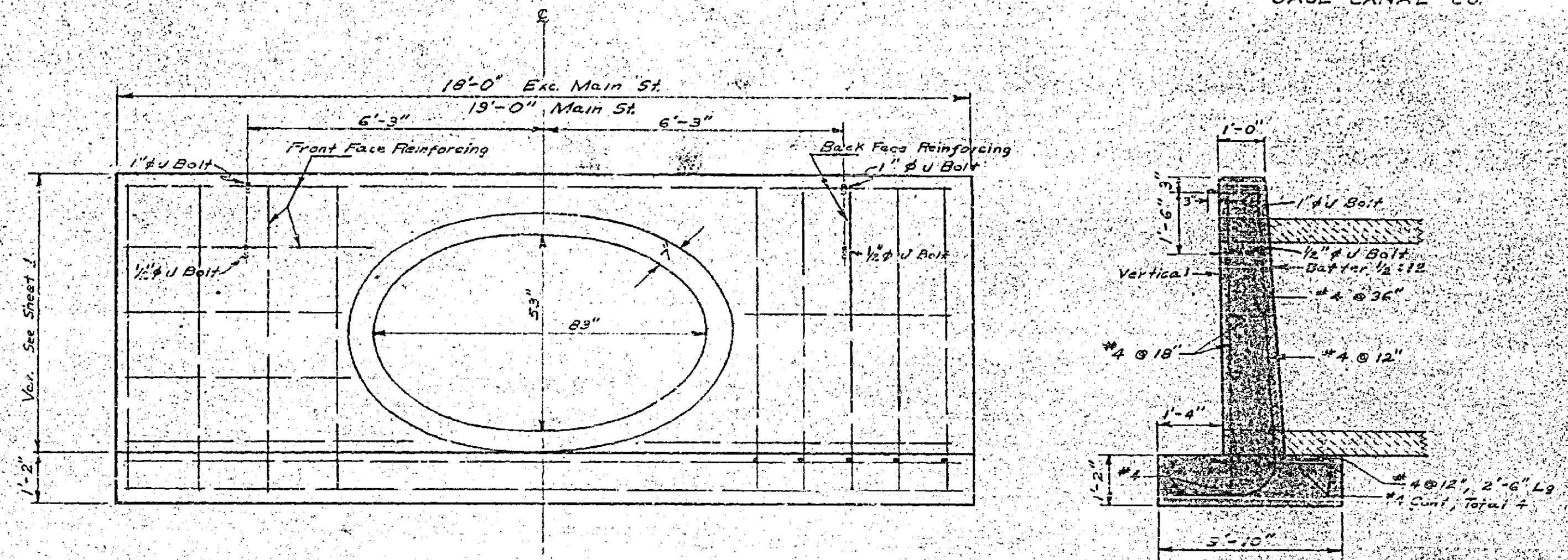

TYPICAL HEADWALL DETAIL  
SCALE 1/2" = 1'-0"

R-50.74-1