

NO.	DATE	DESCRIPTION
1		AS SHOWN
2		AS SHOWN
3		AS SHOWN
4		AS SHOWN
5		AS SHOWN
6		AS SHOWN
7		AS SHOWN
8		AS SHOWN
9		AS SHOWN
10		AS SHOWN

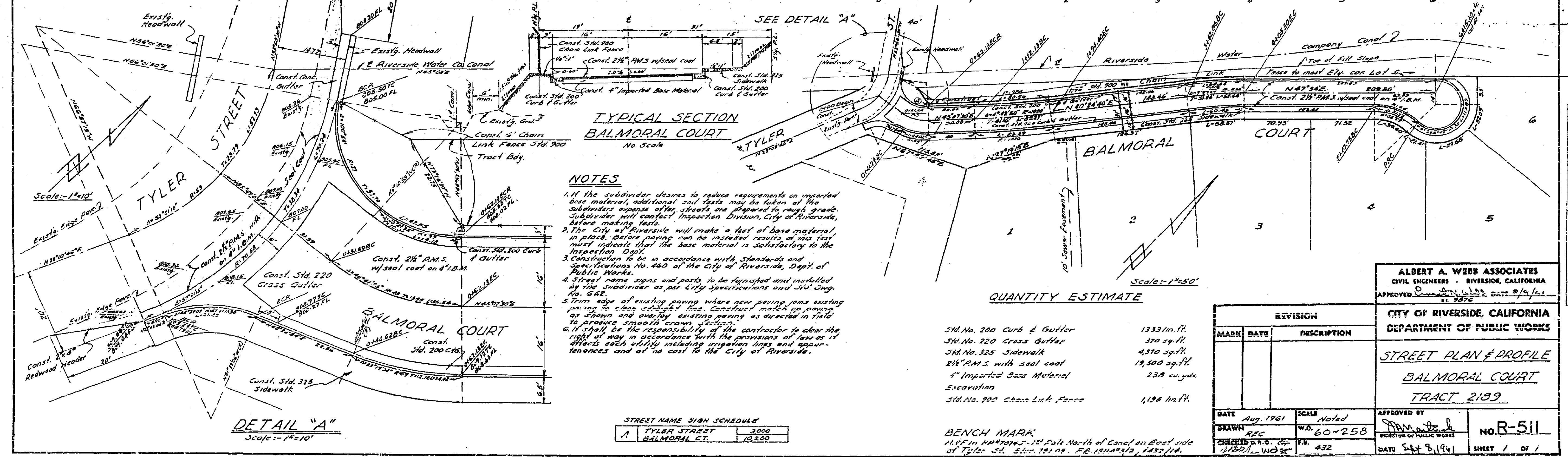

NO.	DATE	DESCRIPTION
1		AS SHOWN
2		AS SHOWN
3		AS SHOWN
4		AS SHOWN
5		AS SHOWN
6		AS SHOWN
7		AS SHOWN
8		AS SHOWN
9		AS SHOWN
10		AS SHOWN

- NOTES**
- If the subdivider desires to reduce requirements on imported base material, additional soil tests may be taken at the subdividers expense after streets are prepared to rough grade. Subdivider will contact Inspection Division, City of Riverside, before making tests.
 - The City of Riverside will make a test of base material, in place. Before paving can be initiated results of this test must indicate that the base material is satisfactory to the Inspection Dept.
 - Construction to be in accordance with Standards and Specifications No. 460 of the City of Riverside, Dept. of Public Works.
 - Street name signs and posts to be furnished and installed by the subdivider as per City Specifications and Std. Spec. No. 522.
 - Trim edge of existing paving where new paving joins existing paving to clean straight line. Construct match up paving as shown and overlay existing paving as directed in field to produce smooth crown section.
 - It shall be the responsibility of the contractor to clear the right of way in accordance with the provisions of law as it affects cuts utility including irrigation lines and appurtenances and at no cost to the city of Riverside.

QUANTITY ESTIMATE

Std. No. 200 Curb & Gutter	1333 lin. ft.
Std. No. 220 Grass Gutter	370 sq. ft.
Std. No. 325 Sidewalk	4370 sq. ft.
2 1/2" P.M.S. with seal coat	19,500 sq. ft.
4" Imported Base Material	238 cu. yds.
Excavation	
Std. No. 900 Chain Link Fence	1,198 lin. ft.

BENCH MARK
 11.5' in height - 12' pole North of Canal on East side of Tyler St. Elev. 841.08 - E.B. 11/10/52, 1482/114.

STREET NAME 3/8" SCHEDULE

A TYLER STREET	3000
B BALMORAL CT.	10200

ALBERT A. WEBB ASSOCIATES
 CIVIL ENGINEERS - RIVERSIDE, CALIFORNIA
 APPROVED: [Signature] DATE: 8/9/61

CITY OF RIVERSIDE, CALIFORNIA
 DEPARTMENT OF PUBLIC WORKS

STREET PLAN & PROFILE
BALMORAL COURT
TRACT 2189

DATE	Aug. 1961	SCALE	Noted	APPROVED BY	[Signature]
DRAWN	REC	W.D.	60-258	REGISTERED PROFESSIONAL ENGINEER	
CHECKED	R.E.S.	P.R.	432		
DATE	Sept. 8, 1961				

NO. R-511
 SHEET 1 OF 1