

NO.	DATE	DESCRIPTION
1		ISSUED FOR PERMITS
2		ISSUED FOR CONSTRUCTION
3		ISSUED FOR RECORD

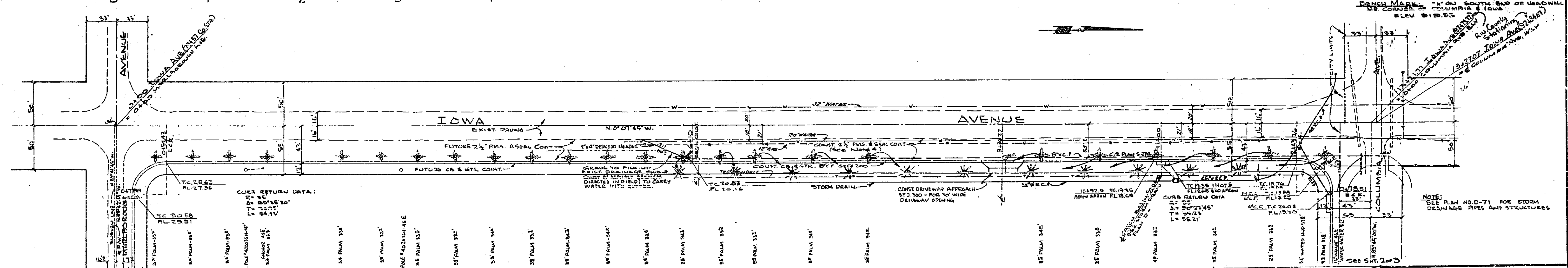

NO.	DATE	DESCRIPTION
1		ISSUED FOR PERMITS
2		ISSUED FOR CONSTRUCTION
3		ISSUED FOR RECORD

- GENERAL NOTES**
- IT SHALL BE THE RESPONSIBILITY OF THE CONTRACTOR TO CLEAR THE RIGHT OF WAY IN ACCORDANCE WITH THE PROVISIONS OF LAW AS IT AFFECTS EACH UTILITY INCLUDING IRRIGATION LINES AND APPURTENANCES AND AT NO COST TO THE CITY.
 - CONSTRUCTION SHALL BE IN ACCORDANCE WITH THE CITY OF RIVERSIDE, DEPARTMENT OF PUBLIC WORKS SPECIFICATIONS NO. 400 AND STANDARD DRAWINGS.
 - IF THE DEVELOPER WISHES TO REDUCE REQUIREMENTS FOR IMPROVED BASE MATERIAL ADDITIONAL SOIL TESTS MAY BE TAKEN AT THE EXPENSE OF THE DEVELOPER. AFTER THE STREETS ARE PREPARED TO BURN GRADE, DEVELOPER WILL CONTACT THE INSPECTION DIVISION, CITY OF RIVERSIDE BEFORE MAKING TESTS. THE CITY OF RIVERSIDE WILL MAKE A TEST OF BASE MATERIAL IN PLACE. BEFORE PAVING CAN BE INSTALLED, RESULTS OF THIS TEST MUST INDICATE THAT BASE MAT. IS SATISFACTORY TO INSPECTION DEPARTMENT.
 - TALL EDGES OF EXISTING PAVING WHERE NEW DRIVE JOINS EXISTING PAVEMENT TO CLEAN STRAIGHT LINE. CONTRACTOR SHALL USE FINISH BY SLOWLY AND OVERLAY EXISTING PAVING AS DIRECTED IN FIELD TO PRODUCE SMOOTH CROWN SECTION.
 - TREES HAVE BEEN RELOCATED AS INDICATED BY ARROWS. COMPLETION TESTS TO BE TAKEN WHERE PLANTING HAS BEEN REMOVED PRIOR TO PLANTING, I.E.

APPROVED FOR ASSOCIATION DIRECTOR

DATE: 9-18-61

ALBERT A. WESS ASSOCIATES
 CIVIL ENGINEERS - RIVERSIDE, CALIFORNIA
 APPROVED: [Signature] DATE: 9-18-61

CITY OF RIVERSIDE, CALIFORNIA
 DEPARTMENT OF PUBLIC WORKS

IOWA AVENUE
 MARLBOROUGH AVE. to COLUMBIA AVE.

MARK	DATE	DESCRIPTION

DATE: MAR-1961 SCALE: HORIZ. 1"=50' VERT. 1"=5'

DRAWN: [Signature] W.D. VEST 12-51

CHECKED: [Signature] P.B. 3-5-66

APPROVED BY: [Signature] DIRECTOR OF PUBLIC WORKS

NO. R-514 DATE: 9-18-61 SHEET 1 OF 3

SEE SHEET 2 OF 3 FOR QUANTITY ESTIMATE

Dwg No. 61-31 A

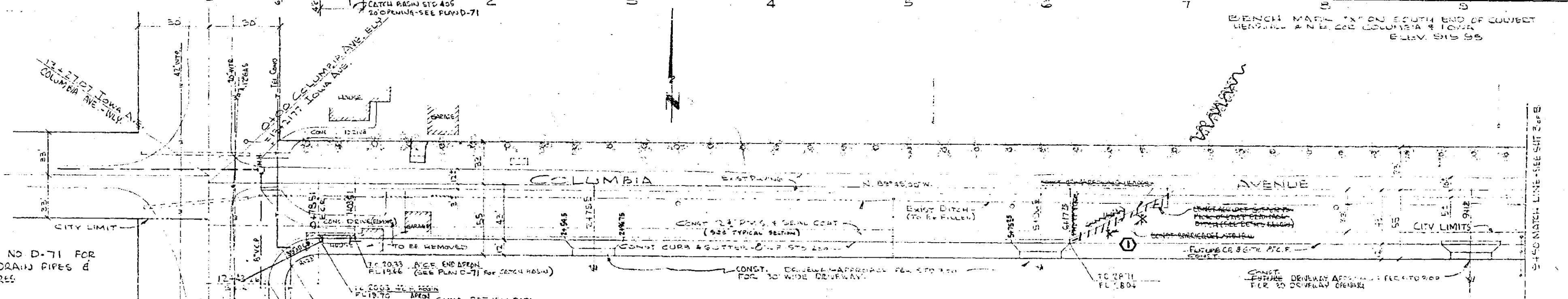
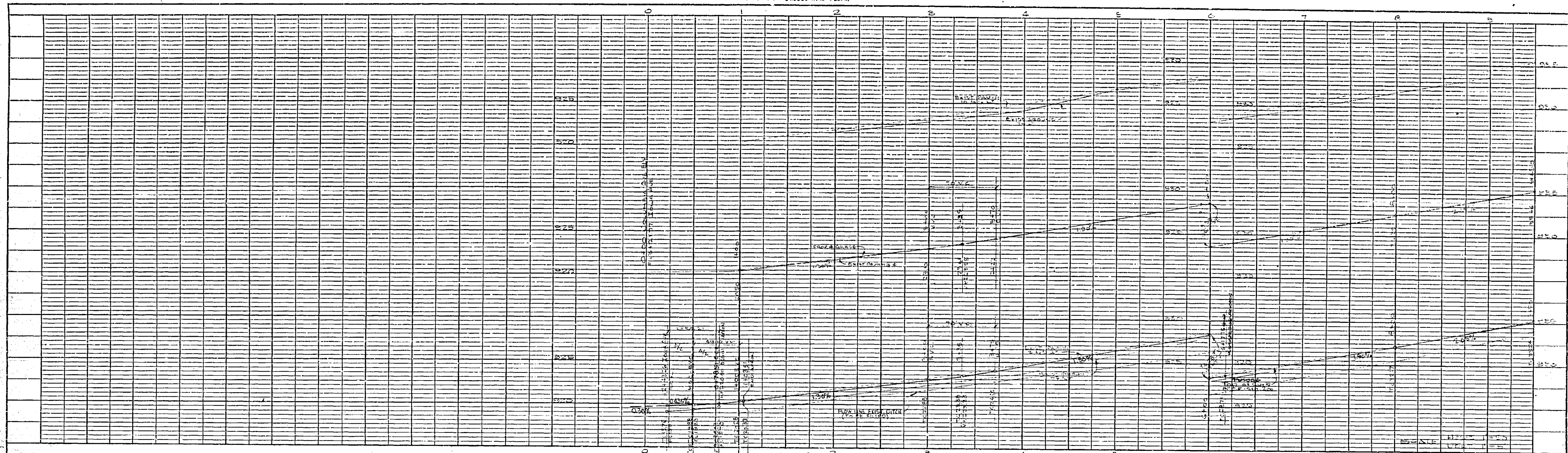

NOTE:
 SEE PLAN NO D-71 FOR
 STORM DRAIN PIPES &
 STRUCTURES

ESTIMATE DOES NOT INCLUDE EXTENSIVE PER
 REVISION ①

QUANTITY ESTIMATE

CURB AND GUTTER 30" x 6" x 6" C.P.	1300 LF
PLANT MIX CONCRETE & SEAL COAT	3250 SF
IMPORTED SAND MATERIAL	2000 CY
2" x 4" REDWOOD PLANKS	175 LF
CONCRETE REMOVAL (DEBRIS)	1700 SF
ADJUST MANHOLE	1 EA
BARRICADE CTS 150	2 EA
ASPHALT GUTTER (PER PLAN)	250 SF
CONCRETE DRIVEWAY APPROACHES 6" x 6" (150) SF	

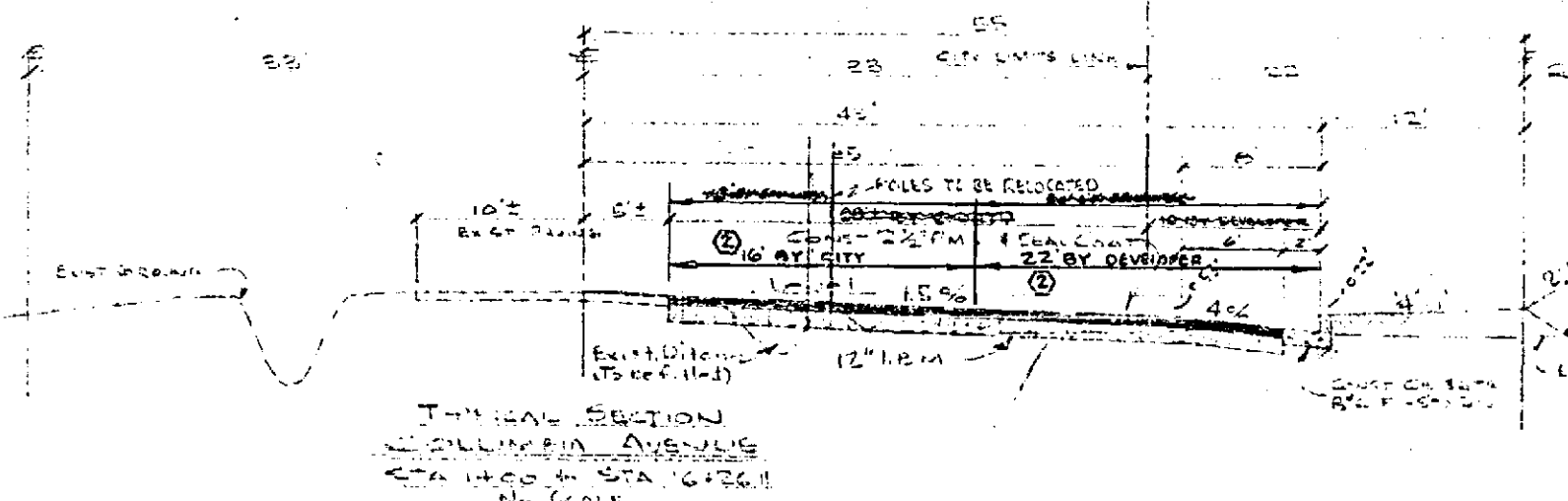
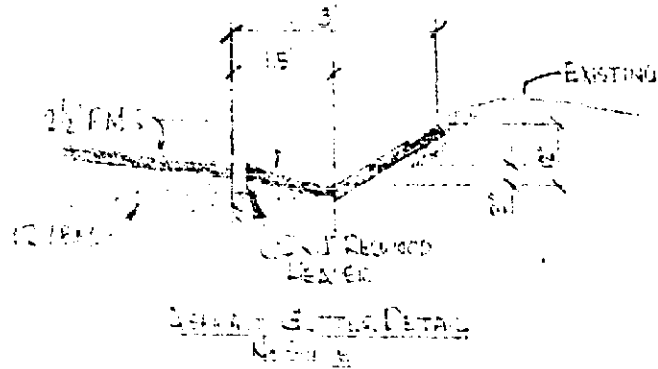

APPROVED: _____ 1961
 A. C. LEITH
 SUPERVISOR, PUBLIC WORKS DEPARTMENT
 BY: *A. L. Duvall* DEPUTY

ALBERT A. WEBB ASSOCIATES
 CIVIL ENGINEERS - RIVERSIDE, CALIFORNIA
 APPROVED: _____ DATE: 3-25-61

CITY OF RIVERSIDE, CALIFORNIA
 DEPARTMENT OF PUBLIC WORKS

REVISION		DESCRIPTION
MARK	DATE	
①	12-15-61	Original amount of paving to be installed by City & County. Estimated amount of paving to be installed by City & County. Estimated amount of paving to be installed by City & County.
②	12-6-61	Amounts of paving to be installed by City & County. Estimated amount of paving to be installed by City & County. Estimated amount of paving to be installed by City & County.

DATE: MAY 11 1961 SCALE: 1" = 10' HORIZ. 1" = 4' VERT.

DRAWN: _____ W.O.
 CHECKED: _____ F.B.
 DATE: 9-8-61

APPROVED BY: *[Signature]*
 DIRECTOR OF PUBLIC WORKS
 NO. E-514
 SHEET 2 OF 3

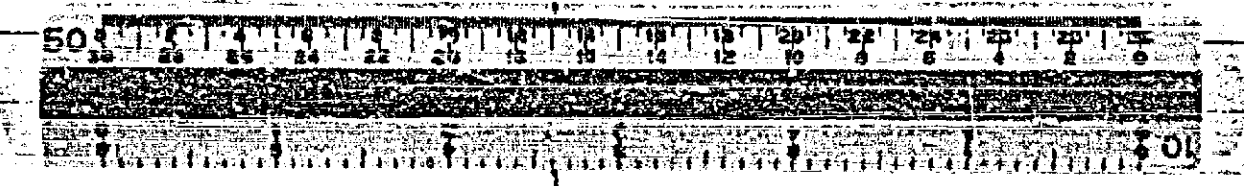

PROFILE
 DATE: _____
 DRAWN BY: _____
 CHECKED BY: _____

PLAN
 DATE: _____
 DRAWN BY: _____
 CHECKED BY: _____

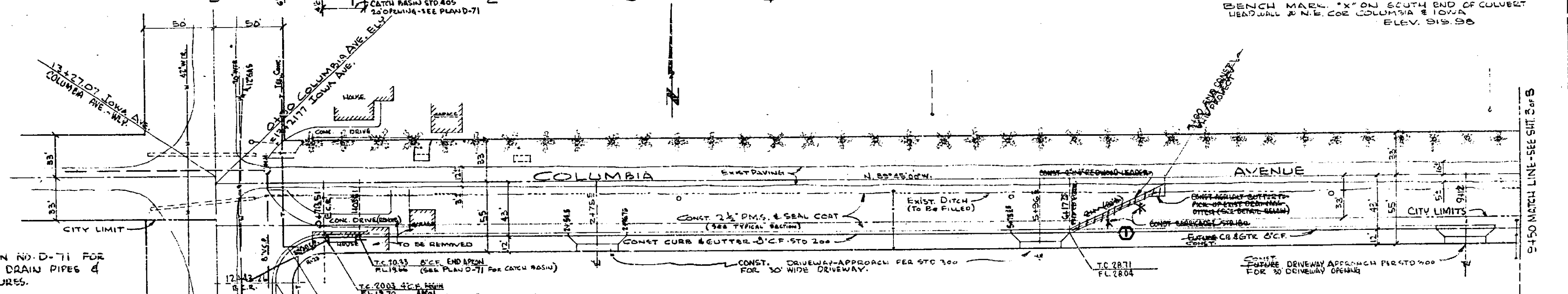
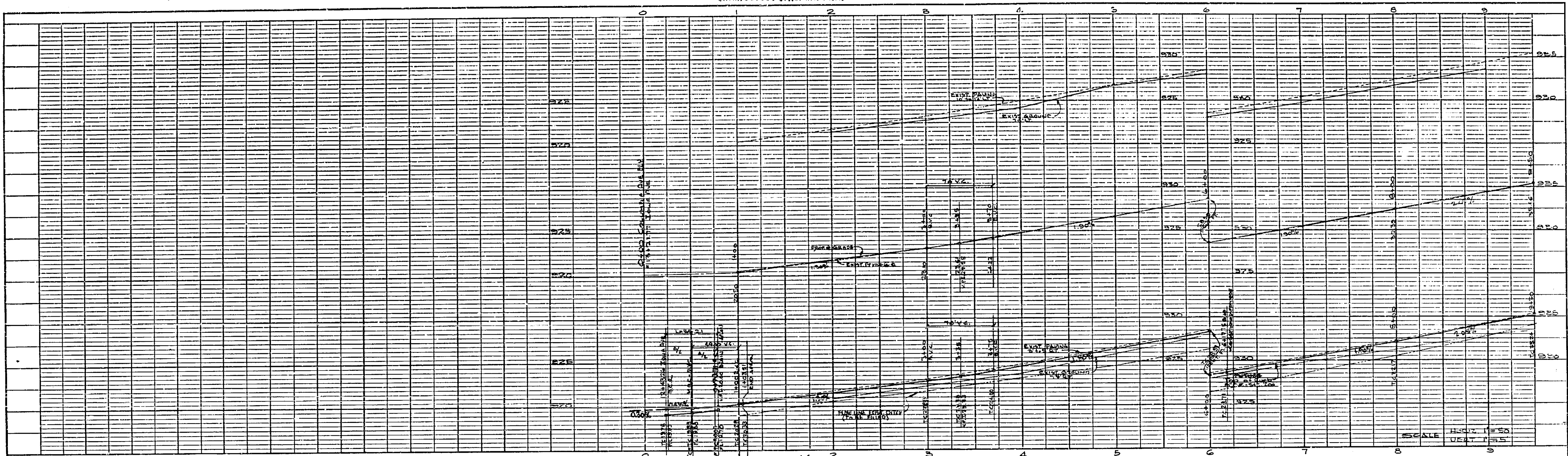

NOTE:
 SEE PLAN NO. D-71 FOR
 STORM DRAIN PIPES &
 STRUCTURES.

QUANTITY ESTIMATE

ESTIMATE DATA NOT REPLANT EXTENSION PER DIVISION ①

CURB AND GUTTER - STD. 24" - 3" C.F.	1909 L.F.
PLANT MIX SURFACE & SEAL COAT	37,870 S.F.
IMPORTED BASE MATERIAL	2000 C.Y.
2" x 4" REDWOOD HEADS	133 L.F.
CONCRETE REMOVAL (DRIVES)	1700 S.F.
ADJUST MANHOLES	1 EA.
BARRICADE - STD. 180	2 EA.
ASPHALT GUTTER (Per Detail)	255 S.F.
CONCRETE DRIVEWAY APPROACHES - STD 30" (314)	1150 S.F.

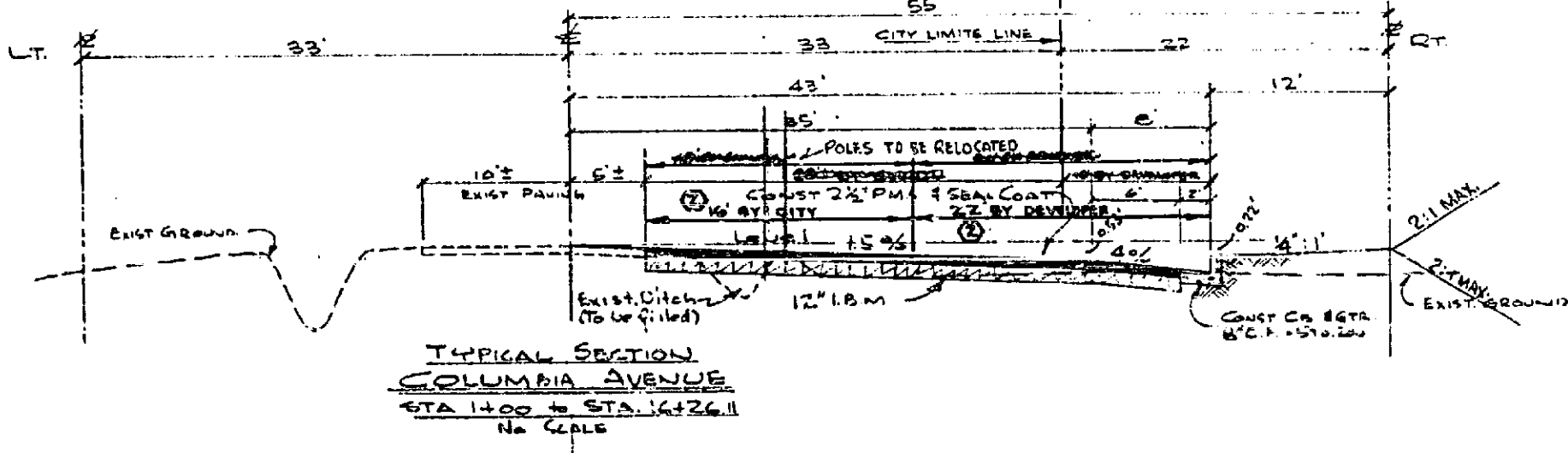
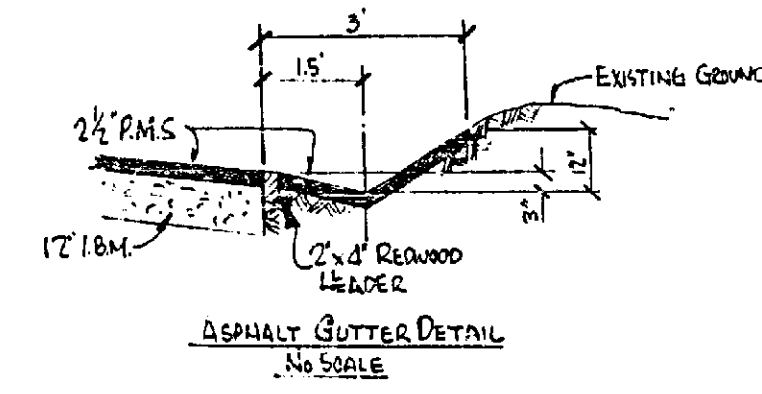

APPROVED: 1961
 A.C. KEITH
 ASSISTANT COUNTY CLERK

ALBERT A. WEBB ASSOCIATES
 CIVIL ENGINEERS - RIVERSIDE, CALIFORNIA
 APPROVED: *Ernest H. Webb* DATE 3-20-61
 115576

CITY OF RIVERSIDE, CALIFORNIA
 DEPARTMENT OF PUBLIC WORKS

MARK	DATE	DESCRIPTION
A	12-15-61	Changed quantity of paving to be included by City & Division
①	1-12-61	RETURNED QUANT. OF IMPROVEMENTS FROM TIME SHEET FOR APPROVED QUANTITIES
②	7-6-61	ASST. 11-22 Amounts of paving to be included by City & Division added to the total (see Cont. 5th. 1000 Section) 1005 780

DATE: MARCH 1961
 SCALE: HORIZ 1" = 50'
 VERT 1" = 5'
 DRAWN: *W.C.*
 CHECKED: *W.C.*
 DATE: 9-18-61
 SHEET 2 OF 3

PROFILE
 DATE: 9-18-61
 NO. R-514

PLAN
 DATE: 9-18-61
 NO. R-514

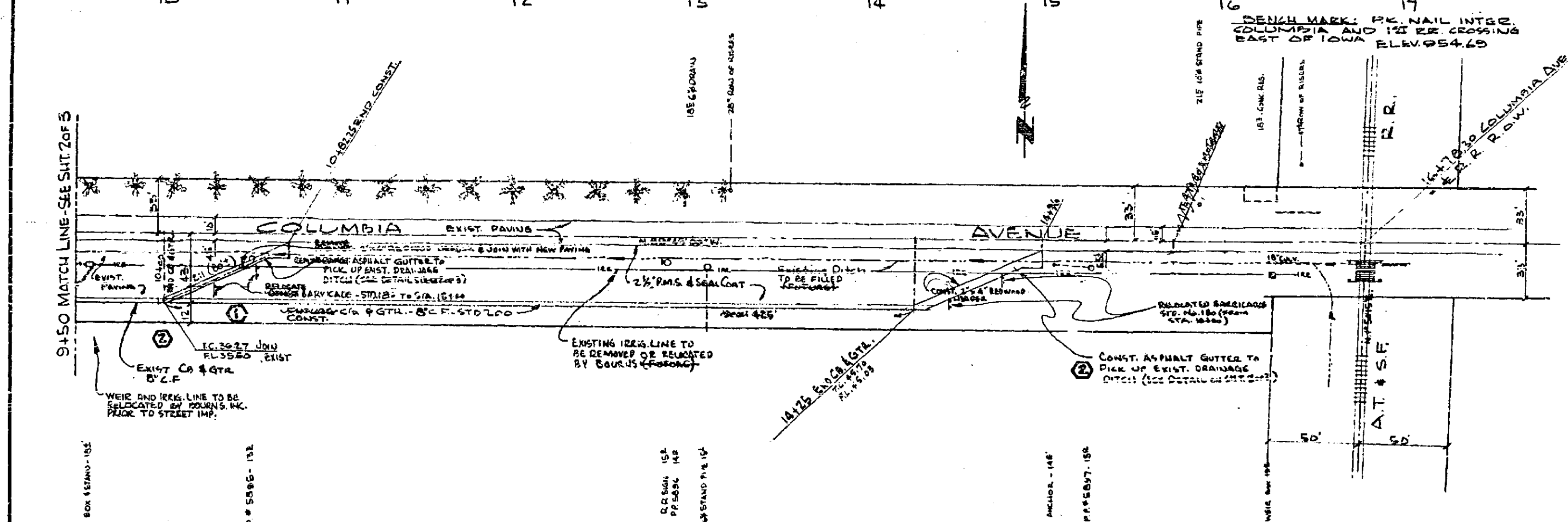
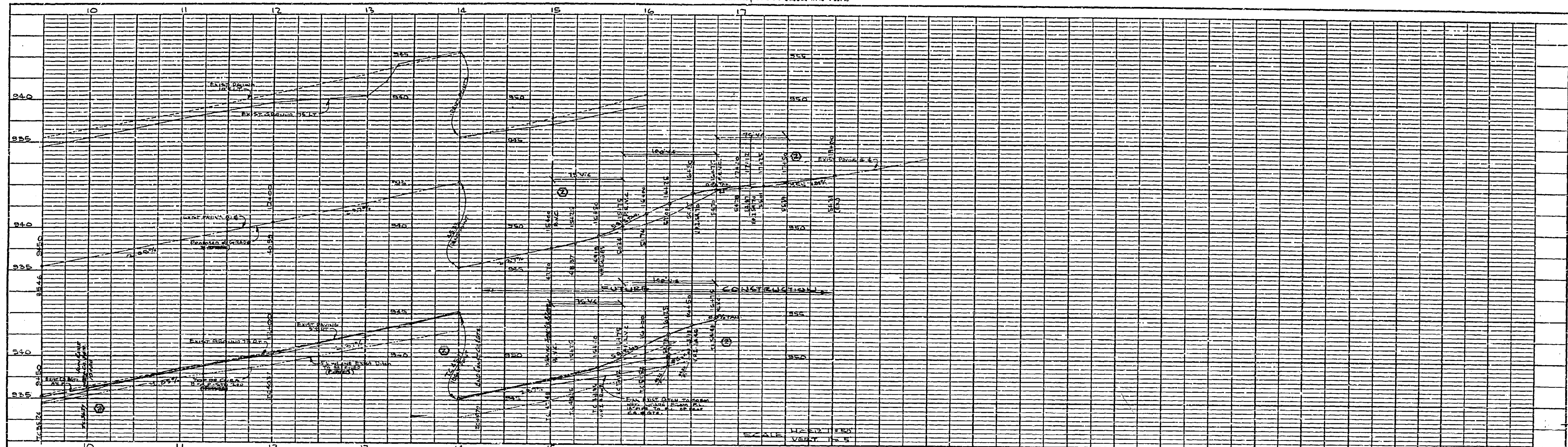

SEE SHEET 2 OF 3 FOR TYPICAL SECTION
 SEE SHEET 1 OF 3 FOR GENERAL NOTES

APPROVED _____, 1961
 A.C. KRITZ
 RIVERSIDE COUNTY RESS. COMMISSIONER
 BY *a.c. Muesel* DEPUTY

ALBERT A. WEBB ASSOCIATES
 CIVIL ENGINEERS - RIVERSIDE, CALIFORNIA
 APPROVED *Albert A. Webb* DATE 3-28-61
 112876

REVISION		
MARK	DATE	DESCRIPTION
①	1-17-61	EXTENDED LIMITS OF RESPONSIBILITY FROM 1100 TO 1150 ST. SEE SHEET 1 OF 3
②	12-24-60	ADDED 1-18-62 SECTION TO SHOW BY WHAT OF GROUND PROFILES TO BE USED FOR GRADE
	1-16-61	ADDED LIMIT TO GRADE LINE BETWEEN STA 1114 AND 1115

CITY OF RIVERSIDE, CALIFORNIA
 DEPARTMENT OF PUBLIC WORKS
 COLUMBIA AVENUE
 IOWA AVENUE TO A.T. & S.F.R.R.
 APPROVED BY *James H. ...*
 DIRECTOR OF PUBLIC WORKS
 DATE 9-19-61
 SHEET 3 OF 3

DATE MARCH 1961 SCALE Horiz. 1"=50'
 DRAWN *dw* V.B. 1"=5'
 CHECKED *dw* P.B. 338/54

PROFILE	DATE	BY
DATE	BY	DATE
DATE	BY	DATE

PLAN	DATE	BY
DATE	BY	DATE
DATE	BY	DATE