

Hydraulic Calc. for CIP Arch
 Smooth Box (fully bedded)

A = 1.48 ft	Hydraulic Data
S = 0.0020	0.24%
n = 0.011	A = 19
V = 3.77 ft/s	T = 125
D = 2.8' CIP Arch	C = 0.30 existing condition
	Q = 83 cfs
	Using C = 0.50
	D = 18' CIP

- GENERAL NOTES:**
- All construction shall be in accordance with standard drawings and Specifications No. 461 of the City of Riverside, Dept. of Public Works.
 - It shall be the responsibility of the Contractor to clear the right of way in accordance with the provisions of law as it affects each utility including irrigation lines and appurtenances and at no extra cost to the City.
 - If the Subdivider desires to reduce requirements on imported base material, additional soil tests may be taken at the Subdivider's expense after streets have been prepared to rough grade. Subdivider will contact the Inspection Division, City of Riverside, before taking test. The City of Riverside will make a test of base material in place before paving can be installed. Results of this test must indicate that the base material is satisfactory to the Inspection Division.
 - Trim edge of existing paving to a clean straight line. Construct match-up paving and overlap on existing paving as directed in the field to produce a smooth, even surface.
 - Street name signs and posts to be furnished and installed by the Subdivider as per City of Riverside Standard No. 662.

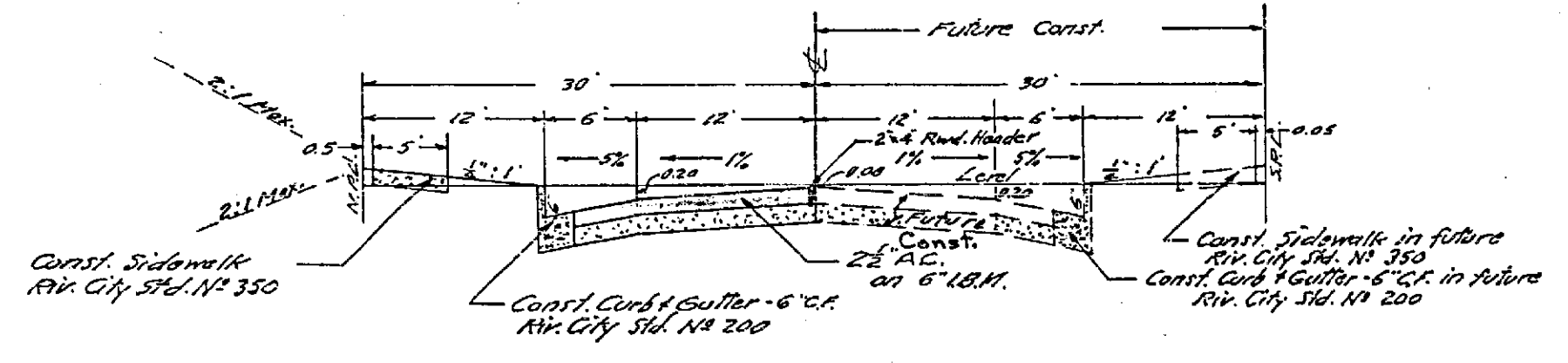
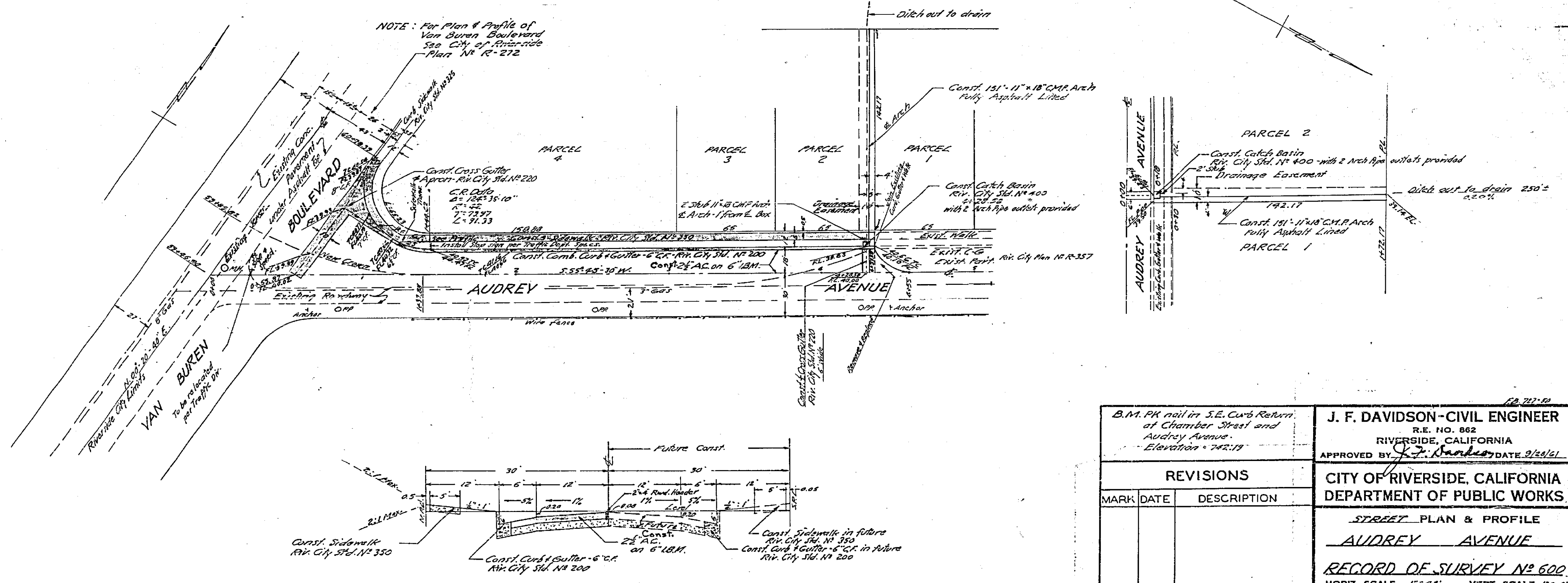

STREET NAME SIGN SCHEDULE

Dist.	Street	Block No.
10'	Van Buren Boulevard	7100
10'	Audrey Avenue	9200

B.M. PK nail in S.E. Curb Return at Chamber Street and Audrey Avenue. Elevation = 742.18		J. F. DAVIDSON - CIVIL ENGINEER R.E. NO. 862 RIVERSIDE, CALIFORNIA APPROVED BY: <i>[Signature]</i> DATE: 9/26/51	
REVISIONS			
MARK	DATE	DESCRIPTION	
STREET PLAN & PROFILE AUDREY AVENUE RECORD OF SURVEY NO. 600 HORIZ. SCALE 1" = 40' VERT. SCALE 1" = 4'			
DESIGNED BY	CHECKED BY	APPROVED BY	NO.
DRAWN BY	AGE	<i>[Signature]</i>	R-520
RECOMMENDED BY	ASSISTANT CITY ENGINEER	DATE	SHEET
<i>[Signature]</i>		9/24/51	1 OF 1

