

PROFILE	
DATE	10-15-62
BY	ADD
CHECKED BY	D.R.B.
APPROVED BY	ADD

STREET NAME SIGN SCHEDULE	
GRAND AVE	5000
CARLINGSFORD AVE	5000
DOVER CT	5000

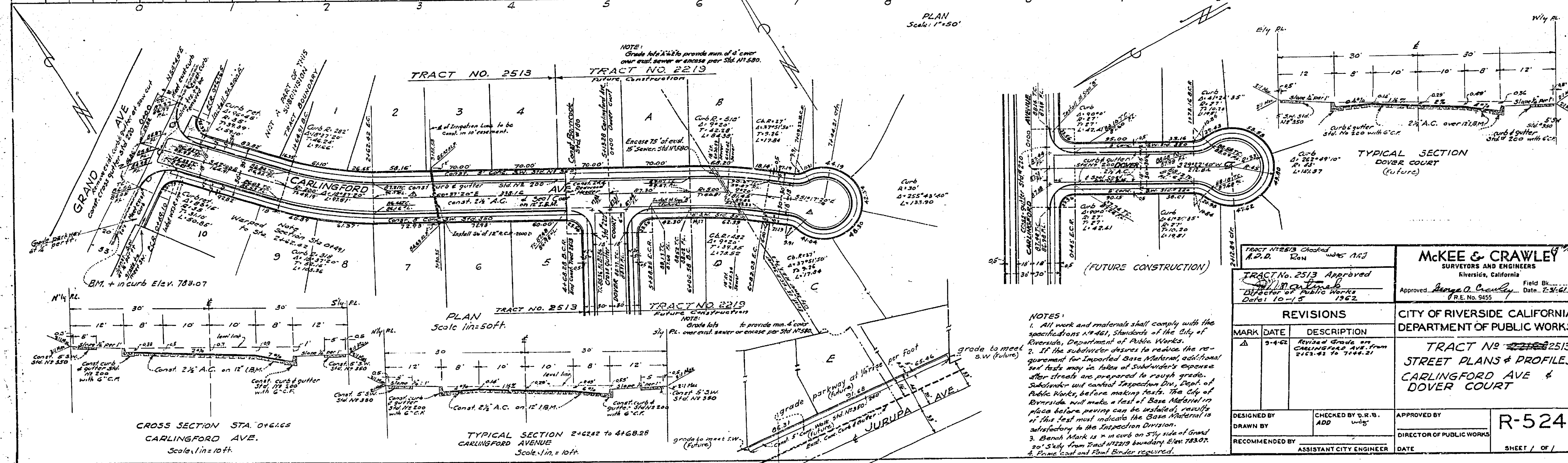

PLAN	
DATE	10-15-62
BY	ADD
CHECKED BY	D.R.B.
APPROVED BY	ADD

McKee & Crawley
SURVEYORS AND ENGINEERS
Riverside, California

Approved: *George A. Crawley* Date: 7-31-62
P.E. No. 9455

CITY OF RIVERSIDE CALIFORNIA
DEPARTMENT OF PUBLIC WORKS

TRACT NO. 2513
STREET PLANS & PROFILES
CARLINGSFORD AVE &
DOVER COURT

DESIGNED BY: ADD
DRAWN BY: ADD
RECOMMENDED BY: ASSISTANT CITY ENGINEER

CHECKED BY: D.R.B.
ADD

APPROVED BY: DIRECTOR OF PUBLIC WORKS
DATE

R-524
SHEET 1 OF 1

NOTES:

- All work and materials shall comply with the specifications of the City of Riverside, Department of Public Works.
- If the subcontractor desires to reduce the requirements for Imported Base Material, additional tests may be taken at Subcontractor's expense after streets are prepared to rough grade. Subcontractor will contact Inspection Div. Dept. of Public Works before making tests. The City of Riverside will make a test of Base Material in place before paving can be installed; results of this test must indicate the Base Material is satisfactory to the Inspection Division.
- Bench Mark is in curb on S.W. side of Grand 30' S.W. from Tract 11219 boundary Elev. 783.07.
- Final cost and Final Border required.

