

PROFILE OF DRAIN
 Scale: 1" = 10' Vert. 1" = 10' Hor.

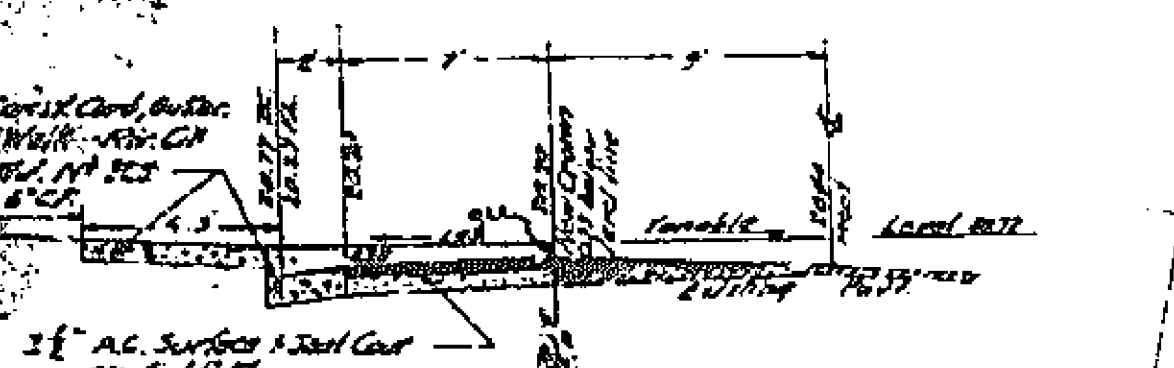

SECTION ON GLENHAVEN AVE
 SHOWING MATCH RAVING
 STA. 0+24.91
 Hor. Scale: 1" = 6' Vert. Scale: 1" = 1'

NOTE: From edge of existing paving to show straight line
 Condition markings paving as shown and overlap on
 existing paving of abutment in the field to produce a
 smooth crown surface

GENERAL NOTES
 1. All construction shall be in accordance with standard drawings
 & specifications of the City of Riverside, Dept. of Public Works
 2. It shall be the responsibility of the Contractor to clear the
 right of way in accordance with the provisions of law as
 to effects and utility including irrigation lines & appur-
 tenances and to restore same to the City
 3. If the Contractor desires to make improvements or amend
 these conditions, additional pay shall be paid as follows: If the
 proposed changes are of a nature which require the use of
 materials, the Contractor shall submit a statement of the
 proposed changes, before being made. The City of Riverside will
 determine if the proposed changes are of a nature which
 require the use of materials, and if so, the Contractor shall
 be allowed a percentage of the cost of the materials. The
 proposed changes shall be subject to the approval of the
 Street Name Sign and shall be furnished and installed
 by the Contractor per City of Riverside Standard No. 162.

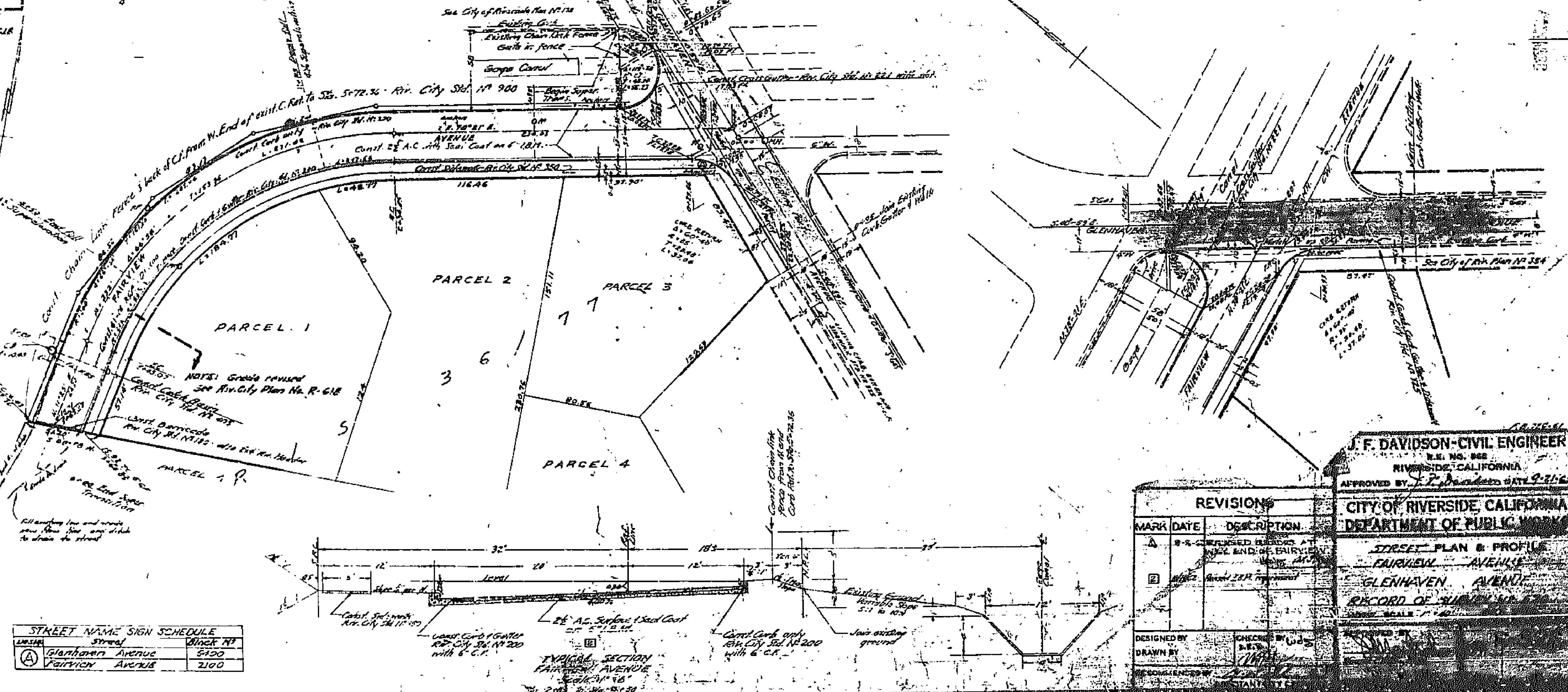

STREET NAME SIGN SCHEDULE

CLASS	Street	Sign #
(A)	Glenhaven Avenue	5100
(A)	Fairview Avenue	2100

REVISIONS

MARK	DATE	DESCRIPTION
1	8-8	REVISED BEING A MEL. END OF FAIRVIEW AVENUE
2	8-12	REVISED BEING A MEL. END OF FAIRVIEW AVENUE

J. F. DAVIDSON - CIVIL ENGINEER
 E.E. No. 888
 RIVERSIDE, CALIFORNIA
 APPROVED BY: *[Signature]* DATE: 8-21-24
CITY OF RIVERSIDE, CALIFORNIA
DEPARTMENT OF PUBLIC WORKS
STREET PLAN & PROFILE
FAIRVIEW AVENUE
GLENHAVEN AVENUE
 RECORD OF SURVEY
 SCALE: 1" = 40' HORIZ. 1" = 10' VERT.

DESIGNED BY: *[Signature]*
 DRAWN BY: *[Signature]*
 CHECKED BY: *[Signature]*
 RECOMMENDED BY: *[Signature]*